

KDF

Sports Flooring Systems & Building Materials

POLTRACK FULL PU RUNNING TRACK SYSTEM



www.kdf.gr

KDF LTD (www.kdf.gr) is one of the most dynamic and export-oriented Greek companies (currently activated in more than 70 countries in 4 continents), based in Greece (EU) and U.A.E too, with production facilities and warehouses in both countries for acrylic and polyurethane materials.

We are experts in sports, industrial and decorative flooring products and systems, with huge experience in Europe, Africa, Asia, Middle East and India as well.

Our export horizon is expanding rapidly and our goal is to stand out as a model of flexibility and competitiveness. The company, being one of the pioneer companies in the sector of sports flooring systems and building materials and giving particular attention to providing a fully upgraded range of products and services, provides certified systems by **ITF, IAAF, EU norms, LNE, LABOSPORT, ISASPORT, to name but a few.**

Our systems are approved in many ministries like:

- Ministry of Education in U.A.E
- Ministry of Education in K.S.A
- Ministry of Education in Oman
- Ministry of Education in Kuwait and many other institutes like
- Oman Royal Police
- Aramco, K.S.A
- Musanada in U.A.E
- Municipality of Doha
- Municipality of Dubai, Abu Dhabi, Sharjah and many others institutions.

KDF goes far beyond trade, providing consultancy in marketing and also technical support all the way, from the costing till the finalization of the project. Operating under the requirements of ISO 9001/2015 for production, trade and also application, we make sure our products are first applied successfully at site by our own people before we launch them abroad.

Therefore, our systems have all stood the real life test in different climates, from Middle East till Russia, and this is one of our main assets, enabling us to provide full and vertical technical support from specifying to final application plus supervision when required or even full application and costing.

We invite you to discover a world of sports flooring expertise and solutions.

VIEW OUR NEW SPORTS CATALOGUE



KDF - Kataskeves Dapedon LTD
e : exports@kdf.gr
w : www.kdf.gr

1 Papanikolaou Ave, Pefka
57010, Thessaloniki, Greece
t / f : 0030 2310 829598

INDICATIVE REFERENCE LIST OF PROJECTS

- 12 SCHOOLS IN U.A.E, MINISTRY OF EDUCATION(THROUGH VARIOUS CONTRACTORS) - 40000m² EPDM Rubber flooring
- AL ESKAN RUNNING TRACK - BURAIDAH, K.S.A -25000m² -Running track, POLTRACK SPRAYCOAT system
- UNIVERSITY OF DAMMAM - KSA - 13000m² - Acrylic cushion floorings
- KING ABDULLAH BASE AIR DEFENSE - TAIF, KSA - 12600 m² - Running track
- KING FAHD UNIVERSITY OF PETROLEUM AND MINERALS-DHARAN, KSA-12400m²-Rubber outdoor flooring
- RUNNING TRACK - K.S.A- 11000 m² - Running track, POLTRACK SANDWICH system
- GEMS SCHOOL - DUBAI, U.A.E - 10000 m² - Running track
- PASARGRAD WHOLESALE MARKET-IRAN - 10000 m² - Decorative flooring
- YAS ISLAND, ABU DHABI, U.A.E - 10000m² Bicycle track
- ANASTASIA KELESIDOU STADIUM/KONSTANTINOS KARAMANLIS - THESSALONIKI, GREECE - 10000m²
-Re-topping project, Running track, Sandwich system, Indoor & Outdoor running track
- ABHA STADIUM - K.S.A - 9000m² - POLTRACK SANDWICH system
- ABU DHABI STADIUM - U.A.E - 9000m² - Artificial Grass, POLITURF LEADER 55140
- ALEXANDRIA STADIUM - ALEXANDRIA, EGYPT - 8500 m² - Running track
- MINISTRY OF EDUCATION IN KUWAIT - KUWAIT - 8000m² - Polyurethane flooring, Polyflex Pu-In system
- SALAM STREET & MINA ROAD, ABU DHABI, U.A.E - 8000m² Bicycle track, Sportground-Ex system
- KING FAHAD NAVAL BASE - JUBAIL, KSA - 8000m² - Running track
- MUNICIPALITY OF VELVENTO - KOZANI, GREECE - 8000m², Running track
- PRINCE FAISAL STADIUM IN RIYADH - K.S.A - 8000m², Running track, POLTRACK SANDWICH system
- ABBHA, KSA - 7600m² - Running track
- MUNICIPALITY OF ZENICA - ZENICA, BOSNIA & HERZEGOVINA - 7500m², Poltrack Spraycoat, Running track
- ADNOC SCHOOLS - U.A.E - 7000m² - Safepol system
- MAJLIS BANDARAYA PETALING JAYA STADIUM - MALAYSIA - 7000m² POLTRACK SANDWICH
- ATLAS CENTER-BAM, IRAN - 7000 m² - Decorative flooring
- RUNNING TRACK - SUDAN - 7000 m² - Running track, POLTRACK SPRAYCOAT system
- RUNNING TRACK STADIUM - CRETE, GREECE - 6500 m² - Running track, POLTRACK SANDWICH system
- PLAYGROUND PROJECT - ABU DHABI, U.A.E - 6500 m², Safety flooring
- RUNNING TRACK PROJECT IN MUSCAT, OMAN - 6400 m² - POLTRACK SANDWICH system
- KAVALA STADIUM - KAVAL, GREECE - 6300m²- 8-lane Running track, POLTRACK SANDWICH SYSTEM
- CORNISH, JEDDAH, K.S.A - 6000m² Bicycle track Sportground-Ex system
- ARTIFICIAL GRASS PROJECT - ATHENS, GREECE - 5700m², Artificial grass
- PAPACHARALAMBIO STADIUM - NAFPAKTOS, GREECE - 5650m² - POLTRACK SANDWICH system
- YOKOGAWA ELECTRIC CORPORATION-DHAHRAN TECHNO VALLEY-DAMMAM, KSA - 5500m²- Epoxy antistatic floorings
- AMITY INTERNATIONAL SCHOOL - ABHU DHABI, U.A.E - 5500m², Poltrack Spraycoat, Running Track
- SHUQAIQ WATER AND ELECTRICITY COMPANY - JIZAN, KSA - 5400 m² - acrylic courts
- TALEEM UPTOWN SCHOOLS - DUBAI, UAE - 5400m²-Acrylic sports courts systems
- SAUDI AIR FORCE - KSA - 5250 m² - Acrylic coating elastoturf, running track
- SHIV NADER SCHOOL - FARIDABAD, INDIA - 5000 m² - Running track, POLTRACK SANDWICH system
- RUNNING TRACK - K.S.A - 5000 m² - Running track, POLTRACK SANDWICH system

-AL HAMRA, RAS AL KHAIMAH, U.A.E - 5000m² Bicycle track, Sportground-Ex system

-AIRBASE IN TAIF - KSA - 5000 m² - Running track

-AMERICAN SCHOOL AL BARSHA - DUBAI - 5000 m² - Running track, POLTRACK SPRAYCOAT system

-NATIONAL STADIUM OF KALAMPAKA - KALAMPAKA, GREECE - 4900m² - Running track, POLTRACK SEALED SPRAYCOAT system

-THAILAND STADIUM - 4800 m² - Running track, POLTRACK SANDWICH system

-DEPARTMENT OF EDUCATION ASIR REGION - KHAMIS, KSA - 4500 m² - Running track

-SERVIA STADIUM - KOZANI, GREECE - 4500m², Running track

-STADIUM OF ISLAMIC CITY OF BAWATH IN AL-AZHAR - EGYPT - 4500m²- Running track, POLTRACK SANDWICH SYSTEM

-MUNICIPALITY STADIUM OF MESSINI - GREECE - 4300m²- Running track, POLTRACK SANDWICH SYSTEM

-COMMUNITY COLLEGE - KHAMIS, KSA - 4200 m² - Running track

-FAYOUM INIVERSITY - EGYPT - 4200m² - Polyurethane sports flooring, POLYFLEX PU System

-MULTIPLE RUNNING TRACKS - ALGERIA - 40000 m² - Running track, POLTRACK SPRAYCOAT system

-SPORTS CLUB CENTER GLIFADA - ATHENS, GREECE - 4000m²- Poltrack Spraycoat, Running Track

-EMIRATES INTERNATIONAL SCHOOL - DUBAI, U.A.E - 4000m² - Safepol System, Playground flooring

-RUNNING TRACK PROJECT IN QATAR - 4000m², Poltrack Spraycoat system

-RUNNING TRACK PROJECT IN SAMOS - GREECE - 4000m², Poltrack Spraycoat system

-HH KHALID BIN BANDAR - RIYADH, KSA - 3800 m² - Volleyball/basketball rubber courts

-SPORTS FLOORING COMPLEX - ISRAEL - 3700 m², Acrylic sports flooring, SPORTFLOOR-EX system

-RUNNING TRACK- UKRAINE - 3600m² - RunningTrack, Poltrack Spraycoat system

-ANATOLIA GOLLEGE - THESSALONIKI, GREECE - 3600m², Running track

-AIMARJAN ASLAND – PARTIAL - 3600m²- Poltrack Sandwich, Running Track

-RUNNING TRACK - ISRAEL - 3500m² - Running track, POLTRACK SANDWICH system

-RUNNING TRACK PROJECT - EGYPT - 3500m² - Running track, POLTRACK SPRAYCOAT system

-BICYCLE TRACK PROJECT - GREECE - 3500m²- Acrylic sports flooring, SPORTGROUND-EX system

-MUNICIPALITY OF ALIMOS - ATHENS, GREECE - 3500m²- Acrylic sports flooring, SPORTGLOOR FAST

-MATRIX SPORTING CLUB - EGYPT - 3400m² - Polyurethane outdoor flooring, Polyflex PU-EX System

-RUNNING TRACK PROJECT - EGYPT - 3400m² - Running track, POLTRACK SPRAYCOAT system

-SPORTS CLUB CENTER KISSAMOS - CRETE, GREECE - 3200m²- Poltrack Sandwich, Running Track

-AL LUSAIL SPORTS CLUB - DOHA, QATAR - 3200m² - Jogging track

-SPORTS CLUB CENTER - SERVIA, GREECE - 3200m² - Poltrack Sandwich, Running Track

-STADIUM CENTER - UKRAINE - 3200m²- RunningTrack, Poltrack Spraycoat system

-KING KHALID UNIVERSITY - ABHA, KSA - 3100 m² - Running track

-ISLAMIC WORLD GARDEN - SHARJA, U.A.E - 3000m²- Safety flooring, SAFEPOL MULTICOLOR system

-AL FAIOUM UNIVERSITY - FAIOUM, EGYPT - 3000m²- Polyurethane indoor flooring, Polyflex PU-IN system

-WADY DEGLA OCTOBER CLUB - CAIRO, EGYPT - 3000m²- Acrylic sports courts

-SPORTS CLUB CENTER "PAPAGOU"- ATHENS, GREECE - 3000m²- Poltrack Sandwich, Running Track

-PANORAMA SPORTS COMPLEX - THESSALONIKI, GREECE - 3000m², Running track

-BENHA SPORTS CITY - EGYPT - 3000m²- Acrylic sports courts

-SPORTS COMPLEX IN UKRAINE - 3000m² - Safety flooring, SAFEPOL MULTICOLOR system

-ISLAMIC WORLD GARDEN - U.A.E - 3000m² - Playground flooring, SAFEPOL MULTICOLOR system

-JOGGING TRACK AT WATERFONT - K.S.A - 3000m² - POLTRACK JOGGING TRACK

-PLAYGROUND FLOORING IN SHARJA - U.A.E - 3000m² - Playground flooring, SAFEPOL MULTICOLOR

-SPORTS FLOORING PROJECT IN YEMEN - 3000m² - Acrylic sports courts, SPORTFLOOR-EX
-SPORTS SCHOOL PROJECT - ARTA, GREECE - 3000m² - Acrylic sports courts, POLYFLEX AEL-EX
-INDIAN ARMY - SAGAR, INDIA - 2800m² - Acrylic sports courts
-ALL SAINTS SCHOOL - MUMBAI, INDIA - 2700 m² - PU outdoor sports flooring and running track
-INDIAN INSTITUTE OF SCIENCE EDUCATION AND RESEARCH-BHOPAL,INDIA-2700m²-Acrylic sports courts
-RESORT IN RED SEA - EGYPT - 2700m²- Acrylic sports courts, FLEXFLOOR-EX system
-OUR OWN GOLF SCHOOL - 2700m²- Poltrack Spraycoat, RunningTrack
-STADIUM STUDENSKA, SPORTS COMPLEX - BARNNA, BOULGARIA - 2700m²-Acrylic sports courts, SPORTFLOOR-EX system
-RAKS PALLIKOODAM SCHOOL - INDIA - 2600m² - Acrylic sports courts, FLEXFLOOR-EX system
-DPS GUNTUR SITE, NEW DELHI INDIA - 2600m² - Acrylic sports courts, SPORTFLOOR-EX system
-HIGH SCHOOL COMPLEX - ATTIKA DISTRICT - 2500m² - Acrylic sports courts, SPORTFLOOR FAST system
-KURNISH AL KHOBAR - K.S.A - 2500m² - Rubber flooring, COLORFLEX system
-AL RAYAN, QATAR - 2500 m² - Running track, POLTRACK SANDWICH system
-OUTDOOR SPORTS VENUE - VARNA, BULGARIA - 2700 m² - Acrylic, ITF classified, 8 layers system
-ALHOSN SPORTS COMPLEX - 2400 m² - Running track, POLTRACK SANDWICH system
-SPORTS FLOORING PROJECT IN BULGARIA - 2200 m²- Acrylic sports courts, SPORTFLOOR-EX system
-TEACHERS COLLEGE - ABHA, KSA - 2050 m² - Running track
-MUSAB BIN OMAIR BOYS SCHOOL - BIN OMRAN, QATAR - 2050 m² - PU outdoor sport flooring
-BURAIRAT SCHOOL - RAK, UAE - 2000 m² - Running track
-SPORTS CENTRE OF GERAKAS - ATHENS, GREECE - 2000m² - Acrylic sports courts, SPORTFLOOR-EX
-HADAYEK ALAHRAM CLUB - GIZA, EGYPT - 2000m², PU outdoor sports flooring, POLYFLEX PU-EX WET-POUR system
-SCHOOL COMPLEX IN NAXOS ISLAND - GREECE - 2000m² - Acrylic sports courts, SPORTFLOOR-FAST
-AL SAILIYA BOYS SCHOOL - AL SAILIYA, QATAR - 2000 m² - Polyurethane, outdoor sport flooring
-KING KHALID UNIVERSITY - ABHA, KSA - 2000 m² - Volleyball/basketball rubber courts
-HH KHALID BIN BANDAR - RIYADH, KSA - 2000 m² - Volleyball/basketball rubber courts
-RAWDA RASHEED PRIMARY SCHOOL FOR BOYS - 2000 m²
-DAMIETTA GOVERNMENT - EGYPT - 2000m² - Running track, Poltrack Spraycoat Sealed System
-MUNICIPAL STADIUM OF GIANNITSA-GIANNITSA,GREECE-2000m² -Running track POLTRACK SANDWICH
-AL WAKAIR BOYS SCHOOL - AL WAKRAH, QATAR - 1950 m² - Polyurethane, outdoor sport flooring
-THE LAKE DISTRICT - PUNE, INDIA - 1950m²- Acrylic sports courts
-PRESIDENTIAL GUARD COMMAND MAHAWI - ABU DHABI, UAE - 1900m² - Football court
-GEMS CAMBRIDGE INTERNATIONAL SCHOOL - HOSHIYARPUR, INDIA - 1900m² - Acrylic sports courts, FLEXFLOOR-EX system
-UNITED (SABIC) SPORTS CLUB - 1900 m² - Rubber flooring
-OUTDOOR SPORTS FLOORING PROJECT - PAKISTAN - 1900 m² - Acrylic sports flooring, WET-POUR POLYFLEX AEL-EX
-SHOOLS MINISTRY OF EDUCATION - KHAMIS, KSA - 1800 m² - Rubber flooring
-AL MAJAD AMPHITHEATER - SHARJA, UAE - 1800m² - Certified Jogging track
-QASSIM UNIVERSITY - KSA - 1800m² - Polyurethane sports flooring
-MODERN ENGLISH SCHOOL - EGYPT - 1785m² - Running track, POLTRACK SPRAYCOAT
-AL QADSIYA MODEL INDEPENDENT SCHOOL - ALWAAB, QATAR - 1770 m² - PU outdoor sport flooring

-IKNS SCHOOL - BAHRAIN - 1700 m² - Playground flooring, SAFEPOL MULTICOLOR system

-AL WAHDA SPORT ACADEMY CLUB - ABU DHABI, UAE - 1700 m² - Acrylic sports system

-ALSARH SCHOOLS OF CIVIL - RIYADH, KSA - 1650m² - PU glue/Soccer field

-PLAYGROUND FLOORING PROJECT IN QATAR - 1650m² - SAFEPOL MULTICOLOR system

-GD GOENKA PUBLIC SCHOOL - PURNIA, INDIA - 1630m²- Acrylic sports courts

-SPA RESORT DERENIVSKUPIA KI - UZHGOROD, UKRAINE - 1600 m² - Flexfloor-ex system, volleyball court

-IISER, INDIAN INSTITUTE OF SCIENCE EDUCATION AND RESEARCH - BHOPAL, INDIA - 1600m² - Acrylic sports courts, FLEXFLOOR-EX system

-GRACANICA SPORTS CENTRE - KOSOVO - 1600m² - Running Track, POLTRACK PRAYCOAT system

-RUNNING TRACK PROJECT IN BOSNIA & HERZEGOVINA - 1585² - POLTRACK PRAYCOAT

-THE MILITARY HOSPITAL - RIYADH, KSA - 1560 m² - Volleyball/basketball rubber courts

-THE MILITARY HOSPITAL - RIYADH, KSA - 1560 m² - Pu glue-PU sports flooring

-STADIUM IN BAJRAM CURRI - TROPOJA, ALBANIA - 1550 m² - SPRAYCOAT system

-SCHOOL SPORTS COMPLEX IN POLIGIROS - GREECE - 1550m²- Acrylic flooring, SPORTFLOOR FAST

-AL FORSHAN SPORTS CENTRE - ABU DHABI, U.A.E - 1500m² - Smartfloor system, Acrylic flooring

-INDUSTRIAL FLOORING - BULGARIA - 1500m² - Epoxy flooring, Polepox Coat 814 system

-SCHOOL IN AL WAKRA CITY - DOHA, QATAR - 1500 m² - Playground flooring

-IRAQ ARMY CAMP - IRAQ - 1500m² - Acrylic flooring in 2,2mm

-SCHOOL IN AL WAKRA CITY - DOHA, QATAR - 1500 m² - Playground flooring

-BICYCLE TRACK PROJECT - LARISA-TRIKALA, GREECE - 1500 m² - SPORTGROUND-EX

-PROJECT GREEN LAND - DUBAI, UAE - 1500 m² - Jogging track

-UP TOWN SCHOOL - 1500m²- Poltrack Spraycoat, RunningTrack

-OUTDOOR SPORTS COURT COMPLEX - INDIA -1400m²- PU flooring, WET-POUR POLYFLEX PU-EX system

-INDIAN AIR FORCE - ALLAHABAD, INDIA - 1450m²- Acrylic sports courts

-SPORTS FLOORING PROJECT IN KOSOVO - STREET BALL - 1400m²- SPORTFLOOR-EX

-DUBAI MODERN HIGH SCHOOL - DUBAI, UAE - 1375 m² - Acrylic sports courts

-PROJECT ECOGREEN - DUBAI, UAE - 1350 m² - Jogging track

-SPORTS FLOORING PROJECT - BANSKO, BULGARIA - 1350 m² - Acrylic sports courts

-POLICE COMPLEX BARRACKS NIZWA - OMAN- 1300 m² - Colorflex, PU sport flooring

-POLICE COMPLEX BARRACKS AL AJAIZ - OMAN - 1300 m² - Colorflex, PU sport flooring

-POLICE COMPLEX BARRACKS KATMATMILAH SITE - OMAN- 1300 m² - Colorflex, PU sport flooring

-POLICE COMPLEX BARRACKS SUWAIQ - OMAN - 1300 m² - Colorflex, PU sport flooring

-POLICE COMPLEX BARRACKS AL KAMIL - OMAN - 1300 m² - Colorflex, PU sport flooring

-PLAYGROUND FLOORING - BAHRAIN - 1300m² - Safepol system

-POLICE COMPLEX BARRACKS SHINAS - OMAN - 1300 m² - Colorflex, PU sport flooring

-POLICE COMPLEX BARRACKS BHALA - OMAN - 1300 m² - Colorflex, PU sport flooring

-POLICE COMPLEX BARRACKS MUDHAIBI - OMAN - 1300 m² - Colorflex, PU sport flooring

-POLICE COMPLEX BARRACKS THUMRAIT - OMAN - 1300 m² - Colorflex, PU sport flooring

-POLICE COMPLEX BARRACKS AL KHOUDH - OMAN - 1300 m² - Colorflex, PU sport flooring

-POLICE COMPLEX BARRACKS MAHDAH - OMAN - 1300 m² - Colorflex, PU sport flooring

-POLICE COMPLEX BARRACKS BID BID - OMAN - 1300 m² - Colorflex, PU sport flooring

-POLICE COMPLEX BARRACKS AL KHABOORA - OMAN - 1300 m² - Colorflex, PU sport flooring

-POLICE COMPLEX BARRACKS DHANK - OMAN - 1300 m² - Colorflex, PU sport flooring

-POLICE COMPLEX BARRACKS HAFEET - OMAN - 1300 m² - Colorflex, PU sport flooring

-POLICE COMPLEX BARRACKS AUQAD - OMAN - 1300 m² - Colorflex, PU sport flooring
-POLICE COMPLEX BARRACKS SUMAIL - OMAN - 1300 m² - Colorflex, PU sport flooring
-MATRIX SPORTING CLUB - EGYPT - 1300 m² - Acrylic flooring, Flexfloor System
-OUTDOOR SPORTS VENUE - KOSOVO - 1300 m² - POLTRACK SPRAYCOAT System
-SPORTS HALL IBRI - MUSCAT, OMAN - 1300 m² - Indoor sports flooring POLYFLEX PU-IN
-ALHALAFI BREAK - RIYADH, KSA - 1276 m² - Rubber flooring
-DELHI PUBLIC SCHOOL - ETAWAH, INDIA - 1250m²- Acrylic sports courts, FLEXFLOOR-EX system
-GI-DHOFAR BEACH RESORT & SPA - OMAN - 1225 m² - Colorflex, PU sport flooring
-RLS BASIC EDUCATION SCHOOL SOHAR - OMAN - 1225 m² - Colorflex, PU sport flooring
-MIXED BASIC EDUCATION SCHOOL AL QABIL - OMAN - 1225 m² - Colorflex, PU sport flooring
-BOYS BASIC EDUCATION SCHOOL BARKHA - OMAN - 1225 m² - Colorflex, PU sport flooring
-GIRLS BASIC EDUCATION SCHOOL MUDHAIBI - OMAN - 1225 m² - Colorflex, PU sport flooring
-MIXED BASIC EDUCATION SCHOOL AL AMERAT - OMAN - 1225 m² - Colorflex, PU sport flooring
-UMSALAMA GIRLS SCHOOL - AL RAYYAN, QATAR - 1200 m² - Polyurethane, outdoor sport flooring
-SHERATON PARK - DOHA, QATAR - 1200 m² - Playground flooring
-RAWDA BIN JASSIM SCHOOL - AL AZIZIYAH, QATAR - 1200 m² - Polyurethane, outdoor sport flooring
-GEMS WESTMINISTER SCHOOL - DUBAI, U.A.E - 1200 m² - Acrylic sports courts
-SILVER SPORTS CLUB - INDIA - 1200m²- Acrylic sports courts
-OUR OWN SCHOOL - SHARJA, U.A.E - 1200m² - Acrylic sports courts
-SHARJAH FOOTBALL CLUB - SHARJAH, UAE - 1200 m² - Polyurethane basketball courts
-SHERATON PARK - DOHA, QATAR - 1200 m² - Playground flooring
-CHILE RUNNING TRACK PROJECT - 1200 m² - Running track, POLTRACK SPRAYCOAT system
-EGYPT RUNING TRACK PROJECT - 1200m², Running Track, POLTRACK SPRAYCOAT system
-EGYPT RUNING TRACK PROJECT - 1200m², Running Track, POLTRACK SANDWICH system
-ALIGARH MUSLIM UNIVERSITY - ALIGARH, INDIA - 1200 m² - Acrylic sports courts, FLEXFLOOR-EX system
-SUMMER RESORT, KIDS PALLY AREA - CHALKIDIKI, GREECE - 1200 m² - Playground flooring, SAFEPOL
-SPORTS FLOOR PROJECT IN PAKISTAN - 1200 m² - Acrylic sports courts, POLYFLEX AEL-EX
-SYMBIOSIS COLLEGE - INDIA - 1180m²- Acrylic sports courts
-SPORTS PROJECT IN EGYPT - 1170m²- Acrylic sports courts, POLYFLEX AEL-EX
-PROFESSOR ABDULAZIZ ANQARI - RIYADH, KSA -1150m² - PU glue/Socccer field
-ACRYLIC, OUTDOOR SPORTS FLOORING PROJECT - KARACHI, PAKISTAN -1150m² - FLEXFLOOR-EX
-AL SAQID ISLAMIC ENGLISH SHCOLL-DUBAI,UAE-1100m²- Acrylic flooring, WET-POUR POLYFLEX AEL-EX
-FIRST POINT SCHOOLS - DUBAI, UAE - 1100m² - Acrylic sports courts-
SHARJAH FOOTBALL CLUB - SHARJAH, UAE - 1200 m² - Polyurethane basketball courts
-SHERATON PARK - DOHA, QATAR - 1200 m² - Playground flooring
-CHILE RUNNING TRACK PROJECT - 1200 m² - Running track, POLTRACK SPRAYCOAT system
-EGYPT RUNING TRACK PROJECT - 1200m², Running Track, POLTRACK SPRAYCOAT system
-EGYPT RUNING TRACK PROJECT - 1200m², Running Track, POLTRACK SANDWICH system
-ALIGARH MUSLIM UNIVERSITY - ALIGARH, INDIA - 1200 m² - Acrylic sports courts, FLEXFLOOR-EX system
-SUMMER RESORT, KIDS PALLY AREA - CHALKIDIKI, GREECE - 1200 m² - Playground flooring, SAFEPOL
-SPORTS FLOOR PROJECT IN PAKISTAN - 1200 m² - Acrylic sports courts, POLYFLEX AEL-EX
-SYMBIOSIS COLLEGE - INDIA - 1180m²- Acrylic sports courts
-SPORTS PROJECT IN EGYPT - 1170m²- Acrylic sports courts, POLYFLEX AEL-EX
-PROFESSOR ABDULAZIZ ANQARI - RIYADH, KSA -1150m² - PU glue/Socccer field

-ACRYLIC, OUTDOOR SPORTS FLOORING PROJECT - KARACHI, PAKISTAN -1150m² - FLEXFLOOR-EX
-AL SAQID ISLAMIC ENGLISH SHCOLL-DUBAI,UAE-1100m²- Acrylic flooring, WET-POUR POLYFLEX AEL-EX
-FIRST POINT SCHOOLS - DUBAI, UAE - 1100m² - Acrylic sports courts
-MAADI BRITISH SCHOOL- EGYPT - 1100m², Multipurpose court, COLORFLEX system
-CENTRAL SQUARE OF MUNICIPALITY OF THERMI - THESSALONIKI, GREECE - 1100m², Decorative flooring MARMOR FLOOR system
-DUBAI AMERICAN ACADEMY - DUBAI, UAE - 1080 m² - Acrylic sports court
-PRELUDE PUBLIC SCHOOL - AGRA, INDIA - 1070m²- Acrylic sports courts
-INDOOR SPORTS FLOORING PROJECT - JORDAN - 1055m² - Polyurethane POLYFLEX PU-IN
-ALMGBAL BREAK - RIYADH, KSA - 1050 m² - Rubber playground
-BANIYAS CLUB AND AL AIN ENGLISH SPEAKING SCHOOL - ABU DHABI, UAE - 1000m² - Acrylic flooring
-WADY DEGLA LOTUS PROJECT - CAIRO, EGYPT - 1000 m² - Acrylic flooring, Wet-Pour Polyflex AEL-EX system.
-JINDAL UNIVERSITY - SONIPAT, HARYANA, INDIA - 1000m² - PU flooring WET-POUR POLYFLEX PU-EX
-MINISTRY OF EDUCATION - DAMMAM, KSA - 1000 m² - PU indoor multipurpose sports flooring
-SHEIKH OBEID MAKTHOUM PALACE - 1000m² - Outdoor polyurethane flooring
-INDIAN AIR FORCE - AGRA, INDIA - 1000m² - Acrylic sports courts
-INDONESIA - 1000 m² - PU indoor multipurpose sports flooring
-INDIAN AIR FORCE - LUCKNOW, INDIA - 1000m² - Acrylic sports courts
-MULTIPURPOSE POLYURTEHANE INDOOR COURTS - F.Y.R.O.M - 1000m² - Polyflex PU-In system
-SODIC PROJECT - EGYPT - 1000m², Multipurpose court, COLORFLEX system
-INDIAN AIR FORCE - VARANASI, INDIA - 1000m² - Acrylic sports courts
-INTERNATIONAL SCHOOL OF CREATIVE SCHIENCE - SHARJAH, U.A.E - 1000m² - Safepol System
-INDIAN AIR FORCE - BIHTA, INDIA - 1000m² - Acrylic sports courts
-INDIAN AIR FORCE - DARBHANGA, INDIA - 1000m² - Acrylic sports courts
-AL AIN INDIAN SCHOOL - AL AIN, UAE - 1000m² - Football court
-GREEK AIR FORCE ACADEMY - TATOI, ATHENS, GREECE - 1000m² - PU flooring, POLYFLEX PU-IN
-DUBAI SCHOLRAS PRIVATE SCHOOL - DUBAI, U.A.E - 1000m² - Acrylic flooring in 2,2mm
-OBOOR SPORTS CLUB - EGYPT - 1000m² - Acrylic flooring
-INDOOR SPORTS PROJECT IN OMAN - MINISTRY OF EDUCATION - 1000m² - PU sports flooring
-VIT AP CAMPUS, AMARAVANTHI, VIJAYAWADA, ANDHRA PRADESH - INDIA - 985m² POLYFLEX PU-IN
-MONARCH INTERNATIONAL SCHOOL - 950m²- Acrylic sports courts, FLEXFLOOR-EX system
-FOOTBALL COURT - LIMASSOL, CYPRUS - 950m²- Artificial grass, POLITURF IMPERIAL 50140
-COMMUNITY COLLEGE - KHAMIS, KSA - 940 m² - Polyurethane indoor multipurpose sports flooring
-GEMS METROPOLE SCHOOL - DUBAI, U.A.E - 900 m² - Playground flooring
-PLAYGROUND FLOORING IN KHARKIV-2 - UKRAINE - 900m² - SAFEPOL MULTICOLOR system
-MINISTRY OF EDUCATION - ABHA, KSA - 900 m² - Polyurethane indoor multipurpose sports flooring
-BAB AL SHAMS SPA HOTEL - DUBAI, UAE - 900m² - Football court
-CAIRO FESTIVAL CITY ORIANA PROJECT - EGYPT - 855m² - Playground flooring, SAFEPOL MULTICOLOR
-INDIAN NAVY - KOCHI, INDIA - 850m² - Acrylic sports courts, FLEXFLOOR-EX system
-GALGOTIAS UNIVERSITY - NOIDA, INDIA - 830m²- Acrylic sports courts, FLEXFLOOR-EX system
-KING KHALID UNIVERSITY - ABHA, KSA - 820 m² - Polyurethane indoor multipurpose sports flooring
-JINDAL UNIVERSITY - SONIPAT, HARYANA, INDIA - 800m² - POLTRACK JOGGING TRACK
-ARTIFICIAL GRASS - STATOVCHA, BULGARIA - 800m² - Artificial grass, POLITURF ROYAL 5588

-SCHOOL IN AL WAKRA CITY - DOHA, QATAR - 800m² - Polyurethane sports flooring

-SULTAN MANOR - RIYADH, KSA - 800m² - Polyurethane multipurpose sports flooring

-MINISTRY OF EDUCATION - AL KHARIZ, KSA - 800m² - PU indoor multipurpose sports flooring

-GEMS AMERICAN ACADEMY - ABU DHABI - U.A.E - 800m² - Running track POLTRACK SANDWICH

-INDOOR SPORTS COURT - MALAYSIA - 800m² - PU indoor sports flooring

-KID'S PLAY AREA IN MALL - MOROCCO - 800m² - PU indoor sports flooring, POLYFLEX PU-IN system

-MARASSI R1 PROJECT - EGYPT - 800m² - Playground flooring, SAFEPOL MULTICOLOR system

-DUBAI ENGLISH SPEAKING COLLEGE - DUBAI, UAE - 783m² - Acrylic flooring, SPORTFLOOR-EX

-SINGAPORE AIRLINES - SINGAPORE - 735m² - PU indoor sports flooring

-HAYATABAD PESHAWAR - INDIA - 750m² - Polyurethane sports flooring, POLYFLEX PU-IN

-AL DAJAN COMPANY - GASIM, KSA - 722m² - Polyurethane sports flooring/Tennis court

-SELECTIVE GOVERNMENT HIGH SCHOOL - EGYPT - 720m², Outdoor sports flooring

-INDIAN AIR FORCE - AHMEDABAD, INDIA - 720m²- Acrylic sports courts

-FITNESS TIME - FAYSALIA, DAMMAM, KSA - 700 m²-PU indoor multipurpose sports flooring/running track

-FITNESS TIME YASMEEN - RIYADH, KSA - 700 m² - PU indoor multipurpose sports flooring/running track

-FERRARI WORLD - ABU DHABI, UAE - 700m² - Playground flooring

-KOHAT SPORTS COMPLEX - PAKISTAN - 700m² - PU flooring, POLYFLEX PU-IN

-FITNESS TIME JUNIOR - RIYADH, KSA - 700 m² - PU indoor multipurpose sports flooring/running track

-FITNESS TIME - OLAYA RIYADH, KSA - 700 m² - PU indoor multipurpose sports flooring/ running track

-FITNESS TIME WAHA - RIYADH, KSA - 700 m² - PU indoor multipurpose sports flooring/running track

-FITNESS TIME, NOOR BRANCH - DAMMAM, KSA -700 m² - PU indoor sports flooring and running track

-FITNESS TIME, ALAMEEN BRANCH - DAMMAM, KSA - 700 m² - PU indoor sports flooring and running track

-FITNESS TIME, PLUS RIYADH - RIYADH, KSA - 700 m² - PU indoor sports flooring and running track

-FITNESS TIME, SALAMA BRANCH BRO & FITNESS - JEDDAH, KSA - 700 m² - PU indoor sports flooring

-FITNESS TIME, 40th BRANCH - JEDDAH, KSA - 700 m² - PU indoor sports flooring and running track

-NASR CLUB- EGYPT - 700m², Multipurpose court, POLYFLEX WET-POUR system

-HUREL DOUBLE 3 - RAS AL KHAIMH, KSA - 700 m² - Shockpad plus acrylic coatings

-THE SUSTAINABLE CITY - DUBAI, U.A.E - 700 m² - Acrylic flooring

-PROJECT IN MALTA - 700 m² - Acrylic flooring, SPORTFLOOR-EX system

-EMAAR - EMIRATES HILLS 2 - DUBAI, U.A.E - 700m² - Basketball court, Acrylic flooring

-AIRFORCE SURBOTO PARK - NEW DELHI, INDIA - 680 m² - Polyurethane outdoor sports flooring

-INDIAN ARMY - DHRANGDHARA, INDIA - 670m²- Acrylic sports courts

-MT.SAINT PATRICK ACADEMY - INDIA - 665m²- Acrylic sports courts

-RAJIV GANDHI THERMAL POWER PLANT - HISAR, INDIA - 650m² - Acrylic sports courts, FLEXFLOOR-EX system

-JAWAHARLAL NEHRU TECHNOLOGICAL UNIVERSITY ANANTAPURAMU - ANANTAPUR, INDIA - 650m² - Acrylic sports courts, FLEXFLOOR-EX system

-REGIONAL HQ AT BURAIMI - OMAN - 650 m² - Colorflex, PU sport flooring

-PLAYGROUND FLOORING PROJECT IN LARNAKA, CYPRUS - 650 m² - SAFEPOL MULTICOLOR system

-ROYAL OMAN POLICE TASK FORCE RUSTAQ - OMAN - 650 m² - Colorflex, PU sport flooring

-ROYAL OMAN POLICE TASK FORCE LIWA - OMAN - 650 m² - Colorflex, PU sport flooring

-ROYAL OMAN POLICE TASK FORCE AL SALIL - OMAN - 650 m² - Colorflex, PU sport flooring

-OUTDOOR TENNIS COURTS - KOSOVO - 650m² - Acrylic sports courts, SPORTFLOOR-EX

-ROYAL OMAN POLICE TASK FORCE IBRI - OMAN - 650m² - Colorflex, PU sport flooring

-ROYAL OMAN POLICE TASK FORCE IBRA - OMAN - 650m² - Colorflex, PU sport flooring
-ROYAL OMAN POLICE TASK FORCE AL SUR - OMAN - 650m² - Colorflex, PU sport flooring
-ROYAL OMAN POLICE TASK FORCE AL DUKUM - OMAN - 650m² - Colorflex, PU sport flooring
-ROYAL OMAN POLICE TASK FORCE AL BURAIMI - OMAN - 650m² - Colorflex, PU sport flooring
-ROYAL OMAN POLICE TASK FORCE AL NIZWA - OMAN - 650m² - Colorflex, PU sport flooring
-ROYAL OMAN POLICE TASK FORCE AL SUWAIQ - OMAN - 650m² - Colorflex, PU sport flooring
-ABU DHABI MUNICIPALITY - ABU DHABI , UAE - 650m² - Acrylic flooring
-ROYAL OMAN POLICE TASK FORCE AL SALALAH - OMAN - 650m² - Colorflex, PU sport flooring
-ROYAL OMAN POLICE TASK FORCE AL BARKHA - OMAN - 650m² - Colorflex, PU sport flooring
-ROYAL OMAN POLICE TASK FORCE KHOUDH - OMAN - 650m² - Colorflex, PU sport flooring
-MULTIPURPOSE COURTS - TIRANA, ALBANIA - 650m² - Acrylic sports flooring, FLEXFLOOR system
-PLAYGROUND FLOORING IN KHARKIV-3 - UKRAINE - 650m² - SAFEPOL MULTICOLOR system -
-MOHAMMED JASSIM M AL THANI SCHOOL - UMSALALALI, QATAR - 620m² - PU outdoor sport flooring
-QATAR GEMS SCHOOL - DOHA, QATAR - 615m² - Polyurethane sports flooring
-VELOOR THRISSUR DISTRICT - KERALA, INDIA - 610m² - Acrylic sports courts, FLEXFLOOR-EX system
-VAISHNO DEVI - DELHI, INDIA - 608m² - Polyurethane outdoor sports flooring
-EQUINE FLOORING - BAHRAIN - 600m², POLTRACK EQUESTRIAN SYSTEM
-THAILAND - 600m²- Acrylic sports courts
-PLAYGROUND FLOORING IN KHARKIV - UKRAINE - 600m² - SAFEPOL MULTICOLOR system
-INDIAN ARMY - AGRA, INDIA - 600m²- Acrylic sports courts
-THE INTERNATIONAL SCHOOL - AGRA, INDIA - 600m²- Acrylic sports courts
-INDIAN ARMY - JHANSI, INDIA - 600m²- Acrylic sports courts
-THE SUSTAINABLE CITY - DUBAI, U.A.E - 600m² - Safepol system
-AMITY SCHOOL, JUMEIRAH ISLAND - DUBAI, UAE - 600m² - Safepol system
-OUR OWN ENGLISH HIGH SCHOOL - SHARJAH, U.A.E - 600m² - Flexfloor system
-OUR OWN ENGLISH HIGH SCHOOL - SHARJAH, U.A.E - 600m² - Polyflex Ael-EX system
-ST. FRANCIS INTER COLLEGE - HATHRAS, INDIA - 600m²- Acrylic sports courts, FLEXFLOOR-EX system
-ST. ANTHONY'S SENIOR SECONDARY SCHOOL - FARRUKHABAD, INDIA - 600m²- Acrylic sports courts, FLEXFLOOR-EX system
-SKATING FOR KIDS - GUJARAT, INDIA - 600m² - Sportfloor system
-IMS COLLEGE - GHAZIABAD, INDIA - 600m²- Acrylic sports courts, FLEXFLOOR-EX system
-GALGOTIAS COLLEGE OF ENGINEERING - GR. NOIDA, INDIA - 600m²- Acrylic sports courts, FLEXFLOOR-EX system
-HOTEL COMPLEX IN DHERMI, ALBANIA - 600m²- Acrylic sports courts, SPORTFLOOR-EX system
-DANIEL BECCERA OCAMPO EDUCATIONAL INSTITUTION-MONQUEGUA,PERU - 580m²POLYFLEX PU-EX
-TATLAY AALI SPORTS COMPLEX - PAKISTAN - 500m²- PU flooring,POLYFLEX PU-IN
-NEW DUBAI BRADENTON SCHOOL- DUBAI, UAE - 570m² - Acrylic sports courts
-DUBAI SILICON OSIS-CENTRAL PARK, DSO - DUBAI, UAE - 560 m² - Jogging track
-MPS WORLD SCHOOL - AGRA, INDIA - 560m²- Acrylic sports courts
-LEADERS INTERNATIONAL SCHOOLS - EGYPT - 560m²- PU sports courts
-HARTLAND INTERNATIONAL SCHOOL - U.A.E - 550m²- SAFEPOL MULTICOLOR system
-PLAYGROUND FLOORING PROJECT IN SINGAPORE - 550m²- SAFEPOL MULTICOLOR system
-ARMY LAW COLLEGE PUNE- PUNE, INDIA - 550m²- Acrylic sports courts, FLEXFLOOR-EX system
-AL WUKAIR GIRLS SCHOOL - AL WAKRAH, QATAR - 550m² - Polyurethane, outdoor sport flooring

-AL BUROUJ PROJECT, SPORTS CLUB - EGYPT - 550m² - Running track, POLTRACK SPRAYCOAT

-BBPS - DELHI, INDIA - 512m² - Polyurethane outdoor sports flooring

-IVY STATE - PUNE, INDIA - 511m²- Acrylic sports courts

-KUNAL ICONIA - INDIA - 510m²- Acrylic sports courts

-AGRICULTURE UNIVERSITY PESHAWAR - INDIA - 500m² - Polyurethane sports flooring, POLYFLEX PU-IN

-LJUBUSKY PROJECT - BOSNIA & HERZEGOVINA - 500m² - Acrylic sports flooring FLEXFLOOR-EX

-MURIDKE SPORTS COMPLEX-SHEIKHUPURA, PUNJAB, PAKISTAN - 500m² -PU flooring,POLYFLEX PU-IN

-AMERICAN SCHOOL OF DUBAI - DUBAI, UAE - Acrylic sports courts

-ETIHAD MUSEUM - JUMEIRAH, DUBAI, UAE - Rubber flooring

-SHENZHEN CITY VALLEY - CHINA - Acrylic sports flooring

-CARPARKING - ABU DHABI, UAE - Acrylic flooring

-DUBAI MILLENIUM SCHOOL - QUSAIS, UAE - Acrylic sports courts

-AMERICAN UNIVERSITY - DUBAI, UAE – Acrylic outdoor sports flooring

-RAK ACADEMY - RAK, UAE - Acrylic flooring

-ISCS - SHARJA, UAE - Acrylic flooring

-THE INTERNATIONAL SCHOOL OF CHOUEIFAT - AJMAN, U.A.E - Sportground-Ex system

-THE KINDER GARDEN STARTERS - DUBAI, U.A.E - Safepol system

-AL ZAHIA PROJECT - SHARJA, UAE - Safepol system

-WADY DEGLA SHERATON CLUB - CAIRO, EGYPT - Acrylic sports flooring

-GEMS WELLINGTON SCHOOL - DUBAI, U.A.E - Safepol system

-JUMEIRAH RETAIL DEVELOPMENT - JUMEIRAH, DUBAI, UAE - Safety rubber flooring

-MR.ABDULRHMIN - JUBAIL, KSA - Rubber playground

-GEMS WESTMINISTER SCHOOL - DUBAI, U.A.E - Safepol system

-POLYURETHANE INDOOR SPORTS COURT - TIRANA, ALBANIA - Polyflex PU-In system

-MULTIPURPOSE COURTS - ODESSA, UKRAINE - Rubber flooring

-MULTIPURPOSE COURTS - ZHOVKVA, UKRAINE - Rubber flooring

-MUNICIPAL TENNIS CLUB - PATRA, GREECE - Flexfloor-EX system, Acrylic sports courts

-INDIAN AIR FORCE - GORAKHPUR, INDIA - Acrylic sports courts

-INDIAN AIR FORCE - BAREILLY, INDIA - Acrylic sports courts

-INDIAN ARMY - BABINA, INDIA - Acrylic sports courts

-ADAM AIRBASE PACKAGE 8, OMAN - Colorflex, PU sport flooring

-GOLD GYM - KOLKATTA, INDIA - Polyurethane indoor sports flooring

-MINISTRY OF FOREIGN AFFAIRS - ABU DHABI, UAE - Polyurethane flooring

-SHRJAH SPORTS CLUB - SHARJAH, UAE - Polyurethane flooring

-GEMS WINCHESTER SCHOOL - AL BARSHA SOUTH, UAE - Acrylic sports system

-HOTEL DOUBLE 3 - RAS AL KHAIMAH, UAE - Prefabricated shock-pad 4mm plus acrylic coatings

-ALNABBAGH STABLE - AL AIN, U.A.E - Polyurethane flooring, POLTRACK EQUESTRIAN FLOORING

-AL WAHDA CLUB - ABU DHABI, UAE - Rubber flooring

-ADJD MAIN BUILDING LANDSCAPE PROJECT - ABU DHABI, UAE - Rubber flooring

-KADEEJ AL KURBA SCHOOL - ABU DHABI, UAE - Rubber flooring

-INTERNATIONAL SCHOOL OF CREATIVE SCIENCE-SHARJA, U.A.E-Flexfloor system/Outdoor Multipurpose court

-ENVIRO, VATIKA HOTELS PVT.LTD - GURGAON, INDIA - Acrylic sports flooring

-ASHIANA - BHUBANESHWAR, INDIA - Acrylic sports flooring

-TCS, ADIBATLA - HYDERABAD, INDIA - Acrylic sports flooring

-IPS, ERODE - CHENNAI, INDIA - Acrylic sports flooring
-LIONS GATE - MUMBAI, INDIA - Acrylic sports flooring
-MORNING GLORY INFRA LIMITED - KANPUR, INDIA - Acrylic sports flooring
-SPORTS HALL ZVORNIK - BOSNIA & HERZEGOVINA - PU flooring POLYFLEX PU-IN
-NAMBIAR - BANGALORE, INDIA - Acrylic sports flooring
-PATHWAYS - GURGAON, INDIA - Acrylic sports flooring
-WELHAMS GIRLS SCHOOL - DEHRADUN, INDIA - Acrylic sports flooring
-WOODDUCK COMMERCIAL CENTER- IRAN - Industrial flooring
-ARABIAN RANCHES by EMAR - DUBAI, U.A.E - Playground flooring
-OUR OWN ENGLISH HIGH SCHOOL - SHARJAH, U.A.E - Playground flooring
-POLO CLUB GHANTOOT - ABU DHABI, U.A.E - Polyurethane flooring, POLTRACK EQUESTRIAN FLOORING
-RAK MODERN SCHOOL - RAS AL KHAIMAH, U.A.E - Playground flooring
-GIIS/GLOBAL INDIAN INTERNATIONAL SCHOOL - RAS AL KHAIMAH, U.A.E - Playground flooring
-MINISTRY OF EDUCATION, NAD AL HAMAR BOYS SCHOOL - DUBAI, U.A.E - Playground flooring
-K.G. KIDS SCHOOL - AALI, BAHRAIN - Playground flooring
-SABIC BEACH CAMPS PROJECT - JUBAIL, K.S.A - Outdoor sports flooring, artificial grass.
-MINISTRY OF EDUCATION, MIZHER GIRLS SCHOOL - DUBAI, U.A.E - Playground flooring
-WARSAN STABLE - Polyurethane flooring, POLTRACK EQUESTRIAN FLOORING
-AL SHIMAL PARK - DOHA, QATAR - Playground flooring
-UM SELAL PARK - DOHA, QATAR - Playground flooring
-AL KABAN PARK - DOHA, QATAR - Playground flooring
-GEMS METROPOLE SCHOOL - DUBAI, U.A.E - Hard court system/Outdoor Multipurpose court
-ARABIAN RANCHES by EMAR - DUBAI, U.A.E - Acrylic Outdoor Tennis and Basketball courts
-RAK MODERN SCHOOL - RAS AL KHAIMAH, U.A.E - Flexfloor system
-GIIS/GLOBAL INDIAN INTERNATIONAL SCHOOL - RAS AL KHAIMAH, U.A.E - Acrylic system
-AVALON HEIGHTS - AJMAN, U.A.E - Acrylic floorings
-DELHI PRIVATE SCHOOL - DUBAI, U.A.E - Acrylic flooring
-ROYAL COMMISSION SCHOOL - JUBALI, KSA - Acrylic sports flooring
-FITNESS TIME PRO - AL AHSA BRANCH - KSA - Flexfloor, Basketball court
-FITNESS TIME PRO - MAKKAH SHARAIE - KSA - Flexfloor, Basketball court
-BIN HAM - AL AIN, UAE - Polyurethane flooring
-SHAMMA BINT MOHAMMED SHOOL - AL AIN, UAE - Polyurethane flooring
-ABDULLAH BIN OTAIBA - ABU DHABI, UAE - Polyurethane flooring
-LIWA INTERNATIONAL SCHOOL - AL AIN, U.A.E - Colorflex outdoor sport system.
-ZOHOUR KG - MANAMA, BAHRAIN - Polyurethane sports flooring
-RAWDA RASHED - QATAR- Polyurethane, outdoor sport flooring
-SAAD BIN ABI WAQAS SCHOOL - AL RAYYAN, QATAR - Polyurethane, outdoor sport flooring
-FITNESS TIME PRO - MADINS RING ROAD BRANCH - KSA - Flexfloor, Basketball court
-AGRA CHAIN - AGRA, INDIA - Acrylic sports flooring
-SUNWORLD - NOIDA, INDIA - Acrylic sports flooring
-SSN INVESTMENTS PRIVATE LIMITED, FRIENDS COLONY - DELHI, INDIA - Acrylic sports flooring
-AJNARA - NOIDA, INDIA - Acrylic sports flooring-BRIGHT RIDERS SCHOOL - ABU DHABI, UAE - Running track, Acrylic sports court
-OUR OWN ENGLISH HIGH SCHOOL - SHARJAH, U.A.E - Poltrack Spaycoat system

-NCC - JAIS, INDIA - Acrylic sports flooring
-ALPHA FOUNDATION FOR EDUCATION & RESEARCH - TRICHIRAPALLI, INDIA - Acrylic sports flooring
-PUSHPANJALI FARMS - NEW DELHI, INDIA - Acrylic sports flooring
-M3M - MERLIN GURGAON, INDIA - Acrylic sports flooring
-NORTH LONDON COLLEGIATE SCHOOL - DUBAI, U.A.E - Playground flooring
-FOOT COURT - EGYPT - Running track, POLTRACK SPRAYCOAT system
-FITNESS TIME ANDALUS BRANCH - JEDDAH, K.S.A - Acrylic sports flooring, FLEXFLOOR SYSTEM
-ST.JOSEPHS WOMENS COLLEGE - ALLEPPEY, KERALA, INDIA - Polyurethane outdoor sports flooring
-RAILWAY SPORTS GROUND - GUNTAKAL, ANDRA PRADESH, INDIA - Acrylic sports flooring
-TERVEL PROJECT - TERVEL, BULGARIA - Playground flooring, SAFEPOL system
-INDOOR COURT - UKRAINE - Polyflex PU-In system
-PRIVATE JOB - HYDERABAD, SOUTH INDIA - Acrylic outdoor sports flooring
-RAILWAY SPORTS GROUND -GUNTAKAL, ANDRA PRADESH, INDIA-Acrylic outdoor sports flooring, 5 layers
-MINISTRY OF EDUCATION U.A.E - Playground flooring
-PLAYGROUND FLOORING - VARNA, BULGARIA - SAFEPOL System
-INDIAN ARMY - SHAHJAHANPUR, INDIA - Acrylic sports courts, FLEXFLOOR-EX system
-AIR FORCE SCHOOL - BENGALURU, INDIA - Acrylic sports courts, FLEXFLOOR-EX system
-ARMY PUBLIC SCHOOL - UDHAMPUR, INDIA - Acrylic sports courts, FLEXFLOOR-EX system
-BAHRAIN ROYAL EQUESTRIAN AND ENDURANCE FEDERATION - BAHRAIN - PU Equestrian system
-PLAYGROUND PROJECT - HONG KONG - SAFEPOL MULTICOLOR system
-PLAYGROUND PROJECT - KOSOVO - SAFEPOL MULTICOLOR system
-KIND SAUDI UNIVERSITY - RIYADAH, K.S.A - Running track, POLTRAC SPRAYCOAT ASYSTEM
-TENNIS COURT IN MYKONOS, GREECE - Acrylic sports courts, POLYFLEX AEL-EX system
-TENNIS COURT PROJECT - PAKISTAN - Acrylic sports courts, SPORTFLOOR-EX-R system
-SHENZHEN CITY VALLEY - CHINA - Acrylic sports courts
-QAYYUM STADIUM PESHAWAR - INDIA - Polyurethane flooring POLYFLEX PU-IN
-PLAYGROUND FLOORING IN CYPRUS - SAFEPOL MULTICOLOR system

PHOTOGRAPHS OF PROJECTS



CERTIFICATES

WORLD ATHLETICS (former I.A.A.F)



WORLD
ATHLETICS.

PRODUCT CERTIFICATE

World Athletics is pleased to certify that the following product meets all the technical requirements of the World Athletics Rules for the relevant competitions.

Product's Trade Name:

Synthetic surface, Poltrack Full PU

Description, Colour/Absolute Thickness:

Full PUR, 15.0mm

Company Name, Country:

Kataskeves Dapedon Ltd. (KDF), GRE

Catalogue Number:

-

Certification Number:

S-20-0297

Test Report by and on:

**No. 300620, Trackmaster (Thailand) Co. Ltd.(THA)
30 June 2020**

Note:

-

Date of Issue:

1 September 2020

Date of Expiry:

September 2024

Issued in accordance with the terms and conditions of the World Athletics Certification System

Jon Ridgeon
World Athletics CEO



PAH TEST REPORT EPDM GRANULES



Intertek Consumer Goods GmbH · Würzburger Straße 152 · 90766 Fürth · Germany

KATASKEVES DAPEDON LTD - KDF
MRS. Maria Nikolaidoy
Mitropoleos 19
54024 Thessaloniki
GREECE

Fürth, May 12/2020

TEST REPORT No. FUTYP2020-01959-C

Date sample received: March 06/2020
Period of testing: March 19/2020 – April 29/2020
Technical Director: Kerstin Scharrer

Sample description: EPDM Granulates E1, E2, E7, E8, E11, E12, E13, E15, E16, E17, E18, E19, E20



For the test results please refer to next pages

Intertek Consumer Goods GmbH
Würzburger Straße 152
90766 Fürth, Germany

Tel.: +49 911 74075 0
Fax: +49 911 74075 30
cg.germany@intertek.com

Sitz Fürth
Amtsgericht Fürth, HRB 5756
USt-IdNr. DE169317871

Geschäftsführer
Reinhold Gehling



Test order

Test of products for polycyclic aromatic hydrocarbons

Summary	Results
Further requirements	<i>pass</i>

Sample description:

No. 1:	Granulate E1 (red rose)
No. 2:	Granulate E2 (orange)
No. 7:	Granulate E7 (brown)
No. 8:	Granulate E8 (dark brown)
No. 11:	Granulate E11 (light blue)
No. 12:	Granulate E12 (dark blue)
No. 13:	Granulate E13 (purple)
No. 15:	Granulate E15 (light grey)
No. 16:	Granulate E16 (dark grey)
No. 17:	Granulate E17 (light green)
No. 18:	Granulate E18 (blue)
No. 19:	Granulate E19 (light brown)
No. 20:	Granulate E20 (EPDM red 0,5-1,5 mm)

Test results

Abbreviations:

n.d. = not determinable (< LoQ)

LoQ = limit of quantification

1. Polycyclic Aromatic Hydrocarbons according to US-EPA+ 2 EFSA PAH and according to Regulation (EC) No. 1907/2006 (REACH) Annex XVII No. 50

Test method: AfPS GS 2019:01 PAK (2019-05)

Limit of quantification: 0.1 mg/kg

Test results in mg/kg

Parameter	CAS-No.	Sample No. 1	Sample No.2	Sample No. 7	Sample No. 8
1 Naphthalene	91-20-3	0.26	0.14	0.14	0.18
2 Acenaphthylene	208-96-8	n.d.	n.d.	n.d.	n.d.
3 Acenaphthene	83-32-9	n.d.	n.d.	n.d.	n.d.
4 Fluorene	86-73-7	0.66	0.22	0.23	0.68
5 Phenanthrene	85-01-8	1.9	0.40	0.46	1.1
6 Anthracene	120-12-7	0.22	n.d.	n.d.	n.d.
7 Fluoranthene	206-44-0	0.39	0.14	0.18	n.d.
8 Pyrene	129-00-0	n.d.	n.d.	0.21	n.d.
9 Benzo(a)anthracene	56-55-3	0.23	n.d.	n.d.	n.d.



Polycyclic Aromatic Hydrocarbons - continued

Test results in mg/kg

Parameter	CAS-No.	Sample No. 1	Sample No. 2	Sample No. 7	Sample No. 8
10 Chrysene	218-01-9	0.28	n.d.	n.d.	n.d.
∑11+12 Benzo(b)fluoranthene + Benzo(j)fluoranthene	205-99-2 + 205-82-3	n.d.	n.d.	n.d.	n.d.
13 Benzo(k)fluoranthene	207-08-9	n.d.	n.d.	n.d.	n.d.
14 Benzo(e)pyrene	192-97-2	n.d.	n.d.	0.21	n.d.
15 Benzo(a)pyrene	50-32-8	n.d.	n.d.	n.d.	n.d.
16 Indeno(1,2,3-cd)pyrene	193-39-5	n.d.	n.d.	n.d.	n.d.
17 Dibenzo(a,h)anthracene	53-70-3	n.d.	n.d.	n.d.	n.d.
18 Benzo(ghi)perylene	191-24-2	n.d.	n.d.	n.d.	n.d.
Sum 15 PAH		3.3^b	0.40^b	0.88^b	1.1^b

^a For summation according to AfPS GS 2019:01 PAK the following PAH are not included: Acenaphthylene, Acenaphthene, Fluorene

^b Only contents from 0.2 mg/kg were used for summation.

Parameter	CAS-No.	Sample No. 11	Sample No. 12	Sample No. 13	Sample No. 15
1 Naphthalene	91-20-3	0.34	0.30	n.d.	n.d.
2 Acenaphthylene	208-96-8	n.d.	n.d.	n.d.	n.d.
3 Acenaphthene	83-32-9	n.d.	n.d.	n.d.	n.d.
4 Fluorene	86-73-7	0.19	n.d.	0.32	0.21
5 Phenanthrene	85-01-8	0.87	0.61	0.65	0.53
6 Anthracene	120-12-7	n.d.	n.d.	n.d.	n.d.
7 Fluoranthene	206-44-0	0.25	0.16	n.d.	0.16
8 Pyrene	129-00-0	n.d.	n.d.	n.d.	0.15
9 Benzo(a)anthracene	56-55-3	n.d.	n.d.	n.d.	n.d.
10 Chrysene	218-01-9	0.15	0.12	n.d.	n.d.
∑11+12 Benzo(b)fluoranthene + Benzo(j)fluoranthene	205-99-2 + 205-82-3	n.d.	n.d.	n.d.	n.d.
13 Benzo(k)fluoranthene	207-08-9	n.d.	n.d.	n.d.	n.d.
14 Benzo(e)pyrene	192-97-2	n.d.	n.d.	n.d.	n.d.
15 Benzo(a)pyrene	50-32-8	n.d.	n.d.	n.d.	n.d.
16 Indeno(1,2,3-cd)pyrene	193-39-5	n.d.	n.d.	n.d.	n.d.
17 Dibenzo(a,h)anthracene	53-70-3	n.d.	n.d.	n.d.	n.d.
18 Benzo(ghi)perylene	191-24-2	n.d.	n.d.	n.d.	n.d.
Sum 15 PAH		1.5^b	0.91^b	0.65^b	0.53^b

^a For summation according to AfPS GS 2019:01 PAK the following PAH are not included: Acenaphthylene, Acenaphthene, Fluorene

^b Only contents from 0.2 mg/kg were used for summation.

Polycyclic Aromatic Hydrocarbons - continued

Test results in mg/kg

Parameter	CAS-No.	Sample No. 16	Sample No. 17	Sample No. 18	Sample No. 19
1 Naphthalene	91-20-3	n.d.	n.d.	n.d.	n.d.
2 Acenaphthylene	208-96-8	n.d.	n.d.	n.d.	n.d.
3 Acenaphthene	83-32-9	n.d.	n.d.	n.d.	n.d.
4 Fluorene	86-73-7	n.d.	n.d.	0.45	n.d.
5 Phenanthrene	85-01-8	n.d.	0.12	0.81	0.12
6 Anthracene	120-12-7	n.d.	n.d.	n.d.	n.d.
7 Fluoranthene	206-44-0	n.d.	n.d.	n.d.	n.d.
8 Pyrene	129-00-0	n.d.	n.d.	n.d.	n.d.
9 Benzo(a)anthracene	56-55-3	n.d.	n.d.	n.d.	n.d.
10 Chrysene	218-01-9	n.d.	n.d.	n.d.	n.d.
Σ11+12 Benzo(b)fluoranthene + Benzo(j)fluoranthene	205-99-2 + 205-82-3	n.d.	n.d.	n.d.	n.d.
13 Benzo(k)fluoranthene	207-08-9	n.d.	n.d.	n.d.	n.d.
14 Benzo(e)pyrene	192-97-2	n.d.	n.d.	n.d.	n.d.
15 Benzo(a)pyrene	50-32-8	n.d.	n.d.	n.d.	n.d.
16 Indeno(1,2,3-cd)pyrene	193-39-5	n.d.	n.d.	n.d.	n.d.
17 Dibenzo(a,h)anthracene	53-70-3	n.d.	n.d.	n.d.	n.d.
18 Benzo(ghi)perylene	191-24-2	n.d.	n.d.	n.d.	n.d.
Sum 15 PAH		n.d.^b	n.d.^b	0.81^b	n.d.^b

^a For summation according to AfPS GS 2019:01 PAK the following PAH are not included: Acenaphthylene, Acenaphthene, Fluorene

^b Only contents from 0.2 mg/kg were used for summation.

Parameter	CAS-No.	Sample No. 20
1 Naphthalene	91-20-3	n.d.
2 Acenaphthylene	208-96-8	n.d.
3 Acenaphthene	83-32-9	n.d.
4 Fluorene	86-73-7	n.d.
5 Phenanthrene	85-01-8	n.d.
6 Anthracene	120-12-7	n.d.
7 Fluoranthene	206-44-0	n.d.
8 Pyrene	129-00-0	n.d.
9 Benzo(a)anthracene	56-55-3	n.d.
10 Chrysene	218-01-9	n.d.
Σ11+12 Benzo(b)fluoranthene + Benzo(j)fluoranthene	205-99-2 + 205-82-3	n.d.
13 Benzo(k)fluoranthene	207-08-9	n.d.
14 Benzo(e)pyrene	192-97-2	n.d.
15 Benzo(a)pyrene	50-32-8	n.d.
16 Indeno(1,2,3-cd)pyrene	193-39-5	n.d.
17 Dibenzo(a,h)anthracene	53-70-3	n.d.
18 Benzo(ghi)perylene	191-24-2	n.d.
Sum 15 PAH		n.d.^b

^a For summation according to AfPS GS 2019:01 PAK the following PAH are not included: Acenaphthylene, Acenaphthene, Fluorene

^b Only contents from 0.2 mg/kg were used for summation.



Conclusion

The tested sample of the presented products “**EPDM Granulates E1, E2, E7, E8, E11, E12, E13, E15, E16, E17, E18, E19, E20**” conform to the EC-Regulation 1907/2006, Annex XVII No. 50.



Remark

Requirements acc. to AfPS GS 2019:01 PAK (Utilization for GS-mark from July 1st, 2020) and Regulation (EC) No. 1907/2006, Annex XVII No. 50

Parameter	Category 1	Category 2		Category 3		Limit value acc. to EC regulation 1907/2006, Annex XVII No. 50	
		a. Use by children	b. other consumer products	a. Use by children	b. other consumer products	Toys, including activity toys, and childcare articles – Components rubber or plastic components that come into direct as well as prolonged or short-term repetitive contact with the human skin or the oral cavity, under normal or reasonably foreseeable conditions of use	Articles shall not be placed on the market for supply to the general public, if any of their rubber or plastic components that come into direct as well as prolonged or short-term repetitive contact with the human skin or the oral cavity, under normal or reasonably foreseeable conditions of use
Benzo[a]pyrene mg/kg	< 0.2	< 0.2	< 0.5	< 0.5	< 1		
Benzo[e]pyrene mg/kg	< 0.2	< 0.2	< 0.5	< 0.5	< 1	0.5	1
Benzo[a]anthracene mg/kg	< 0.2	< 0.2	< 0.5	< 0.5	< 1	0.5	1
Benzo[b]fluoranthene mg/kg	< 0.2	< 0.2	< 0.5	< 0.5	< 1	0.5	1
Benzo[j]fluoranthene mg/kg	< 0.2	< 0.2	< 0.5	< 0.5	< 1	0.5	1
Benzo[k]fluoranthene mg/kg	< 0.2	< 0.2	< 0.5	< 0.5	< 1	0.5	1
Chrysene mg/kg	< 0.2	< 0.2	< 0.5	< 0.5	< 1	0.5	1
Dibenzo[a,h]anthracene mg/kg	< 0.2	< 0.2	< 0.5	< 0.5	< 1	0.5	1
Benzo[ghi]perylene mg/kg	< 0.2	< 0.2	< 0.5	< 0.5	< 1	-	-
Indeno[1,2,3-cd]pyrene mg/kg	< 0.2	< 0.2	< 0.5	< 0.5	< 1	-	-
Phenanthrene, Pyrene, Anthracene, Fluoranthene, mg/kg	< 1 – Sum	< 5 – Sum	< 10 – Sum	< 20 – Sum	< 50 – Sum	-	-
Naphthalene mg/kg	< 1	< 2		< 10		-	-
Sum 15 PAH mg/kg	< 1	< 5	< 10	< 20	< 50	-	-
Evaluation	-	-	-	-	-	pass	-



General note:

This report has been prepared for the titled project or named part thereof and should not be relied upon or used for any other project without an independent check being carried out as to its suitability and prior written authority of Intertek being obtained. Intertek accepts no responsibility or liability for the consequences of this document being used for a purpose other than the purposes for which it was commissioned. Any person using or relying on the document for such other purposes agrees, and will by such use or reliance be taken to confirm his agreement to indemnify Intertek for all loss or damage resulting therefrom. Intertek accepts no responsibility or liability for this document to any party other than the person by whom it was commissioned.

We would like to point out, that Intertek can't provide legally binding assessments referring to isolated cases. The individual legal advice in Germany is reserved to the legal advisory professions and a binding interpretation is subject to the court of justice.

Copying excerpts or otherwise reproducing parts of the test report is permitted only with the consent of the laboratory accepting the order. This report pertains only to the test item(s).

All testing requests are subject to our Terms and Conditions available on www.intertek.com.

END OF REPORT



RUNNING TRACKS

POLTRACK FULL-PU

Synthetic outdoor system for running tracks in stadiums in total thickness of 15mm .

It is applied on fine asphalt or smooth, waterproof concrete, without rising humidity issues. After laying a PU primer for adhesion, follows the first layer (base layer), which consists of the FULL-PU colored polyurethane coating **POLAPLAST P28** and **RECYCLED RUBBER 858** broadcasted on top (fresh-on-fresh), a second layer comprising again the FULL-PU colored polyurethane coating **POLAPLAST P28** laid on the surface and **RECYCLED RUBBER 858** broadcasted on top (fresh-on-fresh) and the third layer (surface layer) is the full-PU colored polyurethane coating **POLAPLAST P28** laid on the surface and **EPDM** granules broadcasted on top to finish it off (fresh-on-fresh).

Certified system by WORLD ATHLETICS.

Steps:

1. POLAPLAST P10 - Polyurethane primer.

Applied by airless sprayer or brush.

2. POLAPLAST P28, specially modified, colored full-PU coating, applied by V-notch trowel.

3. RECYCLED RUBBER 858, SBR granules, broadcasted on the surface.

4. POLAPLAST P28, specially modified, colored full-PU coating, applied by V-notch trowel.

5. RECYCLED RUBBER 858, SBR granules, broadcasted on the surface.

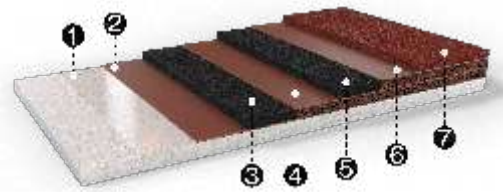

6. POLAPLAST P28, specially modified, full-PU coating, applied by V-notch trowel.

7. EPDM 856, EPDM granules, broadcasted on the surface.

Description	Consumption
POLAPLAST P10 - Polyurethane primer.	0.2kg/m ²
BASE LAYER	
POLAPLAST P28 - Specially modified, colored polyurethane full-PU coating.	3.2kg/m ²
RECYCLED RUBBER 858 in granulometry of 1-4mm.	3kg/m ²
SECOND LAYER	
POLAPLAST P28 - Specially modified, colored polyurethane full-PU coating.	3.2kg/m ²
RECYCLED RUBBER 858 in granulometry of 1-4mm.	2.6kg/m ²
SURFACE LAYER	
POLAPLAST P28 - Specially modified, colored polyurethane full-PU coating.	3.55kg/m ²
EPDM 856 in granulometry of 1-3mm.	4.2kg/m ²

POLTRACK FULL PU SYSTEM

Running track spike-proof system



Synthetic outdoor system for running tracks in stadiums in total thickness of 15mm .

It is applied on fine asphalt or smooth, waterproof concrete, without rising humidity issues. After laying a PU primer for adhesion, follows the first layer (base layer), which consists of the FULL-PU colored polyurethane coating **POLAPLAST P28** and **RECYCLED RUBBER 858** broadcasted on top (fresh-on-fresh), a second layer comprising again the FULL-PU colored polyurethane coating **POLAPLAST P28** laid on the surface and **RECYCLED RUBBER 858** broadcasted on top (fresh-on-fresh) and the third layer (surface layer) is the full-PU colored polyurethane coating **POLAPLAST P28** laid on the surface and EPDM granules broadcasted on top to finish it off (fresh-on-fresh).

Certified system by WORLD ATHLETICS.

Steps :

1. **POLAPLAST P10 - Polyurethane primer.**
3. **Application of POLAPLAST P28 FULL PU coating.**
4. **Broadcasting of RECYCLED RUBBER 858 SBR granules 1-4mm.**
5. **Application of POLAPLAST P28 FULL PU layer.**
6. **Broadcasting of RECYCLED RUBBER 858 SBR granules 1-4mm.**
7. **Application of POLAPLAST P28 FULL PU coating.**
8. **Broadcasting of EPDM granules 1-3mm.**

Preparation – Application

Applied on dry asphalt surfaces (30 days old at least) or smooth concrete surfaces (30 days at least old) without rising humidity issues and free of materials that might prevent bonding e.g. dust, loose particles etc (in case of asphalt or concrete). The success in the application depends on the right preparation of the underlay and use of the material.

- **Good, dry cleaning** of the surface from dust and residues.

- Priming of the surface with **POLAPLAST P10** applied by airless spray or brush. The subsequent base layer should be constructed while **POLAPLAST P10** is still sticky (wet on wet procedure).
- Application by notched trowel, 5.5mm, and the parallel use of a spiked roller, of one layer of the specially, modified, polyurethane self-leveling coating **POLAPLAST P28**. Consumption: 3.2kg/m².
- Broadcasting of **RECYCLED RUBBER 858** SBR granules (1-4mm granulometry) while **POLAPLAST P28** layer is still fresh. Consumption: 3kg/m².
- Next day (or between 12-48 hours, depending on temperature and humidity conditions), removal of the unstuck SBR rubber granules and application by notched trowel, 5.5mm, and the parallel use of a spiked roller, one layer of the specially, modified polyurethane self-leveling material **POLAPLAST P28**. Consumption: 3.2kg/m².
- Broadcasting of SBR recycled rubber granules (1-4mm granulometry) while **POLAPLAST P28** is still fresh. Consumption: 2.60kg/m².
- Next day (or between 12-48 hours, depending on temperature and humidity conditions), removal of the unstuck SBR rubber granules and application by notched trowel, 5.5mm, and the parallel use of a spiked roller, one layer of the specially, modified polyurethane self-leveling material **POLAPLAST P28**. Consumption: 3.55kg/m².
- Broadcasting of EPDM granules (1-3mm granulometry) while **POLAPLAST P28** is still fresh. Consumption: 4.2kg/m²
- After the top layer has cured (depending on conditions, this will usually take 9-12 hours at 20°C), it can be walked on. After 2 days, the top coating of **POLTRACK FULL PU SYSTEM** is fully cured and can be put into service, after proper line marking is performed with the use of special two component polyurethane paint.

Important Remarks

- During temperatures over 40 degrees, ideal time for the application of **POLTRACK FULL PU SYSTEM** is between 22:00 and 09:00 and the minimum bearing temperature during application and drying should be over 10°C.
- The freshly coated surface should be protected from high temperatures, wind, rain and frost for at least the first 24 hours.

Substrate

Asphalt is the safer subfloor for sport floorings for sure and must be always preferred than concrete surfaces.

A. Asphalt Substrate

The asphalt must have a slope of 0.7-1% and must dry for at least 30 days so that all solvents from the asphalt can evaporate.

The asphalt sub-floor should be applied on well compacted 150mm road base sub-floor and asphalt should be laid in one layer (and not 2) in 6 to 8cm with fine and coarse aggregates (up to 15mm granulometry) like the kind of asphalt used in road construction.

So, new road-grade asphalt will have to be laid (minimum 60mm) in one layer containing coarse aggregates and then mature for 30 days at least, before any application takes place on top of the asphalt to avoid bubbles on the final layer of the sport or rubber floorings.

Asphalt Infrastructure

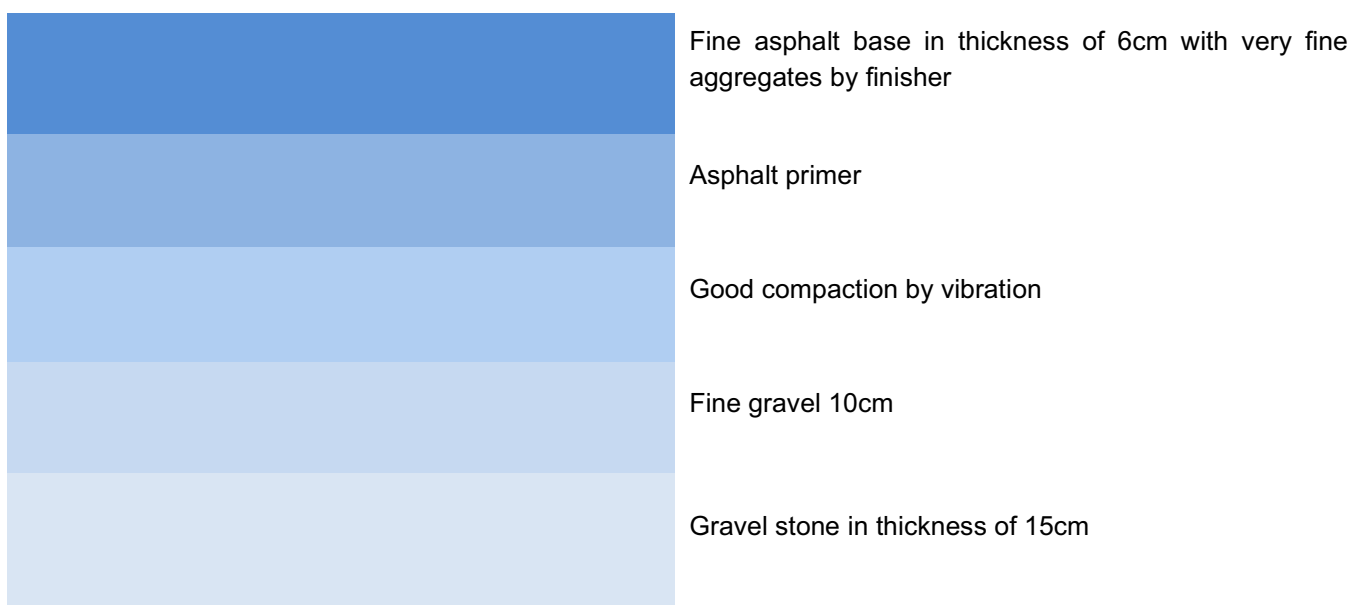

B. Concrete Surface

Concrete surface must be power-trowelled without cracks and must be smooth with a slope of 0.7-1% and humidity under 4% in 10cm depth of concrete.

Concrete must also be **dry at least for 40 days** and then the application takes place if there is no rising humidity for the sub-floor. Before the application takes place, there must be proper grinding of the surface by a grinding machine to open the pores accordingly and also a measurement by special instrument to measure humidity on the surface and in 10cm under the surface.

Generally concrete is a risky sub-floor and there may be problems with rising humidity, especially in areas where the sea level is really high and when the sea is close or in areas near greenery.

Always make expansion joints in large areas of concrete, in order to avoid uncontrollable cracks and failures. Joints should be every 25 square meters creating a grid of 5x5 meters or close to that

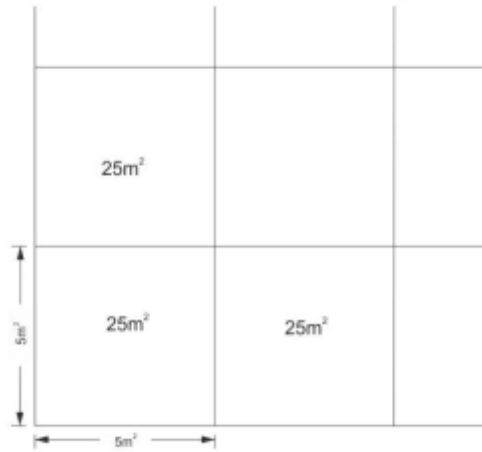

Substrate requirements

Concrete quality

at least C20/25

Age:

at least 40 days

Moisture content:

below 4%

Tools:



POLAPLAST P10

POLYURETHANE PRIMER ONE-COMPONENT

GENERAL CHARACTERISTICS

POLAPLAST P10 is a low viscosity, moisture curing, clear, polyurethane-based, one-component primer with good long term elasticity. **POLAPLAST P10** is used as an adhesive component between the sub-floor and the base layer (wet-pour mixture of SBR and **POLAPLAST P13**) of KDF running track systems.

- Designed for improving adhesion of base layer (wet-pour mixture) of KDF running track systems on asphalt and concrete surfaces without rising humidity issues.
- Penetrates in depth.
- Ideal for old and new surfaces.

TECHNICAL DATA

Basis:	one-component polyurethane
Appearance:	liquid
Color:	transparent
Viscosity :	50 – 250 mPa s at 25°C
Density :	0.9 – 1.0 Kg/Lt at 25°C
Temperature for the application and drying of the material:	10 – 40°C

PREPARATION-APPLICATION

Applied on dry surfaces without rising humidity issues, free of materials that might prevent bonding e.g. dust, loose particles, grease etc (in case of asphalt or concrete). The success in the application depends on the right preparation of the underlay and use of the material.

- **Good, dry** cleaning of the surface from dust and residues.
- Priming of the surface with **POLAPLAST P10** applied by airless sprayer equipment or brush, roller. The base layer (wet-pour mixture of SBR and **POLAPLAST P13**) of KDF running track systems should be constructed while **POLAPLAST P10** is still a bit sticky. Curing takes place at ambient temperature by evaporation of the solvent and reaction with atmospheric moisture. High temperatures and moisture will shorten the cure time. **POLAPLAST P10** is applied in two or more layers as a thin film, and on the final layer, wet-pour mixture of SBR and **POLAPALST P13** can be applied on wet surface.
- The temperature should not fall below 10° C during curing.
- Opened drums should be used up quickly.
- Depending on the temperature and humidity, 3-5 hours is the minimum waiting time.
- The base layer (wet-pour mixture of SBR and **POLAPALST P13**) of the running track systems should be constructed while the final layer of **POLAPLAST P10** is still sticky.
- **NOTE: Rain will cause the primer to lose its function! If the primer was affected by rain, the base layer should not be constructed! Instead, the sub floor has to dry and the primer application has to be repeated.**

CONSUMPTION

150-250 gr/m² depending on the type and the absorbency of the underlay.

APPLICATION
TOOLS

Airless sprayer or brush or roller.



PACKAGING

Supplied in drums of 200 Kg.



STORAGE

12 months in unopened containers in dry places with minimum temperature 5°C and maximum temperature 30°C (out of sunlight).

CAUTION

The application must take place in well-aired places using protective gloves. Skin or eye contact must be avoided, otherwise wash carefully with soap and water.

For more information consult the safety data sheet.

The information given here is true, represents our best knowledge and is based not only on laboratory work, but also on field experience. However, because of numerous factors affecting results we offer this information without any guarantee and no patent liability is assumed. For additional information or questions, contact the technical department of KDF LTD.

POLAPLAST P28

Specially, Modified, Two-component, Self Leveling coating for KDF Running truck Systems **POLTRACK FULL PU**

GENERAL CHARACTERISTICS

POLAPLAST P28 is a specially, modified, pigmented and solvent free, two component self leveling coating, with good elastic and tensile strength properties. Meets WORLD ATHLETICS standard, it is environment- friendly, flexible with high strength.

It's a running track material used as wear coat for sandwich running track systems providing good force reduction.

POLAPLAST P28 is easy to apply, it shows a good curing behavior even at low or high temperature.

TECHNICAL DATA

Mixing Ratio	86.96 : 13.04 (By weight)
Density of mixture (25°C)	1.40 – 1.50 Kg/Lt
Viscosity(25°C)	3500 – 8000 mPa s at 25°C
Pot-life (25°C)	20-30 min.
Application temperature	10 – 40 °C
Curing (25°C and %60 relative humidity)	After 24 hours
Color	KDF colorchart

PREPARATION-APPLICATION

Applied on dry surfaces without rising humidity issues, free of materials that might prevent bonding e.g. dust, loose particles, grease etc (in case of asphalt or concrete).

The success in the application depends on the right preparation of the underlay and use of the material.

- Good, dry cleaning of the surface from dust and residues using vacuum cleaner and squeegee.
- **POLAPLAST P28** is a high performance system constructed on a cast-in-situ cushion base layer of wet pour mixture (SBR rubber granules mixed with polyurethane binder) or prefabricated roll, which is first sealed with the sealant **POLAPLAST P22** before the application of **POLAPLAST P28**, with a final topping of colored EPDM granules broadcast onto **POLAPLAST P28**.
- Processing temperature of both components should be between 10-40°C.
- The A component should be thoroughly stirred to incorporate any slight separation, while continuing stirring the hardener (B component) should be added. Continue stirring until a homogeneous mix is obtained. The mixed material must be used within 20-30 minutes of mixing at 25°C. The well mixed material is applied with a V-notch trowel 5.5 mm and the parallel use of a spiked roller. Before the mixture cures, broadcast the EPDM granules (1mm- 3mm). After full curing, use an air blower to remove the excess of the granules.
- Material consumption lies between 9,8 – 10,1 Kg/m² for a standard FULL PU system and it depends on the temperature of substrate, ambience and material. Substrate temperatures must not exceed 50°C as this would liquefy the material.
- During the first hours after application, the coating had to be protected from direct contact with water, as this could cause foaming of the material. In case of (expected) rain, **POLAPLAST P28** should not be applied.
- NOTE: In cases re-coating is required, proceed in the first 24 hours after previous application without the use of primer if the surface is dry and clean.

CONSUMPTION

9,8 – 10,1 kg/m².

APPLICATION TOOLS

V-notch trowel, 5.5 mm & spiked roller.



PACKAGING

Supplied in barrels and drums(set).



CAUTION

The application must take place in well-aired places using protective gloves. Skin or eye contact must be avoided, otherwise wash carefully with soap and water.

For more information consult the safety data sheet.

The information given here is true, represents our best knowledge and is based not only on laboratory work, but also on field experience. However, because of numerous factors affecting results we offer this information without any guarantee and no patent liability is assumed. For additional information or questions, contact the technical department of KDF LTD.

SBR RUBBER GRANULES 858

GENERAL CHARACTERISTICS

It can be used in sports facilities as infill in synthetic grass with the parallel use of round sand and also as one of the components in case of cast applied wet-pour systems for playground floorings or as shock-pad for sport subfloors in athletic tracks and sports fields.

Rubber granule is derived from car and truck tires. During processing, the tires are mechanically granulated, removing all metal and synthetic fibers, as well as any other foreign part contained in there with specially designed sieves, so as to produce a 99.99% clear rubber with high quality.

PROPERTIES

- 100% recyclable
- Long life
- Resistance to adverse weather conditions
- High shock absorbency and vibration damping
- High abrasion resistance

PREPARATION-APPLICATION

In sports facilities and playgrounds to ensure flexibility of surface and vibration absorption.

TECHNICAL CHARACTERISTICS

Granulometry 1-3mm

DENSITY:	0.48kg/cm ³
SPECIFIC GRAVITY	1.20+/-0.05 (Water = 1.0)
HARDNESS	60
HUMIDITY(%)	<0.65
ELASTICITY	100% - No change
RESISTANCE	113N/cm - Excellent

PACKAGING

Packaging is available in big-bags -1 ton in following sizes:

Grain size	0,5-1,5 mm
Grain size	0,5-2,5 mm
Grain size	0.5-4.0 mm
Grain size	2-8 mm
Grain size	8-20 mm
Grain size	80-50 mm
Grain size	80-120 mm



The information given here is true, represents our best knowledge and is based not only on laboratory work, but also on field experience. However, because of numerous factors affecting results we offer this information without any guarantee and no patent liability is assumed. For additional information or questions, contact the technical department of KDF LTD.

EPDM 856

RUBBER GRANULES

GENERAL CHARACTERISTICS

Type of material: Rubber EPDM

Grain size: 0.8-2.5mm,1.0-3mm,1.0-4mm or others

PERFORMANCE OF SAMPLE 25%

Test item	Performance
Tensile strength (Mpa)	>4.3
Elongation at break (%)	>735
Hardness (shore A)	60-65
Specific gravity (kg/cm ³)	1.45 ± 0.05

PREPARATION-APPLICATION

EPDM 856 granules are basically used for wet pour colored playground floorings (granulometry 1-3mm), for flexible multipurpose outdoor courts in 10-20 mm, SYSTEM COLORFLEX, and in applications of running track system such as POLTRACK SANDWICH SYSTEM (granulometry 1-3mm) and POLTRACK SPRAYCOAT SYSTEM (granulometry 0.5-1.5 mm).

Can be used also as infill of artificial synthetic turf or in the production of epdm rubber tiles or even loose lay and around swimming pools as a flexible flooring.

REMARKS

- It is highly suggested (especially in hot climates like in Middle East countries) the usage of the UV-resistance top coat **POLYSPORT XP 1069**, which gives a strong UV protection and doesn't allow the change of color to occur. **POLYSPORT XP 1069** is produced in all EPDM colour range and needs to be applied with 0,4 kg/m² in two crossing layers by airless sprayer or rollers.
- In case that there is no usage of UV-resistance polyurethane aliphatic coating strong shades like blue, rose, orange, grey etc will alter.
- All technical data are correct to the best of our knowledge and are intended to help our customers.
- They do not constitute a guarantee of qualities and provide on bases for legal liability.
- We advise our customers to choose the PU-binder according to the type and color of the EPDM rubber granules.

CLEANING AND MAINTENANCE MANUAL FOR :

-OUTDOOR SPORTS FLOORING -PLAYGROUND FLOORINGS

Introduction

Outdoor sports floorings and playground surfaces are made of extremely durable polymers, designed to withstand extreme climate conditions and intense use. However for the best maintenance of the sports surface a regular check (once in 6 months) is required and the maintenance of the surface is necessary to preserve the suitability and functionality of the flooring.

The installer's guarantee will usually be conditional on the recommended maintenance requirements being carried out with due diligence.

Maintenance

Maintenance procedures are necessary to preserve the lifetime of the surface and to ensure that:

- The Surface is kept clean.
- The Surface is safe for intense and diverse use.

These objectives are achieved by :

- Sweeping/removing leaves and other debris from the surface.
- Regularly washing the surface with a soft brush to remove contaminants such as grime, grease, algae, moss, sand etc.
- Applying suitable treatments of moss-killer and/or algaecide
- Periodically removing weed growth from the perimeter kerb lines.

Maintenance Equipment

- Leaves, pine needles and other detritus should be removed from the surface immediately as rot quickly helping the growth of mold and moss.
- A mechanical leaf-sweeper or vacuum cleaner is ideal for removing vegetable matter and dirt. Restricted areas may have to be cleaned by hand.
- The maintenance equipment should be well maintained and carefully operated to avoid any physical damage to the surface.
- Pressure loads on the surface as well as friction and shearing loads have to be avoided to prevent damage to the surface.
- At least once a year it is advisable to wash the surface with **low-pressure** jetting apparatus.

- Polymeric surfaces can withstand low pressures without suffering damage.
- Note that no aggressive chemical cleaning agents (chlorine or acid-based) should be used.

Prevention of damages

To ensure the excellent condition of the surface:

- It is forbidden to drive vehicles, bicycles or motorcycles on the surface.
- Chemicals, oils, fuels or solvents on the surface are prohibited.
- Fireworks or cigarettes or unsuitable shoes on the surface are prohibited.

Damages and renovation

The lifetime of an outdoor sports/playground surface depends on its quality, usage and level of maintenance. In general a normal outdoor sports/playground surface used intensively will last 7 to 12 years (depending on the system) before renovation is required. Renovation should be carried out periodically to prevent the total damage of the surface, which would necessitate complete renewal.

Renovation must be carried out by professional and skilled contractors with thorough knowledge of this type of work.

There are different procedures for the renovation of a surface:

- Complete renewal by replacing the worn-out surface with a new sports flooring system.
- Re-topping or sealing with adequate polyurethane or acrylic materials.
- Partial re-topping in particular worn-out areas.

Information contained in this document is of general nature and is given in good faith. As the state of the surface and the use and application of the various cleaning products, is out of our control, our advice for individual cases, verbal, written or based on tests, does not exempt the applicator from the testing the suitability of the cleaning products and their applications.

The above maintenance guide refers to **the below KDF systems:**

-SYSTEM SPORTFLOOR FAST

-SYSTEM SPORTFLOOR-EX

-SYSTEM SPORTFLOOR-EX-R

-SYSTEM FLEXFLOOR-EX

-SYSTEM FLEXFLOOR-EX-R

-SYSTEM POLYFLEX AEL-EX

-SYSTEM POLYFLEX AEL-EX-R

-SYSTEM POLYFLEX WET-POUR EX

-SYSTEM POLYFLEX WET-POUR EX-R

-SYSTEM POLYFLEX PU-EX

-SYSTEM POLYFLEX WET-POUR AEL-EX

-SYSTEM POLYFLEX WET-POUR AEL-EX-R

-SYSTEM SMARTFLOOR-EX

-SYSTEM SAFEPOL MULTICOLOR

-SYSTEM SAFEPOL COLORED

-SYSTEM SAFEPOL WITH TPV GRANULES

-SYSTEM SAFEPOL SBR COLOURANT

-SYSTEM SAFEPOL SANDPROOF

-SYSTEM QUICKLAWN PLAYGROUND SAFEPOL

-SYSTEM QUICKLAWN PLAYGROUND SAFEPOLSANDPROOF

-SYSTEM COLORFLEX

-SYSTEM SPORTGROUND-EX

-SYSTEM DECOQUARTZ

-SYSTEM POLTRACK SPRAYCOAT

-SYSTEM POLTRACK SPRAYCOAT SEALED

-SYSTEM POLTRACK SANDWICH

-SYSTEM POLTRACK ROLL-SANDWICH

-SYSTEM POLTRACK FULL PU

-SYSTEM POLTRACK ACRYLIC

-SYSTEM POLTRACK JOGGING TRACK

-SYSTEM POLTRACK PU JOGGING TRACK

-SYSTEM POLTRACK JOGGING TRACK SBR

-SYSTEM POLTRACK JOGGING TRACK SHOCK-PAD - EPDM

-SYSTEM POLTRACK JOGGING TRACK SHOCK-PAD - ISOPOL

-SYSTEM POLTRACK EQUINE

CERTIFICATES OF KDF LTD



ISO QUALITY MANAGEMENT ISO ENVIROMENTAL MANAGEMENT POLTRACK SPRAYCOAT



POLTRACK SANDWICH POLTRACK ROLL-SANDWICH POLTRACK FULL-PU



POLTRACK FULL-PU POLYFLEX AEL-EX FLEXFLOOR-EX

CERTIFICATES OF KDF LTD



SPORTFLOOR-EX



SPORTFLOOR-EX FAST



SPORTGROUND-EX



POLTRACK JOGGING TRACK



POLYFLEX PU



POLYFLEX PU - FIBA



POLYFLEX PU-BADMINTON



EPDM 856



SAFEPOL

CERTIFICATES OF KDF LTD



SAFEPOL COLORED



SAFEPOL SANDPROOF



SAFEPOL SANDPROOF



PLAYPREM



POLTRACK EQUINE



**PAH FREE TEST REPORT
PU BINDER 1118**



**PAH FREE TEST REPORT
PU BINDER 1125AL**



**PAH FREE TEST REPORT
EPDM 856**



**PAH FREE TEST REPORT
PU BINDER 1118 plus EPDM 856**

CERTIFICATES OF KDF LTD



PU GRASS 149



**POLTRACK SANDWICH
EN 14877**



**POLTRACK SPRAYCOAT
EN 14877**



COLORFLEX EN 14877