

KDF

Sports Flooring Systems & Building Materials



POLTRACK SPRAYCOAT ACRYLIC RUNNING TRACK SYSTEM

www.kdf.gr

KDF LTD (www.kdf.gr) is one of the most dynamic and export-oriented Greek companies (currently activated in more than 80 countries in 4 continents), based in Greece (EU) and in U.A.E too, with production facilities and warehouses in both countries for acrylics and polyurethanes and **EPDM** granules.

We are experts in sports, industrial and decorative flooring products and systems, with huge experience in Europe with many applied projects in Spain, France, Greece as well as Malta, Romania, Bulgaria, Croatia, Serbia and Ukraine. Our presence is active in Latin America too with projects in Colombia, Peru, Chile, and Brazil, Africa, Asia, Middle East and India as well.

Our export horizon is expanding rapidly, and our goal is to stand out as a model of flexibility and competitiveness. The company, being one of the pioneer companies in the sector of sports flooring systems and building materials and giving particular attention to providing a fully upgraded range of products and services, provides certified systems according to all **EU norms and regulations** and by well-known international institutes like **WORLD ATHLETICS, I.T.F, TUV, LNE, LABOSPORT, ISASPORT, INTERTEK to name but a few.**

KDF goes far beyond trade, providing consultancy in marketing and technical support all the way, from the costing till the finalization of the project. Operating under the requirements of **ISO 9001/2015** (and many others like **ISO 14001/2015, ISO 50001/2018, ISO 27001/2013** and more) for production, trade and application, we make sure our products are first applied successfully at site by our own people before we launch them abroad.

Therefore, our systems have all stood the real-life test in different climates, from North Europe to Middle East till South America, and this is one of our main assets, enabling us to provide full and vertical technical support from specifying to final application plus supervision when required or even full application and costing.

We invite you to discover a world of sports flooring expertise and solutions.

VIEW OUR NEW SPORTS CATALOGUE



KDF - Kataskeves Dapedon LTD
e : exports@kdf.gr
w : www.kdf.gr

19th km National Road Thessaloniki-Moudania
57001, Neo Rysio, Thessaloniki, Greece
t / f : +30 2310 829598

Contents

- 3. Technical Description of the system
- 4. Methodology of the system
- 8. Photographs of Projects
- 9. Technical Data Sheet (TDS) per each material
- 20. Maintenance manual
- 23. Indicative Reference List of Projects

RUNNING TRACKS

POLTRACK SPRAYCOAT ACRYLIC

Innovative, new, synthetic outdoor economical system with a shock-pad for running tracks, in thickness of 13mm, or as outdoor system for refreshing old courts. It is applied on fine asphalt or smooth, or waterproof concrete without rising humidity issues. Consists of: a first, base layer mixture, mixed at site, of the polyurethane binder **POLAPLAST P13** and **RECYCLED RUBBER 858**, a second layer (sealing layer) the acrylic pore filler **ELASTOTURF NEUTRO** on top of the cushion mixture or even directly on old, clean acrylic surfaces. The final layer (surface layer) is the mixture of highly pigmented 100% acrylic **ELASTOTURF TRACK** with colored **EPDM** granules in fine granulometry.

It is designed for use on new asphalt or over existing colored surfaces. Ideal solution for making old track surfaces look good as new or make a new track altogether.



Steps:

1. **POLAPLAST P10 - Polyurethane primer.**
Applied by airless sprayer or brush.
2. **Mixture of POLAPLAST P13, RECYCLED RUBBER 858.**
Applied by paving machine.
3. **ELASTOTURF NEUTRO- Acrylic pore filler.**
Applied by squeegee.
4. **Mixture of ELASTOTURF TRACK and EPDM granules.**
It is applied by paving machine or squeegee in two or three layers.

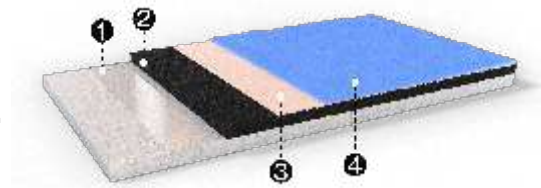

Description	Consumption
POLAPLAST P10 - Polyurethane primer.	0.2kg/m ²
BASE LAYER	
POLAPLAST P13 - One-component, polyurethane binder.	1.2kg/m ² for 10mm mixture
RECYCLED RUBBER 858 in granulometry of 1-4mm.	6kg/m ² for 10mm mixture
SEALING LAYER	
ELASTOTURF NEUTRO - Acrylic pore filler.	1.3-2.5kg/m ²
TOP LAYER	
ELASTOTURF TRACK - 100% modified acrylic.	1kg/m ² in 2 layers for 2mm 1.5kg/m ² in 3 layers for 3mm
EPDM 856 in granulometry of 0.5-1.5mm.	0.9kg/m ²

POLTRACK SPRAYCOAT ACRYLIC

Running track spray-coat system



Innovative, new, synthetic outdoor economical system with a shock-pad for running tracks, in thickness of 13mm, or as outdoor system for refreshing old courts.

It is applied on fine asphalt or smooth, or waterproof concrete without rising humidity issues. Consists of: a first, base layer mixture, mixed at site, of the polyurethane binder **POLAPLAST P13** and **RECYCLED RUBBER 858**, a second layer (sealing layer) the acrylic pore filler **ELASTOTURF NEUTRO** on top of the cushion mixture or even directly on old, clean acrylic surfaces. The final layer (surface layer) is the mixture of highly pigmented 100% acrylic **ELASTOTURF TRACK** with colored EPDM granules in fine granulometry.

It is designed for use on new asphalt or over existing-colored surfaces. Ideal solution for making old track surfaces look good as new or make a new track altogether.

Steps:

1. POLAPLAST P10 - Polyurethane primer.

Applied by airless sprayer or brush.

2. Mixture of POLAPLAST P13 and RECYCLED RUBBER 858.

Applied by paving machine.

3. ELASTOTURF NEUTRO- Acrylic pore filler.

Applied by squeegee.

4. Mixture of ELASTOTURF TRACK and EPDM granules.

It is applied by paving machine or squeegee in two or three layers.

Preparation – Application

Applied on dry asphalt surfaces (30 days old at least) or smooth concrete surfaces (30 days at least old) without arising humidity issues and free of materials that might prevent bonding e.g. dust, loose particles etc (in case of asphalt or concrete). The success in the application depends on the right preparation of the underlay and use of the material.

➤ **Good, dry cleaning** of the surface from dust and residues.

- Priming of the surface with **POLAPLAST P10** applied by airless spray or brush. The base coat of **POLTRACK SYSTEM** should be constructed while **POLAPLAST P10** is still sticky (wet on wet procedure), within 30-60 minutes of primer application.
- Good mixing of **POLAPLAST P13 with RECYCLED RUBBER 858**, SBR granules (0.5-2.5mm) to create a flexible shock-absorbent layer.
- The mixture is poured on the surface and spread using a suitable paving machine or other appropriate machine or a hand straightedge. If the application will be done with hand straightedge then small irregularities in the surface may be removed by compacting the fresh surface using a metallic cylinder.
- After the surface is fully cured (depending on the temperature and humidity, the curing of the shock-absorbent base coat of **POLTRACK SYSTEM** will take 48-72 hours), follows the application of **ELASTOTURF NEUTRO** by squeegee. Consumption: 1.3-2.5kg/m².
- After the **ELASTOTURF NEUTRO** is fully cured (12-24 hours depending on the temperature and humidity), follows the application of the top layer, the mixture of **ELASTOTURF TRACK** and **EPDM** granules.
- Good mixing of **ELASTOTURF TRACK** and **EPDM** granules in granulometry of 0.5-1.5mm in mixing ratio of 50:50 by weight.
- The mixture is poured on the surface and spread using a suitable paving machine or squeegee in two or three layers.

Important Remarks

- ✓ During temperatures over 40 degrees, ideal time for the application of **POLTRACK SPRAYCOAT ACRYLIC SYSTEM** is between 22:00 and 09:00 and the minimum bearing temperature during application and drying should be over 10°C.
- ✓ The freshly coated surface should be protected from high temperatures, wind, rain and frost for at least the first 24 hours.

Substrate

Asphalt is the safer subfloor for sport floorings for sure and must be always preferred than concrete surfaces.

A. Asphalt Substrate

The asphalt must have a slope of 0.7-1% and must dry for at least 30 days so that all solvents from the asphalt can evaporate.

The asphalt sub-floor should be applied on well compacted 150mm road base sub-floor and asphalt should be laid in one layer (and not 2) in 6 to 8cm with fine and coarse aggregates (up to 15mm granulometry) like the kind of asphalt used in road construction.

So, new road-grade asphalt will have to be laid (minimum 60mm) in one layer containing coarse aggregates and then mature for 30 days at least, before any application takes place on top of the asphalt to avoid bubbles on the final layer of the sport or rubber floorings.

Asphalt Infrastructure

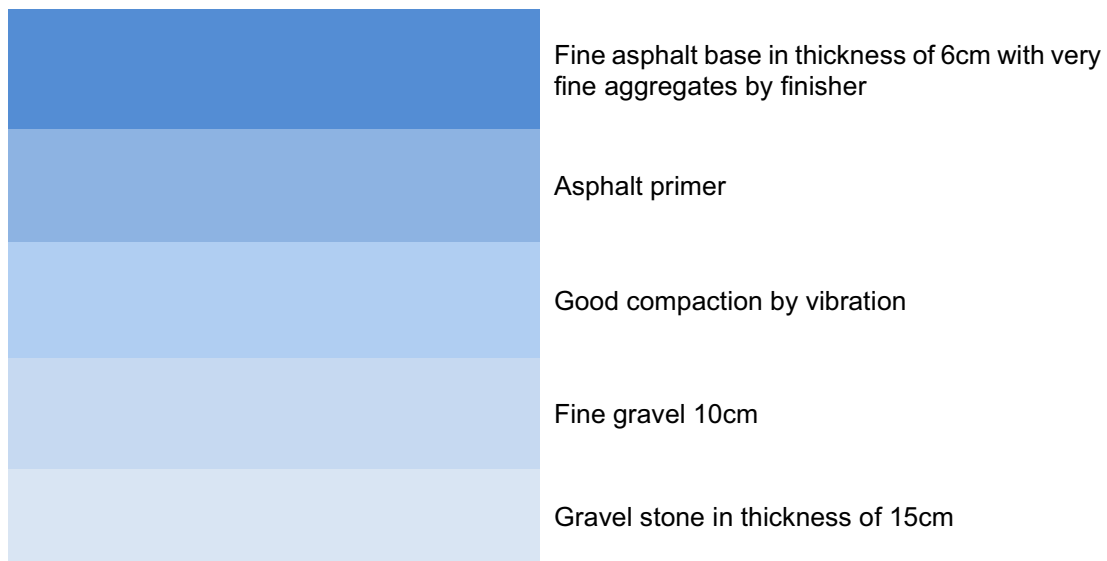

B. Concrete Surface

Concrete surface must be power-trowelled without cracks and must be smooth with a slope of 0.7-1% and humidity under 4% in 10cm depth of concrete.

Concrete must also be **dry at least for 40 days** and then the application takes place if there is no rising humidity for the sub-floor. Before the application takes place, there must be proper grinding of the surface by a grinding machine to open the pores accordingly and also a measurement by special instrument to measure humidity on the surface and in 10cm under the surface.

Generally concrete is a risky sub-floor and there may be problems with rising humidity, especially in areas where the sea level is really high and when the sea is close or in areas near greenery.

Always make expansion joints in large areas of concrete, in order to avoid uncontrollable cracks and failures. Joints should be every 25 square meters creating a grid of 5x5 meters or close to that.

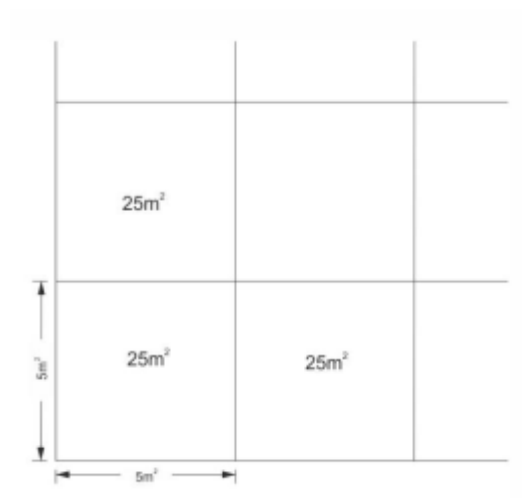

Substrate requirements

Concrete quality	at least C20/25
Age:	at least 40 days
Moisture content:	below 4%

Tools:

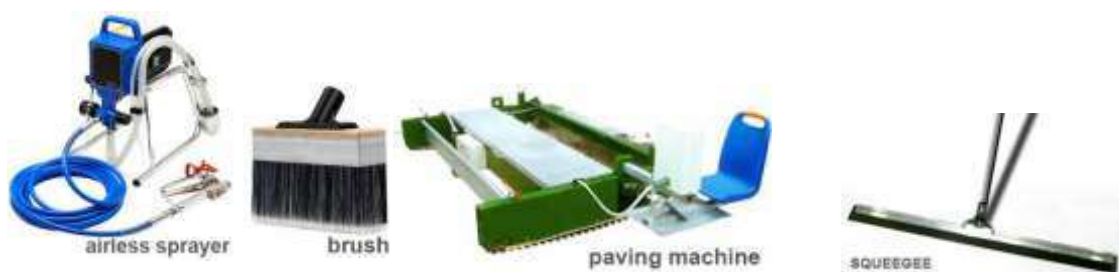

PHOTOGRAPHS OF PROJECTS



POLAPLAST P10

POLYURETHANE PRIMER ONE-COMPONENT

GENERAL CHARACTERISTICS

POLAPLAST P10 is a low viscosity, moisture curing, clear, polyurethane-based, one-component primer with good long term elasticity. **POLAPLAST P10** is used as an adhesive component between the sub-floor and the base layer (wet-pour mixture of SBR and **POLAPLAST P13**) of KDF running track systems.

- Designed for improving adhesion of base layer (wet-pour mixture) of KDF running track systems on asphalt and concrete surfaces without rising humidity issues.
- Penetrates in depth.
- Ideal for old and new surfaces.

TECHNICAL DATA

Basis:	one-component polyurethane
Appearance:	liquid
Color:	transparent
Viscosity :	50 – 250 mPa s at 25°C
Density :	0.9 – 1.0 Kg/Lt at 25°C
Temperature for the application and drying of the material:	10 – 40°C

PREPARATION-APPLICATION

Applied on dry surfaces without rising humidity issues, free of materials that might prevent bonding e.g. dust, loose particles, grease etc (in case of asphalt or concrete). The success in the application depends on the right preparation of the underlay and use of the material.

- **Good, dry** cleaning of the surface from dust and residues.
- Priming of the surface with **POLAPLAST P10** applied by airless sprayer equipment or brush, roller. The base layer (wet-pour mixture of SBR and **POLAPLAST P13**) of KDF running track systems should be constructed while **POLAPLAST P10** is still a bit sticky. Curing takes place at ambient temperature by evaporation of the solvent and reaction with atmospheric moisture. High temperatures and moisture will shorten the cure time. **POLAPLAST P10** is applied in two or more layers as a thin film, and on the final layer, wet-pour mixture of SBR and **POLAPLAST P13** can be applied on wet surface.
- The temperature should not fall below 10°C during curing.
- Opened drums should be used up quickly.
- Depending on the temperature and humidity, 3-5 hours is the minimum waiting time.
- The base layer (wet-pour mixture of SBR and **POLAPLAST P13**) of the running track systems should be constructed while the final layer of **POLAPLAST P10** is still sticky.
- **NOTE: Rain will cause the primer to lose its function! If the primer was affected by rain, the base layer should not be constructed! Instead, the sub floor has to dry and the primer application has to be repeated.**

CONSUMPTION

150-250 gr/m² depending on the type and the absorbency of the underlay.

APPLICATION
TOOLS

Airless sprayer or brush or roller.



PACKAGING

Supplied in drums of 200 Kg.



STORAGE

12 months in unopened containers in dry places with minimum temperature 5°C and maximum temperature 30°C (out of sunlight).

CAUTION

The application must take place in well-aired places using protective gloves. Skin or eye contact must be avoided, otherwise wash carefully with soap and water.

For more information consult the safety data sheet.

The information given here is true, represents our best knowledge and is based not only on laboratory work, but also on field experience. However, because of numerous factors affecting results we offer this information without any guarantee and no patent liability is assumed. For additional information or questions, contact the technical department of KDF LTD.

POLAPLAST P13

ONE-COMPONENT POLYURETHANE BINDER

GENERAL CHARACTERISTICS

POLAPLAST P13 is a solvent free, clear, moisture curing one component polyurethane binder with good long term elasticity.

POLAPLAST P13 exhibits excellent adhesion to most rubber granulates and gives a strong performance both in terms of tensile strength and durability. It is mixed with **RECYCLED RUBBER 858** for the creation of the base layer of KDF's running track systems as well as for the base coat of playgrounds, tennis courts etc.

TECHNICAL DATA

Basis:	one-component polyurethane
Appearance:	liquid
Color:	transparent
Viscosity :	4.000 – 8.000 mPa s at 25°C
Density :	1.08 – 1.18 Kg / Lt at 25°C
Temperature for the application and drying of the material:	10 – 40 °C

PREPARATION-APPLICATION

Applied on dry surfaces, free of materials that might prevent bonding e.g. dust, loose particles etc (in case of asphalt or concrete). The success in the application depends on the right preparation of the underlay and use of the material.

- **Good, dry** cleaning of the surface from dust and residues.
- Priming of the surface with **POLAPLAST P10** applied by airless sprayer and brush. The the base layer of KDF's running track systems, wet-pour shock-absorbent mixture, should be constructed while **POLAPLAST P10 is still sticky (wet in wet procedure)**. Curing takes place at ambient temperature by evaporation of the solvent and reaction with atmospheric moisture. High temperatures and moisture will shorten the cure time. Opened drums should be used up quickly.
- Good mixing of **POLAPLAST P13** and **RECYCLED RUBBER 858 (see mixing ratio below)**. Mixing should be performed using a low revolution mixer (300-600 rpm) for 1-2 min. Stirring of the mixture should be performed thoroughly near the sides and bottom of the container in order to achieve homogeneity.
- Following, the mixture is poured on the surface and spread on in thickness from 11 to 12mm using a suitable paving machine or a hand straightedge and a flat trowel. Any small irregularities in the surface may be removed by rolling the surface using a metallic cylinder.
- The temperature should not fall below 10°C during curing of **POLAPLAST P13**.
- Curing of **POLAPLAST P13** takes place at ambient temperature by reaction with atmospheric moisture. High temperatures and moisture will shorten the cure time of the **POLAPLAST P13**.
- After the surface is fully cured (depending on the temperature and humidity, the curing of the base layer mixture will take 48-72 hours), follows the application of the final layers of the running track systems.

CONSUMPTION

1.32kg **POLAPLAST P13** mixed with 6kg **RECYCLED RUBBER 858** in granulometry of 0.5-2.5mm.

RATIO

18.3 % **POLAPLAST P13** to 81.7% **RECYCLED RUBBER 858** in granulometry of 0.5-2.5mm.

APPLICATION TOOLS

A suitable paving machine or a hand straightedge, a flat trowel and a cylinder for compacting.



PACKAGING

Supplied in barrels of 220 Kg.



STORAGE

12 months in unopened containers in dry places, out of sunlight, with minimum temperature 5°C and maximum temperature 30°C.

CAUTION

The application must take place in well-aired places using protective gloves. Skin or eye contact must be avoided, otherwise wash carefully with soap and water.

For more information consult the material safety data sheet.

The information given here is true, represents our best knowledge and is based not only on laboratory work, but also on field experience. However, because of numerous factors affecting results we offer this information without any guarantee and no patent liability is assumed. For additional information or questions, contact the technical department of KDF LTD.

SBR RUBBER GRANULES 858

GENERAL CHARACTERISTICS

It can be used in sports facilities as infill in synthetic grass with the parallel use of round sand and also as one of the components in case of cast applied wet-pour systems for playground floorings or as shock-pad for sport subfloors in athletic tracks and sports fields.

Rubber granule is derived from car and truck tires. During processing, the tires are mechanically granulated, removing all metal and synthetic fibers, as well as any other foreign part contained in there with specially designed sieves, so as to produce a 99.99% clear rubber with high quality.

PROPERTIES

- 100% recyclable
- Long life
- Resistance to adverse weather conditions
- High shock absorbency and vibration damping
- High abrasion resistance

PREPARATION- APPLICATION

In sports facilities and playgrounds to ensure flexibility of surface and vibration absorption.

TECHNICAL CHARACTERISTICS

Granulometry 1-3mm

DENSITY:	0.48kg/cm ³
SPECIFIC GRAVITY	1.20+/-0.05 (Water = 1.0)
HARDNESS	60
HUMIDITY(%)	<0.65
ELASTICITY	100% - No change
RESISTANCE	113N/cm - Excellent

PACKAGING

Packaging is available in big-bags -1 ton in following sizes:

Grain size	0,5-1,5 mm
Grain size	0,5-2,5 mm
Grain size	0.5-4.0 mm
Grain size	2-8 mm
Grain size	8-20 mm
Grain size	80-50 mm
Grain size	80-120 mm



The information given here is true, represents our best knowledge and is based not only on laboratory work, but also on field experience. However, because of numerous factors affecting results we offer this information without any guarantee and no patent liability is assumed. For additional information or questions, contact the technical department of KDF LTD.

ELASTOTURF NEUTRO

SPECIAL, ELASTIC, COATING FOR INTERNAL AND EXTERNAL SPORT FIELDS

GENERAL CHARACTERISTICS

ELASTOTURF NEUTRO is acrylic-based, elastic, colored, non-slip coating for external and internal sport fields.

- It can be combined with prefabricated shock-absorbent rolls in thickness 4-14mm or wet-pour mixtures.
- Ideal for basketball, volleyball, handball, football and tennis external courts. Suitable for sports centers, schools, fitness centers, pavements, hallways.
- Applied easily, having low cost.
- Provides a safe, high quality game.

TECHNICAL DATA

Basis:	one-component acrylic resin
Appearance:	viscous liquid
Colors:	neutral
Viscosity:	20.000 – 30.000 mPa•s at 25°C
Density:	1.64 – 1.74 Kg/Lt
Temperature for the application and drying of the material:	10 – 40°C
Walkability:	after 24 hours

PREPARATION-APPLICATION

Applied only on dry surfaces, without rising humidity issues and free of materials that might prevent bonding e.g. dust, loose particles, grease etc. The success in the application depends on the right preparation of the underlay and use of the material.

- **Good, dry** cleaning of the surface from dust and residues with vacuum cleaner and squeegees.
- Application of the material on prefabricated shock-absorbent rolls in thickness 4-12mm or a rubber mixture of **SBR plus PU BINDER**, for sealing the pores of the underlay and plasticize the surface.
- Depending on the ambient temperature, **ELASTOTURF NEUTRO** is diluted with 5-6% up to 10% water, prior to application, in order to achieve better fluidity. The next layer follows the other after the previous dries.

CONSUMPTION

1.3 - 2.5 kg/m².

APPLICATION TOOLS

Squeegee (width 55cm). Tools should be cleaned with **WATER** immediately after use.



PACKAGING

Supplied in barrels of 200 kg.



STORAGE

12 months in unopened containers in dry places with minimum temperature 5°C and high temperature 30 °C (avoid sunlight).

REMARKS

- **ELASTOTURF NEUTRO** should be applied in layers smaller than 0.6-0.7mm in order to avoid cracks on the material, due to the rapid evaporation of water. Lining thickness more than 1mm is achieved only by repeated layers.
- During temperatures over 40 C, ideal time for the application of **ELASTOTURF NEUTRO 850** is between 22:00-9:00 a.m. and the minimum bearing temperature during application and drying should be 10 C.
- The freshly coated surface should be protected from high temperatures, wind, rain and frost for at least the first 24 hours.
- In case it gets damaged, it is simply repaired and recoated on the spot.

CAUTION

The application must take place in well-aired places using protective gloves. Skin or eye contact must be avoided, otherwise wash carefully with soap and water.

For more information consult the material safety data sheet.

The information given here is true, represents our best knowledge and is based not only on laboratory work, but also on field experience. However, because of numerous factors affecting results we offer this information without any guarantee and no patent liability is assumed. For additional information or questions, contact the technical department of KDF LTD.

ELASTOTURF TRACK

GENERAL CHARACTERISTICS

ELASTOTURF TRACK is a highly pigmented 100% acrylic polymer concentrate, filled with colored EPDM rubber in fine granulometry. It is designed for the application for **POLTRACK SPRAYCOAT ACRYLIC** System.

Ideal for making an older track look new, or to be used on new construction, **ELASTOTURF TRACK** provides a low cost solution.

TECHNICAL DATA

Basis:	one-component acrylic resin
Appearance:	viscous liquid
Colors:	neutral
Viscosity:	10.000 – 20.000 mPa•s at 25°C
Density:	1.52 – 1.62 Kg/Lt
Temperature for the application and drying of the material:	10 – 40°C after 24 hours
Walkability:	

PREPARATION-APPLICATION

- Application should be done with a spray coat machine.
- Substrate must be completely cured prior applying **ELASTOTURF TRACK**.
- After **ELASTOTURF NEUTRO** dries, follows the application of **ELASTOTURF TRACK** mixed with EPDM 0.5 -1.5 mm (mixing ratio 50:50 by weight).
- The application should take place in 2-3 layers.

CONSUMPTION

1-1.5kg/m² in two or three layers.

PACKAGING

150 Kg barrels.



CAUTION

The application must take place in well-aired places using protective gloves. Skin or eye contact must be avoided, otherwise wash carefully with soap and water.

For more information consult the material safety data sheet.

The information given here is true, represents our best knowledge and is based not only on laboratory work, but also on field experience. However, because of numerous factors affecting results we offer this information without any guarantee and no patent liability is assumed. For additional information or questions, contact the technical department of KDF LTD.

EPDM 856

(Ethylene Propylene Diene Monomer Rubber)

RUBBER GRANULES

GENERAL CHARACTERISTICS

Type of material: Rubber EPDM

Grain size: 0.5-1.5mm, 1-3.5mm, 1-4mm, EPDM dust

PERFORMANCE OF SAMPLE WITH 22% EPDM CONTENT

Test item	Performance	Standard
Tensile strength (N/mm ²)	>1	ASTM D412-6
Elongation at break (%)	>800	ASTM D412-6
Hardness (shore A)	65	ASTM D2240-15
Specific gravity (kg/m ³)	1.51 ± 0.05	ASTM D792-20

PREPARATION-APPLICATION

EPDM 856 granules are basically used for wet pour colored playground floorings (granulometry 1-3.5mm or 1-4mm or 0.5-1.5mm), for flexible multipurpose outdoor courts in 10-20 mm, **SYSTEM COLORFLEX**, and in applications of running track system such as **POLTRACK SANDWICH SYSTEM** (granulometry 1-3.5mm broadcasted) and **POLTRACK SPRAYCOAT SYSTEM** (granulometry 0.5-1.5 mm as spray system mixed with PU resin P12).

Can be used also as infill of artificial synthetic turf or in the production of EPDM rubber tiles or EPDM rubber rolls or loose lay as EPDM Mulch.

REMARKS

- It is highly suggested (especially in hot climates like in Middle East countries) the usage of the UV-resistance topcoat **POLYSPORT XP 1069**, which gives a strong UV protection and doesn't allow the change of color to occur. **POLYSPORT XP 1069** is produced in all EPDM color range and needs to be applied with 0,4 kg/m² in two crossing layers by airless sprayer or rollers over EPDM surfaces with PU binder.
- In case of sprayed coated running track system, it is suggested the usage of POLYSPORT 1052 UV resistant coating where the color shade is green or blue or any other except red color which doesn't need any protection.
- Same can be applied for long term color stability also for the POLTRACK SANDWICH SYSTEM over broadcasted EPDM granules.
- In case that there is no usage of UV-resistance polyurethane aliphatic coating strong shades like blue, rose, orange, grey etc. will alter.
- All technical data are correct to the best of our knowledge and are intended to help our customers.
- They do not constitute a guarantee of qualities and provide on bases for legal liability.
- We advise our customers to choose the correct type of PU-binder (normal aromatic binder or aliphatic 2-component binder) according to the type and color of the EPDM rubber granules.

CERTIFICATES AND TEST REPORTS

Ask for our certificates and test reports for EPDM as:

- pAH and Elements acc. to EN 71-3
- UV resistance test (FIFA Test Method 10)
- SRI (Solar Reflectance Index)
- Weathering Resistance
- Water Resistance
- Dimensional Stability
- Temperature Resistance

The information given here is true, represents our best knowledge and is based not only on laboratory work, but also on field experience. However, because of numerous factors affecting results we offer this information without any guarantee and no patent liability is assumed. For additional information or questions, contact the technical department of KDF LTD.

CLEANING AND MAINTENANCE MANUAL FOR :

-OUTDOOR SPORTS FLOORING -PLAYGROUND FLOORINGS

Introduction

Outdoor sports floorings and playground surfaces are made of extremely durable polymers, designed to withstand extreme climate conditions and intense use. However for the best maintenance of the sports surface a regular check (once in 6 months) is required and the maintenance of the surface is necessary to preserve the suitability and functionality of the flooring.

The installer's guarantee will usually be conditional on the recommended maintenance requirements being carried out with due diligence.

Maintenance

Maintenance procedures are necessary to preserve the lifetime of the surface and to ensure that:

- The Surface is kept clean.
- The Surface is safe for intense and diverse use.

These objectives are achieved by :

- Sweeping/removing leaves and other debris from the surface.
- Regularly washing the surface with a soft brush to remove contaminants such as grime, grease, algae, moss, sand etc.
- Applying suitable treatments of moss-killer and/or algaecide
- Periodically removing weed growth from the perimeter kerb lines.

Maintenance Equipment

- Leaves, pine needles and other detritus should be removed from the surface immediately as rot quickly helping the growth of mold and moss.
- A mechanical leaf-sweeper or vacuum cleaner is ideal for removing vegetable matter and dirt. Restricted areas may have to be cleaned by hand.
- The maintenance equipment should be well maintained and carefully operated to avoid any physical damage to the surface.
- Pressure loads on the surface as well as friction and shearing loads have to be avoided to prevent damage to the surface.
- At least once a year it is advisable to wash the surface with **low-pressure** jetting apparatus.

- Polymeric surfaces can withstand low pressures without suffering damage.
- Note that no aggressive chemical cleaning agents (chlorine or acid-based) should be used.

Prevention of damages

To ensure the excellent condition of the surface:

- It is forbidden to drive vehicles, bicycles or motorcycles on the surface.
- Chemicals, oils, fuels or solvents on the surface are prohibited.
- Fireworks or cigarettes or unsuitable shoes on the surface are prohibited.

Damages and renovation

The lifetime of an outdoor sports/playground surface depends on its quality, usage and level of maintenance. In general a normal outdoor sports/playground surface used intensively will last 7 to 12 years (depending on the system) before renovation is required. Renovation should be carried out periodically to prevent the total damage of the surface, which would necessitate complete renewal.

Renovation must be carried out by professional and skilled contractors with thorough knowledge of this type of work.

There are different procedures for the renovation of a surface:

- Complete renewal by replacing the worn-out surface with a new sports flooring system.
- Re-topping or sealing with adequate polyurethane or acrylic materials.
- Partial re-topping in particular worn-out areas.

Information contained in this document is of general nature and is given in good faith. As the state of the surface and the use and application of the various cleaning products, is out of our control, our advice for individual cases, verbal, written or based on tests, does not exempt the applicator from the testing the suitability of the cleaning products and their applications.

The above maintenance guide refers to **the below KDF systems:**

-SYSTEM SPORTFLOOR FAST

-SYSTEM SPORTFLOOR-EX

-SYSTEM SPORTFLOOR-EX-R

-SYSTEM FLEXFLOOR-EX

-SYSTEM FLEXFLOOR-EX-R

-SYSTEM POLYFLEX AEL-EX

-SYSTEM POLYFLEX AEL-EX-R
-SYSTEM POLYFLEX WET-POUR EX
-SYSTEM POLYFLEX WET-POUR EX-R
-SYSTEM POLYFLEX PU-EX
-SYSTEM POLYFLEX WET-POUR AEL-EX
-SYSTEM POLYFLEX WET-POUR AEL-EX-R
-SYSTEM SMARTFLOOR-EX
-SYSTEM SAFEPOL MULTICOLOR
-SYSTEM SAFEPOL COLORED
-SYSTEM SAFEPOL WITH TPV GRANULES
-SYSTEM SAFEPOL SBR COLOURANT
-SYSTEM SAFEPOL SANDPROOF
-SYSTEM QUICKLAWN PLAYGROUND SAFEPOL
-SYSTEM QUICKLAWN PLAYGROUND SAFEPOLSANDPROOF
-SYSTEM COLORFLEX
-SYSTEM SPORTGROUND-EX
-SYSTEM DECOQUARTZ
-SYSTEM POLTRACK SPRAYCOAT
-SYSTEM POLTRACK SPRAYCOAT SEALED
-SYSTEM POLTRACK SANDWICH
-SYSTEM POLTRACK ROLL-SANDWICH
-SYSTEM POLTRACK FULL PU
-SYSTEM POLTRACK ACRYLIC
-SYSTEM POLTRACK JOGGING TRACK
-SYSTEM POLTRACK PU JOGGING TRACK
-SYSTEM POLTRACK JOGGING TRACK SBR
-SYSTEM POLTRACK JOGGING TRACK SHOCK-PAD - EPDM
-SYSTEM POLTRACK JOGGING TRACK SHOCK-PAD - ISOPOL
-SYSTEM POLTRACK EQUINE

INDICATIVE REFERENCE LIST OF PROJECTS

- RIYADH CITY NORTH PHASE 7A - ABHU DHABI, U.A.E - 80000m² Bicycle track, Sportground-Ex system
- RIYADH CITY NORTH PHASE 7B - ABHU DHABI, U.A.E - 60000m² Bicycle track, Sportground-Ex system
- CONSTRUCTION OF HARD LANDSCAPING - U.A.E - 60000m² Bicycle track, Sportground-Ex system
- RIYADH CITY SOUTH PHASE 1 - ABHU DHABI, U.A.E - 42000m² Bicycle track, Sportground-Ex system
- 12 SCHOOLS IN U.A.E, MINISTRY OF EDUCATION(THROUGH VARIOUS CONTRACTORS) - 40000m² EPDM Rubber flooring
- MULTIPLE RUNNING TRACKS - ALGERIA - 40000 m² - Running track, POLTRACK SPRAYCOAT system
- AL ESKAN RUNNING TRACK - BURAIDAH, K.S.A -25000m² -Running track, POLTRACK SPRAYCOAT system
- UNIVERSITY OF DAMMAM - KSA - 13000m² - Acrylic cushion floorings
- KING ABDULLAH BASE AIR DEFENSE - TAIF, KSA - 12600 m² - Running track
- KING FAHD UNIVERSITY OF PETROLEUM AND MINERALS-DHARAN, KSA-12400m²-Rubber outdoor flooring
- ”KOSTAS KENTERIS” STADIUM & NATIONAL STADIUM OF MITILINI - MITILINI ISLA, GREECE - 12000m² - Running track, POLTRACK SANDWICH system
- RUNNING TRACK - K.S.A- 11000 m² - Running track, POLTRACK SANDWICH system
- GEMS SCHOOL - DUBAI, U.A.E - 10000 m² - Running track
- PASARGRAD WHOLESALE MARKET-IRAN - 10000 m² - Decorative flooring
- YAS ISLAND, ABU DHABI, U.A.E - 10000m² Bicycle track
- ANASTASIA KELESIDOU STADIUM/KONSTANTINOS KARAMANLIS - THESSALONIKI, GREECE - 10000m²
- Re-topping project, Running track, Sandwich system, Indoor & Outdoor running track
- KAFTANZOGLIO NATIONAL STADIUM OF THESSALONIKI - GREECE - 9000m², POLTRACK SANDWICH
- ABHA STADIUM - K.S.A - 9000m² - POLTRACK SANDWICH system
- ABU DHABI STADIUM - U.A.E - 9000m² - Artificial Grass, POLITURF LEADER 55140
- ALEXANDRIA STADIUM - ALEXANDRIA, EGYPT - 8500 m² - Running track
- SICHUAN INVESTMENT INTERNATIONAL TENNIS CENTER - CHENGDU CHINA - 8250 m² - SPORTFLOOR-EX HARD COURT
- MINISTRY OF EDUCATION IN KUWAIT - KUWAIT - 8000m² - Polyurethane flooring, Polyflex Pu-In system
- SALAM STREET & MINA ROAD, ABU DHABI, U.A.E - 8000m² Bicycle track, Sportground-Ex system
- KING FAHAD NAVAL BASE - JUBAIL, KSA - 8000m² - Running track
- MUNICIPALITY OF VELVENTO - KOZANI, GREECE - 8000m², Running track
- PRINCE FAISAL STADIUM IN RIYADH - K.S.A - 8000m², Running track, POLTRACK SANDWICH system
- ABBHA, KSA - 7600m² - Running track
- MUNICIPALITY OF ZENICA - ZENICA, BOSNIA & HERZEGOVINA - 7500m², Poltrack Spraycoat, Running track
- RUNNING TRACK - KAMIANETS, PODILSKYI, UKRAINE - 7400m², Poltrack Spraycoat
- NATIONAL STADIUM OF TRIKALA - TRIKALA, GREECE - 7000m² - Running track POLTRACK FULL PU
- TELUK BAYAR MINI OLYMPI STADIUM - INDONESIA - 7000m² - Running track, POLTRACK SANDWICH
- ADNOC SCHOOLS - U.A.E - 7000m² - Safepol system
- MAJLIS BANDARAYA PETALING JAYA STADIUM - MALAYSIA - 7000m² POLTRACK SANDWICH
- ATLAS CENTER-BAM, IRAN - 7000 m² - Decorative flooring
- RUNNING TRACK - SUDAN - 7000 m² - Running track, POLTRACK SPRAYCOAT system
- COLOMBIA RUNNING TRACK PROJECT - 6800 m² - POLTRACK SPRAYCOAT
- MUNICIPALITY STADIUM ANDROS ISLA, GREECE - 6700m²- POLTRACK SANDWICH RETTOPING SYSTEM
- RUNNING TRACK STADIUM - CRETE, GREECE - 6500 m² - Running track, POLTRACK SANDWICH system

-PLAYGROUND PROJECT - ABU DHABI, U.A.E - 6500 m², Safety flooring
-RUNNING TRACK STADIUM - DRAMA, GREECE - 6500 m² - Running track, POLTRACK SANDWICH system
-SAADIYAT ISLAND - ABHU DHABI, U.A.E - 6500m² Bicycle track, Sportground-Ex system
-RUNNING TRACK PROJECT IN MUSCAT, OMAN - 6400 m² - POLTRACK SANDWICH system
-KAVALA STADIUM - KAVALA, GREECE - 6300m²- 8-lane Running track, POLTRACK SANDWICH SYSTEM
-CHENGDU SPORT UNIVERSITY - CHENGU, CHINA - 6300 m² - Cushion system, FLEXFLOOR-EX
-CORNISH, JEDDAH, K.S.A - 6000m² Bicycle track Sportground-Ex system
-MUNICIPALITY STADIUM-MOLAOI, GREECE - 5800m²- POLTRACK SANDWICH SYSTEM
-MUNICIPALITY STADIUM SOFADES, GREECE - 5800m²- POLTRACK SANDWICH SYSTEM
-MUNICIPALITY STADIUM OF ALIARTOS - ALIARTOS, GREECE - 5700m²- POLTRACK SPRAYCOAT
-ARTIFICIAL GRASS PROJECT - ATHENS, GREECE - 5700m², Artificial grass
-PAPACHARALAMBIO STADIUM - NAFPAKTOS, GREECE - 5650m² - POLTRACK SANDWICH system
-AMITY INTERNATIONAL SCHOOL - ABHU DHABI, U.A.E - 5500m², Poltrack Spraycoat, Running Track
-MUNICIPALITY STADIUM LOUTRAKI, GREECE - 5500m²- POLTRACK SANDWICH SYSTEM
-SHUQAIQ WATER AND ELECTRICITY COMPANY - JIZAN, KSA - 5400 m² - acrylic courts
-TALEEM UPTOWN SCHOOLS - DUBAI, UAE - 5400m²-Acrylic sports courts systems
-ZAYED PORT - ABHU DHABI, U.A.E - 5400m² Bicycle track, Sportground-Ex system
-SAN FERNANDO DE HENARES - SPAIN - 5300m² - POLTRACK SANDWICH
-SAUDI AIR FORCE - KSA - 5250 m² - Acrylic coating elastoturf, running track
-OMAN WATERFRONT - OMAN - 5000 m² - COLORFLEX-EX
-SHIV NADER SCHOOL - FARIDABAD, INDIA - 5000 m² - Running track, POLTRACK SANDWICH system
-RUNNING TRACK - K.S.A - 5000 m² - Running track, POLTRACK SANDWICH system
-AL HAMRA, RAS AL KHAIMAH, U.A.E - 5000m² Bicycle track, Sportground-Ex system
-AIRBASE IN TAIF - KSA - 5000 m² - Running track
-AMERICAN SCHOOL AL BARSHA - DUBAI - 5000 m² - Running track, POLTRACK SPRAYCOAT system
-MUNICIPALITY STADIUM AMFISSA, GREECE - 5000m²- POLTRACK SANDWICH SYSTEM
-NATIONAL STADIUM OF KALAMPAKA -KALAMPAKA, GREECE-4900m²-POLTRACK SEALED SPRAYCOAT
-MONTORNES DE VALLES - BARCELONA, SPAIN - 4900m² - POLTRACK SPRAYCOAT
-THAILAND STADIUM - 4800 m² - Running track, POLTRACK SANDWICH system
-UMM GHAFAH CYCLE TRACK - AL AIN, U.A.E - 4700m² Bicycle track, Sportground-Ex system
-LYCEE FRANCAIS INTERNATIONAL THEODORE MONOD - SADIYAT, ABU DHABI, U.A.E - 4650 m² - Art. Grass POLITURF LEADER 55140
-BIG SQUARE & LRT STREET, MASDAR CITY - ABHU DHABI, U.A.E - 4600m² Bicycle track, Sportground-Ex
-DEPARTMENT OF EDUCATION ASIR REGION - KHAMIS, KSA - 4500 m² - Running track
-SERVIA STADIUM - KOZANI, GREECE - 4500m², Running track
-STADIUM OF ISLAMIC CITY OF BAWATH IN AL-AZHAR - EGYPT - 4500m²- POLTRACK SANDWICH
-MUNICIPALITY STADIUM OF SOFADES - GREECE - 4500m²- POLTRACK SANDWICH SYSTEM
-BURGUILLOS STADIUM IN SEVILLA - SPAIN - 4400 m² - Running track, POLTRACK SPRAYCOAT system
-”POSIDONIO” NATIONAL ATHLETIC CENTER - THESSALONIKI, GREECE - 4300m²- Acrylic certified flooring
-MUNICIPALITY STADIUM OF MESSINI - GREECE - 4300m²- Running track, POLTRACK SANDWICH SYSTEM
-MUNICIPAL SPORTS CENTER VELOU-VOHA - PELOPONNISOS, GREECE - 4300m²- POLTRACK SANDWICH
-COMMUNITY COLLEGE - KHAMIS, KSA - 4200 m² - Running track
-FAYOUM INIVERSITY - EGYPT - 4200m² - Polyurethane sports flooring, POLYFLEX PU System
-POLIDEPORTIVO UNIVERSIDAD ALCALA DE HENARES-MADRID,SPAIN-4000m²-POLTRACK SPRAYCOAT

-SPORTS CLUB CENTER GLIFADA - ATHENS, GREECE - 4000m²- Poltrack Spraycoat, Running Track
-EMIRATES INTERNATIONAL SCHOOL - DUBAI, U.A.E - 4000m² - Safepol System, Playground flooring
-YAS NORTH EMMARATHI COMMUNITY - ABHU DHABI, U.A.E - 4000m² Bicycle track, Sportground-Ex system
-RUNNING TRACK PROJECT IN QATAR - 4000m², Poltrack Spraycoat system
-RUNNING TRACK PROJECT IN SAMOS - GREECE - 4000m², Poltrack Spraycoat system
-RECONSTRUCTION OF MOROCOCHA STADIUM - PERU - 3850m² - Running track, POLTRACK SANDWICH
-HH KHALID BIN BANDAR - RIYADH, KSA - 3800 m² - Volleyball/basketball rubber courts
-SPORTS FLOORING COMPLEX - ISRAEL - 3700 m², Acrylic sports flooring, SPORTFLOOR-EX system
-MUNICIPALITY STADIUM OF AGIA PARASKEVI, GREECE - 3700m²- POLTRACK SANDWICH SYSTEM
-MUNICIPALITY STADIUM OF HALKIDA - EUBOEA, GREECE - 3700m²- POLTRACK SANDWICH SYSTEM
-RUNNING TRACK- UKRAINE - 3600m² - RunningTrack, Poltrack Spraycoat system
-ANATOLIA GOLLEGE - THESSALONIKI, GREECE - 3600m², Running track
-AIMARJAN ASLAND – PARTIAL - 3600m²- Poltrack Sandwich, Running Track
-RUNNING TRACK - ISRAEL - 3500m² - Running track, POLTRACK SANDWICH system
-KING ABDULLAH UNIVERSITY TECHNOLOGY - K.S.A - 3500m² - Running track, POLTRACK SANDWICH system
-RUNNING TRACK PROJECT - EGYPT - 3500m² - Running track, POLTRACK SPRAYCOAT system
-BICYCLE TRACK PROJECT - GREECE - 3500m²- Acrylic sports flooring, SPORTGROUND-EX system
-MUNICIPALITY OF ALIMOS - ATHENS, GREECE - 3500m²- Acrylic sports flooring, SPORTFLOOR FAST
-MUNICIPALITY STADIUM OF HOLARGOS, ATHENS- GREECE - 3500m²- POLTRACK SANDWICH SYSTEM
-MATRIX SPORTING CLUB - EGYPT - 3400m² - Polyurethane outdoor flooring, Polyflex PU-EX System
-RUNNING TRACK PROJECT - EGYPT - 3400m² - Running track, POLTRACK SPRAYCOAT system
-SPORTS CLUB CENTER KISSAMOS - CRETE, GREECE - 3200m²- Poltrack Sandwich, Running Track
-AL LUSAIL SPORTS CLUB - DOHA, QATAR - 3200m² - Jogging track
-SPORTS CLUB CENTER - SERBIA, GREECE - 3200m² - Poltrack Sandwich, Running Track
-STADIUM CENTER - UKRAINE - 3200m² - RunningTrack, Poltrack Spraycoat system
-KING KHALID UNIVERSITY - ABHA, KSA - 3100 m² - Running track
-MUNICIPALITY STADIUM KRESTENA - GREECE - 3100m²- Poltrack Sandwich, Running Track
-ISLAMIC WORLD GARDEN - SHARJA, U.A.E - 3000m²- Safety flooring, SAFEPOL MULTICOLOR system
-AL FAIOUM UNIVERSITY - FAIOUM, EGYPT - 3000m²- Polyurethane indoor flooring, Polyflex PU-IN system
-RUNNING TRACK PROJECT - VELVEDOS MUNICIPALITY, GREECE - 3000m²- POLTRACK SANDWICH
-WADY DEGLA OCTOBER CLUB - CAIRO, EGYPT - 3000m²- Acrylic sports courts
-SPORTS CLUB CENTER “PAPAGOU”- ATHENS, GREECE - 3000m²- Poltrack Sandwich, Running Track
-PANORAMA SPORTS COMPLEX - THESSALONIKI, GREECE - 3000m², Running track
-PLAYGROUND FLOORING PROJECT IN NORTHERN GREECE - KILKIS, GREECE - 3000m²- SAFEPOL
-TENNIS HALL OF THE DEYANG OLYNPIC SPORTA CENTER - DEYANG, CHINA - 3000 m² - SPORTFLOOR-EX
-BENHA SPORTS CITY - EGYPT - 3000m²- Acrylic sports courts
-SPORTS COMPLEX IN UKRAINE - 3000m² - Safety flooring, SAFEPOL MULTICOLOR system
-CHENAO TENNIS HALL OF THE CHONGGING OLYMPIC SPORTS CENTER - CHONGGING, CHINA - 3000 m² -
SPORTFLOOR-EX
-JOGGING TRACK AT WATERFONT - K.S.A - 3000m² - POLTRACK JOGGING TRACK
-PLAYGROUND FLOORING IN SHARJA - U.A.E - 3000m² - Playground flooring, SAFEPOL MULTICOLOR
-SPORTS FLOORING PROJECT IN YEMEN - 3000m²- Acrylic sports courts, SPORTFLOOR-EX
-SPORTS SCHOOL PROJECT - ARTA, GREECE - 3000m²- Acrylic sports courts, POLYFLEX AEL-EX
-ALIMOS STADIUM - ALIMOS, GREECE - 2850m² - Running track, POLTRACK SANDWICH

-INDIAN ARMY - SAGAR, INDIA - 2800m²- Acrylic sports courts
-COLEGIO INTERNACIONAL DE LA SERENA - CHILE - 2800 m² - Running track, POLTRACK SANDWICH system
-ALL SAINTS SCHOOL - MUMBAI, INDIA - 2700 m² - PU outdoor sports flooring and running track
-INDIAN INSTITUTE OF SCIENCE EDUCATION AND RESEARCH-BHOPAL,INDIA-2700m²-Acrylic sports courts
-RESORT IN RED SEA - EGYPT - 2700m²- Acrylic sports courts, FLEXFLOOR-EX system
-OUR OWN GOLF SCHOOL - 2700m²- Poltrack Spraycoat, RunningTrack
-BAILE FIGA, BISTRITA NASAUD - ROMANIA - 2700m² - Safety flooring, SAFEPOL MULTICOLOR system
-STADIUM STUDENTSKA, SPORTS COMPLEX - BARNNA, BOULGARIA - 2700m² - SPORTFLOOR-EX system
-OUTDOOR SPORTS VENUE - VARNA, BULGARIA - 2700 m² - Acrylic, ITF classified, 8 layers system
-RAKS PALLIKOODAM SCHOOL - INDIA - 2600m² - Acrylic sports courts, FLEXFLOOR-EX system
-DPS GUNTUR SITE, NEW DELHI INDIA - 2600m² - Acrylic sports courts, SPORTFLOOR-EX system
-MUNICIPAL STADIUM OF PREVEZA - GREECE - 2600m² - Running track, POLTRACK SANDWICH
-HIGH SCHOOL COMPLEX - ATTIKA DISTRICT - 2500m² - Acrylic sports courts, SPORTFLOOR FAST system
-KURNISH AL KHOBAR - K.S.A - 2500m² - Rubber flooring, COLORFLEX system
-AL RAYAN, QATAR - 2500 m² - Running track, POLTRACK SANDWICH system
-MUNICIPALITY PARK OF TRIKALA - GREECE - 2500 m² - Running track, POLTRACK FULL-PU
-ALHOSN SPORTS COMPLEX - 2400 m² - Running track, POLTRACK SANDWICH system
-PROJECT BELICA - CROATIA - 2300 m² - Running track, POLTRACK SPRAYCOAT system
-MUNICIPAL SPORTS CENTER PAVLOU MELA - THESSALONIKI, GREECE - 2300 m² - SPORTFLOOR-EX
-MUNICIPALITY STADIUM OF DOXATO - GREECE - 2300m²- POLTRACK SANDWICH SYSTEM
-TORRES DE COTILLAS - SPAIN - 2300m²- POLTRACK SPRAYCOAT
-WADY DEGLA EL NAKHIL CLUB - CAIRO, EGYPT - 2260m² - Acrylic sports courts, POLYFLEX AEL-EX
-OUTDOOR SPORTS FLOORING PROJECT - INDIA - 2250 m²- Acrylic sports courts, SPORTFLOOR-EX
-SPORTS FLOORING PROJECT IN BULGARIA - 2200 m²- Acrylic sports courts, SPORTFLOOR-EX system
-LULU SCHOOL - ABU DHABI, U.A.E - 2200 m² - SAFEPOL MULTICOLOR
-TEACHERS COLLEGE - ABHA, KSA - 2050 m² - Running track
-MUSAB BIN OMAIR BOYS SCHOOL - BIN OMRAN, QATAR - 2050 m² - PU outdoor sport flooring
-BURAIRAT SCHOOL - RAK, UAE - 2000 m² - Running track
-SPORTS CENTRE OF GERAKAS - ATHENS, GREECE - 2000m² - Acrylic sports courts, SPORTFLOOR-EX
-HADAYEK ALAHRAM CLUB - GIZA, EGYPT - 2000m²-PU outdoor sports flooring, POLYFLEX PU-EX WET- POUR
-JP, ADA CIGANLIJA - BELGRADE, SERBIA - 2000m² - SPORTFLOOR-EX
-YASMINA SCHOOL - ABUDHABI, U.A.E - 2000m² - Playground flooring, SAFEPOL MULTICOLOR
-SCHOOL COMPLEX IN NAXOS ISLAND - GREECE - 2000m² - Acrylic sports courts, SPORTFLOOR-FAST
-MUNICIPALITY STADIUM OF MALIA, CRETE - GREECE - 2000m²- POLTRACK SPRAYCOAT SYSTEM
-AL SAILIYA BOYS SCHOOL - AL SAILIYA, QATAR - 2000 m² - Polyurethane, outdoor sport flooring
-KING KHALID UNIVERSITY - ABHA, KSA - 2000 m² - Volleyball/basketball rubber courts
-HH KHALID BIN BANDAR - RIYADH, KSA - 2000 m² - Volleyball/basketball rubber courts
-MUNICIPALITY STADIUM OF DRAMA - GREECE - 2000m²- POLTRACK SANDWICH SYSTEM
-RAWDA RASHEED PRIMARY SCHOOL FOR BOYS - 2000 m² - Outdoor sports flooring
-DEIRA INTERNATIONAL SCHOOL - DUBAI, U.A.E - 2000 m² - POLYFLEX PU-IN
-DAMIETTA GOVERNMENT - EGYPT - 2000m² - Running track, Poltrack Spraycoat Sealed System
-MUNICIPAL STADIUM OF GIANNITSA-GIANNITSA,GREECE-2000m² -Running track POLTRACK SANDWICH
-AL WAKAIR BOYS SCHOOL - AL WAKRAH, QATAR - 1950 m² - Polyurethane, outdoor sport flooring
-THE LAKE DISTRICT - PUNE, INDIA - 1950m²- Acrylic sports courts
-PRESIDENTIAL GUARD COMMANDM MAHAWI - ABU DHABI, UAE - 1900m² - Football court

-GEMS CAMBRIDGE INTERNATIONAL SCHOOL - HOSHIYARPUR, INDIA - 1900m² - FLEXFLOOR-EX
-MUNICIPALITY STADIUM KARPENISI, GREECE - 1900m² - POLTRACK SANDWICH SYSTEM
-UNITED (SABIC) SPORTS CLUB - 1900 m² - Rubber flooring
-OUTDOOR SPORTS FLOORING PROJECT - PAKISTAN - 1900 m² - WET-POUR POLYFLEX AEL-EX
-SHOOLS MINISTRY OF EDUCATION - KHAMIS, KSA - 1800 m² - Rubber flooring
-AL MAJAD AMPHITHEATER - SHARJA, UAE - 1800m² - Certified Jogging track
-MULTIPURPOSE COURTS - KEFALONIA, GREECE - 1800m² - SPORTFLOOR-EX
-QASSIM UNIVERSITY - KSA - 1800m² - Polyurethane sports flooring
-MODERN ENGLISH SCHOOL - EGYPT - 1785m² - Running track, POLTRACK SPRAYCOAT
-AL QADSIYA MODEL INDEPENDENT SCHOOL - ALWAAB, QATAR - 1770 m² - PU outdoor sport flooring
-MUNICIPAL SPORTS CENTER IN KIATO - GREECE - 1750 m² - POLTRACK SPRAYCOAT, SPORTFLOOR-EX
-IKNS SCHOOL - BAHRAIN - 1700 m² - Playground flooring, SAFEPOL MULTICOLOR system
-AL WAHDA SPORT ACADEMY CLUB - ABU DHABI, UAE - 1700 m² - Acrylic sports system
-MUNICIPALITY STADIUM OF AGIA VARVARA - GREECE - 1700m² - POLTRACK SPRAYCOAT SYSTEM
-MULTIPURPOSE ACRYLIC COURTS - BAHRAIN - 1700 m² - SPORTFLOOR-EX system
-ALSARH SCHOOLS OF CIVIL - RIYADH, KSA - 1650m² - PU glue/Soccer field
-PLAYGROUND FLOORING PROJECT IN QATAR - 1650m² - SAFEPOL MULTICOLOR system
-ESTADIO PROVINCIAL DE SANDIA - PUNO, PERU - 1650m² - POLTRACK SANDWICH
-GD GOENKA PUBLIC SCHOLL - PURNIA, INDIA - 1630m² - Acrylic sport1600 m²
-MUNICIPALITY STADIUM OF AGIA VARVARA - GREECE - 1700m² - POLTRACK SPRAYCOAT SYSTEM
-MULTIPURPOSE ACRYLIC COURTS - BAHRAIN - 1700 m² - SPORTFLOOR-EX system
-ALSARH SCHOOLS OF CIVIL - RIYADH, KSA - 1650m² - PU glue/Soccer field
-PLAYGROUND FLOORING PROJECT IN QATAR - 1650m² - SAFEPOL MULTICOLOR system
-ESTADIO PROVINCIAL DE SANDIA - PUNO, PERU - 1650m² - POLTRACK SANDWICH
-GD GOENKA PUBLIC SCHOLL - PURNIA, INDIA - 1630m² - Acrylic sport1600 m² - s courts
-CIVIL DEFENCE TRAINING CENTER, EASTERN PROVINCE - K.S.A - 1600 m² - POLTRACK SPRAYCOAT
-SPA RESORT DERENIVSKUPIA KI - UZHGOROD, UKRAINE - 1600 m² - Flexfloor-ex system, volleyball court
-CIVIL DEFENCE TRAINING CENTER, EASTERN PROVINCE - K.S.A - 1600 m² - POLYFLEX PU-IN
-IISER, INDIAN INSTITUTE OF SCIENCE EDUCATION AND RESEARCH - BHOPAL, INDIA - 1600m² - Acrylic sports courts, FLEXFLOOR-EX system
-EFKARPIA MUNICIPALITY - THESSALONIKI, GREECE - 1600m² - Acrylic sports courts,SPORTFLOOR-EX
-GRACANICA SPORTS CENTRE - KOSOVO - 1600m² - Running Track, POLTRACK PRAYCOAT system
-3 OUTDOOR BASKETBALL COURTS - RHODES ISL GREECE - 1600 m² - FLEXFLOOR-EX system
-RUNNING TRACK PROJECT IN BOSNIA & HERZEGOVINA - 1585² - POLTRACK PRAYCOAT
-THE MILITARY HOSPITAL - RIYADH, KSA - 1560 m² - Volleyball/basketball rubber courts-PU sports flooring
-STADIUM IN BAJRAM CURRI - TROPOJA, ALBANIA - 1550 m² - SPRAYCOAT system
-SCHOOL SPORTS COMPLEX IN POLIGIROS - GREECE - 1550m² - Acrylic flooring, SPORTFLOOR FAST
-AL FORSHAN SPORTS CENTRE - ABU DHABI, U.A.E - 1500m² - Smartfloor system, Acrylic flooring
-INDUSTRIAL FLOORING - BULGARIA - 1500m² - Epoxy flooring, Polepox Coat 814 system
-SCHOOL IN AL WAKRA CITY - DOHA, QATAR - 1500 m² - Playground flooring
-REAL SCHOOL SHAH ALAM - MALAYSIA - 1500 m² - POLTRACK SPRAYCOAT
-IRAQ ARMY CAMP - IRAQ - 1500m² - Acrylic flooring in 2,2mm
-BICYCLE TRACK PROJECT - LARISA-TRIKALA, GREECE - 1500 m² - SPORTGROUND-EX
-PROJECT GREEN LAND - DUBAI, UAE - 1500 m² - Jogging track
-UP TOWN SCHOOL - 1500m² - Poltrack Spraycoat, RunningTrack

-INDIAN AIR FORCE - ALLAHABAD, INDIA - 1450m² - Acrylic sports courts
-OUTDOOR SPORTS COURT COMPLEX - INDIA -1400m²- PU flooring, WET-POUR POLYFLEX PU-EX
-SPORTS FLOORING PROJECT IN KOSOVO - STREET BALL - 1400m²- SPORTFLOOR-EX
-DUBAI MODERN HIGH SCHOOL - DUBAI, UAE - 1375 m² - Acrylic sports courts
-PROJECT ECOGREEN - DUBAI, UAE - 1350 m² - Jogging track
-SAVA BASELINE ACADEMY - MALTA - 1350m² - SMARTFLOOR-EX
-TENNIS CLUB CENTER IN LJUBLJANA - SLOVENIA - 1350m²- SPORTFLOOR-EX
-SPORTS FLOORING PROJECT - BANSKO, BULGARIA - 1350 m² - Acrylic sports courts
-"10" NATIONAL TV STATION - KOSOVO - 1300 m² - Outdoor, acrylic flooring, WET POUR POYFLEX AEL-EX
-POLICE COMPLEX BARRACKS NIZWA - OMAN- 1300 m² - Colorflex, PU sport flooring
-POLICE COMPLEX BARRACKS AL AJAIZ - OMAN - 1300 m² - Colorflex, PU sport flooring
-POLICE COMPLEX BARRACKS KATMATMILAH SITE - OMAN- 1300 m² - Colorflex, PU sport flooring
-POLICE COMPLEX BARRACKS SUWAIQ - OMAN - 1300 m² - Colorflex, PU sport flooring
-POLICE COMPLEX BARRACKS AL KAMIL - OMAN - 1300 m² - Colorflex, PU sport flooring
-PLAYGROUND FLOORING - BAHRAIN - 1300m² - Safepol system
-POLICE COMPLEX BARRACKS SHINAS - OMAN - 1300 m² - Colorflex, PU sport flooring
-POLICE COMPLEX BARRACKS BHALA - OMAN - 1300 m² - Colorflex, PU sport flooring
-POLICE COMPLEX BARRACKS MUDHAIBI - OMAN - 1300 m² - Colorflex, PU sport flooring
-POLICE COMPLEX BARRACKS THUMRAIT - OMAN - 1300 m² - Colorflex, PU sport flooring
-BASKETBALL COURTS PROJECT - NEAPOLI, THESSALONIKI, GREECE - 1300m² - SPORTFLOOR-EX
-POLICE COMPLEX BARRACKS AL KHOUDH - OMAN - 1300 m² - Colorflex, PU sport flooring
-POLICE COMPLEX BARRACKS MAHDAH - OMAN - 1300 m² - Colorflex, PU sport flooring
-POLICE COMPLEX BARRACKS BID BID - OMAN - 1300 m² - Colorflex, PU sport flooring
-POLICE COMPLEX BARRACKS AL KHABoORA - OMAN - 1300 m² - Colorflex, PU sport flooring
-POLICE COMPLEX BARRACKS DHANK - OMAN - 1300 m² - Colorflex, PU sport flooring
-POLICE COMPLEX BARRACKS HAFEET - OMAN - 1300 m² - Colorflex, PU sport flooring
-POLICE COMPLEX BARRACKS AUQAD - OMAN - 1300 m² - Colorflex, PU sport flooring
-POLICE COMPLEX BARRACKS SUMAIL - OMAN - 1300 m² - Colorflex, PU sport flooring
-MATRIX SPORTING CLUB - EGYPT - 1300 m² - Acrylic flooring, Flexfloor System
-OUTDOOR SPORTS VENUE - KOSOVO - 1300 m² - POLTRACK SPRAYCOAT System
-MUNICIPALITY SPORTS CENTRE SYKIES, THESSALONIKI - GREECE - 1300m²- POLTRACK SANDWICH
-SPORTS HALL IBRI - MUSCAT, OMAN - 1300 m² - Indoor sports flooring POLYFLEX PU-IN
-IK TENNIS ACADEMY - MALTA - 1300 m² - SPORTFLOOR-EX HARD COURT
-ALHALAFI BREAK - RIYADH, KSA - 1276 m² - Rubber flooring
-DELHI PUBLIC SCHOOL - ETAWAH, INDIA - 1250m²- Acrylic sports courts, FLEXFLOOR-EX system
-SCHOOL SPORTS PROJECT - ARTASHAT, ARMENIA - 1250m²- COLORLFEX-EX
-GI-DHOFAR BEACH RESORT & SPA - OMAN - 1225 m² - Colorflex, PU sport flooring
-RLS BASIC EDUCATION SCHOOL SOHAR - OMAN - 1225 m² - Colorflex, PU sport flooring
-MIXED BASIC EDUCATION SCHOOL AL QABIL - OMAN - 1225 m² - Colorflex, PU sport flooring
-BOYS BASIC EDUCATION SCHOOL BARKHA - OMAN - 1225 m² - Colorflex, PU sport flooring
-GIRLS BASIC EDUCATION SCHOOL MUDHAIBI - OMAN - 1225 m² - Colorflex, PU sport flooring
-MIXED BASIC EDUCATION SCHOOL AL AMERAT - OMAN - 1225 m² - Colorflex, PU sport flooring
-UMSALAMA GIRLS SCHOOL - AL RAYYAN, QATAR - 1200 m² - Polyurethane, outdoor sport flooring
-SHERATON PARK - DOHA, QATAR - 1200 m² - Playground flooring
-RAWDA BIN JASSIM SCHOOL - AL AZIZIYAH, QATAR - 1200 m² - Polyurethane, outdoor sport flooring

-GEMS WESTMINSTER SCHOOL - DUBAI, U.A.E - 1200 m² - Acrylic sports courts
-SILVER SPORTS CLUB - INDIA - 1200m² - Acrylic sports courts
-OUR OWN SCHOOL - SHARJA, U.A.E - 1200m² - Acrylic sports courts
-SHARJAH FOOTBALL CLUB - SHARJAH, UAE - 1200 m² - Polyurethane basketball courts
-SHERATON PARK - DOHA, QATAR - 1200 m² - Playground flooring
-CHILE RUNNING TRACK PROJECT - 1200 m² - Running track, POLTRACK SPRAYCOAT system
-EGYPT RUNING TRACK PROJECT - 1200m², Running Track, POLTRACK SPRAYCOAT system
-EGYPT RUNING TRACK PROJECT - 1200m², Running Track, POLTRACK SANDWICH system
-ALIGARH MUSLIM UNIVERSITY - ALIGARH, INDIA - 1200 m² - Acrylic sports courts, FLEXFLOOR-EX system
-SUMMER RESORT, KIDS Paly Area - CHALKIDIKI, GREECE - 1200 m² - Playground flooring, SAFEPOL
-SPORTS FLOOR PROJECT IN PAKISTAN - 1200 m² - Acrylic sports courts, POLYFLEX AEL-EX
-SCHOOL COMPLEX - ZAKINTHOS, GREECE - 1200 m² - Acrylic sports courts, SPORTFLOOR FAST
-SYMBIOSIS COLLEGE - INDIA - 1180m² - Acrylic sports courts
-SPORTS PROJECT IN EGYPT - 1170m² - Acrylic sports courts, POLYFLEX AEL-EX
-PROFESSOR ABDULAZIZ ANQARI - RIYADH, KSA -1150m² - PU glue/Socccer field
-ACRYLIC, OUTDOOR SPORTS FLOORING PROJECT - KARACHI, PAKISTAN -1150m² - FLEXFLOOR-EX
-AL SAQID ISLAMIC ENGLISH SHCOLL-DUBAI,UAE-1100m²- Acrylic flooring, WET-POUR POLYFLEX AEL-EX
-REAL SCHOOL HULU LANGAT - MALAYSIA - 1100m² - POLTRACK SPRAYCOAT
-MAADI BRITISH SCHOOL- EGYPT - 1100m², Multipurpose court, COLORFLEX system
-OUTDOOR SPORTS PROJECT IN FOCSANI REGION - ROMANIA - 1100m² - POLTRACK SPRAYCOAT
-CENTRAL SQUARE OF MUNICIPALITY OF THERMI - THESSALONIKI, GREECE - 1100m², Decorative flooring MARMOR FLOOR system
-GREEK TECHNOLOGICAL EDUCATIONAL INSTITUTE OF THESSALIA - GREECE - 1100m², Running Track, POLTRACK SANDWICH system
-NANSHA INTERNATIONAL TENNIS CENTER - GUANGZHOU, CHINA - 1000 m² - SPORTFLOOR-EX
-KORYDALLOS DISTRICT - ATHENS, GREECE - 1100m² - FLEXFLOOR-EX
-CINEGUILLA - PERU - 1100m² - POLYFLEX PU-EX
-FIRST POINT SCHOOLS - DUBAI, UAE1100m² - Acrylic sports courts
-OUTDDOR SPORTS FLOORING PROJECT-ARTA, GREECE-1100m²-POLYFLEX AEL-EX & SPORTFLOOR
-TUMBES - PERU - 1100m² - POLYFLEX PU-IN
-DUBAI AMERICAN ACADEMY - DUBAI, UAE - 1080 m² - Acrylic sports court
-PRELUDE PUBLIC SCHOOL - AGRA, INDIA - 1070m² - Acrylic sports courts
-INDOOR SPORTS FLOORING PROJECT - JORDAN - 1055m² - Polyurethane POLYFLEX PU-IN
-ALMGBAL BREAK - RIYADH, KSA - 1050 m² - Rubber playground
-PLAYGROUND MULTI-PROJECT IN HUANCVELICA - PERU - 1050 m² - SAFEPOL MULTICOLOR
-BANIYAS CLUB AND AL AIN ENGLISH SPEAKING SCHOOL - ABU DHABI, UAE - 1000m² - Acrylic flooring
-WADY DEGLA LOTUS PROJECT - CAIRO, EGYPT - 1000 m² - Acrylic flooring, Wet-Pour Polyflex AEL-EX
-GRAVA SCHOOL COMPLEX - ATHENS, GREECE - 1000 m² - POLTRACK SANDWICH RETTOPING
-INDIAN AIR FORCE - VARANASI, INDIA - 1000m² - Acrylic sports courts
-MULTIPURPOSE COURT - K.S.A - 1000m²- WET-POUR POLEFLEX AEL-EX
-GARDENIA RESIDENTS - DUBAI, U.A.E - 1000 m² - SAFEPOL MULTICOLOR system
-JINDAL UNIVERSITY - SONIPAT, HARYANA, INDIA - 1000m² - PU flooring WET-POUR POLYFLEX PU-EX
-MINISTRY OF EDUCATION - DAMMAM, KSA - 1000 m² - PU indoor multipurpose sports flooring
-SHEIKH OBEID MAKTHOUM PALACE - 1000m² - Outdoor polyurethane flooring
-PAVILHAO POLIDESPORTIVO - SAO JOAO DA PESQUEIRA - PORTUGAL - 1000 m² - POLYFLEX PU-IN

-INDIAN AIR FORCE - AGRA, INDIA - 1000m² - Acrylic sports courts
-INDONESIA - 1000 m² - PU indoor multipurpose sports flooring
-FOOTBALL PITCH PROJECT IN CHALKIDIKI - GREECE-1000 m² Artificial Grass POLITURF TRIUMPH 60100
-INDIAN AIR FORCE - LUCKNOW, INDIA - 1000m² - Acrylic sports courts
-MULTIPURPOSE POLYURTEHANE INDOOR COURTS - F.Y.R.O.M - 1000m² - Polyflex PU-In system
-SODIC PROJECT - EGYPT - 1000m², Multipurpose court, COLORFLEX system
-MUNICIPALITY STADIUM OF LARISA "ALKAZAR"- GREECE -1000m²-POLTRACK SANDWICH RETTOPING
-INDIAN AIR FORCE - VARANASI, INDIA - 1000m² - Acrylic sports courts
-INTERNATIONAL SCHOOL OF CREATIVE SCHIENCE - SHARJAH, U.A.E - 1000m² - Safepol System
-INDIAN AIR FORCE - BIHTA, INDIA - 1000m² - Acrylic sports courts
-INDIAN AIR FORCE - DARBHANGA, INDIA - 1000m² - Acrylic sports courts
-AL AIN INDIAN SCHOOL - AL AIN, UAE - 1000m² - Football court
-GREEK AIR FORCE ACADEMY - TATOI, ATHENS, GREECE - 1000m² - PU flooring, POLYFLEX PU-IN
-DUBAI SCHOLRAS PRIVATE SCHOOL - DUBAI, U.A.E - 1000m² - Acrylic flooring in 2,2mm
-OBOOR SPORTS CLUB - EGYPT - 1000m² - Acrylic flooring
-CAMANA - PERU - 1000m² - POLYFLEX PU-IN
-INDOOR SPORTS PROJECT IN OMAN - MINISTRY OF EDUCATION - 1000m² - PU sports flooring
-VIT AP CAMPUS, AMARAVANTHI, VIJAYAWADA, ANDHRA PRADESH - INDIA - 985m² POLYFLEX PU-IN
-MONARCH INTERNATIONAL SCHOOL - 950m²- Acrylic sports courts, FLEXFLOOR-EX system
-FOOTBALL COURT - LIMASSOL, CYPRUS - 950m² - Artificial grass, POLITURF IMPERIAL 50140
-MULTISPORT FIELD GADIME - KOSOVO - 950m² - POLTRACK SPRAYCOAT
-COMMUNITY COLLEGE - KHAMIS, KSA - 940 m² - Polyurethane indoor multipurpose sports flooring
-GEMS METROPOLE SCHOOL - DUBAI, U.A.E - 900 m² - Playground flooring
-PLAYGROUND FLOORING IN KHARKIV-2 - UKRAINE - 900m² - SAFEPOL MULTICOLOR system
-MINISTRY OF EDUCATION - ABHA, KSA - 900 m² - Polyurethane indoor multipurpose sports flooring
-BAB AL SHAMS SPA HOTEL - DUBAI, UAE - 900m² - Football court
-STREET BALL COURTS - BOSNIA 7 HERZEGOVINA - 880m² - POLTRACK SPRAYCOAT system
-CAIRO FESTIVAL CITY ORIANA PROJECT - EGYPT - 855m² - Playground flooring, SAFEPOL MULTICOLOR
-INDIAN NAVY - KOCHI, INDIA - 850m² - Acrylic sports courts, FLEXFLOOR-EX system
-PARCONA - PERU - 850m² - POLYFLEX PU-EX
-SCHOOL SPORTS COMPLEX - K.S.A - 850m² - POLYFLEX AEL-EX
-CHICAUMA PROJECT - CHILE - 850m² - SAFEPOL MULTICOLOR
-JUBAIL - K.S.A - 850m² - WETPOUR POLYFLEX AEL-EX
-PLAYGROUND PROJECT IN KILKIS - GREECE - 850m² - Playground flooring, SAFEPOL MULTICOLOR
-GALGOTIAS UNIVERSITY - NOIDA, INDIA - 830m²- Acrylic sports courts, FLEXFLOOR-EX system
-KING KHALID UNIVERSITY - ABHA, KSA - 820 m² - Polyurethane indoor multipurpose sports flooring
-SCHOOL COMPLEX - KOSOVO - 820 m² - SPORTFLOOR-EX, ITF classified – class 4
-YLL MORINA SCHOOL - GJAKOVA, KOSOVO - 810m²- Outdoor sports project, POLTRACK SPRAYCOAT
-GYMNASIUM IN OBERHOFFEN - ALSACE, FRANCE - 800m²- POLYFLEX PU-IN
-SPORTS CENTER ANTIRIO - GREECE - 800m² - Running track POLTRACK SPRAYCOAT
-JINDAL UNIVERSITY - SONIPAT, HARYANA, INDIA - 800m² - POLTRACK JOGGING TRACK
-ARTIFICIAL GRASS - STATOVCHA, BULGARIA - 800m² - Artificial grass, POLITURF ROYAL 5588
-SCHOOL IN AL WAKRA CITY - DOHA, QATAR - 800m² - Polyurethane sports flooring
-LYCEE FRANCAISE PROJECT - BEIRUT, LEBANON - 800m² - Acrylic sports flooring

-SULTAN MANOR - RIYADH, KSA - 800m² - Polyurethane multipurpose sports flooring
-MINISTRY OF EDUCATION - AL KHARIZ, KSA - 800m² - PU indoor multipurpose sports flooring
-GEMS AMERICAN ACADEMY - ABU DHABI - U.A.E - 800m² - Running track POLTRACK SANDWICH
-INDOOR SPORTS COURT - MALAYSIA - 800m² - PU indoor sports flooring
-KID'S PLAY AREA IN MALL - MOROCCO - 800m² - PU indoor sports flooring, POLYFLEX PU-IN system
-MARASSI R1 PROJECT - EGYPT - 800m² - Playground flooring, SAFEPOL MULTICOLOR system
-SPORTS CENTER GLIFADA, ATHENS - GREECE - 800m² - Running track POLTRACK SANDWICH
-SPORTS CENTER VRILISIA, ATHENS - GREECE - 800m² - Running track POLTRACK SANDWICH
-DUBAI ENGLISH SPEAKING COLLEGE - DUBAI, UAE - 783m² - Acrylic flooring, SPORTFLOOR-EX
-MULTIPURPOSE COURT - YEREVAN - ARMENIA - 765m² - COLORFLEX-EX
-HAYATABAD PESHAWAR - INDIA - 750m² - Polyurethane sports flooring, POLYFLEX PU-IN
-SINGAPORE AIRLINES - SINGAPORE - 735m² - PU indoor sports flooring
-CJM MIZIARA SCHOOL - LEBANON - 730m² - WET-POUR POLYFLEX AEL-EX
-AL DAJAN COMPANY - GASIM, KSA - 722m² - Polyurethane sports flooring/Tennis court
-SELECTIVE GOVERNMENT HIGH SCHOOL - EGYPT - 720m² - Outdoor sports flooring
-INDIAN AIR FORCE - AHMEDABAD, INDIA - 720m² - Acrylic sports courts
-FITNESS TIME - FAYSALIA, DAMMAM, KSA - 700 m² - PU indoor multipurpose sports flooring/running track
-FITNESS TIME YASMEEN - RIYADH, KSA - 700 m² - PU indoor multipurpose sports flooring/running track
-FERRARI WORLD - ABU DHABI, UAE - 700m² - Playground flooring
-KOHAT SPORTS COMPLEX - PAKISTAN - 700m² - PU flooring, POLYFLEX PU-IN
-FITNESS TIME JUNIOR - RIYADH, KSA - 700 m² - PU indoor multipurpose sports flooring/running track
-FITNESS TIME - OLAYA RIYADH, KSA - 700 m² - PU indoor multipurpose sports flooring/ running track
-FITNESS TIME WAHA - RIYADH, KSA - 700 m² - PU indoor multipurpose sports flooring/running track
-FITNESS TIME, NOOR BRANCH - DAMMAM, KSA - 700 m² - PU indoor sports flooring and running track
-FITNESS TIME, ALAMEEN BRANCH - DAMMAM, KSA - 700 m² - PU indoor sports flooring and running track
-FITNESS TIME, PLUS RIYADH - RIYADH, KSA - 700 m² - PU indoor sports flooring and running track
-FITNESS TIME, SALAMA BRANCH BRO & FITNESS - JEDDAH, KSA - 700 m² - PU indoor sports flooring
-FITNESS TIME, 40th BRANCH - JEDDAH, KSA - 700 m² - PU indoor sports flooring and running track
-NASR CLUB- EGYPT - 700m² - Multipurpose court, POLYFLEX WET-POUR system
-HUREL DOUBLE 3 - RAS AL KHAIMEH, KSA - 700 m² - Shockpad plus acrylic coatings
-THE SUSTAINABLE CITY - DUBAI, U.A.E - 700 m² - Acrylic flooring
-PROJECT IN MALTA - 700 m² - Acrylic flooring, SPORTFLOOR-EX system
-EMAAR - EMIRATES HILLS 2 - DUBAI, U.A.E - 700m² - Basketball court, Acrylic flooring
-AIRFORCE SURBOTO PARK - NEW DELHI, INDIA - 680 m² - Polyurethane outdoor sports flooring
-INDIAN ARMY - DHRANGDHARA, INDIA - 670m² - Acrylic sports courts
-MT.SAINT PATRICK ACADEMY - INDIA - 665m² - Acrylic sports courts
-RAJIV GANDHI THERMAL POWER PLANT - HISAR, INDIA - 650m² - Acrylic sports courts, FLEXFLOOR-EX
-JAWAHARLAL NEHRU TECHNOLOGICAL UNIVERSITY ANANTAPURAMU - ANANTAPUR, INDIA - 650m² - Acrylic sports courts, FLEXFLOOR-EX system
-TILAL HOTEL - DUBAI, U.A.E - 650 m² - SAFEPOL MULTICOLOR system
-REGIONAL HQ AT BURAIMI - OMAN - 650 m² - Colorflex, PU sport flooring
-PLAYGROUND FLOORING PROJECT IN LARNAKA, CYPRUS - 650 m² - SAFEPOL MULTICOLOR system
-ROYAL OMAN POLICE TASK FORCE RUSTAQ - OMAN - 650 m² - Colorflex, PU sport flooring
-ROYAL OMAN POLICE TASK FORCE LIWA - OMAN - 650 m² - Colorflex, PU sport flooring
-ROYAL OMAN POLICE TASK FORCE AL SALIL - OMAN - 650 m² - Colorflex, PU sport flooring

-OUTDOOR TENNIS COURTS - KOSOVO - 650m² - Acrylic sports courts, SPORTFLOOR-EX
-ROYAL OMAN POLICE TASK FORCE IBRI - OMAN - 650m² - Colorflex, PU sport flooring
-ROYAL OMAN POLICE TASK FORCE IBRA - OMAN - 650m² - Colorflex, PU sport flooring
-ROYAL OMAN POLICE TASK FORCE AL SUR - OMAN - 650m² - Colorflex, PU sport flooring
-3 PICKLEBALL COURTS IN CRAZ CITY - AUSTRIA - 650m² - Acrylic sports flooring, FLEXFLOOR-EX system
-ROYAL OMAN POLICE TASK FORCE AL DUKUM - OMAN - 650m² - Colorflex, PU sport flooring
-ROYAL OMAN POLICE TASK FORCE AL BURAIMI - OMAN - 650m² - Colorflex, PU sport flooring
-OASIS COMPLEX - K.S.A - 650m² - WET-POUR POLYFLEX PU-IN system
-ROYAL OMAN POLICE TASK FORCE AL NIZWA - OMAN - 650m² - Colorflex, PU sport flooring
-ROYAL OMAN POLICE TASK FORCE AL SUWAIQ - OMAN - 650m² - Colorflex, PU sport flooring
-ABU DHABI MUNICIPALITY - ABU DHABI , UAE - 650m² - Acrylic flooring
-INDOOR BASKETBALL COURT - JUBAIL - K.S.A - 650m² - WET-POUR POLYFLEX PU-IN system
-ST. MARY'S SCHOOL - LEMESOS, CYPRUS - 650m² - Playground flooring, SAFEPOL MULTICOLOR
-ROYAL OMAN POLICE TASK FORCE AL SALALAH - OMAN - 650m² - Colorflex, PU sport flooring
-ROYAL OMAN POLICE TASK FORCE AL BARKHA - OMAN - 650m² - Colorflex, PU sport flooring
-ROYAL OMAN POLICE TASK FORCE KHOUDH - OMAN - 650m² - Colorflex, PU sport flooring
-MULTIPURPOSE COURTS - TIRANA, ALBANIA - 650m² - Acrylic sports flooring, FLEXFLOOR system
-PLAYGROUND FLOORING IN KHARKIV-3 - UKRAINE - 650m² - SAFEPOL MULTICOLOR system
-MOHAMMED JASSIM M AL THANI SCHOOL - UMSALALALI, QATAR - 620m² - PU outdoor sport flooring
-QATAR GEMS SCHOOL - DOHA, QATAR - 615m² - Polyurethane sports flooring
-VELOOR THRISSUR DISTRICT - KERALA, INDIA - 610m² - Acrylic sports courts, FLEXFLOOR-EX system
-PUBLIC PARK - ABU DHABI, U.A.E - 610m² - Acrylic sports courts, SPORTFLOOE-EX FAST system
-VAISHNO DEVI - DELHI, INDIA - 610m² - Polyurethane outdoor sports flooring
-EQUINE FLOORING - BAHRAIN - 600m², POLTRACK EQUESTRIAN SYSTEM
-THAILAND - 600m² - Acrylic sports courts
-VILLA SINMAC PARK - SAN ANTONIO, PERU - 600m² - SAFEPOL MULTICOLOR system
-WATER'S EDGE RESIDENTIAL DEV'T - YAS ISLAND, ABHU DHABI, U.A.E - 600m² Sportground-Ex system
-PLAYGROUND FLOORING IN BAHRAIN - 600m² - SAFEPOL MULTICOLOR system
-PLAYGROUND FLOORING IN KHARKIV - UKRAINE - 600m² - SAFEPOL MULTICOLOR system
-INDIAN ARMY - AGRA, INDIA - 600m² - Acrylic sports courts
-THE INTERNATIONAL SCHOOL - AGRA, INDIA - 600m² - Acrylic sports courts
-INDIAN ARMY - JHANSI, INDIA - 600m² - Acrylic sports courts
-THE SUSTAINABLE CITY - DUBAI, U.A.E - 600m² - Safepol system
-AMITY SCHOOL, JUMEIRAH ISLAND - DUBAI, UAE - 600m² - Safepol system
-QUEEN ZAIN AL SHARAF HALL - JORDAN - 600m² - POLYFLEX PU-IN
-OUR OWN ENGLISH HIGH SCHOOL - SHARJAH, U.A.E - 600m² - Flexfloor system
-OUR OWN ENGLISH HIGH SCHOOL - SHARJAH, U.A.E - 600m² - Polyflex Ael-EX system
-ST. FRANCIS INTER COLLEGE - HATHRAS, INDIA - 600m² - Acrylic sports courts, FLEXFLOOR-EX system
-ST. ANTHONY'S SENIOR SECONDARY SCHOOL - FARRUKHABAD, INDIA - 600m² - FLEXFLOOR-EX
-SKATING FOR KIDS - GUJARAT, INDIA - 600m² - Sportfloor system
-IMS COLLEGE - GHAZIABAD, INDIA - 600m² - Acrylic sports courts, FLEXFLOOR-EX system
-GALGOTIAS COLLEGE OF ENGINEERING - GR. NOIDA, INDIA - 600m² - Acrylic sports courts, FLEXFLOOR-EX
-HOTEL COMPLEX IN DHERMI, ALBANIA - 600m² - Acrylic sports courts, SPORTFLOOR-EX system
-DANIEL BECCERA OCAMPO EDUCATIONAL INSTITUTION-MONQUEGUA,PERU - 580m² POLYFLEX PU-EX
-TATLAY AALI SPORTS COMPLEX - PAKISTAN - 500m² - PU flooring, POLYFLEX PU-IN

-NEW DUBAI BRADENTON SCHOOL- DUBAI, UAE - 570m² - Acrylic sports courts
-«CRONWELL PLATAMON RESORT» HOTEL IN PLATAMONAS - GREECE - 560m² - SPLASH PARK FLOORING, AQUASOFT-EX system
-DUBAI SILICON OSIS-CENTRAL PARK, DSO - DUBAI, UAE - 560 m² - Jogging track
-MPS WORLD SCHOOL - AGRA, INDIA - 560m²- Acrylic sports courts
-LEADERS INTERNATIONAL SCHOOLS - EGYPT - 560m²- PU sports courts
-PLAYGROUND PROJECT IN AL KASIM - K.S.A - 560m²- SAFEPOL MULTICOLOR
-HARTLAND INTERNATIONAL SCHOOL - U.A.E - 550m²- SAFEPOL MULTICOLOR system
-PLAYGROUND FLOORING PROJECT IN SINGAPORE - 550m²- SAFEPOL MULTICOLOR system
-ARMY LAW COLLEGE PUNE- PUNE, INDIA - 550m²- Acrylic sports courts, FLEXFLOOR-EX system
-AL WUKAIR GIRLS SCHOOL - AL WAKRAH, QATAR - 550m² - Polyurethane, outdoor sport flooring
-AL BUROUJ PROJECT, SPORTS CLUB - EGYPT - 550m² - Running track, POLTRACK SPRAYCOAT
-PLAYGROUND PROJECT IN CYPRUS - 550m²- SAFEPOL MULTICOLOR system
-BBPS - DELHI, INDIA - 512m² - Polyurethane outdoor sports flooring
-IVY STATE - PUNE, INDIA - 511m²- Acrylic sports courts
-KUNAL ICONIA - INDIA - 510m²- Acrylic sports courts
-PORT CISNE - CHILE - 500m² - SAFEPOL MULTICOLOR
-AGRICULTURE UNIVERSITY PESHAWAR - INDIA - 500m² - Polyurethane sports flooring, POLYFLEX PU-IN
-LJUBUSKY PROJECT - BOSNIA & HERZEGOVINA - 500m² - Acrylic sports flooring FLEXFLOOR-EX
-MURIDKE SPORTS COMPLEX-SHEIKHUPURA, PUNJAB, PAKISTAN - 500m²-PU flooring,POLYFLEX PU-IN
-CRNA REKA PETROL - NORTH MACEDONIA - 500m² - Acrylic flooring, FLEXFLOOR-EX
-ONE PARK AVENUE, SOBHA HARTLAND - U.A.E - 500m² - SAFEPOL MULTICOLOR system
-VARIOUS PLAYGROUND PROJECTS IN ABU DHABI - U.A.E - SAFEPOL MULTICOLOR system
-AMERICAN SCHOOL OF DUBAI - DUBAI, UAE - Acrylic sports courts
-ETIHAD MUSEUM - JUMEIRAH, DUBAI, UAE - Rubber flooring
-SHENZHEN CITY VALLEY - CHINA - Acrylic sports flooring
-CARPARKING - ABU DHABI, UAE - Acrylic flooring
-DUBAI MILLENIUM SCHOOL - QUSAIS, UAE - Acrylic sports courts
-AMERICAN UNIVERSITY - DUBAI, UAE – Acrylic outdoor sports flooring
-RAK ACADEMY - RAK, UAE - Acrylic flooring
-ISCS - SHARJA, UAE - Acrylic flooring
-THE INTERNATIONAL SCHOOL OF CHOUEIFAT - AJMAN, U.A.E - Sportground-Ex system
-THE KINDER GARDEN STARTERS - DUBAI, U.A.E - Safepol system
-AL ZAHIA PROJECT - SHARJA, UAE - Safepol system
-WADY DEGLA SHERATON CLUB - CAIRO, EGYPT - Acrylic sports flooring
-NEW DUBAI BRADENTON SCHOOL- DUBAI, UAE - 570m² - Acrylic sports courts
-PLAYGROUND PROJECT IN QATAR - SAFEPOL MULTICOLOR
-GEMS WELLINGTON SCHOOL - DUBAI, U.A.E - Safepol system
-JUMEIRAH RETAIL DEVELOPMENT - JUMEIRAH, DUBAI, UAE - Safety rubber flooring
-MR.ABDULRHMIN - JUBAIL, KSA - Rubber playground
-GEMS WESTMINISTER SCHOOL - DUBAI, U.A.E - Safepol system
-POLYURETHANE INDOOR SPORTS COURT - TIRANA, ALBANIA - Polyflex PU-In system
-MULTIPURPOSE COURTS - ODESSA, UKRAINE - Rubber flooring
-MULTIPURPOSE COURTS - ZHOVKVA, UKRAINE - Rubber flooring
-MUNICIPAL TENNIS CLUB - PATRA, GREECE - Flexfloor-EX system, Acrylic sports courts

-INDIAN AIR FORCE - GORAKHPUR, INDIA - Acrylic sports courts
-INDIAN AIR FORCE - BAREILLY, INDIA - Acrylic sports courts
-INDIAN ARMY - BABINA, INDIA - Acrylic sports courts
-ADAM AIRBASE PACKAGE 8, OMAN - Colorflex, PU sport flooring
-GOLD GYM - KOLKATTA, INDIA - Polyurethane indoor sports flooring
-MINISTRY OF FOREIGN AFFAIRS - ABU DHABI, UAE - Polyurethane flooring
-SHRJAH SPORTS CLUB - SHARJAH, UAE - Polyurethane flooring
-GEMS WINCHESTER SCHOOL - AL BARSHA SOUTH, UAE - Acrylic sports system
-HOTEL DOUBLE 3 - RAS AL KHAIMAH, UAE - Prefabricated shock-pad 4mm plus acrylic coatings
-ALNABBAGH STABLE - AL AIN, U.A.E - Polyurethane flooring, POLTRACK EQUESTRIAN FLOORING
-AL WAHDA CLUB - ABU DHABI, UAE - Rubber flooring
-ADJD MAIN BUILDING LANDSCAPE PROJECT - ABU DHABI, UAE - Rubber flooring
-KADEEJ AL KURBA SCHOOL - ABU DHABI, UAE - Rubber flooring
-INTERNATIONAL SCHOOL OF CREATIVE SCIENCE-SHARJA, U.A.E-Flexfloor system/Outdoor Multipurpose court
-ENVIRO, VATIKA HOTELS PVT.LTD - GURGAON, INDIA - Acrylic sports flooring
-ASHIANA - BHUBANESHWAR, INDIA - Acrylic sports flooring
-TCS, ADIBATLA - HYDERABAD, INDIA - Acrylic sports flooring
-IPS, ERODE - CHENNAI, INDIA - Acrylic sports flooring
-LIONS GATE - MUMBAI, INDIA - Acrylic sports flooring
-MORNING GLORY INFRA LIMITED - KANPUR, INDIA - Acrylic sports flooring
-SPORTS HALL ZVORNIK - BOSNIA & HERZEGOVINA - PU flooring POLYFLEX PU-IN
-NAMBIAR - BANGALORE, INDIA - Acrylic sports flooring
-PATHWAYS - GURGAON, INDIA - Acrylic sports flooring
-WELHAMS GIRLS SCHOOL - DEHRADUN, INDIA - Acrylic sports flooring
-WOODDUCK COMMERCIAL CENTER- IRAN - Industrial flooring
-ARABIAN RANCHES by EMAR - DUBAI, U.A.E - Playground flooring
-OUR OWN ENGLISH HIGH SCHOOL - SHARJAH, U.A.E - Playground flooring
-POLO CLUB GHANTOOT - ABU DHABI, U.A.E - Polyurethane flooring, POLTRACK EQUESTRIAN FLOORING
-RAK MODERN SCHOOL - RAS AL KHAIMAH, U.A.E - Playground flooring
-GIIS/GLOBAL INDIAN INTERNATIONAL SCHOOL - RAS AL KHAIMAH, U.A.E - Playground flooring
-MINISTRY OF EDUCATION, NAD AL HAMAR BOYS SCHOOL - DUBAI, U.A.E - Playground flooring
-K.G. KIDS SCHOOL - AALI, BAHRAIN - Playground flooring
-SABIC BEACH CAMPS PROJECT - JUBAIL, K.S.A - Outdoor sports flooring, artificial grass.
-MINISTRY OF EDUCATION, MIZHER GIRLS SCHOOL - DUBAI, U.A.E - Playground flooring
-WARSAN STABLE - Polyurethane flooring, POLTRACK EQUESTRIAN FLOORING
-AL SHIMAL PARK - DOHA, QATAR - Playground flooring
-UM SELAL PARK - DOHA, QATAR - Playground flooring
-GEMS METROPOLE SCHOOL - DUBAI, U.A.E - Hard court system/Outdoor Multipurpose court
-ARABIAN RANCHES by EMAR - DUBAI, U.A.E - Acrylic Outdoor Tennis and Basketball courts
-RAK MODERN SCHOOL - RAS AL KHAIMAH, U.A.E - Flexfloor system
-GIIS/GLOBAL INDIAN INTERNATIONAL SCHOOL - RAS AL KHAIMAH, U.A.E - Acrylic system
-AVALON HEIGHTS - AJMAN, U.A.E - Acrylic floorings
-DELHI PRIVATE SCHOOL - DUBAI, U.A.E - Acrylic flooring
-ROYAL COMMISSION SCHOOL - JUBALI, KSA - Acrylic sports flooring

-FITNESS TIME PRO - AL AHSA BRANCH - KSA - Flexfloor, Basketball court
-FITNESS TIME PRO - MAKKAH SHARAIE - KSA - Flexfloor, Basketball court
-BIN HAM - AL AIN, UAE - Polyurethane flooring
-SHAMMA BINT MOHAMMED SHOOL - AL AIN, UAE - Polyurethane flooring
-ABDULLAH BIN OTAIBA - ABU DHABI, UAE - Polyurethane flooring
-LIWA INTERNATIONAL SCHOOL - AL AIN, U.A.E - Colorflex outdoor sport system
-ZOHOUR KG - MANAMA, BAHRAIN - Polyurethane sports flooring
-RAWDA RASHED - QATAR- Polyurethane, outdoor sport flooring
-SAAD BIN ABI WAQAS SCHOOL - AL RAYYAN, QATAR - Polyurethane, outdoor sport flooring
-FITNESS TIME PRO - MADINS RING ROAD BRANCH - KSA - Flexfloor, Basketball court
-AGRA CHAIN - AGRA, INDIA - Acrylic sports flooring
-SUNWORLD - NOIDA, INDIA - Acrylic sports flooring
-SSN INVESTMENTS PRIVATE LIMITED, FRIENDS COLONY - DELHI, INDIA - Acrylic sports flooring
-AJNARA - NOIDA, INDIA - Acrylic sports flooring
-BRIGHT RIDERS SCHOOL - ABU DHABI, UAE - Running track, Acrylic sports court
-OUR OWN ENGLISH HIGH SCHOOL - SHARJAH, U.A.E - Poltrack Spaycoat system
-NCC - JAIS, INDIA - Acrylic sports flooring
-ALPHA FOUNDATION FOR EDUCATION & RESEARCH - TRICHIRAPALLI, INDIA - Acrylic sports flooring
-PUSHPANJALI FARMS - NEW DELHI, INDIA - Acrylic sports flooring
-M3M - MERLIN GURGAON, INDIA - Acrylic sports flooring
-NORTH LONDON COLLEGIATE SCHOOL - DUBAI, U.A.E - Playground flooring
-FOOT COURT - EGYPT - Running track, POLTRACK SPRAYCOAT system
-FITNESS TIME ANDALUS BRANCH - JEDDAH, K.S.A - Acrylic sports flooring, FLEXFLOOR SYSTEM
-ST.JOSEPHS WOMENS COLLEGE - ALLEPPEY, KERALA, INDIA - Polyurethane outdoor sports flooring
-RAILWAY SPORTS GROUND - GUNTAKAL, ANDRA PRADESH, INDIA - Acrylic sports flooring
-TERVEL PROJECT - TERVEL, BULGARIA - Playground flooring, SAFEPOL system
-INDOOR COURT - UKRAINE - Polyflex PU-In system
-PRIVATE JOB - HYDERABAD, SOUTH INDIA - Acrylic outdoor sports flooring
-RAILWAY SPORTS GROUND -GUNTAKAL, ANDRA PRADESH, INDIA-Acrylic outdoor sports flooring, 5 layers
-VARIOUS PLAYGROUND PROJECTS IN ABU DHABI - U.A.E - SAFEPOL MULTICOLOR system
-POLYURETHANE OUTDOOR SPORTS COURT - QATAR - POLYFLEX PU-EX system
-QASR AL SARAB DESERT RESORT - ABU DHABI, U.A.E - SAFEPOL MULTICOLOR
-SPORTS CENTER IN HANOI - VIETNAM - POLYFLEX PU-IN
-NIELSON BUKA RESORT - KALAMATA, GREECE - FLEXFLOOR-EX
-PARALYMPICS FEDERATION SPORTS CENTER - CAMBODIA - POLYFLEX PU-IN system
-MINISTRY OF EDUCATION U.A.E - Playground flooring
-PLAYGROUND FLOORING - VARNA, BULGARIA - SAFEPOL System
-INDIAN ARMY - SHAHJAHANPUR, INDIA - Acrylic sports courts, FLEXFLOOR-EX system
-AIR FORCE SCHOOL - BENGALURU, INDIA - Acrylic sports courts, FLEXFLOOR-EX system
-ARMY PUBLIC SCHOOL - UDHAMPUR, INDIA - Acrylic sports courts, FLEXFLOOR-EX system
-BAHRAIN ROYAL EQUESTRIAN AND ENDURANCE FEDERATION - BAHRAIN - PU Equestrian system
-PLAYGROUND PROJECT - HONG KONG - SAFEPOL MULTICOLOR system
-PLAYGROUND PROJECT - KOSOVO - SAFEPOL MULTICOLOR system
-KIND SAUDI UNIVERSITY - RIYADAH, K.S.A - Running track, POLTRACK SPRAYCOAT ASYSTEM
-TENNIS COURT IN MYKONOS, GREECE - Acrylic sports courts, POLYFLEX AEL-EX system

- TENNIS COURT PROJECT - PAKISTAN** - Acrylic sports courts, SPORTFLOOR-EX-R system
- SHENZHEN CITY VALLEY - CHINA** - Acrylic sports courts
- QAYYUM STADIUM PESHAWAR - INDIA** - Polyurethane flooring POLYFLEX PU-IN
- PLAYGROUND FLOORING IN CYPRUS** - SAFEPOL MULTICOLOR system
- PLAYGROUND FLOORING - PRNJAVOR, BOSNIA & HERZEGOVINA** - SAFEPOL MULTICOLOR system
- BASKETBALL & BADMINTON COURTS-ASHIANA DAKSH-INDIA**-Polyurethane flooring POLYFLEX PU-EX
- BASKETBALL & BADMINTON COURTS-ASHIANA UMANG-INDIA**-Polyurethane flooring POLYFLEX PU-EX
- MULTIPURPOSE COURT - GUATEMALA** - POLYFLEX AEL-EX-R
- PLAYGROUND PROJECT - K.S.A** - SAFEPOL MULTICOLOR
- PLAYGROUND PROJECT IN JUBAIL - K.S.A** - SAFEPOL MULTICOLOR
- REPTON SCHOOL - DUBAI, U.A.E** - SAFEPOL MULTICOLOR
- PLAYGROUND PROJECT IN TEL AVIV - ISRAEL** - SAFEPOL MULTICOLOR
- PLAYGROUND PROJECT IN RISHON LEZION - ISRAEL** - SAFEPOL MULTICOLOR
- PLAYGROUND PROJECT IN ILION - ATHENS,ISRAEL** - SAFEPOL MULTICOLOR
- PLAYGROUND PROJECT WATERFORIN OF SAN ANTONIO - CHILE** - SAFEPOL MULTICOLOR