

KDF

Sports Flooring Systems & Building Materials

WET-POUR POLYFLEX AEL-IN INDOOR SPORT SYSTEM



www.kdf.gr



KDF LTD (www.kdf.gr) is one of the most dynamic and export-oriented Greek companies (currently activated in more than 80 countries in 4 continents), based in Greece (EU) and in U.A.E too, with production facilities and warehouses in both countries for acrylics and polyurethanes and **EPDM** granules.

We are experts in sports, industrial and decorative flooring products and systems, with huge experience in Europe with many applied projects in Spain, France, Greece as well as Malta, Romania, Bulgaria, Croatia, Serbia and Ukraine. Our presence is active in Latin America too with projects in Colombia, Peru, Chile, and Brazil, Africa, Asia, Middle East and India as well.

Our export horizon is expanding rapidly, and our goal is to stand out as a model of flexibility and competitiveness. The company, being one of the pioneer companies in the sector of sports flooring systems and building materials and giving particular attention to providing a fully upgraded range of products and services, provides certified systems according to all **EU norms and regulations** and by well-known international institutes like **WORLD ATHLETICS, I.T.F, TUV, LNE, LABOSPORT, ISASPORT, INTERTEK to name but a few.**

KDF goes far beyond trade, providing consultancy in marketing and technical support all the way, from the costing till the finalization of the project. Operating under the requirements of **ISO 9001/2015** (and many others like **ISO 14001/2015, ISO 50001/2018, ISO 27001/2013** and more) for production, trade and application, we make sure our products are first applied successfully at site by our own people before we launch them abroad.

Therefore, our systems have all stood the real-life test in different climates, from North Europe to Middle East till South America, and this is one of our main assets, enabling us to provide full and vertical technical support from specifying to final application plus supervision when required or even full application and costing.

We invite you to discover a world of sports flooring expertise and solutions.

[VIEW OUR NEW SPORTS CATALOGUE](#)



KDF - Kataskeves Dapedon LTD
e : exports@kdf.gr
w : www.kdf.gr

19th km National Road Thessaloniki-Moudania
57001, Neo Rysio, Thessaloniki, Greece
t / f : +30 2310 829598

Contents

- 3. Technical Description of the system
- 4. Methodology of the system
- 8. Colorchart
- 10. Photographs of Projects
- 11. Technical Data Sheet (TDS) per each material
- 21. Maintenance manual
- 23. Indicative Reference List of Projects

INDOOR SPORTS FLOORING

WET-POUR POLYFLEX AEL-IN

Indoor highly flexible shock-absorbent, acrylic sports flooring system, ideal for multipurpose halls, gym floors, tennis, basketball, volleyball, handball, futsal courts, as well as any other indoor sports court.

Combination of a mixture of **PU BINDER 1118** and **RECYCLED RUBBER 858 - SBR granules** in granulometry of 0.5-2mm, applied by paver machine in thickness of 6mm up to 14mm, with acrylic-based and polyurethane-based coatings.



Steps:

- 1. PU PRIMER 870 - Special, polyurethane primer.**
Applied by airless sprayer or brush on asphalt surfaces or on waterproof concrete surfaces without rising humidity issues.
- 2. Mixture of PU BINDER 1118 and RECYCLED RUBBER 858 (minimum 6mm) - Elastic, shock-absorbent, wet-pour mixture.**
The **RECYCLED RUBBER 858** is in granulometry of 0.5-2mm. Applied by paver machine in thickness from 6mm up to 14mm or more.
- 3. ELASTOTURF 851S - Acrylic, elastic, smooth, coating for sports flooring systems.**
Consists of acrylic resins, powder quartz sand and special improver. Applied by squeegee in three layers at least.
- 4. POLYSPORT 952 - Polyurethane, aliphatic, two-component top coating for indoor sports flooring.**
Applied, in two crossing layers by airless sprayer or short haired mohair roller.

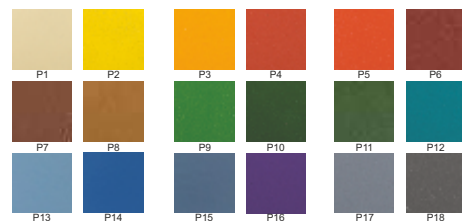
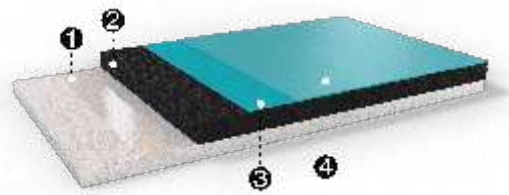

Description	Consumption
PU PRIMER 870 - Special, polyurethane, primer.	0.2-0.3kg/m ² for 2 layers
PU BINDER 1118 - Polyurethane binder.	1.32kg/m ² for 10mm mixture
RECYCLED RUBBER 858 - SBR granules in granulometry of 0.5-2mm.	6kg/m ² for 10mm mixture
ELASTOTURF 851S - Acrylic, elastic, smooth coating for sports floors systems.	3.5-3.8kg/m ² for 3 layers
POLYSPORT 952 - Polyurethane, aliphatic, two-component top coating for indoor sports flooring.	0.35kg/m ² for 2 layers

SYSTEM WET – POUR POLYFLEX AEL – IN

Total thickness of 8mm – 14mm



Indoor highly flexible shock-absorbent, acrylic sports flooring system, ideal for multipurpose halls, gym floors, tennis, basketball, volleyball, handball, futsal courts, as well as any other indoor sports court.

Combination of a mixture of PU BINDER 1118 and RECYCLED RUBBER 858 - SBR granules in granulometry of 0.5-2mm, applied by paver machine in thickness of 6mm up to 14mm, with acrylic-based and polyurethane-based coatings.

Steps:

1. **PU PRIMER 870 - Polyurethane primer.** Applied by airless sprayer or brush on asphalt surfaces or on waterproof concrete surfaces without rising humidity issues.
2. **Mixture of PU BINDER 1118 and RECYCLED RUBBER 858(minimum 6mm) - Elastic, shock-absorbent, wet-pour mixture.**
The **RECYCLED RUBBER 858** is in granulometry of 0.5-2mm. Applied by paver machine in thickness from 6mm up to 14mm or more.
3. **ELASTOTURF 851S - Acrylic, elastic, smooth, coating for sports floors systems.** Consists of acrylic resins, powder quartz sand and special improver. It is combined with **ISOPOL 854** as substrate to create multi-purpose sports flooring systems. Highly resistant to adverse weather conditions (snow, frost, heat waves etc.) after drying. Applied by squeegee in three layers at least.
4. **POLYSPORT 952 - Polyurethane, aliphatic, two-component top coating for indoor sport floorings.**
Applied, in two crossing layers by airless sprayer or short haired mohair roller.

Preparation – Application

Applied only on dry waterproof concrete surfaces (over 40 days old from date of placement) without rising humidity issues and free of materials that might prevent bonding e.g. dust, loose particles, grease etc. The success in the application depends on the right preparation of the underlay and use of the material.

- **Good, dry** cleaning of the surface from dust and residues with vacuum cleaner and squeegees.
- Priming of the surface with **PU PRIMER 870** for the proper adhesion on the sub-floor. Application of two or more layers in sections each time, right before the application of the next material, in order to ensure proper adhesion, until the surface is saturated. Avoid the creation of puddles of the material. Consumption: 200-300gr/m² in two layers, depending on the absorption of the underlay.

- When the primer begins to dry (approximately 1 hour depending on the ambient temperature), follows the application of wet-pour shock-absorbent mixture by paver machine in the desired thickness or even by hand if the applicator is very experienced, with a straightedge and a flat trowel, using also a cylinder for final compacting. **The wet-pour shock-absorbent mixture consists of SBR granules in 0.5-2.0 mm granulometry and PU binder.** It is strongly recommended the application of the mixture during night hours in the Middle East countries during summer months.
- As soon as the mixture dries (48-72 hours depending on the ambient temperature), follows the application of **ELASTOTURF 851S in at least 3 crossing layers.**
- Depending on the ambient temperature **ELASTOTURF 851S** is diluted with 5-6% up to 10% water, prior to application, in order to achieve better fluidity. It is applied in three or more coatings by squeegee, depending on the desired thickness. The next layer follows the other after the previous starts to dry (approximately 24 hours depending on the ambient temperature), Consumption: 3,5-3,8 kg/m² (3 layers).
- The next day, depending ambient temperature follows application of finishing paint **POLYSPORT 952** in 2 crossing layers by a short-haired mohair roller or even better by airless sprayer. Consumption: 0,35 kg per square meter in 2 layers.

Important Remarks

- ✓ During temperatures over 40 degrees, ideal time for the application of **WET-POUR POLYFLEX AEL-IN SYSTEM** is between 22:00 and 09:00 and the minimum bearing temperature during application and drying should be over 10°C.
- ✓ In case the second layer of PU top coat is applied after more than 24 hours of the application of the first one then the whole surface must be sanded by a special sanding machine. After that the second layer can be applied.
- ✓ The freshly coated surface should be protected from high temperatures, wind, rain and frost for at least the first 24 hours.
- ✓ In case it gets damaged, it is simply repaired and recoated on the spot.

Substrate

Asphalt is the safer subfloor for sport floorings for sure and must be always preferred than concrete surfaces.

A. Asphalt Substrate

The asphalt must have a slope of 0.7-1% and must dry for at least 30 days so that all solvents from the asphalt can evaporate.

The asphalt sub-floor should be applied on well compacted 150mm road base sub-floor and asphalt should be laid in one layer (and not 2) in 6 to 8cm with fine and coarse aggregates (up to 15mm granulometry) like the kind of asphalt used in road construction.

So, new road-grade asphalt will have to be laid (minimum 60mm) in one layer containing coarse aggregates and then mature for 30 days at least, before any application takes place on top of the asphalt to avoid bubbles on the final layer of the sport or rubber floorings.

Asphalt Infrastructure

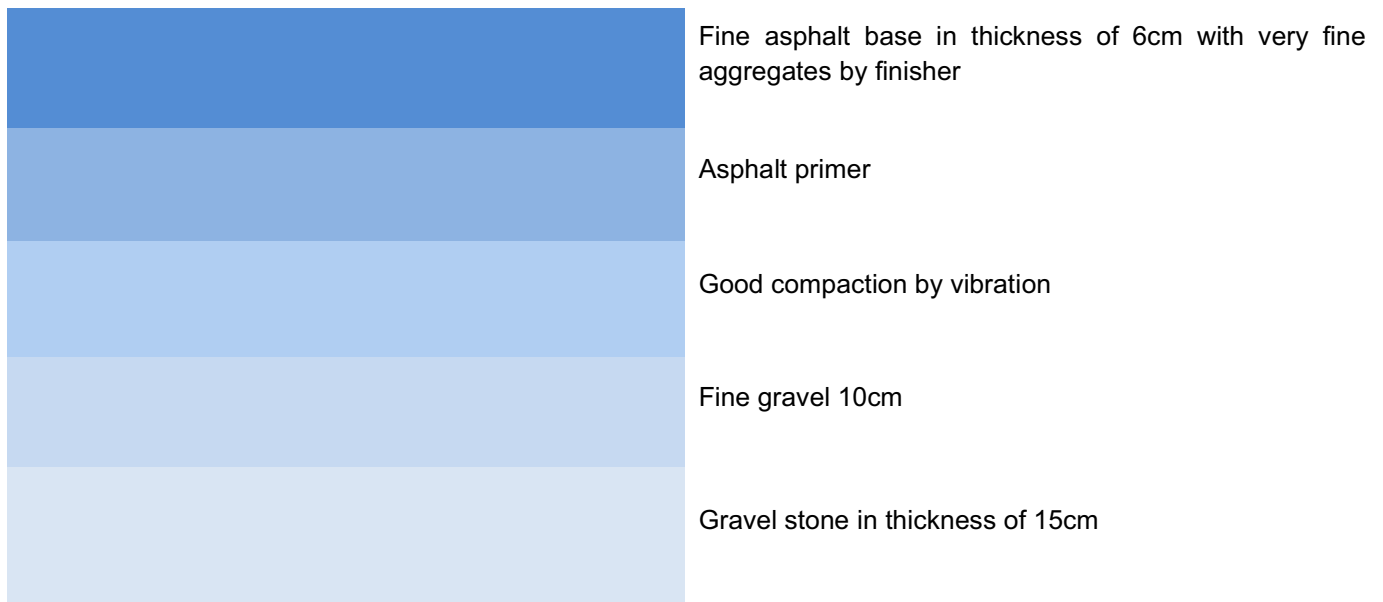

B. CONCRETE SURFACES

Concrete surface must be power-trowelled without cracks and must be smooth with a slope of 0.7-1% and humidity under 4% in 10cm depth of concrete.

Concrete must also be **dry at least for 40 days** and then the application takes place if there is no rising humidity for the sub-floor. Before the application takes place, there must be proper grinding of the surface by a grinding machine to open the pores accordingly and also a measurement by special instrument to measure humidity on the surface and in 10cm under the surface.

Generally concrete is a risky sub-floor and there may be problems with rising humidity, especially in areas where the sea level is really high and when the sea is close or in areas near greenery.

Always make expansion joints in large areas of concrete, in order to avoid uncontrollable cracks and failures. Joints should be every 25 square meters creating a grid of 5x5 meters or close to that.

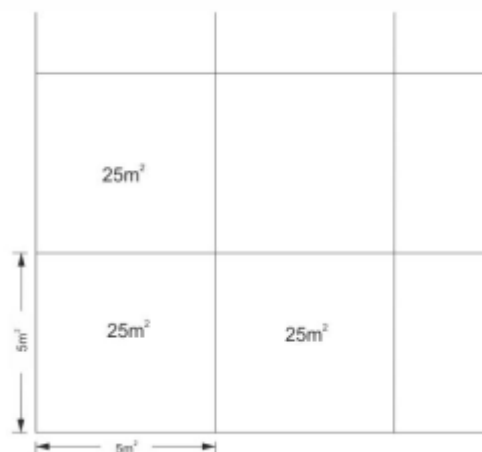

Substrate requirements

Concrete quality	at least C20/25
Age:	at least 40 days
Moisture content:	below 4%

Tools:

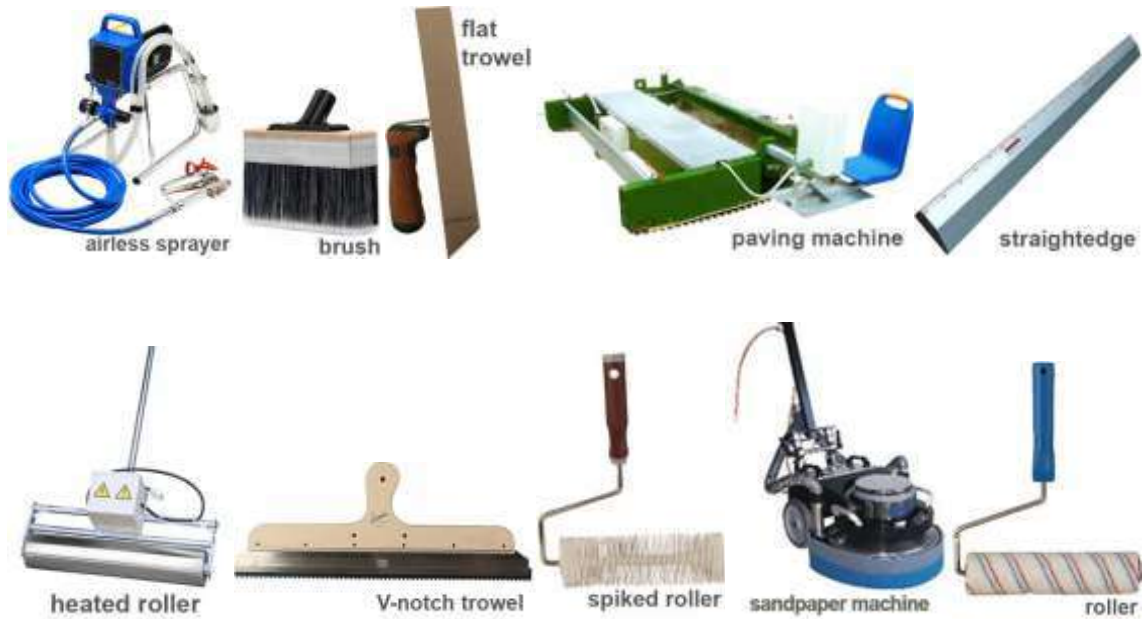



The colors may vary slightly from the original due to digital representation.



The colors may vary slightly from the original due to digital representation.

PHOTOGRAPHS OF PROJECTS



PU PRIMER 870

TRANSPARENT, ONE COMPONENT, POLYURETHANE -BASED PRIMER, USED AS AN ADHESIVE COMPONENT BETWEEN SUBFLOOR AND SPORTS SYSTEMS

GENERAL CHARACTERISTICS

POLYURETHANE PRIMER 870 is a clear, polyurethane-based, one-component primer, which is used as an adhesive component between the sub-floor and sport systems.

- ✓ Penetrates in depth.
- ✓ Ideal for old and new surfaces.

TECHNICAL DATA

Basis:	one-component polyurethane
Appearance:	liquid
Color:	transparent
Viscosity:	100 – 500 mPa•s at 25°C
Density:	0.9- 1.0 Kg/Lt
Temperature for the application and drying of the material:	10 – 40°C

PREPARATION-APPLICATION

Applied on dry surfaces without rising humidity issues, free of materials that might prevent bonding e.g. dust, loose particles, grease etc (in case of asphalt or concrete). The success in the application depends on the right preparation of the underlay and use of the material.

- **Good, dry** cleaning of the surface from dust and residues.
- Priming of the surface with **PU PRIMER 870** applied by airless sprayer equipment or brush or roller. The base layer (wet-pour mixture of SBR and **PU BINDER 1118**) should be constructed while **PU PRIMER 870** is still a bit sticky. Curing takes place at ambient temperature by evaporation of the solvent and reaction with atmospheric moisture. High temperatures and moisture will shorten the curing time. **PU PRIMER 870** is applied in two or more layers as a thin film, and on the final layer, the wet-pour mixture of SBR and **PU BINDER 1118** can be applied on the still sticky surface.
- The temperature should not fall below 10° C during curing.
- Opened drums should be used up quickly.
- The layer (wet-pour mixture of SBR and **PU BINDER 1118**) should be constructed while the final layer of **PU PRIMER 870** is still sticky.
- **NOTE: Rain will cause the primer to lose its function! If the primer was affected by rain, the base layer should not be constructed! Instead, the sub floor has to dry and the primer application has to be repeated.**

CONSUMPTION

200-300 gr/m² depending on the type and the absorbency of the underlay.

APPLICATION TOOLS

Brush, roller or airless sprayer. Tools should be cleaned with a PU solvent immediately after use.



PACKAGING

Drums / Barrels.



STORAGE

One year in unopened containers in cool and dry places, out of sunlight, with minimum temperature 5°C and maximum temperature 30°C.

REMARKS

- Working time of **POLYURETHANE PRIMER 870** decreases when ambient temperature rises.
- Prolonged storage of partially used containers containing **POLYURETHANE PRIMER 870** must be avoided as contact with atmospheric moisture will result in skinning and clouding of the product.

CAUTION

The application must take place in well-aired places using protective gloves. Skin or eye contact must be avoided, otherwise wash carefully with soap and water.

For more information consult the safety data sheet.

The information given here is true, represents our best knowledge and is based not only on laboratory work, but also on field experience. However, because of numerous factors affecting results we offer this information without any guarantee and no patent liability is assumed. For additional information or questions, contact the technical department of KDF LTD.

PU BINDER 1118

POLYURETHANE BINDER

GENERAL CHARACTERISTICS

100% solids, aromatic, polyisocyanate-prepolymer, moisture-curing binder based on diphenylmethane diisocyanate. It is MDI based and solvent free and has low viscosity. It exhibits excellent adhesion to all rubber granules and gives a strong performance both in terms of tensile strength and durability.

It is mixed with **RECYCLED RUBBER 858** or **EPDM granules** for the creation of the elastic safety flooring **SAFEPOL MULTICOLOR** or other flexible rubber floorings, ideal for playgrounds, athletic tracks, schools etc. Combines and bonds RIM components, polyurethane granules and sponge particles. Also it can be used as lining for insulation and for pasting.

TECHNICAL DATA

Density of mixture (25°C)	1.08 – 1.18 Kg/Lt
Viscosity (25°C)	4.000 - 8.000 mPa.s
Pot-life (25°C)	30-75 min.
Application temperature	Min 10°C
Curing (25°C and %60 relative humidity)	After 24 hours it cures

PREPARATION-APPLICATION

Applied on dry surfaces without rising humidity issues, free of materials that might prevent bonding e.g. dust, loose particles, grease etc (in case of asphalt or concrete). The success in the application depends on the right preparation of the underlay and use of the material.

Good, dry cleaning of the surface from dust and residues using vacuum cleaner and squeegees.

Can be used for kids playground, running tracks, sports grounds, walkways and offices.

Moulded in production: Rubber granules and binder are thoroughly mixed, taken into moulds, and then pressure is applied. 160 bar pressure, mold temperature of 130 degree gives reasonable results in 12 - 15 minutes. In molding applications, binder content should not fall below 5%.

On-site applications: **Applied on dry surfaces, free of materials that might prevent bonding e.g. dust, loose particles etc (in case of asphalt or concrete).** The success in the application depends on the right preparation of the underlay and use of the material.

- **Good, dry** cleaning of the surface from dust and residues.
- Priming of the surface with the special **POLYURETHANE PRIMER 870** in two layers.
- Good mixing of the **PU BINDER 1118** and the **RECYCLED RUBBER 858**. Mixing should be performed using a low revolution mixer (300-600 rpm) for 1-2 min. Stirring of the mixture should be performed thoroughly near the sides and bottom of the container in order to achieve homogeneity.
- Following, the mixture is poured on the surface and spread on the desired thickness using paving machine or by hand, if the applicator is experienced, with rake for spreading, (wooden) straightedge for initial smoothing, flat metal trowel for final smoothing and compacting, cylinder weighing 8-15kg for final compacting-(cylinder should be cleaned repeatedly with diesel to remove stuck granules from its surface).

-
- The application procedure for **SAFEPOL MULTICOLOR (PU BINDER 1118 and EPDM 856 mixture)** on top of asphalt or waterproof concrete directly is the same as for **SAFEPOL MIXTURE** (the mixture of **PU BINDER 1118** and **RECYCLED RUBBER 858**).
-

RATIO MIXTURE

- 18% **PU BINDER 1118** and 82% **RECYCLED RUBBER 858**, for sports flooring.
 - 14% **PU BINDER 1118** and 86% **RECYCLED RUBBER 858**, for playground flooring.
 - 20% **PU BINDER 1118** and 80% **RECYCLED RUBBER 858** for **SAFEPOL COLOURANT**.
 - 17% **PU BINDER 1118** and 83% **EPDM 856**.
-

APPLICATION TOOLS

For the mixture **PU BINDER 1118** and **RECYCLED RUBBER 858** or: paver machine or rake, straightedge, flat metal trowel, cylinder weighing 8-15kg



PACKAGING

220kg in barrels.



STORAGE

12 months in unopened containers in cool and dry places, out of sunlight, with minimum temperature 5°C and maximum temperature 30°C.

REMARKS

- Concrete humidity should not be above 4%, ambient humidity should be at least 40% and most 80%. To begin the application, must wait for the appropriate humidity.
 - Working time of **PU BINDER 1118** decreases when ambient temperature rises.
 - Prolonged storage of partially used containers containing **PU BINDER 1118** must be avoided as contact with atmospheric moisture will result in skinning and clouding of the product.
-

CAUTION

The application must take place in well-aired places using protective gloves. Skin or eye contact must be avoided, otherwise wash carefully with soap and water.

For more information consult the material safety data sheet.

The information given here is true, represents our best knowledge and is based not only on laboratory work, but also on field experience. However, because of numerous factors affecting results we offer this information without any guarantee and no patent liability is assumed. For additional information or questions, contact the technical department of KDF LTD.

SBR RUBBER GRANULES 858

GENERAL CHARACTERISTICS

It can be used in sports facilities as infill in synthetic grass with the parallel use of round sand and also as one of the components in case of cast applied wet-pour systems for playground floorings or as shock-pad for sport subfloors in athletic tracks and sports fields.

Rubber granule is derived from car and truck tires. During processing, the tires are mechanically granulated, removing all metal and synthetic fibers, as well as any other foreign part contained in there with specially designed sieves, so as to produce a 99.99% clear rubber with high quality.

PROPERTIES

- 100% recyclable
- Long life
- Resistance to adverse weather conditions
- High shock absorbency and vibration damping
- High abrasion resistance

PREPARATION-APPLICATION

In sports facilities and playgrounds to ensure flexibility of surface and vibration absorption.

TECHNICAL CHARACTERISTICS

Granulometry 1-3mm

DENSITY:	0.48kg/cm ³
SPECIFIC GRAVITY	1.20+/-0.05 (Water = 1.0)
HARDNESS	60
HUMIDITY(%)	<0.65
ELASTICITY	100% - No change
RESISTANCE	113N/cm - Excellent

PACKAGING

Packaging is available in big-bags -1 ton in following sizes:

Grain size	0,5-1,5 mm
Grain size	0,5-2,5 mm
Grain size	0.5-4.0 mm
Grain size	2-8 mm
Grain size	8-20 mm
Grain size	80-50 mm
Grain size	80-120 mm



The information given here is true, represents our best knowledge and is based not only on laboratory work, but also on field experience. However, because of numerous factors affecting results we offer this information without any guarantee and no patent liability is assumed. For additional information or questions, contact the technical department of KDF LTD.

ELASTOTURF 851S - SMOOTH

SPECIAL, ELASTIC, SMOOTH COATING FOR INTERNAL SPORT COURTS

GENERAL CHARACTERISTICS

ELASTOTURF 851S is acrylic-based, elastic, smooth colored coating for internal sport courts.

Is combined with prefabricated shock- pad roll in thickness of 4mm to 14 mm or a wet-pour mixture of **SBR granunles** (0.5 – 2.0 mm granulometry) **plus PU BINDER** in order to seal the pores and plasticize the floor.

- Ideal for multipurpose courts, basketball, volleyball, handball, football and tennis internal courts. Suitable for sports centers, schools, fitness centers, hallways.
- Applied easily, having low cost.
- Provides a safe, high quality game.

TECHNICAL DATA

Basis:	one-component acrylic resin
Appearance:	viscous liquid
Colors:	available in 24 colors form KDF colorchart
Temperature for the application and drying of the material:	10 – 40 °C
Viscosity:	10.000 – 20.000 mPa•s at 25°C
Density	1.47 – 1.57 Kg/Lt
Walkability:	after 24 hours at 25°C
Total Hardening:	5 days at 25°C

PREPARATION-APPLICATION

Applied only on dry surfaces, without rising humidity issues and free of materials that might prevent bonding e.g. dust, loose particles, grease etc. The success in the application depends on the right preparation of the underlay and use of the material.

- **Good, dry** cleaning of the surface from dust and residues with vacuum cleaner and squeegees.
- Application of the material (in three or more layers) on prefabricated shock-absorbent rolls in thickness of 4mm to 14mm or on wet-pour made from the mixture of **RECYCLED RUBBER 858 (0.5 -2.0 mm granulometry)** and **PU BINDER 1118** (in three or more layers), for sealing the pores of the underlay and plasticize the surface.
- Depending on the ambient temperature, **ELASTOTURF 851S** is diluted with 5-6% up to 10% water, prior to application, in order to achieve better fluidity. The next layer is applied after the previous starts to dry.
- Before the application of the second layer and after the application of the final layer (before applying **TOP COAT POLYSPORT 952**), always use a sanding machine.
- The next day, depending on the ambient temperature follows the application of **TOP COAT POLYSPORT 952** in 2 crossing layers by a short-haired mohair roller or even better by airless sprayer.

CONSUMPTION

- 1.5 – 1.6 kg/m² (three layers on shock-pad)
- 3.5 – 3.8 kg/m² depending on the SBR granulometry (three layers on wet-pour shock-pad)

APPLICATION TOOLS

Squeegee (width 55cm). Tools should be cleaned with **WATER** immediately after use.



PACKAGING

Supplied in barrels of 200 Kg.



STORAGE

12 months in unopened containers in dry places with minimum temperature 5°C and high temperature 30°C (avoid sunlight).

REMARKS

- During temperatures over 40 C, ideal time for the application of **ELASTOTURF 851S** is between 22:00-9:00 a.m. and the minimum bearing temperature during application and drying should be 10 C.
- The freshly coated surface should be protected from high temperatures and frost for at least the first 24 hours.
- In case it gets damaged, it is simply repaired and recoated on the spot.

CAUTION

The application must take place in well-aired places using protective gloves. Skin or eye contact must be avoided, otherwise wash carefully with soap and water.

For more information consult the safety data sheet.

The information given here is true, represents our best knowledge and is based not only on laboratory work, but also on field experience. However, because of numerous factors affecting results we offer this information without any guarantee and no patent liability is assumed. For additional information or questions, contact the technical department of KDF LTD.

POLYSPORT 952-SEMIMAT

POLYURETHANE-BASED, TWO-COMPONENT, SEMIMAT, FINISH ALIPHATIC COATING

GENERAL CHARACTERISTICS

POLYSPORT 952-SEMIMAT is a polyurethane, two-component, solvent-based, with semi-mat, finish aliphatic coating for indoor sports surfaces.

- It is applied on polyurethane, self-leveling coating **POLYSPORT PU 951** as a final, sealing layer of a multilayer polyurethane floor especially designed for sport halls such as tennis, basketball, handball, volleyball and multipurpose halls.
- Applies easily with short-haired mohair roller and airless sprayer.
- Provides a surface with anti-slip properties.

TECHNICAL DATA

Basis:	two-component polyurethane paint
Appearance:	liquid
Colors:	KDF colorchart
Viscosity(25°C):	800-2.500 mPas
Density(25°C):	1.30-1.40 kg/l
Mixing proportion (A:B):	85:15 by weight
Temperature for the application and drying of the material:	15 – 40°C

PREPARATION-APPLICATION

Applied on dry surfaces without rising humidity issues, free of materials that might prevent bonding e.g. dust, loose particles, grease etc (in case of asphalt or concrete). The success in the application depends on the right preparation of the underlay and use of the material.

- **Good, dry** cleaning of the surface from dust and residues using vacuum cleaner and squeegee.
- Caution must be taken so that temperature of the support surface as well as ambient air remains above 15°C during application and curing of the materials while relative humidity does not exceed 75%.
- Application of prefabricated sub-floor **ISOPOL 854** using **PU FLEX 140** or wet-pour rubber cushion mix of SBR rubber and **PU BINDER 1118**.
- Sealing of surface porosity of **ISOPOL 854** or the wet-pour rubber cushion mix of SBR rubber and **PU BINDER 1118** using elastic pore sealer **POLYSPORT STUCCO 950** and application of self-leveling coating **POLYSPORT PU 951**.
- The next day, depending on the ambient temperature follows the application of **POLYSPORT 952-SEMIMAT** in two crossed layers. The second layer is applied after the first layer has dried (within 24h). Components A & B (hardener) packed into separate containers in fixed weight proportions are mixed together using a low revolution mixer (300-600 rpm) for 1-2 min. Stirring of the mixture should be performed thoroughly near the sides and bottom of the container in order to achieve uniform dispersion of the hardener.
- The application is done by airless sprayer or short-haired mohair roller in 2 crossing layers.

CONSUMPTION

App.200-250 gr/m², for two layers.

APPLICATION TOOLS

Short-haired mohair roller or airless sprayer. Tools should be cleaned with **PU SOLVENT** immediately after use.



PACKAGING

Supplied in set of 20 Kg (two drums).



STORAGE

12 months in unopened containers in dry places with minimum temperature 5°C and maximum temperature 30°C (avoid sunlight).

REMARKS

- In case the layer of PU top coat is applied after more than 24 hours of the application of the last layer of PU pore filler then the whole surface must be sanded by a special sanding machine. After that the PU top coat can be applied.
- In case the second layer of PU top coat is applied after more than 24 hours of the application of the first one then the whole surface must be sanded by a special sanding machine. After that the second layer can be applied.
- Working time of **POLYSPORT 952-SEMIMAT** decreases when ambient temperature rises.
- Prolonged storage of partially used containers containing **POLYSPORT 952-SEMIMAT** must be avoided as contact with atmospheric moisture will result in skinning and clouding of the product.
- All surfaces should be thoroughly cleaned from dust and residues prior each application.
- After hardening **POLYSPORT 952-SEMIMAT** is completely safe for health.

CAUTION

The application must take place in well-aired places using protective gloves. Skin or eye contact must be avoided, otherwise wash carefully with soap and water.

For more information consult the safety data sheet.

The information given here is true, represents our best knowledge and is based not only on laboratory work, but also on field experience. However, because of numerous factors affecting results we offer this information without any guarantee and no patent liability is assumed. For additional information or questions, contact the technical department of KDF LTD.

CLEANING AND MAINTENANCE MANUAL FOR :

-INDOOR SYSTEMS

Introduction

Indoor sports surfaces are made of extremely durable polymers, designed to withstand intense use. However for the best maintenance of the rubber and sport surface a regular check (once in 6 months) is required and maintenance of the surface is necessary to preserve the suitability of the surface.

The installer's guarantee will usually be conditional on the recommended maintenance requirements being carried out with due diligence.

Maintenance

Maintenance procedures are necessary to preserve the lifetime of the surface and to ensure that:

- The Surface is kept clean.
- The Surface is safe for intense diverse use and all types of users.
- The facility looks attractive.

These objectives are achieved by:

- Sweeping/scraping/removing debris and foreign matter from the surface.
- Regularly washing the surface to remove contaminants such as any kind of food, small stones, drinks or any other particle that can create scratches or damage.

Maintenance Equipment

Meticulous (mechanical) cleaning, occasional washing and dirt/foreign matter removing are the basic maintenance measures, apart from making sure that no damage occurs due to unforeseen reasons.

A mechanical vacuum cleaner is ideal for removing foreign matter and dirt. Restricted areas may have to be cleaned by hand.

The equipment should be well maintained and carefully operated to avoid contamination of, or physical damage to, the surface. Spillage of fuel or lubricating oil will damage the surface.

The pressure loading on the surface as well as the friction and shearing loads have to be kept to a minimum to prevent damage to the surface. Large pneumatic tires and soft brushes along with careful operating of the machinery, is recommended to avoid any damage on the surface.

Note that no aggressive chemical cleaning agents (chlorine or acid-based) should be used; normal neutral market detergents are adequate.

Prevention of damages

To ensure maintaining the surfaces to a high standard, restrictions should be imposed on the use of the surface.

- No chemicals, oils, fuel or solvents or many kind of drink and food should be allowed on the surface.
- No fireworks or cigarettes or high heels or inadequate shoes should be allowed on the synthetic surface .

Damages and renovation

The lifetime of an indoor sports surface depends on its quality, usage and level of maintenance. In general a normal indoor sports surface used intensively will last 8 to 10 years (depending on the system) before renovation is required. Renovation should be carried out periodically to prevent the total damage of the surface, which would necessitate complete renewal.

Renovation must be carried out by professional and skilled contractors with thorough knowledge of this type of work

There are different procedures for the renovation of a surface:

- Complete renewal by replacing the worn-out surface with a new sports flooring system.
- Re-topping or sealing with adequate polyurethane or acrylic materials. In general, one could refresh the indoor sports floor by applying couple of additional layers of PU top coat after 10-12 years.
- Partial re-topping in particular worn-out areas.

Information contained in this document is of general nature and is given in good faith. As the state of the surface and the use and application of the various cleaning products, is out of our control, our advice for individual cases, verbal, written or based on tests, does not exempt the applicator from the testing the suitability of the cleaning products and their applications.

The above maintenance guide refers to the below KDF systems:

-SYSTEM POLYFLEX PU-IN

-SYSTEM POLYFLEX PU-IN WET-POUR

-SYSTEM POLYFLEX AEL-IN

-SYSTEM POLYFLEX AEL-IN WET-POUR

INDICATIVE REFERENCE LIST OF PROJECTS

- RIYADH CITY NORTH PHASE 7A - ABHU DHABI, U.A.E - 80000m² Bicycle track, Sportground-Ex system
- RIYADH CITY NORTH PHASE 7B - ABHU DHABI, U.A.E - 60000m² Bicycle track, Sportground-Ex system
- CONSTRUCTION OF HARD LANDSCAPING - U.A.E - 60000m² Bicycle track, Sportground-Ex system
- RIYADH CITY SOUTH PHASE 1 - ABHU DHABI, U.A.E - 42000m² Bicycle track, Sportground-Ex system
- 12 SCHOOLS IN U.A.E, MINISTRY OF EDUCATION(THROUGH VARIOUS CONTRACTORS) - 40000m² EPDM Rubber flooring
- MULTIPLE RUNNING TRACKS - ALGERIA - 40000 m² - Running track, POLTRACK SPRAYCOAT system
- AL ESKAN RUNNING TRACK - BURAIDAH, K.S.A -25000m² -Running track, POLTRACK SPRAYCOAT system
- UNIVERSITY OF DAMMAM - KSA - 13000m² - Acrylic cushion floorings
- KING ABDULLAH BASE AIR DEFENSE - TAIF, KSA - 12600 m² - Running track
- KING FAHD UNIVERSITY OF PETROLEUM AND MINERALS-DHARAN, KSA-12400m²-Rubber outdoor flooring
- ”KOSTAS KENTERIS” STADIUM & NATIONAL STADIUM OF MITILINI - MITILINI ISLA, GREECE - 12000m² - Running track, POLTRACK SANDWICH system
- RUNNING TRACK - K.S.A- 11000 m² - Running track, POLTRACK SANDWICH system
- GEMS SCHOOL - DUBAI, U.A.E - 10000 m² - Running track
- PASARGRAD WHOLESALE MARKET-IRAN - 10000 m² - Decorative flooring
- YAS ISLAND, ABU DHABI, U.A.E - 10000m² Bicycle track
- ANASTASIA KELESIDOU STADIUM/KONSTANTINOS KARAMANLIS - THESSALONIKI, GREECE - 10000m²
- Re-topping project, Running track, Sandwich system, Indoor & Outdoor running track
- KAFTANZOGLIO NATIONAL STADIUM OF THESSALONIKI - GREECE - 9000m², POLTRACK SANDWICH
- ABHA STADIUM - K.S.A - 9000m²- POLTRACK SANDWICH system
- ABU DHABI STADIUM - U.A.E - 9000m² - Artificial Grass, POLITURF LEADER 55140
- ALEXANDRIA STADIUM - ALEXANDRIA, EGYPT - 8500 m² - Running track
- SICHUAN INVESTMENT INTERNATIONAL TENNIS CENTER - CHENGDU CHINA - 8250 m² - SPORTFLOOR-EX HARD COURT
- MINISTRY OF EDUCATION IN KUWAIT - KUWAIT - 8000m² - Polyurethane flooring, Polyflex Pu-In system
- SALAM STREET & MINA ROAD, ABU DHABI, U.A.E - 8000m² Bicycle track, Sportground-Ex system
- KING FAHAD NAVAL BASE - JUBAIL, KSA - 8000m² - Running track
- MUNICIPALITY OF VELVENTO - KOZANI, GREECE - 8000m², Running track
- PRINCE FAISAL STADIUM IN RIYADH - K.S.A - 8000m², Running track, POLTRACK SANDWICH system
- ABBHA, KSA - 7600m² - Running track
- MUNICIPALITY OF ZENICA - ZENICA, BOSNIA & HERZEGOVINA - 7500m², Poltrack Spraycoat, Running track
- RUNNING TRACK - KAMIANETS, PODILSKYI, UKRAINE - 7400m², Poltrack Spraycoat
- NATIONAL STADIUM OF TRIKALA - TRIKALA, GREECE - 7000m² - Running track POLTRACK FULL PU
- TELUK BAYAR MINI OLYMPI STADIUM - INDONESIA - 7000m² - Running track, POLTRACK SANDWICH
- ADNOC SCHOOLS - U.A.E - 7000m² - Safepol system
- MAJLIS BANDARAYA PETALING JAYA STADIUM - MALAYSIA - 7000m² POLTRACK SANDWICH
- ATLAS CENTER-BAM, IRAN - 7000 m² - Decorative flooring
- RUNNING TRACK - SUDAN - 7000 m² - Running track, POLTRACK SPRAYCOAT system
- COLOMBIA RUNNING TRACK PROJECT - 6800 m² - POLTRACK SPRAYCOAT
- MUNICIPALITY STADIUM ANDROS ISLA, GREECE - 6700m²- POLTRACK SANDWICH RETTOPING SYSTEM
- RUNNING TRACK STADIUM - CRETE, GREECE - 6500 m² - Running track, POLTRACK SANDWICH system

-PLAYGROUND PROJECT - ABU DHABI, U.A.E - 6500 m², Safety flooring
-RUNNING TRACK STADIUM - DRAMA, GREECE - 6500 m² - Running track, POLTRACK SANDWICH system
-SAADIYAT ISLAND - ABHU DHABI, U.A.E - 6500m² Bicycle track, Sportground-Ex system
-RUNNING TRACK PROJECT IN MUSCAT, OMAN - 6400 m² - POLTRACK SANDWICH system
-KAVALA STADIUM - KAVALA, GREECE - 6300m²- 8-lane Running track, POLTRACK SANDWICH SYSTEM
-CHENGDU SPORT UNIVERSITY - CHENGU, CHINA - 6300 m² - Cushion system, FLEXFLOOR-EX
-CORNISH, JEDDAH, K.S.A - 6000m² Bicycle track Sportground-Ex system
-MUNICIPALITY STADIUM-MOLAOI, GREECE - 5800m²- POLTRACK SANDWICH SYSTEM
-MUNICIPALITY STADIUM SOFADES, GREECE - 5800m²- POLTRACK SANDWICH SYSTEM
-MUNICIPALITY STADIUM OF ALIARTOS - ALIARTOS, GREECE - 5700m²- POLTRACK SPRAYCOAT
-ARTIFICIAL GRASS PROJECT - ATHENS, GREECE - 5700m², Artificial grass
-PAPACHARALAMBIO STADIUM - NAFPAKTOS, GREECE - 5650m² - POLTRACK SANDWICH system
-AMITY INTERNATIONAL SCHOOL - ABHU DHABI, U.A.E - 5500m², Poltrack Spraycoat, Running Track
-MUNICIPALITY STADIUM LOUTRAKI, GREECE - 5500m²- POLTRACK SANDWICH SYSTEM
-SHUQAIQ WATER AND ELECTRICITY COMPANY - JIZAN, KSA - 5400 m² - acrylic courts
-TALEEM UPTOWN SCHOOLS - DUBAI, UAE - 5400m²-Acrylic sports courts systems
-ZAYED PORT - ABHU DHABI, U.A.E - 5400m² Bicycle track, Sportground-Ex system
-SAN FERNANDO DE HENARES - SPAIN - 5300m² - POLTRACK SANDWICH
-SAUDI AIR FORCE - KSA - 5250 m² - Acrylic coating elastoturf, running track
-OMAN WATERFRONT - OMAN - 5000 m² - COLORFLEX-EX
-SHIV NADER SCHOOL - FARIDABAD, INDIA - 5000 m² - Running track, POLTRACK SANDWICH system
-RUNNING TRACK - K.S.A - 5000 m² - Running track, POLTRACK SANDWICH system
-AL HAMRA, RAS AL KHAIMAH, U.A.E - 5000m² Bicycle track, Sportground-Ex system
-AIRBASE IN TAIF - KSA - 5000 m² - Running track
-AMERICAN SCHOOL AL BARSHA - DUBAI - 5000 m² - Running track, POLTRACK SPRAYCOAT system
-MUNICIPALITY STADIUM AMFISSA, GREECE - 5000m²- POLTRACK SANDWICH SYSTEM
-NATIONAL STADIUM OF KALAMPAKA -KALAMPAKA, GREECE-4900m²-POLTRACK SEALED SPRAYCOAT
-MONTORNES DE VALLES - BARCELONA, SPAIN - 4900m² - POLTRACK SPRAYCOAT
-THAILAND STADIUM - 4800 m² - Running track, POLTRACK SANDWICH system
-UMM GHAFAH CYCLE TRACK - AL AIN, U.A.E - 4700m² Bicycle track, Sportground-Ex system
-LYCEE FRANCAIS INTERNATIONAL THEODORE MONOD - SADIYAT, ABU DHABI, U.A.E - 4650 m² - Art. Grass POLITURF LEADER 55140
-BIG SQUARE & LRT STREET, MASDAR CITY - ABHU DHABI, U.A.E - 4600m² Bicycle track, Sportground-Ex
-DEPARTMENT OF EDUCATION ASIR REGION - KHAMIS, KSA - 4500 m² - Running track
-SERVIA STADIUM - KOZANI, GREECE - 4500m², Running track
-STADIUM OF ISLAMIC CITY OF BAWATH IN AL-AZHAR - EGYPT - 4500m²- POLTRACK SANDWICH
-MUNICIPALITY STADIUM OF SOFADES - GREECE - 4500m²- POLTRACK SANDWICH SYSTEM
-BURGUILLOS STADIUM IN SEVILLA - SPAIN - 4400 m² - Running track, POLTRACK SPRAYCOAT system
-”POSIDONIO” NATIONAL ATHLETIC CENTER - THESSALONIKI, GREECE - 4300m²- Acrylic certified flooring
-MUNICIPALITY STADIUM OF MESSINI - GREECE - 4300m²- Running track, POLTRACK SANDWICH SYSTEM
-MUNICIPAL SPORTS CENTER VELOU-VOHA - PELOPONNISOS, GREECE - 4300m²- POLTRACK SANDWICH
-COMMUNITY COLLEGE - KHAMIS, KSA - 4200 m² - Running track
-FAYOUM INIVERSITY - EGYPT - 4200m² - Polyurethane sports flooring, POLYFLEX PU System
-POLIDEPORTIVO UNIVERSIDAD ALCALA DE HENARES-MADRID,SPAIN-4000m²-POLTRACK SPRAYCOAT

-SPORTS CLUB CENTER GLIFADA - ATHENS, GREECE - 4000m²- Poltrack Spraycoat, Running Track
-EMIRATES INTERNATIONAL SCHOOL - DUBAI, U.A.E - 4000m² - Safepol System, Playground flooring
-YAS NORTH EMMARATHI COMMUNITY - ABHU DHABI, U.A.E - 4000m² Bicycle track, Sportground-Ex system
-RUNNING TRACK PROJECT IN QATAR - 4000m², Poltrack Spraycoat system
-RUNNING TRACK PROJECT IN SAMOS - GREECE - 4000m², Poltrack Spraycoat system
-RECONSTRUCTION OF MOROCOCHA STADIUM - PERU - 3850m² - Running track, POLTRACK SANDWICH
-HH KHALID BIN BANDAR - RIYADH, KSA - 3800 m² - Volleyball/basketball rubber courts
-SPORTS FLOORING COMPLEX - ISRAEL - 3700 m², Acrylic sports flooring, SPORTFLOOR-EX system
-MUNICIPALITY STADIUM OF AGIA PARASKEVI, GREECE - 3700m²- POLTRACK SANDWICH SYSTEM
-MUNICIPALITY STADIUM OF HALKIDA - EUBOEA, GREECE - 3700m²- POLTRACK SANDWICH SYSTEM
-RUNNING TRACK- UKRAINE - 3600m² - RunningTrack, Poltrack Spraycoat system
-ANATOLIA GOLLEGE - THESSALONIKI, GREECE - 3600m², Running track
-AIMARJAN ASLAND – PARTIAL - 3600m²- Poltrack Sandwich, Running Track
-RUNNING TRACK - ISRAEL - 3500m² - Running track, POLTRACK SANDWICH system
-KING ABDULLAH UNIVERSITY TECHNOLOGY - K.S.A - 3500m² - Running track, POLTRACK SANDWICH system
-RUNNING TRACK PROJECT - EGYPT - 3500m² - Running track, POLTRACK SPRAYCOAT system
-BICYCLE TRACK PROJECT - GREECE - 3500m²- Acrylic sports flooring, SPORTGROUND-EX system
-MUNICIPALITY OF ALIMOS - ATHENS, GREECE - 3500m²- Acrylic sports flooring, SPORTFLOOR FAST
-MUNICIPALITY STADIUM OF HOLARGOS, ATHENS- GREECE - 3500m²- POLTRACK SANDWICH SYSTEM
-MATRIX SPORTING CLUB - EGYPT - 3400m² - Polyurethane outdoor flooring, Polyflex PU-EX System
-RUNNING TRACK PROJECT - EGYPT - 3400m² - Running track, POLTRACK SPRAYCOAT system
-SPORTS CLUB CENTER KISSAMOS - CRETE, GREECE - 3200m²- Poltrack Sandwich, Running Track
-AL LUSAIL SPORTS CLUB - DOHA, QATAR - 3200m² - Jogging track
-SPORTS CLUB CENTER - SERBIA, GREECE - 3200m² - Poltrack Sandwich, Running Track
-STADIUM CENTER - UKRAINE - 3200m² - RunningTrack, Poltrack Spraycoat system
-KING KHALID UNIVERSITY - ABHA, KSA - 3100 m² - Running track
-MUNICIPALITY STADIUM KRESTENA - GREECE - 3100m²- Poltrack Sandwich, Running Track
-ISLAMIC WORLD GARDEN - SHARJA, U.A.E - 3000m²- Safety flooring, SAFEPOL MULTICOLOR system
-AL FAIOUM UNIVERSITY - FAIOUM, EGYPT - 3000m²- Polyurethane indoor flooring, Polyflex PU-IN system
-RUNNING TRACK PROJECT - VELVEDOS MUNICIPALITY, GREECE - 3000m²- POLTRACK SANDWICH
-WADY DEGLA OCTOBER CLUB - CAIRO, EGYPT - 3000m²- Acrylic sports courts
-SPORTS CLUB CENTER “PAPAGOU”- ATHENS, GREECE - 3000m²- Poltrack Sandwich, Running Track
-PANORAMA SPORTS COMPLEX - THESSALONIKI, GREECE - 3000m², Running track
-PLAYGROUND FLOORING PROJECT IN NORTHERN GREECE - KILKIS, GREECE - 3000m²- SAFEPOL
-TENNIS HALL OF THE DEYANG OLYNPIC SPORTA CENTER - DEYANG, CHINA - 3000 m² - SPORTFLOOR-EX
-BENHA SPORTS CITY - EGYPT - 3000m²- Acrylic sports courts
-SPORTS COMPLEX IN UKRAINE - 3000m² - Safety flooring, SAFEPOL MULTICOLOR system
-CHENAO TENNIS HALL OF THE CHONGGING OLYMPIC SPORTS CENTER - CHONGGING, CHINA - 3000 m² -
SPORTFLOOR-EX
-JOGGING TRACK AT WATERFONT - K.S.A - 3000m² - POLTRACK JOGGING TRACK
-PLAYGROUND FLOORING IN SHARJA - U.A.E - 3000m² - Playground flooring, SAFEPOL MULTICOLOR
-SPORTS FLOORING PROJECT IN YEMEN - 3000m²- Acrylic sports courts, SPORTFLOOR-EX
-SPORTS SCHOOL PROJECT - ARTA, GREECE - 3000m²- Acrylic sports courts, POLYFLEX AEL-EX
-ALIMOS STADIUM - ALIMOS, GREECE - 2850m² - Running track, POLTRACK SANDWICH

-INDIAN ARMY - SAGAR, INDIA - 2800m²- Acrylic sports courts
-COLEGIO INTERNACIONAL DE LA SERENA - CHILE - 2800 m² - Running track, POLTRACK SANDWICH system
-ALL SAINTS SCHOOL - MUMBAI, INDIA - 2700 m² - PU outdoor sports flooring and running track
-INDIAN INSTITUTE OF SCIENCE EDUCATION AND RESEARCH-BHOPAL,INDIA-2700m²-Acrylic sports courts
-RESORT IN RED SEA - EGYPT - 2700m²- Acrylic sports courts, FLEXFLOOR-EX system
-OUR OWN GOLF SCHOOL - 2700m²- Poltrack Spraycoat, RunningTrack
-BAILE FIGA, BISTRITA NASAUD - ROMANIA - 2700m² - Safety flooring, SAFEPOL MULTICOLOR system
-STADIUM STUDENTSKA, SPORTS COMPLEX - BARNNA, BOULGARIA - 2700m² - SPORTFLOOR-EX system
-OUTDOOR SPORTS VENUE - VARNA, BULGARIA - 2700 m² - Acrylic, ITF classified, 8 layers system
-RAKS PALLIKOODAM SCHOOL - INDIA - 2600m² - Acrylic sports courts, FLEXFLOOR-EX system
-DPS GUNTUR SITE, NEW DELHI INDIA - 2600m² - Acrylic sports courts, SPORTFLOOR-EX system
-MUNICIPAL STADIUM OF PREVEZA - GREECE - 2600m² - Running track, POLTRACK SANDWICH
-HIGH SCHOOL COMPLEX - ATTIKA DISTRICT - 2500m² - Acrylic sports courts, SPORTFLOOR FAST system
-KURNISH AL KHOBAR - K.S.A - 2500m² - Rubber flooring, COLORFLEX system
-AL RAYAN, QATAR - 2500 m² - Running track, POLTRACK SANDWICH system
-MUNICIPALITY PARK OF TRIKALA - GREECE - 2500 m² - Running track, POLTRACK FULL-PU
-ALHOSN SPORTS COMPLEX - 2400 m² - Running track, POLTRACK SANDWICH system
-PROJECT BELICA - CROATIA - 2300 m² - Running track, POLTRACK SPRAYCOAT system
-MUNICIPAL SPORTS CENTER PAVLOU MELA - THESSALONIKI, GREECE - 2300 m² - SPORTFLOOR-EX
-MUNICIPALITY STADIUM OF DOXATO - GREECE - 2300m²- POLTRACK SANDWICH SYSTEM
-TORRES DE COTILLAS - SPAIN - 2300m²- POLTRACK SPRAYCOAT
-WADY DEGLA EL NAKHIL CLUB - CAIRO, EGYPT - 2260m² - Acrylic sports courts, POLYFLEX AEL-EX
-OUTDOOR SPORTS FLOORING PROJECT - INDIA - 2250 m²- Acrylic sports courts, SPORTFLOOR-EX
-SPORTS FLOORING PROJECT IN BULGARIA - 2200 m²- Acrylic sports courts, SPORTFLOOR-EX system
-LULU SCHOOL - ABU DHABI, U.A.E - 2200 m² - SAFEPOL MULTICOLOR
-TEACHERS COLLEGE - ABHA, KSA - 2050 m² - Running track
-MUSAB BIN OMAIR BOYS SCHOOL - BIN OMRAN, QATAR - 2050 m² - PU outdoor sport flooring
-BURAIRAT SCHOOL - RAK, UAE - 2000 m² - Running track
-SPORTS CENTRE OF GERAKAS - ATHENS, GREECE - 2000m² - Acrylic sports courts, SPORTFLOOR-EX
-HADAYEK ALAHAMR CLUB - GIZA, EGYPT - 2000m²-PU outdoor sports flooring, POLYFLEX PU-EX WET- POUR
-JP, ADA CIGANLIJA - BELGRADE, SERBIA - 2000m² - SPORTFLOOR-EX
-YASMINA SCHOOL - ABUDHABI, U.A.E - 2000m² - Playground flooring, SAFEPOL MULTICOLOR
-SCHOOL COMPLEX IN NAXOS ISLAND - GREECE - 2000m² - Acrylic sports courts, SPORTFLOOR-FAST
-MUNICIPALITY STADIUM OF MALIA, CRETE - GREECE - 2000m²- POLTRACK SPRAYCOAT SYSTEM
-AL SAILIYA BOYS SCHOOL - AL SAILIYA, QATAR - 2000 m² - Polyurethane, outdoor sport flooring
-KING KHALID UNIVERSITY - ABHA, KSA - 2000 m² - Volleyball/basketball rubber courts
-HH KHALID BIN BANDAR - RIYADH, KSA - 2000 m² - Volleyball/basketball rubber courts
-MUNICIPALITY STADIUM OF DRAMA - GREECE - 2000m²- POLTRACK SANDWICH SYSTEM
-RAWDA RASHEED PRIMARY SCHOOL FOR BOYS - 2000 m² - Outdoor sports flooring
-DEIRA INTERNATIONAL SCHOOL - DUBAI, U.A.E - 2000 m² - POLYFLEX PU-IN
-DAMIETTA GOVERNMENT - EGYPT - 2000m² - Running track, Poltrack Spraycoat Sealed System
-MUNICIPAL STADIUM OF GIANNITSA-GIANNITSA,GREECE-2000m² -Running track POLTRACK SANDWICH
-AL WAKAIR BOYS SCHOOL - AL WAKRAH, QATAR - 1950 m² - Polyurethane, outdoor sport flooring
-THE LAKE DISTRICT - PUNE, INDIA - 1950m²- Acrylic sports courts
-PRESIDENTIAL GUARD COMMAND MAHAWI - ABU DHABI, UAE - 1900m² - Football court

-GEMS CAMBRIDGE INTERNATIONAL SCHOOL - HOSHIYARPUR, INDIA - 1900m² - FLEXFLOOR-EX
-MUNICIPALITY STADIUM KARPENISI, GREECE - 1900m² - POLTRACK SANDWICH SYSTEM
-UNITED (SABIC) SPORTS CLUB - 1900 m² - Rubber flooring
-OUTDOOR SPORTS FLOORING PROJECT - PAKISTAN - 1900 m² - WET-POUR POLYFLEX AEL-EX
-SHOOLS MINISTRY OF EDUCATION - KHAMIS, KSA - 1800 m² - Rubber flooring
-AL MAJAD AMPHITHEATER - SHARJA, UAE - 1800m² - Certified Jogging track
-MULTIPURPOSE COURTS - KEFALONIA, GREECE - 1800m² - SPORTFLOOR-EX
-QASSIM UNIVERSITY - KSA - 1800m² - Polyurethane sports flooring
-MODERN ENGLISH SCHOOL - EGYPT - 1785m² - Running track, POLTRACK SPRAYCOAT
-AL QADSIYA MODEL INDEPENDENT SCHOOL - ALWAAB, QATAR - 1770 m² - PU outdoor sport flooring
-MUNICIPAL SPORTS CENTER IN KIATO - GREECE - 1750 m² - POLTRACK SPRAYCOAT, SPORTFLOOR-EX
-IKNS SCHOOL - BAHRAIN - 1700 m² - Playground flooring, SAFEPOL MULTICOLOR system
-AL WAHDA SPORT ACADEMY CLUB - ABU DHABI, UAE - 1700 m² - Acrylic sports system
-MUNICIPALITY STADIUM OF AGIA VARVARA - GREECE - 1700m² - POLTRACK SPRAYCOAT SYSTEM
-MULTIPURPOSE ACRYLIC COURTS - BAHRAIN - 1700 m² - SPORTFLOOR-EX system
-ALSARH SCHOOLS OF CIVIL - RIYADH, KSA - 1650m² - PU glue/Soccer field
-PLAYGROUND FLOORING PROJECT IN QATAR - 1650m² - SAFEPOL MULTICOLOR system
-ESTADIO PROVINCIAL DE SANDIA - PUNO, PERU - 1650m² - POLTRACK SANDWICH
-GD GOENKA PUBLIC SCHOLL - PURNIA, INDIA - 1630m² - Acrylic sport1600 m²
-MUNICIPALITY STADIUM OF AGIA VARVARA - GREECE - 1700m² - POLTRACK SPRAYCOAT SYSTEM
-MULTIPURPOSE ACRYLIC COURTS - BAHRAIN - 1700 m² - SPORTFLOOR-EX system
-ALSARH SCHOOLS OF CIVIL - RIYADH, KSA - 1650m² - PU glue/Soccer field
-PLAYGROUND FLOORING PROJECT IN QATAR - 1650m² - SAFEPOL MULTICOLOR system
-ESTADIO PROVINCIAL DE SANDIA - PUNO, PERU - 1650m² - POLTRACK SANDWICH
-GD GOENKA PUBLIC SCHOLL - PURNIA, INDIA - 1630m² - Acrylic sport1600 m² - s courts
-CIVIL DEFENCE TRAINING CENTER, EASTERN PROVINCE - K.S.A - 1600 m² - POLTRACK SPRAYCOAT
-SPA RESORT DERENIVSKUPIA KI - UZHGOROD, UKRAINE - 1600 m² - Flexfloor-ex system, volleyball court
-CIVIL DEFENCE TRAINING CENTER, EASTERN PROVINCE - K.S.A - 1600 m² - POLYFLEX PU-IN
-IISER, INDIAN INSTITUTE OF SCIENCE EDUCATION AND RESEARCH - BHOPAL, INDIA - 1600m² - Acrylic sports courts, FLEXFLOOR-EX system
-EFKARPIA MUNICIPALITY - THESSALONIKI, GREECE - 1600m² - Acrylic sports courts,SPORTFLOOR-EX
-GRACANICA SPORTS CENTRE - KOSOVO - 1600m² - Running Track, POLTRACK PRAYCOAT system
-3 OUTDOOR BASKETBALL COURTS - RHODES ISL GREECE - 1600 m² - FLEXFLOOR-EX system
-RUNNING TRACK PROJECT IN BOSNIA & HERZEGOVINA - 1585² - POLTRACK PRAYCOAT
-THE MILITARY HOSPITAL - RIYADH, KSA - 1560 m² - Volleyball/basketball rubber courts-PU sports flooring
-STADIUM IN BAJRAM CURRI - TROPOJA, ALBANIA - 1550 m² - SPRAYCOAT system
-SCHOOL SPORTS COMPLEX IN POLIGIROS - GREECE - 1550m² - Acrylic flooring, SPORTFLOOR FAST
-AL FORSHAN SPORTS CENTRE - ABU DHABI, U.A.E - 1500m² - Smartfloor system, Acrylic flooring
-INDUSTRIAL FLOORING - BULGARIA - 1500m² - Epoxy flooring, Polepox Coat 814 system
-SCHOOL IN AL WAKRA CITY - DOHA, QATAR - 1500 m² - Playground flooring
-REAL SCHOOL SHAH ALAM - MALAYSIA - 1500 m² - POLTRACK SPRAYCOAT
-IRAQ ARMY CAMP - IRAQ - 1500m² - Acrylic flooring in 2,2mm
-BICYCLE TRACK PROJECT - LARISA-TRIKALA, GREECE - 1500 m² - SPORTGROUND-EX
-PROJECT GREEN LAND - DUBAI, UAE - 1500 m² - Jogging track
-UP TOWN SCHOOL - 1500m² - Poltrack Spraycoat, RunningTrack

-INDIAN AIR FORCE - ALLAHABAD, INDIA - 1450m² - Acrylic sports courts
-OUTDOOR SPORTS COURT COMPLEX - INDIA -1400m²- PU flooring, WET-POUR POLYFLEX PU-EX
-SPORTS FLOORING PROJECT IN KOSOVO - STREET BALL - 1400m²- SPORTFLOOR-EX
-DUBAI MODERN HIGH SCHOOL - DUBAI, UAE - 1375 m² - Acrylic sports courts
-PROJECT ECOGREEN - DUBAI, UAE - 1350 m² - Jogging track
-SAVA BASELINE ACADEMY - MALTA - 1350m² - SMARTFLOOR-EX
-TENNIS CLUB CENTER IN LJUBLJANA - SLOVENIA - 1350m²- SPORTFLOOR-EX
-SPORTS FLOORING PROJECT - BANSKO, BULGARIA - 1350 m² - Acrylic sports courts
-”10” NATIONAL TV STATION - KOSOVO - 1300 m² - Outdoor, acrylic flooring, WET POUR POYFLEX AEL-EX
-POLICE COMPLEX BARRACKS NIZWA - OMAN- 1300 m² - Colorflex, PU sport flooring
-POLICE COMPLEX BARRACKS AL AJAIZ - OMAN - 1300 m² - Colorflex, PU sport flooring
-POLICE COMPLEX BARRACKS KATMATMILAH SITE - OMAN- 1300 m² - Colorflex, PU sport flooring
-POLICE COMPLEX BARRACKS SUWAIQ - OMAN - 1300 m² - Colorflex, PU sport flooring
-POLICE COMPLEX BARRACKS AL KAMIL - OMAN - 1300 m² - Colorflex, PU sport flooring
-PLAYGROUND FLOORING - BAHRAIN - 1300m² - Safepol system
-POLICE COMPLEX BARRACKS SHINAS - OMAN - 1300 m² - Colorflex, PU sport flooring
-POLICE COMPLEX BARRACKS BHALA - OMAN - 1300 m² - Colorflex, PU sport flooring
-POLICE COMPLEX BARRACKS MUDHAIBI - OMAN - 1300 m² - Colorflex, PU sport flooring
-POLICE COMPLEX BARRACKS THUMRAIT - OMAN - 1300 m² - Colorflex, PU sport flooring
-BASKETBALL COURTS PROJECT - NEAPOLI, THESSALONIKI, GREECE - 1300m² - SPORTFLOOR-EX
-POLICE COMPLEX BARRACKS AL KHOUDH - OMAN - 1300 m² - Colorflex, PU sport flooring
-POLICE COMPLEX BARRACKS MAHDAH - OMAN - 1300 m² - Colorflex, PU sport flooring
-POLICE COMPLEX BARRACKS BID BID - OMAN - 1300 m² - Colorflex, PU sport flooring
-POLICE COMPLEX BARRACKS AL KHABoORA - OMAN - 1300 m² - Colorflex, PU sport flooring
-POLICE COMPLEX BARRACKS DHANK - OMAN - 1300 m² - Colorflex, PU sport flooring
-POLICE COMPLEX BARRACKS HAFEET - OMAN - 1300 m² - Colorflex, PU sport flooring
-POLICE COMPLEX BARRACKS AUQAD - OMAN - 1300 m² - Colorflex, PU sport flooring
-POLICE COMPLEX BARRACKS SUMAIL - OMAN - 1300 m² - Colorflex, PU sport flooring
-MATRIX SPORTING CLUB - EGYPT - 1300 m² - Acrylic flooring, Flexfloor System
-OUTDOOR SPORTS VENUE - KOSOVO - 1300 m² - POLTRACK SPRAYCOAT System
-MUNICIPALITY SPORTS CENTRE SYKIES, THESSALONIKI - GREECE - 1300m²- POLTRACK SANDWICH
-SPORTS HALL IBRI - MUSCAT, OMAN - 1300 m² - Indoor sports flooring POLYFLEX PU-IN
-IK TENNIS ACADEMY - MALTA - 1300 m² - SPORTFLOOR-EX HARD COURT
-ALHALAFI BREAK - RIYADH, KSA - 1276 m² - Rubber flooring
-DELHI PUBLIC SCHOOL - ETAWAH, INDIA - 1250m²- Acrylic sports courts, FLEXFLOOR-EX system
-SCHOOL SPORTS PROJECT - ARTASHAT, ARMENIA - 1250m²- COLORLFEX-EX
-GI-DHOFAR BEACH RESORT & SPA - OMAN - 1225 m² - Colorflex, PU sport flooring
-RLS BASIC EDUCATION SCHOOL SOHAR - OMAN - 1225 m² - Colorflex, PU sport flooring
-MIXED BASIC EDUCATION SCHOOL AL QABIL - OMAN - 1225 m² - Colorflex, PU sport flooring
-BOYS BASIC EDUCATION SCHOOL BARKHA - OMAN - 1225 m² - Colorflex, PU sport flooring
-GIRLS BASIC EDUCATION SCHOOL MUDHAIBI - OMAN - 1225 m² - Colorflex, PU sport flooring
-MIXED BASIC EDUCATION SCHOOL AL AMERAT - OMAN - 1225 m² - Colorflex, PU sport flooring
-UMSALAMA GIRLS SCHOOL - AL RAYYAN, QATAR - 1200 m² - Polyurethane, outdoor sport flooring
-SHERATON PARK - DOHA, QATAR - 1200 m² - Playground flooring
-RAWDA BIN JASSIM SCHOOL - AL AZIZIYAH, QATAR - 1200 m² - Polyurethane, outdoor sport flooring

-GEMS WESTMINSTER SCHOOL - DUBAI, U.A.E - 1200 m² - Acrylic sports courts
-SILVER SPORTS CLUB - INDIA - 1200m² - Acrylic sports courts
-OUR OWN SCHOOL - SHARJA, U.A.E - 1200m² - Acrylic sports courts
-SHARJAH FOOTBALL CLUB - SHARJAH, UAE - 1200 m² - Polyurethane basketball courts
-SHERATON PARK - DOHA, QATAR - 1200 m² - Playground flooring
-CHILE RUNNING TRACK PROJECT - 1200 m² - Running track, POLTRACK SPRAYCOAT system
-EGYPT RUNING TRACK PROJECT - 1200m², Running Track, POLTRACK SPRAYCOAT system
-EGYPT RUNING TRACK PROJECT - 1200m², Running Track, POLTRACK SANDWICH system
-ALIGARH MUSLIM UNIVERSITY - ALIGARH, INDIA - 1200 m² - Acrylic sports courts, FLEXFLOOR-EX system
-SUMMER RESORT, KIDS Paly AREA - CHALKIDIKI, GREECE - 1200 m² - Playground flooring, SAFEPOL
-SPORTS FLOOR PROJECT IN PAKISTAN - 1200 m² - Acrylic sports courts, POLYFLEX AEL-EX
-SCHOOL COMPLEX - ZAKINTHOS, GREECE - 1200 m² - Acrylic sports courts, SPORTFLOOR FAST
-SYMBIOSIS COLLEGE - INDIA - 1180m² - Acrylic sports courts
-SPORTS PROJECT IN EGYPT - 1170m² - Acrylic sports courts, POLYFLEX AEL-EX
-PROFESSOR ABDULAZIZ ANQARI - RIYADH, KSA -1150m² - PU glue/Socccer field
-ACRYLIC, OUTDOOR SPORTS FLOORING PROJECT - KARACHI, PAKISTAN -1150m² - FLEXFLOOR-EX
-AL SAQID ISLAMIC ENGLISH SHCOLL-DUBAI,UAE-1100m²- Acrylic flooring, WET-POUR POLYFLEX AEL-EX
-REAL SCHOOL HULU LANGAT - MALAYSIA - 1100m² - POLTRACK SPRAYCOAT
-MAADI BRITISH SCHOOL- EGYPT - 1100m², Multipurpose court, COLORFLEX system
-OUTDOOR SPORTS PROJECT IN FOCSANI REGION - ROMANIA - 1100m² - POLTRACK SPRAYCOAT
-CENTRAL SQUARE OF MUNICIPALITY OF THERMI - THESSALONIKI, GREECE - 1100m², Decorative flooring MARMOR FLOOR system
-GREEK TECHNOLOGICAL EDUCATIONAL INSTITUTE OF THESSALIA - GREECE - 1100m², Running Track, POLTRACK SANDWICH system
-NANSHA INTERNATIONAL TENNIS CENTER - GUANGZHOU, CHINA - 1000 m² - SPORTFLOOR-EX
-KORYDALLOS DISTRICT - ATHENS, GREECE - 1100m² - FLEXFLOOR-EX
-CINEGUILLA - PERU - 1100m² - POLYFLEX PU-EX
-FIRST POINT SCHOOLS - DUBAI, UAE1100m² - Acrylic sports courts
-OUTDDOR SPORTS FLOORING PROJECT-ARTA, GREECE-1100m²-POLYFLEX AEL-EX & SPORTFLOOR
-TUMBES - PERU - 1100m² - POLYFLEX PU-IN
-DUBAI AMERICAN ACADEMY - DUBAI, UAE - 1080 m² - Acrylic sports court
-PRELUDE PUBLIC SCHOOL - AGRA, INDIA - 1070m² - Acrylic sports courts
-INDOOR SPORTS FLOORING PROJECT - JORDAN - 1055m² - Polyurethane POLYFLEX PU-IN
-ALMGBAL BREAK - RIYADH, KSA - 1050 m² - Rubber playground
-PLAYGROUND MULTI-PROJECT IN HUANCVELICA - PERU - 1050 m² - SAFEPOL MULTICOLOR
-BANIYAS CLUB AND AL AIN ENGLISH SPEAKING SCHOOL - ABU DHABI, UAE - 1000m² - Acrylic flooring
-WADY DEGLA LOTUS PROJECT - CAIRO, EGYPT - 1000 m² - Acrylic flooring, Wet-Pour Polyflex AEL-EX
-GRAVA SCHOOL COMPLEX - ATHENS, GREECE - 1000 m² - POLTRACK SANDWICH RETTOPING
-INDIAN AIR FORCE - VARANASI, INDIA - 1000m² - Acrylic sports courts
-MULTIPURPOSE COURT - K.S.A - 1000m²- WET-POUR POLEFLEX AEL-EX
-GARDENIA RESIDENTS - DUBAI, U.A.E - 1000 m² - SAFEPOL MULTICOLOR system
-JINDAL UNIVERSITY - SONIPAT, HARYANA, INDIA - 1000m² - PU flooring WET-POUR POLYFLEX PU-EX
-MINISTRY OF EDUCATION - DAMMAM, KSA - 1000 m² - PU indoor multipurpose sports flooring
-SHEIKH OBEID MAKTHOUM PALACE - 1000m² - Outdoor polyurethane flooring
-PAVILHAO POLIDESPORTIVO - SAO JOAO DA PESQUEIRA - PORTUGAL - 1000 m² - POLYFLEX PU-IN

-INDIAN AIR FORCE - AGRA, INDIA - 1000m² - Acrylic sports courts
-INDONESIA - 1000 m² - PU indoor multipurpose sports flooring
-FOOTBALL PITCH PROJECT IN CHALKIDIKI - GREECE-1000 m² Artificial Grass POLITURF TRIUMPH 60100
-INDIAN AIR FORCE - LUCKNOW, INDIA - 1000m² - Acrylic sports courts
-MULTIPURPOSE POLYURTEHANE INDOOR COURTS - F.Y.R.O.M - 1000m² - Polyflex PU-In system
-SODIC PROJECT - EGYPT - 1000m², Multipurpose court, COLORFLEX system
-MUNICIPALITY STADIUM OF LARISA "ALKAZAR"- GREECE -1000m²-POLTRACK SANDWICH RETTOPING
-INDIAN AIR FORCE - VARANASI, INDIA - 1000m² - Acrylic sports courts
-INTERNATIONAL SCHOOL OF CREATIVE SCHIENCE - SHARJAH, U.A.E - 1000m² - Safepol System
-INDIAN AIR FORCE - BIHTA, INDIA - 1000m² - Acrylic sports courts
-INDIAN AIR FORCE - DARBHANGA, INDIA - 1000m² - Acrylic sports courts
-AL AIN INDIAN SCHOOL - AL AIN, UAE - 1000m² - Football court
-GREEK AIR FORCE ACADEMY - TATOI, ATHENS, GREECE - 1000m² - PU flooring, POLYFLEX PU-IN
-DUBAI SCHOLRAS PRIVATE SCHOOL - DUBAI, U.A.E - 1000m² - Acrylic flooring in 2,2mm
-OBOOR SPORTS CLUB - EGYPT - 1000m² - Acrylic flooring
-CAMANA - PERU - 1000m² - POLYFLEX PU-IN
-INDOOR SPORTS PROJECT IN OMAN - MINISTRY OF EDUCATION - 1000m² - PU sports flooring
-VIT AP CAMPUS, AMARAVANTHI, VIJAYAWADA, ANDHRA PRADESH - INDIA - 985m² POLYFLEX PU-IN
-MONARCH INTERNATIONAL SCHOOL - 950m²- Acrylic sports courts, FLEXFLOOR-EX system
-FOOTBALL COURT - LIMASSOL, CYPRUS - 950m² - Artificial grass, POLITURF IMPERIAL 50140
-MULTISPORT FIELD GADIME - KOSOVO - 950m² - POLTRACK SPRAYCOAT
-COMMUNITY COLLEGE - KHAMIS, KSA - 940 m² - Polyurethane indoor multipurpose sports flooring
-GEMS METROPOLE SCHOOL - DUBAI, U.A.E - 900 m² - Playground flooring
-PLAYGROUND FLOORING IN KHARKIV-2 - UKRAINE - 900m² - SAFEPOL MULTICOLOR system
-MINISTRY OF EDUCATION - ABHA, KSA - 900 m² - Polyurethane indoor multipurpose sports flooring
-BAB AL SHAMS SPA HOTEL - DUBAI, UAE - 900m² - Football court
-STREET BALL COURTS - BOSNIA 7 HERZEGOVINA - 880m² - POLTRACK SPRAYCOAT system
-CAIRO FESTIVAL CITY ORIANA PROJECT - EGYPT - 855m² - Playground flooring, SAFEPOL MULTICOLOR
-INDIAN NAVY - KOCHI, INDIA - 850m² - Acrylic sports courts, FLEXFLOOR-EX system
-PARCONA - PERU - 850m² - POLYFLEX PU-EX
-SCHOOL SPORTS COMPLEX - K.S.A - 850m² - POLYFLEX AEL-EX
-CHICAUMA PROJECT - CHILE - 850m² - SAFEPOL MULTICOLOR
-JUBAIL - K.S.A - 850m² - WETPOUR POLYFLEX AEL-EX
-PLAYGROUND PROJECT IN KILKIS - GREECE - 850m² - Playground flooring, SAFEPOL MULTICOLOR
-GALGOTIAS UNIVERSITY - NOIDA, INDIA - 830m²- Acrylic sports courts, FLEXFLOOR-EX system
-KING KHALID UNIVERSITY - ABHA, KSA - 820 m² - Polyurethane indoor multipurpose sports flooring
-SCHOOL COMPLEX - KOSOVO - 820 m² - SPORTFLOOR-EX, ITF classified – class 4
-YLL MORINA SCHOOL - GJAKOVA, KOSOVO - 810m²- Outdoor sports project, POLTRACK SPRAYCOAT
-GYMNASIUM IN OBERHOFFEN - ALSACE, FRANCE - 800m²- POLYFLEX PU-IN
-SPORTS CENTER ANTIRIO - GREECE - 800m² - Running track POLTRACK SPRAYCOAT
-JINDAL UNIVERSITY - SONIPAT, HARYANA, INDIA - 800m² - POLTRACK JOGGING TRACK
-ARTIFICIAL GRASS - STATOVCHA, BULGARIA - 800m² - Artificial grass, POLITURF ROYAL 5588
-SCHOOL IN AL WAKRA CITY - DOHA, QATAR - 800m² - Polyurethane sports flooring
-LYCEE FRANCAISE PROJECT - BEIRUT, LEBANON - 800m² - Acrylic sports flooring

-SULTAN MANOR - RIYADH, KSA - 800m² - Polyurethane multipurpose sports flooring
-MINISTRY OF EDUCATION - AL KHARIZ, KSA - 800m² - PU indoor multipurpose sports flooring
-GEMS AMERICAN ACADEMY - ABU DHABI - U.A.E - 800m² - Running track POLTRACK SANDWICH
-INDOOR SPORTS COURT - MALAYSIA - 800m² - PU indoor sports flooring
-KID'S PLAY AREA IN MALL - MOROCCO - 800m² - PU indoor sports flooring, POLYFLEX PU-IN system
-MARASSI R1 PROJECT - EGYPT - 800m² - Playground flooring, SAFEPOL MULTICOLOR system
-SPORTS CENTER GLIFADA, ATHENS - GREECE - 800m² - Running track POLTRACK SANDWICH
-SPORTS CENTER VRILISIA, ATHENS - GREECE - 800m² - Running track POLTRACK SANDWICH
-DUBAI ENGLISH SPEAKING COLLEGE - DUBAI, UAE - 783m² - Acrylic flooring, SPORTFLOOR-EX
-MULTIPURPOSE COURT - YEREVAN - ARMENIA - 765m² - COLORFLEX-EX
-HAYATABAD PESHAWAR - INDIA - 750m² - Polyurethane sports flooring, POLYFLEX PU-IN
-SINGAPORE AIRLINES - SINGAPORE - 735m² - PU indoor sports flooring
-CJM MIZIARA SCHOOL - LEBANON - 730m² - WET-POUR POLYFLEX AEL-EX
-AL DAJAN COMPANY - GASIM, KSA - 722m² - Polyurethane sports flooring/Tennis court
-SELECTIVE GOVERNMENT HIGH SCHOOL - EGYPT - 720m², Outdoor sports flooring
-INDIAN AIR FORCE - AHMEDABAD, INDIA - 720m² - Acrylic sports courts
-FITNESS TIME - FAYSALIA, DAMMAM, KSA - 700 m² - PU indoor multipurpose sports flooring/running track
-FITNESS TIME YASMEEN - RIYADH, KSA - 700 m² - PU indoor multipurpose sports flooring/running track
-FERRARI WORLD - ABU DHABI, UAE - 700m² - Playground flooring
-KOHAT SPORTS COMPLEX - PAKISTAN - 700m² - PU flooring, POLYFLEX PU-IN
-FITNESS TIME JUNIOR - RIYADH, KSA - 700 m² - PU indoor multipurpose sports flooring/running track
-FITNESS TIME - OLAYA RIYADH, KSA - 700 m² - PU indoor multipurpose sports flooring/ running track
-FITNESS TIME WAHA - RIYADH, KSA - 700 m² - PU indoor multipurpose sports flooring/running track
-FITNESS TIME, NOOR BRANCH - DAMMAM, KSA - 700 m² - PU indoor sports flooring and running track
-FITNESS TIME, ALAMEEN BRANCH - DAMMAM, KSA - 700 m² - PU indoor sports flooring and running track
-FITNESS TIME, PLUS RIYADH - RIYADH, KSA - 700 m² - PU indoor sports flooring and running track
-FITNESS TIME, SALAMA BRANCH BRO & FITNESS - JEDDAH, KSA - 700 m² - PU indoor sports flooring
-FITNESS TIME, 40th BRANCH - JEDDAH, KSA - 700 m² - PU indoor sports flooring and running track
-NASR CLUB- EGYPT - 700m², Multipurpose court, POLYFLEX WET-POUR system
-HUREL DOUBLE 3 - RAS AL KHAIMEH, KSA - 700 m² - Shockpad plus acrylic coatings
-THE SUSTAINABLE CITY - DUBAI, U.A.E - 700 m² - Acrylic flooring
-PROJECT IN MALTA - 700 m² - Acrylic flooring, SPORTFLOOR-EX system
-EMAAR - EMIRATES HILLS 2 - DUBAI, U.A.E - 700m² - Basketball court, Acrylic flooring
-AIRFORCE SURBOTO PARK - NEW DELHI, INDIA - 680 m² - Polyurethane outdoor sports flooring
-INDIAN ARMY - DHRANGDHARA, INDIA - 670m² - Acrylic sports courts
-MT.SAINT PATRICK ACADEMY - INDIA - 665m² - Acrylic sports courts
-RAJIV GANDHI THERMAL POWER PLANT - HISAR, INDIA - 650m² - Acrylic sports courts, FLEXFLOOR-EX
-JAWAHARLAL NEHRU TECHNOLOGICAL UNIVERSITY ANANTAPURAMU - ANANTAPUR, INDIA - 650m² - Acrylic sports courts, FLEXFLOOR-EX system
-TILAL HOTEL - DUBAI, U.A.E - 650 m² - SAFEPOL MULTICOLOR system
-REGIONAL HQ AT BURAIMI - OMAN - 650 m² - Colorflex, PU sport flooring
-PLAYGROUND FLOORING PROJECT IN LARNAKA, CYPRUS - 650 m² - SAFEPOL MULTICOLOR system
-ROYAL OMAN POLICE TASK FORCE RUSTAQ - OMAN - 650 m² - Colorflex, PU sport flooring
-ROYAL OMAN POLICE TASK FORCE LIWA - OMAN - 650 m² - Colorflex, PU sport flooring
-ROYAL OMAN POLICE TASK FORCE AL SALIL - OMAN - 650 m² - Colorflex, PU sport flooring

-OUTDOOR TENNIS COURTS - KOSOVO - 650m² - Acrylic sports courts, SPORTFLOOR-EX
-ROYAL OMAN POLICE TASK FORCE IBRI - OMAN - 650m² - Colorflex, PU sport flooring
-ROYAL OMAN POLICE TASK FORCE IBRA - OMAN - 650m² - Colorflex, PU sport flooring
-ROYAL OMAN POLICE TASK FORCE AL SUR - OMAN - 650m² - Colorflex, PU sport flooring
-3 PICKLEBALL COURTS IN CRAZ CITY - AUSTRIA - 650m² - Acrylic sports flooring, FLEXFLOOR-EX system
-ROYAL OMAN POLICE TASK FORCE AL DUKUM - OMAN - 650m² - Colorflex, PU sport flooring
-ROYAL OMAN POLICE TASK FORCE AL BURAIMI - OMAN - 650m² - Colorflex, PU sport flooring
-OASIS COMPLEX - K.S.A - 650m² - WET-POUR POLYFLEX PU-IN system
-ROYAL OMAN POLICE TASK FORCE AL NIZWA - OMAN - 650m² - Colorflex, PU sport flooring
-ROYAL OMAN POLICE TASK FORCE AL SUWAIQ - OMAN - 650m² - Colorflex, PU sport flooring
-ABU DHABI MUNICIPALITY - ABU DHABI , UAE - 650m² - Acrylic flooring
-INDOOR BASKETBALL COURT - JUBAIL - K.S.A - 650m² - WET-POUR POLYFLEX PU-IN system
-ST. MARY'S SCHOOL - LEMESOS, CYPRUS - 650m² - Playground flooring, SAFEPOL MULTICOLOR
-ROYAL OMAN POLICE TASK FORCE AL SALALAH - OMAN - 650m² - Colorflex, PU sport flooring
-ROYAL OMAN POLICE TASK FORCE AL BARKHA - OMAN - 650m² - Colorflex, PU sport flooring
-ROYAL OMAN POLICE TASK FORCE KHOUDH - OMAN - 650m² - Colorflex, PU sport flooring
-MULTIPURPOSE COURTS - TIRANA, ALBANIA - 650m² - Acrylic sports flooring, FLEXFLOOR system
-PLAYGROUND FLOORING IN KHARKIV-3 - UKRAINE - 650m² - SAFEPOL MULTICOLOR system
-MOHAMMED JASSIM M AL THANI SCHOOL - UMSALALALI, QATAR - 620m² - PU outdoor sport flooring
-QATAR GEMS SCHOOL - DOHA, QATAR - 615m² - Polyurethane sports flooring
-VELOOR THRISSUR DISTRICT - KERALA, INDIA - 610m² - Acrylic sports courts, FLEXFLOOR-EX system
-PUBLIC PARK - ABU DHABI, U.A.E - 610m² - Acrylic sports courts, SPORTFLOOE-EX FAST system
-VAISHNO DEVI - DELHI, INDIA - 610m² - Polyurethane outdoor sports flooring
-EQUINE FLOORING - BAHRAIN - 600m², POLTRACK EQUESTRIAN SYSTEM
-THAILAND - 600m² - Acrylic sports courts
-VILLA SINMAC PARK - SAN ANTONIO, PERU - 600m² - SAFEPOL MULTICOLOR system
-WATER'S EDGE RESIDENTIAL DEV'T - YAS ISLAND, ABHU DHABI, U.A.E - 600m² Sportground-Ex system
-PLAYGROUND FLOORING IN BAHRAIN - 600m² - SAFEPOL MULTICOLOR system
-PLAYGROUND FLOORING IN KHARKIV - UKRAINE - 600m² - SAFEPOL MULTICOLOR system
-INDIAN ARMY - AGRA, INDIA - 600m² - Acrylic sports courts
-THE INTERNATIONAL SCHOOL - AGRA, INDIA - 600m² - Acrylic sports courts
-INDIAN ARMY - JHANSI, INDIA - 600m² - Acrylic sports courts
-THE SUSTAINABLE CITY - DUBAI, U.A.E - 600m² - Safepol system
-AMITY SCHOOL, JUMEIRAH ISLAND - DUBAI, UAE - 600m² - Safepol system
-QUEEN ZAIN AL SHARAF HALL - JORDAN - 600m² - POLYFLEX PU-IN
-OUR OWN ENGLISH HIGH SCHOOL - SHARJAH, U.A.E - 600m² - Flexfloor system
-OUR OWN ENGLISH HIGH SCHOOL - SHARJAH, U.A.E - 600m² - Polyflex Ael-EX system
-ST. FRANCIS INTER COLLEGE - HATHRAS, INDIA - 600m² - Acrylic sports courts, FLEXFLOOR-EX system
-ST. ANTHONY'S SENIOR SECONDARY SCHOOL - FARRUKHABAD, INDIA - 600m² - FLEXFLOOR-EX
-SKATING FOR KIDS - GUJARAT, INDIA - 600m² - Sportfloor system
-IMS COLLEGE - GHAZIABAD, INDIA - 600m² - Acrylic sports courts, FLEXFLOOR-EX system
-GALGOTIAS COLLEGE OF ENGINEERING - GR. NOIDA, INDIA - 600m² - Acrylic sports courts, FLEXFLOOR-EX
-HOTEL COMPLEX IN DHERMI, ALBANIA - 600m² - Acrylic sports courts, SPORTFLOOR-EX system
-DANIEL BECCERA OCAMPO EDUCATIONAL INSTITUTION-MONQUEGUA,PERU - 580m² POLYFLEX PU-EX
-TATLAY AALI SPORTS COMPLEX - PAKISTAN - 500m² - PU flooring, POLYFLEX PU-IN

-NEW DUBAI BRADENTON SCHOOL- DUBAI, UAE - 570m² - Acrylic sports courts
-«CRONWELL PLATAMON RESORT» HOTEL IN PLATAMONAS - GREECE - 560m² - SPLASH PARK FLOORING, AQUASOFT-EX system
-DUBAI SILICON OSIS-CENTRAL PARK, DSO - DUBAI, UAE - 560 m² - Jogging track
-MPS WORLD SCHOOL - AGRA, INDIA - 560m²- Acrylic sports courts
-LEADERS INTERNATIONAL SCHOOLS - EGYPT - 560m²- PU sports courts
-PLAYGROUND PROJECT IN AL KASIM - K.S.A - 560m²- SAFEPOL MULTICOLOR
-HARTLAND INTERNATIONAL SCHOOL - U.A.E - 550m²- SAFEPOL MULTICOLOR system
-PLAYGROUND FLOORING PROJECT IN SINGAPORE - 550m²- SAFEPOL MULTICOLOR system
-ARMY LAW COLLEGE PUNE- PUNE, INDIA - 550m²- Acrylic sports courts, FLEXFLOOR-EX system
-AL WUKAIR GIRLS SCHOOL - AL WAKRAH, QATAR - 550m² - Polyurethane, outdoor sport flooring
-AL BUROUJ PROJECT, SPORTS CLUB - EGYPT - 550m² - Running track, POLTRACK SPRAYCOAT
-PLAYGROUND PROJECT IN CYPRUS - 550m²- SAFEPOL MULTICOLOR system
-BBPS - DELHI, INDIA - 512m² - Polyurethane outdoor sports flooring
-IVY STATE - PUNE, INDIA - 511m²- Acrylic sports courts
-KUNAL ICONIA - INDIA - 510m²- Acrylic sports courts
-PORT CISNE - CHILE - 500m² - SAFEPOL MULTICOLOR
-AGRICULTURE UNIVERSITY PESHAWAR - INDIA - 500m² - Polyurethane sports flooring, POLYFLEX PU-IN
-LJUBUSKY PROJECT - BOSNIA & HERZEGOVINA - 500m² - Acrylic sports flooring FLEXFLOOR-EX
-MURIDKE SPORTS COMPLEX-SHEIKHUPURA, PUNJAB, PAKISTAN - 500m²-PU flooring,POLYFLEX PU-IN
-CRNA REKA PETROL - NORTH MACEDONIA - 500m² - Acrylic flooring, FLEXFLOOR-EX
-ONE PARK AVENUE, SOBHA HARTLAND - U.A.E - 500m² - SAFEPOL MULTICOLOR system
-VARIOUS PLAYGROUND PROJECTS IN ABU DHABI - U.A.E - SAFEPOL MULTICOLOR system
-AMERICAN SCHOOL OF DUBAI - DUBAI, UAE - Acrylic sports courts
-ETIHAD MUSEUM - JUMEIRAH, DUBAI, UAE - Rubber flooring
-SHENZHEN CITY VALLEY - CHINA - Acrylic sports flooring
-CARPARKING - ABU DHABI, UAE - Acrylic flooring
-DUBAI MILLENIUM SCHOOL - QUSAIS, UAE - Acrylic sports courts
-AMERICAN UNIVERSITY - DUBAI, UAE – Acrylic outdoor sports flooring
-RAK ACADEMY - RAK, UAE - Acrylic flooring
-ISCS - SHARJA, UAE - Acrylic flooring
-THE INTERNATIONAL SCHOOL OF CHOUEIFAT - AJMAN, U.A.E - Sportground-Ex system
-THE KINDER GARDEN STARTERS - DUBAI, U.A.E - Safepol system
-AL ZAHIA PROJECT - SHARJA, UAE - Safepol system
-WADY DEGLA SHERATON CLUB - CAIRO, EGYPT - Acrylic sports flooring
-NEW DUBAI BRADENTON SCHOOL- DUBAI, UAE - 570m² - Acrylic sports courts
-PLAYGROUND PROJECT IN QATAR - SAFEPOL MULTICOLOR
-GEMS WELLINGTON SCHOOL - DUBAI, U.A.E - Safepol system
-JUMEIRAH RETAIL DEVELOPMENT - JUMEIRAH, DUBAI, UAE - Safety rubber flooring
-MR.ABDULRHMIN - JUBAIL, KSA - Rubber playground
-GEMS WESTMINISTER SCHOOL - DUBAI, U.A.E - Safepol system
-POLYURETHANE INDOOR SPORTS COURT - TIRANA, ALBANIA - Polyflex PU-In system
-MULTIPURPOSE COURTS - ODESSA, UKRAINE - Rubber flooring
-MULTIPURPOSE COURTS - ZHOVKVA, UKRAINE - Rubber flooring
-MUNICIPAL TENNIS CLUB - PATRA, GREECE - Flexfloor-EX system, Acrylic sports courts

-INDIAN AIR FORCE - GORAKHPUR, INDIA - Acrylic sports courts
-INDIAN AIR FORCE - BAREILLY, INDIA - Acrylic sports courts
-INDIAN ARMY - BABINA, INDIA - Acrylic sports courts
-ADAM AIRBASE PACKAGE 8, OMAN - Colorflex, PU sport flooring
-GOLD GYM - KOLKATTA, INDIA - Polyurethane indoor sports flooring
-MINISTRY OF FOREIGN AFFAIRS - ABU DHABI, UAE - Polyurethane flooring
-SHRJAH SPORTS CLUB - SHARJAH, UAE - Polyurethane flooring
-GEMS WINCHESTER SCHOOL - AL BARSHA SOUTH, UAE - Acrylic sports system
-HOTEL DOUBLE 3 - RAS AL KHAIMAH, UAE - Prefabricated shock-pad 4mm plus acrylic coatings
-ALNABBAGH STABLE - AL AIN, U.A.E - Polyurethane flooring, POLTRACK EQUESTRIAN FLOORING
-AL WAHDA CLUB - ABU DHABI, UAE - Rubber flooring
-ADJD MAIN BUILDING LANDSCAPE PROJECT - ABU DHABI, UAE - Rubber flooring
-KADEEJ AL KURBA SCHOOL - ABU DHABI, UAE - Rubber flooring
-INTERNATIONAL SCHOOL OF CREATIVE SCIENCE-SHARJA, U.A.E-Flexfloor system/Outdoor Multipurpose court
-ENVIRO, VATIKA HOTELS PVT.LTD - GURGAON, INDIA - Acrylic sports flooring
-ASHIANA - BHUBANESHWAR, INDIA - Acrylic sports flooring
-TCS, ADIBATLA - HYDERABAD, INDIA - Acrylic sports flooring
-IPS, ERODE - CHENNAI, INDIA - Acrylic sports flooring
-LIONS GATE - MUMBAI, INDIA - Acrylic sports flooring
-MORNING GLORY INFRA LIMITED - KANPUR, INDIA - Acrylic sports flooring
-SPORTS HALL ZVORNIK - BOSNIA & HERZEGOVINA - PU flooring POLYFLEX PU-IN
-NAMBIAR - BANGALORE, INDIA - Acrylic sports flooring
-PATHWAYS - GURGAON, INDIA - Acrylic sports flooring
-WELHAMS GIRLS SCHOOL - DEHRADUN, INDIA - Acrylic sports flooring
-WOODDUCK COMMERCIAL CENTER- IRAN - Industrial flooring
-ARABIAN RANCHES by EMAR - DUBAI, U.A.E - Playground flooring
-OUR OWN ENGLISH HIGH SCHOOL - SHARJAH, U.A.E - Playground flooring
-POLO CLUB GHANTOOT - ABU DHABI, U.A.E - Polyurethane flooring, POLTRACK EQUESTRIAN FLOORING
-RAK MODERN SCHOOL - RAS AL KHAIMAH, U.A.E - Playground flooring
-GIIS/GLOBAL INDIAN INTERNATIONAL SCHOOL - RAS AL KHAIMAH, U.A.E - Playground flooring
-MINISTRY OF EDUCATION, NAD AL HAMAR BOYS SCHOOL - DUBAI, U.A.E - Playground flooring
-K.G. KIDS SCHOOL - AALI, BAHRAIN - Playground flooring
-SABIC BEACH CAMPS PROJECT - JUBAIL, K.S.A - Outdoor sports flooring, artificial grass.
-MINISTRY OF EDUCATION, MIZHER GIRLS SCHOOL - DUBAI, U.A.E - Playground flooring
-WARSAN STABLE - Polyurethane flooring, POLTRACK EQUESTRIAN FLOORING
-AL SHIMAL PARK - DOHA, QATAR - Playground flooring
-UM SELAL PARK - DOHA, QATAR - Playground flooring
-GEMS METROPOLE SCHOOL - DUBAI, U.A.E - Hard court system/Outdoor Multipurpose court
-ARABIAN RANCHES by EMAR - DUBAI, U.A.E - Acrylic Outdoor Tennis and Basketball courts
-RAK MODERN SCHOOL - RAS AL KHAIMAH, U.A.E - Flexfloor system
-GIIS/GLOBAL INDIAN INTERNATIONAL SCHOOL - RAS AL KHAIMAH, U.A.E - Acrylic system
-AVALON HEIGHTS - AJMAN, U.A.E - Acrylic floorings
-DELHI PRIVATE SCHOOL - DUBAI, U.A.E - Acrylic flooring
-ROYAL COMMISSION SCHOOL - JUBALI, KSA - Acrylic sports flooring

-FITNESS TIME PRO - AL AHSA BRANCH - KSA - Flexfloor, Basketball court
-FITNESS TIME PRO - MAKKAH SHARAIE - KSA - Flexfloor, Basketball court
-BIN HAM - AL AIN, UAE - Polyurethane flooring
-SHAMMA BINT MOHAMMED SHOOL - AL AIN, UAE - Polyurethane flooring
-ABDULLAH BIN OTAIBA - ABU DHABI, UAE - Polyurethane flooring
-LIWA INTERNATIONAL SCHOOL - AL AIN, U.A.E - Colorflex outdoor sport system
-ZOHOUR KG - MANAMA, BAHRAIN - Polyurethane sports flooring
-RAWDA RASHED - QATAR- Polyurethane, outdoor sport flooring
-SAAD BIN ABI WAQAS SCHOOL - AL RAYYAN, QATAR - Polyurethane, outdoor sport flooring
-FITNESS TIME PRO - MADINS RING ROAD BRANCH - KSA - Flexfloor, Basketball court
-AGRA CHAIN - AGRA, INDIA - Acrylic sports flooring
-SUNWORLD - NOIDA, INDIA - Acrylic sports flooring
-SSN INVESTMENTS PRIVATE LIMITED, FRIENDS COLONY - DELHI, INDIA - Acrylic sports flooring
-AJNARA - NOIDA, INDIA - Acrylic sports flooring
-BRIGHT RIDERS SCHOOL - ABU DHABI, UAE - Running track, Acrylic sports court
-OUR OWN ENGLISH HIGH SCHOOL - SHARJAH, U.A.E - Poltrack Spaycoat system
-NCC - JAIS, INDIA - Acrylic sports flooring
-ALPHA FOUNDATION FOR EDUCATION & RESEARCH - TRICHIRAPALLI, INDIA - Acrylic sports flooring
-PUSHPANJALI FARMS - NEW DELHI, INDIA - Acrylic sports flooring
-M3M - MERLIN GURGAON, INDIA - Acrylic sports flooring
-NORTH LONDON COLLEGIATE SCHOOL - DUBAI, U.A.E - Playground flooring
-FOOT COURT - EGYPT - Running track, POLTRACK SPRAYCOAT system
-FITNESS TIME ANDALUS BRANCH - JEDDAH, K.S.A - Acrylic sports flooring, FLEXFLOOR SYSTEM
-ST.JOSEPHS WOMENS COLLEGE - ALLEPPEY, KERALA, INDIA - Polyurethane outdoor sports flooring
-RAILWAY SPORTS GROUND - GUNTAKAL, ANDRA PRADESH, INDIA - Acrylic sports flooring
-TERVEL PROJECT - TERVEL, BULGARIA - Playground flooring, SAFEPOL system
-INDOOR COURT - UKRAINE - Polyflex PU-In system
-PRIVATE JOB - HYDERABAD, SOUTH INDIA - Acrylic outdoor sports flooring
-RAILWAY SPORTS GROUND -GUNTAKAL, ANDRA PRADESH, INDIA-Acrylic outdoor sports flooring, 5 layers
-VARIOUS PLAYGROUND PROJECTS IN ABU DHABI - U.A.E - SAFEPOL MULTICOLOR system
-POLYURETHANE OUTDOOR SPORTS COURT - QATAR - POLYFLEX PU-EX system
-QASR AL SARAB DESERT RESORT - ABU DHABI, U.A.E - SAFEPOL MULTICOLOR
-SPORTS CENTER IN HANOI - VIETNAM - POLYFLEX PU-IN
-NIELSON BUKA RESORT - KALAMATA, GREECE - FLEXFLOOR-EX
-PARALYMPICS FEDERATION SPORTS CENTER - CAMBODIA - POLYFLEX PU-IN system
-MINISTRY OF EDUCATION U.A.E - Playground flooring
-PLAYGROUND FLOORING - VARNA, BULGARIA - SAFEPOL System
-INDIAN ARMY - SHAHJAHANPUR, INDIA - Acrylic sports courts, FLEXFLOOR-EX system
-AIR FORCE SCHOOL - BENGALURU, INDIA - Acrylic sports courts, FLEXFLOOR-EX system
-ARMY PUBLIC SCHOOL - UDHAMPUR, INDIA - Acrylic sports courts, FLEXFLOOR-EX system
-BAHRAIN ROYAL EQUESTRIAN AND ENDURANCE FEDERATION - BAHRAIN - PU Equestrian system
-PLAYGROUND PROJECT - HONG KONG - SAFEPOL MULTICOLOR system
-PLAYGROUND PROJECT - KOSOVO - SAFEPOL MULTICOLOR system
-KIND SAUDI UNIVERSITY - RIYADAH, K.S.A - Running track, POLTRACK SPRAYCOAT ASYSTEM
-TENNIS COURT IN MYKONOS, GREECE - Acrylic sports courts, POLYFLEX AEL-EX system

- TENNIS COURT PROJECT - PAKISTAN** - Acrylic sports courts, SPORTFLOOR-EX-R system
- SHENZHEN CITY VALLEY - CHINA** - Acrylic sports courts
- QAYYUM STADIUM PESHAWAR - INDIA** - Polyurethane flooring POLYFLEX PU-IN
- PLAYGROUND FLOORING IN CYPRUS** - SAFEPOL MULTICOLOR system
- PLAYGROUND FLOORING - PRNJAVOR, BOSNIA & HERZEGOVINA** - SAFEPOL MULTICOLOR system
- BASKETBALL & BADMINTON COURTS-ASHIANA DAKSH-INDIA**-Polyurethane flooring POLYFLEX PU-EX
- BASKETBALL & BADMINTON COURTS-ASHIANA UMANG-INDIA**-Polyurethane flooring POLYFLEX PU-EX
- MULTIPURPOSE COURT - GUATEMALA** - POLYFLEX AEL-EX-R
- PLAYGROUND PROJECT - K.S.A** - SAFEPOL MULTICOLOR
- PLAYGROUND PROJECT IN JUBAIL - K.S.A** - SAFEPOL MULTICOLOR
- REPTON SCHOOL - DUBAI, U.A.E** - SAFEPOL MULTICOLOR
- PLAYGROUND PROJECT IN TEL AVIV - ISRAEL** - SAFEPOL MULTICOLOR
- PLAYGROUND PROJECT IN RISHON LEZION - ISRAEL** - SAFEPOL MULTICOLOR
- PLAYGROUND PROJECT IN ILION - ATHENS,ISRAEL** - SAFEPOL MULTICOLOR
- PLAYGROUND PROJECT WATERFORIN OF SAN ANTONIO - CHILE** - SAFEPOL MULTICOLOR