

# KDF

Sports Flooring Systems & Building Materials

## POLTRACK JOGGING TRACK SBR



[www.kdf.gr](http://www.kdf.gr)

**KDF LTD** ([www.kdf.gr](http://www.kdf.gr)) is one of the most dynamic and export-oriented Greek companies (currently activated in more than 55 countries in 4 continents), based in Greece (EU) and U.A.E too, with production facilities and warehouses in both countries for acrylic and polyurethane materials.

**We are experts in sports, industrial and decorative flooring products and systems**, with huge experience in Europe, Africa, Asia, Middle East and India as well.

Our export horizon is expanding rapidly and our goal is to stand out as a model of flexibility and competitiveness. The company, being one of the pioneer companies in the sector of sports flooring systems and building materials and giving particular attention to providing a fully upgraded range of products and services, provides certified systems by **ITF, IAAF, EU norms, LNE, LABOSPORT, ISASPORT, to name but a few.**

**Our systems are approved in many ministries like:**

- Ministry of Education in U.A.E
- Ministry of Education in K.S.A
- Ministry of Education in Oman
- Ministry of Education in Kuwait and many other institutes like
- Oman Royal Police
- Aramco, K.S.A
- Musanada in U.A.E
- Municipality of Doha
- Municipality of Dubai, Abu Dhabi, Sharjah and many others institutions.

KDF goes far beyond trade, providing consultancy in marketing and also technical support all the way, from the costing till the finalization of the project. Operating under the requirements of ISO 9001/2015 for production, trade and also application, we make sure our products are first applied successfully at site by our own people before we launch them abroad.

Therefore, our systems have all stood the real life test in different climates, from Middle East till Russia, and this is one of our main assets, enabling us to provide full and vertical technical support from specifying to final application plus supervision when required or even full application and costing.

**We invite you to discover a world of sports flooring expertise and solutions.**

VIEW OUR NEW SPORTS CATALOGUE



**KDF - Kataskeves Dapedon LTD**  
e : [exports@kdf.gr](mailto:exports@kdf.gr)  
w : [www.kdf.gr](http://www.kdf.gr)

1 Papanikolaou Ave, Pefka  
57010, Thessaloniki, Greece  
t / f : 0030 2310 829598

# INDICATIVE REFERENCE LIST OF PROJECTS

-12 SCHOOLS IN U.A.E, MINISTRY OF EDUCATION(THROUGH VARIOUS CONTRACTORS) - 40000m<sup>2</sup> EPDM Rubber flooring

-UNIVERSITY OF DAMMAM - KSA - 13000m<sup>2</sup> - Acrylic cushion floorings

-KING ABDULLAH BASE AIR DEFENSE - TAIF, KSA - 12600 m<sup>2</sup> - Running track

-KING FAHD UNIVERSITY OF PETROLEUM AND MINERALS-DHARAN, KSA-12400m<sup>2</sup>-Rubber outdoor flooring

-RUNNING TRACK - K.S.A- 11000 m<sup>2</sup> - Running track, POLTRACK SANDWICH system

-GEMS SCHOOL - DUBAI, U.A.E - 10000 m<sup>2</sup> - Running track

-PASARGRAD WHOLESALE MARKET-IRAN - 10000 m<sup>2</sup> - Decorative flooring

-YAS ISLAND, ABU DHABI, U.A.E - 10000m<sup>2</sup> Bicycle track

-ABHA STADIUM - K.S.A - 9000m<sup>2</sup> - POLTRACK SANDWICH system

-ABU DHABI STADIUM - U.A.E - 9000m<sup>2</sup> - Artificial Grass, POLITURF LEADER 55140

-ALEXANDRIA STADIUM - ALEXANDRIA, EGYPT - 8500 m<sup>2</sup> - Running track

-MINISTRY OF EDUCATION IN KUWAIT - KUWAIT - 8000m<sup>2</sup> - Polyurethane flooring, Polyflex Pu-In system

-SALAM STREET & MINA ROAD, ABU DHABI, U.A.E - 8000m<sup>2</sup> Bicycle track, Sportground-Ex system

-KING FAHAD NAVAL BASE - JUBAIL, KSA - 8000m<sup>2</sup> - Running track

-MUNICIPALITY OF VELVENTO - KOZANI, GREECE - 8000m<sup>2</sup>, Running track

-ABBHA, KSA - 7600m<sup>2</sup> - Running track

-MUNICIPALITY OF ZENICA - ZENICA, BOSNIA& HERZEGOVINA - 7500m<sup>2</sup>, Poltrack Spraycoat, Running track

-ADNOC SCHOOLS - U.A.E - 7000m<sup>2</sup> - Safepol system

-ATLAS CENTER-BAM, IRAN - 7000 m<sup>2</sup> - Decorative flooring

-RUNNING TRACK - SUDAN - 7000 m<sup>2</sup> - Running track, POLTRACK SPRAYCOAT system

-CORNISH, JEDDAH, K.S.A - 6000m<sup>2</sup> Bicycle track Sportground-Ex system

-YOKOGAWA ELECTRIC CORPORATION-DHAHRAN TECHNO VALLEY-DAMMAM, KSA - 5500m<sup>2</sup>- Epoxy antistatic floorings

-AMITY INTERNATIONAL SCHOOL - ABHU DHABI, U.A.E - 5500m<sup>2</sup>, Poltrack Spraycoat, Running Track

-SHUQAIQ WATER AND ELECTRICITY COMPANY - JIZAN, KSA - 5400 m<sup>2</sup> - acrylic courts

-TALEEM UPTOWN SCHOOLS - DUBAI, UAE - 5400m<sup>2</sup>-Acrylic sports courts systems

-SAUDI AIR FORCE - KSA - 5250 m<sup>2</sup> - Acrylic coating elastoturf, running track

-RUNNING TRACK - K.S.A - 5000 m<sup>2</sup> - Running track, POLTRACK SANDWICH system

-AL HAMRA, RAS AL KHAIMAH, U.A.E - 5000m<sup>2</sup> Bicycle track, Sportground-Ex system

-AIRBASE IN TAIF - KSA - 5000 m<sup>2</sup> - Running track

-DEPARTMENT OF EDUCATION ASIR REGION - KHAMIS, KSA - 4500 m<sup>2</sup> - Running track

-SERVIA STADIUM - KOZANI, GREECE - 4500m<sup>2</sup>, Running track

-COMMUNITY COLLEGE - KHAMIS, KSA - 4200 m<sup>2</sup> - Running track

-MULTIPLE RUNNING TRACKS - ALGERIA - 40000 m<sup>2</sup> - Running track, POLTRACK SPRAYCOAT system

-SPORTS CLUB CENTER GLIFADA - ATHENS, GREECE - 4000m<sup>2</sup>- Poltrack Spraycoat, Running Track

-EMIRATES INTERNATIONAL SCHOOL - DUBAI, U.A.E - 4000m<sup>2</sup> - Safepol System, Playground flooring

-HH KHALID BIN BANDAR - RIYADH, KSA - 3800 m<sup>2</sup> - Volleyball/basketball rubber courts

-RUNNING TRACK- UKRAINE - 3600m<sup>2</sup> - RunningTrack, Poltrack Spraycoat system

-ANATOLIA GOLLEGE - THESSALONIKI, GREECE - 3600m<sup>2</sup>, Running track

-AIMARJAN ASLAND – PARTIAL - 3600m<sup>2</sup>- Poltrack Sandwich, Running Track

-RUNNING TRACK - ISRAEL - 3500 m<sup>2</sup> - Running track, POLTRACK SANDWICH system



**-MATRIX SPORTING CLUB - EGYPT - 3400 m<sup>2</sup> - Polyurethane outdoor flooring, Polyflex PU-EX System**  
**-SPORTS CLUB CENTER KISSAMOS - CRETE, GREECE - 3200m<sup>2</sup>- Poltrack Sandwich, Running Track**  
**-AL LUSAIL SPORTS CLUB - DOHA, QATAR - 3200m<sup>2</sup> - Jogging track**  
**-SPORTS CLUB CENTER - SERBIA, GREECE - 3200m<sup>2</sup> - Poltrack Sandwich, Running Track**  
**-STADIUM CENTER - UKRAINE - 3200m<sup>2</sup> - RunningTrack, Poltrack Spraycoat system**  
**-KING KHALID UNIVERSITY - ABHA, KSA - 3100 m<sup>2</sup> - Running track**  
**-AL FAIOUM UNIVERSITY - FAIOUM, EGYPT - 3000m<sup>2</sup>- Polyurethane indoor flooring, Polyflex PU-IN system**  
**-SPORTS CLUB CENTER "PAPAGO" - ATHENS, GREECE - 3000m<sup>2</sup>- Poltrack Sandwich, Running Track**  
**-PANORAMA SPORTS COMPLEX - THESSALONIKI, GREECE - 3000m<sup>2</sup>, Running track**  
**-INDIAN ARMY - SAGAR, INDIA - 2800m<sup>2</sup>- Acrylic sports courts**  
**-ALL SAINTS SCHOOL - MUMBAI, INDIA - 2700 m<sup>2</sup> - PU outdoor sports flooring and running track**  
**-INDIAN INSTITUTE OF SCIENCE EDUCATION AND RESEARCH-BHOPAL, INDIA-2700m<sup>2</sup> -Acrylic sports courts**  
**-OUR OWN GOLF SCHOOL - 2700m<sup>2</sup>- Poltrack Spraycoat, RunningTrack**  
**-AL RAYAN, QATAR - 2500 m<sup>2</sup> - Running track, POLTRACK SANDWICH system**  
**-OUTDOOR SPORTS VENUE - VARNA, BULGARIA - 2500 m<sup>2</sup> - Acrylic, ITF classified, 8 layers system**  
**-ALHOSN SPORTS COMPLEX - 2400 m<sup>2</sup> - Running track, POLTRACK SANDWICH system**  
**-TEACHERS COLLEGE - ABHA, KSA - 2050 m<sup>2</sup> - Running track**  
**-MUSAB BIN OMAIR BOYS SCHOOL - BIN OMRAN, QATAR - 2050 m<sup>2</sup> - PU outdoor sport flooring**  
**-BURAIRAT SCHOOL - RAK, UAE - 2000 m<sup>2</sup> - Running track**  
**-HADAYEK ALAHRAM CLUB - GIZA, EGYPT - 2000m<sup>2</sup>, PU outdoor sports flooring, POLYFLEX PU-EX WET-POUR system**  
**-AL SAILIYA BOYS SCHOOL - AL SAILIYA, QATAR - 2000 m<sup>2</sup> - Polyurethane, outdoor sport flooring**  
**-KING KHALID UNIVERSITY - ABHA, KSA - 2000 m<sup>2</sup> - Volleyball/basketball rubber courts**  
**-HH KHALID BIN BANDAR - RIYADH, KSA - 2000 m<sup>2</sup> - Volleyball/basketball rubber courts**  
**-RAWDA RASHEED PRIMARY SCHOOL FOR BOYS - 2000 m<sup>2</sup>**  
**-DAMIETTA GOVERNMENT - EGYPT - 2000m<sup>2</sup> - Running track, Poltrack Spraycoat Sealed System**  
**-AL WAKAIR BOYS SCHOOL - AL WAKRAH, QATAR - 1950 m<sup>2</sup> - Polyurethane, outdoor sport flooring**  
**-THE LAKE DISTRICT - PUNE, INDIA - 1950m<sup>2</sup>- Acrylic sports courts**  
**-PRESIDENTIAL GUARD COMMAND MAHAWI - ABU DHABI, UAE - 1900m<sup>2</sup> - Football court**  
**-UNITED (SABIC) SPORTS CLUB - 1900 m<sup>2</sup> - Rubber flooring**  
**-SHOOLS MINISTRY OF EDUCATION - KHAMIS, KSA - 1800 m<sup>2</sup> - Rubber floorin**  
**-AL MAJAD AMPHITHEATER - SHARJA, UAE - 1800m<sup>2</sup> - Certified Jogging track**  
**-QASSIM UNIVERSITY - KSA - 1800 m<sup>2</sup> - Polyurethane sports flooring**  
**-AL QADSIYA MODEL INDEPENDENT SCHOOL - ALWAAB, QATAR - 1770 m<sup>2</sup> - PU outdoor sport flooring**  
**-AL WAHDA SPORT ACADEMY CLUB - ABU DHABI, UAE - 1700 m<sup>2</sup> - Acrylic sports system**  
**-ALSARH SCHOOLS OF CIVIL - RIYADH, KSA - 1650m<sup>2</sup> - PU glue/Soccer field**  
**-GD GOENKA PUBLIC SCHOLL - PURNIA, INDIA - 1630m<sup>2</sup>- Acrylic sports courts**  
**-SPA RESORT DERENIVSKUPIA KI - UZHGOROD, UKRAINE - 1600 m<sup>2</sup> - Flexfloor-ex system, volleyball court**  
**-THE MILITARY HOSPITAL - RIYADH, KSA - 1560 m<sup>2</sup> - Volleyball/basketball rubber courts**  
**-THE MILITARY HOSPITAL - RIYADH, KSA - 1560 m<sup>2</sup> - Pu glue-PU sports flooring**  
**-AL FORSHAN SPORTS CENTRE - ABU DHABI, U.A.E - 1500m<sup>2</sup> - Smartfloor system, Acrylic flooring**  
**-INDUSTRIAL FLOORING - BULGARIA - 1500m<sup>2</sup> - Epoxy flooring, Polepox Coat 814 system**  
**-SCHOOL IN AL WAKRA CITY - DOHA, QATAR - 1500 m<sup>2</sup> - Playground flooring**

**-IRAQ ARMY CAMP - IRAQ - 1500m<sup>2</sup> - Acrylic flooring in 2,2mm**

**-SCHOOL IN AL WAKRA CITY - DOHA, QATAR - 1500 m<sup>2</sup> - Playground flooring**

**-PROJECT GREEN LAND - DUBAI, UAE - 1500 m<sup>2</sup> - Jogging track**

**-UP TOWN SCHOOL - 1500m<sup>2</sup>- Poltrack Spraycoat, RunningTrack**

**-INDIAN AIR FORCE - ALLAHABAD, INDIA - 1450m<sup>2</sup> - Acrylic sports courts**

**-DUBAI MODERN HIGH SCHOOL - DUBAI, UAE - 1375 m<sup>2</sup> - Acrylic sports courts**

**-PROJECT ECOGREEN - DUBAI, UAE - 1350 m<sup>2</sup> - Jogging track**

**-POLICE COMPLEX BARRACKS NIZWA - OMAN- 1300 m<sup>2</sup> - Colorflex, PU sport flooring**

**-POLICE COMPLEX BARRACKS AL AJAIZ - OMAN - 1300 m<sup>2</sup> - Colorflex, PU sport flooring**

**-POLICE COMPLEX BARRACKS KATMATMILAH SITE - OMAN- 1300 m<sup>2</sup> - Colorflex, PU sport flooring**

**-POLICE COMPLEX BARRACKS SUWAIQ - OMAN - 1300 m<sup>2</sup> - Colorflex, PU sport flooring**

**-POLICE COMPLEX BARRACKS AL KAMIL - OMAN - 1300 m<sup>2</sup> - Colorflex, PU sport flooring**

**-PLAYGROUND FLOORING - BAHRAIN - 1300m<sup>2</sup> - Safepol system**

**-POLICE COMPLEX BARRACKS SHINAS - OMAN - 1300 m<sup>2</sup> - Colorflex, PU sport flooring**

**-POLICE COMPLEX BARRACKS BHALA - OMAN - 1300 m<sup>2</sup> - Colorflex, PU sport flooring**

**-POLICE COMPLEX BARRACKS MUDHAIBI - OMAN - 1300 m<sup>2</sup> - Colorflex, PU sport flooring**

**-POLICE COMPLEX BARRACKS THUMRAIT - OMAN - 1300 m<sup>2</sup> - Colorflex, PU sport flooring**

**-POLICE COMPLEX BARRACKS AL KHOUDH - OMAN - 1300 m<sup>2</sup> - Colorflex, PU sport flooring**

**-POLICE COMPLEX BARRACKS MAHDAH - OMAN - 1300 m<sup>2</sup> - Colorflex, PU sport flooring**

**-POLICE COMPLEX BARRACKS BID BID - OMAN - 1300 m<sup>2</sup> - Colorflex, PU sport flooring**

**-POLICE COMPLEX BARRACKS AL KHABOORA - OMAN - 1300 m<sup>2</sup> - Colorflex, PU sport flooring**

**-POLICE COMPLEX BARRACKS DHANK - OMAN - 1300 m<sup>2</sup> - Colorflex, PU sport flooring**

**-POLICE COMPLEX BARRACKS HAFEET - OMAN - 1300 m<sup>2</sup> - Colorflex, PU sport flooring**

**-POLICE COMPLEX BARRACKS AUQAD - OMAN - 1300 m<sup>2</sup> - Colorflex, PU sport flooring**

**-POLICE COMPLEX BARRACKS SUMAIL - OMAN - 1300 m<sup>2</sup> - Colorflex, PU sport floor**

**-OUTDOOR SPORTS VENUE - KOSOVO - 1300 m<sup>2</sup> - POLTRACK SPRAYCOAT System**

**-ALHALAFI BREAK - RIYADH, KSA - 1276 m<sup>2</sup> - Rubber flooring**

**-GI-DHOFAR BEACH RESORT & SPA - OMAN - 1225 m<sup>2</sup> - Colorflex, PU sport flooring**

**-RLS BASIC EDUCATION SCHOOL SOHAR - OMAN - 1225 m<sup>2</sup> - Colorflex, PU sport flooring**

**-MIXED BASIC EDUCATION SCHOOL AL QABIL - OMAN - 1225 m<sup>2</sup> - Colorflex, PU sport flooring**

**-BOYS BASIC EDUCATION SCHOOL BARKHA - OMAN - 1225 m<sup>2</sup> - Colorflex, PU sport flooring**

**-GIRLS BASIC EDUCATION SCHOOL MUDHAIBI - OMAN - 1225 m<sup>2</sup> - Colorflex, PU sport flooring**

**-MIXED BASIC EDUCATION SCHOOL AL AMERAT - OMAN - 1225 m<sup>2</sup> - Colorflex, PU sport flooring**

**-UMSALAMA GIRLS SCHOOL - AL RAYYAN, QATAR - 1200 m<sup>2</sup> - Polyurethane, outdoor sport flooring**

**-SHERATON PARK - DOHA, QATAR - 1200 m<sup>2</sup> - Playground flooring**

**-RAWDA BIN JASSIM SCHOOL - AL AZIZIYAH, QATAR - 1200 m<sup>2</sup> - Polyurethane, outdoor sport flooring**

**-GEMS WESTMINISTER SCHOOL - DUBAI, U.A.E - 1200 m<sup>2</sup> - Acrylic sports courts**

**-SILVER SPORTS CLUB - INDIA - 1200m<sup>2</sup>- Acrylic sports courts**

**-OUR OWN SCHOOL - SHARJA, U.A.E - 1200m<sup>2</sup> - Acrylic sports courts**

**-SHARJAH FOOTBALL CLUB - SHARJAH, UAE - 1200 m<sup>2</sup> - Polyurethane basketball courtsing**

**-MATRIX SPORTING CLUB - EGYPT - 1300 m<sup>2</sup> - Acrylic flooring, Flexfloor System**

**-SHERATON PARK - DOHA, QATAR - 1200 m<sup>2</sup> - Playground flooring**

**-SYMBIOSIS COLLEGE - INDIA - 1180m<sup>2</sup> - Acrylic sports courts**

**-PROFESSOR ABDULAZIZ ANQARI - RIYADH, KSA -1150m<sup>2</sup> - PU glue/Socccer field**

**-AL SAQID ISLAMIC ENGLISH SHCOLL-DUBAI,UAE-1100m<sup>2</sup>- Acrylic flooring, WET-POUR POLYFLEX AEL-EX**  
**-FIRST POINT SCHOOLS - DUBAI, UAE - 1100m<sup>2</sup> - Acrylic sports courts**  
**-MAADI BRITISH SCHOOL- EGYPT - 1100m<sup>2</sup>, Multipurpose court, COLORFLEX system**  
**-DUBAI AMERICAN ACADEMY - DUBAI, UAE - 1080 m<sup>2</sup> - Acrylic sports court**  
**-PRELUDE PUBLIC SCHOOL - AGRA, INDIA - 1070m<sup>2</sup>- Acrylic sports courts**  
**-ALMGBAL BREAK - RIYADH, KSA - 1050 m<sup>2</sup> - Rubber playground**  
**-BANIYAS CLUB AND AL AIN ENGLISH SPEAKING SCHOOL - ABU DHABI, UAE - 1000m<sup>2</sup> - Acrylic flooring**  
**-WADY DEGLA LOTUS PROJECT - CAIRO, EGYPT- 1000 m<sup>2</sup> - Acrylic flooring, Wet-Pour Polyflex AEL-EX system.**  
**-MINISTRY OF EDUCATION - DAMMAM, KSA - 1000 m<sup>2</sup> - PU indoor multipurpose sports flooring**  
**-SHEIKH OBEID MAKTHOUM PALACE - 1000m<sup>2</sup> - Outdoor polyurethane flooring**  
**-INDIAN AIR FORCE - AGRA, INDIA - 1000m<sup>2</sup>- Acrylic sports courts**  
**-INDIAN AIR FORCE - LUCKNOW, INDIA - 1000m<sup>2</sup>- Acrylic sports courts**  
**-MULTIPURPOSE POLYURTEHANE INDOOR COURTS - F.Y.R.O.M - 1000m<sup>2</sup> - Polyflex PU-In system**  
**-SODIC PROJECT - EGYPT - 1000m<sup>2</sup>, Multipurpose court, COLORFLEX system**  
**-INDIAN AIR FORCE - VARANASI, INDIA - 1000m<sup>2</sup>- Acrylic sports courts**  
**-INTERNATIONAL SCHOOL OF CREATIVE SCHIENCE - SHARJAH, U.A.E - 1000m<sup>2</sup> - Safepol System**  
**-INDIAN AIR FORCE - BIHTA, INDIA - 1000m<sup>2</sup>- Acrylic sports courts**  
**-INDIAN AIR FORCE - DARBHANGA, INDIA - 1000m<sup>2</sup>- Acrylic sports courts**  
**-AL AIN INDIAN SCHOOL - AL AIN, UAE - 1000m<sup>2</sup> - Football court**  
**-DUBAI SCHOLRAS PRIVATE SCHOOL - DUBAI, U.A.E - 1000m<sup>2</sup> - Acrylic flooring in 2,2mm**  
**-COMMUNITY COLLEGE - KHAMIS, KSA - 940 m<sup>2</sup> - Polyurethane indoor multipurpose sports flooring**  
**-GEMS METROPOLE SCHOOL - DUBAI, U.A.E - 900 m<sup>2</sup> - Playground flooring**  
**-MINISTRY OF EDUCATION - ABHA, KSA - 900 m<sup>2</sup> - Polyurethane indoor multipurpose sports flooring**  
**-BAB AL SHAMS SPA HOTEL - DUBAI, UAE - 900m<sup>2</sup> - Football court**  
**-KING KHALID UNIVERSITY - ABHA, KSA - 820 m<sup>2</sup> - Polyurethane indoor multipurpose sports flooring**  
**-SCHOOL IN AL WAKRA CITY - DOHA, QATAR - 800m<sup>2</sup> - Polyurethane sports flooring**  
**-SULTAN MANOR - RIYADH, KSA - 800 m<sup>2</sup> - Polyurethane multipurpose sports flooring**  
**-MINISTRY OF EDUCATION - AL KHARIZ, KSA - 800 m<sup>2</sup> - PU indoor multipurpose sports flooring**  
**-INDOOR SPORTS COURT - MALAYSIA - 800 m<sup>2</sup> - PU indoor sports flooring**  
**-KID'S PLAY AREA IN MALL - MOROCCO - 800 m<sup>2</sup> - PU indoor sports flooring, POLYFLEX PU-IN system**  
**-DUBAI ENGLISH SPEAKING COLLEGE - DUBAI, UAE - 783m<sup>2</sup> - Acrylic flooring, SPORTFLOOR-EX, HARD COURT**  
**-SINGAPORE AIRLINES - SINGAPORE - 735m<sup>2</sup> - PU indoor sports flooring**  
**-AL DAJAN COMPANY - GASIM, KSA - 722 m<sup>2</sup> - Polyurethane sports flooring/Tennis court**  
**-SELECTIVE GOVERNMENT HIGH SCHOOL - EGYPT - 720m<sup>2</sup>, Outdoor sports flooring**  
**-INDIAN AIR FORCE - AHMEDABAD, INDIA - 720m<sup>2</sup>- Acrylic sports courts**  
**-FITNESS TIME - FAYSALIA, DAMMAM, KSA - 700 m<sup>2</sup>-PU indoor multipurpose sports flooring/running track**  
**-FITNESS TIME YASMEEN - RIYADH, KSA - 700 m<sup>2</sup> - PU indoor multipurpose sports flooring/running track**  
**-FERRARI WORLD - ABU DHABI, UAE - 700m<sup>2</sup> - Playground flooring**  
**-FITNESS TIME JUNIOR - RIYADH, KSA - 700 m<sup>2</sup> - PU indoor multipurpose sports flooring/running track**  
**-FITNESS TIME - OLAYA RIYADH, KSA - 700 m<sup>2</sup> - PU indoor multipurpose sports flooring/ running track**  
**-FITNESS TIME WAHA - RIYADH, KSA - 700 m<sup>2</sup> - PU indoor multipurpose sports flooring/running track**  
**-FITNESS TIME, NOOR BRANCH - DAMMAM, KSA -700 m<sup>2</sup> - PU indoor sports flooring and running track**  
**-FITNESS TIME, ALAMEEN BRANCH - DAMMAM, KSA - 700 m<sup>2</sup> - PU indoor sports flooring and running track**  
**-FITNESS TIME, PLUS RIYADH - RIYADH, KSA - 700 m<sup>2</sup> - PU indoor sports flooring and running track**

**-FITNESS TIME, SALAMA BRANCH BRO & FITNESS - JEDDAH, KSA - 700 m<sup>2</sup> - PU indoor sports flooring**  
**-FITNESS TIME, 40th BRANCH - JEDDAH, KSA - 700 m<sup>2</sup> - PU indoor sports flooring and running track**  
**-NASR CLUB- EGYPT - 700m<sup>2</sup>, Multipurpose court, POLYFLEX WET-POUR system**  
**-HUREL DOUBLE 3 - RAS AL KHAIMH, KSA - 700 m<sup>2</sup> - Shockpad plus acrylic coatings**  
**-THE SUSTAINABLE CITY - DUBAI, U.A.E - 700 m<sup>2</sup> - Acrylic flooring**  
**-EMAAR - EMIRATES HILLS 2 - DUBAI, U.A.E - 700m<sup>2</sup> - Basketball court, Acrylic flooring**  
**-AIRFORCE SURBOTO PARK - NEW DELHI, INDIA - 680 m<sup>2</sup> - Polyurethane outdoor sports flooring**  
**-INDIAN ARMY - DHRANGDHARA, INDIA - 670m<sup>2</sup>- Acrylic sports courts**  
**-MT.SAINT PATRICK ACADEMY - INDIA - 665m<sup>2</sup>- Acrylic sports courts**  
**-REGIONAL HQ AT BURAIMI - OMAN - 650 m<sup>2</sup> - Colorflex, PU sport flooring**  
**-ROYAL OMAN POLICE TASK FORCE RUSTAQ - OMAN - 650 m<sup>2</sup> - Colorflex, PU sport flooring**  
**-ROYAL OMAN POLICE TASK FORCE LIWA - OMAN - 650 m<sup>2</sup> - Colorflex, PU sport flooring**  
**-ROYAL OMAN POLICE TASK FORCE AL SALIL - OMAN - 650 m<sup>2</sup> - Colorflex, PU sport flooring**  
**-ROYAL OMAN POLICE TASK FORCE IBRI - OMAN - 650 m<sup>2</sup> - Colorflex, PU sport flooring**  
**-ROYAL OMAN POLICE TASK FORCE IBRA - OMAN - 650 m<sup>2</sup> - Colorflex, PU sport flooring**  
**-ROYAL OMAN POLICE TASK FORCE AL SUR - OMAN - 650 m<sup>2</sup> - Colorflex, PU sport flooring**  
**-ROYAL OMAN POLICE TASK FORCE AL DUKUM - OMAN - 650 m<sup>2</sup> - Colorflex, PU sport flooring**  
**-ROYAL OMAN POLICE TASK FORCE AL BURAIMI - OMAN - 650 m<sup>2</sup> - Colorflex, PU sport flooring**  
**-ROYAL OMAN POLICE TASK FORCE AL NIZWA - OMAN - 650 m<sup>2</sup> - Colorflex, PU sport flooring**  
**-ROYAL OMAN POLICE TASK FORCE AL SUWAIQ - OMAN - 650 m<sup>2</sup> - Colorflex, PU sport flooring**  
**-ABU DHABI MUNICIPALITY - ABU DHABI , UAE - 650 m<sup>2</sup> - Acrylic flooring**  
**-ROYAL OMAN POLICE TASK FORCE AL SALALAH - OMAN - 650 m<sup>2</sup> - Colorflex, PU sport flooring**  
**-ROYAL OMAN POLICE TASK FORCE AL BARKHA - OMAN - 650 m<sup>2</sup> - Colorflex, PU sport flooring**  
**-ROYAL OMAN POLICE TASK FORCE KHOUDH - OMAN - 650 m<sup>2</sup> - Colorflex, PU sport flooring**  
**-MULTIPURPOSE COURTS - TIRANA, ALBANIA - 650 m<sup>2</sup> - Acrylic sports flooring, FLEXFLOOR system**  
**-MOHAMMED JASSIM M AL THANI SCHOOL - UMSALALALI, QATAR - 620 m<sup>2</sup> - PU outdoor sport flooring**  
**-QATAR GEMS SCHOOL - DOHA, QATAR - 615 m<sup>2</sup> - Polyurethane sports flooring**  
**-VAISHNO DEVI - DELHI, INDIA - 608 m<sup>2</sup> - Polyurethane outdoor sports flooring**  
**-INDIAN ARMY - AGRA, INDIA - 600m<sup>2</sup>- Acrylic sports courts**  
**-THE INTERNATIONAL SCHOOL - AGRA, INDIA - 600m<sup>2</sup>- Acrylic sports courts**  
**-INDIAN ARMY - JHANSI, INDIA - 600m<sup>2</sup>- Acrylic sports courts**  
**-THE SUSTAINABLE CITY - DUBAI, U.A.E - 600 m<sup>2</sup> - Safepol system**  
**-AMITY SCHOOL, JUMEIRAH ISLAND - DUBAI, UAE - 600 m<sup>2</sup> - Safepol system**  
**-OUR OWN ENGLISH HIGH SCHOOL - SHARJAH, U.A.E - 600 m<sup>2</sup> - Flexfloor system**  
**-OUR OWN ENGLISH HIGH SCHOOL - SHARJAH, U.A.E - 600 m<sup>2</sup> - Polyflex Ael-EX system**  
**-SKATING FOR KIDS - GUJARAT, INDIA - 600 m<sup>2</sup> - Sportfloor system**  
**-NEW DUBAI BRADENTON SCHOOL- DUBAI, UAE - 570 m<sup>2</sup> - Acrylic sports courts**  
**-DUBAI SILICON OSIS-CENTRAL PARK, DSO - DUBAI, UAE - 560 m<sup>2</sup> - Jogging track**  
**-MPS WORLD SCHOOL - AGRA, INDIA - 560m<sup>2</sup>- Acrylic sports courts**  
**-AL WUKAIR GIRLS SCHOOL - AL WAKRAH, QATAR - 550 m<sup>2</sup> - Polyurethane, outdoor sport flooring**  
**-BBPS - DELHI, INDIA - 512 m<sup>2</sup> - Polyurethane outdoor sports flooring**  
**-IVY STATE - PUNE, INDIA - 511m<sup>2</sup>- Acrylic sports courts**  
**-KUNAL ICONIA - INDIA - 510m<sup>2</sup>- Acrylic sports courts**  
**-AMERICAN SCHOOL OF DUBAI - DUBAI, UAE - Acrylic sports courts**

**-ETIHAD MUSEUM - JUMEIRAH, DUBAI, UAE** - Rubber flooring

**-CARPARKING - ABU DHABI, UAE** - Acrylic flooring

**-DUBAI MILLENIUM SCHOOL - QUSAIS, UAE** - Acrylic sports courts

**-AMERICAN UNIVERSITY - DUBAI, UAE** – Acrylic outdoor sports flooring

**-RAK ACADEMY - RAK, UAE** - Acrylic flooring

**-ISCS - SHARJA, UAE** - Acrylic flooring

**-THE INTERNATIONAL SCHOOL OF CHOUEIFAT - AJMAN, U.A.E** - Sportground-Ex system

**-THE KINDER GARDEN STARTERS - DUBAI, U.A.E** - Safepol system

**-AL ZAHIA PROJECT - SHARJA, UAE** - Safepol system

**-WADY DEGLA SHERATON CLUB - CAIRO, EGYPT** - Acrylic sports flooring

**-GEMS WELLINGTON SCHOOL - DUBAI, U.A.E** - Safepol system

**-JUMEIRAH RETAIL DEVELOPMENT - JUMEIRAH, DUBAI, UAE** - Safety rubber flooring

**-MR.ABDULRHMIN - JUBAIL, KSA** - Rubber playground

**-GEMS WESTMINISTER SCHOOL - DUBAI, U.A.E** - Safepol system

**-POLYURETHANE INDOOR SPORTS COURT - TIRANA, ALBANIA** - Polyflex PU-In system

**-MULTIPURPOSE COURTS - ODESSA, UKRAINE** - Rubber flooring

**-MULTIPURPOSE COURTS - ZHOVKVA, UKRAINE** - Rubber flooring

**-MUNICIPAL TENNIS CLUB - PATRA, GREECE** - Flexfloor-EX system, Acrylic sports courts

**-INDIAN AIR FORCE - GORAKHPUR, INDIA** - Acrylic sports courts

**-INDIAN AIR FORCE - BAREILLY, INDIA** - Acrylic sports courts

**-INDIAN ARMY - BABINA, INDIA** - Acrylic sports courts

**-ADAM AIRBASE PACKAGE 8, OMAN** - Colorflex, PU sport flooring

**-GOLD GYM - KOLKATTA, INDIA** - Polyurethane indoor sports flooring

**-MINISTRY OF FOREIGN AFFAIRS - ABU DHABI, UAE** - Polyurethane flooring

**-SHRJAH SPORTS CLUB - SHARJAH, UAE** - Polyurethane flooring

**-GEMS WINCHESTER SCHOOL - AL BARSHA SOUTH, UAE** - Acrylic sports system

**-HOTEL DOUBLE 3 - RAS AL KHAIMAH, UAE** - Prefabricated shock-pad 4mm plus acrylic coatings

**-ALNABBAGH STABLE - AL AIN, U.A.E** - Polyurethane flooring, POLTRACK EQUESTRIAN FLOORING

**-AL WAHDA CLUB - ABU DHABI, UAE** - Rubber flooring

**-ADJD MAIN BUILDING LANDSCAPE PROJECT - ABU DHABI, UAE** - Rubber flooring

**-KADEEJ AL KURBA SCHOOL - ABU DHABI, UAE** - Rubber flooring

**-INTERNATIONAL SCHOOL OF CREATIVE SCIENCE - SHARJA, U.A.E** - Flexfloor system/Outdoor Multipurpose court

**-ENVIRO, VATIKA HOTELS PVT.LTD - GURGAON, INDIA** - Acrylic sports flooring

**-ASHIANA - BHUBANESHWAR, INDIA** - Acrylic sports flooring

**-TCS, ADIBATLA - HYDERABAD, INDIA** - Acrylic sports flooring

**-IPS, ERODE - CHENNAI, INDIA** - Acrylic sports flooring

**-LIONS GATE - MUMBAI, INDIA** - Acrylic sports flooring

**-MORNING GLORY INFRA LIMITED - KANPUR, INDIA** - Acrylic sports flooring

**-NAMBIAR - BANGALORE, INDIA** - Acrylic sports flooring

**-PATHWAYS - GURGAON, INDIA** - Acrylic sports flooring

**-WELHAMS GIRLS SCHOOL - DEHRADUN, INDIA** - Acrylic sports flooring

**-WOODDUCK COMMERCIAL CENTER- IRAN** - Industrial flooring

**-ARABIAN RANCHES by EMAR - DUBAI, U.A.E** - Playground flooring



**-OUR OWN ENGLISH HIGH SCHOOL - SHARJAH, U.A.E** - Playground flooring

**-POLO CLUB GHANTOOT - ABU DHABI, U.A.E** - Polyurethane flooring, POLTRACK EQUESTRIAN FLOORING

**-RAK MODERN SCHOOL - RAS AL KHAIMAH, U.A.E** - Playground flooring

**-GIIS/GLOBAL INDIAN INTERNATIONAL SCHOOL - RAS AL KHAIMAH, U.A.E** - Playground flooring

**-MINISTRY OF EDUCATION, NAD AL HAMAR BOYS SCHOOL - DUBAI, U.A.E** - Playground flooring

**-K.G. KIDS SCHOOL - AALI, BAHRAIN** - Playground flooring

**-SABIC BEACH CAMPS PROJECT - JUBAIL, K.S.A** - Outdoor sports flooring, artificial grass.

**-MINISTRY OF EDUCATION, MIZHER GIRLS SCHOOL - DUBAI, U.A.E** - Playground flooring

**-WARSAN STABLE** - Polyurethane flooring, POLTRACK EQUESTRIAN FLOORING

**-AL SHIMAL PARK - DOHA, QATAR** - Playground flooring

**-UM SELAL PARK - DOHA, QATAR** - Playground flooring

**-AL KABAN PARK - DOHA, QATAR** - Playground flooring

**-GEMS METROPOLE SCHOOL - DUBAI, U.A.E** - Hard court system/Outdoor Multipurpose court

**-ARABIAN RANCHES by EMAR - DUBAI, U.A.E** - Acrylic Outdoor Tennis and Basketball courts

**-RAK MODERN SCHOOL - RAS AL KHAIMAH, U.A.E** - Flexfloor system

**-GIIS/GLOBAL INDIAN INTERNATIONAL SCHOOL - RAS AL KHAIMAH, U.A.E** - Acrylic system

**-AVALON HEIGHTS - AJMAN, U.A.E** - Acrylic floorings

**-DELHI PRIVATE SCHOOL - DUBAI, U.A.E** - Acrylic flooring

**-ROYAL COMMISSION SCHOOL - JUBALI, KSA** - Acrylic sports flooring

**-FITNESS TIME PRO - AL AHSA BRANCH - KSA** - Flexfloor, Basketball court

**-FITNESS TIME PRO - MAKKAH SHARAIE - KSA** - Flexfloor, Basketball court

**-BIN HAM - AL AIN, UAE** - Polyurethane flooring

**-SHAMMA BINT MOHAMMED SHOOOL - AL AIN, UAE** - Polyurethane flooring

**-ABDULLAH BIN OTAIBA - ABU DHABI, UAE** - Polyurethane flooring

**-LIWA INTERNATIONAL SCHOOL - AL AIN, U.A.E** - Colorflex outdoor sport system.

**-ZOHOUR KG - MANAMA, BAHRAIN** - Polyurethane sports flooring

**-RAWDA RASHED - QATAR-** Polyurethane, outdoor sport flooring

**-SAAD BIN ABI WAQAS SCHOOL - AL RAYYAN, QATAR** - Polyurethane, outdoor sport flooring

**-FITNESS TIME PRO - MADINS RING ROAD BRANCH - KSA** - Flexfloor, Basketball court

**-AGRA CHAIN - AGRA, INDIA** - Acrylic sports flooring

**-SUNWORLD - NOIDA, INDIA** - Acrylic sports flooring

**-SSN INVESTMENTS PRIVATE LIMITED, FRIENDS COLONY - DELHI, INDIA** - Acrylic sports flooring

**-AJNARA - NOIDA, INDIA** - Acrylic sports flooring

**-BRIGHT RIDERS SCHOOL - ABU DHABI, UAE** - Running track, Acrylic sports court

**-OUR OWN ENGLISH HIGH SCHOOL - SHARJAH, U.A.E** - Poltrack Spaycoat system

**-NCC - JAIS, INDIA** - Acrylic sports flooring

**-ALPHA FOUNDATION FOR EDUCATION & RESEARCH - TRICHIRAPALLI, INDIA** - Acrylic sports flooring

**-PUSHPANJALI FARMS - NEW DELHI, INDIA** - Acrylic sports flooring

**-M3M - MERLIN GURGAON, INDIA** - Acrylic sports flooring

**-NORTH LONDON COLLEGIATE SCHOOL - DUBAI, U.A.E** - Playground flooring

**-FOOT COURT - EGYPT** - Running track, POLTRACK SPRAYCOAT system

**-FITNESS TIME ANDALUS BRANCH - JEDDAH, K.S.A** - Acrylic sports flooring, FLEXFLOOR SYSTEM

**-ST.JOSEPHS WOMENS COLLEGE - ALLEPPEY, KERALA, INDIA** - Polyurethane outdoor sports flooring

**-WADY DEGLA SHERATON CLUB - CAIRO, EGYPT** - Acrylic sports flooring

- RAILWAY SPORTS GROUND - GUNTAKAL, ANDRA PRADESH, INDIA - Acrylic sports flooring**
- TERVEL PROJECT - TERVEL, BULGARIA - Playground flooring, SAFEPOL system**
- INDOOR COURT - UKRAINE - Polyflex PU-In system**
- PRIVATE JOB - HYDERABAD, SOUTH INDIA - Acrylic outdoor sports flooring**
- RAILWAY SPORTS GROUND -GUNTAKAL, ANDRA PRADESH, INDIA-Acrylic outdoor sports flooring, 5 layers**
- MINISTRY OF EDUCATION U.A.E - Playground flooring**
- PLAYGROUND FLOORING - VARNA, BULGARIA - SAFEPOL System**

# PHOTOGRAPHS OF PROJECTS

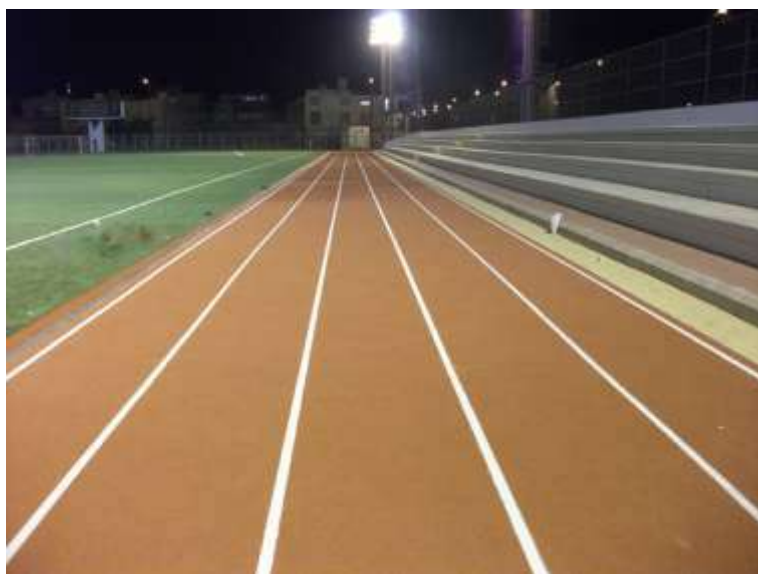

# PAH TEST REPORT

## PU BINDER 1118



Intertek Consumer Goods GmbH · Würzburger Straße 152 · 90766 Fürth · Germany

**KATASKEVES DAPEDON LTD - KDF**  
MRS. Maria Nikolaidoy  
Mitropoleos 19  
54024 Thessaloniki  
GREECE



Fürth, May 11/2020

### TEST REPORT No. FUTYP2020-01959-A

Date sample received: March 06/2020  
Period of testing: March 19/2020 – April 29/2020  
Technical Director: Kerstin Scharrer

**Sample description: PU Binder 1118**



*For the test results please refer to next pages*

Intertek Consumer Goods GmbH  
Würzburger Straße 152  
90766 Fürth, Germany

Tel.: +49 911 74075 0  
Fax: +49 911 74075 30  
cg.germany@intertek.com

Sitz Fürth  
Amtsgericht Fürth, HRB 5756  
USt-IdNr. DE169317871

Geschäftsführer  
Reinhold Gehling





## Test order

Test of a product for migration of certain elements acc. to EN 71 part 3

Summary	Results
DIN EN 71-3 (Safety of toys) – Migration of certain elements	<b>pass</b>

### Sample description:

No. 22:	PU binder
---------	-----------

## Test results

Abbreviations:

n.d. = not determinable (< LoQ)

LoQ = limit of quantification

### 1. Migration of certain elements

#### 1.1 Migration of certain elements -17 Elements- according to DIN EN 71-3

Sampling, extraction: DIN EN 71-3:2019-08

Measurement: ICP-OES: DIN EN ISO 11885:2009-09 / Hg: DIN EN ISO 17852:2008-04 (AFS)

#### Test results in mg/kg

Parameter	LoQ	limit value category III	Sample No. 22
Aluminium	10	70 000 (28 130) <sup>y</sup>	n.d.
Antimony	2	560	n.d.
Arsenic	1	47	n.d.
Barium	10	18 750	n.d.
Boron	10	15 000	n.d.
Cadmium	0.1	17	n.d.
Chromium (III)	3	460	n.d.
Cobalt	1	130	n.d.
Copper	10	7 700	n.d.
Lead	0.5	23	n.d.
Manganese	10	15 000	n.d.
Mercury	0.5	94	n.d.
Nickel	5	930	n.d.
Selenium	2	460	n.d.
Strontium	10	56 000	n.d.
Tin	3	180 000	n.d.
Zinc	10	46 000	n.d.

<sup>y</sup> new limit for Aluminium valid as of May 20<sup>th</sup>, 2021; see directive (EU) 2019/1922

## 1.2 Migration of certain elements -Chromium VI- according to DIN EN 71-3

Sampling, extraction: DIN EN 71-3:2019-08  
Measurement IC- Matrix Elimination

### Test results in mg/kg

	LoQ	limit value category III	Sample No. 22
Chromium VI	0.01	0.053	n.d.

### Conclusion

The tested sample of the presented product "**PU Binder 1118**" conforms to the requirements of DIN EN 71 Part 3 category 3.

---

**General note:**

This report has been prepared for the titled project or named part thereof and should not be relied upon or used for any other project without an independent check being carried out as to its suitability and prior written authority of Intertek being obtained. Intertek accepts no responsibility or liability for the consequences of this document being used for a purpose other than the purposes for which it was commissioned. Any person using or relying on the document for such other purposes agrees, and will by such use or reliance be taken to confirm his agreement to indemnify Intertek for all loss or damage resulting therefrom. Intertek accepts no responsibility or liability for this document to any party other than the person by whom it was commissioned.

We would like to point out, that Intertek can't provide legally binding assessments referring to isolated cases. The individual legal advice in Germany is reserved to the legal advisory professions and a binding interpretation is subject to the court of justice.

Copying excerpts or otherwise reproducing parts of the test report is permitted only with the consent of the laboratory accepting the order. This report pertains only to the test item(s).

All testing requests are subject to our Terms and Conditions available on [www.intertek.com](http://www.intertek.com).

END OF REPORT



# JOGGING TRACKS

## POLTRACK JOGGING TRACK - SBR

Elastic, seamless, flexible colored flooring, ideal for jogging tracks.

It consists of a shock-pad base of **RECYCLED RUBBER 858** (granulometry 0.5-2mm) with **PU BINDER 1118**. Then follows a PU flexible pore filler coating **POLYSPORT STUCCO 1050** in 2 layers and a sealing PU, UV-resistant aliphatic top layer, **POLYSPORT 1052**, in two crossing layers.

The success in the application depends on the right preparation of the underlay and use of the material.



### Steps:

1. **PU PRIMER 870 - Polyurethane primer.**  
Applied by brush, roller or spray.
2. **Mixture of PU BINDER 1118 and RECYCLED RUBBER 858** (in granulometry of 2-5mm or 3-5mm) applied by paving machine.
3. **POLYSPORT STUCCO 1050 - Polyurethane, elastic, two-component pore filler.**  
Used for sealing porous prefabricated subfloor of sports floorings such as **ISOPOL 854** or wet-pour cushion shock-pads. Applied by flat trowel.
4. **POLYSPORT 1052 - UV-resistant, polyurethane, two-component, mat or glossy top coating for outdoor sports floorings.**  
Applied in two crossing layers, by airless spray or rollers.

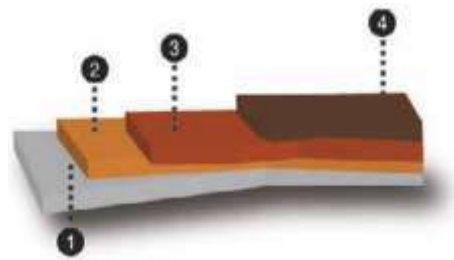

Description	Consumption
PU PRIMER 870 - Polyurethane primer.	0.2kg/m <sup>2</sup> for 1 layer
<b>BASE LAYER</b>	
PU BINDER 1118 - Polyurethane binder.	1.6kg/m <sup>2</sup> for 16mm mixture
RECYCLED RUBBER 858 in granulometry of 2-5mm or 3-5mm.	10.4kg/m <sup>2</sup> for 16mm mixture
<b>SEALING LAYER</b>	
POLYSPORT STUCCO 1050 - Polyurethane, elastic, two-component pore filler.	1.5kg/m <sup>2</sup> for 2 layers
<b>TOP COATING</b>	
POLYSPORT 1052 - UV-resistant, polyurethane, two-component, mat or glossy top coating for outdoor sports floorings.	0.25kg/m <sup>2</sup> for 2 layers



## POLTRACK JOGGING TRACK SBR SYSTEM

Total thickness 18mm

---



**Elastic, seamless, flexible coloured flooring, ideal for jogging tracks.** It consists of a base layer of SBR granules (granulometry 0.5-2mm) and then follows a PU flexible pore filler coating in 2 layers and a sealing PU UV resistant aliphatic top layer in two crossing layers.

### Steps:

**1. PU PRIMER 870 - Polyurethane primer.**

Applied by brush, roller or spray.

**2. Mixture of PU BINDER 1118 and RECYCLED RUBBER 858** applied by paving machine.

**3. POLYSPORT STUCCO 1050 - Polyurethane, elastic, two-component pore filler.**

Applied by flat trowel.

**4. POLYSPORT 1052 - UV-resistant, polyurethane, two-component, top coating for outdoor sports floorings.**

Applied in two crossing layers, by airless spray or rollers.

### Preparation – Application

**Applied only on dry asphalt and concrete surfaces (over 30 days old from date of placement) without rising humidity issues and free of materials that might prevent bonding e.g. dust, loose particles, grease etc.** The success in the application depends on the right preparation of the underlay and use of the material.

- Priming of the surface with polyurethane primer, **PU PRIMER 870**, with an airless sprayer or brush. Consumption: 0,2 kg/m<sup>2</sup>, 2 layers.
- After 5-12 hours and when the primer is almost dry but not completely, follows the application of the **mixture of PU BINDER 1118 and SBR granules** with paver machine in thickness of 13mm.

- Afterwards when the surface of the base layer is dry, follows the application of polyurethane elastic pore filler **POLYSPORT STUCCO 1050 with metal trowels to create a completely non porous surface**. Consumption: 1,5 kg kg/m<sup>2</sup> for 2 layers.
- Before the last **UV top layers** are applied, the surface needs the use of sandpaper machine to make a completely even surface without any irregularities or crumbs.
- After sanding the whole surface, follows the application of UV-resistant, aliphatic, two-component top coat, **POLYSPORT 1052**, in two cross layers by airless spray or by rollers. Consumption: 0,25kg/m<sup>2</sup>.

### Important Remarks

- During summer or during temperatures over 40 degrees, ideal time for the application of **POLTRACK JOGGING TRACK SBR** is between 22:00 and 09:00 and the minimum bearing temperature during application and drying should be over 10°C.
- In case the second layer of PU pore filler is applied after more than 24 hours of the application of the first one then the whole surface must be sanded by a special sanding machine. After that the second layer can be applied.
- In case the layer of PU top coat is applied after more than 24 hours of the application of the last layer of PU pore filler then the whole surface must be sanded by a special sanding machine. After that the PU top coat can be applied.
- In case the second layer of PU top coat is applied after more than 24 hours of the application of the first one then the whole surface must be sanded by a special sanding machine. After that the second layer can be applied.
- The freshly coated surface should be protected from high temperatures, wind, rain and frost for at least the first 24 hours.

### Substrate

**Asphalt is the safer subfloor for sport floorings for sure and must be always preferred than concrete surfaces.**

#### **A. Asphalt Substrate**

**The asphalt must have a slope of 0.7-1% and must dry for at least 30 days so that all solvents from the asphalt can evaporate.**

The asphalt sub-floor should be applied on well compacted 150mm road base sub-floor and asphalt should be laid in one layer (and not 2) in 6 to 8cm with fine and coarse aggregates (up to 15mm granulometry) like the kind of asphalt used in road construction.

So, new road-grade asphalt will have to be laid (minimum 60mm) in one layer containing coarse aggregates and then mature for 30 days at least, before any application takes place on top of the asphalt to avoid bubbles on the final layer of the sport or rubber floorings.

## Asphalt Infrastructure

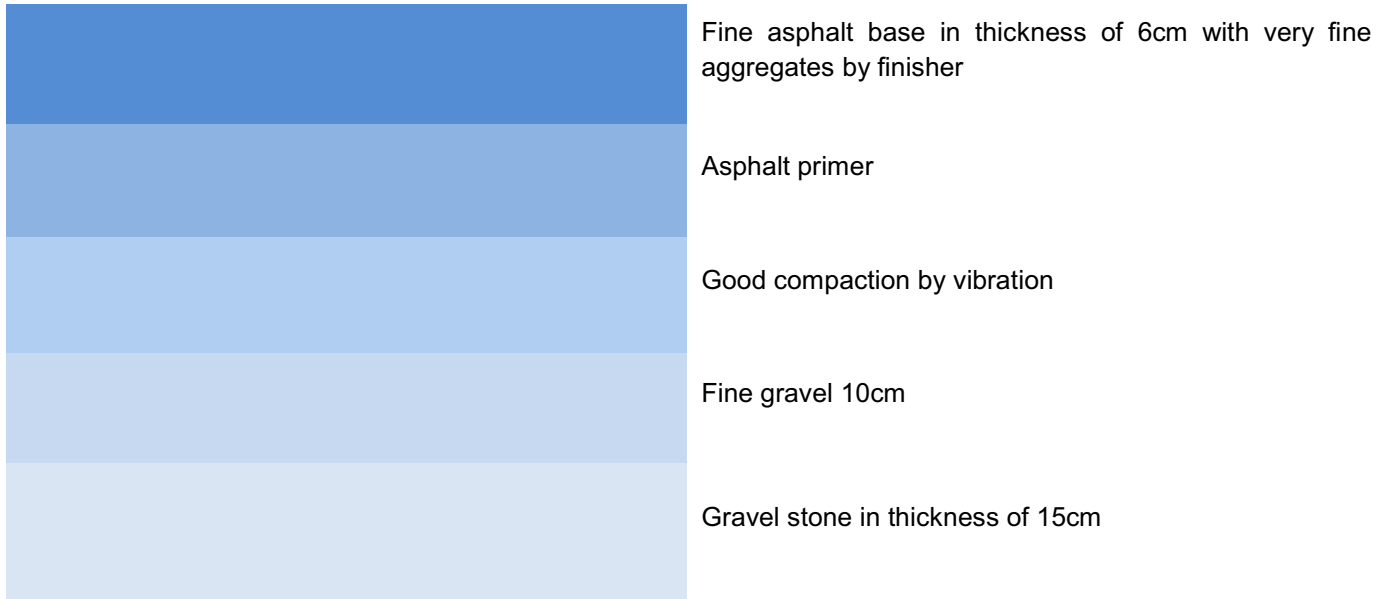

### B. Concrete Surface

**Concrete surface must be power-trowelled without cracks and must be smooth with a slope of 0.7-1% and humidity under 4% in 10cm depth of concrete.**

Concrete must also be **dry at least for 40 days** and then the application takes place if there is no rising humidity for the sub-floor. Before the application takes place, there must be proper grinding of the surface by a grinding machine to open the pores accordingly and also a measurement by special instrument to measure humidity on the surface and in 10cm under the surface.

Generally concrete is a risky sub-floor and there may be problems with rising humidity, especially in areas where the sea level is really high and when the sea is close or in areas near greenery.

**Always make expansion joints in large areas of concrete, in order to avoid uncontrollable cracks and failures.** Joints should be every 25 square meters creating a grid of 5x5 meters or close to that.

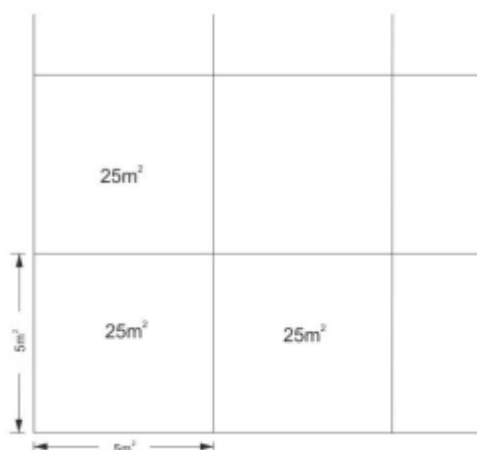

<b><u>SUBSTRATE REQUIREMENTS</u></b>	Concrete quality	at least C20/25
	Age:	at least 40 days
	Moisture content:	below 4%

**Tools:**



**Colors:** Following colorchart.





The colors may vary slightly from the original due to digital representation.



The colors may vary slightly from the original due to digital representation.

# PU PRIMER 870

TRANSPARENT, ONE COMPONENT, POLYURETHANE-BASED PRIMER, USED AS AN ADHESIVE COMPONENT BETWEEN SUBFLOOR AND SPORTS SYSTEMS

## GENERAL CHARACTERISTICS

**POLYURETHANE PRIMER 870** is a clear, polyurethane-based, one-component primer, which is used as an adhesive component between the sub-floor and sport systems.

- Penetrates in depth.
- Ideal for old and new surfaces.

## TECHNICAL DATA

Basis:	one-component polyurethane
Appearance:	liquid
Color:	transparent
Viscosity:	50 – 250 mPa s at 25°C
Density:	0.9- 1.0 Kg/Lt
Temperature for the application and drying of the material:	10 – 40°C

## PREPARATION-APPLICATION

**Applied on dry surfaces without rising humidity issues, free of materials that might prevent bonding e.g. dust, loose particles, grease etc (in case of asphalt or concrete).** The success in the application depends on the right preparation of the underlay and use of the material.

- **Good, dry** cleaning of the surface from dust and residues.
- Priming of the surface with **PU PRIMER 870** applied by airless sprayer equipment or brush, roller. The base layer (wet-pour mixture of SBR and PU BINDER 1118) should be constructed while **PU PRIMER 870** is still a bit sticky. Curing takes place at ambient temperature by evaporation of the solvent and reaction with atmospheric moisture. High temperatures and moisture will shorten the cure time. **PU PRIMER 870** is applied in two or more layers as a thin film, and on the final layer, wet-pour mixture of SBR and PU BINDER 1118 can be applied on sticky surface.
- The temperature should not fall below 10° C during curing.
- Opened drums should be used up quickly.
- The layer (wet-pour mixture of SBR and PU BINDER 1118) should be constructed while the final layer of **PU PRIMER 870** is still sticky.
- **NOTE: Rain will cause the primer to lose its function! If the primer was affected by rain, the base layer should not be constructed! Instead, the sub floor has to dry and the primer application has to be repeated.**

## CONSUMPTION

200-300 gr/m<sup>2</sup> depending on the type and the absorbency of the underlay.

## APPLICATION TOOLS

Brush and airless sprayer. Tools should be cleaned with a PU solvent immediately after use.

## PACKAGING

Drums / Barrels.

---

## **STORAGE**

One year in unopened containers in cool and dry places, out of sunlight, with minimum temperature 5°C and maximum temperature 30°C.

---

## **REMARKS**

- Working time of **POLYURETHANE PRIMER 870** decreases when ambient temperature rises.
  - Prolonged storage of partially used containers containing **POLYURETHANE PRIMER 870** must be avoided as contact with atmospheric moisture will result in skinning and clouding of the product.
- 

## **CAUTION**

The application must take place in well-aired places using protective gloves. Skin or eye contact must be avoided, otherwise wash carefully with soap and water.

**For more information consult the safety data sheet.**

---

The information given here is true, represents our best knowledge and is based not only on laboratory work, but also on field experience. However, because of numerous factors affecting results we offer this information without any guarantee and no patent liability is assumed. For additional information or questions, contact the technical department of KDF LTD.

# PU BINDER 1118

## POLYURETHANE BINDER

### GENERAL CHARACTERISTICS

100% solids, aromatic, polyisocyanate-prepolymer, moisture-curing binder based on diphenylmethane diisocyanate. It is MDI based and solvent free and has low viscosity. It exhibits excellent adhesion to all rubber granules and gives a strong performance both in terms of tensile strength and durability.

It is mixed with **RECYCLED RUBBER 858** or **EPDM granules** for the creation of the elastic safety flooring **SAFEPOL MULTICOLOR** or other flexible rubber floorings, ideal for playgrounds, athletic tracks, schools etc. Combines and bonds RIM components, polyurethane granules and sponge particles. Also it can be used as lining for insulation and for pasting.

### TECHNICAL DATA

Density of mixture (25°C)	app. 1.08 – 1.18 Kg/Lt
Viscosity (25°C)	4.000 - 8.000 mPa.s
Pot-life (25°C)	30-75 min.
Application temperature	Min 10°C
Curing (25°C and %60 relative humidity)	After 24 hours it cures.

### PREPARATION-APPLICATION

**Applied on dry surfaces without rising humidity issues, free of materials that might prevent bonding e.g. dust, loose particles, grease etc (in case of asphalt or concrete).** The success in the application depends on the right preparation of the underlay and use of the material.

**Good, dry** cleaning of the surface from dust and residues using vacuum cleaner and squeegees.

Can be used for kids playground, running tracks, sports grounds, walkways and offices.

**Moulded in production:** Rubber granules and binder are thoroughly mixed, taken into moulds, and then pressure is applied. 160 bar pressure, mold temperature of 130 degree gives reasonable results in 12 - 15 minutes. In molding applications, binder content should not fall below 5%.

**On-site applications:** **Applied on dry surfaces, free of materials that might prevent bonding e.g. dust, loose particles etc (in case of asphalt or concrete).** The success in the application depends on the right preparation of the underlay and use of the material.

- **Good, dry** cleaning of the surface from dust and residues.
- Priming of the surface with the special **POLYURETHANE PRIMER 870** in two layers.
- Good mixing of the **PU BINDER 1118** and the **RECYCLED RUBBER 858**. Mixing should be performed using a low revolution mixer (300-600 rpm) for 1-2 min. Stirring of the mixture should be performed thoroughly near the sides and bottom of the container in order to achieve homogeneity.
- Following, the mixture is poured on the surface and spread on the desired thickness using paving machine or by hand, if the applicator is experienced, with rake for spreading, (wooden) straightedge for initial smoothing, flat metal trowel for final smoothing and compacting, cylinder weighing 8-15kg for final compacting-(cylinder should be cleaned repeatedly with diesel to remove stuck granules from its surface).
- The application procedure for **SAFEPOL MULTICOLOR (PU BINDER 1118 and EPDM 856 mixture)** on top of asphalt or waterproof concrete directly is the same as for

**SAFEPOL MIXTURE** (the mixture of **PU BINDER 1118** and **RECYCLED RUBBER 858**).

---

**RATIO MIXTURE**

- 16% **PU BINDER 1118** and 84% **RECYCLED RUBBER 858**, for sports flooring.
  - 14% **PU BINDER 1118** and 86% **RECYCLED RUBBER 858**, for playground flooring.
  - 17% **PU BINDER 1118** and 83% **EPDM 856**.
- 

**PACKAGING**

220kg in barrels.

---

**STORAGE**

12 months in unopened containers in cool and dry places, out of sunlight, with minimum temperature 5°C and maximum temperature 30°C.

---

**REMARKS**

- Concrete humidity should not be above 4%, ambient humidity should be at least 40% and most 80%. To begin the application, must wait for the appropriate humidity.
  - Working time of **PU BINDER 1118** decreases when ambient temperature rises.
  - Prolonged storage of partially used containers containing **PU BINDER 1118** must be avoided as contact with atmospheric moisture will result in skinning and clouding of the product.
- 

**CAUTION**

The application must take place in well-aired places using protective gloves. Skin or eye contact must be avoided, otherwise wash carefully with soap and water.

**For more information consult the material safety data sheet.**

---

The information given here is true, represents our best knowledge and is based not only on laboratory work, but also on field experience. However, because of numerous factors affecting results we offer this information without any guarantee and no patent liability is assumed. For additional information or questions, contact the technical department of KDF LTD.



# SBR RUBBER GRANULES 858

## GENERAL CHARACTERISTICS

It can be used in sports facilities as infill in synthetic grass with the parallel use of round sand and also as one of the components in case of cast applied wet-pour systems for playground floorings or as shock-pad for sport subfloors in athletic tracks and sports fields.

Rubber granule is derived from car and truck tires. During processing, the tires are mechanically granulated, removing all metal and synthetic fibers, as well as any other foreign part contained in there with specially designed sieves, so as to produce a 99.99% clear rubber with high quality.

## PROPERTIES

- 100% recyclable
- Long life
- Resistance to adverse weather conditions
- High shock absorbency and vibration damping
- High abrasion resistance

## PREPARATION-APPLICATION

In sports facilities and playgrounds to ensure flexibility of surface and vibration absorption.

## TECHNICAL CHARACTERISTICS

### Granulometry 1-3mm

DENSITY:	0.48kg/cm <sup>3</sup>
SPECIFIC GRAVITY	1.20+/- .05 (Water = 1.0)
HARDNESS	60
HUMIDITY(%)	<0.65
ELASTICITY	100% - No change
RESISTANCE	113N/cm - Excellent

## PACKAGING

Packaging is available in big-bags -1 ton in following sizes:

Grain size	0,5-1,5 mm
Grain size	0,5-2,5 mm
Grain size	0.5-4.0 mm
Grain size	2-8 mm
Grain size	8-20 mm
Grain size	80-50 mm
Grain size	80-120 mm

# POLYSPORT STUCCO 1050

POLYURETHANE, ELASTIC, TWO-COMPONENT PORE FILLER

## GENERAL CHARACTERISTICS

**POLYSPORT STUCCO 1050** is elastic solvent-free, two component polyurethane based sealant for outdoor sport surfaces.

**POLYSPORT STUCCO 1050** has very good filling capacity and thixotropic properties. It has low fluidity feature with its filler structure can be easily applied. It provides strong and elastic filling after the reaction.

## TECHNICAL DATA

Mixing Ratio	90.8 : 9.2 (By weight)
Density of mixture (25°C)	1.69-1.79 Kg/lt
Viscosity of mixture (25°C)	40.000-55.000 mPa s at 25°C
Pot-life (25°C)	20-30 min at 25°C
Application temperature	Min 10 – 40 °C
Curing (25°C and %60 relative humidity)	After 24 hours
Color	Beige

## PREPARATION-APPLICATION

**Applied on dry surfaces without rising humidity issues, free of materials that might prevent bonding e.g. dust, loose particles, grease etc (in case of asphalt or concrete).** The success in the application depends on the right preparation of the underlay and use of the material.

- **Good, dry** cleaning of the surface from dust and residues using vacuum cleaner and squeegees.
- It can be applied directly on top of surfaces, on a cast-in-situ cushion base layer of wet pour (SBR rubber granules mixed with polyurethane binder) or prefabricated roll, which have to be dry, load bearing, clean and free of loose and brittle particles and substances which impair adhesion such as oil, grease, paint or other contaminants.
- The A component should be thoroughly stirred to incorporate any slight separation, while continuing stirring the contents of the B component (hardener) should be added. Continue stirring until a homogeneous mix is obtained. The mixed material must be used within 20-30 minutes of mixing at 25°C The surface must be dry and clean from dust and residues. Application is done by flat metal trowel.

## CONSUMPTION

- 1.25 - 3.7 kg/m<sup>2</sup>, depends on the porosity of the substrate.

## PACKAGING

250 kg barrels and drums.

## STORAGE

One year in unopened containers in cool and dry places, out of sunlight, with minimum

temperature 5°C and maximum temperature 30°C.

---

#### **REMARKS**

- Substrate must be dry, clean, and free from dust, grease and oil. Application must be done between 10°C - 40°C.
  - In case the second layer of PU pore filler is applied after more than 24 hours of the application of the first one then the whole surface must be sanded by a special sanding machine. After that the second layer can be applied.
- 

#### **CAUTION**

Harmful if swallowed. Seek immediately medical attention. Rubber gloves and safety glasses with side guards should be worn.

**For more information consult the safety data sheet.**

---

The information given here is true, represents our best knowledge and is based not only on laboratory work, but also on field experience. However, because of numerous factors affecting results we offer this information without any guarantee and no patent liability is assumed. For additional information or questions, contact the technical department of KDF LTD.

# POLYSPORT 1052-SEMIMAT

UV-RESISTANT, POLYURETHANE-BASED, TWO-COMPONENT, SEMIMAT, FINISH ALIPHATIC COATING

## GENERAL CHARACTERISTICS

**POLYSPORT 1052-SEMIMAT** is a polyurethane, two-component, solvent-based, semi-mat finish aliphatic coating for outdoor sports surfaces.

- It is applied as a final, sealing layer on top of playground floorings made of **SBR rubber granules** plus **PU binder** mixture, or **EPDM** plus **PU binder** mixture, on safety tiles and on top of polyurethane outdoor sports systems such as **POLYFLEX PU-EX**.
- It is UV-resistant and thus absolutely suitable for outdoor surfaces, including running tracks, for UV-protection in case of sensitive, light colors such as blue, orange, green.
- Ideal for protection of EPDM rubber flooring.

## TECHNICAL DATA

Mixing Ratio (colored)	85 :15 (By weight)
Density (25°C)	1.38-1.48 kg/lt
Viscosity (25°C)	1.000-3.500 mPas
Application Temperature	15 – 40 °C
Curing (25°C)	9-12 hours
Color	KDF colorchart

## PREPARATION-APPLICATION

**Applied on dry surfaces without rising humidity issues, free of materials that might prevent bonding e.g. dust, loose particles, grease etc (in case of asphalt or concrete).** The success in the application depends on the right preparation of the underlay and use of the material.

- Good, dry cleaning of the surface from dust and residues using vacuum cleaner and squeegees.
- Caution must be taken so that temperature of the support surface as well as ambient air remains above 15° C during application and curing of the materials while relative humidity does not exceed 75%.
- The A component should be thoroughly stirred to incorporate any slight separation, while continuing stirring, the hardener (B component) should be added. Continue stirring until a homogeneous mix is obtained.
- The application is done by airless sprayer or short-haired mohair roller in 2 crossing layers.

## CONSUMPTION

200-250 gr/m<sup>2</sup> on polyurethane floorings

400-500 gr/m<sup>2</sup> on running tracks or EPDM surfaces.

Apply two layers at least.

## APPLICATION TOOLS

Short-haired mohair paint roller or airless sprayer. Tools should be cleaned with **PU SOLVENT** immediately after use.

---

## STORAGE

12 months in unopened containers in dry places with minimum temperature 5°C and maximum temperature 30°C (avoid sunlight).

---

## REMARKS

- Working time of **POLYSPORT 1052-SEMIMAT** decreases when ambient temperature rises.
  - Prolonged storage of partially used containers, containing **POLYSPORT 1052-SEMIMAT** must be avoided, as contact with atmospheric moisture could possibly cause clouding of the product.
  - After hardening **POLYSPORT 1052-SEMIMAT** is completely safe for health.
  - The second layer of **POLYSPORT 1052-SEMIMAT** has to be applied strictly within 24 hours, depending on the temperature and humidity (European conditions) **or within 3-6 hours (GCC high-temperature conditions)** in order to cover the surface swiftly and protect it from unwanted weather or other adverse conditions (sand dust, accumulated dirt or foreign matter etc.). In case the 24-hour limit (Europe) or the 3-6-hour limit (GCC) is surpassed or weather or other adverse conditions interfere between layers at any time, the surface might need sanding again to restore smoothness and cleanliness before applying subsequent layers of the aliphatic top coat.
- 

## CAUTION

The application must take place in well-aired places using protective gloves. Skin or eye contact must be avoided, otherwise wash carefully with soap and water.

**For more information consult the safety data sheet.**

---

The information given here is true, represents our best knowledge and is based not only on laboratory work, but also on field experience. However, because of numerous factors affecting results we offer this information without any guarantee and no patent liability is assumed. For additional information or questions, contact the technical department of KDF LTD.

# **CLEANING AND MAINTENANCE MANUAL FOR :**

## **-OUTDOOR SPORTS FLOORING**

## **-PLAYGROUND FLOORINGS**

### **Introduction**

Outdoor sports floorings and playground surfaces are made of extremely durable polymers, designed to withstand extreme climate conditions and intense use. However for the best maintenance of the rubber and sport surface a regular check (once in 6 months) is required and the maintenance of the surface is necessary to preserve the suitability of the surface (sand pits, areas of vegetation) which could leave algae, moss and leaf deposits.

The installer's guarantee will usually be conditional on the recommended maintenance requirements being carried out with due diligence.

### **Maintenance**

Maintenance procedures are necessary to preserve the lifetime of the surface and to ensure that:

- The Surface is kept clean.
- The Surface is safe for intense diverse use and all types of users.
- The facility looks attractive.

These objectives are achieved by :

- Sweeping/scraping/removing leaves and other debris and foreign matter from the surface.
- Regularly washing the surface to remove contaminants such as grime, grease, algae, moss, sand, foreign matter etc.
- Applying suitable treatments of moss-killer and/or algaecide
- Periodically removing weed growth from the perimeter kerb lines.

### **Maintenance Equipment**

Leaves, pine needles and other detritus should not be allowed to remain on the surface for any length of time. If this does happen, they rapidly rot down, forming a contaminating "skin" on the surface and providing a growth media for algae and moss.



A mechanical leaf-sweeper or vacuum cleaner is ideal for removing vegetable matter and dirt. Restricted areas may have to be cleaned by hand.

The equipment should be well maintained and carefully operated to avoid contamination of, or physical damage to, the surface. Spillage of fuel or lubricating oil will damage the surface.

The pressure loading on the surface as well as the friction and shearing loads have to be kept to a minimum to prevent damage to the surface. Large pneumatic tires and soft brushes along with careful operating of the machinery, is recommended to avoid any damage on the surface.

A mechanical leaf-sweeper or vacuum cleaner is ideal for removing vegetable matter and dirt. Restricted areas may have to be cleaned by hand.

The equipment should be well maintained and carefully operated to avoid contamination of, or physical damage to, the surface. Spillage of fuel or lubricating oil will damage the surface.

The pressure loading on the surface as well as the friction and shearing loads have to be kept to a minimum to prevent damage to the surface. Large pneumatic tires and soft brushes along with careful operating of the machinery, is recommended to avoid any damage on the surface.

At least once a year it is advisable to wash the surface with low-pressure jetting apparatus.

Polymeric surfaces can withstand low pressures without suffering damage.

Note that no aggressive chemical cleaning agents (chlorine or acid-based) should be used; normal neutral market detergents are adequate.

### **Prevention of damages**

To ensure maintaining the surfaces to a high standard, restrictions should be imposed on the use of the surface.

- In general no vehicles should be permitted to drive on the outdoor sports/playground surface.
- No chemicals, oils, fuel or solvents should be allowed on the surface.
- No fireworks or cigarettes or inadequate shoes should be allowed on the synthetic surface.

### **Damages and renovation**

The lifetime of an outdoor sports/playground surface depends on its quality, usage and level of maintenance. In general a normal outdoor sports/playground surface used intensively will last 7 to 12 years (depending on the system) before renovation is required. Renovation should be carried out periodically to prevent the total damage of the surface, which would necessitate complete renewal.

Renovation must be carried out by professional and skilled contractors with thorough knowledge of this type of work

There are different procedures for the renovation of a surface:

- Complete renewal by replacing the worn-out surface with a new sports flooring system.
- Re-topping or sealing with adequate polyurethane or acrylic materials.
- Partial re-topping in particular worn-out areas.

Information contained in this document is of general nature and is given in good faith. As the state of the surface and the use and application of the various cleaning products, is out of our control, our advice for individual cases, verbal, written or based on tests, does not exempt the applicator from the testing the suitability of the cleaning products and their applications.

The above maintenance guide refers to **the below KDF systems:**

**-SYSTEM SPORTFLOOR**

**-SYSTEM FLEXFLOOR**

**-SYSTEM POLYFLEX AEL EX**

**-SYSTEM POLYFLEX WET POUR EX**

**-SYSTEM POLYFLEX PU EX**

**-SYSTEM POLYFLEX WET POUR AEL EX**

**-SYSTEM SMARTFLOOR**

**-SYSTEM SAFEPOL**

**-SYSTEM SAFEPOL COLORED**

**-SYSTEM SAFEPOL WITH TPV GRANULES**

**-SYSTEM SAFEPOL SANDPROOF**

**-SYSTEM QUICKLAWN PLAYGROUND SAFEPOL**

**-SYSTEM QUICKLAWN PLAYGROUND SAFEPOLSANDPROOF**

**-SYSTEM COLORFLEX**

**-SYSTEM SPORTGROUND-EX**

**-SYSTEM POLTRACK SPRAYCOAT**

**-SYSTEM POLTRACK SPRAYCOAT SEALED**

- SYSTEM POLTRACK SANDWICH**
- SYSTEM POLTRACK SANDWICH IN ROLLS**
- SYSTEM POLTRACK FULL PU**
- SYSTEM POLTRACK ACRYLIC**
- SYSTEM POLTRACK JOGGING TRACK**
- SYSTEM POLTRACK PU JOGGING TRACK**
- SYSTEM POLTRACK JOGGING TRACK SBR**
- SYSTEM POLTRACK JOGGING TRACK SHOCK-PAD - EPDM**
- SYSTEM POLTRACK JOGGING TRACK SHOCK-PAD - ISOPOL**
- SYSTEM POLTRACK EQUINE**

# CERTIFICATES OF KDF Ltd



ISO KDF Ltd



POLTRACK SPRAYCOAT



POLTRACK SANDWICH



POLYFLEX AEL-EX



FLEXFLOOR-EX



SPORTFLOOR-EX



SPORTFLOOR-EX FAST



POLTRACK EQUINE



BADMINTON POLYFLEX PU

# CERTIFICATES OF KDF Ltd



POLYFLEX PU



SPORTGROUND-EX



POLTRACK JOGGING TRACK



FIBA POLYFLEX PU



SAFEPOL



SAFEPOL



EPDM 856



SAFEPOL SANDPROOF



SAFEPOL SANDPROOF



# CERTIFICATES OF KDF Ltd



PLAYPREM



POLTRACK FULL-PU



PU GRASS 149



PAH TEST REPORT  
PU BINDER 1118



PAH TEST REPORT  
PU BINDER 1125 AL



PAH TEST REPORT  
EPDM 856



PAH TEST REPORT  
PU BINDER plus EPDM 856