



# KDF

Sports Flooring Systems & Building Materials

## POLTRACK FULL PU RUNNING TRACK SYSTEM



[www.kdf.gr](http://www.kdf.gr)

**KDF LTD** ([www.kdf.gr](http://www.kdf.gr)) is one of the most dynamic and export-oriented Greek companies (currently activated in more than 80 countries in 4 continents), based in Greece (EU) and in U.A.E too, with production facilities and warehouses in both countries for acrylics and polyurethanes and **EPDM** granules.

**We are experts in sports, industrial and decorative flooring products and systems**, with huge experience in Europe with many applied projects in Spain, France, Greece as well as Malta, Romania, Bulgaria, Croatia, Serbia and Ukraine. Our presence is active in Latin America too with projects in Colombia, Peru, Chile, and Brazil, Africa, Asia, Middle East and India as well.

Our export horizon is expanding rapidly, and our goal is to stand out as a model of flexibility and competitiveness. The company, being one of the pioneer companies in the sector of sports flooring systems and building materials and giving particular attention to providing a fully upgraded range of products and services, provides certified systems according to all **EU norms and regulations** and by well-known international institutes like **WORLD ATHLETICS, I.T.F, TUV, LNE, LABOSPORT, ISASPORT, INTERTEK to name but a few.**

**KDF** goes far beyond trade, providing consultancy in marketing and technical support all the way, from the costing till the finalization of the project. Operating under the requirements of **ISO 9001/2015** (and many others like **ISO 14001/2015, ISO 50001/2018, ISO 27001/2013** and more) for production, trade and application, we make sure our products are first applied successfully at site by our own people before we launch them abroad.

Therefore, our systems have all stood the real-life test in different climates, from North Europe to Middle East till South America, and this is one of our main assets, enabling us to provide full and vertical technical support from specifying to final application plus supervision when required or even full application and costing.

**We invite you to discover a world of sports flooring expertise and solutions.**

[VIEW OUR NEW SPORTS CATALOGUE](#)



**KDF - Kataskeves Dapedon LTD**  
e : [exports@kdf.gr](mailto:exports@kdf.gr)  
w : [www.kdf.gr](http://www.kdf.gr)

19th km National Road Thessaloniki-Moudania  
57001, Neo Rysio, Thessaloniki, Greece  
t / f : +30 2310 829598

# Contents

- 3. Technical Description of the system
- 4. Methodology of the system
- 8. Photographs of Projects
- 9. Technical Data Sheet (TDS) per each material
- 17. Maintenance manual
- 20. Indicative Reference List of Projects

# RUNNING TRACKS

## POLTRACK FULL-PU

Synthetic outdoor system for running tracks in stadiums in total thickness of 15mm .

It is applied on fine asphalt or smooth, waterproof concrete, without rising humidity issues. After laying a PU primer for adhesion, follows the first layer (base layer), which consists of the FULL-PU colored polyurethane coating **POLAPLAST P28** and **RECYCLED RUBBER 858** broadcasted on top (fresh-on-fresh), a second layer comprising again the FULL-PU colored polyurethane coating **POLAPLAST P28** laid on the surface and **RECYCLED RUBBER 858** broadcasted on top (fresh-on-fresh) and the third layer (surface layer) is the full-PU colored polyurethane coating **POLAPLAST P28** laid on the surface and **EPDM** granules broadcasted on top to finish it off (fresh-on-fresh).

**Certified system by WORLD ATHLETICS.**

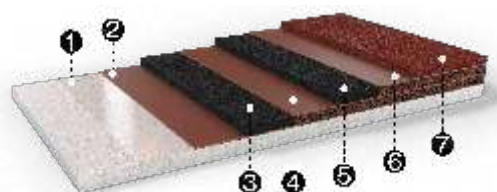

### Steps:

#### 1. **POLAPLAST P10 - Polyurethane primer.**

Applied by airless sprayer or brush.

#### 2. **POLAPLAST P28, specially modified, colored full-PU coating,** applied by V-notch trowel.

#### 3. **RECYCLED RUBBER 858,** SBR granules, broadcasted on the surface.

#### 4. **POLAPLAST P28, specially modified, colored full-PU coating,** applied by V-notch trowel.

#### 5. **RECYCLED RUBBER 858,** SBR granules, broadcasted on the surface.

#### 6. **POLAPLAST P28, specially modified, full-PU coating,** applied by V-notch trowel.

#### 7. **EPDM 856,** EPDM granules, broadcasted on the surface.

Description	Consumption
POLAPLAST P10 - Polyurethane primer.	0.2kg/m <sup>2</sup>
<b>BASE LAYER</b>	
POLAPLAST P28 - Specially modified, colored polyurethane full-PU coating.	2.7kg/m <sup>2</sup> for 5mm mixture
RECYCLED RUBBER 858 in granulometry of 1-4mm.	3kg/m <sup>2</sup> for 5mm mixture
<b>SECOND LAYER</b>	
POLAPLAST P28 - Specially modified, colored polyurethane full-PU coating.	2.8kg/m <sup>2</sup> for 5mm mixture
RECYCLED RUBBER 858 in granulometry of 1-4mm.	2.6kg/m <sup>2</sup> for 5mm mixture
<b>SURFACE LAYER</b>	
POLAPLAST P28 - Specially modified, colored polyurethane full-PU coating.	2.8kg/m <sup>2</sup> for 5mm mixture
EPDM 856 in granulometry of 1-3mm.	4.2kg/m <sup>2</sup> for 5mm mixture

## **POLTRACK FULL PU SYSTEM**

### **Running track spike-proof system**

---



Synthetic outdoor system for running tracks in stadiums in total thickness of 15mm.

It is applied on fine asphalt or smooth, waterproof concrete, without rising humidity issues. After laying a PU primer for adhesion, follows the first layer (base layer), which consists of the **FULL-PU** colored polyurethane coating **POLAPLAST P28** and **RECYCLED RUBBER 858** broadcasted on top (fresh-on-fresh), a second layer comprising again the **FULL-PU** colored polyurethane coating **POLAPLAST P28** laid on the surface and **RECYCLED RUBBER 858** broadcasted on top (fresh-on-fresh) and the third layer (surface layer) is the full-PU colored polyurethane coating **POLAPLAST P28** laid on the surface and **EPDM** granules broadcasted on top to finish it off (fresh-on-fresh).

**Certified system by WORLD ATHLETICS.**

#### **Steps**

1. **POLAPLAST P10 - Polyurethane primer.**
3. **Application of POLAPLAST P28 FULL PU coating.**
4. **Broadcasting of RECYCLED RUBBER 858 SBR granules 1-4mm.**
5. **Application of POLAPLAST P28 FULL PU layer.**
6. **Broadcasting of RECYCLED RUBBER 858 SBR granules 1-4mm.**
7. **Application of POLAPLAST P28 FULL PU coating.**
8. **Broadcasting of EPDM granules 1-3mm.**

#### **Preparation – Application**

Applied on dry asphalt surfaces (30 days old at least) or smooth concrete surfaces (30 days at least old) without rising humidity issues and free of materials that might prevent bonding e.g. dust, loose particles etc (in case of asphalt or concrete). The success in the application depends on the right preparation of the underlay and use of the material.

- **Good, dry cleaning** of the surface from dust and residues.

- Priming of the surface with **POLAPLAST P10** applied by airless spray or brush. The subsequent base layer should be constructed while **POLAPLAST P10** is still sticky (wet on wet procedure), within 30-60 minutes of primer application.
- Application by notched trowel, 5.5mm, and the parallel use of a spiked roller, of one layer of the specially, modified, polyurethane self-leveling coating **POLAPLAST P28**. Consumption: 2.7kg/m<sup>2</sup>.
- Broadcasting of **RECYCLED RUBBER 858** SBR granules (1-4mm granulometry) while **POLAPLAST P28** layer is still fresh. Consumption: 3kg/m<sup>2</sup>.
- Next day (or between 12-24 hours, depending on temperature and humidity conditions), removal of the unstuck SBR rubber granules and application by notched trowel, 5.5mm, and the parallel use of a spiked roller, one layer of the specially, modified polyurethane self-leveling material **POLAPLAST P28**. Consumption: 2.8kg/m<sup>2</sup>.
- Broadcasting of SBR recycled rubber granules (1-4mm granulometry) while **POLAPLAST P28** is still fresh. Consumption: 2.60kg/m<sup>2</sup>.
- Next day (or between 12-24 hours, depending on temperature and humidity conditions), removal of the unstuck SBR rubber granules and application by notched trowel, 5.5mm, and the parallel use of a spiked roller, one layer of the specially, modified polyurethane self-leveling material **POLAPLAST P28**. Consumption: 2.8kg/m<sup>2</sup>.
- Broadcasting of EPDM granules (1-3mm granulometry) while **POLAPLAST P28** is still fresh. Consumption: 4.2kg/m<sup>2</sup>
- After the top layer has cured (depending on conditions, this will usually take 9-12 hours at 20°C), it can be walked on. After 2 days, the top coating of **POLTRACK FULL PU SYSTEM** is fully cured and can be put into service, after proper line marking is performed with the use of special two component polyurethane paint.

### **Important Remarks**

- ✓ During temperatures over 40 degrees, ideal time for the application of **POLTRACK FULL PU SYSTEM** is between 22:00 and 09:00 and the minimum bearing temperature during application and drying should be over 10°C.
- ✓ The freshly coated surface should be protected from high temperatures, wind, rain and frost for at least the first 24 hours.

### **Substrate**

**Asphalt is the safer subfloor for sport floorings for sure and must be always preferred than concrete surfaces.**

#### **A. Asphalt Substrate**

**The asphalt must have a slope of 0.7-1% and must dry for at least 30 days so that all solvents from the asphalt can evaporate.**

The asphalt sub-floor should be applied on well compacted 150mm road base sub-floor and asphalt should be laid in one layer (and not 2) in 6 to 8cm with fine and coarse aggregates (up to 15mm granulometry) like the kind of asphalt used in road construction.

So, new road-grade asphalt will have to be laid (minimum 60mm) in one layer containing coarse aggregates and then mature for 30 days at least, before any application takes place on top of the asphalt to avoid bubbles on the final layer of the sport or rubber floorings.

#### Asphalt Infrastructure

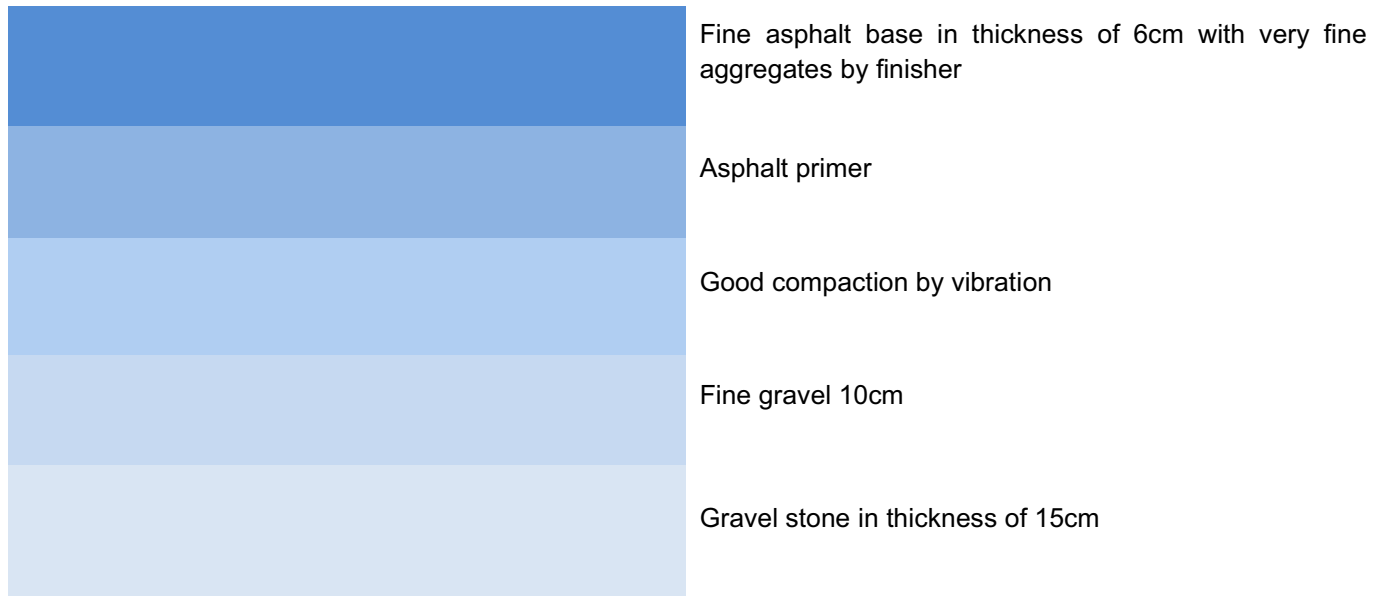

#### B. Concrete Surface

**Concrete surface must be power-trowelled without cracks and must be smooth with a slope of 0.7-1% and humidity under 4% in 10cm depth of concrete.**

Concrete must also be **dry at least for 40 days** and then the application takes place if there is no rising humidity for the sub-floor. Before the application takes place, there must be proper grinding of the surface by a grinding machine to open the pores accordingly and also a measurement by special instrument to measure humidity on the surface and in 10cm under the surface.

Generally concrete is a risky sub-floor and there may be problems with rising humidity, especially in areas where the sea level is really high and when the sea is close or in areas near greenery.

**Always make expansion joints in large areas of concrete, in order to avoid uncontrollable cracks and failures.** Joints should be every 25 square meters creating a grid of 5x5 meters or close to that.

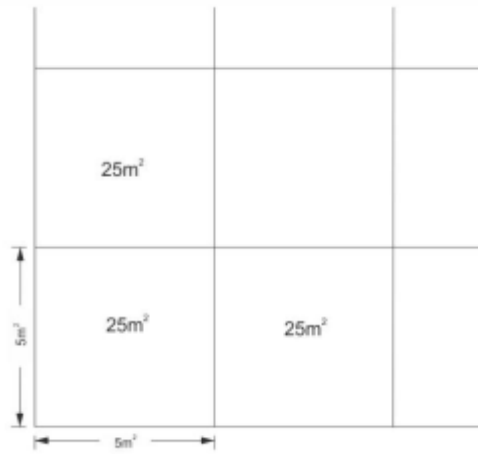

### Substrate requirements

Concrete quality	at least C20/25
Age:	at least 40 days
Moisture content:	below 4%

### Tools:





# PHOTOGRAPHS OF PROJECTS



# POLAPLAST P10

## POLYURETHANE PRIMER ONE-COMPONENT

### GENERAL CHARACTERISTICS

**POLAPLAST P10** is a low viscosity, moisture curing, clear, polyurethane-based, one-component primer with good long term elasticity. **POLAPLAST P10** is used as an adhesive component between the sub-floor and the base layer (wet-pour mixture of SBR and **POLAPLAST P13**) of KDF running track systems.

- Designed for improving adhesion of base layer (wet-pour mixture) of KDF running track systems on asphalt and concrete surfaces without rising humidity issues.
- Penetrates in depth.
- Ideal for old and new surfaces.

### TECHNICAL DATA

Basis:	one-component polyurethane
Appearance:	liquid
Color:	transparent
Viscosity :	50 – 250 mPa s at 25°C
Density :	0.9 – 1.0 Kg/Lt at 25°C
Temperature for the application and drying of the material:	10 – 40°C

### PREPARATION-APPLICATION

**Applied on dry surfaces without rising humidity issues, free of materials that might prevent bonding e.g. dust, loose particles, grease etc (in case of asphalt or concrete).** The success in the application depends on the right preparation of the underlay and use of the material.

- **Good, dry** cleaning of the surface from dust and residues.
- Priming of the surface with **POLAPLAST P10** applied by airless sprayer equipment or brush, roller. The base layer (wet-pour mixture of SBR and **POLAPLAST P13**) of KDF running track systems should be constructed while **POLAPLAST P10** is still a bit sticky. Curing takes place at ambient temperature by evaporation of the solvent and reaction with atmospheric moisture. High temperatures and moisture will shorten the cure time. **POLAPLAST P10** is applied in two or more layers as a thin film, and on the final layer, wet-pour mixture of SBR and **POLAPLAST P13** can be applied on wet surface.
- The temperature should not fall below 10°C during curing.
- Opened drums should be used up quickly.
- Depending on the temperature and humidity, 3-5 hours is the minimum waiting time.
- The base layer (wet-pour mixture of SBR and **POLAPLAST P13**) of the running track systems should be constructed while the final layer of **POLAPLAST P10** is still sticky.
- **NOTE: Rain will cause the primer to lose its function! If the primer was affected by rain, the base layer should not be constructed! Instead, the sub floor has to dry and the primer application has to be repeated.**

### CONSUMPTION

150-250 gr/m<sup>2</sup> depending on the type and the absorbency of the underlay.

---

**APPLICATION**  
**TOOLS**

Airless sprayer or brush or roller.



---

**PACKAGING**

Supplied in drums of 200 Kg.



---

**STORAGE**

12 months in unopened containers in dry places with minimum temperature 5°C and maximum temperature 30°C (out of sunlight).

---

**CAUTION**

The application must take place in well-aired places using protective gloves. Skin or eye contact must be avoided, otherwise wash carefully with soap and water.

**For more information consult the safety data sheet.**

---

The information given here is true, represents our best knowledge and is based not only on laboratory work, but also on field experience. However, because of numerous factors affecting results we offer this information without any guarantee and no patent liability is assumed. For additional information or questions, contact the technical department of KDF LTD.

# POLAPLAST P28

Specially, Modified, Two-component, Self Leveling coating for KDF Running track Systems **POLTRACK FULL PU**

## GENERAL CHARACTERISTICS

**POLAPLAST P28** is a specially, modified, pigmented and solvent free, two component self leveling coating, with good elastic and tensile strength properties. Meets WORLD ATHLETICS standard, it is environment- friendly, flexible with high strength.

It's a running track material used as wear coat for sandwich running track systems providing good force reduction.

**POLAPLAST P28** is easy to apply, it shows a good curing behavior even at low or high temperature.

## TECHNICAL DATA

Mixing Ratio	86.96 : 13.04 (By weight)
Density of mixture (25°C)	1.40 – 1.50 Kg/Lt
Viscosity(25°C)	3500 – 8000 mPa s at 25°C
Pot-life (25°C)	20-30 min.
Application temperature	10 – 40 °C
Curing (25°C and %60 relative humidity)	After 24 hours
Color	KDF colorchart

## PREPARATION-APPLICATION

**Applied on dry surfaces without rising humidity issues, free of materials that might prevent bonding e.g. dust, loose particles, grease etc (in case of asphalt or concrete).**

The success in the application depends on the right preparation of the underlay and use of the material.

- Good, dry cleaning of the surface from dust and residues using vacuum cleaner and squeegee.
- **POLAPLAST P28** is a high performance system constructed on a cast-in-situ cushion base layer of wet pour mixture (SBR rubber granules mixed with polyurethane binder) or prefabricated roll, which is first sealed with the sealant **POLAPLAST P22** before the application of **POLAPLAST P28**, with a final topping of colored EPDM granules broadcast onto **POLAPLAST P28**.
- Processing temperature of both components should be between 10-40°C.
- The A component should be thoroughly stirred to incorporate any slight separation, while continuing stirring the hardener (B component) should be added. Continue stirring until a homogeneous mix is obtained. The mixed material must be used within 20-30 minutes of mixing at 25°C. The well mixed material is applied with a V-notch trowel 5.5 mm and the parallel use of a spiked roller. Before the mixture cures, broadcast the EPDM granules (1mm- 3mm). After full curing, use an air blower to remove the excess of the granules.
- Material consumption lies between 8,2 – 8,5 Kg/m<sup>2</sup> for a standard FULL PU system and it depends on the temperature of substrate, ambience and material. Substrate temperatures must not exceed 50°C as this would liquefy the material.
- During the first hours after application, the coating had to be protected from direct contact with water, as this could cause foaming of the material. In case of (expected) rain, **POLAPLAST P28** should not be applied.
- NOTE: In cases re-coating is required, proceed in the first 24 hours after previous application without the use of primer if the surface is dry and clean.

## CONSUMPTION

8,2 – 8,5 kg/m<sup>2</sup>.

---

**APPLICATION  
TOOLS**

V-notch trowel, 5.5 mm & spiked roller.



---

**PACKAGING**

Supplied in barrels and drums(set).



---

**CAUTION**

The application must take place in well-aired places using protective gloves. Skin or eye contact must be avoided, otherwise wash carefully with soap and water.

**For more information consult the safety data sheet.**

---

The information given here is true, represents our best knowledge and is based not only on laboratory work, but also on field experience. However, because of numerous factors affecting results we offer this information without any guarantee and no patent liability is assumed. For additional information or questions, contact the technical department of KDF LTD.

# SBR RUBBER GRANULES 858

## GENERAL CHARACTERISTICS

It can be used in sports facilities as infill in synthetic grass with the parallel use of round sand and also as one of the components in case of cast applied wet-pour systems for playground floorings or as shock-pad for sport subfloors in athletic tracks and sports fields.

Rubber granule is derived from car and truck tires. During processing, the tires are mechanically granulated, removing all metal and synthetic fibers, as well as any other foreign part contained in there with specially designed sieves, so as to produce a 99.99% clear rubber with high quality.

## PROPERTIES

- 100% recyclable
- Long life
- Resistance to adverse weather conditions
- High shock absorbency and vibration damping
- High abrasion resistance

## PREPARATION-APPLICATION

In sports facilities and playgrounds to ensure flexibility of surface and vibration absorption.

## TECHNICAL CHARACTERISTICS

### Granulometry 1-3mm

DENSITY:	0.48kg/cm <sup>3</sup>
SPECIFIC GRAVITY	1.20+/-0.05 (Water = 1.0)
HARDNESS	60
HUMIDITY(%)	<0.65
ELASTICITY	100% - No change
RESISTANCE	113N/cm - Excellent

## PACKAGING

Packaging is available in big-bags -1 ton in following sizes:

Grain size	0,5-1,5 mm
Grain size	0,5-2,5 mm
Grain size	0.5-4.0 mm
Grain size	2-8 mm
Grain size	8-20 mm
Grain size	80-50 mm
Grain size	80-120 mm



---

The information given here is true, represents our best knowledge and is based not only on laboratory work, but also on field experience. However, because of numerous factors affecting results we offer this information without any guarantee and no patent liability is assumed. For additional information or questions, contact the technical department of KDF LTD.

# EPDM 856

(Ethylene Propylene Diene Monomer Rubber)

RUBBER GRANULES

## GENERAL CHARACTERISTICS

Type of material: Rubber EPDM

Grain size: 0.5-1.5mm, 1-3.5mm, 1-4mm, EPDM dust

## PERFORMANCE OF SAMPLE WITH 22% EPDM CONTENT

Test item	Performance	Standard
Tensile strength (N/mm <sup>2</sup> )	>1	ASTM D412-6
Elongation at break (%)	>800	ASTM D412-6
Hardness (shore A)	65	ASTM D2240-15
Specific gravity (kg/m <sup>3</sup> )	1.51 ± 0.05	ASTM D792-20

## PREPARATION-APPLICATION

**EPDM 856** granules are basically used for wet pour colored playground floorings (granulometry 1-3.5mm or 1-4mm or 0.5-1.5mm), for flexible multipurpose outdoor courts in 10-20 mm, **SYSTEM COLORFLEX**, and in applications of running track system such as **POLTRACK SANDWICH SYSTEM** (granulometry 1-3.5mm broadcasted) and **POLTRACK SPRAYCOAT SYSTEM** (granulometry 0.5-1.5 mm as spray system mixed with PU resin P12).

Can be used also as infill of artificial synthetic turf or in the production of EPDM rubber tiles or EPDM rubber rolls or loose lay as EPDM Mulch.

## REMARKS

- It is highly suggested (especially in hot climates like in Middle East countries) the usage of the UV-resistance topcoat **POLYSPORT XP 1069**, which gives a strong UV protection and doesn't allow the change of color to occur. **POLYSPORT XP 1069** is produced in all EPDM color range and needs to be applied with 0,4 kg/m<sup>2</sup> in two crossing layers by airless sprayer or rollers over EPDM surfaces with PU binder.
- In case of sprayed coated running track system, it is suggested the usage of POLYSPORT 1052 UV resistant coating where the color shade is green or blue or any other except red color which doesn't need any protection.
- Same can be applied for long term color stability also for the POLTRACK SANDWICH SYSTEM over broadcasted EPDM granules.
- In case that there is no usage of UV-resistance polyurethane aliphatic coating strong shades like blue, rose, orange, grey etc. will alter.
- All technical data are correct to the best of our knowledge and are intended to help our customers.
- They do not constitute a guarantee of qualities and provide on bases for legal liability.
- We advise our customers to choose the correct type of PU-binder (normal aromatic binder or aliphatic 2-component binder) according to the type and color of the EPDM rubber granules.



---

## **CERTIFICATES AND TEST REPORTS**

Ask for our certificates and test reports for EPDM as:

- pAH and Elements acc. to EN 71-3
- UV resistance test (FIFA Test Method 10)
- SRI (Solar Reflectance Index)
- Weathering Resistance
- Water Resistance
- Dimensional Stability
- Temperature Resistance

---

The information given here is true, represents our best knowledge and is based not only on laboratory work, but also on field experience. However, because of numerous factors affecting results we offer this information without any guarantee and no patent liability is assumed. For additional information or questions, contact the technical department of KDF LTD.

# CLEANING AND MAINTENANCE MANUAL FOR :

## -OUTDOOR SPORTS FLOORING -PLAYGROUND FLOORINGS

### Introduction

Outdoor sports floorings and playground surfaces are made of extremely durable polymers, designed to withstand extreme climate conditions and intense use. However for the best maintenance of the sports surface a regular check (once in 6 months) is required and the maintenance of the surface is necessary to preserve the suitability and functionality of the flooring.

The installer's guarantee will usually be conditional on the recommended maintenance requirements being carried out with due diligence.

### Maintenance

Maintenance procedures are necessary to preserve the lifetime of the surface and to ensure that:

- The Surface is kept clean.
- The Surface is safe for intense and diverse use.

These objectives are achieved by :

- Sweeping/removing leaves and other debris from the surface.
- Regularly washing the surface with a soft brush to remove contaminants such as grime, grease, algae, moss, sand etc.
- Applying suitable treatments of moss-killer and/or algaecide
- Periodically removing weed growth from the perimeter kerb lines.

### Maintenance Equipment

- Leaves, pine needles and other detritus should be removed from the surface immediately as rot quickly helping the growth of mold and moss.
- A mechanical leaf-sweeper or vacuum cleaner is ideal for removing vegetable matter and dirt. Restricted areas may have to be cleaned by hand.
- The maintenance equipment should be well maintained and carefully operated to avoid any physical damage to the surface.
- Pressure loads on the surface as well as friction and shearing loads have to be avoided to prevent damage to the surface.
- At least once a year it is advisable to wash the surface with **low-pressure** jetting apparatus.

- Polymeric surfaces can withstand low pressures without suffering damage.
- Note that no aggressive chemical cleaning agents (chlorine or acid-based) should be used.

### **Prevention of damages**

To ensure the excellent condition of the surface:

- It is forbidden to drive vehicles, bicycles or motorcycles on the surface.
- Chemicals, oils, fuels or solvents on the surface are prohibited.
- Fireworks or cigarettes or unsuitable shoes on the surface are prohibited.

### **Damages and renovation**

The lifetime of an outdoor sports/playground surface depends on its quality, usage and level of maintenance. In general a normal outdoor sports/playground surface used intensively will last 7 to 12 years (depending on the system) before renovation is required. Renovation should be carried out periodically to prevent the total damage of the surface, which would necessitate complete renewal.

Renovation must be carried out by professional and skilled contractors with thorough knowledge of this type of work.

There are different procedures for the renovation of a surface:

- Complete renewal by replacing the worn-out surface with a new sports flooring system.
- Re-topping or sealing with adequate polyurethane or acrylic materials.
- Partial re-topping in particular worn-out areas.

Information contained in this document is of general nature and is given in good faith. As the state of the surface and the use and application of the various cleaning products, is out of our control, our advice for individual cases, verbal, written or based on tests, does not exempt the applicator from the testing the suitability of the cleaning products and their applications.

The above maintenance guide refers to **the below KDF systems:**

**-SYSTEM SPORTFLOOR FAST**

**-SYSTEM SPORTFLOOR-EX**

**-SYSTEM SPORTFLOOR-EX-R**

**-SYSTEM FLEXFLOOR-EX**

**-SYSTEM FLEXFLOOR-EX-R**

**-SYSTEM POLYFLEX AEL-EX**

**-SYSTEM POLYFLEX AEL-EX-R**  
**-SYSTEM POLYFLEX WET-POUR EX**  
**-SYSTEM POLYFLEX WET-POUR EX-R**  
**-SYSTEM POLYFLEX PU-EX**  
**-SYSTEM POLYFLEX WET-POUR AEL-EX**  
**-SYSTEM POLYFLEX WET-POUR AEL-EX-R**  
**-SYSTEM SMARTFLOOR-EX**  
**-SYSTEM SAFEPOL MULTICOLOR**  
**-SYSTEM SAFEPOL COLORED**  
**-SYSTEM SAFEPOL WITH TPV GRANULES**  
**-SYSTEM SAFEPOL SBR COLOURANT**  
**-SYSTEM SAFEPOL SANDPROOF**  
**-SYSTEM QUICKLAWN PLAYGROUND SAFEPOL**  
**-SYSTEM QUICKLAWN PLAYGROUND SAFEPOLSANDPROOF**  
**-SYSTEM COLORFLEX**  
**-SYSTEM SPORTGROUND-EX**  
**-SYSTEM DECOQUARTZ**  
**-SYSTEM POLTRACK SPRAYCOAT**  
**-SYSTEM POLTRACK SPRAYCOAT SEALED**  
**-SYSTEM POLTRACK SANDWICH**  
**-SYSTEM POLTRACK ROLL-SANDWICH**  
**-SYSTEM POLTRACK FULL PU**  
**-SYSTEM POLTRACK ACRYLIC**  
**-SYSTEM POLTRACK JOGGING TRACK**  
**-SYSTEM POLTRACK PU JOGGING TRACK**  
**-SYSTEM POLTRACK JOGGING TRACK SBR**  
**-SYSTEM POLTRACK JOGGING TRACK SHOCK-PAD - EPDM**  
**-SYSTEM POLTRACK JOGGING TRACK SHOCK-PAD - ISOPOL**  
**-SYSTEM POLTRACK EQUINE**

# INDICATIVE REFERENCE LIST OF PROJECTS

- RIYADH CITY NORTH PHASE 7A - ABHU DHABI, U.A.E - 80000m<sup>2</sup> Bicycle track, Sportground-Ex system
- RIYADH CITY NORTH PHASE 7B - ABHU DHABI, U.A.E - 60000m<sup>2</sup> Bicycle track, Sportground-Ex system
- CONSTRUCTION OF HARD LANDSCAPING - U.A.E - 60000m<sup>2</sup> Bicycle track, Sportground-Ex system
- RIYADH CITY SOUTH PHASE 1 - ABHU DHABI, U.A.E - 42000m<sup>2</sup> Bicycle track, Sportground-Ex system
- 12 SCHOOLS IN U.A.E, MINISTRY OF EDUCATION(THROUGH VARIOUS CONTRACTORS) - 40000m<sup>2</sup> EPDM Rubber flooring
- MULTIPLE RUNNING TRACKS - ALGERIA - 40000 m<sup>2</sup> - Running track, POLTRACK SPRAYCOAT system
- AL ESKAN RUNNING TRACK - BURAIDAH, K.S.A -25000m<sup>2</sup> -Running track, POLTRACK SPRAYCOAT system
- UNIVERSITY OF DAMMAM - KSA - 13000m<sup>2</sup> - Acrylic cushion floorings
- KING ABDULLAH BASE AIR DEFENSE - TAIF, KSA - 12600 m<sup>2</sup> - Running track
- KING FAHD UNIVERSITY OF PETROLEUM AND MINERALS-DHARAN, KSA-12400m<sup>2</sup>-Rubber outdoor flooring
- ”KOSTAS KENTERIS” STADIUM & NATIONAL STADIUM OF MITILINI - MITILINI ISLA, GREECE - 12000m<sup>2</sup> - Running track, POLTRACK SANDWICH system
- RUNNING TRACK - K.S.A- 11000 m<sup>2</sup> - Running track, POLTRACK SANDWICH system
- GEMS SCHOOL - DUBAI, U.A.E - 10000 m<sup>2</sup> - Running track
- PASARGRAD WHOLESALE MARKET-IRAN - 10000 m<sup>2</sup> - Decorative flooring
- YAS ISLAND, ABU DHABI, U.A.E - 10000m<sup>2</sup> Bicycle track
- ANASTASIA KELESIDOU STADIUM/KONSTANTINOS KARAMANLIS - THESSALONIKI, GREECE - 10000m<sup>2</sup>
- Re-topping project, Running track, Sandwich system, Indoor & Outdoor running track
- KAFTANZOGLIO NATIONAL STADIUM OF THESSALONIKI - GREECE - 9000m<sup>2</sup>, POLTRACK SANDWICH
- ABHA STADIUM - K.S.A - 9000m<sup>2</sup>- POLTRACK SANDWICH system
- ABU DHABI STADIUM - U.A.E - 9000m<sup>2</sup> - Artificial Grass, POLITURF LEADER 55140
- ALEXANDRIA STADIUM - ALEXANDRIA, EGYPT - 8500 m<sup>2</sup> - Running track
- SICHUAN INVESTMENT INTERNATIONAL TENNIS CENTER - CHENGDU CHINA - 8250 m<sup>2</sup> - SPORTFLOOR-EX HARD COURT
- MINISTRY OF EDUCATION IN KUWAIT - KUWAIT - 8000m<sup>2</sup> - Polyurethane flooring, Polyflex Pu-In system
- SALAM STREET & MINA ROAD, ABU DHABI, U.A.E - 8000m<sup>2</sup> Bicycle track, Sportground-Ex system
- KING FAHAD NAVAL BASE - JUBAIL, KSA - 8000m<sup>2</sup> - Running track
- MUNICIPALITY OF VELVENTO - KOZANI, GREECE - 8000m<sup>2</sup>, Running track
- PRINCE FAISAL STADIUM IN RIYADH - K.S.A - 8000m<sup>2</sup>, Running track, POLTRACK SANDWICH system
- ABBHA, KSA - 7600m<sup>2</sup> - Running track
- MUNICIPALITY OF ZENICA - ZENICA, BOSNIA & HERZEGOVINA - 7500m<sup>2</sup>, Poltrack Spraycoat, Running track
- RUNNING TRACK - KAMIANETS, PODILSKYI, UKRAINE - 7400m<sup>2</sup>, Poltrack Spraycoat
- NATIONAL STADIUM OF TRIKALA - TRIKALA, GREECE - 7000m<sup>2</sup> - Running track POLTRACK FULL PU
- TELUK BAYAR MINI OLYMPI STADIUM - INDONESIA - 7000m<sup>2</sup> - Running track, POLTRACK SANDWICH
- ADNOC SCHOOLS - U.A.E - 7000m<sup>2</sup> - Safepol system
- MAJLIS BANDARAYA PETALING JAYA STADIUM - MALAYSIA - 7000m<sup>2</sup> POLTRACK SANDWICH
- ATLAS CENTER-BAM, IRAN - 7000 m<sup>2</sup> - Decorative flooring
- RUNNING TRACK - SUDAN - 7000 m<sup>2</sup> - Running track, POLTRACK SPRAYCOAT system
- COLOMBIA RUNNING TRACK PROJECT - 6800 m<sup>2</sup> - POLTRACK SPRAYCOAT
- MUNICIPALITY STADIUM ANDROS ISLA, GREECE - 6700m<sup>2</sup>- POLTRACK SANDWICH RETTOPING SYSTEM
- RUNNING TRACK STADIUM - CRETE, GREECE - 6500 m<sup>2</sup> - Running track, POLTRACK SANDWICH system

**-PLAYGROUND PROJECT - ABU DHABI, U.A.E** - 6500 m<sup>2</sup>, Safety flooring  
**-RUNNING TRACK STADIUM - DRAMA, GREECE** - 6500 m<sup>2</sup> - Running track, POLTRACK SANDWICH system  
**-SAADIYAT ISLAND - ABHU DHABI, U.A.E** - 6500m<sup>2</sup> Bicycle track, Sportground-Ex system  
**-RUNNING TRACK PROJECT IN MUSCAT, OMAN** - 6400 m<sup>2</sup> - POLTRACK SANDWICH system  
**-KAVALA STADIUM - KAVALA, GREECE** - 6300m<sup>2</sup>- 8-lane Running track, POLTRACK SANDWICH SYSTEM  
**-CHENGDU SPORT UNIVERSITY - CHENGU, CHINA** - 6300 m<sup>2</sup> - Cushion system, FLEXFLOOR-EX  
**-CORNISH, JEDDAH, K.S.A** - 6000m<sup>2</sup> Bicycle track Sportground-Ex system  
**-MUNICIPALITY STADIUM-MOLAOI, GREECE** - 5800m<sup>2</sup>- POLTRACK SANDWICH SYSTEM  
**-MUNICIPALITY STADIUM SOFADES, GREECE** - 5800m<sup>2</sup>- POLTRACK SANDWICH SYSTEM  
**-MUNICIPALITY STADIUM OF ALIARTOS - ALIARTOS, GREECE** - 5700m<sup>2</sup>- POLTRACK SPRAYCOAT  
**-ARTIFICIAL GRASS PROJECT - ATHENS, GREECE** - 5700m<sup>2</sup>, Artificial grass  
**-PAPACHARALAMBIO STADIUM - NAFPAKTOS, GREECE** - 5650m<sup>2</sup> - POLTRACK SANDWICH system  
**-AMITY INTERNATIONAL SCHOOL - ABHU DHABI, U.A.E** - 5500m<sup>2</sup>, Poltrack Spraycoat, Running Track  
**-MUNICIPALITY STADIUM LOUTRAKI, GREECE** - 5500m<sup>2</sup>- POLTRACK SANDWICH SYSTEM  
**-SHUQAIQ WATER AND ELECTRICITY COMPANY - JIZAN, KSA** - 5400 m<sup>2</sup> - acrylic courts  
**-TALEEM UPTOWN SCHOOLS - DUBAI, UAE** - 5400m<sup>2</sup>-Acrylic sports courts systems  
**-ZAYED PORT - ABHU DHABI, U.A.E** - 5400m<sup>2</sup> Bicycle track, Sportground-Ex system  
**-SAN FERNANDO DE HENARES - SPAIN** - 5300m<sup>2</sup> - POLTRACK SANDWICH  
**-SAUDI AIR FORCE - KSA** - 5250 m<sup>2</sup> - Acrylic coating elastoturf, running track  
**-OMAN WATERFRONT - OMAN** - 5000 m<sup>2</sup> - COLORFLEX-EX  
**-SHIV NADER SCHOOL - FARIDABAD, INDIA** - 5000 m<sup>2</sup> - Running track, POLTRACK SANDWICH system  
**-RUNNING TRACK - K.S.A** - 5000 m<sup>2</sup> - Running track, POLTRACK SANDWICH system  
**-AL HAMRA, RAS AL KHAIMAH, U.A.E** - 5000m<sup>2</sup> Bicycle track, Sportground-Ex system  
**-AIRBASE IN TAIF - KSA** - 5000 m<sup>2</sup> - Running track  
**-AMERICAN SCHOOL AL BARSHA - DUBAI** - 5000 m<sup>2</sup> - Running track, POLTRACK SPRAYCOAT system  
**-MUNICIPALITY STADIUM AMFISSA, GREECE** - 5000m<sup>2</sup>- POLTRACK SANDWICH SYSTEM  
**-NATIONAL STADIUM OF KALAMPAKA -KALAMPAKA, GREECE**-4900m<sup>2</sup>-POLTRACK SEALED SPRAYCOAT  
**-MONTORNES DE VALLES - BARCELONA, SPAIN** - 4900m<sup>2</sup> - POLTRACK SPRAYCOAT  
**-THAILAND STADIUM** - 4800 m<sup>2</sup> - Running track, POLTRACK SANDWICH system  
**-UMM GHAFAH CYCLE TRACK - AL AIN, U.A.E** - 4700m<sup>2</sup> Bicycle track, Sportground-Ex system  
**-LYCEE FRANCAIS INTERNATIONAL THEODORE MONOD - SADIYAT, ABU DHABI, U.A.E** - 4650 m<sup>2</sup> - Art. Grass POLITURF LEADER 55140  
**-BIG SQUARE & LRT STREET, MASDAR CITY - ABHU DHABI, U.A.E** - 4600m<sup>2</sup> Bicycle track, Sportground-Ex  
**-DEPARTMENT OF EDUCATION ASIR REGION - KHAMIS, KSA** - 4500 m<sup>2</sup> - Running track  
**-SERVIA STADIUM - KOZANI, GREECE** - 4500m<sup>2</sup>, Running track  
**-STADIUM OF ISLAMIC CITY OF BAWATH IN AL-AZHAR - EGYPT** - 4500m<sup>2</sup>- POLTRACK SANDWICH  
**-MUNICIPALITY STADIUM OF SOFADES - GREECE** - 4500m<sup>2</sup>- POLTRACK SANDWICH SYSTEM  
**-BURGUILLOS STADIUM IN SEVILLA - SPAIN** - 4400 m<sup>2</sup> - Running track, POLTRACK SPRAYCOAT system  
**-”POSIDONIO” NATIONAL ATHLETIC CENTER - THESSALONIKI, GREECE** - 4300m<sup>2</sup>- Acrylic certified flooring  
**-MUNICIPALITY STADIUM OF MESSINI - GREECE** - 4300m<sup>2</sup>- Running track, POLTRACK SANDWICH SYSTEM  
**-MUNICIPAL SPORTS CENTER VELOU-VOHA - PELOPONNISOS, GREECE** - 4300m<sup>2</sup>- POLTRACK SANDWICH  
**-COMMUNITY COLLEGE - KHAMIS, KSA** - 4200 m<sup>2</sup> - Running track  
**-FAYOUM INIVERSITY - EGYPT** - 4200m<sup>2</sup> - Polyurethane sports flooring, POLYFLEX PU System  
**-POLIDEPORTIVO UNIVERSIDAD ALCALA DE HENARES-MADRID,SPAIN**-4000m<sup>2</sup>-POLTRACK SPRAYCOAT

**-SPORTS CLUB CENTER GLIFADA - ATHENS, GREECE** - 4000m<sup>2</sup>- Poltrack Spraycoat, Running Track  
**-EMIRATES INTERNATIONAL SCHOOL - DUBAI, U.A.E** - 4000m<sup>2</sup> - Safepol System, Playground flooring  
**-YAS NORTH EMMARATHI COMMUNITY - ABHU DHABI, U.A.E** - 4000m<sup>2</sup> Bicycle track, Sportground-Ex system  
**-RUNNING TRACK PROJECT IN QATAR** - 4000m<sup>2</sup>, Poltrack Spraycoat system  
**-RUNNING TRACK PROJECT IN SAMOS - GREECE** - 4000m<sup>2</sup>, Poltrack Spraycoat system  
**-RECONSTRUCTION OF MOROCOCHA STADIUM - PERU** - 3850m<sup>2</sup> - Running track, POLTRACK SANDWICH  
**-HH KHALID BIN BANDAR - RIYADH, KSA** - 3800 m<sup>2</sup> - Volleyball/basketball rubber courts  
**-SPORTS FLOORING COMPLEX - ISRAEL** - 3700 m<sup>2</sup>, Acrylic sports flooring, SPORTFLOOR-EX system  
**-MUNICIPALITY STADIUM OF AGIA PARASKEVI, GREECE** - 3700m<sup>2</sup>- POLTRACK SANDWICH SYSTEM  
**-MUNICIPALITY STADIUM OF HALKIDA - EUBOEA, GREECE** - 3700m<sup>2</sup>- POLTRACK SANDWICH SYSTEM  
**-RUNNING TRACK- UKRAINE** - 3600m<sup>2</sup> - RunningTrack, Poltrack Spraycoat system  
**-ANATOLIA GOLLEGE - THESSALONIKI, GREECE** - 3600m<sup>2</sup>, Running track  
**-AIMARJAN ASLAND – PARTIAL** - 3600m<sup>2</sup>- Poltrack Sandwich, Running Track  
**-RUNNING TRACK - ISRAEL** - 3500m<sup>2</sup> - Running track, POLTRACK SANDWICH system  
**-KING ABDULLAH UNIVERSITY TECHNOLOGY - K.S.A** - 3500m<sup>2</sup> - Running track, POLTRACK SANDWICH system  
**-RUNNING TRACK PROJECT - EGYPT** - 3500m<sup>2</sup> - Running track, POLTRACK SPRAYCOAT system  
**-BICYCLE TRACK PROJECT - GREECE** - 3500m<sup>2</sup>- Acrylic sports flooring, SPORTGROUND-EX system  
**-MUNICIPALITY OF ALIMOS - ATHENS, GREECE** - 3500m<sup>2</sup>- Acrylic sports flooring, SPORTFLOOR FAST  
**-MUNICIPALITY STADIUM OF HOLARGOS, ATHENS- GREECE** - 3500m<sup>2</sup>- POLTRACK SANDWICH SYSTEM  
**-MATRIX SPORTING CLUB - EGYPT** - 3400m<sup>2</sup> - Polyurethane outdoor flooring, Polyflex PU-EX System  
**-RUNNING TRACK PROJECT - EGYPT** - 3400m<sup>2</sup> - Running track, POLTRACK SPRAYCOAT system  
**-SPORTS CLUB CENTER KISSAMOS - CRETE, GREECE** - 3200m<sup>2</sup>- Poltrack Sandwich, Running Track  
**-AL LUSAIL SPORTS CLUB - DOHA, QATAR** - 3200m<sup>2</sup> - Jogging track  
**-SPORTS CLUB CENTER - SERBIA, GREECE** - 3200m<sup>2</sup> - Poltrack Sandwich, Running Track  
**-STADIUM CENTER - UKRAINE** - 3200m<sup>2</sup> - RunningTrack, Poltrack Spraycoat system  
**-KING KHALID UNIVERSITY - ABHA, KSA** - 3100 m<sup>2</sup> - Running track  
**-MUNICIPALITY STADIUM KRESTENA - GREECE** - 3100m<sup>2</sup>- Poltrack Sandwich, Running Track  
**-ISLAMIC WORLD GARDEN - SHARJA, U.A.E** - 3000m<sup>2</sup>- Safety flooring, SAFEPOL MULTICOLOR system  
**-AL FAIOUM UNIVERSITY - FAIOUM, EGYPT** - 3000m<sup>2</sup>- Polyurethane indoor flooring, Polyflex PU-IN system  
**-RUNNING TRACK PROJECT - VELVEDOS MUNICIPALITY, GREECE** - 3000m<sup>2</sup>- POLTRACK SANDWICH  
**-WADY DEGLA OCTOBER CLUB - CAIRO, EGYPT** - 3000m<sup>2</sup>- Acrylic sports courts  
**-SPORTS CLUB CENTER “PAPAGOU”- ATHENS, GREECE** - 3000m<sup>2</sup>- Poltrack Sandwich, Running Track  
**-PANORAMA SPORTS COMPLEX - THESSALONIKI, GREECE** - 3000m<sup>2</sup>, Running track  
**-PLAYGROUND FLOORING PROJECT IN NORTHERN GREECE - KILKIS, GREECE** - 3000m<sup>2</sup>- SAFEPOL  
**-TENNIS HALL OF THE DEYANG OLYNPIC SPORTA CENTER - DEYANG, CHINA** - 3000 m<sup>2</sup> - SPORTFLOOR-EX  
**-BENHA SPORTS CITY - EGYPT** - 3000m<sup>2</sup>- Acrylic sports courts  
**-SPORTS COMPLEX IN UKRAINE** - 3000m<sup>2</sup> - Safety flooring, SAFEPOL MULTICOLOR system  
**-CHENAO TENNIS HALL OF THE CHONGGING OLYMPIC SPORTS CENTER - CHONGGING, CHINA** - 3000 m<sup>2</sup> -  
SPORTFLOOR-EX  
**-JOGGING TRACK AT WATERFONT - K.S.A** - 3000m<sup>2</sup> - POLTRACK JOGGING TRACK  
**-PLAYGROUND FLOORING IN SHARJA - U.A.E** - 3000m<sup>2</sup> - Playground flooring, SAFEPOL MULTICOLOR  
**-SPORTS FLOORING PROJECT IN YEMEN** - 3000m<sup>2</sup>- Acrylic sports courts, SPORTFLOOR-EX  
**-SPORTS SCHOOL PROJECT - ARTA, GREECE** - 3000m<sup>2</sup>- Acrylic sports courts, POLYFLEX AEL-EX  
**-ALIMOS STADIUM - ALIMOS, GREECE** - 2850m<sup>2</sup> - Running track, POLTRACK SANDWICH



**-INDIAN ARMY - SAGAR, INDIA** - 2800m<sup>2</sup>- Acrylic sports courts  
**-COLEGIO INTERNACIONAL DE LA SERENA - CHILE** - 2800 m<sup>2</sup> - Running track, POLTRACK SANDWICH system  
**-ALL SAINTS SCHOOL - MUMBAI, INDIA** - 2700 m<sup>2</sup> - PU outdoor sports flooring and running track  
**-INDIAN INSTITUTE OF SCIENCE EDUCATION AND RESEARCH-BHOPAL,INDIA**-2700m<sup>2</sup>-Acrylic sports courts  
**-RESORT IN RED SEA - EGYPT** - 2700m<sup>2</sup>- Acrylic sports courts, FLEXFLOOR-EX system  
**-OUR OWN GOLF SCHOOL - 2700m<sup>2</sup>-** Poltrack Spraycoat, RunningTrack  
**-BAILE FIGA, BISTRITA NASAUD - ROMANIA** - 2700m<sup>2</sup> - Safety flooring, SAFEPOL MULTICOLOR system  
**-STADIUM STUDENSKA, SPORTS COMPLEX - BARNNA, BOULGARIA** - 2700m<sup>2</sup> - SPORTFLOOR-EX system  
**-OUTDOOR SPORTS VENUE - VARNA, BULGARIA** - 2700 m<sup>2</sup> - Acrylic, ITF classified, 8 layers system  
**-RAKS PALLIKOODAM SCHOOL - INDIA** - 2600m<sup>2</sup> - Acrylic sports courts, FLEXFLOOR-EX system  
**-DPS GUNTUR SITE, NEW DELHI INDIA** - 2600m<sup>2</sup> - Acrylic sports courts, SPORTFLOOR-EX system  
**-MUNICIPAL STADIUM OF PREVEZA - GREECE** - 2600m<sup>2</sup> - Running track, POLTRACK SANDWICH  
**-HIGH SCHOOL COMPLEX - ATTIKA DISTRICT** - 2500m<sup>2</sup> - Acrylic sports courts, SPORTFLOOR FAST system  
**-KURNISH AL KHOBAR - K.S.A** - 2500m<sup>2</sup> - Rubber flooring, COLORFLEX system  
**-AL RAYAN, QATAR** - 2500 m<sup>2</sup> - Running track, POLTRACK SANDWICH system  
**-MUNICIPALITY PARK OF TRIKALA - GREECE** - 2500 m<sup>2</sup> - Running track, POLTRACK FULL-PU  
**-ALHOSN SPORTS COMPLEX** - 2400 m<sup>2</sup> - Running track, POLTRACK SANDWICH system  
**-PROJECT BELICA - CROATIA** - 2300 m<sup>2</sup> - Running track, POLTRACK SPRAYCOAT system  
**-MUNICIPAL SPORTS CENTER PAVLOU MELA - THESSALONIKI, GREECE** - 2300 m<sup>2</sup> - SPORTFLOOR-EX  
**-MUNICIPALITY STADIUM OF DOXATO - GREECE** - 2300m<sup>2</sup>- POLTRACK SANDWICH SYSTEM  
**-TORRES DE COTILLAS - SPAIN** - 2300m<sup>2</sup>- POLTRACK SPRAYCOAT  
**-WADY DEGLA EL NAKHIL CLUB - CAIRO, EGYPT** - 2260m<sup>2</sup> - Acrylic sports courts, POLYFLEX AEL-EX  
**-OUTDOOR SPORTS FLOORING PROJECT - INDIA** - 2250 m<sup>2</sup>- Acrylic sports courts, SPORTFLOOR-EX  
**-SPORTS FLOORING PROJECT IN BULGARIA** - 2200 m<sup>2</sup>- Acrylic sports courts, SPORTFLOOR-EX system  
**-LULU SCHOOL - ABU DHABI, U.A.E** - 2200 m<sup>2</sup> - SAFEPOL MULTICOLOR  
**-TEACHERS COLLEGE - ABHA, KSA** - 2050 m<sup>2</sup> - Running track  
**-MUSAB BIN OMAIR BOYS SCHOOL - BIN OMRAN, QATAR** - 2050 m<sup>2</sup> - PU outdoor sport flooring  
**-BURAIRAT SCHOOL - RAK, UAE** - 2000 m<sup>2</sup> - Running track  
**-SPORTS CENTRE OF GERAKAS - ATHENS, GREECE** - 2000m<sup>2</sup> - Acrylic sports courts, SPORTFLOOR-EX  
**-HADAYEK ALAHAMR CLUB - GIZA, EGYPT** - 2000m<sup>2</sup>-PU outdoor sports flooring, POLYFLEX PU-EX WET- POUR  
**-JP, ADA CIGANLIJA - BELGRADE, SERBIA** - 2000m<sup>2</sup> - SPORTFLOOR-EX  
**-YASMINA SCHOOL - ABUDHABI, U.A.E** - 2000m<sup>2</sup> - Playground flooring, SAFEPOL MULTICOLOR  
**-SCHOOL COMPLEX IN NAXOS ISLAND - GREECE** - 2000m<sup>2</sup> - Acrylic sports courts, SPORTFLOOR-FAST  
**-MUNICIPALITY STADIUM OF MALIA, CRETE - GREECE** - 2000m<sup>2</sup>- POLTRACK SPRAYCOAT SYSTEM  
**-AL SAILIYA BOYS SCHOOL - AL SAILIYA, QATAR** - 2000 m<sup>2</sup> - Polyurethane, outdoor sport flooring  
**-KING KHALID UNIVERSITY - ABHA, KSA** - 2000 m<sup>2</sup> - Volleyball/basketball rubber courts  
**-HH KHALID BIN BANDAR - RIYADH, KSA** - 2000 m<sup>2</sup> - Volleyball/basketball rubber courts  
**-MUNICIPALITY STADIUM OF DRAMA - GREECE** - 2000m<sup>2</sup>- POLTRACK SANDWICH SYSTEM  
**-RAWDA RASHEED PRIMARY SCHOOL FOR BOYS** - 2000 m<sup>2</sup> - Outdoor sports flooring  
**-DEIRA INTERNATIONAL SCHOOL - DUBAI, U.A.E** - 2000 m<sup>2</sup> - POLYFLEX PU-IN  
**-DAMIETTA GOVERNMENT - EGYPT** - 2000m<sup>2</sup> - Running track, Poltrack Spraycoat Sealed System  
**-MUNICIPAL STADIUM OF GIANNITSA-GIANNITSA,GREECE**-2000m<sup>2</sup> -Running track POLTRACK SANDWICH  
**-AL WAKAIR BOYS SCHOOL - AL WAKRAH, QATAR** - 1950 m<sup>2</sup> - Polyurethane, outdoor sport flooring  
**-THE LAKE DISTRICT - PUNE, INDIA** - 1950m<sup>2</sup>- Acrylic sports courts  
**-PRESIDENTIAL GUARD COMMAND MAHAWI - ABU DHABI, UAE** - 1900m<sup>2</sup> - Football court



**-GEMS CAMBRIDGE INTERNATIONAL SCHOOL - HOSHIYARPUR, INDIA - 1900m<sup>2</sup> - FLEXFLOOR-EX**  
**-MUNICIPALITY STADIUM KARPENISI, GREECE - 1900m<sup>2</sup> - POLTRACK SANDWICH SYSTEM**  
**-UNITED (SABIC) SPORTS CLUB - 1900 m<sup>2</sup> - Rubber flooring**  
**-OUTDOOR SPORTS FLOORING PROJECT - PAKISTAN - 1900 m<sup>2</sup> - WET-POUR POLYFLEX AEL-EX**  
**-SHOOLS MINISTRY OF EDUCATION - KHAMIS, KSA - 1800 m<sup>2</sup> - Rubber flooring**  
**-AL MAJAD AMPHITHEATER - SHARJA, UAE - 1800m<sup>2</sup> - Certified Jogging track**  
**-MULTIPURPOSE COURTS - KEFALONIA, GREECE - 1800m<sup>2</sup> - SPORTFLOOR-EX**  
**-QASSIM UNIVERSITY - KSA - 1800m<sup>2</sup> - Polyurethane sports flooring**  
**-MODERN ENGLISH SCHOOL - EGYPT - 1785m<sup>2</sup> - Running track, POLTRACK SPRAYCOAT**  
**-AL QADSIYA MODEL INDEPENDENT SCHOOL - ALWAAB, QATAR - 1770 m<sup>2</sup> - PU outdoor sport flooring**  
**-MUNICIPAL SPORTS CENTER IN KIATO - GREECE - 1750 m<sup>2</sup> - POLTRACK SPRAYCOAT, SPORTFLOOR-EX**  
**-IKNS SCHOOL - BAHRAIN - 1700 m<sup>2</sup> - Playground flooring, SAFEPOL MULTICOLOR system**  
**-AL WAHDA SPORT ACADEMY CLUB - ABU DHABI, UAE - 1700 m<sup>2</sup> - Acrylic sports system**  
**-MUNICIPALITY STADIUM OF AGIA VARVARA - GREECE - 1700m<sup>2</sup> - POLTRACK SPRAYCOAT SYSTEM**  
**-MULTIPURPOSE ACRYLIC COURTS - BAHRAIN - 1700 m<sup>2</sup> - SPORTFLOOR-EX system**  
**-ALSARH SCHOOLS OF CIVIL - RIYADH, KSA - 1650m<sup>2</sup> - PU glue/Soccer field**  
**-PLAYGROUND FLOORING PROJECT IN QATAR - 1650m<sup>2</sup> - SAFEPOL MULTICOLOR system**  
**-ESTADIO PROVINCIAL DE SANDIA - PUNO, PERU - 1650m<sup>2</sup> - POLTRACK SANDWICH**  
**-GD GOENKA PUBLIC SCHOLL - PURNIA, INDIA - 1630m<sup>2</sup> - Acrylic sport1600 m<sup>2</sup>**  
**-MUNICIPALITY STADIUM OF AGIA VARVARA - GREECE - 1700m<sup>2</sup> - POLTRACK SPRAYCOAT SYSTEM**  
**-MULTIPURPOSE ACRYLIC COURTS - BAHRAIN - 1700 m<sup>2</sup> - SPORTFLOOR-EX system**  
**-ALSARH SCHOOLS OF CIVIL - RIYADH, KSA - 1650m<sup>2</sup> - PU glue/Soccer field**  
**-PLAYGROUND FLOORING PROJECT IN QATAR - 1650m<sup>2</sup> - SAFEPOL MULTICOLOR system**  
**-ESTADIO PROVINCIAL DE SANDIA - PUNO, PERU - 1650m<sup>2</sup> - POLTRACK SANDWICH**  
**-GD GOENKA PUBLIC SCHOLL - PURNIA, INDIA - 1630m<sup>2</sup> - Acrylic sport1600 m<sup>2</sup> - s courts**  
**-CIVIL DEFENCE TRAINING CENTER, EASTERN PROVINCE - K.S.A - 1600 m<sup>2</sup> - POLTRACK SPRAYCOAT**  
**-SPA RESORT DERENIVSKUPIA KI - UZHGOROD, UKRAINE - 1600 m<sup>2</sup> - Flexfloor-ex system, volleyball court**  
**-CIVIL DEFENCE TRAINING CENTER, EASTERN PROVINCE - K.S.A - 1600 m<sup>2</sup> - POLYFLEX PU-IN**  
**-IISER, INDIAN INSTITUTE OF SCIENCE EDUCATION AND RESEARCH - BHOPAL, INDIA - 1600m<sup>2</sup> - Acrylic sports courts, FLEXFLOOR-EX system**  
**-EFKARPIA MUNICIPALITY - THESSALONIKI, GREECE - 1600m<sup>2</sup> - Acrylic sports courts,SPORTFLOOR-EX**  
**-GRACANICA SPORTS CENTRE - KOSOVO - 1600m<sup>2</sup> - Running Track, POLTRACK PRAYCOAT system**  
**-3 OUTDOOR BASKETBALL COURTS - RHODES ISL GREECE - 1600 m<sup>2</sup> - FLEXFLOOR-EX system**  
**-RUNNING TRACK PROJECT IN BOSNIA & HERZEGOVINA - 1585<sup>2</sup> - POLTRACK PRAYCOAT**  
**-THE MILITARY HOSPITAL - RIYADH, KSA - 1560 m<sup>2</sup> - Volleyball/basketball rubber courts-PU sports flooring**  
**-STADIUM IN BAJRAM CURRI - TROPOJA, ALBANIA - 1550 m<sup>2</sup> - SPRAYCOAT system**  
**-SCHOOL SPORTS COMPLEX IN POLIGIROS - GREECE - 1550m<sup>2</sup> - Acrylic flooring, SPORTFLOOR FAST**  
**-AL FORSHAN SPORTS CENTRE - ABU DHABI, U.A.E - 1500m<sup>2</sup> - Smartfloor system, Acrylic flooring**  
**-INDUSTRIAL FLOORING - BULGARIA - 1500m<sup>2</sup> - Epoxy flooring, Polepox Coat 814 system**  
**-SCHOOL IN AL WAKRA CITY - DOHA, QATAR - 1500 m<sup>2</sup> - Playground flooring**  
**-REAL SCHOOL SHAH ALAM - MALAYSIA - 1500 m<sup>2</sup> - POLTRACK SPRAYCOAT**  
**-IRAQ ARMY CAMP - IRAQ - 1500m<sup>2</sup> - Acrylic flooring in 2,2mm**  
**-BICYCLE TRACK PROJECT - LARISA-TRIKALA, GREECE - 1500 m<sup>2</sup> - SPORTGROUND-EX**  
**-PROJECT GREEN LAND - DUBAI, UAE - 1500 m<sup>2</sup> - Jogging track**  
**-UP TOWN SCHOOL - 1500m<sup>2</sup> - Poltrack Spraycoat, RunningTrack**

**-INDIAN AIR FORCE - ALLAHABAD, INDIA** - 1450m<sup>2</sup> - Acrylic sports courts  
**-OUTDOOR SPORTS COURT COMPLEX - INDIA** -1400m<sup>2</sup>- PU flooring, WET-POUR POLYFLEX PU-EX  
**-SPORTS FLOORING PROJECT IN KOSOVO - STREET BALL** - 1400m<sup>2</sup>- SPORTFLOOR-EX  
**-DUBAI MODERN HIGH SCHOOL - DUBAI, UAE** - 1375 m<sup>2</sup> - Acrylic sports courts  
**-PROJECT ECOGREEN - DUBAI, UAE** - 1350 m<sup>2</sup> - Jogging track  
**-SAVA BASELINE ACADEMY - MALTA** - 1350m<sup>2</sup> - SMARTFLOOR-EX  
**-TENNIS CLUB CENTER IN LJUBLJANA - SLOVENIA** - 1350m<sup>2</sup>- SPORTFLOOR-EX  
**-SPORTS FLOORING PROJECT - BANSKO, BULGARIA** - 1350 m<sup>2</sup> - Acrylic sports courts  
**-"10" NATIONAL TV STATION - KOSOVO** - 1300 m<sup>2</sup> - Outdoor, acrylic flooring, WET POUR POYFLEX AEL-EX  
**-POLICE COMPLEX BARRACKS NIZWA - OMAN**- 1300 m<sup>2</sup> - Colorflex, PU sport flooring  
**-POLICE COMPLEX BARRACKS AL AJAIZ - OMAN** - 1300 m<sup>2</sup> - Colorflex, PU sport flooring  
**-POLICE COMPLEX BARRACKS KATMATMILAH SITE - OMAN**- 1300 m<sup>2</sup> - Colorflex, PU sport flooring  
**-POLICE COMPLEX BARRACKS SUWAIQ - OMAN** - 1300 m<sup>2</sup> - Colorflex, PU sport flooring  
**-POLICE COMPLEX BARRACKS AL KAMIL - OMAN** - 1300 m<sup>2</sup> - Colorflex, PU sport flooring  
**-PLAYGROUND FLOORING - BAHRAIN** - 1300m<sup>2</sup> - Safepol system  
**-POLICE COMPLEX BARRACKS SHINAS - OMAN** - 1300 m<sup>2</sup> - Colorflex, PU sport flooring  
**-POLICE COMPLEX BARRACKS BHALA - OMAN** - 1300 m<sup>2</sup> - Colorflex, PU sport flooring  
**-POLICE COMPLEX BARRACKS MUDHAIBI - OMAN** - 1300 m<sup>2</sup> - Colorflex, PU sport flooring  
**-POLICE COMPLEX BARRACKS THUMRAIT - OMAN** - 1300 m<sup>2</sup> - Colorflex, PU sport flooring  
**-BASKETBALL COURTS PROJECT - NEAPOLI, THESSALONIKI, GREECE** - 1300m<sup>2</sup> - SPORTFLOOR-EX  
**-POLICE COMPLEX BARRACKS AL KHOUDH - OMAN** - 1300 m<sup>2</sup> - Colorflex, PU sport flooring  
**-POLICE COMPLEX BARRACKS MAHDAH - OMAN** - 1300 m<sup>2</sup> - Colorflex, PU sport flooring  
**-POLICE COMPLEX BARRACKS BID BID - OMAN** - 1300 m<sup>2</sup> - Colorflex, PU sport flooring  
**-POLICE COMPLEX BARRACKS AL KHAPOORA - OMAN** - 1300 m<sup>2</sup> - Colorflex, PU sport flooring  
**-POLICE COMPLEX BARRACKS DHANK - OMAN** - 1300 m<sup>2</sup> - Colorflex, PU sport flooring  
**-POLICE COMPLEX BARRACKS HAFEET - OMAN** - 1300 m<sup>2</sup> - Colorflex, PU sport flooring  
**-POLICE COMPLEX BARRACKS AUQAD - OMAN** - 1300 m<sup>2</sup> - Colorflex, PU sport flooring  
**-POLICE COMPLEX BARRACKS SUMAIL - OMAN** - 1300 m<sup>2</sup> - Colorflex, PU sport flooring  
**-MATRIX SPORTING CLUB - EGYPT** - 1300 m<sup>2</sup> - Acrylic flooring, Flexfloor System  
**-OUTDOOR SPORTS VENUE - KOSOVO** - 1300 m<sup>2</sup> - POLTRACK SPRAYCOAT System  
**-MUNICIPALITY SPORTS CENTRE SYKIES, THESSALONIKI - GREECE** - 1300m<sup>2</sup>- POLTRACK SANDWICH  
**-SPORTS HALL IBRI - MUSCAT, OMAN** - 1300 m<sup>2</sup> - Indoor sports flooring POLYFLEX PU-IN  
**-IK TENNIS ACADEMY - MALTA** - 1300 m<sup>2</sup> - SPORTFLOOR-EX HARD COURT  
**-ALHALAFI BREAK - RIYADH, KSA** - 1276 m<sup>2</sup> - Rubber flooring  
**-DELHI PUBLIC SCHOOL - ETAWAH, INDIA** - 1250m<sup>2</sup>- Acrylic sports courts, FLEXFLOOR-EX system  
**-SCHOOL SPORTS PROJECT - ARTASHAT, ARMENIA** - 1250m<sup>2</sup>- COLORLFEX-EX  
**-GI-DHOFAR BEACH RESORT & SPA - OMAN** - 1225 m<sup>2</sup> - Colorflex, PU sport flooring  
**-RLS BASIC EDUCATION SCHOOL SOHAR - OMAN** - 1225 m<sup>2</sup> - Colorflex, PU sport flooring  
**-MIXED BASIC EDUCATION SCHOOL AL QABIL - OMAN** - 1225 m<sup>2</sup> - Colorflex, PU sport flooring  
**-BOYS BASIC EDUCATION SCHOOL BARKHA - OMAN** - 1225 m<sup>2</sup> - Colorflex, PU sport flooring  
**-GIRLS BASIC EDUCATION SCHOOL MUDHAIBI - OMAN** - 1225 m<sup>2</sup> - Colorflex, PU sport flooring  
**-MIXED BASIC EDUCATION SCHOOL AL AMERAT - OMAN** - 1225 m<sup>2</sup> - Colorflex, PU sport flooring  
**-UMSALAMA GIRLS SCHOOL - AL RAYYAN, QATAR** - 1200 m<sup>2</sup> - Polyurethane, outdoor sport flooring  
**-SHERATON PARK - DOHA, QATAR** - 1200 m<sup>2</sup> - Playground flooring  
**-RAWDA BIN JASSIM SCHOOL - AL AZIZIYAH, QATAR** - 1200 m<sup>2</sup> - Polyurethane, outdoor sport flooring

**-GEMS WESTMINSTER SCHOOL - DUBAI, U.A.E** - 1200 m<sup>2</sup> - Acrylic sports courts  
**-SILVER SPORTS CLUB - INDIA** - 1200m<sup>2</sup> - Acrylic sports courts  
**-OUR OWN SCHOOL - SHARJA, U.A.E** - 1200m<sup>2</sup> - Acrylic sports courts  
**-SHARJAH FOOTBALL CLUB - SHARJAH, UAE** - 1200 m<sup>2</sup> - Polyurethane basketball courts  
**-SHERATON PARK - DOHA, QATAR** - 1200 m<sup>2</sup> - Playground flooring  
**-CHILE RUNNING TRACK PROJECT** - 1200 m<sup>2</sup> - Running track, POLTRACK SPRAYCOAT system  
**-EGYPT RUNING TRACK PROJECT** - 1200m<sup>2</sup>, Running Track, POLTRACK SPRAYCOAT system  
**-EGYPT RUNING TRACK PROJECT** - 1200m<sup>2</sup>, Running Track, POLTRACK SANDWICH system  
**-ALIGARH MUSLIM UNIVERSITY - ALIGARH, INDIA** - 1200 m<sup>2</sup> - Acrylic sports courts, FLEXFLOOR-EX system  
**-SUMMER RESORT, KIDS Paly Area - CHALKIDIKI, GREECE** - 1200 m<sup>2</sup> - Playground flooring, SAFEPOL  
**-SPORTS FLOOR PROJECT IN PAKISTAN** - 1200 m<sup>2</sup> - Acrylic sports courts, POLYFLEX AEL-EX  
**-SCHOOL COMPLEX - ZAKINTHOS, GREECE** - 1200 m<sup>2</sup> - Acrylic sports courts, SPORTFLOOR FAST  
**-SYMBIOSIS COLLEGE - INDIA** - 1180m<sup>2</sup> - Acrylic sports courts  
**-SPORTS PROJECT IN EGYPT** - 1170m<sup>2</sup> - Acrylic sports courts, POLYFLEX AEL-EX  
**-PROFESSOR ABDULAZIZ ANQARI - RIYADH, KSA** -1150m<sup>2</sup> - PU glue/Socccer field  
**-ACRYLIC, OUTDOOR SPORTS FLOORING PROJECT - KARACHI, PAKISTAN** -1150m<sup>2</sup> - FLEXFLOOR-EX  
**-AL SAQID ISLAMIC ENGLISH SHCOLL-DUBAI,UAE**-1100m<sup>2</sup>- Acrylic flooring, WET-POUR POLYFLEX AEL-EX  
**-REAL SCHOOL HULU LANGAT - MALAYSIA** - 1100m<sup>2</sup> - POLTRACK SPRAYCOAT  
**-MAADI BRITISH SCHOOL- EGYPT** - 1100m<sup>2</sup>, Multipurpose court, COLORFLEX system  
**-OUTDOOR SPORTS PROJECT IN FOCSANI REGION - ROMANIA** - 1100m<sup>2</sup> - POLTRACK SPRAYCOAT  
**-CENTRAL SQUARE OF MUNICIPALITY OF THERMI - THESSALONIKI, GREECE** - 1100m<sup>2</sup>, Decorative flooring MARMOR FLOOR system  
**-GREEK TECHNOLOGICAL EDUCATIONAL INSTITUTE OF THESSALIA - GREECE** - 1100m<sup>2</sup>, Running Track, POLTRACK SANDWICH system  
**-NANSHA INTERNATIONAL TENNIS CENTER - GUANGZHOU, CHINA** - 1000 m<sup>2</sup> - SPORTFLOOR-EX  
**-KORYDALLOS DISTRICT - ATHENS, GREECE** - 1100m<sup>2</sup> - FLEXFLOOR-EX  
**-CINEGUILLA - PERU** - 1100m<sup>2</sup> - POLYFLEX PU-EX  
**-FIRST POINT SCHOOLS - DUBAI, UAE**1100m<sup>2</sup> - Acrylic sports courts  
**-OUTDDOR SPORTS FLOORING PROJECT-ARTA, GREECE**-1100m<sup>2</sup>-POLYFLEX AEL-EX & SPORTFLOOR  
**-TUMBES - PERU** - 1100m<sup>2</sup> - POLYFLEX PU-IN  
**-DUBAI AMERICAN ACADEMY - DUBAI, UAE** - 1080 m<sup>2</sup> - Acrylic sports court  
**-PRELUDE PUBLIC SCHOOL - AGRA, INDIA** - 1070m<sup>2</sup> - Acrylic sports courts  
**-INDOOR SPORTS FLOORING PROJECT - JORDAN** - 1055m<sup>2</sup> - Polyurethane POLYFLEX PU-IN  
**-ALMGBAL BREAK - RIYADH, KSA** - 1050 m<sup>2</sup> - Rubber playground  
**-PLAYGROUND MULTI-PROJECT IN HUANCVELICA - PERU** - 1050 m<sup>2</sup> - SAFEPOL MULTICOLOR  
**-BANIYAS CLUB AND AL AIN ENGLISH SPEAKING SCHOOL - ABU DHABI, UAE** - 1000m<sup>2</sup> - Acrylic flooring  
**-WADY DEGLA LOTUS PROJECT - CAIRO, EGYPT** - 1000 m<sup>2</sup> - Acrylic flooring, Wet-Pour Polyflex AEL-EX  
**-GRAVA SCHOOL COMPLEX - ATHENS, GREECE** - 1000 m<sup>2</sup> - POLTRACK SANDWICH RETTOPING  
**-INDIAN AIR FORCE - VARANASI, INDIA** - 1000m<sup>2</sup> - Acrylic sports courts  
**-MULTIPURPOSE COURT - K.S.A** - 1000m<sup>2</sup>- WET-POUR POLEFLEX AEL-EX  
**-GARDENIA RESIDENTS - DUBAI, U.A.E** - 1000 m<sup>2</sup> - SAFEPOL MULTICOLOR system  
**-JINDAL UNIVERSITY - SONIPAT, HARYANA, INDIA** - 1000m<sup>2</sup> - PU flooring WET-POUR POLYFLEX PU-EX  
**-MINISTRY OF EDUCATION - DAMMAM, KSA** - 1000 m<sup>2</sup> - PU indoor multipurpose sports flooring  
**-SHEIKH OBEID MAKTHOUM PALACE** - 1000m<sup>2</sup> - Outdoor polyurethane flooring  
**-PAVILHAO POLIDESPORTIVO - SAO JOAO DA PESQUEIRA - PORTUGAL** - 1000 m<sup>2</sup> - POLYFLEX PU-IN

**-INDIAN AIR FORCE - AGRA, INDIA - 1000m<sup>2</sup> - Acrylic sports courts**  
**-INDONESIA - 1000 m<sup>2</sup> - PU indoor multipurpose sports flooring**  
**-FOOTBALL PITCH PROJECT IN CHALKIDIKI - GREECE-1000 m<sup>2</sup> Artificial Grass POLITURF TRIUMPH 60100**  
**-INDIAN AIR FORCE - LUCKNOW, INDIA - 1000m<sup>2</sup> - Acrylic sports courts**  
**-MULTIPURPOSE POLYURTEHANE INDOOR COURTS - F.Y.R.O.M - 1000m<sup>2</sup> - Polyflex PU-In system**  
**-SODIC PROJECT - EGYPT - 1000m<sup>2</sup>, Multipurpose court, COLORFLEX system**  
**-MUNICIPALITY STADIUM OF LARISA "ALKAZAR"- GREECE -1000m<sup>2</sup>-POLTRACK SANDWICH RETTOPING**  
**-INDIAN AIR FORCE - VARANASI, INDIA - 1000m<sup>2</sup> - Acrylic sports courts**  
**-INTERNATIONAL SCHOOL OF CREATIVE SCHIENCE - SHARJAH, U.A.E - 1000m<sup>2</sup> - Safepol System**  
**-INDIAN AIR FORCE - BIHTA, INDIA - 1000m<sup>2</sup> - Acrylic sports courts**  
**-INDIAN AIR FORCE - DARBHANGA, INDIA - 1000m<sup>2</sup> - Acrylic sports courts**  
**-AL AIN INDIAN SCHOOL - AL AIN, UAE - 1000m<sup>2</sup> - Football court**  
**-GREEK AIR FORCE ACADEMY - TATOI, ATHENS, GREECE - 1000m<sup>2</sup> - PU flooring, POLYFLEX PU-IN**  
**-DUBAI SCHOLRAS PRIVATE SCHOOL - DUBAI, U.A.E - 1000m<sup>2</sup> - Acrylic flooring in 2,2mm**  
**-OBOOR SPORTS CLUB - EGYPT - 1000m<sup>2</sup> - Acrylic flooring**  
**-CAMANA - PERU - 1000m<sup>2</sup> - POLYFLEX PU-IN**  
**-INDOOR SPORTS PROJECT IN OMAN - MINISTRY OF EDUCATION - 1000m<sup>2</sup> - PU sports flooring**  
**-VIT AP CAMPUS, AMARAVANTHI, VIJAYAWADA, ANDHRA PRADESH - INDIA - 985m<sup>2</sup> POLYFLEX PU-IN**  
**-MONARCH INTERNATIONAL SCHOOL - 950m<sup>2</sup>- Acrylic sports courts, FLEXFLOOR-EX system**  
**-FOOTBALL COURT - LIMASSOL, CYPRUS - 950m<sup>2</sup> - Artificial grass, POLITURF IMPERIAL 50140**  
**-MULTISPORT FIELD GADIME - KOSOVO - 950m<sup>2</sup> - POLTRACK SPRAYCOAT**  
**-COMMUNITY COLLEGE - KHAMIS, KSA - 940 m<sup>2</sup> - Polyurethane indoor multipurpose sports flooring**  
**-GEMS METROPOLE SCHOOL - DUBAI, U.A.E - 900 m<sup>2</sup> - Playground flooring**  
**-PLAYGROUND FLOORING IN KHARKIV-2 - UKRAINE - 900m<sup>2</sup> - SAFEPOL MULTICOLOR system**  
**-MINISTRY OF EDUCATION - ABHA, KSA - 900 m<sup>2</sup> - Polyurethane indoor multipurpose sports flooring**  
**-BAB AL SHAMS SPA HOTEL - DUBAI, UAE - 900m<sup>2</sup> - Football court**  
**-STREET BALL COURTS - BOSNIA 7 HERZEGOVINA - 880m<sup>2</sup> - POLTRACK SPRAYCOAT system**  
**-CAIRO FESTIVAL CITY ORIANA PROJECT - EGYPT - 855m<sup>2</sup> - Playground flooring, SAFEPOL MULTICOLOR**  
**-INDIAN NAVY - KOCHI, INDIA - 850m<sup>2</sup> - Acrylic sports courts, FLEXFLOOR-EX system**  
**-PARCONA - PERU - 850m<sup>2</sup> - POLYFLEX PU-EX**  
**-SCHOOL SPORTS COMPLEX - K.S.A - 850m<sup>2</sup> - POLYFLEX AEL-EX**  
**-CHICAUMA PROJECT - CHILE - 850m<sup>2</sup> - SAFEPOL MULTICOLOR**  
**-JUBAIL - K.S.A - 850m<sup>2</sup> - WETPOUR POLYFLEX AEL-EX**  
**-PLAYGROUND PROJECT IN KILKIS - GREECE - 850m<sup>2</sup> - Playground flooring, SAFEPOL MULTICOLOR**  
**-GALGOTIAS UNIVERSITY - NOIDA, INDIA - 830m<sup>2</sup>- Acrylic sports courts, FLEXFLOOR-EX system**  
**-KING KHALID UNIVERSITY - ABHA, KSA - 820 m<sup>2</sup> - Polyurethane indoor multipurpose sports flooring**  
**-SCHOOL COMPLEX - KOSOVO - 820 m<sup>2</sup> - SPORTFLOOR-EX, ITF classified – class 4**  
**-YLL MORINA SCHOOL - GJAKOVA, KOSOVO - 810m<sup>2</sup>- Outdoor sports project, POLTRACK SPRAYCOAT**  
**-GYMNASIUM IN OBERHOFFEN - ALSACE, FRANCE - 800m<sup>2</sup>- POLYFLEX PU-IN**  
**-SPORTS CENTER ANTIRIO - GREECE - 800m<sup>2</sup> - Running track POLTRACK SPRAYCOAT**  
**-JINDAL UNIVERSITY - SONIPAT, HARYANA, INDIA - 800m<sup>2</sup> - POLTRACK JOGGING TRACK**  
**-ARTIFICIAL GRASS - STATOVCHA, BULGARIA - 800m<sup>2</sup> - Artificial grass, POLITURF ROYAL 5588**  
**-SCHOOL IN AL WAKRA CITY - DOHA, QATAR - 800m<sup>2</sup> - Polyurethane sports flooring**  
**-LYCEE FRANCAISE PROJECT - BEIRUT, LEBANON - 800m<sup>2</sup> - Acrylic sports flooring**



**-SULTAN MANOR - RIYADH, KSA - 800m<sup>2</sup> - Polyurethane multipurpose sports flooring**  
**-MINISTRY OF EDUCATION - AL KHARIZ, KSA - 800m<sup>2</sup> - PU indoor multipurpose sports flooring**  
**-GEMS AMERICAN ACADEMY - ABU DHABI - U.A.E - 800m<sup>2</sup> - Running track POLTRACK SANDWICH**  
**-INDOOR SPORTS COURT - MALAYSIA - 800m<sup>2</sup> - PU indoor sports flooring**  
**-KID'S PLAY AREA IN MALL - MOROCCO - 800m<sup>2</sup> - PU indoor sports flooring, POLYFLEX PU-IN system**  
**-MARASSI R1 PROJECT - EGYPT - 800m<sup>2</sup> - Playground flooring, SAFEPOL MULTICOLOR system**  
**-SPORTS CENTER GLIFADA, ATHENS - GREECE - 800m<sup>2</sup> - Running track POLTRACK SANDWICH**  
**-SPORTS CENTER VRILISIA, ATHENS - GREECE - 800m<sup>2</sup> - Running track POLTRACK SANDWICH**  
**-DUBAI ENGLISH SPEAKING COLLEGE - DUBAI, UAE - 783m<sup>2</sup> - Acrylic flooring, SPORTFLOOR-EX**  
**-MULTIPURPOSE COURT - YEREVAN - ARMENIA - 765m<sup>2</sup> - COLORFLEX-EX**  
**-HAYATABAD PESHAWAR - INDIA - 750m<sup>2</sup> - Polyurethane sports flooring, POLYFLEX PU-IN**  
**-SINGAPORE AIRLINES - SINGAPORE - 735m<sup>2</sup> - PU indoor sports flooring**  
**-CJM MIZIARA SCHOOL - LEBANON - 730m<sup>2</sup> - WET-POUR POLYFLEX AEL-EX**  
**-AL DAJAN COMPANY - GASIM, KSA - 722m<sup>2</sup> - Polyurethane sports flooring/Tennis court**  
**-SELECTIVE GOVERNMENT HIGH SCHOOL - EGYPT - 720m<sup>2</sup>, Outdoor sports flooring**  
**-INDIAN AIR FORCE - AHMEDABAD, INDIA - 720m<sup>2</sup>- Acrylic sports courts**  
**-FITNESS TIME - FAYSALIA, DAMMAM, KSA - 700 m<sup>2</sup>-PU indoor multipurpose sports flooring/running track**  
**-FITNESS TIME YASMEEN - RIYADH, KSA - 700 m<sup>2</sup> - PU indoor multipurpose sports flooring/running track**  
**-FERRARI WORLD - ABU DHABI, UAE - 700m<sup>2</sup> - Playground flooring**  
**-KOHAT SPORTS COMPLEX - PAKISTAN - 700m<sup>2</sup> - PU flooring, POLYFLEX PU-IN**  
**-FITNESS TIME JUNIOR - RIYADH, KSA - 700 m<sup>2</sup> - PU indoor multipurpose sports flooring/running track**  
**-FITNESS TIME - OLAYA RIYADH, KSA - 700 m<sup>2</sup> - PU indoor multipurpose sports flooring/ running track**  
**-FITNESS TIME WAHA - RIYADH, KSA - 700 m<sup>2</sup> - PU indoor multipurpose sports flooring/running track**  
**-FITNESS TIME, NOOR BRANCH - DAMMAM, KSA -700 m<sup>2</sup> - PU indoor sports flooring and running track**  
**-FITNESS TIME, ALAMEEN BRANCH - DAMMAM, KSA - 700 m<sup>2</sup> - PU indoor sports flooring and running track**  
**-FITNESS TIME, PLUS RIYADH - RIYADH, KSA - 700 m<sup>2</sup> - PU indoor sports flooring and running track**  
**-FITNESS TIME, SALAMA BRANCH BRO & FITNESS - JEDDAH, KSA - 700 m<sup>2</sup> - PU indoor sports flooring**  
**-FITNESS TIME, 40th BRANCH - JEDDAH, KSA - 700 m<sup>2</sup> - PU indoor sports flooring and running track**  
**-NASR CLUB- EGYPT - 700m<sup>2</sup>, Multipurpose court, POLYFLEX WET-POUR system**  
**-HUREL DOUBLE 3 - RAS AL KHAIMH, KSA - 700 m<sup>2</sup> - Shockpad plus acrylic coatings**  
**-THE SUSTAINABLE CITY - DUBAI, U.A.E - 700 m<sup>2</sup> - Acrylic flooring**  
**-PROJECT IN MALTA - 700 m<sup>2</sup> - Acrylic flooring, SPORTFLOOR-EX system**  
**-EMAAR - EMIRATES HILLS 2 - DUBAI, U.A.E - 700m<sup>2</sup> - Basketball court, Acrylic flooring**  
**-AIRFORCE SURBOTO PARK - NEW DELHI, INDIA - 680 m<sup>2</sup> - Polyurethane outdoor sports flooring**  
**-INDIAN ARMY - DHRANGDHARA, INDIA - 670m<sup>2</sup> - Acrylic sports courts**  
**-MT.SAINT PATRICK ACADEMY - INDIA - 665m<sup>2</sup>- Acrylic sports courts**  
**-RAJIV GANDHI THERMAL POWER PLANT - HISAR, INDIA - 650m<sup>2</sup> - Acrylic sports courts, FLEXFLOOR-EX**  
**-JAWAHARLAL NEHRU TECHNOLOGICAL UNIVERSITY ANANTAPURAMU - ANANTAPUR, INDIA - 650m<sup>2</sup> - Acrylic sports courts, FLEXFLOOR-EX system**  
**-TILAL HOTEL - DUBAI, U.A.E - 650 m<sup>2</sup> - SAFEPOL MULTICOLOR system**  
**-REGIONAL HQ AT BURAIMI - OMAN - 650 m<sup>2</sup> - Colorflex, PU sport flooring**  
**-PLAYGROUND FLOORING PROJECT IN LARNAKA, CYPRUS - 650 m<sup>2</sup> - SAFEPOL MULTICOLOR system**  
**-ROYAL OMAN POLICE TASK FORCE RUSTAQ - OMAN - 650 m<sup>2</sup> - Colorflex, PU sport flooring**  
**-ROYAL OMAN POLICE TASK FORCE LIWA - OMAN - 650 m<sup>2</sup> - Colorflex, PU sport flooring**  
**-ROYAL OMAN POLICE TASK FORCE AL SALIL - OMAN - 650 m<sup>2</sup> - Colorflex, PU sport flooring**

**-OUTDOOR TENNIS COURTS - KOSOVO - 650m<sup>2</sup> - Acrylic sports courts, SPORTFLOOR-EX**  
**-ROYAL OMAN POLICE TASK FORCE IBRI - OMAN - 650m<sup>2</sup> - Colorflex, PU sport flooring**  
**-ROYAL OMAN POLICE TASK FORCE IBRA - OMAN - 650m<sup>2</sup> - Colorflex, PU sport flooring**  
**-ROYAL OMAN POLICE TASK FORCE AL SUR - OMAN - 650m<sup>2</sup> - Colorflex, PU sport flooring**  
**-3 PICKLEBALL COURTS IN CRAZ CITY - AUSTRIA - 650m<sup>2</sup> - Acrylic sports flooring, FLEXFLOOR-EX system**  
**-ROYAL OMAN POLICE TASK FORCE AL DUKUM - OMAN - 650m<sup>2</sup> - Colorflex, PU sport flooring**  
**-ROYAL OMAN POLICE TASK FORCE AL BURAIMI - OMAN - 650m<sup>2</sup> - Colorflex, PU sport flooring**  
**-OASIS COMPLEX - K.S.A - 650m<sup>2</sup> - WET-POUR POLYFLEX PU-IN system**  
**-ROYAL OMAN POLICE TASK FORCE AL NIZWA - OMAN - 650m<sup>2</sup> - Colorflex, PU sport flooring**  
**-ROYAL OMAN POLICE TASK FORCE AL SUWAIQ - OMAN - 650m<sup>2</sup> - Colorflex, PU sport flooring**  
**-ABU DHABI MUNICIPALITY - ABU DHABI , UAE - 650m<sup>2</sup> - Acrylic flooring**  
**-INDOOR BASKETBALL COURT - JUBAIL - K.S.A - 650m<sup>2</sup> - WET-POUR POLYFLEX PU-IN system**  
**-ST. MARY'S SCHOOL - LEMESOS, CYPRUS - 650m<sup>2</sup> - Playground flooring, SAFEPOL MULTICOLOR**  
**-ROYAL OMAN POLICE TASK FORCE AL SALALAH - OMAN - 650m<sup>2</sup> - Colorflex, PU sport flooring**  
**-ROYAL OMAN POLICE TASK FORCE AL BARKHA - OMAN - 650m<sup>2</sup> - Colorflex, PU sport flooring**  
**-ROYAL OMAN POLICE TASK FORCE KHOUDH - OMAN - 650m<sup>2</sup> - Colorflex, PU sport flooring**  
**-MULTIPURPOSE COURTS - TIRANA, ALBANIA - 650m<sup>2</sup> - Acrylic sports flooring, FLEXFLOOR system**  
**-PLAYGROUND FLOORING IN KHARKIV-3 - UKRAINE - 650m<sup>2</sup> - SAFEPOL MULTICOLOR system**  
**-MOHAMMED JASSIM M AL THANI SCHOOL - UMSALALALI, QATAR - 620m<sup>2</sup> - PU outdoor sport flooring**  
**-QATAR GEMS SCHOOL - DOHA, QATAR - 615m<sup>2</sup> - Polyurethane sports flooring**  
**-VELOOR THRISSUR DISTRICT - KERALA, INDIA - 610m<sup>2</sup> - Acrylic sports courts, FLEXFLOOR-EX system**  
**-PUBLIC PARK - ABU DHABI, U.A.E - 610m<sup>2</sup> - Acrylic sports courts, SPORTFLOOE-EX FAST system**  
**-VAISHNO DEVI - DELHI, INDIA - 610m<sup>2</sup> - Polyurethane outdoor sports flooring**  
**-EQUINE FLOORING - BAHRAIN - 600m<sup>2</sup>, POLTRACK EQUESTRIAN SYSTEM**  
**-THAILAND - 600m<sup>2</sup> - Acrylic sports courts**  
**-VILLA SINMAC PARK - SAN ANTONIO, PERU - 600m<sup>2</sup> - SAFEPOL MULTICOLOR system**  
**-WATER'S EDGE RESIDENTIAL DEV'T - YAS ISLAND, ABHU DHABI, U.A.E - 600m<sup>2</sup> Sportground-Ex system**  
**-PLAYGROUND FLOORING IN BAHRAIN - 600m<sup>2</sup> - SAFEPOL MULTICOLOR system**  
**-PLAYGROUND FLOORING IN KHARKIV - UKRAINE - 600m<sup>2</sup> - SAFEPOL MULTICOLOR system**  
**-INDIAN ARMY - AGRA, INDIA - 600m<sup>2</sup> - Acrylic sports courts**  
**-THE INTERNATIONAL SCHOOL - AGRA, INDIA - 600m<sup>2</sup> - Acrylic sports courts**  
**-INDIAN ARMY - JHANSI, INDIA - 600m<sup>2</sup> - Acrylic sports courts**  
**-THE SUSTAINABLE CITY - DUBAI, U.A.E - 600m<sup>2</sup> - Safepol system**  
**-AMITY SCHOOL, JUMEIRAH ISLAND - DUBAI, UAE - 600m<sup>2</sup> - Safepol system**  
**-QUEEN ZAIN AL SHARAF HALL - JORDAN - 600m<sup>2</sup> - POLYFLEX PU-IN**  
**-OUR OWN ENGLISH HIGH SCHOOL - SHARJAH, U.A.E - 600m<sup>2</sup> - Flexfloor system**  
**-OUR OWN ENGLISH HIGH SCHOOL - SHARJAH, U.A.E - 600m<sup>2</sup> - Polyflex Ael-EX system**  
**-ST. FRANCIS INTER COLLEGE - HATHRAS, INDIA - 600m<sup>2</sup> - Acrylic sports courts, FLEXFLOOR-EX system**  
**-ST. ANTHONY'S SENIOR SECONDARY SCHOOL - FARRUKHABAD, INDIA - 600m<sup>2</sup> - FLEXFLOOR-EX**  
**-SKATING FOR KIDS - GUJARAT, INDIA - 600m<sup>2</sup> - Sportfloor system**  
**-IMS COLLEGE - GHAZIABAD, INDIA - 600m<sup>2</sup> - Acrylic sports courts, FLEXFLOOR-EX system**  
**-GALGOTIAS COLLEGE OF ENGINEERING - GR. NOIDA, INDIA - 600m<sup>2</sup> - Acrylic sports courts, FLEXFLOOR-EX**  
**-HOTEL COMPLEX IN DHERMI, ALBANIA - 600m<sup>2</sup> - Acrylic sports courts, SPORTFLOOR-EX system**  
**-DANIEL BECCERA OCAMPO EDUCATIONAL INSTITUTION-MONQUEGUA,PERU - 580m<sup>2</sup> POLYFLEX PU-EX**  
**-TATLAY AALI SPORTS COMPLEX - PAKISTAN - 500m<sup>2</sup> - PU flooring, POLYFLEX PU-IN**

**-NEW DUBAI BRADENTON SCHOOL- DUBAI, UAE - 570m<sup>2</sup> - Acrylic sports courts**  
**-«CRONWELL PLATAMON RESORT» HOTEL IN PLATAMONAS - GREECE - 560m<sup>2</sup> - SPLASH PARK FLOORING, AQUASOFT-EX system**  
**-DUBAI SILICON OSIS-CENTRAL PARK, DSO - DUBAI, UAE - 560 m<sup>2</sup> - Jogging track**  
**-MPS WORLD SCHOOL - AGRA, INDIA - 560m<sup>2</sup>- Acrylic sports courts**  
**-LEADERS INTERNATIONAL SCHOOLS - EGYPT - 560m<sup>2</sup>- PU sports courts**  
**-PLAYGROUND PROJECT IN AL KASIM - K.S.A - 560m<sup>2</sup>- SAFEPOL MULTICOLOR**  
**-HARTLAND INTERNATIONAL SCHOOL - U.A.E - 550m<sup>2</sup>- SAFEPOL MULTICOLOR system**  
**-PLAYGROUND FLOORING PROJECT IN SINGAPORE - 550m<sup>2</sup>- SAFEPOL MULTICOLOR system**  
**-ARMY LAW COLLEGE PUNE- PUNE, INDIA - 550m<sup>2</sup>- Acrylic sports courts, FLEXFLOOR-EX system**  
**-AL WUKAIR GIRLS SCHOOL - AL WAKRAH, QATAR - 550m<sup>2</sup> - Polyurethane, outdoor sport flooring**  
**-AL BUROUJ PROJECT, SPORTS CLUB - EGYPT - 550m<sup>2</sup> - Running track, POLTRACK SPRAYCOAT**  
**-PLAYGROUND PROJECT IN CYPRUS - 550m<sup>2</sup>- SAFEPOL MULTICOLOR system**  
**-BBPS - DELHI, INDIA - 512m<sup>2</sup> - Polyurethane outdoor sports flooring**  
**-IVY STATE - PUNE, INDIA - 511m<sup>2</sup>- Acrylic sports courts**  
**-KUNAL ICONIA - INDIA - 510m<sup>2</sup>- Acrylic sports courts**  
**-PORT CISNE - CHILE - 500m<sup>2</sup> - SAFEPOL MULTICOLOR**  
**-AGRICULTURE UNIVERSITY PESHAWAR - INDIA - 500m<sup>2</sup> - Polyurethane sports flooring, POLYFLEX PU-IN**  
**-LJUBUSKY PROJECT - BOSNIA & HERZEGOVINA - 500m<sup>2</sup> - Acrylic sports flooring FLEXFLOOR-EX**  
**-MURIDKE SPORTS COMPLEX-SHEIKHUPURA, PUNJAB, PAKISTAN - 500m<sup>2</sup>-PU flooring,POLYFLEX PU-IN**  
**-CRNA REKA PETROL - NORTH MACEDONIA - 500m<sup>2</sup> - Acrylic flooring, FLEXFLOOR-EX**  
**-ONE PARK AVENUE, SOBHA HARTLAND - U.A.E - 500m<sup>2</sup> - SAFEPOL MULTICOLOR system**  
**-VARIOUS PLAYGROUND PROJECTS IN ABU DHABI - U.A.E - SAFEPOL MULTICOLOR system**  
**-AMERICAN SCHOOL OF DUBAI - DUBAI, UAE - Acrylic sports courts**  
**-ETIHAD MUSEUM - JUMEIRAH, DUBAI, UAE - Rubber flooring**  
**-SHENZHEN CITY VALLEY - CHINA - Acrylic sports flooring**  
**-CARPARKING - ABU DHABI, UAE - Acrylic flooring**  
**-DUBAI MILLENIUM SCHOOL - QUSAIS, UAE - Acrylic sports courts**  
**-AMERICAN UNIVERSITY - DUBAI, UAE – Acrylic outdoor sports flooring**  
**-RAK ACADEMY - RAK, UAE - Acrylic flooring**  
**-ISCS - SHARJA, UAE - Acrylic flooring**  
**-THE INTERNATIONAL SCHOOL OF CHOUEIFAT - AJMAN, U.A.E - Sportground-Ex system**  
**-THE KINDER GARDEN STARTERS - DUBAI, U.A.E - Safepol system**  
**-AL ZAHIA PROJECT - SHARJA, UAE - Safepol system**  
**-WADY DEGLA SHERATON CLUB - CAIRO, EGYPT - Acrylic sports flooring**  
**-NEW DUBAI BRADENTON SCHOOL- DUBAI, UAE - 570m<sup>2</sup> - Acrylic sports courts**  
**-PLAYGROUND PROJECT IN QATAR - SAFEPOL MULTICOLOR**  
**-GEMS WELLINGTON SCHOOL - DUBAI, U.A.E - Safepol system**  
**-JUMEIRAH RETAIL DEVELOPMENT - JUMEIRAH, DUBAI, UAE - Safety rubber flooring**  
**-MR.ABDULRHMIN - JUBAIL, KSA - Rubber playground**  
**-GEMS WESTMINISTER SCHOOL - DUBAI, U.A.E - Safepol system**  
**-POLYURETHANE INDOOR SPORTS COURT - TIRANA, ALBANIA - Polyflex PU-In system**  
**-MULTIPURPOSE COURTS - ODESSA, UKRAINE - Rubber flooring**  
**-MULTIPURPOSE COURTS - ZHOVKVA, UKRAINE - Rubber flooring**  
**-MUNICIPAL TENNIS CLUB - PATRA, GREECE - Flexfloor-EX system, Acrylic sports courts**

**-INDIAN AIR FORCE - GORAKHPUR, INDIA** - Acrylic sports courts  
**-INDIAN AIR FORCE - BAREILLY, INDIA** - Acrylic sports courts  
**-INDIAN ARMY - BABINA, INDIA** - Acrylic sports courts  
**-ADAM AIRBASE PACKAGE 8, OMAN** - Colorflex, PU sport flooring  
**-GOLD GYM - KOLKATTA, INDIA** - Polyurethane indoor sports flooring  
**-MINISTRY OF FOREIGN AFFAIRS - ABU DHABI, UAE** - Polyurethane flooring  
**-SHRJAH SPORTS CLUB - SHARJAH, UAE** - Polyurethane flooring  
**-GEMS WINCHESTER SCHOOL - AL BARSHA SOUTH, UAE** - Acrylic sports system  
**-HOTEL DOUBLE 3 - RAS AL KHAIMAH, UAE** - Prefabricated shock-pad 4mm plus acrylic coatings  
**-ALNABBAGH STABLE - AL AIN, U.A.E** - Polyurethane flooring, POLTRACK EQUESTRIAN FLOORING  
**-AL WAHDA CLUB - ABU DHABI, UAE** - Rubber flooring  
**-ADJD MAIN BUILDING LANDSCAPE PROJECT - ABU DHABI, UAE** - Rubber flooring  
**-KADEEJ AL KURBA SCHOOL - ABU DHABI, UAE** - Rubber flooring  
**-INTERNATIONAL SCHOOL OF CREATIVE SCIENCE-SHARJA, U.A.E**-Flexfloor system/Outdoor Multipurpose court  
**-ENVIRO, VATIKA HOTELS PVT.LTD - GURGAON, INDIA** - Acrylic sports flooring  
**-ASHIANA - BHUBANESHWAR, INDIA** - Acrylic sports flooring  
**-TCS, ADIBATLA - HYDERABAD, INDIA** - Acrylic sports flooring  
**-IPS, ERODE - CHENNAI, INDIA** - Acrylic sports flooring  
**-LIONS GATE - MUMBAI, INDIA** - Acrylic sports flooring  
**-MORNING GLORY INFRA LIMITED - KANPUR, INDIA** - Acrylic sports flooring  
**-SPORTS HALL ZVORNIK - BOSNIA & HERZEGOVINA** - PU flooring POLYFLEX PU-IN  
**-NAMBIAR - BANGALORE, INDIA** - Acrylic sports flooring  
**-PATHWAYS - GURGAON, INDIA** - Acrylic sports flooring  
**-WELHAMS GIRLS SCHOOL - DEHRADUN, INDIA** - Acrylic sports flooring  
**-WOODDUCK COMMERCIAL CENTER- IRAN** - Industrial flooring  
**-ARABIAN RANCHES by EMAR - DUBAI, U.A.E** - Playground flooring  
**-OUR OWN ENGLISH HIGH SCHOOL - SHARJAH, U.A.E** - Playground flooring  
**-POLO CLUB GHANTOOT - ABU DHABI, U.A.E** - Polyurethane flooring, POLTRACK EQUESTRIAN FLOORING  
**-RAK MODERN SCHOOL - RAS AL KHAIMAH, U.A.E** - Playground flooring  
**-GIIS/GLOBAL INDIAN INTERNATIONAL SCHOOL - RAS AL KHAIMAH, U.A.E** - Playground flooring  
**-MINISTRY OF EDUCATION, NAD AL HAMAR BOYS SCHOOL - DUBAI, U.A.E** - Playground flooring  
**-K.G. KIDS SCHOOL - AALI, BAHRAIN** - Playground flooring  
**-SABIC BEACH CAMPS PROJECT - JUBAIL, K.S.A** - Outdoor sports flooring, artificial grass.  
**-MINISTRY OF EDUCATION, MIZHER GIRLS SCHOOL - DUBAI, U.A.E** - Playground flooring  
**-WARSAN STABLE** - Polyurethane flooring, POLTRACK EQUESTRIAN FLOORING  
**-AL SHIMAL PARK - DOHA, QATAR** - Playground flooring  
**-UM SELAL PARK - DOHA, QATAR** - Playground flooring  
**-GEMS METROPOLE SCHOOL - DUBAI, U.A.E** - Hard court system/Outdoor Multipurpose court  
**-ARABIAN RANCHES by EMAR - DUBAI, U.A.E** - Acrylic Outdoor Tennis and Basketball courts  
**-RAK MODERN SCHOOL - RAS AL KHAIMAH, U.A.E** - Flexfloor system  
**-GIIS/GLOBAL INDIAN INTERNATIONAL SCHOOL - RAS AL KHAIMAH, U.A.E** - Acrylic system  
**-AVALON HEIGHTS - AJMAN, U.A.E** - Acrylic floorings  
**-DELHI PRIVATE SCHOOL - DUBAI, U.A.E** - Acrylic flooring  
**-ROYAL COMMISSION SCHOOL - JUBALI, KSA** - Acrylic sports flooring



**-FITNESS TIME PRO - AL AHSA BRANCH - KSA** - Flexfloor, Basketball court  
**-FITNESS TIME PRO - MAKKAH SHARAIE - KSA** - Flexfloor, Basketball court  
**-BIN HAM - AL AIN, UAE** - Polyurethane flooring  
**-SHAMMA BINT MOHAMMED SHOOL - AL AIN, UAE** - Polyurethane flooring  
**-ABDULLAH BIN OTAIBA - ABU DHABI, UAE** - Polyurethane flooring  
**-LIWA INTERNATIONAL SCHOOL - AL AIN, U.A.E** - Colorflex outdoor sport system  
**-ZOHOUR KG - MANAMA, BAHRAIN** - Polyurethane sports flooring  
**-RAWDA RASHED - QATAR**- Polyurethane, outdoor sport flooring  
**-SAAD BIN ABI WAQAS SCHOOL - AL RAYYAN, QATAR** - Polyurethane, outdoor sport flooring  
**-FITNESS TIME PRO - MADINS RING ROAD BRANCH - KSA** - Flexfloor, Basketball court  
**-AGRA CHAIN - AGRA, INDIA** - Acrylic sports flooring  
**-SUNWORLD - NOIDA, INDIA** - Acrylic sports flooring  
**-SSN INVESTMENTS PRIVATE LIMITED, FRIENDS COLONY - DELHI, INDIA** - Acrylic sports flooring  
**-AJNARA - NOIDA, INDIA** - Acrylic sports flooring  
**-BRIGHT RIDERS SCHOOL - ABU DHABI, UAE** - Running track, Acrylic sports court  
**-OUR OWN ENGLISH HIGH SCHOOL - SHARJAH, U.A.E** - Poltrack Spaycoat system  
**-NCC - JAIS, INDIA** - Acrylic sports flooring  
**-ALPHA FOUNDATION FOR EDUCATION & RESEARCH - TRICHIRAPALLI, INDIA** - Acrylic sports flooring  
**-PUSHPANJALI FARMS - NEW DELHI, INDIA** - Acrylic sports flooring  
**-M3M - MERLIN GURGAON, INDIA** - Acrylic sports flooring  
**-NORTH LONDON COLLEGIATE SCHOOL - DUBAI, U.A.E** - Playground flooring  
**-FOOT COURT - EGYPT** - Running track, POLTRACK SPRAYCOAT system  
**-FITNESS TIME ANDALUS BRANCH - JEDDAH, K.S.A** - Acrylic sports flooring, FLEXFLOOR SYSTEM  
**-ST.JOSEPHS WOMENS COLLEGE - ALLEPPEY, KERALA, INDIA** - Polyurethane outdoor sports flooring  
**-RAILWAY SPORTS GROUND - GUNTAKAL, ANDRA PRADESH, INDIA** - Acrylic sports flooring  
**-TERVEL PROJECT - TERVEL, BULGARIA** - Playground flooring, SAFEPOL system  
**-INDOOR COURT - UKRAINE** - Polyflex PU-In system  
**-PRIVATE JOB - HYDERABAD, SOUTH INDIA** - Acrylic outdoor sports flooring  
**-RAILWAY SPORTS GROUND -GUNTAKAL, ANDRA PRADESH, INDIA**-Acrylic outdoor sports flooring, 5 layers  
**-VARIOUS PLAYGROUND PROJECTS IN ABU DHABI - U.A.E** - SAFEPOL MULTICOLOR system  
**-POLYURETHANE OUTDOOR SPORTS COURT - QATAR** - POLYFLEX PU-EX system  
**-QASR AL SARAB DESERT RESORT - ABU DHABI, U.A.E** - SAFEPOL MULTICOLOR  
**-SPORTS CENTER IN HANOI - VIETNAM** - POLYFLEX PU-IN  
**-NIELSON BUKA RESORT - KALAMATA, GREECE** - FLEXFLOOR-EX  
**-PARALYMPICS FEDERATION SPORTS CENTER - CAMBODIA** - POLYFLEX PU-IN system  
**-MINISTRY OF EDUCATION U.A.E** - Playground flooring  
**-PLAYGROUND FLOORING - VARNA, BULGARIA** - SAFEPOL System  
**-INDIAN ARMY - SHAHJAHANPUR, INDIA** - Acrylic sports courts, FLEXFLOOR-EX system  
**-AIR FORCE SCHOOL - BENGALURU, INDIA** - Acrylic sports courts, FLEXFLOOR-EX system  
**-ARMY PUBLIC SCHOOL - UDHAMPUR, INDIA** - Acrylic sports courts, FLEXFLOOR-EX system  
**-BAHRAIN ROYAL EQUESTRIAN AND ENDURANCE FEDERATION - BAHRAIN** - PU Equestrian system  
**-PLAYGROUND PROJECT - HONG KONG** - SAFEPOL MULTICOLOR system  
**-PLAYGROUND PROJECT - KOSOVO** - SAFEPOL MULTICOLOR system  
**-KIND SAUDI UNIVERSITY - RIYADAH, K.S.A** - Running track, POLTRACK SPRAYCOAT ASYSTEM  
**-TENNIS COURT IN MYKONOS, GREECE** - Acrylic sports courts, POLYFLEX AEL-EX system

- TENNIS COURT PROJECT - PAKISTAN** - Acrylic sports courts, SPORTFLOOR-EX-R system
- SHENZHEN CITY VALLEY - CHINA** - Acrylic sports courts
- QAYYUM STADIUM PESHAWAR - INDIA** - Polyurethane flooring POLYFLEX PU-IN
- PLAYGROUND FLOORING IN CYPRUS** - SAFEPOL MULTICOLOR system
- PLAYGROUND FLOORING - PRNJAVOR, BOSNIA & HERZEGOVINA** - SAFEPOL MULTICOLOR system
- BASKETBALL & BADMINTON COURTS-ASHIANA DAKSH-INDIA**-Polyurethane flooring POLYFLEX PU-EX
- BASKETBALL & BADMINTON COURTS-ASHIANA UMANG-INDIA**-Polyurethane flooring POLYFLEX PU-EX
- MULTIPURPOSE COURT - GUATEMALA** - POLYFLEX AEL-EX-R
- PLAYGROUND PROJECT - K.S.A** - SAFEPOL MULTICOLOR
- PLAYGROUND PROJECT IN JUBAIL - K.S.A** - SAFEPOL MULTICOLOR
- REPTON SCHOOL - DUBAI, U.A.E** - SAFEPOL MULTICOLOR
- PLAYGROUND PROJECT IN TEL AVIV - ISRAEL** - SAFEPOL MULTICOLOR
- PLAYGROUND PROJECT IN RISHON LEZION - ISRAEL** - SAFEPOL MULTICOLOR
- PLAYGROUND PROJECT IN ILION - ATHENS,ISRAEL** - SAFEPOL MULTICOLOR
- PLAYGROUND PROJECT WATERFORIN OF SAN ANTONIO - CHILE** - SAFEPOL MULTICOLOR