

KDF

Sports Flooring Systems & Building Materials



**POLTRACK SPRAYCOAT SEALED
RUNNING TRACK SYSTEM**

www.kdf.gr

KDF LTD (www.kdf.gr) is one of the most dynamic and export-oriented Greek companies (currently activated in more than 55 countries in 4 continents), based in Greece (EU) and U.A.E too, with production facilities and warehouses in both countries for acrylic and polyurethane materials.

We are experts in sports, industrial and decorative flooring products and systems, with huge experience in Europe, Africa, Asia, Middle East and India as well.

Our export horizon is expanding rapidly and our goal is to stand out as a model of flexibility and competitiveness. The company, being one of the pioneer companies in the sector of sports flooring systems and building materials and giving particular attention to providing a fully upgraded range of products and services, provides certified systems by **ITF, IAAF, EU norms, LNE, LABOSPORT, ISASPORT, to name but a few.**

Our systems are approved in many ministries like:

- Ministry of Education in U.A.E
- Ministry of Education in K.S.A
- Ministry of Education in Oman
- Ministry of Education in Kuwait and many other institutes like
- Oman Royal Police
- Aramco, K.S.A
- Musanada in U.A.E
- Municipality of Doha
- Municipality of Dubai, Abu Dhabi, Sharjah and many others institutions.

KDF goes far beyond trade, providing consultancy in marketing and also technical support all the way, from the costing till the finalization of the project. Operating under the requirements of ISO 9001/2015 for production, trade and also application, we make sure our products are first applied successfully at site by our own people before we launch them abroad.

Therefore, our systems have all stood the real life test in different climates, from Middle East till Russia, and this is one of our main assets, enabling us to provide full and vertical technical support from specifying to final application plus supervision when required or even full application and costing.

We invite you to discover a world of sports flooring expertise and solutions.

VIEW OUR NEW SPORTS CATALOGUE



KDF - Kataskeves Dapedon LTD
e : exports@kdf.gr
w : www.kdf.gr

1 Papanikolaou Ave, Pefka
57010, Thessaloniki, Greece
t / f : 0030 2310 829598

INDICATIVE REFERENCE LIST OF PROJECTS

-12 SCHOOLS IN U.A.E, MINISTRY OF EDUCATION(THROUGH VARIOUS CONTRACTORS) - 40000m² EPDM Rubber flooring

-UNIVERSITY OF DAMMAM - KSA - 13000m² - Acrylic cushion floorings

-KING ABDULLAH BASE AIR DEFENSE - TAIF, KSA - 12600 m² - Running track

-KING FAHD UNIVERSITY OF PETROLEUM AND MINERALS-DHARAN, KSA-12400m²-Rubber outdoor flooring

-RUNNING TRACK - K.S.A- 11000 m² - Running track, POLTRACK SANDWICH system

-GEMS SCHOOL - DUBAI, U.A.E - 10000 m² - Running track

-PASARGRAD WHOLESALE MARKET-IRAN - 10000 m² - Decorative flooring

-YAS ISLAND, ABU DHABI, U.A.E - 10000m² Bicycle track

-ABHA STADIUM - K.S.A - 9000m² - POLTRACK SANDWICH system

-ABU DHABI STADIUM - U.A.E - 9000m² - Artificial Grass, POLITURF LEADER 55140

-ALEXANDRIA STADIUM - ALEXANDRIA, EGYPT - 8500 m² - Running track

-MINISTRY OF EDUCATION IN KUWAIT - KUWAIT - 8000m² - Polyurethane flooring, Polyflex Pu-In system

-SALAM STREET & MINA ROAD, ABU DHABI, U.A.E - 8000m² Bicycle track, Sportground-Ex system

-KING FAHAD NAVAL BASE - JUBAIL, KSA - 8000m² - Running track

-MUNICIPALITY OF VELVENTO - KOZANI, GREECE - 8000m², Running track

-ABBHA, KSA - 7600m² - Running track

-MUNICIPALITY OF ZENICA - ZENICA, BOSNIA& HERZEGOVINA - 7500m², Poltrack Spraycoat, Running track

-ADNOC SCHOOLS - U.A.E - 7000m² - Safepol system

-ATLAS CENTER-BAM, IRAN - 7000 m² - Decorative flooring

-RUNNING TRACK - SUDAN - 7000 m² - Running track, POLTRACK SPRAYCOAT system

-CORNISH, JEDDAH, K.S.A - 6000m² Bicycle track Sportground-Ex system

-YOKOGAWA ELECTRIC CORPORATION-DHAHRAN TECHNO VALLEY-DAMMAM, KSA - 5500m²- Epoxy antistatic floorings

-AMITY INTERNATIONAL SCHOOL - ABHU DHABI, U.A.E - 5500m², Poltrack Spraycoat, Running Track

-SHUQAIQ WATER AND ELECTRICITY COMPANY - JIZAN, KSA - 5400 m² - acrylic courts

-TALEEM UPTOWN SCHOOLS - DUBAI, UAE - 5400m²-Acrylic sports courts systems

-SAUDI AIR FORCE - KSA - 5250 m² - Acrylic coating elastoturf, running track

-RUNNING TRACK - K.S.A - 5000 m² - Running track, POLTRACK SANDWICH system

-AL HAMRA, RAS AL KHAIMAH, U.A.E - 5000m² Bicycle track, Sportground-Ex system

-AIRBASE IN TAIF - KSA - 5000 m² - Running track

-DEPARTMENT OF EDUCATION ASIR REGION - KHAMIS, KSA - 4500 m² - Running track

-SERVIA STADIUM - KOZANI, GREECE - 4500m², Running track

-COMMUNITY COLLEGE - KHAMIS, KSA - 4200 m² - Running track

-MULTIPLE RUNNING TRACKS - ALGERIA - 40000 m² - Running track, POLTRACK SPRAYCOAT system

-SPORTS CLUB CENTER GLIFADA - ATHENS, GREECE - 4000m²- Poltrack Spraycoat, Running Track

-EMIRATES INTERNATIONAL SCHOOL - DUBAI, U.A.E - 4000m² - Safepol System, Playground flooring

-HH KHALID BIN BANDAR - RIYADH, KSA - 3800 m² - Volleyball/basketball rubber courts

-RUNNING TRACK- UKRAINE - 3600m² - RunningTrack, Poltrack Spraycoat system

-ANATOLIA GOLLEGE - THESSALONIKI, GREECE - 3600m², Running track

-AIMARJAN ASLAND – PARTIAL - 3600m²- Poltrack Sandwich, Running Track

-RUNNING TRACK - ISRAEL - 3500 m² - Running track, POLTRACK SANDWICH system

-MATRIX SPORTING CLUB - EGYPT - 3400 m² - Polyurethane outdoor flooring, Polyflex PU-EX System
-SPORTS CLUB CENTER KISSAMOS - CRETE, GREECE - 3200m²- Poltrack Sandwich, Running Track
-AL LUSAIL SPORTS CLUB - DOHA, QATAR - 3200m² - Jogging track
-SPORTS CLUB CENTER - SERBIA, GREECE - 3200m² - Poltrack Sandwich, Running Track
-STADIUM CENTER - UKRAINE - 3200m² - RunningTrack, Poltrack Spraycoat system
-KING KHALID UNIVERSITY - ABHA, KSA - 3100 m² - Running track
-AL FAIOUM UNIVERSITY - FAIOUM, EGYPT - 3000m²- Polyurethane indoor flooring, Polyflex PU-IN system
-SPORTS CLUB CENTER "PAPAGO" - ATHENS, GREECE - 3000m²- Poltrack Sandwich, Running Track
-PANORAMA SPORTS COMPLEX - THESSALONIKI, GREECE - 3000m², Running track
-INDIAN ARMY - SAGAR, INDIA - 2800m²- Acrylic sports courts
-ALL SAINTS SCHOOL - MUMBAI, INDIA - 2700 m² - PU outdoor sports flooring and running track
-INDIAN INSTITUTE OF SCIENCE EDUCATION AND RESEARCH-BHOPAL, INDIA-2700m² -Acrylic sports courts
-OUR OWN GOLF SCHOOL - 2700m²- Poltrack Spraycoat, RunningTrack
-AL RAYAN, QATAR - 2500 m² - Running track, POLTRACK SANDWICH system
-OUTDOOR SPORTS VENUE - VARNA, BULGARIA - 2500 m² - Acrylic, ITF classified, 8 layers system
-ALHOSN SPORTS COMPLEX - 2400 m² - Running track, POLTRACK SANDWICH system
-TEACHERS COLLEGE - ABHA, KSA - 2050 m² - Running track
-MUSAB BIN OMAIR BOYS SCHOOL - BIN OMRAN, QATAR - 2050 m² - PU outdoor sport flooring
-BURAIRAT SCHOOL - RAK, UAE - 2000 m² - Running track
-HADAYEK ALAHRAM CLUB - GIZA, EGYPT - 2000m², PU outdoor sports flooring, POLYFLEX PU-EX WET-POUR system
-AL SAILIYA BOYS SCHOOL - AL SAILIYA, QATAR - 2000 m² - Polyurethane, outdoor sport flooring
-KING KHALID UNIVERSITY - ABHA, KSA - 2000 m² - Volleyball/basketball rubber courts
-HH KHALID BIN BANDAR - RIYADH, KSA - 2000 m² - Volleyball/basketball rubber courts
-RAWDA RASHEED PRIMARY SCHOOL FOR BOYS - 2000 m²
-DAMIETTA GOVERNMENT - EGYPT - 2000m² - Running track, Poltrack Spraycoat Sealed System
-AL WAKAIR BOYS SCHOOL - AL WAKRAH, QATAR - 1950 m² - Polyurethane, outdoor sport flooring
-THE LAKE DISTRICT - PUNE, INDIA - 1950m²- Acrylic sports courts
-PRESIDENTIAL GUARD COMMANDM MAHAWI - ABU DHABI, UAE - 1900m² - Football court
-UNITED (SABIC) SPORTS CLUB - 1900 m² - Rubber flooring
-SHOOLS MINISTRY OF EDUCATION - KHAMIS, KSA - 1800 m² - Rubber floorin
-AL MAJAD AMPHITHEATER - SHARJA, UAE - 1800m² - Certified Jogging track
-QASSIM UNIVERSITY - KSA - 1800 m² - Polyurethane sports flooring
-AL QADSIYA MODEL INDEPENDENT SCHOOL - ALWAAB, QATAR - 1770 m² - PU outdoor sport flooring
-AL WAHDA SPORT ACADEMY CLUB - ABU DHABI, UAE - 1700 m² - Acrylic sports system
-ALSARH SCOOLES OF CIVIL - RIYADH, KSA - 1650m² - PU glue/Socccer field
-GD GOENKA PUBLIC SCHOLL - PURNIA, INDIA - 1630m²- Acrylic sports courts
-SPA RESORT DERENIVSKUPIA KI - UZHGOROD, UKRAINE - 1600 m² - Flexfloor-ex system, volleyball court
-THE MILITARY HOSPITAL - RIYADH, KSA - 1560 m² - Volleyball/basketball rubber courts
-THE MILITARY HOSPITAL - RIYADH, KSA - 1560 m² - Pu glue-PU sports flooring
-AL FORSHAN SPORTS CENTRE - ABU DHABI, U.A.E - 1500m² - Smartfloor system, Acrylic flooring
-INDUSTRIAL FLOORING - BULGARIA - 1500m² - Epoxy flooring, Polepox Coat 814 system
-SCHOOL IN AL WAKRA CITY - DOHA, QATAR - 1500 m² - Playground flooring

-IRAQ ARMY CAMP - IRAQ - 1500m² - Acrylic flooring in 2,2mm

-SCHOOL IN AL WAKRA CITY - DOHA, QATAR - 1500 m² - Playground flooring

-PROJECT GREEN LAND - DUBAI, UAE - 1500 m² - Jogging track

-UP TOWN SCHOOL - 1500m²- Poltrack Spraycoat, RunningTrack

-INDIAN AIR FORCE - ALLAHABAD, INDIA - 1450m² - Acrylic sports courts

-DUBAI MODERN HIGH SCHOOL - DUBAI, UAE - 1375 m² - Acrylic sports courts

-PROJECT ECOGREEN - DUBAI, UAE - 1350 m² - Jogging track

-POLICE COMPLEX BARRACKS NIZWA - OMAN- 1300 m² - Colorflex, PU sport flooring

-POLICE COMPLEX BARRACKS AL AJAIZ - OMAN - 1300 m² - Colorflex, PU sport flooring

-POLICE COMPLEX BARRACKS KATMATMILAH SITE - OMAN- 1300 m² - Colorflex, PU sport flooring

-POLICE COMPLEX BARRACKS SUWAIQ - OMAN - 1300 m² - Colorflex, PU sport flooring

-POLICE COMPLEX BARRACKS AL KAMIL - OMAN - 1300 m² - Colorflex, PU sport flooring

-PLAYGROUND FLOORING - BAHRAIN - 1300m² - Safepol system

-POLICE COMPLEX BARRACKS SHINAS - OMAN - 1300 m² - Colorflex, PU sport flooring

-POLICE COMPLEX BARRACKS BHALA - OMAN - 1300 m² - Colorflex, PU sport flooring

-POLICE COMPLEX BARRACKS MUDHAIBI - OMAN - 1300 m² - Colorflex, PU sport flooring

-POLICE COMPLEX BARRACKS THUMRAIT - OMAN - 1300 m² - Colorflex, PU sport flooring

-POLICE COMPLEX BARRACKS AL KHOUDH - OMAN - 1300 m² - Colorflex, PU sport flooring

-POLICE COMPLEX BARRACKS MAHDAH - OMAN - 1300 m² - Colorflex, PU sport flooring

-POLICE COMPLEX BARRACKS BID BID - OMAN - 1300 m² - Colorflex, PU sport flooring

-POLICE COMPLEX BARRACKS AL KHABOORA - OMAN - 1300 m² - Colorflex, PU sport flooring

-POLICE COMPLEX BARRACKS DHANK - OMAN - 1300 m² - Colorflex, PU sport flooring

-POLICE COMPLEX BARRACKS HAFEET - OMAN - 1300 m² - Colorflex, PU sport flooring

-POLICE COMPLEX BARRACKS AUQAD - OMAN - 1300 m² - Colorflex, PU sport flooring

-POLICE COMPLEX BARRACKS SUMAIL - OMAN - 1300 m² - Colorflex, PU sport floor

-OUTDOOR SPORTS VENUE - KOSOVO - 1300 m² - POLTRACK SPRAYCOAT System

-ALHALAFI BREAK - RIYADH, KSA - 1276 m² - Rubber flooring

-GI-DHOFAR BEACH RESORT & SPA - OMAN - 1225 m² - Colorflex, PU sport flooring

-RLS BASIC EDUCATION SCHOOL SOHAR - OMAN - 1225 m² - Colorflex, PU sport flooring

-MIXED BASIC EDUCATION SCHOOL AL QABIL - OMAN - 1225 m² - Colorflex, PU sport flooring

-BOYS BASIC EDUCATION SCHOOL BARKHA - OMAN - 1225 m² - Colorflex, PU sport flooring

-GIRLS BASIC EDUCATION SCHOOL MUDHAIBI - OMAN - 1225 m² - Colorflex, PU sport flooring

-MIXED BASIC EDUCATION SCHOOL AL AMERAT - OMAN - 1225 m² - Colorflex, PU sport flooring

-UMSALAMA GIRLS SCHOOL - AL RAYYAN, QATAR - 1200 m² - Polyurethane, outdoor sport flooring

-SHERATON PARK - DOHA, QATAR - 1200 m² - Playground flooring

-RAWDA BIN JASSIM SCHOOL - AL AZIZIYAH, QATAR - 1200 m² - Polyurethane, outdoor sport flooring

-GEMS WESTMINISTER SCHOOL - DUBAI, U.A.E - 1200 m² - Acrylic sports courts

-SILVER SPORTS CLUB - INDIA - 1200m²- Acrylic sports courts

-OUR OWN SCHOOL - SHARJA, U.A.E - 1200m² - Acrylic sports courts

-SHARJAH FOOTBALL CLUB - SHARJAH, UAE - 1200 m² - Polyurethane basketball courtsing

-MATRIX SPORTING CLUB - EGYPT - 1300 m² - Acrylic flooring, Flexfloor System

-SHERATON PARK - DOHA, QATAR - 1200 m² - Playground flooring

-SYMBIOSIS COLLEGE - INDIA - 1180m² - Acrylic sports courts

-PROFESSOR ABDULAZIZ ANQARI - RIYADH, KSA -1150m² - PU glue/Socccer field

-AL SAQID ISLAMIC ENGLISH SHCOLL-DUBAI,UAE-1100m²- Acrylic flooring, WET-POUR POLYFLEX AEL-EX
-FIRST POINT SCHOOLS - DUBAI, UAE - 1100m² - Acrylic sports courts
-MAADI BRITISH SCHOOL- EGYPT - 1100m², Multipurpose court, COLORFLEX system
-DUBAI AMERICAN ACADEMY - DUBAI, UAE - 1080 m² - Acrylic sports court
-PRELUDE PUBLIC SCHOOL - AGRA, INDIA - 1070m²- Acrylic sports courts
-ALMGBAL BREAK - RIYADH, KSA - 1050 m² - Rubber playground
-BANIYAS CLUB AND AL AIN ENGLISH SPEAKING SCHOOL - ABU DHABI, UAE - 1000m² - Acrylic flooring
-WADY DEGLA LOTUS PROJECT - CAIRO, EGYPT- 1000 m² - Acrylic flooring, Wet-Pour Polyflex AEL-EX system.
-MINISTRY OF EDUCATION - DAMMAM, KSA - 1000 m² - PU indoor multipurpose sports flooring
-SHEIKH OBEID MAKTHOUM PALACE - 1000m² - Outdoor polyurethane flooring
-INDIAN AIR FORCE - AGRA, INDIA - 1000m²- Acrylic sports courts
-INDIAN AIR FORCE - LUCKNOW, INDIA - 1000m²- Acrylic sports courts
-MULTIPURPOSE POLYURTEHANE INDOOR COURTS - F.Y.R.O.M - 1000m² - Polyflex PU-In system
-SODIC PROJECT - EGYPT - 1000m², Multipurpose court, COLORFLEX system
-INDIAN AIR FORCE - VARANASI, INDIA - 1000m²- Acrylic sports courts
-INTERNATIONAL SCHOOL OF CREATIVE SCHIENCE - SHARJAH, U.A.E - 1000m² - Safepol System
-INDIAN AIR FORCE - BIHTA, INDIA - 1000m²- Acrylic sports courts
-INDIAN AIR FORCE - DARBHANGA, INDIA - 1000m²- Acrylic sports courts
-AL AIN INDIAN SCHOOL - AL AIN, UAE - 1000m² - Football court
-DUBAI SCHOLRAS PRIVATE SCHOOL - DUBAI, U.A.E - 1000m² - Acrylic flooring in 2,2mm
-COMMUNITY COLLEGE - KHAMIS, KSA - 940 m² - Polyurethane indoor multipurpose sports flooring
-GEMS METROPOLE SCHOOL - DUBAI, U.A.E - 900 m² - Playground flooring
-MINISTRY OF EDUCATION - ABHA, KSA - 900 m² - Polyurethane indoor multipurpose sports flooring
-BAB AL SHAMS SPA HOTEL - DUBAI, UAE - 900m² - Football court
-KING KHALID UNIVERSITY - ABHA, KSA - 820 m² - Polyurethane indoor multipurpose sports flooring
-SCHOOL IN AL WAKRA CITY - DOHA, QATAR - 800m² - Polyurethane sports flooring
-SULTAN MANOR - RIYADH, KSA - 800 m² - Polyurethane multipurpose sports flooring
-MINISTRY OF EDUCATION - AL KHARIZ, KSA - 800 m² - PU indoor multipurpose sports flooring
-INDOOR SPORTS COURT - MALAYSIA - 800 m² - PU indoor sports flooring
-KID'S PLAY AREA IN MALL - MOROCCO - 800 m² - PU indoor sports flooring, POLYFLEX PU-IN system
-DUBAI ENGLISH SPEAKING COLLEGE - DUBAI, UAE - 783m² - Acrylic flooring, SPORTFLOOR-EX, HARD COURT
-SINGAPORE AIRLINES - SINGAPORE - 735m² - PU indoor sports flooring
-AL DAJAN COMPANY - GASIM, KSA - 722 m² - Polyurethane sports flooring/Tennis court
-SELECTIVE GOVERNMENT HIGH SCHOOL - EGYPT - 720m², Outdoor sports flooring
-INDIAN AIR FORCE - AHMEDABAD, INDIA - 720m²- Acrylic sports courts
-FITNESS TIME - FAYSALIA, DAMMAM, KSA - 700 m²-PU indoor multipurpose sports flooring/running track
-FITNESS TIME YASMEEN - RIYADH, KSA - 700 m² - PU indoor multipurpose sports flooring/running track
-FERRARI WORLD - ABU DHABI, UAE - 700m² - Playground flooring
-FITNESS TIME JUNIOR - RIYADH, KSA - 700 m² - PU indoor multipurpose sports flooring/running track
-FITNESS TIME - OLAYA RIYADH, KSA - 700 m² - PU indoor multipurpose sports flooring/ running track
-FITNESS TIME WAHA - RIYADH, KSA - 700 m² - PU indoor multipurpose sports flooring/running track
-FITNESS TIME, NOOR BRANCH - DAMMAM, KSA -700 m² - PU indoor sports flooring and running track
-FITNESS TIME, ALAMEEN BRANCH - DAMMAM, KSA - 700 m² - PU indoor sports flooring and running track
-FITNESS TIME, PLUS RIYADH - RIYADH, KSA - 700 m² - PU indoor sports flooring and running track

-FITNESS TIME, SALAMA BRANCH BRO & FITNESS - JEDDAH, KSA - 700 m² - PU indoor sports flooring
-FITNESS TIME, 40th BRANCH - JEDDAH, KSA - 700 m² - PU indoor sports flooring and running track
-NASR CLUB- EGYPT - 700m², Multipurpose court, POLYFLEX WET-POUR system
-HUREL DOUBLE 3 - RAS AL KHAIMH, KSA - 700 m² - Shockpad plus acrylic coatings
-THE SUSTAINABLE CITY - DUBAI, U.A.E - 700 m² - Acrylic flooring
-EMAAR - EMIRATES HILLS 2 - DUBAI, U.A.E - 700m² - Basketball court, Acrylic flooring
-AIRFORCE SURBOTO PARK - NEW DELHI, INDIA - 680 m² - Polyurethane outdoor sports flooring
-INDIAN ARMY - DHRANGDHARA, INDIA - 670m²- Acrylic sports courts
-MT.SAINT PATRICK ACADEMY - INDIA - 665m²- Acrylic sports courts
-REGIONAL HQ AT BURAIMI - OMAN - 650 m² - Colorflex, PU sport flooring
-ROYAL OMAN POLICE TASK FORCE RUSTAQ - OMAN - 650 m² - Colorflex, PU sport flooring
-ROYAL OMAN POLICE TASK FORCE LIWA - OMAN - 650 m² - Colorflex, PU sport flooring
-ROYAL OMAN POLICE TASK FORCE AL SALIL - OMAN - 650 m² - Colorflex, PU sport flooring
-ROYAL OMAN POLICE TASK FORCE IBRI - OMAN - 650 m² - Colorflex, PU sport flooring
-ROYAL OMAN POLICE TASK FORCE IBRA - OMAN - 650 m² - Colorflex, PU sport flooring
-ROYAL OMAN POLICE TASK FORCE AL SUR - OMAN - 650 m² - Colorflex, PU sport flooring
-ROYAL OMAN POLICE TASK FORCE AL DUKUM - OMAN - 650 m² - Colorflex, PU sport flooring
-ROYAL OMAN POLICE TASK FORCE AL BURAIMI - OMAN - 650 m² - Colorflex, PU sport flooring
-ROYAL OMAN POLICE TASK FORCE AL NIZWA - OMAN - 650 m² - Colorflex, PU sport flooring
-ROYAL OMAN POLICE TASK FORCE AL SUWAIQ - OMAN - 650 m² - Colorflex, PU sport flooring
-ABU DHABI MUNICIPALITY - ABU DHABI , UAE - 650 m² - Acrylic flooring
-ROYAL OMAN POLICE TASK FORCE AL SALALAH - OMAN - 650 m² - Colorflex, PU sport flooring
-ROYAL OMAN POLICE TASK FORCE AL BARKHA - OMAN - 650 m² - Colorflex, PU sport flooring
-ROYAL OMAN POLICE TASK FORCE KHOUDH - OMAN - 650 m² - Colorflex, PU sport flooring
-MULTIPURPOSE COURTS - TIRANA, ALBANIA - 650 m² - Acrylic sports flooring, FLEXFLOOR system
-MOHAMMED JASSIM M AL THANI SCHOOL - UMSALALALI, QATAR - 620 m² - PU outdoor sport flooring
-QATAR GEMS SCHOOL - DOHA, QATAR - 615 m² - Polyurethane sports flooring
-VAISHNO DEVI - DELHI, INDIA - 608 m² - Polyurethane outdoor sports flooring
-INDIAN ARMY - AGRA, INDIA - 600m²- Acrylic sports courts
-THE INTERNATIONAL SCHOOL - AGRA, INDIA - 600m²- Acrylic sports courts
-INDIAN ARMY - JHANSI, INDIA - 600m²- Acrylic sports courts
-THE SUSTAINABLE CITY - DUBAI, U.A.E - 600 m² - Safepol system
-AMITY SCHOOL, JUMEIRAH ISLAND - DUBAI, UAE - 600 m² - Safepol system
-OUR OWN ENGLISH HIGH SCHOOL - SHARJAH, U.A.E - 600 m² - Flexfloor system
-OUR OWN ENGLISH HIGH SCHOOL - SHARJAH, U.A.E - 600 m² - Polyflex Ael-EX system
-SKATING FOR KIDS - GUJARAT, INDIA - 600 m² - Sportfloor system
-NEW DUBAI BRADENTON SCHOOL- DUBAI, UAE - 570 m² - Acrylic sports courts
-DUBAI SILICON OSIS-CENTRAL PARK, DSO - DUBAI, UAE - 560 m² - Jogging track
-MPS WORLD SCHOOL - AGRA, INDIA - 560m²- Acrylic sports courts
-AL WUKAIR GIRLS SCHOOL - AL WAKRAH, QATAR - 550 m² - Polyurethane, outdoor sport flooring
-BBPS - DELHI, INDIA - 512 m² - Polyurethane outdoor sports flooring
-IVY STATE - PUNE, INDIA - 511m²- Acrylic sports courts
-KUNAL ICONIA - INDIA - 510m²- Acrylic sports courts
-AMERICAN SCHOOL OF DUBAI - DUBAI, UAE - Acrylic sports courts

-ETIHAD MUSEUM - JUMEIRAH, DUBAI, UAE - Rubber flooring
-CARPARKING - ABU DHABI, UAE - Acrylic flooring
-DUBAI MILLENIUM SCHOOL - QUSAIS, UAE - Acrylic sports courts
-AMERICAN UNIVERSITY - DUBAI, UAE – Acrylic outdoor sports flooring
-RAK ACADEMY - RAK, UAE - Acrylic flooring
-ISCS - SHARJA, UAE - Acrylic flooring
-THE INTERNATIONAL SCHOOL OF CHOUEIFAT - AJMAN, U.A.E - Sportground-Ex system
-THE KINDER GARDEN STARTERS - DUBAI, U.A.E - Safepol system
-AL ZAHIA PROJECT - SHARJA, UAE - Safepol system
-WADY DEGLA SHERATON CLUB - CAIRO, EGYPT - Acrylic sports flooring
-GEMS WELLINGTON SCHOOL - DUBAI, U.A.E - Safepol system
-JUMEIRAH RETAIL DEVELOPMENT - JUMEIRAH, DUBAI, UAE - Safety rubber flooring
-MR.ABDULRHMIN - JUBAIL, KSA - Rubber playground
-GEMS WESTMINISTER SCHOOL - DUBAI, U.A.E - Safepol system
-POLYURETHANE INDOOR SPORTS COURT - TIRANA, ALBANIA - Polyflex PU-In system
-MULTIPURPOSE COURTS - ODESSA, UKRAINE - Rubber flooring
-MULTIPURPOSE COURTS - ZHOVKVA, UKRAINE - Rubber flooring
-MUNICIPAL TENNIS CLUB - PATRA, GREECE - Flexfloor-EX system, Acrylic sports courts
-INDIAN AIR FORCE - GORAKHPUR, INDIA - Acrylic sports courts
-INDIAN AIR FORCE - BAREILLY, INDIA - Acrylic sports courts
-INDIAN ARMY - BABINA, INDIA - Acrylic sports courts
-ADAM AIRBASE PACKAGE 8, OMAN - Colorflex, PU sport flooring
-GOLD GYM - KOLKATTA, INDIA - Polyurethane indoor sports flooring
-MINISTRY OF FOREIGN AFFAIRS - ABU DHABI, UAE - Polyurethane flooring
-SHRJAH SPORTS CLUB - SHARJAH, UAE - Polyurethane flooring
-GEMS WINCHESTER SCHOOL - AL BARSHA SOUTH, UAE - Acrylic sports system
-HOTEL DOUBLE 3 - RAS AL KHAIMAH, UAE - Prefabricated shock-pad 4mm plus acrylic coatings
-ALNABBAGH STABLE - AL AIN, U.A.E - Polyurethane flooring, POLTRACK EQUESTRIAN FLOORING
-AL WAHDA CLUB - ABU DHABI, UAE - Rubber flooring
-ADJD MAIN BUILDING LANDSCAPE PROJECT - ABU DHABI, UAE - Rubber flooring
-KADEEJ AL KURBA SCHOOL - ABU DHABI, UAE - Rubber flooring
-INTERNATIONAL SCHOOL OF CREATIVE SCIENCE - SHARJA, U.A.E - Flexfloor system/Outdoor Multipurpose court
-ENVIRO, VATIKA HOTELS PVT.LTD - GURGAON, INDIA - Acrylic sports flooring
-ASHIANA - BHUBANESHWAR, INDIA - Acrylic sports flooring
-TCS, ADIBATLA - HYDERABAD, INDIA - Acrylic sports flooring
-IPS, ERODE - CHENNAI, INDIA - Acrylic sports flooring
-LIONS GATE - MUMBAI, INDIA - Acrylic sports flooring
-MORNING GLORY INFRA LIMITED - KANPUR, INDIA - Acrylic sports flooring
-NAMBIAR - BANGALORE, INDIA - Acrylic sports flooring
-PATHWAYS - GURGAON, INDIA - Acrylic sports flooring
-WELHAMS GIRLS SCHOOL - DEHRADUN, INDIA - Acrylic sports flooring
-WOODDUCK COMMERCIAL CENTER- IRAN - Industrial flooring
-ARABIAN RANCHES by EMAR - DUBAI, U.A.E - Playground flooring

-OUR OWN ENGLISH HIGH SCHOOL - SHARJAH, U.A.E - Playground flooring

-POLO CLUB GHANTOOT - ABU DHABI, U.A.E - Polyurethane flooring, POLTRACK EQUESTRIAN FLOORING

-RAK MODERN SCHOOL - RAS AL KHAIMAH, U.A.E - Playground flooring

-GIIS/GLOBAL INDIAN INTERNATIONAL SCHOOL - RAS AL KHAIMAH, U.A.E - Playground flooring

-MINISTRY OF EDUCATION, NAD AL HAMAR BOYS SCHOOL - DUBAI, U.A.E - Playground flooring

-K.G. KIDS SCHOOL - AALI, BAHRAIN - Playground flooring

-SABIC BEACH CAMPS PROJECT - JUBAIL, K.S.A - Outdoor sports flooring, artificial grass.

-MINISTRY OF EDUCATION, MIZHER GIRLS SCHOOL - DUBAI, U.A.E - Playground flooring

-WARSAN STABLE - Polyurethane flooring, POLTRACK EQUESTRIAN FLOORING

-AL SHIMAL PARK - DOHA, QATAR - Playground flooring

-UM SELAL PARK - DOHA, QATAR - Playground flooring

-AL KABAN PARK - DOHA, QATAR - Playground flooring

-GEMS METROPOLE SCHOOL - DUBAI, U.A.E - Hard court system/Outdoor Multipurpose court

-ARABIAN RANCHES by EMAR - DUBAI, U.A.E - Acrylic Outdoor Tennis and Basketball courts

-RAK MODERN SCHOOL - RAS AL KHAIMAH, U.A.E - Flexfloor system

-GIIS/GLOBAL INDIAN INTERNATIONAL SCHOOL - RAS AL KHAIMAH, U.A.E - Acrylic system

-AVALON HEIGHTS - AJMAN, U.A.E - Acrylic floorings

-DELHI PRIVATE SCHOOL - DUBAI, U.A.E - Acrylic flooring

-ROYAL COMMISSION SCHOOL - JUBALI, KSA - Acrylic sports flooring

-FITNESS TIME PRO - AL AHSA BRANCH - KSA - Flexfloor, Basketball court

-FITNESS TIME PRO - MAKKAH SHARAIE - KSA - Flexfloor, Basketball court

-BIN HAM - AL AIN, UAE - Polyurethane flooring

-SHAMMA BINT MOHAMMED SHOOOL - AL AIN, UAE - Polyurethane flooring

-ABDULLAH BIN OTAIBA - ABU DHABI, UAE - Polyurethane flooring

-LIWA INTERNATIONAL SCHOOL - AL AIN, U.A.E - Colorflex outdoor sport system.

-ZOHOUR KG - MANAMA, BAHRAIN - Polyurethane sports flooring

-RAWDA RASHED - QATAR- Polyurethane, outdoor sport flooring

-SAAD BIN ABI WAQAS SCHOOL - AL RAYYAN, QATAR - Polyurethane, outdoor sport flooring

-FITNESS TIME PRO - MADINS RING ROAD BRANCH - KSA - Flexfloor, Basketball court

-AGRA CHAIN - AGRA, INDIA - Acrylic sports flooring

-SUNWORLD - NOIDA, INDIA - Acrylic sports flooring

-SSN INVESTMENTS PRIVATE LIMITED, FRIENDS COLONY - DELHI, INDIA - Acrylic sports flooring

-AJNARA - NOIDA, INDIA - Acrylic sports flooring

-BRIGHT RIDERS SCHOOL - ABU DHABI, UAE - Running track, Acrylic sports court

-OUR OWN ENGLISH HIGH SCHOOL - SHARJAH, U.A.E - Poltrack Spaycoat system

-NCC - JAIS, INDIA - Acrylic sports flooring

-ALPHA FOUNDATION FOR EDUCATION & RESEARCH - TRICHIRAPALLI, INDIA - Acrylic sports flooring

-PUSHPANJALI FARMS - NEW DELHI, INDIA - Acrylic sports flooring

-M3M - MERLIN GURGAON, INDIA - Acrylic sports flooring

-NORTH LONDON COLLEGIATE SCHOOL - DUBAI, U.A.E - Playground flooring

-FOOT COURT - EGYPT - Running track, POLTRACK SPRAYCOAT system

-FITNESS TIME ANDALUS BRANCH - JEDDAH, K.S.A - Acrylic sports flooring, FLEXFLOOR SYSTEM

-ST.JOSEPHS WOMENS COLLEGE - ALLEPPEY, KERALA, INDIA - Polyurethane outdoor sports flooring

-WADY DEGLA SHERATON CLUB - CAIRO, EGYPT - Acrylic sports flooring

- RAILWAY SPORTS GROUND - GUNTAKAL, ANDRA PRADESH, INDIA - Acrylic sports flooring**
- TERVEL PROJECT - TERVEL, BULGARIA - Playground flooring, SAFEPOL system**
- INDOOR COURT - UKRAINE - Polyflex PU-In system**
- PRIVATE JOB - HYDERABAD, SOUTH INDIA - Acrylic outdoor sports flooring**
- RAILWAY SPORTS GROUND -GUNTAKAL, ANDRA PRADESH, INDIA-Acrylic outdoor sports flooring, 5 layers**
- MINISTRY OF EDUCATION U.A.E - Playground flooring**
- PLAYGROUND FLOORING - VARNA, BULGARIA - SAFEPOL System**

PHOTOGRAPHS OF PROJECTS



LABOSPORT

TEST REPORT

16-0492IT

Issued on October 6th 2016

CLIENT

KATASKEYES DAPEDON LTD

PRODUCT NAME

EPDM 856

TYPE

EPDM GRANULES

Test according to:

**DIN 18035-7:2014 Sports Grounds Part 7; Synthetic Turf Areas
Determination of Environmental Compatibility**

Reproduction of this test report is only authorized in its entirety

The results are solely considered valid for the specimen subjected to testing



Labosport Italia S.r.l.

Via Monte, 50 - 23870 CARNATE (CO) LOMBARDO (I) - CI
Tel. +39 039 85462 18 - Fax +39 039 858 31 69

www.labosport.it
labosport@labosport.it

PAH TEST REPORT EPDM GRANULES



Intertek Consumer Goods GmbH · Würzburger Straße 152 · 90766 Fürth · Germany

KATASKEVES DAPEDON LTD - KDF
MRS. Maria Nikolaidoy
Mitropoleos 19
54024 Thessaloniki
GREECE

Fürth, May 12/2020

TEST REPORT No. FUTYP2020-01959-C

Date sample received: March 06/2020
Period of testing: March 19/2020 – April 29/2020
Technical Director: Kerstin Scharrer

Sample description: EPDM Granulates E1, E2, E7, E8, E11, E12, E13, E15, E16, E17, E18, E19, E20



For the test results please refer to next pages

Intertek Consumer Goods GmbH
Würzburger Straße 152
90766 Fürth, Germany

Tel.: +49 911 74075 0
Fax: +49 911 74075 30
cg.germany@intertek.com

Sitz Fürth
Amtsgericht Fürth, HRB 5756
USt-IdNr. DE169317871

Geschäftsführer
Reinhold Gehling



Test order

Test of products for polycyclic aromatic hydrocarbons

Summary	Results
Further requirements	<i>pass</i>

Sample description:

No. 1:	Granulate E1 (red rose)
No. 2:	Granulate E2 (orange)
No. 7:	Granulate E7 (brown)
No. 8:	Granulate E8 (dark brown)
No. 11:	Granulate E11 (light blue)
No. 12:	Granulate E12 (dark blue)
No. 13:	Granulate E13 (purple)
No. 15:	Granulate E15 (light grey)
No. 16:	Granulate E16 (dark grey)
No. 17:	Granulate E17 (light green)
No. 18:	Granulate E18 (blue)
No. 19:	Granulate E19 (light brown)
No. 20:	Granulate E20 (EPDM red 0,5-1,5 mm)

Test results

Abbreviations:

n.d. = not determinable (< LoQ)

LoQ = limit of quantification

1. Polycyclic Aromatic Hydrocarbons according to US-EPA+ 2 EFSA PAH and according to Regulation (EC) No. 1907/2006 (REACH) Annex XVII No. 50

Test method: AfPS GS 2019:01 PAK (2019-05)

Limit of quantification: 0.1 mg/kg

Test results in mg/kg

Parameter	CAS-No.	Sample No. 1	Sample No.2	Sample No. 7	Sample No. 8
1 Naphthalene	91-20-3	0.26	0.14	0.14	0.18
2 Acenaphthylene	208-96-8	n.d.	n.d.	n.d.	n.d.
3 Acenaphthene	83-32-9	n.d.	n.d.	n.d.	n.d.
4 Fluorene	86-73-7	0.66	0.22	0.23	0.68
5 Phenanthrene	85-01-8	1.9	0.40	0.46	1.1
6 Anthracene	120-12-7	0.22	n.d.	n.d.	n.d.
7 Fluoranthene	206-44-0	0.39	0.14	0.18	n.d.
8 Pyrene	129-00-0	n.d.	n.d.	0.21	n.d.
9 Benzo(a)anthracene	56-55-3	0.23	n.d.	n.d.	n.d.



Polycyclic Aromatic Hydrocarbons - continued

Test results in mg/kg

Parameter	CAS-No.	Sample No. 1	Sample No. 2	Sample No. 7	Sample No. 8
10 Chrysene	218-01-9	0.28	n.d.	n.d.	n.d.
∑11+12 Benzo(b)fluoranthene + Benzo(j)fluoranthene	205-99-2 + 205-82-3	n.d.	n.d.	n.d.	n.d.
13 Benzo(k)fluoranthene	207-08-9	n.d.	n.d.	n.d.	n.d.
14 Benzo(e)pyrene	192-97-2	n.d.	n.d.	0.21	n.d.
15 Benzo(a)pyrene	50-32-8	n.d.	n.d.	n.d.	n.d.
16 Indeno(1,2,3-cd)pyrene	193-39-5	n.d.	n.d.	n.d.	n.d.
17 Dibenzo(a,h)anthracene	53-70-3	n.d.	n.d.	n.d.	n.d.
18 Benzo(ghi)perylene	191-24-2	n.d.	n.d.	n.d.	n.d.
Sum 15 PAH		3.3^b	0.40^b	0.88^b	1.1^b

^a For summation according to AfPS GS 2019:01 PAK the following PAH are not included: Acenaphthylene, Acenaphthene, Fluorene

^b Only contents from 0.2 mg/kg were used for summation.

Parameter	CAS-No.	Sample No. 11	Sample No. 12	Sample No. 13	Sample No. 15
1 Naphthalene	91-20-3	0.34	0.30	n.d.	n.d.
2 Acenaphthylene	208-96-8	n.d.	n.d.	n.d.	n.d.
3 Acenaphthene	83-32-9	n.d.	n.d.	n.d.	n.d.
4 Fluorene	86-73-7	0.19	n.d.	0.32	0.21
5 Phenanthrene	85-01-8	0.87	0.61	0.65	0.53
6 Anthracene	120-12-7	n.d.	n.d.	n.d.	n.d.
7 Fluoranthene	206-44-0	0.25	0.16	n.d.	0.16
8 Pyrene	129-00-0	n.d.	n.d.	n.d.	0.15
9 Benzo(a)anthracene	56-55-3	n.d.	n.d.	n.d.	n.d.
10 Chrysene	218-01-9	0.15	0.12	n.d.	n.d.
∑11+12 Benzo(b)fluoranthene + Benzo(j)fluoranthene	205-99-2 + 205-82-3	n.d.	n.d.	n.d.	n.d.
13 Benzo(k)fluoranthene	207-08-9	n.d.	n.d.	n.d.	n.d.
14 Benzo(e)pyrene	192-97-2	n.d.	n.d.	n.d.	n.d.
15 Benzo(a)pyrene	50-32-8	n.d.	n.d.	n.d.	n.d.
16 Indeno(1,2,3-cd)pyrene	193-39-5	n.d.	n.d.	n.d.	n.d.
17 Dibenzo(a,h)anthracene	53-70-3	n.d.	n.d.	n.d.	n.d.
18 Benzo(ghi)perylene	191-24-2	n.d.	n.d.	n.d.	n.d.
Sum 15 PAH		1.5^b	0.91^b	0.65^b	0.53^b

^a For summation according to AfPS GS 2019:01 PAK the following PAH are not included: Acenaphthylene, Acenaphthene, Fluorene

^b Only contents from 0.2 mg/kg were used for summation.

Polycyclic Aromatic Hydrocarbons - continued

Test results in mg/kg

Parameter	CAS-No.	Sample No. 16	Sample No. 17	Sample No. 18	Sample No. 19
1 Naphthalene	91-20-3	n.d.	n.d.	n.d.	n.d.
2 Acenaphthylene	208-96-8	n.d.	n.d.	n.d.	n.d.
3 Acenaphthene	83-32-9	n.d.	n.d.	n.d.	n.d.
4 Fluorene	86-73-7	n.d.	n.d.	0.45	n.d.
5 Phenanthrene	85-01-8	n.d.	0.12	0.81	0.12
6 Anthracene	120-12-7	n.d.	n.d.	n.d.	n.d.
7 Fluoranthene	206-44-0	n.d.	n.d.	n.d.	n.d.
8 Pyrene	129-00-0	n.d.	n.d.	n.d.	n.d.
9 Benzo(a)anthracene	56-55-3	n.d.	n.d.	n.d.	n.d.
10 Chrysene	218-01-9	n.d.	n.d.	n.d.	n.d.
Σ11+12 Benzo(b)fluoranthene + Benzo(j)fluoranthene	205-99-2 + 205-82-3	n.d.	n.d.	n.d.	n.d.
13 Benzo(k)fluoranthene	207-08-9	n.d.	n.d.	n.d.	n.d.
14 Benzo(e)pyrene	192-97-2	n.d.	n.d.	n.d.	n.d.
15 Benzo(a)pyrene	50-32-8	n.d.	n.d.	n.d.	n.d.
16 Indeno(1,2,3-cd)pyrene	193-39-5	n.d.	n.d.	n.d.	n.d.
17 Dibenzo(a,h)anthracene	53-70-3	n.d.	n.d.	n.d.	n.d.
18 Benzo(ghi)perylene	191-24-2	n.d.	n.d.	n.d.	n.d.
Sum 15 PAH		n.d.^b	n.d.^b	0.81^b	n.d.^b

^a For summation according to AfPS GS 2019:01 PAK the following PAH are not included: Acenaphthylene, Acenaphthene, Fluorene

^b Only contents from 0.2 mg/kg were used for summation.

Parameter	CAS-No.	Sample No. 20
1 Naphthalene	91-20-3	n.d.
2 Acenaphthylene	208-96-8	n.d.
3 Acenaphthene	83-32-9	n.d.
4 Fluorene	86-73-7	n.d.
5 Phenanthrene	85-01-8	n.d.
6 Anthracene	120-12-7	n.d.
7 Fluoranthene	206-44-0	n.d.
8 Pyrene	129-00-0	n.d.
9 Benzo(a)anthracene	56-55-3	n.d.
10 Chrysene	218-01-9	n.d.
Σ11+12 Benzo(b)fluoranthene + Benzo(j)fluoranthene	205-99-2 + 205-82-3	n.d.
13 Benzo(k)fluoranthene	207-08-9	n.d.
14 Benzo(e)pyrene	192-97-2	n.d.
15 Benzo(a)pyrene	50-32-8	n.d.
16 Indeno(1,2,3-cd)pyrene	193-39-5	n.d.
17 Dibenzo(a,h)anthracene	53-70-3	n.d.
18 Benzo(ghi)perylene	191-24-2	n.d.
Sum 15 PAH		n.d.^b

^a For summation according to AfPS GS 2019:01 PAK the following PAH are not included: Acenaphthylene, Acenaphthene, Fluorene

^b Only contents from 0.2 mg/kg were used for summation.



Conclusion

The tested sample of the presented products “**EPDM Granulates E1, E2, E7, E8, E11, E12, E13, E15, E16, E17, E18, E19, E20**” conform to the EC-Regulation 1907/2006, Annex XVII No. 50.



Remark

Requirements acc. to AfPS GS 2019:01 PAK (Utilization for GS-mark from July 1st, 2020) and Regulation (EC) No. 1907/2006, Annex XVII No. 50

Parameter	Category 1	Category 2		Category 3		Limit value acc. to EC regulation 1907/2006, Annex XVII No. 50	
		a. Use by children	b. other consumer products	a. Use by children	b. other consumer products	Toys, including activity toys, and childcare articles – Components rubber or plastic components that come into direct as well as prolonged or short-term repetitive contact with the human skin or the oral cavity, under normal or reasonably foreseeable conditions of use	Articles shall not be placed on the market for supply to the general public, if any of their rubber or plastic components that come into direct as well as prolonged or short-term repetitive contact with the human skin or the oral cavity, under normal or reasonably foreseeable conditions of use
Benzo[a]pyrene mg/kg	< 0.2	< 0.2	< 0.5	< 0.5	< 1		
Benzo[e]pyrene mg/kg	< 0.2	< 0.2	< 0.5	< 0.5	< 1	0.5	1
Benzo[a]anthracene mg/kg	< 0.2	< 0.2	< 0.5	< 0.5	< 1	0.5	1
Benzo[b]fluoranthene mg/kg	< 0.2	< 0.2	< 0.5	< 0.5	< 1	0.5	1
Benzo[j]fluoranthene mg/kg	< 0.2	< 0.2	< 0.5	< 0.5	< 1	0.5	1
Benzo[k]fluoranthene mg/kg	< 0.2	< 0.2	< 0.5	< 0.5	< 1	0.5	1
Chrysene mg/kg	< 0.2	< 0.2	< 0.5	< 0.5	< 1	0.5	1
Dibenzo[a,h]anthracene mg/kg	< 0.2	< 0.2	< 0.5	< 0.5	< 1	0.5	1
Benzo[ghi]perylene mg/kg	< 0.2	< 0.2	< 0.5	< 0.5	< 1	-	-
Indeno[1,2,3-cd]pyrene mg/kg	< 0.2	< 0.2	< 0.5	< 0.5	< 1	-	-
Phenanthrene, Pyrene, Anthracene, Fluoranthene, mg/kg	< 1 – Sum	< 5 – Sum	< 10 – Sum	< 20 – Sum	< 50 – Sum	-	-
Naphthalene mg/kg	< 1	< 2		< 10		-	-
Sum 15 PAH mg/kg	< 1	< 5	< 10	< 20	< 50	-	-
Evaluation	-	-	-	-	-	pass	-



General note:

This report has been prepared for the titled project or named part thereof and should not be relied upon or used for any other project without an independent check being carried out as to its suitability and prior written authority of Intertek being obtained. Intertek accepts no responsibility or liability for the consequences of this document being used for a purpose other than the purposes for which it was commissioned. Any person using or relying on the document for such other purposes agrees, and will by such use or reliance be taken to confirm his agreement to indemnify Intertek for all loss or damage resulting therefrom. Intertek accepts no responsibility or liability for this document to any party other than the person by whom it was commissioned.

We would like to point out, that Intertek can't provide legally binding assessments referring to isolated cases. The individual legal advice in Germany is reserved to the legal advisory professions and a binding interpretation is subject to the court of justice.

Copying excerpts or otherwise reproducing parts of the test report is permitted only with the consent of the laboratory accepting the order. This report pertains only to the test item(s).

All testing requests are subject to our Terms and Conditions available on www.intertek.com.

END OF REPORT



RUNNING TRACKS

POLTRACK SEALED SPRAYCOAT

Synthetic outdoor system for running tracks.

It is applied on fine asphalt or smooth, waterproof concrete, without rising humidity issues. Consists of a first base layer mixed at site, mixture of **RECYCLED RUBBER 858 SBR granules** and the polyurethane binder **POLAPLAST P13**, then a second layer (sealing layer), a polyurethane pore filler, **POLYSPORT STUCCO 1050** and then a third layer, spray coat, is applied at site which consists of **EPDM 856** (0.5-1.5mm) and the spraycoat, colored polyurethane binder **POLAPLAST P12**.

Priming with **POLAPLAST P10** precedes the application.



Steps:

- POLAPLAST P10 - Polyurethane primer.**
Applied by airless sprayer or brush.
- Mixture of POLAPLAST P13 and RECYCLED RUBBER 858 SBR granules.**
Applied by paving machine.
- POLYSPORT STUCCO 1050 - Polyurethane, elastic, two-component pore filler.**
Used for sealing porous prefabricated subfloor of sports floorings such as **ISOPOL 854** or wet-pour cushion shock-pads. Applied by flat trowel.
- Mixture of POLAPLAST P12 and EPDM 856.**
Applied by spraying machine in two crossings.

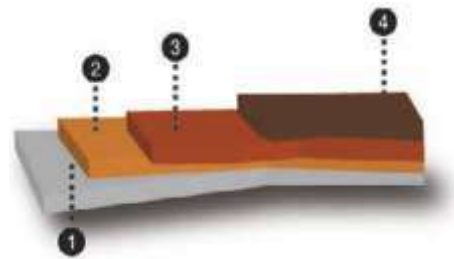

Description	Consumption
POLAPLAST P10 - Polyurethane primer.	0.15-0.2kg/m ²
BASE LAYER	
POLAPLAST P13 - One-component, polyurethane binder.	1.32kg/m ²
RECYCLED RUBBER 858 in granulometry of 0.5-2.5mm.	6kg/m ²
SEALING LAYER	
POLYSPORT STUCCO 1050 - Polyurethane, elastic, two-component pore filler.	1.5kg/m ² for 2 layers
SPRAY LAYER	
POLAPLAST P12 - Colored, two-component polyurethane spray coating.	1.35kg/m ²
EPDM 856 in granulometry of 0.5-1.5mm.	0.9kg/m ²

POLTRACK SPRAYCOAT SEALED Running track system



Synthetic outdoor system for running tracks. It is applied on fine asphalt or smooth, waterproof concrete, without rising humidity issues. Consists of a first base layer, mixed at site, a mixture of **RECYCLED RUBBER 858** in granulometry of 0.5-2.5mm and the polyurethane binder **POLAPLAST P13**, then a second layer (sealing layer) the polyurethane, pore filler, **POLYSPORT STUCCO 1050**, and of a third layer, spray coat, which consists of **EPDM 856** and the colored polyurethane binder **POLAPLAST P12**. Priming with **POLAPLAST P10** precedes the application.

Steps :

1. **POLAPLAST P10 - Polyurethane primer.**
2. **Mixture of POLAPLAST P13 and RECYCLED RUBBER 858**, applied by paving machine.
3. **POLYSPORT STUCCO - Polyurethane, two-component pore filler.**
4. **Mixture of POLAPLAST P12 and the EPDM 856**, applied by spraying machine.

Preparation – Application

Applied on dry asphalt surfaces (30 days old at least) or smooth concrete surfaces (30 days at least old) without arising humidity issues and free of materials that might prevent bonding e.g. dust, loose particles etc (in case of asphalt or concrete). The success in the application depends on the right preparation of the underlay and use of the material.

- **Good, dry cleaning** of the surface from dust and residues.
- Priming of the surface **with POLAPLAST P10** applied by airless spray or brushes. The base coat of **POLTRACK SEALED SYSTEM** should be constructed while **POLAPLAST P10** is still sticky (wet on wet procedure).
- The base shock-absorbent layer OF **POLTRACK SEALED SYSTEM** should be constructed within 6-12 hours of primer application.

- **Good mixing of the POLAPLAST P13 with recycled rubber granules (0.5-2.5mm)** to create a flexible shock-absorbent layer.
- The mixture is poured on the surface and spread using a suitable paving machine or other appropriate machine or a hand straightedge. If the application will be done with hand straightedge then small irregularities in the surface may be removed by rolling on the fresh surface using a metallic cylinder.
- After the surface is fully cured (depending on the temperature and humidity, the curing of the shock-pad base coat of POLTRACK will take 12-48 hours), follows the application of the sealing layer **POLYSPORT STUCCO 1050** in two crossing layers with a metal trowel. Consumption: 1.5kg/m².
- The top spray coating of the **POLTRACK SEALED SYSTEM** is applied in two crossing layers. The epdm granules (granulometry 0,5-1,5mm) and **the POLAPLAST P12** are mixed and applied with a suitable spraying machine.
- The two components of **POLAPLAST P12** are thoroughly mixed at site. The EPDM granules and the **POLAPLAST P12** are mixed and applied with a suitable spraying machine. Then the **TOP SPRAY COATING OF THE POLTRACK SYSTEM** is applied in two “cross hatch” layers. The curing time of the **TOP SPRAY COATING OF THE POLTRACK SYSTEM** is 9-12 hours. After this time, the second layer can be applied.
- **The second layer has to be applied “cross hatch”, i.e. perpendicular to the first layer to insure a good coverage.**
- After the second layer has cured (depending on conditions, this will usually take 9-12 hours at 20°C), it can be walked on. After 2 days, the top spray coating **of POLTRACK SEALED SYSTEM** is fully cured and can be put into service, after proper line marking is performed with the use of special two component polyurethane paint.

Important Remarks

- During temperatures over 40 degrees, ideal time for the application of **POLTRACK SPRAYCOAT SEALED SYSTEM** is between 22:00 and 09:00 and the minimum bearing temperature during application and drying should be over 10°C.
- The freshly coated surface should be protected from high temperatures, wind, rain and frost for at least the first 24 hours.

Substrate

Asphalt is the safer subfloor for sport floorings for sure and must be always preferred than concrete surfaces.

A. Asphalt Substrate

The asphalt must have a slope of 0.7-1% and must dry for at least 30 days so that all solvents from the asphalt can evaporate.

The asphalt sub-floor should be applied on well compacted 150mm road base sub-floor and asphalt should be laid in one layer (and not 2) in 6 to 8cm with fine and coarse aggregates (up to 15mm granulometry) like the kind of asphalt used in road construction.

So, new road-grade asphalt will have to be laid (minimum 60mm) in one layer containing coarse aggregates and then mature for 30 days at least, before any application takes place on top of the asphalt to avoid bubbles on the final layer of the sport or rubber floorings.

Asphalt Infrastructure

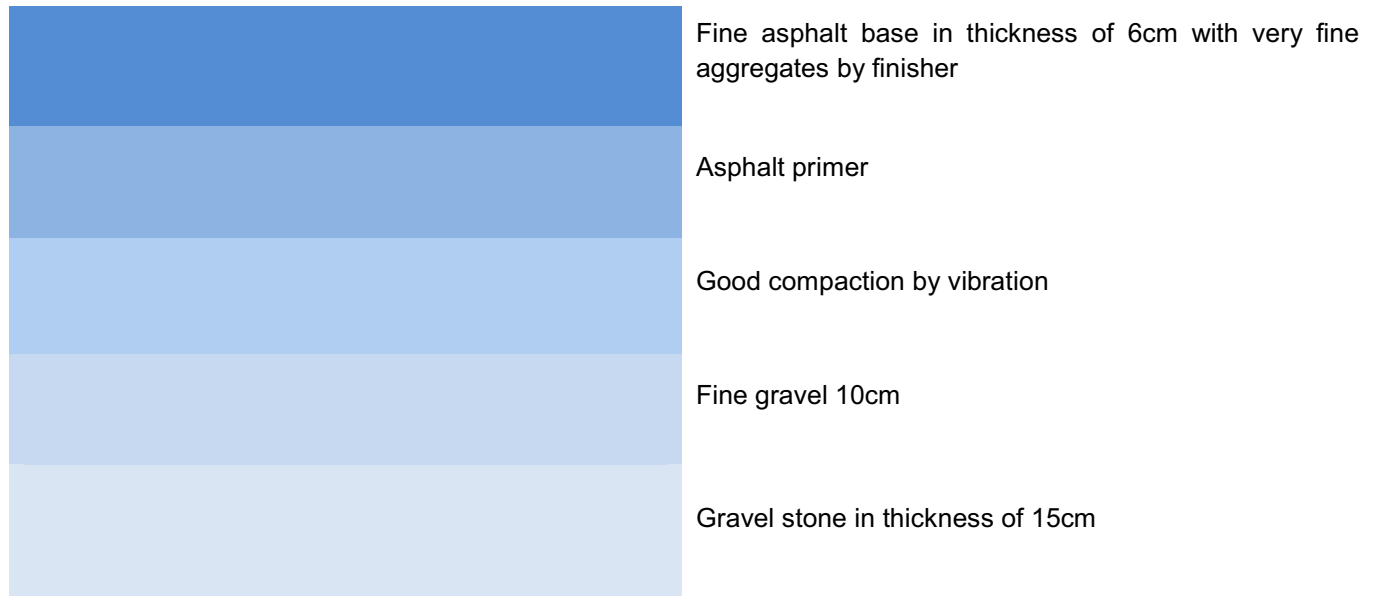

B. Concrete Surface

Concrete surface must be power-trowelled without cracks and must be smooth with a slope of 0.7-1% and humidity under 4% in 10cm depth of concrete.

Concrete must also be **dry at least for 40 days** and then the application takes place if there is no rising humidity for the sub-floor. Before the application takes place, there must be proper grinding of the surface by a grinding machine to open the pores accordingly and also a measurement by special instrument to measure humidity on the surface and in 10cm under the surface.

Generally concrete is a risky sub-floor and there may be problems with rising humidity, especially in areas where the sea level is really high and when the sea is close or in areas near greenery.

Always make expansion joints in large areas of concrete, in order to avoid uncontrollable cracks and failures. Joints should be every 25 square meters creating a grid of 5x5 meters or close to that.

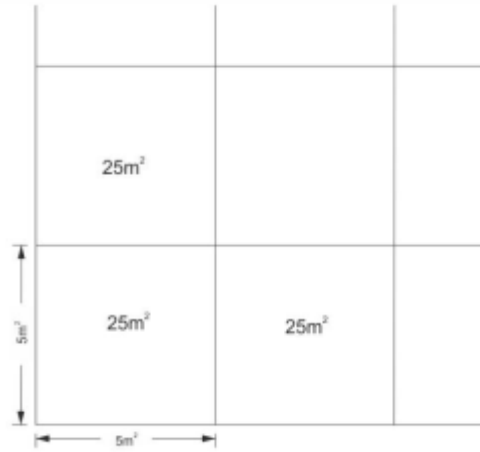

<u>SUBSTRATE REQUIREMENTS</u>	Concrete quality	at least C20/25
	Age:	at least 40 days
	Moisture content:	below 4%

Tools:



AIRLESS SPRAYER



BRUSH



PAVING MACHINE



STRAIGHTEDGE



RAKE



FLAT TROWEL



CYLINDER



SPRAYCOAT MACHINE

POLAPLAST P10

POLYURETHANE PRIMER ONE-COMPONENT

GENERAL CHARACTERISTICS

POLAPLAST P10 is a low viscosity, moisture curing, clear, polyurethane-based, one-component primer with good long term elasticity. **POLAPLAST P10** is used as an adhesive component between the sub-floor and the base layer (wet-pour mixture of SBR and POLAPLAST P13) of KDF's running track systems.

- Designed for improving adhesion of base layer (wet-pour mixture) of KDF's running track systems on asphalt and concrete surfaces without rising humidity issues.
- Penetrates in depth.
- Ideal for old and new surfaces.

TECHNICAL DATA

Basis:	one-component polyurethane
Appearance:	liquid
Color:	transparent
Viscosity :	50 – 250 mPa s at 25°C
Density :	0.9 – 1.0 Kg/Lt at 25°C
Temperature for the application and drying of the material:	10 – 40°C

PREPARATION-APPLICATION

Applied on dry surfaces without rising humidity issues, free of materials that might prevent bonding e.g. dust, loose particles, grease etc (in case of asphalt or concrete). The success in the application depends on the right preparation of the underlay and use of the material.

- **Good, dry** cleaning of the surface from dust and residues.
- Priming of the surface with **POLAPLAST P10** applied by airless sprayer equipment or brush, roller. The base layer (wet-pour mixture of SBR and **POLAPLAST P13**) of KDF's running track systems should be constructed while **POLAPLAST P10** is still a bit sticky. Curing takes place at ambient temperature by evaporation of the solvent and reaction with atmospheric moisture. High temperatures and moisture will shorten the cure time. **POLAPLAST P10** is applied in two or more layers as a thin film, and on the final layer, wet-pour mixture of SBR and **POLAPALST P13** can be applied on wet surface.
- The temperature should not fall below 10° C during curing.
- Opened drums should be used up quickly.
- Depending on the temperature and humidity, 3-5 hours is the minimum waiting time.
- The base layer (wet-pour mixture of SBR and **POLAPALST P13**) of the running track systems should be constructed while the final layer of **POLAPLAST P10** is still sticky.
- **NOTE: Rain will cause the primer to lose its function! If the primer was affected by rain, the base layer should not be constructed! Instead, the sub floor has to dry and the primer application has to be repeated.**

CONSUMPTION

150-250 gr/m² depending on the type and the absorbency of the underlay.

**APPLICATION
TOOLS**

Airless sprayer or brush or roller.

PACKAGING

Supplied in drums of 200 Kg.

STORAGE

12 months in unopened containers in dry places with minimum temperature 5°C and maximum temperature 30°C (out of sunlight).

CAUTION

The application must take place in well-aired places using protective gloves. Skin or eye contact must be avoided, otherwise wash carefully with soap and water.

For more information consult the safety data sheet.

The information given here is true, represents our best knowledge and is based not only on laboratory work, but also on field experience. However, because of numerous factors affecting results we offer this information without any guarantee and no patent liability is assumed. For additional information or questions, contact the technical department of KDF LTD.

POLAPLAST P13

ONE-COMPONENT POLYURETHANE BINDER

GENERAL CHARACTERISTICS

POLAPLAST P13 is a solvent free, clear, moisture curing one component polyurethane binder with good long term elasticity.

POLAPLAST P13 exhibits excellent adhesion to most rubber granulates and gives a strong performance both in terms of tensile strength and durability. It is mixed with **RECYCLED RUBBER 858** for the creation of the base layer of KDF's bicycle track system as well as for the base coat of playgrounds, tennis courts etc.

TECHNICAL DATA

Basis:	one-component polyurethane
Appearance:	liquid
Color:	transparent
Viscosity :	4.000 – 8.000 mPa s at 25°C
Density :	1.08 – 1.18 Kg / Lt at 25°C
Temperature for the application and drying of the material:	10 – 40 °C

PREPARATION-APPLICATION

Applied on dry surfaces, free of materials that might prevent bonding e.g. dust, loose particles etc (in case of asphalt or concrete). The success in the application depends on the right preparation of the underlay and use of the material.

- **Good, dry** cleaning of the surface from dust and residues.
- Priming of the surface with **POLAPLAST P10** applied by airless sprayer and brush. The base layer of KDF's bicycle track system, wet-pour shock-absorbent mixture, should be constructed while **POLAPLAST P10 is still sticky (wet in wet procedure)**. Curing takes place at ambient temperature by evaporation of the solvent and reaction with atmospheric moisture. High temperatures and moisture will shorten the curing time. Opened drums should be used up quickly.
- Good mixing of **POLAPLAST P13** and **RECYCLED RUBBER 858 (see mixing ratio below)**. Mixing should be performed using a low revolution mixer (300-600 rpm) for 1-2 min. Stirring of the mixture should be performed thoroughly near the sides and bottom of the container in order to achieve homogeneity.
- Following, the mixture is poured on the surface and spread on in thickness from 11 to 12mm using a suitable paving machine or a hand straightedge and a flat trowel. Any small irregularities in the surface may be removed by rolling the surface using a metallic cylinder.
- The temperature should not fall below 10°C during curing of **POLAPLAST P13**.
- Curing of **POLAPLAST P13** takes place at ambient temperature by reaction with atmospheric moisture. High temperatures and moisture will shorten the curing time of the **POLAPLAST P13**.
- The surface can be walked on after 12 – 18 hours at 25°C. After the surface is fully cured (depending on the temperature and humidity, the curing of the base layer mixture will take 12-48hours), follows the application of the final layers of the bicycle track system.

CONSUMPTION

1.32kg **POLAPLAST P13** mixed with 6kg **RECYCLED RUBBER 858** in granulometry of 0.5-2.5mm.

RATIO 18.3% **POLAPLAST P13** to 81,7 % **RECYCLED RUBBER 858** in granulometry of 0.5-2.5mm.

APPLICATION A suitable paving machine or a hand straightedge and a flat trowel.
TOOLS

PACKAGING Supplied in drums of 220 Kg. Other size on request.

STORAGE 12 months in unopened containers in dry places, out of sunlight, with minimum temperature 5°C and maximum temperature 30°C.

CAUTION The application must take place in well-aired places using protective gloves. Skin or eye contact must be avoided, otherwise wash carefully with soap and water.

For more information consult the material safety data sheet.

The information given here is true, represents our best knowledge and is based not only on laboratory work, but also on field experience. However, because of numerous factors affecting results we offer this information without any guarantee and no patent liability is assumed. For additional information or questions, contact the technical department of KDF LTD.

SBR RUBBER GRANULES 858

GENERAL CHARACTERISTICS

It can be used in sports facilities as infill in synthetic grass with the parallel use of round sand and also as one of the components in case of cast applied wet-pour systems for playground floorings or as shock-pad for sport subfloors in athletic tracks and sports fields.

Rubber granule is derived from car and truck tires. During processing, the tires are mechanically granulated, removing all metal and synthetic fibers, as well as any other foreign part contained in there with specially designed sieves, so as to produce a 99.99% clear rubber with high quality.

PROPERTIES

- 100% recyclable
- Long life
- Resistance to adverse weather conditions
- High shock absorbency and vibration damping
- High abrasion resistance

PREPARATION-APPLICATION

In sports facilities and playgrounds to ensure flexibility of surface and vibration absorption.

TECHNICAL CHARACTERISTICS

Granulometry 1-3mm

DENSITY:	0.48kg/cm ³
SPECIFIC GRAVITY	1.20+/- .05 (Water = 1.0)
HARDNESS	60
HUMIDITY(%)	<0.65
ELASTICITY	100% - No change
RESISTANCE	113N/cm - Excellent

PACKAGING

Packaging is available in big-bags -1 ton in following sizes:

Grain size	0,5-1,5 mm
Grain size	0,5-2,5 mm
Grain size	0.5-4.0 mm
Grain size	2-8 mm
Grain size	8-20 mm
Grain size	80-50 mm
Grain size	80-120 mm

POLYSPORT STUCCO 1050

POLYURETHANE, ELASTIC, TWO-COMPONENT PORE FILLER

GENERAL CHARACTERISTICS

POLYSPORT STUCCO 1050 is elastic solvent-free, two component polyurethane based sealant for outdoor sport surfaces.

POLYSPORT STUCCO 1050 has very good filling capacity and thixotropic properties. It has low fluidity feature with its filler structure can be easily applied. It provides strong and elastic filling after the reaction.

TECHNICAL DATA

Mixing Ratio	90.8 : 9.2 (By weight)
Density of mixture (25°C)	1.69-1.79 Kg/lt
Viscosity of mixture (25°C)	40.000-55.000 mPa s at 25°C
Pot-life (25°C)	20-30 min at 25°C
Application temperature	Min 10 – 38 °C
Curing (25°C and %60 relative humidity)	After 24 hours
Color	Beige

PREPARATION-APPLICATION

Applied on dry surfaces without rising humidity issues, free of materials that might prevent bonding e.g. dust, loose particles, grease etc (in case of asphalt or concrete). The success in the application depends on the right preparation of the underlay and use of the material.

- **Good, dry** cleaning of the surface from dust and residues using vacuum cleaner and squeegees.
- It can be applied directly on top of surfaces, on a cast-in-situ cushion base layer of wet pour (SBR rubber granules mixed with polyurethane binder) or prefabricated roll, which have to be dry, load bearing, clean and free of loose and brittle particles and substances which impair adhesion such as oil, grease, paint or other contaminants.
- The A component should be thoroughly stirred to incorporate any slight separation, while continuing stirring the contents of the B component (hardener) should be added. Continue stirring until a homogeneous mix is obtained. The mixed material must be used within 20-30 minutes of mixing at 25°C The surface must be dry and clean from dust and residues. Application is done by flat metal trowel.

CONSUMPTION

1.25 - 3.7 kg/m², depends on the porosity of the substrate.

PACKAGING

250 kg barrels and drums.

STORAGE

One year in unopened containers in cool and dry places, out of sunlight, with minimum

temperature 5°C and maximum temperature 30°C.

REMARKS

- Substrate must be dry, clean, and free from dust, grease and oil. Application must be done between 10°C - 40°C.
 - In case the second layer of PU pore filler is applied after more than 24 hours of the application of the first one then the whole surface must be sanded by a special sanding machine. After that the second layer can be applied.
-

CAUTION

Harmful if swallowed. Seek immediately medical attention. Rubber gloves and safety glasses with side guards should be worn.

For more information consult the safety data sheet.

The information given here is true, represents our best knowledge and is based not only on laboratory work, but also on field experience. However, because of numerous factors affecting results we offer this information without any guarantee and no patent liability is assumed. For additional information or questions, contact the technical department of KDF LTD.

POLAPLAST P12

COLORED TWO-COMPONENT POLYURETHANE SPRAY COATING

GENERAL CHARACTERISTICS

POLAPLAST P12 is a low viscous, two component polyurethane spray coating with good long term elasticity. Meets IAAF standard, it is environment- friendly, flexible with high strength.

POLAPLAST P12 is used as the second basic spray layer mixed with EPDM rubber granules, for the “on site” production of KDF's running track systems, **POLTRACK SPRAYCOAT SYSTEM**.

TECHNICAL DATA

Mixing Ratio	86.58 % : 13.42 % (By weight)
Viscosity(25°C)	900-3000 mPa
Density of mixture (25°C)	1.54-1.64 kg/lit
Pot-life (25°C)	app. 30 min. at 25°C
Application temperature	10 – 40 °C
Curing (25°C and %60 relative humidity)	9-12 hours
Color	KDF PU colorchart

PREPARATION-APPLICATION

Applied on dry surfaces, free of materials that might prevent bonding e.g. dust, loose particles etc (in case of asphalt or concrete). The success in the application depends on the right preparation of the underlay and use of the material.

- Application of the primer **POLAPLAST P10** (please consult the TDS of **POLAPLAST P10**)
- Application of the **BASE COAT OF POLTRACK SYSTEM** with wet-pour made from the mixture of **POLAPLAST P13** and the **RECYCLED RUBBER 858** (please consult the TDS of **POLAPLAST P13**)
- After the surface is fully cured (the curing depends on the temperature and humidity, 12-48 h), follows the application of the final **TOP SPRAY COATING OF THE POLTRACK SYSTEM**, which is consisted by **POLAPLAST P12** and **EPDM** granules of 0.5-1.5 mm granulometry
- Transportation and prolonged storage of spray coatings containing more than one pigment (e.g. beige or grey) can lead to separation of pigments. To obtain a uniform color, the spray coatings should be mixed well prior to application, in order to ensure an even color. The mixing must be done thoroughly until all the **EPDM** granules are coated. The mixing time with an agreed mixer will last from 3 to 5 minutes. The right spray viscosity depends on the spray equipment. Additional solvent amount (Xylene, Butylacetate) up to 2 % can be added to the mixture **POLAPLAST P12** and **EPDM**
- The **EPDM** granules must be dry
- The two components of **POLAPLAST P12** are thoroughly mixed at site. The **EPDM** granules and the **POLAPLAST P12** are mixed and applied with a suitable spraying machine. Then the **TOP SPRAY COATING OF THE POLTRACK SYSTEM** is applied in two “cross hatch” layers. The curing time of the **TOP SPRAY COATING OF THE POLTRACK SYSTEM** is 9-12 hours. After this time, the second layer can be applied.
- **The second layer has to be applied “cross hatch”, i.e. perpendicular to the first layer**

to insure a good coverage.

- Curing takes place at ambient temperature and is influenced by atmospheric moisture. Higher temperatures and moisture will shorten the cure time. After 3-5 days, the **TOP SPRAY COATING OF THE POLTRACK SYSTEM** is fully cured.
-

CONSUMPTION

- Consumption of **POLAPLAST P12**: 1.35kg/m²
 - Consumption of mixture of the **TOP SPRAY COATING OF THE POLTRACK SYSTEM (POLAPLAST P12 plus EPDM 0.5-1.5mm thickness, two layers)**: 2.25kg/m².
-

RATIO

60:40 **POLAPLAST P12** : **EPDM 0.5-1.5mm** (By weight)

APPLICATION TOOLS

Spraying machine.

PACKAGING

Supplied in barrels.

STORAGE

12 months in unopened containers in dry places with minimum temperature 5°C and maximum temperature 30°C (out of sunlight).

CAUTION

The application must take place in well-aired places using protective gloves. Skin or eye contact must be avoided, otherwise wash carefully with soap and water.

For more information consult the safety data sheet.

The information given here is true, represents our best knowledge and is based not only on laboratory work, but also on field experience. However, because of numerous factors affecting results we offer this information without any guarantee and no patent liability is assumed. For additional information or questions, contact the technical department of KDF LTD.

EPDM 856

RUBBER GRANULES

GENERAL CHARACTERISTICS

Type of material: Rubber EPDM

Grain size: 0.8-2.5mm,1.0-3mm,1.0-4mm or others

PERFORMANCE OF SAMPLE 25%

Test item	Performance
Tensile strength (Mpa)	>4.3
Elongation at break (%)	>735
Hardness (shore A)	60-65
Specific gravity (kg/cm ³)	1.45 ± 0.05

PREPARATION-APPLICATION

EPDM 856 granules are basically used for wet pour colored playground floorings (granulometry 1-3mm), for flexible multipurpose outdoor courts in 10-20 mm, SYSTEM COLORFLEX, and in applications of running track system such as POLTRACK SANDWICH SYSTEM (granulometry 1-3mm) and POLTRACK SPRAYCOAT SYSTEM (granulometry 0.5-1.5 mm).

Can be used also as infill of artificial synthetic turf or in the production of epdm rubber tiles or even loose lay and around swimming pools as a flexible flooring.

REMARKS

- It is highly suggested (especially in hot climates like in Middle East countries) the usage of the UV-resistance top coat **POLYSPORT XP 1069**, which gives a strong UV protection and doesn't allow the change of color to occur. **POLYSPORT XP 1069** is produced in all EPDM colour range and needs to be applied with 0,4 kg/m² in two crossing layers by airless sprayer or rollers.
- In case that there is no usage of UV-resistance polyurethane aliphatic coating strong shades like blue, rose, orange, grey etc will alter.
- All technical data are correct to the best of our knowledge and are intended to help our customers.
- They do not constitute a guarantee of qualities and provide on bases for legal liability.
- We advise our customers to choose the PU-binder according to the type and color of the EPDM rubber granules.

CLEANING AND MAINTENANCE MANUAL FOR :

-OUTDOOR SPORTS FLOORING

-PLAYGROUND FLOORINGS

Introduction

Outdoor sports floorings and playground surfaces are made of extremely durable polymers, designed to withstand extreme climate conditions and intense use. However for the best maintenance of the rubber and sport surface a regular check (once in 6 months) is required and the maintenance of the surface is necessary to preserve the suitability of the surface (sand pits, areas of vegetation) which could leave algae, moss and leaf deposits.

The installer's guarantee will usually be conditional on the recommended maintenance requirements being carried out with due diligence.

Maintenance

Maintenance procedures are necessary to preserve the lifetime of the surface and to ensure that:

- The Surface is kept clean.
- The Surface is safe for intense diverse use and all types of users.
- The facility looks attractive.

These objectives are achieved by :

- Sweeping/scraping/removing leaves and other debris and foreign matter from the surface.
- Regularly washing the surface to remove contaminants such as grime, grease, algae, moss, sand, foreign matter etc.
- Applying suitable treatments of moss-killer and/or algaecide
- Periodically removing weed growth from the perimeter kerb lines.

Maintenance Equipment

Leaves, pine needles and other detritus should not be allowed to remain on the surface for any length of time. If this does happen, they rapidly rot down, forming a contaminating "skin" on the surface and providing a growth media for algae and moss.

A mechanical leaf-sweeper or vacuum cleaner is ideal for removing vegetable matter and dirt. Restricted areas may have to be cleaned by hand.

The equipment should be well maintained and carefully operated to avoid contamination of, or physical damage to, the surface. Spillage of fuel or lubricating oil will damage the surface.

The pressure loading on the surface as well as the friction and shearing loads have to be kept to a minimum to prevent damage to the surface. Large pneumatic tires and soft brushes along with careful operating of the machinery, is recommended to avoid any damage on the surface.

A mechanical leaf-sweeper or vacuum cleaner is ideal for removing vegetable matter and dirt. Restricted areas may have to be cleaned by hand.

The equipment should be well maintained and carefully operated to avoid contamination of, or physical damage to, the surface. Spillage of fuel or lubricating oil will damage the surface.

The pressure loading on the surface as well as the friction and shearing loads have to be kept to a minimum to prevent damage to the surface. Large pneumatic tires and soft brushes along with careful operating of the machinery, is recommended to avoid any damage on the surface.

At least once a year it is advisable to wash the surface with low-pressure jetting apparatus.

Polymeric surfaces can withstand low pressures without suffering damage.

Note that no aggressive chemical cleaning agents (chlorine or acid-based) should be used; normal neutral market detergents are adequate.

Prevention of damages

To ensure maintaining the surfaces to a high standard, restrictions should be imposed on the use of the surface.

- In general no vehicles should be permitted to drive on the outdoor sports/playground surface.
- No chemicals, oils, fuel or solvents should be allowed on the surface.
- No fireworks or cigarettes or inadequate shoes should be allowed on the synthetic surface.

Damages and renovation

The lifetime of an outdoor sports/playground surface depends on its quality, usage and level of maintenance. In general a normal outdoor sports/playground surface used intensively will last 7 to 12 years (depending on the system) before renovation is required. Renovation should be carried out periodically to prevent the total damage of the surface, which would necessitate complete renewal.

Renovation must be carried out by professional and skilled contractors with thorough knowledge of this type of work

There are different procedures for the renovation of a surface:

- Complete renewal by replacing the worn-out surface with a new sports flooring system.
- Re-topping or sealing with adequate polyurethane or acrylic materials.
- Partial re-topping in particular worn-out areas.

Information contained in this document is of general nature and is given in good faith. As the state of the surface and the use and application of the various cleaning products, is out of our control, our advice for individual cases, verbal, written or based on tests, does not exempt the applicator from the testing the suitability of the cleaning products and their applications.

The above maintenance guide refers to **the below KDF systems:**

-SYSTEM SPORTFLOOR

-SYSTEM FLEXFLOOR

-SYSTEM POLYFLEX AEL EX

-SYSTEM POLYFLEX WET POUR EX

-SYSTEM POLYFLEX PU EX

-SYSTEM POLYFLEX WET POUR AEL EX

-SYSTEM SMARTFLOOR

-SYSTEM SAFEPOL

-SYSTEM SAFEPOL COLORED

-SYSTEM SAFEPOL WITH TPV GRANULES

-SYSTEM SAFEPOL SANDPROOF

-SYSTEM QUICKLAWN PLAYGROUND SAFEPOL

-SYSTEM QUICKLAWN PLAYGROUND SAFEPOLSANDPROOF

-SYSTEM COLORFLEX

-SYSTEM SPORTGROUND-EX

-SYSTEM POLTRACK SPRAYCOAT

-SYSTEM POLTRACK SPRAYCOAT SEALED

- SYSTEM POLTRACK SANDWICH**
- SYSTEM POLTRACK SANDWICH IN ROLLS**
- SYSTEM POLTRACK FULL PU**
- SYSTEM POLTRACK ACRYLIC**
- SYSTEM POLTRACK JOGGING TRACK**
- SYSTEM POLTRACK PU JOGGING TRACK**
- SYSTEM POLTRACK JOGGING TRACK SBR**
- SYSTEM POLTRACK JOGGING TRACK SHOCK-PAD - EPDM**
- SYSTEM POLTRACK JOGGING TRACK SHOCK-PAD - ISOPOL**
- SYSTEM POLTRACK EQUINE**

CERTIFICATES OF KDF Ltd



ISO KDF Ltd



POLTRACK SPRAYCOAT



POLTRACK SANDWICH



POLYFLEX AEL-EX



FLEXFLOOR-EX



SPORTFLOOR-EX



SPORTFLOOR-EX FAST



POLTRACK EQUINE



BADMINTON POLYFLEX PU

CERTIFICATES OF KDF Ltd



POLYFLEX PU



SPORTGROUND-EX



POLTRACK JOGGING TRACK



FIBA POLYFLEX PU



SAFEPOL



SAFEPOL



EPDM 856



SAFEPOL SANDPROOF



SAFEPOL SANDPROOF

CERTIFICATES OF KDF Ltd



PLAYPREM



POLTRACK FULL-PU



PU GRASS 149



PAH TEST REPORT
PU BINDER 1118



PAH TEST REPORT
PU BINDER 1125 AL



PAH TEST REPORT
EPDM 856



PAH TEST REPORT
PU BINDER plus EPDM 856