

KDF

Sports Flooring Systems & Building Materials

SAFEPOL SANDPROOF SYSTEM PLAYGROUND FLOORINGS



www.kdf.gr

KDF LTD (www.kdf.gr) is one of the most dynamic and export-oriented Greek companies (currently activated in more than 50 countries in 4 continents), based in Greece (EU) and U.A.E too, with production facilities and warehouses in both countries for acrylic and polyurethane materials.

We are experts in sports, industrial and decorative flooring products and systems, with huge experience in Europe, Africa, Asia, Middle East and India as well.

Our export horizon is expanding rapidly and our goal is to stand out as a model of flexibility and competitiveness. The company, being one of the pioneer companies in the sector of sports flooring systems and building materials and giving particular attention to providing a fully upgraded range of products and services, provides certified systems by **ITF, IAAF, EU norms, LNE, LABOSPORT, ISASPORT, to name but a few.**

Our systems are approved in many ministries like:

- Ministry of Education in U.A.E
- Ministry of Education in K.S.A
- Ministry of Education in Oman
- Ministry of Education in Kuwait and many other institutes like
- Oman Royal Police
- Aramco, K.S.A
- Musanada in U.A.E
- Municipality of Doha
- Municipality of Dubai, Abu Dhabi, Sharjah and many others institutions.

KDF goes far beyond trade, providing consultancy in marketing and also technical support all the way, from the costing till the finalization of the project. Operating under the requirements of ISO 9001/2015 for production, trade and also application, we make sure our products are first applied successfully at site by our own people before we launch them abroad.

Therefore, our systems have all stood the real life test in different climates, from Middle East till Russia, and this is one of our main assets, enabling us to provide full and vertical technical support from specifying to final application plus supervision when required or even full application and costing.

We invite you to discover a world of sports flooring expertise and solutions.

VIEW OUR NEW SPORTS CATALOGUE



KDF - Kataskeves Dapedon LTD
e : exports@kdf.gr
w : www.kdf.gr

1 Papanikolaou Ave, Pefka
57010, Thessaloniki, Greece
t / f : 0030 2310 829598

INDICATIVE REFERENCE LIST OF PROJECTS

- 12 SCHOOLS IN U.A.E, MINISTRY OF EDUCATION(THROUGH VARIOUS CONTRACTORS) - 40000m² EPDM Rubber flooring
- UNIVERSITY OF DAMMAM - KSA - 13000m² - Acrylic cushion floorings
- KING ABDULLAH BASE AIR DEFENSE - TAIF, KSA - 12600 m² - Running track
- KING FAHD UNIVERSITY OF PETROLEUM AND MINERALS-DHARAN, KSA-12400m²-Rubber outdoor flooring
- RUNNING TRACK - K.S.A- 11000 m² - Running track, POLTRACK SANDWICH system
- GEMS SCHOOL - DUBAI, U.A.E - 10000 m² - Running track
- PASARGRAD WHOLESALE MARKET-IRAN - 10000 m² - Decorative flooring
- YAS ISLAND, ABU DHABI, U.A.E - 10000m² Bicycle track
- ALEXANDRIA STADIUM - ALEXANDRIA, EGYPT - 8500 m² - Running track
- SALAM STREET & MINA ROAD, ABU DHABI, U.A.E - 8000m² Bicycle track, Sportground-Ex system
- KING FAHAD NAVAL BASE - JUBAIL, KSA - 8000m² - Running track
- MUNICIPALITY OF VELVENTO - KOZANI, GREECE - 8000m², Running track
- ABBHA, KSA - 7600m² - Running track
- MUNICIPALITY OF ZENICA - ZENICA, BOSNIA& HERZEGOVINA - 7500m², Poltrack Spraycoat, Running track
- ADNOC SCHOOLS - U.A.E - 7000m² - Safepol system
- ATLAS CENTER-BAM, IRAN - 7000 m² - Decorative flooring
- RUNNING TRACK - SUDAN - 7000 m² - Running track, POLTRACK SPRAYCOAT system
- CORNISH, JEDDAH, K.S.A - 6000m² Bicycle track Sportground-Ex system
- YOKOGAWA ELECTRIC CORPORATION-DHAHRAN TECHNO VALLEY-DAMMAM, KSA - 5500m²- Epoxy antistatic floorings
- AMITY INTERNATIONAL SCHOOL - ABHU DHABI, U.A.E - 5500m², Poltrack Spraycoat, Running Track
- SHUQAIQ WATER AND ELECTRICITY COMPANY - JIZAN, KSA - 5400 m² - acrylic courts
- TALEEM UPTOWN SCHOOLS - DUBAI, UAE - 5400m²-Acrylic sports courts systems
- SAUDI AIR FORCE - KSA - 5250 m² - Acrylic coating elastoturf, running track
- RUNNING TRACK - K.S.A - 5000 m² - Running track, POLTRACK SANDWICH system
- AL HAMRA, RAS AL KHAIMAH, U.A.E - 5000m² Bicycle track, Sportground-Ex system
- AIRBASE IN TAIF - KSA - 5000 m² - Running track
- DEPARTMENT OF EDUCATION ASIR REGION - KHAMIS, KSA - 4500 m² - Running track
- SERVIA STADIUM - KOZANI, GREECE - 4500m², Running track
- COMMUNITY COLLEGE - KHAMIS, KSA - 4200 m² - Running track
- MULTIPLE RUNNING TRACKS - ALGERIA - 40000 m² - Running track, POLTRACK SPRAYCOAT system
- EMIRATES INTERNATIONAL SCHOOL - DUBAI, U.A.E - 4000m² - Safepol System, Playground flooring
- SPORTS CLUB CENTER GLIFADA - ATHENS, GREECE - 4000m²- Poltrack Spraycoat, Running Track
- HH KHALID BIN BANDAR - RIYADH, KSA - 3800 m² - Volleyball/basketball rubber courts
- ANATOLIA GOLLEGE - THESSALONIKI, GREECE - 3600m², Running track
- AIMARJAN ASLAND – PARTIAL - 3600m²- Poltrack Sandwich, Running Track
- RUNNING TRACK - ISRAEL - 3500 m² - Running track, POLTRACK SANDWICH system
- SPORTS CLUB CENTER KISSAMOS - CRETE, GREECE - 3200m²- Poltrack Sandwich, Running Track
- AL LUSAIL SPORTS CLUB - DOHA, QATAR - 3200m² - Jogging track
- SPORTS CLUB CENTER - SERVIA, GREECE - 3200m² - Poltrack Sandwich, Running Track

-KING KHALID UNIVERSITY - ABHA, KSA - 3100 m² - Running track

-SPORTS CLUB CENTER "PAPAGOU" - ATHENS, GREECE - 3000m²- Poltrack Sandwich, Running Track

-PANORAMA SPORTS COMPLEX - THESSALONIKI, GREECE - 3000m², Running track

-INDIAN ARMY - SAGAR, INDIA - 2800m²- Acrylic sports courts

-ALL SAINTS SCHOOL - MUMBAI, INDIA - 2700 m² - PU outdoor sports flooring and running track

-INDIAN INSTITUTE OF SCIENCE EDUCATION AND RESEARCH-BHOPAL,INDIA-2700m²-Acrylic sports courts

-OUR OWN GOLF SCHOOL - 2700m²- Poltrack Spraycoat, RunningTrack

-AL RAYAN, QATAR - 2500 m² - Running track, POLTRACK SANDWICH system

-ALHOSN SPORTS COMPLEX - 2400 m² - Running track, POLTRACK SANDWICH system

-TEACHERS COLLEGE - ABHA, KSA - 2050 m² - Running track

-MUSAB BIN OMAIR BOYS SCHOOL - BIN OMRAN, QATAR - 2050 m² - PU outdoor sport flooring

-BURAIRAT SCHOOL - RAK, UAE - 2000 m² - Running track

-HADAYEK ALAHRAM CLUB - GIZA, EGYPT - 2000m², PU outdoor sports flooring, POLYFLEX PU-EX WET-POUR system

-AL SAILIYA BOYS SCHOOL - AL SAILIYA, QATAR - 2000 m² - Polyurethane, outdoor sport flooring

-KING KHALID UNIVERSITY - ABHA, KSA - 2000 m² - Volleyball/basketball rubber courts

-HH KHALID BIN BANDAR - RIYADH, KSA - 2000 m² - Volleyball/basketball rubber courts

-RAWDA RASHEED PRIMARY SCHOOL FOR BOYS - 2000 m²

-AL WAKAIR BOYS SCHOOL - AL WAKRAH, QATAR - 1950 m² - Polyurethane, outdoor sport flooring

-THE LAKE DISTRICT - PUNE, INDIA - 1950m²- Acrylic sports courts

-PRESIDENTIAL GUARD COMMAND MAHAWI - ABU DHABI, UAE - 1900m² - Football court

-UNITED (SABIC) SPORTS CLUB - 1900 m² - Rubber flooring

-SHOOLS MINISTRY OF EDUCATION - KHAMIS, KSA - 1800 m² - Rubber flooring

-AL MAJAD AMPHITHEATER - SHARJA, UAE - 1800m² - Certified Jogging track

-QASSIM UNIVERSITY - KSA - 1800 m² - Polyurethane sports flooring

-AL QADSIYA MODEL INDEPENDENT SCHOOL - ALWAAB, QATAR - 1770 m² - PU outdoor sport flooring

-AL WAHDA SPORT ACADEMY CLUB - ABU DHABI, UAE - 1700 m² - Acrylic sports system

-ALSARH SCHOOLS OF CIVIL - RIYADH, KSA - 1650m² - PU glue/Soccer field

-GD GOENKA PUBLIC SCHOLL - PURNIA, INDIA - 1630m²- Acrylic sports courts

-SPA RESORT DERENIVSKUPIA KI - UZHGOROD, UKRAINE - 1600 m² - Flexfloor-ex system, volleyball court

-THE MILITARY HOSPITAL - RIYADH, KSA - 1560 m² - Volleyball/basketball rubber courts

-THE MILITARY HOSPITAL - RIYADH, KSA - 1560 m² - Pu glue-PU sports flooring

-AL FORSHAN SPORTS CENTRE - ABU DHABI, U.A.E - 1500m² - Smartfloor system, Acrylic flooring

-SCHOOL IN AL WAKRA CITY - DOHA, QATAR - 1500 m² - Playground flooring

-IRAQ ARMY CAMP - IRAQ - 1500m² - Acrylic flooring in 2,2mm

-SCHOOL IN AL WAKRA CITY - DOHA, QATAR - 1500 m² - Playground flooring

-PROJECT GREEN LAND - DUBAI, UAE - 1500 m² - Jogging track

-UP TOWN SCHOOL - 1500m²- Poltrack Spraycoat, RunningTrack

-INDIAN AIR FORCE - ALLAHABAD, INDIA - 1450m²- Acrylic sports courts

-DUBAI MODERN HIGH SCHOOL - DUBAI, UAE - 1375 m² - Acrylic sports courts

-PROJECT ECOGREEN - DUBAI, UAE - 1350 m² - Jogging track

-POLICE COMPLEX BARRACKS NIZWA - OMAN- 1300 m² - Colorflex, PU sport flooring

-POLICE COMPLEX BARRACKS AL AJAIZ - OMAN - 1300 m² - Colorflex, PU sport flooring

-POLICE COMPLEX BARRACKS KATMATMILAH SITE - OMAN- 1300 m² - Colorflex, PU sport flooring
-POLICE COMPLEX BARRACKS SUWAIQ - OMAN - 1300 m² - Colorflex, PU sport flooring
-POLICE COMPLEX BARRACKS AL KAMIL - OMAN - 1300 m² - Colorflex, PU sport flooring
-PLAYGROUND FLOORING - BAHRAIN - 1300m² - Safepol system
-POLICE COMPLEX BARRACKS SHINAS - OMAN - 1300 m² - Colorflex, PU sport flooring
-POLICE COMPLEX BARRACKS BHALA - OMAN - 1300 m² - Colorflex, PU sport flooring
-POLICE COMPLEX BARRACKS MUDHAIBI - OMAN - 1300 m² - Colorflex, PU sport flooring
-POLICE COMPLEX BARRACKS THUMRAIT - OMAN - 1300 m² - Colorflex, PU sport flooring
-POLICE COMPLEX BARRACKS AL KHOUDH - OMAN - 1300 m² - Colorflex, PU sport flooring
-POLICE COMPLEX BARRACKS MAHDAH - OMAN - 1300 m² - Colorflex, PU sport flooring
-POLICE COMPLEX BARRACKS BID BID - OMAN - 1300 m² - Colorflex, PU sport flooring
-POLICE COMPLEX BARRACKS AL KHABOORA - OMAN - 1300 m² - Colorflex, PU sport flooring
-POLICE COMPLEX BARRACKS DHANK - OMAN - 1300 m² - Colorflex, PU sport flooring
-POLICE COMPLEX BARRACKS HAFEET - OMAN - 1300 m² - Colorflex, PU sport flooring
-POLICE COMPLEX BARRACKS AUQAD - OMAN - 1300 m² - Colorflex, PU sport flooring
-POLICE COMPLEX BARRACKS SUMAIL - OMAN - 1300 m² - Colorflex, PU sport flooring
-ALHALAFI BREAK - RIYADH, KSA - 1276 m² - Rubber flooring
-GI-DHOFAR BEACH RESORT & SPA - OMAN - 1225 m² - Colorflex, PU sport flooring
-RLS BASIC EDUCATION SCHOOL SOHAR - OMAN - 1225 m² - Colorflex, PU sport flooring
-MIXED BASIC EDUCATION SCHOOL AL QABIL - OMAN - 1225 m² - Colorflex, PU sport flooring
-BOYS BASIC EDUCATION SCHOOL BARKHA - OMAN - 1225 m² - Colorflex, PU sport flooring
-GIRLS BASIC EDUCATION SCHOOL MUDHAIBI - OMAN - 1225 m² - Colorflex, PU sport flooring
-MIXED BASIC EDUCATION SCHOOL AL AMERAT - OMAN - 1225 m² - Colorflex, PU sport flooring
-UMSALAMA GIRLS SCHOOL - AL RAYYAN, QATAR - 1200 m² - Polyurethane, outdoor sport flooring
-SHERATON PARK - DOHA, QATAR - 1200 m² - Playground flooring
-RAWDA BIN JASSIM SCHOOL - AL AZIZIYAH, QATAR - 1200 m² - Polyurethane, outdoor sport flooring
-GEMS WESTMINISTER SCHOOL - DUBAI, U.A.E - 1200 m² - Acrylic sports courts
-SILVER SPORTS CLUB - INDIA - 1200m²- Acrylic sports courts
-OUR OWN SCHOOL - SHARJA, U.A.E - 1200m² - Acrylic sports courts
-SHARJAH FOOTBALL CLUB - SHARJAH, UAE - 1200 m² - Polyurethane basketball courts
-SHERATON PARK - DOHA, QATAR - 1200 m² - Playground flooring
-SYMBIOSIS COLLEGE - INDIA - 1180m²- Acrylic sports courts
-PROFESSOR ABDULAZIZ ANQARI - RIYADH, KSA -1150m² - PU glue/Socccer field
-AL SAQID ISLAMIC ENGLISH SHCOLL-DUBAI,UAE-1100m²- Acrylic flooring, WET-POUR POLYFLEX AEL-EX
-FIRST POINT SCHOOLS - DUBAI, UAE - 1100m² - Acrylic sports courts
-MAADI BRITISH SCHOOL- EGYPT - 1100m², Multipurpose court, COLORFLEX system
-DUBAI AMERICAN ACADEMY - DUBAI, UAE - 1080 m² - Acrylic sports court
-PRELUDE PUBLIC SCHOOL - AGRA, INDIA - 1070m²- Acrylic sports courts
-ALMGBAL BREAK - RIYADH, KSA - 1050 m² - Rubber playground
-BANIYAS CLUB AND AL AIN ENGLISH SPEAKING SCHOOL - ABU DHABI, UAE - 1000m² - Acrylic flooring
-MINISTRY OF EDUCATION - DAMMAM, KSA - 1000 m² - PU indoor multipurpose sports flooring
-SHEIKH OBEID MAKTHOUM PALACE - 1000m² - Outdoor polyurethane flooring
-INDIAN AIR FORCE - AGRA, INDIA - 1000m²- Acrylic sports courts
-INDIAN AIR FORCE - LUCKNOW, INDIA - 1000m² - Acrylic sports courts

-MULTIPURPOSE POLYURTEHANE INDOOR COURTS - F.Y.R.O.M - 1000m² - Polyflex PU-In system
-SODIC PROJECT - EGYPT - 1000m², Multipurpose court, COLORFLEX system
-INDIAN AIR FORCE - VARANASI, INDIA - 1000m² - Acrylic sports courts
-INTERNATIONAL SCHOOL OF CREATIVE SCHIENCE - SHARJAH, U.A.E - 1000m² - Safepol System
-INDIAN AIR FORCE - BIHTA, INDIA - 1000m² - Acrylic sports courts
-INDIAN AIR FORCE - DARBHANGA, INDIA - 1000m² - Acrylic sports courts
-AL AIN INDIAN SCHOOL - AL AIN, UAE - 1000m² - Football court
-DUBAI SCHOLRAS PRIVATE SCHOOL - DUBAI, U.A.E - 1000m² - Acrylic flooring in 2,2mm
-COMMUNITY COLLEGE - KHAMIS, KSA - 940 m² - Polyurethane indoor multipurpose sports flooring
-GEMS METROPOLE SCHOOL - DUBAI, U.A.E - 900 m² - Playground flooring
-MINISTRY OF EDUCATION - ABHA, KSA - 900 m² - Polyurethane indoor multipurpose sports flooring
-BAB AL SHAMS SPA HOTEL - DUBAI, UAE - 900m² - Football court
-KING KHALID UNIVERSITY - ABHA, KSA - 820 m² - Polyurethane indoor multipurpose sports flooring
-SCHOOL IN AL WAKRA CITY - DOHA, QATAR - 800m² - Polyurethane sports flooring
-SULTAN MANOR - RIYADH, KSA - 800 m² - Polyurethane multipurpose sports flooring
-MINISTRY OF EDUCATION - AL KHARIZ, KSA - 800 m² - PU indoor multipurpose sports flooring
-DUBAI ENGLISH SPEAKING COLLEGE - DUBAI, UAE - 783m² - Acrylic flooring, SPORTFLOOR-EX, HARD COURT
-SINGAPORE AIRLINES - SINGAPORE - 735m² - PU indoor sports flooring
-AL DAJAN COMPANY - GASIM, KSA - 722 m² - Polyurethane sports flooring/Tennis court
-SELECTIVE GOVERNMENT HIGH SCHOOL - EGYPT - 720m², Outdoor sports flooring
-INDIAN AIR FORCE - AHMEDABAD, INDIA - 720m² - Acrylic sports courts
-FITNESS TIME - FAYSALIA, DAMMAM, KSA - 700 m²-PU indoor multipurpose sports flooring/running track
-FITNESS TIME YASMEEN - RIYADH, KSA - 700 m² - PU indoor multipurpose sports flooring/running track
-FERRARI WORLD - ABU DHABI, UAE - 700m² - Playground flooring
-FITNESS TIME JUNIOR - RIYADH, KSA - 700 m² - PU indoor multipurpose sports flooring/running track
-FITNESS TIME - OLAYA RIYADH, KSA - 700 m² - PU indoor multipurpose sports flooring/ running track
-FITNESS TIME WAHA - RIYADH, KSA - 700 m² - PU indoor multipurpose sports flooring/running track
-FITNESS TIME, NOOR BRANCH - DAMMAM, KSA -700 m² - PU indoor sports flooring and running track
-FITNESS TIME, ALAMEEN BRANCH - DAMMAM, KSA - 700 m² - PU indoor sports flooring and running track
-FITNESS TIME, PLUS RIYADH - RIYADH, KSA - 700 m² - PU indoor sports flooring and running track
-FITNESS TIME, SALAMA BRANCH BRO & FITNESS - JEDDAH, KSA - 700 m² - PU indoor sports flooring
-FITNESS TIME, 40th BRANCH - JEDDAH, KSA - 700 m² - PU indoor sports flooring and running track
-NASR CLUB- EGYPT - 700m², Multipurpose court, POLYFLEX WET-POUR system
-HUREL DOUBLE 3 - RAS AL KHAIMH, KSA - 700 m² - Shockpad plus acrylic coatings
-THE SUSTAINABLE CITY - DUBAI, U.A.E - 700 m² - Acrylic flooring
-EMAAR - EMIRATES HILLS 2 - DUBAI, U.A.E - 700m² - Basketball court, Acrylic flooring
-AIRFORCE SURBOTO PARK - NEW DELHI, INDIA - 680 m² - Polyurethane outdoor sports flooring
-INDIAN ARMY - DHRANGDHARA, INDIA - 670m² - Acrylic sports courts
-MT.SAINT PATRICK ACADEMY - INDIA - 665m²- Acrylic sports courts
-REGIONAL HQ AT BURAIMI - OMAN - 650 m² - Colorflex, PU sport flooring
-ROYAL OMAN POLICE TASK FORCE RUSTAQ - OMAN - 650 m² - Colorflex, PU sport flooring
-ROYAL OMAN POLICE TASK FORCE LIWA - OMAN - 650 m² - Colorflex, PU sport flooring
-ROYAL OMAN POLICE TASK FORCE AL SALIL - OMAN - 650 m² - Colorflex, PU sport flooring
-ROYAL OMAN POLICE TASK FORCE IBRI - OMAN - 650 m² - Colorflex, PU sport flooring

-ROYAL OMAN POLICE TASK FORCE IBRA - OMAN - 650 m² - Colorflex, PU sport flooring
-ROYAL OMAN POLICE TASK FORCE AL SUR - OMAN - 650 m² - Colorflex, PU sport flooring
-ROYAL OMAN POLICE TASK FORCE AL DUKUM - OMAN - 650 m² - Colorflex, PU sport flooring
-ROYAL OMAN POLICE TASK FORCE AL BURAIMI - OMAN - 650 m² - Colorflex, PU sport flooring
-ROYAL OMAN POLICE TASK FORCE AL NIZWA - OMAN - 650 m² - Colorflex, PU sport flooring
-ROYAL OMAN POLICE TASK FORCE AL SUWAIQ - OMAN - 650 m² - Colorflex, PU sport flooring
-ABU DHABI MUNICIPALITY - ABU DHABI , UAE - 650 m² - Acrylic flooring
-ROYAL OMAN POLICE TASK FORCE AL SALALAH - OMAN - 650 m² - Colorflex, PU sport flooring
-ROYAL OMAN POLICE TASK FORCE AL BARKHA - OMAN - 650 m² - Colorflex, PU sport flooring
-ROYAL OMAN POLICE TASK FORCE KHOUDH - OMAN - 650 m² - Colorflex, PU sport flooring
-MOHAMMED JASSIM M AL THANI SCHOOL - UMSALALALI, QATAR - 620 m² - PU outdoor sport flooring
-QATAR GEMS SCHOOL - DOHA, QATAR - 615 m² - Polyurethane sports flooring
-VAISHNO DEVI - DELHI, INDIA - 608 m² - Polyurethane outdoor sports flooring
-INDIAN ARMY - AGRA, INDIA - 600m²- Acrylic sports courts
-THE INTERNATIONAL SCHOOL - AGRA, INDIA - 600m²- Acrylic sports courts
-INDIAN ARMY - JHANSI, INDIA - 600m²- Acrylic sports courts
-THE SUSTAINABLE CITY - DUBAI, U.A.E - 600 m² - Safepol system
-AMITY SCHOOL, JUMEIRAH ISLAND - DUBAI, UAE - 600 m² - Safepol system
-OUR OWN ENGLISH HIGH SCHOOL - SHARJAH, U.A.E - 600 m² - Flexfloor system
-OUR OWN ENGLISH HIGH SCHOOL - SHARJAH, U.A.E - 600 m² - Polyflex Ael-EX system
-NEW DUBAI BRADENTON SCHOOL- DUBAI, UAE - 570 m² - Acrylic sports courts
-DUBAI SILICON OSIS-CENTRAL PARK, DSO - DUBAI, UAE - 560 m² - Jogging track
-MPS WORLD SCHOOL - AGRA, INDIA - 560m²- Acrylic sports courts
-AL WUKAIR GIRLS SCHOOL - AL WAKRAH, QATAR - 550 m² - Polyurethane, outdoor sport flooring
-BBPS - DELHI, INDIA - 512 m² - Polyurethane outdoor sports flooring
-IVY STATE - PUNE, INDIA - 511m²- Acrylic sports courts
-KUNAL ICONIA - INDIA - 510m²- Acrylic sports courts
-AMERICAN SCHOOL OF DUBAI - DUBAI, UAE - Acrylic sports courts
-ETIHAD MUSEUM - JUMEIRAH, DUBAI, UAE - Rubber flooring
-CARPARKING - ABU DHABI, UAE - Acrylic flooring
-DUBAI MILLENIUM SCHOOL - QUSAIS, UAE - Acrylic sports courts
-AMERICAN UNIVERSITY - DUBAI, UAE – Acrylic outdoor sports flooring
-RAK ACADEMY - RAK, UAE - Acrylic flooring
-ISCS - SHARJA, UAE - Acrylic flooring
-THE INTERNATIONAL SCHOOL OF CHOUEIFAT - AJMAN, U.A.E - Sportground-Ex system
-THE KINDER GARDEN STARTERS - DUBAI, U.A.E - Safepol system
-AL ZAHIA PROJECT - SHARJA, UAE - Safepol system
-WADY DEGLA SHERATON CLUB - CAIRO, EGYPT - Acrylic sports flooring
-GEMS WELLINGTON SCHOOL - DUBAI, U.A.E - Safepol system
-JUMEIRAH RETAIL DEVELOPMENT - JUMEIRAH, DUBAI, UAE - Safety rubber flooring
-MR.ABDULRHMIN - JUBAIL, KSA - Rubber playground
-GEMS WESTMINISTER SCHOOL - DUBAI, U.A.E - Safepol system
-POLYURETHANE INDOOR SPORTS COURT - TIRANA, ALBANIA - Polyflex PU-In system
-MULTIPURPOSE COURTS - ODESSA, UKRAINE - Rubber flooring

-MULTIPURPOSE COURTS - ZHOVKVA, UKRAINE - Rubber flooring

-MUNICIPAL TENNIS CLUB - PATRA, GREECE - Flexfloor-EX system, Acrylic sports courts

-INDIAN AIR FORCE - GORAKHPUR, INDIA - Acrylic sports courts

-INDIAN AIR FORCE - BAREILLY, INDIA - Acrylic sports courts

-INDIAN ARMY - BABINA, INDIA - Acrylic sports courts

-ADAM AIRBASE PACKAGE 8, OMAN - Colorflex, PU sport flooring

-GOLD GYM - KOLKATTA, INDIA - Polyurethane indoor sports flooring

-MINISTRY OF FOREIGN AFFAIRS - ABU DHABI, UAE - Polyurethane flooring

-SHRJAH SPORTS CLUB - SHARJAH, UAE - Polyurethane flooring

-GEMS WINCHESTER SCHOOL - AL BARSHA SOUTH, UAE - Acrylic sports system

-HOTEL DOUBLE 3 - RAS AL KHAIMAH, UAE - Prefabricated shock-pad 4mm plus acrylic coatings

-AL WAHDA CLUB - ABU DHABI, UAE - Rubber flooring

-ADJD MAIN BUILDING LANDSCAPE PROJECT - ABU DHABI, UAE - Rubber flooring

-KADEEJ AL KURBA SCHOOL - ABU DHABI, UAE - Rubber flooring

-INTERNATIONAL SCHOOL OF CREATIVE SCIENCE - SHARJA, U.A.E - Flexfloor system/Outdoor Multipurpose court

-ENVIRO, VATIKA HOTELS PVT.LTD - GURGAON, INDIA - Acrylic sports flooring

-ASHIANA - BHUBANESHWAR, INDIA - Acrylic sports flooring

-TCS, ADIBATLA - HYDERABAD, INDIA - Acrylic sports flooring

-IPS, ERODE - CHENNAI, INDIA - Acrylic sports flooring

-LIONS GATE - MUMBAI, INDIA - Acrylic sports flooring

-MORNING GLORY INFRA LIMITED - KANPUR, INDIA - Acrylic sports flooring

-NAMBIAR - BANGALORE, INDIA - Acrylic sports flooring

-PATHWAYS - GURGAON, INDIA - Acrylic sports flooring

-WELHAMS GIRLS SCHOOL - DEHRADUN, INDIA - Acrylic sports flooring

-WOODDUCK COMMERCIAL CENTER- IRAN - Industrial flooring

-ARABIAN RANCHES by EMAR - DUBAI, U.A.E - Playground flooring

-OUR OWN ENGLISH HIGH SCHOOL - SHARJAH, U.A.E - Playground flooring

-NORTH LONDON COLLEGIATE SCHOOL - DUBAI, U.A.E - Playground flooring

-RAK MODERN SCHOOL - RAS AL KHAIMAH, U.A.E - Playground flooring

-GIIS/GLOBAL INDIAN INTERNATIONAL SCHOOL - RAS AL KHAIMAH, U.A.E - Playground flooring

-MINISTRY OF EDUCATION, NAD AL HAMAR BOYS SCHOOL - DUBAI, U.A.E - Playground flooring

-K.G. KIDS SCHOOL - AALI, BAHRAIN - Playground flooring

-SABIC BEACH CAMPS PROJECT - JUBAIL, K.S.A - Outdoor sports flooring, artificial grass.

-MINISTRY OF EDUCATION, MIZHER GIRLS SCHOOL - DUBAI, U.A.E - Playground flooring

-AL SHIMAL PARK - DOHA, QATAR - Playground flooring

-UM SELAL PARK - DOHA, QATAR - Playground flooring

-AL KABAN PARK - DOHA, QATAR - Playground flooring

-GEMS METROPOLE SCHOOL - DUBAI, U.A.E - Hard court system/Outdoor Multipurpose court

-ARABIAN RANCHES by EMAR - DUBAI, U.A.E - Acrylic Outdoor Tennis and Basketball courts

-RAK MODERN SCHOOL - RAS AL KHAIMAH, U.A.E - Flexfloor system

-GIIS/GLOBAL INDIAN INTERNATIONAL SCHOOL - RAS AL KHAIMAH, U.A.E - Acrylic system

-AVALON HEIGHTS - AJMAN, U.A.E - Acrylic floorings

-DELHI PRIVATE SCHOOL - DUBAI, U.A.E - Acrylic flooring

-ROYAL COMMISSION SCHOOL - JUBALI, KSA - Acrylic sports flooring

-FITNESS TIME PRO - AL AHSA BRANCH - KSA - Flexfloor, Basketball court
-FITNESS TIME PRO - MAKKAH SHARAIE - KSA - Flexfloor, Basketball court
-BIN HAM - AL AIN, UAE - Polyurethane flooring
-SHAMMA BINT MOHAMMED SHOOL - AL AIN, UAE - Polyurethane flooring
-ABDULLAH BIN OTAIBA - ABU DHABI, UAE - Polyurethane flooring
-LIWA INTERNATIONAL SCHOOL - AL AIN, U.A.E - Colorflex outdoor sport system.
-ZOHOUR KG - MANAMA, BAHRAIN - Polyurethane sports flooring
-RAWDA RASHED - QATAR- Polyurethane, outdoor sport flooring
-SAAD BIN ABI WAQAS SCHOOL - AL RAYYAN, QATAR - Polyurethane, outdoor sport flooring
-FITNESS TIME PRO - MADINS RING ROAD BRANCH - KSA - Flexfloor, Basketball court
-AGRA CHAIN - AGRA, INDIA - Acrylic sports flooring
-SUNWORLD - NOIDA, INDIA - Acrylic sports flooring
-SSN INVESTMENTS PRIVATE LIMITED, FRIENDS COLONY - DELHI, INDIA - Acrylic sports flooring
-AJNARA - NOIDA, INDIA - Acrylic sports flooring
-BRIGHT RIDERS SCHOOL - ABU DHABI, UAE - Running track, Acrylic sports court
-OUR OWN ENGLISH HIGH SCHOOL - SHARJAH, U.A.E - Poltrack Spaycoat system
-NCC - JAIS, INDIA - Acrylic sports flooring
-ALPHA FOUNDATION FOR EDUCATION & RESEARCH - TRICHIRAPALLI, INDIA - Acrylic sports flooring
-PUSHPANJALI FARMS - NEW DELHI, INDIA - Acrylic sports flooring
-M3M - MERLIN GURGAON, INDIA - Acrylic sports flooring
-FOOT COURT - EGYPT - Running track, POLTRACK SPRAYCOAT system
-FITNESS TIME ANDALUS BRANCH - JEDDAH, K.S.A - Acrylic sports flooring, FLEXFLOOR SYSTEM
-ST.JOSEPHS WOMENS COLLEGE - ALLEPPEY, KERALA, INDIA - Polyurethane outdoor sports flooring
-WADY DEGLA LOTUS PROJECT - CAIRO, EGYPT - Acrylic sports flooring
-RAILWAY SPORTS GROUND - GUNTAKAL, ANDRA PRADESH, INDIA - Acrylic sports flooring

PHOTOGRAPHS OF PROJECTS



CERTIFICATES OF SAFE POL SANDPROOF



LABORATORY REPORT

Product name : Colored Flooring 55mm (SBR + PU)
Product type : Wet Pour Flooring (closed porous)
Principal : KATASKEVES DAPEDON LTD (KDF)
Purpose : Determination of critical fall height
Operator : Dionisis Noussas

Report number : 15-2017 rev.A
Date : 23/3/2017
Page : 1 of 3
Standard : EN 1177:2008

Statement : This material shall also conform to the requirements of EN 1176-1, in particular, clauses 4 and 6.

Photographs



Conditions

Temperature : 18°C
Humidity : 60%

Product information

Material : SBR 53mm & PU 2mm
Length : 0.50 m
Width : 0.50 m
Thickness : 0.055 m
Foundation : Concrete
Supplier : TUV HELLAS (Test Services)

Test positions

- Position 1:**
in the centre of the tiles
- Position 2:**
in the centre of a joint between two adjoining tiles
- Position 3:**
in the centre of the tiles
- Position 4:**
in the centre of a joint between two adjoining tiles
- Position 5:**
in the centre of the tiles
- Position 6:**
in the centre of a joint between two adjoining tiles
- Position 7:**
in the centre of the tiles
- Position 8:**
in the centre of a joint between two adjoining tiles
- Position 9:**
at the junction where the greatest number of tiles meet

Conclusion : The critical fall height of the measured sample is 1.5 meter (position 7).

TEST REPORT

17-0879IT

Issued on May 10th 2018

CLIENT

KATASKEVES DAPEDON LTD

PRODUCT NAME

SAFEPOL SANDPROOF 55mm (SBR + PU)

TYPE

**WET POUR LIQUID POLYURETHANE
SEALED SYSTEM**

Test according to:

Test protocol for outdoor surface as requested by the customer

Reproduction of this test report is only authorized in its entirety

The results are solely considered valid for the specimen subjected to testing

Labosport Italia S.r.l

Via Monza, 80 – 23870 CERNUSCO LOMBARDONE (LC)
Tel. +39 039 894.62.15 – Fax +39 039 968.51.68

www.labosport.it
labosport@labosport.it

Pag. 1 of 18



LAB N° 1427

PLAYGROUND FLOORING

SAFEPOL SANDPROOF

Innovative, elastic, seamless, flexible colored flooring **with sandproof properties**, ideal for school courtyards and playground floorings.

It consists of a cushion base of 2 layers, first layer is a base layer of **RECYCLED RUBBER 858** (granulometry 2-4mm or 2-5mm) with **PU BINDER 1178**, in thickness of 30-110mm and second layer a mixture of **RECYCLED RUBBER 858** (granulometry 0,5-2mm) with **PU BINDER 1178** in thickness of 10mm. Then follows the **modified sealing, sandproof and waterproof KDF-PU 1055 pore filler** with high elasticity in 2 crossing layers and the **modified, KDF-PU 1056, sealing, UV-resistant, aliphatic, elastic, glossy top layer** in 3 crossing layers.



Certified system by TUV and LABOSPORT Institute.

Steps:

1. PU PRIMER 870 - Special, polyurethane primer.

Applied by brush or airless sprayer on asphalt surfaces or on waterproof concrete surfaces without rising humidity issues.

2. Mixture of PU BINDER 1178 and RECYCLED RUBBER 858 in granulometry of 2-4mm or 2-5mm.

Application with paving machine, in thickness of 30-110mm.

3. Mixture of PU BINDER 1178 and RECYCLED RUBBER 858 in granulometry of 0.5-2mm.

Application with paving machine, in thickness of 10mm.

4. KDF-PU 1055 - Polyurethane, modified, sandproof and waterproof, elastic pore filler.

Applied by metal trowel to create a completely non porous surface.

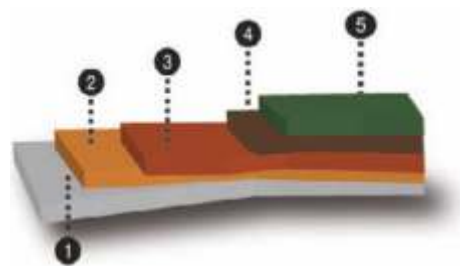

5. KDF-PU 1056 - Polyurethane, modified, UV-resistant, aliphatic, elastic, glossy, two-component top coating.

Applied, in two crossing layers by airless sprayer or short haired mohair roller.

Description	Consumption
PU PRIMER 870 - Special, polyurethane, primer.	0.2-0.3kg/m ² for 2 layers
PU BINDER 1178 - Special, polyurethane binder.	1kg/m ² for 10mm mixture
RECYCLED RUBBER 858 - SBR granules in granulometry of 2-4mm or 2-5mm. (for 10mm mixture)	6kg/m ² for 10mm mixture
PU BINDER 1178 - Special, polyurethane binder.	1.2kg/m ² for 10mm mixture
RECYCLED RUBBER 858 - SBR granules in granulometry of 0.5-2mm. (for 10mm mixture)	6kg/m ² for 10mm mixture
KDF-PU 1055 - Polyurethane, modified, sandproof and waterproof, elastic pore filler.	2kg/m ² for 2 layers
KDF-PU 1056 - Polyurethane, modified, UV-resistant, aliphatic, elastic, glossy, two-component top coating.	0.3kg/m ² for 2 layers

SAFEPOL SANDPROOF SYSTEM

Playground, safety flooring



Innovative, elastic, seamless, flexible colored flooring, ideal for school courtyards and playground floorings.

It consists of a cushion base of 2 layers, first layer is a base layer of **RECYCLED RUBBER 858**, SBR granules (granulometry 2-4mm or 2-5mm) with **PU BINDER 1178**, in thickness of 30-110mm and second layer a mixture of **RECYCLED RUBBER 858**, SBR granules (granulometry 0,5-2mm) with **PU BINDER 1178** in thickness of 10mm. Then follows the modified sealing, sandproof and waterproof **KDF-PU 1055** pore filler with high elasticity in 2 crossing layers and the modified, **KDF-PU 1056**, sealing, UV-resistant, aliphatic, elastic, glossy top layer in 3 crossing layers.

Steps

1. **PU PRIMER 870 - Special, polyurethane primer.** Applied by brush or airless sprayer on asphalt surfaces or on waterproof concrete surfaces without rising humidity issues.
2. **Mixture of PU BINDER 1178 and RECYCLED RUBBER 858 in granulometry of 2-4mm or 2-5mm.**
Application with paving machine, in thickness of 30-110mm.
3. **Mixture of PU BINDER 1178 and RECYCLED RUBBER 858 in granulometry of 0.5-2mm.**
Application with paving machine, in thickness of 10mm.
4. **KDF-PU 1055 - Polyurethane, modified, sandproof and waterproof, elastic pore filler.** Applied by metal trowel to create a completely non porous surface.
5. **KDF-PU 1056 - Polyurethane, modified, UV-resistant, aliphatic, elastic, glossy, two-component top coating.** Applied, in two crossing layers by airless sprayer or short haired mohair roller.

Preparation – Application

Applied only on dry asphalt and concrete surfaces (over 30 days old from date of placement for asphalt and 40 days for concrete) without rising humidity issues and free of materials that might prevent bonding e.g. dust, loose particles, grease etc. The success in the application depends on the right preparation of the underlay and use of the material.

- **Good, dry** cleaning of the surface from dust and residues.

- Priming of the surface with special **POLYURETHANE PRIMER 870** in two layers. Consumption: 200-250 gr/m², depending on the absorption of the underlay. It is recommended that the second layer should be applied in sections each time, right before the application of the mixture of **PU BINDER 1178** and **RECYCLED RUBBER 858** in order to ensure proper adhesion, especially on the edges and endings of the playground flooring.
- After 5-12 hours and when the primer is almost dry but not completely, application of the **mixture of PU BINDER 1178 and SBR granules, in granulometry 2-4mm or 2-5mm**, with paver machine, to have the appropriate elasticity on the subfloor, in thickness of 30-110mm. Consumption 7kg/m²/cm.
- Then, when the first cushion surface is dry, application with paver machine of a mixture of **PU BINDER 1178 with SBR granules in granulometry 0,5-2mm** in thickness of 10mm. Consumption 7.2kg/m²/cm.
- Afterwards when the surface of SBR is dry, application of **polyurethane, modified, sandproof and waterproof, elastic pore filler KDF-PU 1055 with metal trowels to create a completely non porous surface**. Consumption: 2 7kg/m² for 2 layers.
- Before the last **UV-resistant top layers** are applied, the surface needs the use of sandpaper machine to make a completely even surface without any irregularities or loose crumbs.
- After the sandpaper of the whole surface is finished follows the application of 350 gr/square meter of our **polyurethane, modified, UV-resistant, aliphatic, elastic, glossy, two-component top coating KDF-PU 1056** in three cross layers by airless spray or by rollers.

Important Remarks

- During temperatures over 40 degrees, ideal time for the application of **SAFEPOL SANDPROOF** is between 22:00 and 09:00 and the minimum bearing temperature during application and drying should be over 10°C.
- The freshly coated surface should be protected from high temperatures, wind, rain and frost for at least the first 24 hours.

Substrate

Asphalt is the safer subfloor for sport floorings for sure and must be always preferred than concrete surfaces.

A. Asphalt Substrate

The asphalt must have a slope of 0.7-1% and must dry for at least 30 days so that all solvents from the asphalt can evaporate.

The asphalt sub-floor should be applied on well compacted 150mm road base sub-floor and asphalt should be laid in one layer (and not 2) in 6 to 8cm with fine and coarse aggregates (up to 15mm granulometry) like the kind of asphalt used in road construction.

So, new road-grade asphalt will have to be laid (minimum 60mm) in one layer containing coarse aggregates and then mature for 30 days at least, before any application takes place on top of the asphalt to avoid bubbles on the final layer of the sport or rubber floorings.

Asphalt Infrastructure

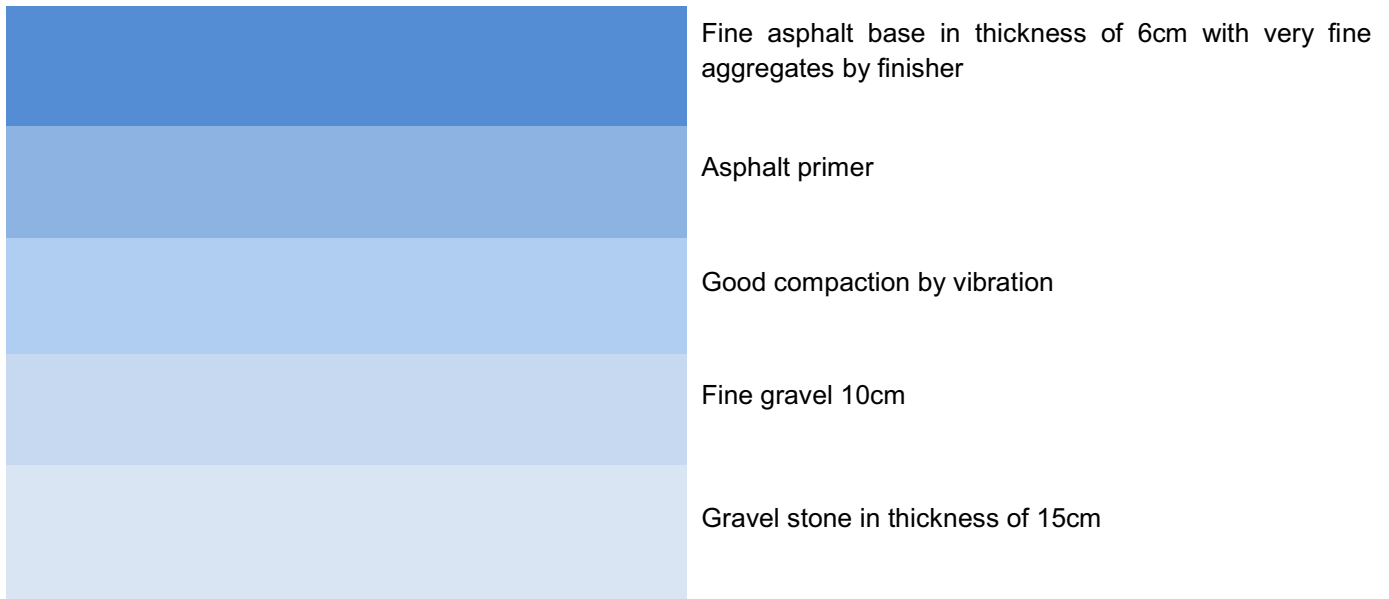

B. Concrete Surface

Concrete surface must be power-trowelled without cracks and must be smooth with a slope of 0.7-1% and humidity under 4% in 10cm depth of concrete.

Concrete must also be **dry at least for 40 days** and then the application takes place if there is no rising humidity for the sub-floor. Before the application takes place, there must be proper grinding of the surface by a grinding machine to open the pores accordingly and also a measurement by special instrument to measure humidity on the surface and in 10cm under the surface.

Generally concrete is a risky sub-floor and there may be problems with rising humidity, especially in areas where the sea level is really high and when the sea is close or in areas near greenery.

Always make expansion joints in large areas of concrete, in order to avoid uncontrollable cracks and failures. Joints should be every 25 square meters creating a grid of 5x5 meters or close to that.

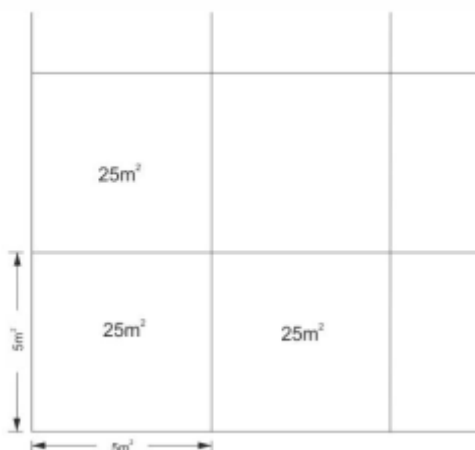

<u>SUBSTRATE REQUIREMENTS</u>	Concrete quality	at least C20/25
	Age:	at least 40 days
	Moisture content:	below 4%

Tools:



Colors: Following colorchart.



The colors may vary slightly from the original due to digital representation.



The colors may vary slightly from the original due to digital representation.

PU PRIMER 870

TRANSPARENT, ONE COMPONENT, POLYURETHANE-BASED PRIMER, USED AS AN ADHESIVE COMPONENT BETWEEN SUBFLOOR AND SPORTS SYSTEMS

GENERAL CHARACTERISTICS

POLYURETHANE PRIMER 870 is a clear, polyurethane-based, one-component primer, which is used as an adhesive component between the sub-floor and sport systems.

- Penetrates in depth.
- Ideal for old and new surfaces.

TECHNICAL DATA

Basis:	one-component polyurethane
Appearance:	liquid
Color:	transparent
Viscosity:	50 – 250 mPa s at 25°C
Density:	0.9- 1.0 Kg/Lt
Temperature for the application and drying of the material:	10 – 40°C

PREPARATION-APPLICATION

Applied on dry surfaces without rising humidity issues, free of materials that might prevent bonding e.g. dust, loose particles, grease etc (in case of asphalt or concrete). The success in the application depends on the right preparation of the underlay and use of the material.

- **Good, dry** cleaning of the surface from dust and residues.
- Priming of the surface with **PU PRIMER 870** applied by airless sprayer equipment or brush, roller. The base layer (wet-pour mixture of SBR and PU BINDER 1118) should be constructed while **PU PRIMER 870** is still a bit sticky. Curing takes place at ambient temperature by evaporation of the solvent and reaction with atmospheric moisture. High temperatures and moisture will shorten the cure time. **PU PRIMER 870** is applied in two or more layers as a thin film, and on the final layer, wet-pour mixture of SBR and PU BINDER 1118 can be applied on sticky surface.
- The temperature should not fall below 10° C during curing.
- Opened drums should be used up quickly.
- The layer (wet-pour mixture of SBR and PU BINDER 1118) should be constructed while the final layer of **PU PRIMER 870** is still sticky.
- **NOTE: Rain will cause the primer to lose its function! If the primer was affected by rain, the base layer should not be constructed! Instead, the sub floor has to dry and the primer application has to be repeated.**

CONSUMPTION

200-300 gr/m² depending on the type and the absorbency of the underlay.

APPLICATION TOOLS

Brush and airless sprayer. Tools should be cleaned with a PU solvent immediately after use.

PACKAGING

Drums / Barrels.

STORAGE

One year in unopened containers in cool and dry places, out of sunlight, with minimum temperature 5°C and maximum temperature 30°C.

REMARKS

- Working time of **POLYURETHANE PRIMER 870** decreases when ambient temperature rises.
 - Prolonged storage of partially used containers containing **POLYURETHANE PRIMER 870** must be avoided as contact with atmospheric moisture will result in skinning and clouding of the product.
-

CAUTION

The application must take place in well-aired places using protective gloves. Skin or eye contact must be avoided, otherwise wash carefully with soap and water.

For more information consult the safety data sheet.

The information given here is true, represents our best knowledge and is based not only on laboratory work, but also on field experience. However, because of numerous factors affecting results we offer this information without any guarantee and no patent liability is assumed. For additional information or questions, contact the technical department of KDF LTD.

PU BINDER 1178

SPECIAL POLYURETHANE BINDER

GENERAL CHARACTERISTICS

100% solids, aromatic polyisocyanate-prepolymer moisture-curing binder based on diphenylmethane diisocyanate. It is MDI based and solvent free. It exhibits excellent adhesion to all rubber granules and gives a strong performance both in terms of tensile strength and durability.

It is mixed with **RECYCLED RUBBER 858, SBR granules**, for the creation of the innovative, elastic, safety playground flooring **SAFEPOL SANDPROOF SYSTEM** or other flexible rubber floorings, ideal for playgrounds, schools etc.

PU BINDER 1178 cured with the air humidity, has low viscosity and is solvent free. **PU BINDER 1178** combines and bonds SBR or EPDM rubber granules, RIM components, polyurethane granules and sponge particles. Also it can be used as lining for insulation and for pasting.

TECHNICAL DATA

Density (25°C)	1,09±0.1 gr/cm ³
Viscosity (25°C)	8000±mPas
Color	Clear, pale yellow

SUBSTRATE REQUIREMENTS

Concrete quality:	at least C20/25
Age:	at least 30 days
Moisture content:	below 4%

PREPARATION-APPLICATION

On-site applications: Applied on dry surfaces, free of materials that might prevent bonding e.g. dust, loose particles etc (in case of asphalt or concrete). The success in the application depends on the right preparation of the underlay and use of the material.

- **Good, dry** cleaning of the surface from dust and residues.
- Priming of the surface with the special **POLYURETHANE PRIMER 870** in two layers. Consumption: 250-400 gr/m², depending on the absorption of the underlay. It is recommended that the second layer should be applied in sections each time, right before the application of **PU BINDER 1178** and **SBR granules** in order to ensure proper adhesion.
- Good mixing of the **PU BINDER 1178** and the **RECYCLED RUBBER 858 in granulometry of 2-4mm or 2-5mm**. Mixing should be performed using a low revolution mixer (300-600 rpm) for 1-2 min. Stirring of the mixture should be performed thoroughly near the sides and bottom of the container in order to achieve homogeneity.
- Following, the mixture is poured on the surface and spread on the desired thickness using paving machine or it can be done manually if the applicator is experienced, with rake for spreading, (wooden) straightedge for initial smoothing, flat metal trowel for final smoothing and compacting, cylinder weighing 8-15kg for final compacting-(cylinder should be cleaned repeatedly with diesel to remove stuck granules from its surface). Consumption: 7kg/m²/cm.
- Good mixing of the **PU BINDER 1178** and the **RECYCLED RUBBER 858 in granulometry of 0.5-2mm**. Mixing should be performed using a low revolution mixer (300-600 rpm) for 1-2 min. Stirring of the mixture should be performed thoroughly near the sides and bottom of the container in order to achieve homogeneity.
- Following, the mixture is poured on the surface and spread on the desired thickness using paving machine or it can be done manually if the applicator is experienced, with rake for

spreading, (wooden) straightedge for initial smoothing, flat metal trowel for final smoothing and compacting, cylinder weighing 8-15kg for final compacting-(cylinder should be cleaned repeatedly with diesel to remove stuck granules from its surface). Consumption: 7,2kg/m²/cm.

- Follows the application of **KDF-PU 1055** a special waterproof and sandproof, polyurethane pore filler.
 - And finally a top coat is applied, **KDF-PU 1056**, polyurethane, modified, UV-resistant, aliphatic, elastic, glossy, two-component top coating.
-

PACKAGING

220kg in barrels.

STORAGE

One year in unopened containers in dry places with minimum temperature 5°C and maximum temperature 30°C, protected from moisture and heat.

REMARKS

The floor must be smooth, dry and clean. Must be removed from oil, dirt, rust and burr. Do not add any foreign material. Concrete humidity should not be above 4%, ambient humidity should be at least 40% and most 80%. To begin the application, must wait for the appropriate humidity

Working time of **PU BINDER 1178** decreases when ambient temperature rises.

Prolonged storage of partially used containers containing **PU BINDER 1178** must be avoided as contact with atmospheric moisture will result in skinning and clouding of the product.

CAUTION

The application must take place in well-aired places using protective gloves. Skin or eye contact must be avoided, otherwise wash carefully with soap and water.

For more information consult the material safety data sheet.

The information given here is true, represents our best knowledge and is based not only on laboratory work, but also on field experience. However, because of numerous factors affecting results we offer this information without any guarantee and no patent liability is assumed. For additional information or questions, contact the technical department of KDF LTD.

SBR RUBBER GRANULES 858

GENERAL CHARACTERISTICS

It can be used in sports facilities as infill in synthetic grass with the parallel use of round sand and also as one of the components in case of cast applied wet-pour systems for playground floorings or as shock-pad for sport subfloors in athletic tracks and sports fields.

Rubber granule is derived from car and truck tires. During processing, the tires are mechanically granulated, removing all metal and synthetic fibers, as well as any other foreign part contained in there with specially designed sieves, so as to produce a 99.99% clear rubber with high quality.

PROPERTIES

- 100% recyclable
- Long life
- Resistance to adverse weather conditions
- High shock absorbency and vibration damping
- High abrasion resistance

PREPARATION-APPLICATION

In sports facilities and playgrounds to ensure flexibility of surface and vibration absorption.

TECHNICAL CHARACTERISTICS

Granulometry 1-3mm

DENSITY:	0.48kg/cm ³
SPECIFIC GRAVITY	1.20+/- .05 (Water = 1.0)
HARDNESS	60
HUMIDITY(%)	<0.65
ELASTICITY	100% - No change
RESISTANCE	113N/cm - Excellent

PACKAGING

Packaging is available in big-bags -1 ton in following sizes:

Grain size	0,5-1,5 mm
Grain size	0,5-2,5 mm
Grain size	0.5-4.0 mm
Grain size	2-8 mm
Grain size	8-20 mm
Grain size	80-50 mm
Grain size	80-120 mm

KDF-PU 1055 PORE FILLER

FOR SANDPROOF-WATERPOOF PLAYGROUND FLOORINGS

GENERAL CHARACTERISTICS

KDF-PU 1055 PORE FILLER is a sealing, sandproof and waterproof modified pore filler with high elasticity that can be applied over SBR cushion layers.

KDF-PU 1055 PORE FILLER resists against sand penetration/ depositing, humidity, water and most of the chemicals. It has very good filling capacity and thixotropic properties. It has low fluidity feature with its filler structure. It can be easily applied. It provides strong and very elastic filling after the reaction.

TECHNICAL DATA

Mixing Ratio	90.8 : 9.2 (By weight)
Density of mixture (25°C)	1.69-1.79 Kg/lt
Viscosity of mixture (25°C)	40000-55000 mPa s at 25°C
Pot-life (25°C)	30-40 min
Application temperature	Min 10°C
Curing (25°C and %60 relative humidity)	After 24 hours it can be sanded
Color	Creme

PREPARATION-APPLICATION

It is used to fill pores, cracks, dilation spaces, holes to smooth and repair the floor and other filling applications. Especially used for sealing and sandproofing in-situ applied SBR (or EPDM) layers in SAFEPOL SANDPROOF system

The resin component should be thoroughly stirred to incorporate any slight separation, whilst continuing stirring the contents of the hardener container should be added. Continue stirring until a homogeneous mix is obtained. The mixed material must be used within 30-40 minutes of mixing at 25°C The surface must be dry and clean. **KDF-PU 1055 PORE FILLER** can be applied by trowel.

CONSUMPTION

2 kg per m² (depends on the surface absorbance and SBR granulation)

PACKAGING

Barrels 280kg

STORAGE

One year in unopened containers in cool and dry places, out of sunlight, with minimum temperature 5°C and maximum temperature 30°C.

REMARKS

Substrate must be dry, clean, and free from dust, grease and oil. Application must be done between 10°C - 40°C.

KDF-PU 1055 PORE FILLER has to be thoroughly sanded before the application of the top

aliphatic coat **KDF-PU 1056 TOP COATING** in order to provide a smooth clean surface for the aliphatic top coat that will follow right after the sanding process is completed.

By no means **KDF-PU 1055 PORE FILLER** should be applied in thickness. The material is a pore filler and not a levelling material, and so it should be applied as pore filler (thin dragged layer over the substrate). In case it is applied in some areas in thickness, those areas should be well ground with sanding machine before subsequent layers in order to avoid cracking of the material due to oversized thickness.

Attention should be given also to possible trapped humidity in the pore filler, which could lead to cracks in the material or bubbles of the material.

Moreover, it is important that the mixing ratio between PU BINDER to SBR or EPDM rubber in the underlying cushion mixtures is kept as stable as possible in order to obtain similar flexibility of the cushion throughout the surface. Otherwise, areas with different flexibilities might occur. Same can happen if the mixing is not properly done in the paving machine or in the barrels/drums to secure uniformity throughout.

CAUTION

Harmful if swallowed. Seek immediately medical attention. Rubber gloves and safety glasses with side guards should be worn.

For more information consult the material safety data sheet.

The information given here is true, represents our best knowledge and is based not only on laboratory work, but also on field experience. However, because of numerous factors affecting results we offer this information without any guarantee and no patent liability is assumed. For additional information or questions, contact the technical department of KDF LTD.

KDF-PU 1056 TOP COATING

FOR SANDPROOF-WATERPOOF PLAYGROUND FLOORINGS

GENERAL CHARACTERISTICS

KDF-PU 1056 TOP COATING is a polyurethane, two-component, solvent-based, glossy finish aliphatic, elastic coating for outdoor sports surfaces.

It is applied as a final, sealing layer on top of playground floorings made of **SBR rubber** plus **PU binder mixture**, or **EPDM** plus **PU binder mixture**, on safety tiles. Especially used as the sealing top coat in the **SAFEPOL SANDPROOF** system.

Provides a glossy surface with exceptional resistance in abrasion and various chemical agents.

It is UV-resistant and thus absolutely suitable for outdoor surfaces.

TECHNICAL DATA

Mixing Ratio (transparent)	83,5 :16,5 (By weight)
Mixing Ratio (colored)	78 : 22 by weight
Density (25°C)	app. 1,3±0.1 gr/cm ³
Application Temperature	Min 10°C
Curing (25°C)	8-10 hour
Color	18 colors from KDF color chart

PREPARATION-APPLICATION

- Good, dry cleaning of the surface from dust and residues using vacuum cleaner and squeegees.
- Caution must be taken so that temperature of the support surface as well as ambient air remains above 15°C during application and curing of the materials while relative humidity does not exceed 75%.
- The resin component should be thoroughly stirred to incorporate any slight separation, whilst continuing stirring the contents of the hardener container should be added. Continue stirring until a homogeneous mix is obtained. Airless sprayer or roller can apply **KDF-PU 1056 TOP COATING**.

CONSUMPTION

App.350-400 gr/m² for the SAFEPOL SANDPROOF system. Apply three coats at least.

PACKAGING

5kg, 15kg set (A+B).

STORAGE

12 months in unopened containers in dry places with minimum temperature 5°C and maximum temperature 30°C.

REMARKS

- Working time of **KDF-PU 1056 TOP COATING** decreases when ambient temperature rises.
- Prolonged storage of partially used containers containing **KDF-PU 1056 TOP COATING** must be avoided as contact with atmospheric moisture will result in skinning and clouding of the product.
- After hardening **KDF-PU 1056 TOP COATING** is completely safe for health.
- The three layers of **KDF-PU 1056 TOP COATING** will have to be applied strictly within 24 hours of one another (European conditions) **or within 3-6 hours (GCC high-temperature conditions)** in order to cover the surface swiftly and protect it from unwanted weather or other adverse conditions (sand dust, accumulated dirt or foreign matter etc.). In case the 24-hour limit (Europe) or the 3-6-hour limit (GCC) is surpassed or weather or other adverse conditions interfere between layers at any time, the surface might need sanding again to restore smoothness and cleanliness before applying subsequent layers of the aliphatic top coat.

CAUTION

The application must take place in well-aired places using protective gloves. Skin or eye contact must be avoided, otherwise wash carefully with soap and water.

For more information consult the material safety data sheet.

The information given here is true, represents our best knowledge and is based not only on laboratory work, but also on field experience. However, because of numerous factors affecting results we offer this information without any guarantee and no patent liability is assumed. For additional information or questions, contact the technical department of KDF LTD.

CLEANING AND MAINTENANCE MANUAL FOR :

-OUTDOOR SPORTS FLOORING

-PLAYGROUND FLOORINGS

Introduction

Outdoor sports floorings and playground surfaces are made of extremely durable polymers, designed to withstand extreme climate conditions and intense use. However for the best maintenance of the rubber and sport surface a regular check (once in 6 months) is required and the maintenance of the surface is necessary to preserve the suitability of the surface (sand pits, areas of vegetation) which could leave algae, moss and leaf deposits.

The installer's guarantee will usually be conditional on the recommended maintenance requirements being carried out with due diligence.

Maintenance

Maintenance procedures are necessary to preserve the lifetime of the surface and to ensure that:

- The Surface is kept clean.
- The Surface is safe for intense diverse use and all types of users.
- The facility looks attractive.

These objectives are achieved by :

- Sweeping/scraping/removing leaves and other debris and foreign matter from the surface.
- Regularly washing the surface to remove contaminants such as grime, grease, algae, moss, sand, foreign matter etc.
- Applying suitable treatments of moss-killer and/or algacide
- Periodically removing weed growth from the perimeter kerb lines.

Maintenance Equipment

Leaves, pine needles and other detritus should not be allowed to remain on the surface for any length of time. If this does happen, they rapidly rot down, forming a contaminating "skin" on the surface and providing a growth media for algae and moss.

A mechanical leaf-sweeper or vacuum cleaner is ideal for removing vegetable matter and dirt. Restricted areas may have to be cleaned by hand.

The equipment should be well maintained and carefully operated to avoid contamination of, or physical damage to, the surface. Spillage of fuel or lubricating oil will damage the surface.

The pressure loading on the surface as well as the friction and shearing loads have to be kept to a minimum to prevent damage to the surface. Large pneumatic tires and soft brushes along with careful operating of the machinery, is recommended to avoid any damage on the surface.

A mechanical leaf-sweeper or vacuum cleaner is ideal for removing vegetable matter and dirt. Restricted areas may have to be cleaned by hand.

The equipment should be well maintained and carefully operated to avoid contamination of, or physical damage to, the surface. Spillage of fuel or lubricating oil will damage the surface.

The pressure loading on the surface as well as the friction and shearing loads have to be kept to a minimum to prevent damage to the surface. Large pneumatic tires and soft brushes along with careful operating of the machinery, is recommended to avoid any damage on the surface.

At least once a year it is advisable to wash the surface with low-pressure jetting apparatus.

Polymeric surfaces can with stand low pressures without suffering damage.

Note that no aggressive chemical cleaning agents (chlorine or acid-based) should be used; normal neutral market detergents are adequate.

Prevention of damages

To ensure maintaining the surfaces to a high standard, restrictions should be imposed on the use of the surface.

- In general no vehicles should be permitted to drive on the outdoor sports/playground surface.
- No chemicals, oils, fuel or solvents should be allowed on the surface.
- No fireworks or cigarettes or inadequate shoes should be allowed on the synthetic surface.

Damages and renovation

The lifetime of an outdoor sports/playground surface depends on its quality, usage and level of maintenance. In general a normal outdoor sports/playground surface used intensively will last 7 to 12 years (depending on the system) before renovation is required. Renovation should be carried out periodically to prevent the total damage of the surface, which would necessitate complete renewal.

Renovation must be carried out by professional and skilled contractors with thorough knowledge of this type of work

There are different procedures for the renovation of a surface:

- Complete renewal by replacing the worn-out surface with a new sports flooring system.
- Re-topping or sealing with adequate polyurethane or acrylic materials.
- Partial re-topping in particular worn-out areas.

Information contained in this document is of general nature and is given in good faith. As the state of the surface and the use and application of the various cleaning products, is out of our control, our advice for individual cases, verbal, written or based on tests, does not exempt the applicator from the testing the suitability of the cleaning products and their applications.

The above maintenance guide refers to **the below KDF systems:**

- SYSTEM SPORTFLOOR-EX**
- SYSTEM FLEXFLOOR-EX**
- SYSTEM POLYFLEX AEL EX**
- SYSTEM POLYFLEX WET POUR AEL-EX**
- SYSTEM POLYFLEX PU EX**
- SYSTEM POLYFLEX WET POUR PU - EX**
- SYSTEM SMARTFLOOR**
- SYSTEM SAFEPOL**
- SYSTEM SAFEPOL WITH TPV GRANULES**
- SYSTEM SAFEPOL COLORED**
- SYSTEM SAFEPOL SANDPROOF**
- SYSTEM QUICKLAWN PLAYGROUND SAFEPOL**
- SYSTEM QUICKLAWN PLAYGROUND SAFEPOLSANDPROOF**
- SYSTEM COLORFLEX**
- SYSTEM SPORTGROUND-EX**
- SYSTEM POLTRACK SPRAYCOAT**
- SYSTEM POLTRACK SPRAYCOAT SEALED**
- SYSTEM POLTRACK SANDWICH**
- SYSTEM POLTRACK SANDWICH IN ROLLS**
- SYSTEM POLTRACK FULL PU**
- SYSTEM POLTRACK ACRYLIC**
- SYSTEM POLTRACK JOGGING TRACK**
- SYSTEM POLTRACK PU JOGGING TRACK**
- SYSTEM POLTRACK JOGGING TRACK SBR**
- SYSTEM POLTRACK JOGGING TRACK SHOCK-PAD - EPDM**
- SYSTEM POLTRACK JOGGING TRACK SHOCK-PAD - ISOPOL**
- SYSTEM POLTRACK EQUINE**

CERTIFICATES OF KDF Ltd



ISO KDF Ltd



POLTRACK SPRAYCOAT



POLTRACK SANDWICH



POLYFLEX AEL-EX



FLEXFLOOR-EX



SPORTFLOOR-EX



SPORTFLOOR-EX FAST



POLTRACK EQUINE



BADMINTON POLYFLEX PU

CERTIFICATES OF KDF Ltd



POLYFLEX PU



SPORTGROUND-EX



POLTRACK JOGGING TRACK



FIBA POLYFLEX PU



SAFEPOL



EPDM 856



PLAYPREM

Product name	Order number
Safepol Sandproof (SBR+PU)	14-0501IT
Product type	Date
Shock absorbing surface	20/05/2016
Address	Page
Κατασκευές Δαπέδων Αθλητικών Χώρων	04/01
Client	Request
KDF Ltd	Performance test and certification of the product

Photographs

Conditions

Temperature	23°C
Humidity	55%

Product information

Material	SBR + PU
Width	1.20 m
Length	1.20 m
Thickness	55 mm
Weight	1.40 kg/m²
Supplier	Το Εργοστάσιο της εταιρείας

Test positions

- Position 1: In the center of the floor
- Position 2: In the center of the floor
- Position 3: In the center of the floor
- Position 4: In the center of the floor
- Position 5: In the center of the floor
- Position 6: In the center of the floor
- Position 7: In the center of the floor
- Position 8: In the center of the floor
- Position 9: In the center of the floor
- Position 10: In the center of the floor

SAFEPOL SANDPROOF



SAFEPOL SANDPROOF

CERTIFICATES OF KDF Ltd



POLTRACK FULL-PU



PU GRASS 149