

# KDF

Sports Flooring Systems & Building Materials

## POLYFLEX AEL-IN INDOOR SPORT SYSTEM

---



**KDF LTD** ([www.kdf.gr](http://www.kdf.gr)) is one of the most dynamic and export-oriented Greek companies (currently activated in more than 50 countries in 4 continents), based in Greece (EU) and U.A.E too, with production facilities and warehouses in both countries for acrylic and polyurethane materials.

**We are experts in sports, industrial and decorative flooring products and systems**, with huge experience in Europe, Africa, Asia, Middle East and India as well.

Our export horizon is expanding rapidly and our goal is to stand out as a model of flexibility and competitiveness. The company, being one of the pioneer companies in the sector of sports flooring systems and building materials and giving particular attention to providing a fully upgraded range of products and services, provides certified systems by **ITF, IAAF, EU norms, LNE, LABOSPORT, ISASPORT, to name but a few.**

**Our systems are approved in many ministries like:**

- Ministry of Education in U.A.E
- Ministry of Education in K.S.A
- Ministry of Education in Oman
- Ministry of Education in Kuwait and many other institutes like
- Oman Royal Police
- Aramco, K.S.A
- Musanada in U.A.E
- Municipality of Doha
- Municipality of Dubai, Abu Dhabi, Sharjah and many others institutions.

KDF goes far beyond trade, providing consultancy in marketing and also technical support all the way, from the costing till the finalization of the project. Operating under the requirements of ISO 9001/2015 for production, trade and also application, we make sure our products are first applied successfully at site by our own people before we launch them abroad.

Therefore, our systems have all stood the real life test in different climates, from Middle East till Russia, and this is one of our main assets, enabling us to provide full and vertical technical support from specifying to final application plus supervision when required or even full application and costing.

**We invite you to discover a world of sports flooring expertise and solutions.**

VIEW OUR NEW SPORTS CATALOGUE



**KDF - Kataskeves Dapedon LTD**  
e : [exports@kdf.gr](mailto:exports@kdf.gr)  
w : [www.kdf.gr](http://www.kdf.gr)

1 Papanikolaou Ave, Pefka  
57010, Thessaloniki, Greece  
t / f : 0030 2310 829598

# INDICATIVE REFERENCE LIST OF PROJECTS

- 12 SCHOOLS IN U.A.E, MINISTRY OF EDUCATION(THROUGH VARIOUS CONTRACTORS) - 40000m<sup>2</sup> EPDM Rubber flooring
- UNIVERSITY OF DAMMAM - KSA - 13000m<sup>2</sup> - Acrylic cushion floorings
- KING ABDULLAH BASE AIR DEFENSE - TAIF, KSA - 12600 m<sup>2</sup> - Running track
- KING FAHD UNIVERSITY OF PETROLEUM AND MINERALS-DHARAN, KSA-12400m<sup>2</sup>-Rubber outdoor flooring
- RUNNING TRACK - K.S.A- 11000 m<sup>2</sup> - Running track, POLTRACK SANDWICH system
- GEMS SCHOOL - DUBAI, U.A.E - 10000 m<sup>2</sup> - Running track
- PASARGRAD WHOLESALE MARKET-IRAN - 10000 m<sup>2</sup> - Decorative flooring
- YAS ISLAND, ABU DHABI, U.A.E - 10000m<sup>2</sup> Bicycle track
- ALEXANDRIA STADIUM - ALEXANDRIA, EGYPT - 8500 m<sup>2</sup> - Running track
- SALAM STREET & MINA ROAD, ABU DHABI, U.A.E - 8000m<sup>2</sup> Bicycle track, Sportground-Ex system
- KING FAHAD NAVAL BASE - JUBAIL, KSA - 8000m<sup>2</sup> - Running track
- MUNICIPALITY OF VELVENTO - KOZANI, GREECE - 8000m<sup>2</sup>, Running track
- ABBHA, KSA - 7600m<sup>2</sup> - Running track
- MUNICIPALITY OF ZENICA - ZENICA, BOSNIA& HERZEGOVINA - 7500m<sup>2</sup>, Poltrack Spraycoat, Running track
- ADNOC SCHOOLS - U.A.E - 7000m<sup>2</sup> - Safepol system
- ATLAS CENTER-BAM, IRAN - 7000 m<sup>2</sup> - Decorative flooring
- RUNNING TRACK - SUDAN - 7000 m<sup>2</sup> - Running track, POLTRACK SPRAYCOAT system
- CORNISH, JEDDAH, K.S.A - 6000m<sup>2</sup> Bicycle track Sportground-Ex system
- YOKOGAWA ELECTRIC CORPORATION-DHAHRAN TECHNO VALLEY-DAMMAM, KSA - 5500m<sup>2</sup>- Epoxy antistatic floorings
- AMITY INTERNATIONAL SCHOOL - ABHU DHABI, U.A.E - 5500m<sup>2</sup>, Poltrack Spraycoat, Running Track
- SHUQAIQ WATER AND ELECTRICITY COMPANY - JIZAN, KSA - 5400 m<sup>2</sup> - acrylic courts
- TALEEM UPTOWN SCHOOLS - DUBAI, UAE - 5400m<sup>2</sup>-Acrylic sports courts systems
- SAUDI AIR FORCE - KSA - 5250 m<sup>2</sup> - Acrylic coating elastoturf, running track
- RUNNING TRACK - K.S.A - 5000 m<sup>2</sup> - Running track, POLTRACK SANDWICH system
- AL HAMRA, RAS AL KHAIMAH, U.A.E - 5000m<sup>2</sup> Bicycle track, Sportground-Ex system
- AIRBASE IN TAIF - KSA - 5000 m<sup>2</sup> - Running track
- DEPARTMENT OF EDUCATION ASIR REGION - KHAMIS, KSA - 4500 m<sup>2</sup> - Running track
- SERVIA STADIUM - KOZANI, GREECE - 4500m<sup>2</sup>, Running track
- COMMUNITY COLLEGE - KHAMIS, KSA - 4200 m<sup>2</sup> - Running track
- MULTIPLE RUNNING TRACKS - ALGERIA - 40000 m<sup>2</sup> - Running track, POLTRACK SPRAYCOAT system
- EMIRATES INTERNATIONAL SCHOOL - DUBAI, U.A.E - 4000m<sup>2</sup> - Safepol System, Playground flooring
- SPORTS CLUB CENTER GLIFADA - ATHENS, GREECE - 4000m<sup>2</sup>- Poltrack Spraycoat, Running Track
- HH KHALID BIN BANDAR - RIYADH, KSA - 3800 m<sup>2</sup> - Volleyball/basketball rubber courts
- ANATOLIA GOLLEGE - THESSALONIKI, GREECE - 3600m<sup>2</sup>, Running track
- AIMARJAN ASLAND – PARTIAL - 3600m<sup>2</sup>- Poltrack Sandwich, Running Track
- RUNNING TRACK - ISRAEL - 3500 m<sup>2</sup> - Running track, POLTRACK SANDWICH system
- SPORTS CLUB CENTER KISSAMOS - CRETE, GREECE - 3200m<sup>2</sup>- Poltrack Sandwich, Running Track
- AL LUSAIL SPORTS CLUB - DOHA, QATAR - 3200m<sup>2</sup> - Jogging track
- SPORTS CLUB CENTER - SERVIA, GREECE - 3200m<sup>2</sup> - Poltrack Sandwich, Running Track

**-KING KHALID UNIVERSITY - ABHA, KSA - 3100 m<sup>2</sup> - Running track**

**-SPORTS CLUB CENTER "PAPAGOU" - ATHENS, GREECE - 3000m<sup>2</sup> - Poltrack Sandwich, Running Track**

**-PANORAMA SPORTS COMPLEX - THESSALONIKI, GREECE - 3000m<sup>2</sup>, Running track**

**-INDIAN ARMY - SAGAR, INDIA - 2800m<sup>2</sup>- Acrylic sports courts**

**-ALL SAINTS SCHOOL - MUMBAI, INDIA - 2700 m<sup>2</sup> - PU outdoor sports flooring and running track**

**-INDIAN INSTITUTE OF SCIENCE EDUCATION AND RESEARCH-BHOPAL,INDIA-2700m<sup>2</sup>-Acrylic sports courts**

**-OUR OWN GOLF SCHOOL - 2700m<sup>2</sup>- Poltrack Spraycoat, RunningTrack**

**-AL RAYAN, QATAR - 2500 m<sup>2</sup> - Running track, POLTRACK SANDWICH system**

**-ALHOSN SPORTS COMPLEX - 2400 m<sup>2</sup> - Running track, POLTRACK SANDWICH system**

**-TEACHERS COLLEGE - ABHA, KSA - 2050 m<sup>2</sup> - Running track**

**-MUSAB BIN OMAIR BOYS SCHOOL - BIN OMRAN, QATAR - 2050 m<sup>2</sup> - PU outdoor sport flooring**

**-BURAIRAT SCHOOL - RAK, UAE - 2000 m<sup>2</sup> - Running track**

**-HADAYEK ALAHRAM CLUB - GIZA, EGYPT - 2000m<sup>2</sup>, PU outdoor sports flooring, POLYFLEX PU-EX WET-POUR system**

**-AL SAILIYA BOYS SCHOOL - AL SAILIYA, QATAR - 2000 m<sup>2</sup> - Polyurethane, outdoor sport flooring**

**-KING KHALID UNIVERSITY - ABHA, KSA - 2000 m<sup>2</sup> - Volleyball/basketball rubber courts**

**-HH KHALID BIN BANDAR - RIYADH, KSA - 2000 m<sup>2</sup> - Volleyball/basketball rubber courts**

**-RAWDA RASHEED PRIMARY SCHOOL FOR BOYS - 2000 m<sup>2</sup>**

**-AL WAKAIR BOYS SCHOOL - AL WAKRAH, QATAR - 1950 m<sup>2</sup> - Polyurethane, outdoor sport flooring**

**-THE LAKE DISTRICT - PUNE, INDIA - 1950m<sup>2</sup>- Acrylic sports courts**

**-PRESIDENTIAL GUARD COMMAND MAHAWI - ABU DHABI, UAE - 1900m<sup>2</sup> - Football court**

**-UNITED (SABIC) SPORTS CLUB - 1900 m<sup>2</sup> - Rubber flooring**

**-SHOOLS MINISTRY OF EDUCATION - KHAMIS, KSA - 1800 m<sup>2</sup> - Rubber flooring**

**-AL MAJAD AMPHITHEATER - SHARJA, UAE - 1800m<sup>2</sup> - Certified Jogging track**

**-QASSIM UNIVERSITY - KSA - 1800 m<sup>2</sup> - Polyurethane sports flooring**

**-AL QADSIYA MODEL INDEPENDENT SCHOOL - ALWAAB, QATAR - 1770 m<sup>2</sup> - PU outdoor sport flooring**

**-AL WAHDA SPORT ACADEMY CLUB - ABU DHABI, UAE - 1700 m<sup>2</sup> - Acrylic sports system**

**-ALSARH SCHOOLS OF CIVIL - RIYADH, KSA - 1650m<sup>2</sup> - PU glue/Soccer field**

**-GD GOENKA PUBLIC SCHOLL - PURNIA, INDIA - 1630m<sup>2</sup>- Acrylic sports courts**

**-SPA RESORT DERENIVSKUPIA KI - UZHGOROD, UKRAINE - 1600 m<sup>2</sup> - Flexfloor-ex system, volleyball court**

**-THE MILITARY HOSPITAL - RIYADH, KSA - 1560 m<sup>2</sup> - Volleyball/basketball rubber courts**

**-THE MILITARY HOSPITAL - RIYADH, KSA - 1560 m<sup>2</sup> - Pu glue-PU sports flooring**

**-AL FORSHAN SPORTS CENTRE - ABU DHABI, U.A.E - 1500m<sup>2</sup> - Smartfloor system, Acrylic flooring**

**-SCHOOL IN AL WAKRA CITY - DOHA, QATAR - 1500 m<sup>2</sup> - Playground flooring**

**-IRAQ ARMY CAMP - IRAQ - 1500m<sup>2</sup> - Acrylic flooring in 2,2mm**

**-SCHOOL IN AL WAKRA CITY - DOHA, QATAR - 1500 m<sup>2</sup> - Playground flooring**

**-PROJECT GREEN LAND - DUBAI, UAE - 1500 m<sup>2</sup> - Jogging track**

**-UP TOWN SCHOOL - 1500m<sup>2</sup>- Poltrack Spraycoat, RunningTrack**

**-INDIAN AIR FORCE - ALLAHABAD, INDIA - 1450m<sup>2</sup>- Acrylic sports courts**

**-DUBAI MODERN HIGH SCHOOL - DUBAI, UAE - 1375 m<sup>2</sup> - Acrylic sports courts**

**-PROJECT ECOGREEN - DUBAI, UAE - 1350 m<sup>2</sup> - Jogging track**

**-POLICE COMPLEX BARRACKS NIZWA - OMAN- 1300 m<sup>2</sup> - Colorflex, PU sport flooring**

**-POLICE COMPLEX BARRACKS AL AJAIZ - OMAN - 1300 m<sup>2</sup> - Colorflex, PU sport flooring**

**-POLICE COMPLEX BARRACKS KATMATMILAH SITE - OMAN- 1300 m<sup>2</sup> - Colorflex, PU sport flooring**  
**-POLICE COMPLEX BARRACKS SUWAIQ - OMAN - 1300 m<sup>2</sup> - Colorflex, PU sport flooring**  
**-POLICE COMPLEX BARRACKS AL KAMIL - OMAN - 1300 m<sup>2</sup> - Colorflex, PU sport flooring**  
**-PLAYGROUND FLOORING - BAHRAIN - 1300m<sup>2</sup> - Safepol system**  
**-POLICE COMPLEX BARRACKS SHINAS - OMAN - 1300 m<sup>2</sup> - Colorflex, PU sport flooring**  
**-POLICE COMPLEX BARRACKS BHALA - OMAN - 1300 m<sup>2</sup> - Colorflex, PU sport flooring**  
**-POLICE COMPLEX BARRACKS MUDHAIBI - OMAN - 1300 m<sup>2</sup> - Colorflex, PU sport flooring**  
**-POLICE COMPLEX BARRACKS THUMRAIT - OMAN - 1300 m<sup>2</sup> - Colorflex, PU sport flooring**  
**-POLICE COMPLEX BARRACKS AL KHOUDH - OMAN - 1300 m<sup>2</sup> - Colorflex, PU sport flooring**  
**-POLICE COMPLEX BARRACKS MAHDAH - OMAN - 1300 m<sup>2</sup> - Colorflex, PU sport flooring**  
**-POLICE COMPLEX BARRACKS BID BID - OMAN - 1300 m<sup>2</sup> - Colorflex, PU sport flooring**  
**-POLICE COMPLEX BARRACKS AL KHABOORA - OMAN - 1300 m<sup>2</sup> - Colorflex, PU sport flooring**  
**-POLICE COMPLEX BARRACKS DHANK - OMAN - 1300 m<sup>2</sup> - Colorflex, PU sport flooring**  
**-POLICE COMPLEX BARRACKS HAFEET - OMAN - 1300 m<sup>2</sup> - Colorflex, PU sport flooring**  
**-POLICE COMPLEX BARRACKS AUQAD - OMAN - 1300 m<sup>2</sup> - Colorflex, PU sport flooring**  
**-POLICE COMPLEX BARRACKS SUMAIL - OMAN - 1300 m<sup>2</sup> - Colorflex, PU sport flooring**  
**-ALHALAFI BREAK - RIYADH, KSA - 1276 m<sup>2</sup> - Rubber flooring**  
**-GI-DHOFAR BEACH RESORT & SPA - OMAN - 1225 m<sup>2</sup> - Colorflex, PU sport flooring**  
**-RLS BASIC EDUCATION SCHOOL SOHAR - OMAN - 1225 m<sup>2</sup> - Colorflex, PU sport flooring**  
**-MIXED BASIC EDUCATION SCHOOL AL QABIL - OMAN - 1225 m<sup>2</sup> - Colorflex, PU sport flooring**  
**-BOYS BASIC EDUCATION SCHOOL BARKHA - OMAN - 1225 m<sup>2</sup> - Colorflex, PU sport flooring**  
**-GIRLS BASIC EDUCATION SCHOOL MUDHAIBI - OMAN - 1225 m<sup>2</sup> - Colorflex, PU sport flooring**  
**-MIXED BASIC EDUCATION SCHOOL AL AMERAT - OMAN - 1225 m<sup>2</sup> - Colorflex, PU sport flooring**  
**-UMSALAMA GIRLS SCHOOL - AL RAYYAN, QATAR - 1200 m<sup>2</sup> - Polyurethane, outdoor sport flooring**  
**-SHERATON PARK - DOHA, QATAR - 1200 m<sup>2</sup> - Playground flooring**  
**-RAWDA BIN JASSIM SCHOOL - AL AZIZIYAH, QATAR - 1200 m<sup>2</sup> - Polyurethane, outdoor sport flooring**  
**-GEMS WESTMINISTER SCHOOL - DUBAI, U.A.E - 1200 m<sup>2</sup> - Acrylic sports courts**  
**-SILVER SPORTS CLUB - INDIA - 1200m<sup>2</sup>- Acrylic sports courts**  
**-OUR OWN SCHOOL - SHARJA, U.A.E - 1200m<sup>2</sup> - Acrylic sports courts**  
**-SHARJAH FOOTBALL CLUB - SHARJAH, UAE - 1200 m<sup>2</sup> - Polyurethane basketball courts**  
**-SHERATON PARK - DOHA, QATAR - 1200 m<sup>2</sup> - Playground flooring**  
**-SYMBIOSIS COLLEGE - INDIA - 1180m<sup>2</sup>- Acrylic sports courts**  
**-PROFESSOR ABDULAZIZ ANQARI - RIYADH, KSA -1150m<sup>2</sup> - PU glue/Socccer field**  
**-AL SAQID ISLAMIC ENGLISH SHCOLL-DUBAI,UAE-1100m<sup>2</sup>- Acrylic flooring, WET-POUR POLYFLEX AEL-EX**  
**-FIRST POINT SCHOOLS - DUBAI, UAE - 1100m<sup>2</sup> - Acrylic sports courts**  
**-MAADI BRITISH SCHOOL- EGYPT - 1100m<sup>2</sup>, Multipurpose court, COLORFLEX system**  
**-DUBAI AMERICAN ACADEMY - DUBAI, UAE - 1080 m<sup>2</sup> - Acrylic sports court**  
**-PRELUDE PUBLIC SCHOOL - AGRA, INDIA - 1070m<sup>2</sup>- Acrylic sports courts**  
**-ALMGBAL BREAK - RIYADH, KSA - 1050 m<sup>2</sup> - Rubber playground**  
**-BANIYAS CLUB AND AL AIN ENGLISH SPEAKING SCHOOL - ABU DHABI, UAE - 1000m<sup>2</sup> - Acrylic flooring**  
**-MINISTRY OF EDUCATION - DAMMAM, KSA - 1000 m<sup>2</sup> - PU indoor multipurpose sports flooring**  
**-SHEIKH OBEID MAKTHOUM PALACE - 1000m<sup>2</sup> - Outdoor polyurethane flooring**  
**-INDIAN AIR FORCE - AGRA, INDIA - 1000m<sup>2</sup>- Acrylic sports courts**  
**-INDIAN AIR FORCE - LUCKNOW, INDIA - 1000m<sup>2</sup> - Acrylic sports courts**



**-MULTIPURPOSE POLYURTEHANE INDOOR COURTS - F.Y.R.O.M - 1000m<sup>2</sup> - Polyflex PU-In system**

**-SODIC PROJECT - EGYPT - 1000m<sup>2</sup>, Multipurpose court, COLORFLEX system**

**-INDIAN AIR FORCE - VARANASI, INDIA - 1000m<sup>2</sup> - Acrylic sports courts**

**-INTERNATIONAL SCHOOL OF CREATIVE SCHIENCE - SHARJAH, U.A.E - 1000m<sup>2</sup> - Safepol System**

**-INDIAN AIR FORCE - BIHTA, INDIA - 1000m<sup>2</sup> - Acrylic sports courts**

**-INDIAN AIR FORCE - DARBHANGA, INDIA - 1000m<sup>2</sup> - Acrylic sports courts**

**-AL AIN INDIAN SCHOOL - AL AIN, UAE - 1000m<sup>2</sup> - Football court**

**-DUBAI SCHOLRAS PRIVATE SCHOOL - DUBAI, U.A.E - 1000m<sup>2</sup> - Acrylic flooring in 2,2mm**

**-COMMUNITY COLLEGE - KHAMIS, KSA - 940 m<sup>2</sup> - Polyurethane indoor multipurpose sports flooring**

**-GEMS METROPOLE SCHOOL - DUBAI, U.A.E - 900 m<sup>2</sup> - Playground flooring**

**-MINISTRY OF EDUCATION - ABHA, KSA - 900 m<sup>2</sup> - Polyurethane indoor multipurpose sports flooring**

**-BAB AL SHAMS SPA HOTEL - DUBAI, UAE - 900m<sup>2</sup> - Football court**

**-KING KHALID UNIVERSITY - ABHA, KSA - 820 m<sup>2</sup> - Polyurethane indoor multipurpose sports flooring**

**-SCHOOL IN AL WAKRA CITY - DOHA, QATAR - 800m<sup>2</sup> - Polyurethane sports flooring**

**-SULTAN MANOR - RIYADH, KSA - 800 m<sup>2</sup> - Polyurethane multipurpose sports flooring**

**-MINISTRY OF EDUCATION - AL KHARIZ, KSA - 800 m<sup>2</sup> - PU indoor multipurpose sports flooring**

**-DUBAI ENGLISH SPEAKING COLLEGE - DUBAI, UAE - 783m<sup>2</sup> - Acrylic flooring, SPORTFLOOR-EX, HARD COURT**

**-SINGAPORE AIRLINES - SINGAPORE - 735m<sup>2</sup> - PU indoor sports flooring**

**-AL DAJAN COMPANY - GASIM, KSA - 722 m<sup>2</sup> - Polyurethane sports flooring/Tennis court**

**-SELECTIVE GOVERNMENT HIGH SCHOOL - EGYPT - 720m<sup>2</sup>, Outdoor sports flooring**

**-INDIAN AIR FORCE - AHMEDABAD, INDIA - 720m<sup>2</sup> - Acrylic sports courts**

**-FITNESS TIME - FAYSALIA, DAMMAM, KSA - 700 m<sup>2</sup>-PU indoor multipurpose sports flooring/running track**

**-FITNESS TIME YASMEEN - RIYADH, KSA - 700 m<sup>2</sup> - PU indoor multipurpose sports flooring/running track**

**-FERRARI WORLD - ABU DHABI, UAE - 700m<sup>2</sup> - Playground flooring**

**-FITNESS TIME JUNIOR - RIYADH, KSA - 700 m<sup>2</sup> - PU indoor multipurpose sports flooring/running track**

**-FITNESS TIME - OLAYA RIYADH, KSA - 700 m<sup>2</sup> - PU indoor multipurpose sports flooring/ running track**

**-FITNESS TIME WAHA - RIYADH, KSA - 700 m<sup>2</sup> - PU indoor multipurpose sports flooring/running track**

**-FITNESS TIME, NOOR BRANCH - DAMMAM, KSA -700 m<sup>2</sup> - PU indoor sports flooring and running track**

**-FITNESS TIME, ALAMEEN BRANCH - DAMMAM, KSA - 700 m<sup>2</sup> - PU indoor sports flooring and running track**

**-FITNESS TIME, PLUS RIYADH - RIYADH, KSA - 700 m<sup>2</sup> - PU indoor sports flooring and running track**

**-FITNESS TIME, SALAMA BRANCH BRO & FITNESS - JEDDAH, KSA - 700 m<sup>2</sup> - PU indoor sports flooring**

**-FITNESS TIME, 40th BRANCH - JEDDAH, KSA - 700 m<sup>2</sup> - PU indoor sports flooring and running track**

**-NASR CLUB- EGYPT - 700m<sup>2</sup>, Multipurpose court, POLYFLEX WET-POUR system**

**-HUREL DOUBLE 3 - RAS AL KHAIMH, KSA - 700 m<sup>2</sup> - Shockpad plus acrylic coatings**

**-THE SUSTAINABLE CITY - DUBAI, U.A.E - 700 m<sup>2</sup> - Acrylic flooring**

**-EMAAR - EMIRATES HILLS 2 - DUBAI, U.A.E - 700m<sup>2</sup> - Basketball court, Acrylic flooring**

**-AIRFORCE SURBOTO PARK - NEW DELHI, INDIA - 680 m<sup>2</sup> - Polyurethane outdoor sports flooring**

**-INDIAN ARMY - DHRANGDHARA, INDIA - 670m<sup>2</sup> - Acrylic sports courts**

**-MT.SAINT PATRICK ACADEMY - INDIA - 665m<sup>2</sup>- Acrylic sports courts**

**-REGIONAL HQ AT BURAIMI - OMAN - 650 m<sup>2</sup> - Colorflex, PU sport flooring**

**-ROYAL OMAN POLICE TASK FORCE RUSTAQ - OMAN - 650 m<sup>2</sup> - Colorflex, PU sport flooring**

**-ROYAL OMAN POLICE TASK FORCE LIWA - OMAN - 650 m<sup>2</sup> - Colorflex, PU sport flooring**

**-ROYAL OMAN POLICE TASK FORCE AL SALIL - OMAN - 650 m<sup>2</sup> - Colorflex, PU sport flooring**

**-ROYAL OMAN POLICE TASK FORCE IBRI - OMAN - 650 m<sup>2</sup> - Colorflex, PU sport flooring**

-ROYAL OMAN POLICE TASK FORCE IBRA - OMAN - 650 m<sup>2</sup> - Colorflex, PU sport flooring  
-ROYAL OMAN POLICE TASK FORCE AL SUR - OMAN - 650 m<sup>2</sup> - Colorflex, PU sport flooring  
-ROYAL OMAN POLICE TASK FORCE AL DUKUM - OMAN - 650 m<sup>2</sup> - Colorflex, PU sport flooring  
-ROYAL OMAN POLICE TASK FORCE AL BURAIMI - OMAN - 650 m<sup>2</sup> - Colorflex, PU sport flooring  
-ROYAL OMAN POLICE TASK FORCE AL NIZWA - OMAN - 650 m<sup>2</sup> - Colorflex, PU sport flooring  
-ROYAL OMAN POLICE TASK FORCE AL SUWAIQ - OMAN - 650 m<sup>2</sup> - Colorflex, PU sport flooring  
-ABU DHABI MUNICIPALITY - ABU DHABI , UAE - 650 m<sup>2</sup> - Acrylic flooring  
-ROYAL OMAN POLICE TASK FORCE AL SALALAH - OMAN - 650 m<sup>2</sup> - Colorflex, PU sport flooring  
-ROYAL OMAN POLICE TASK FORCE AL BARKHA - OMAN - 650 m<sup>2</sup> - Colorflex, PU sport flooring  
-ROYAL OMAN POLICE TASK FORCE KHOUDH - OMAN - 650 m<sup>2</sup> - Colorflex, PU sport flooring  
-MOHAMMED JASSIM M AL THANI SCHOOL - UMSALALALI, QATAR - 620 m<sup>2</sup> - PU outdoor sport flooring  
-QATAR GEMS SCHOOL - DOHA, QATAR - 615 m<sup>2</sup> - Polyurethane sports flooring  
-VAISHNO DEVI - DELHI, INDIA - 608 m<sup>2</sup> - Polyurethane outdoor sports flooring  
-INDIAN ARMY - AGRA, INDIA - 600m<sup>2</sup>- Acrylic sports courts  
-THE INTERNATIONAL SCHOOL - AGRA, INDIA - 600m<sup>2</sup>- Acrylic sports courts  
-INDIAN ARMY - JHANSI, INDIA - 600m<sup>2</sup>- Acrylic sports courts  
-THE SUSTAINABLE CITY - DUBAI, U.A.E - 600 m<sup>2</sup> - Safepol system  
-AMITY SCHOOL, JUMEIRAH ISLAND - DUBAI, UAE - 600 m<sup>2</sup> - Safepol system  
-OUR OWN ENGLISH HIGH SCHOOL - SHARJAH, U.A.E - 600 m<sup>2</sup> - Flexfloor system  
-OUR OWN ENGLISH HIGH SCHOOL - SHARJAH, U.A.E - 600 m<sup>2</sup> - Polyflex Ael-EX system  
-NEW DUBAI BRADENTON SCHOOL- DUBAI, UAE - 570 m<sup>2</sup> - Acrylic sports courts  
-DUBAI SILICON OSIS-CENTRAL PARK, DSO - DUBAI, UAE - 560 m<sup>2</sup> - Jogging track  
-MPS WORLD SCHOOL - AGRA, INDIA - 560m<sup>2</sup>- Acrylic sports courts  
-AL WUKAIR GIRLS SCHOOL - AL WAKRAH, QATAR - 550 m<sup>2</sup> - Polyurethane, outdoor sport flooring  
-BBPS - DELHI, INDIA - 512 m<sup>2</sup> - Polyurethane outdoor sports flooring  
-IVY STATE - PUNE, INDIA - 511m<sup>2</sup>- Acrylic sports courts  
-KUNAL ICONIA - INDIA - 510m<sup>2</sup>- Acrylic sports courts  
-AMERICAN SCHOOL OF DUBAI - DUBAI, UAE - Acrylic sports courts  
-ETIHAD MUSEUM - JUMEIRAH, DUBAI, UAE - Rubber flooring  
-CARPARKING - ABU DHABI, UAE - Acrylic flooring  
-DUBAI MILLENIUM SCHOOL - QUSAIS, UAE - Acrylic sports courts  
-AMERICAN UNIVERSITY - DUBAI, UAE – Acrylic outdoor sports flooring  
-RAK ACADEMY - RAK, UAE - Acrylic flooring  
-ISCS - SHARJA, UAE - Acrylic flooring  
-THE INTERNATIONAL SCHOOL OF CHOUEIFAT - AJMAN, U.A.E - Sportground-Ex system  
-THE KINDER GARDEN STARTERS - DUBAI, U.A.E - Safepol system  
-AL ZAHIA PROJECT - SHARJA, UAE - Safepol system  
-WADY DEGLA SHERATON CLUB - CAIRO, EGYPT - Acrylic sports flooring  
-GEMS WELLINGTON SCHOOL - DUBAI, U.A.E - Safepol system  
-JUMEIRAH RETAIL DEVELOPMENT - JUMEIRAH, DUBAI, UAE - Safety rubber flooring  
-MR.ABDULRHMIN - JUBAIL, KSA - Rubber playground  
-GEMS WESTMINISTER SCHOOL - DUBAI, U.A.E - Safepol system  
-POLYURETHANE INDOOR SPORTS COURT - TIRANA, ALBANIA - Polyflex PU-In system  
-MULTIPURPOSE COURTS - ODESSA, UKRAINE - Rubber flooring

**-MULTIPURPOSE COURTS - ZHOVKVA, UKRAINE - Rubber flooring**

**-MUNICIPAL TENNIS CLUB - PATRA, GREECE - Flexfloor-EX system, Acrylic sports courts**

**-INDIAN AIR FORCE - GORAKHPUR, INDIA - Acrylic sports courts**

**-INDIAN AIR FORCE - BAREILLY, INDIA - Acrylic sports courts**

**-INDIAN ARMY - BABINA, INDIA - Acrylic sports courts**

**-ADAM AIRBASE PACKAGE 8, OMAN - Colorflex, PU sport flooring**

**-GOLD GYM - KOLKATTA, INDIA - Polyurethane indoor sports flooring**

**-MINISTRY OF FOREIGN AFFAIRS - ABU DHABI, UAE - Polyurethane flooring**

**-SHRJAH SPORTS CLUB - SHARJAH, UAE - Polyurethane flooring**

**-GEMS WINCHESTER SCHOOL - AL BARSHA SOUTH, UAE - Acrylic sports system**

**-HOTEL DOUBLE 3 - RAS AL KHAIMAH, UAE - Prefabricated shock-pad 4mm plus acrylic coatings**

**-AL WAHDA CLUB - ABU DHABI, UAE - Rubber flooring**

**-ADJD MAIN BUILDING LANDSCAPE PROJECT - ABU DHABI, UAE - Rubber flooring**

**-KADEEJ AL KURBA SCHOOL - ABU DHABI, UAE - Rubber flooring**

**-INTERNATIONAL SCHOOL OF CREATIVE SCIENCE - SHARJA, U.A.E - Flexfloor system/Outdoor Multipurpose court**

**-ENVIRO, VATIKA HOTELS PVT.LTD - GURGAON, INDIA - Acrylic sports flooring**

**-ASHIANA - BHUBANESHWAR, INDIA - Acrylic sports flooring**

**-TCS, ADIBATLA - HYDERABAD, INDIA - Acrylic sports flooring**

**-IPS, ERODE - CHENNAI, INDIA - Acrylic sports flooring**

**-LIONS GATE - MUMBAI, INDIA - Acrylic sports flooring**

**-MORNING GLORY INFRA LIMITED - KANPUR, INDIA - Acrylic sports flooring**

**-NAMBIAR - BANGALORE, INDIA - Acrylic sports flooring**

**-PATHWAYS - GURGAON, INDIA - Acrylic sports flooring**

**-WELHAMS GIRLS SCHOOL - DEHRADUN, INDIA - Acrylic sports flooring**

**-WOODDUCK COMMERCIAL CENTER- IRAN - Industrial flooring**

**-ARABIAN RANCHES by EMAR - DUBAI, U.A.E - Playground flooring**

**-OUR OWN ENGLISH HIGH SCHOOL - SHARJAH, U.A.E - Playground flooring**

**-NORTH LONDON COLLEGIATE SCHOOL - DUBAI, U.A.E - Playground flooring**

**-RAK MODERN SCHOOL - RAS AL KHAIMAH, U.A.E - Playground flooring**

**-GIIS/GLOBAL INDIAN INTERNATIONAL SCHOOL - RAS AL KHAIMAH, U.A.E - Playground flooring**

**-MINISTRY OF EDUCATION, NAD AL HAMAR BOYS SCHOOL - DUBAI, U.A.E - Playground flooring**

**-K.G. KIDS SCHOOL - AALI, BAHRAIN - Playground flooring**

**-SABIC BEACH CAMPS PROJECT - JUBAIL, K.S.A - Outdoor sports flooring, artificial grass.**

**-MINISTRY OF EDUCATION, MIZHER GIRLS SCHOOL - DUBAI, U.A.E - Playground flooring**

**-AL SHIMAL PARK - DOHA, QATAR - Playground flooring**

**-UM SELAL PARK - DOHA, QATAR - Playground flooring**

**-AL KABAN PARK - DOHA, QATAR - Playground flooring**

**-GEMS METROPOLE SCHOOL - DUBAI, U.A.E - Hard court system/Outdoor Multipurpose court**

**-ARABIAN RANCHES by EMAR - DUBAI, U.A.E - Acrylic Outdoor Tennis and Basketball courts**

**-RAK MODERN SCHOOL - RAS AL KHAIMAH, U.A.E - Flexfloor system**

**-GIIS/GLOBAL INDIAN INTERNATIONAL SCHOOL - RAS AL KHAIMAH, U.A.E - Acrylic system**

**-AVALON HEIGHTS - AJMAN, U.A.E - Acrylic floorings**

**-DELHI PRIVATE SCHOOL - DUBAI, U.A.E - Acrylic flooring**

**-ROYAL COMMISSION SCHOOL - JUBALI, KSA - Acrylic sports flooring**



**-FITNESS TIME PRO - AL AHSA BRANCH - KSA - Flexfloor, Basketball court**  
**-FITNESS TIME PRO - MAKKAH SHARAIE - KSA - Flexfloor, Basketball court**  
**-BIN HAM - AL AIN, UAE - Polyurethane flooring**  
**-SHAMMA BINT MOHAMMED SHOOL - AL AIN, UAE - Polyurethane flooring**  
**-ABDULLAH BIN OTAIBA - ABU DHABI, UAE - Polyurethane flooring**  
**-LIWA INTERNATIONAL SCHOOL - AL AIN, U.A.E - Colorflex outdoor sport system.**  
**-ZOHOUR KG - MANAMA, BAHRAIN - Polyurethane sports flooring**  
**-RAWDA RASHED - QATAR- Polyurethane, outdoor sport flooring**  
**-SAAD BIN ABI WAQAS SCHOOL - AL RAYYAN, QATAR - Polyurethane, outdoor sport flooring**  
**-FITNESS TIME PRO - MADINS RING ROAD BRANCH - KSA - Flexfloor, Basketball court**  
**-AGRA CHAIN - AGRA, INDIA - Acrylic sports flooring**  
**-SUNWORLD - NOIDA, INDIA - Acrylic sports flooring**  
**-SSN INVESTMENTS PRIVATE LIMITED, FRIENDS COLONY - DELHI, INDIA - Acrylic sports flooring**  
**-AJNARA - NOIDA, INDIA - Acrylic sports flooring**  
**-BRIGHT RIDERS SCHOOL - ABU DHABI, UAE - Running track, Acrylic sports court**  
**-OUR OWN ENGLISH HIGH SCHOOL - SHARJAH, U.A.E - Poltrack Spaycoat system**  
**-NCC - JAIS, INDIA - Acrylic sports flooring**  
**-ALPHA FOUNDATION FOR EDUCATION & RESEARCH - TRICHIRAPALLI, INDIA - Acrylic sports flooring**  
**-PUSHPANJALI FARMS - NEW DELHI, INDIA - Acrylic sports flooring**  
**-M3M - MERLIN GURGAON, INDIA - Acrylic sports flooring**  
**-FOOT COURT - EGYPT - Running track, POLTRACK SPRAYCOAT system**  
**-FITNESS TIME ANDALUS BRANCH - JEDDAH, K.S.A - Acrylic sports flooring, FLEXFLOOR SYSTEM**  
**-ST.JOSEPHS WOMENS COLLEGE - ALLEPPEY, KERALA, INDIA - Polyurethane outdoor sports flooring**  
**-WADY DEGLA LOTUS PROJECT - CAIRO, EGYPT - Acrylic sports flooring**  
**-RAILWAY SPORTS GROUND - GUNTAKAL, ANDRA PRADESH, INDIA - Acrylic sports flooring**

# PHOTOGRAPHS OF PROJECTS



# INDOOR SPORTS FLOORING

## POLYFLEX AEL-IN

Indoor highly flexible shock-absorbent, acrylic sports flooring system, ideal for multipurpose halls, gym floors, tennis, basketball, volleyball, handball, futsal courts (shoes without spikes), as well as any other indoor sports court.

Combination of prefabricated shock-pads with coatings in average total thickness of 8-14mm.



### Steps:

**1. PU FLEX 140 - Special, polyurethane, two component, adhesive.**

It is applied, with V-notch trowel, on dry waterproof surfaces of concrete without rising humidity issues or asphalt. Used for the application of **ISOPOL 854** shock-pads or other prefabricated shock-absorbent rolls made from recycled rubber or EPDM.

**2. ISOPOL 854 - Shock-pad in rolls.**

Elastic, prefabricated shock-pad made of recycled rubber providing shock-absorbency, in thickness of 4mm up to 12mm. Used as cushion substrate before the application of polyurethane or acrylic systems.

**3. ELASTOTURF 851S - Acrylic, elastic, smooth, coating for sports floors systems.**

Consists of acrylic resins, powder quartz sand and special improver. It is combined with **ISOPOL 854** as substrate to create multi-purpose sports flooring systems. Highly resistant to adverse weather conditions (snow, frost, heat waves etc.) after drying. Applied by squeegee.

**4. POLYSPORT 952 - Polyurethane, aliphatic, two-component top coating for indoor sport floorings.**

Applied, in two crossing layers by airless sprayer or short haired mohair roller.

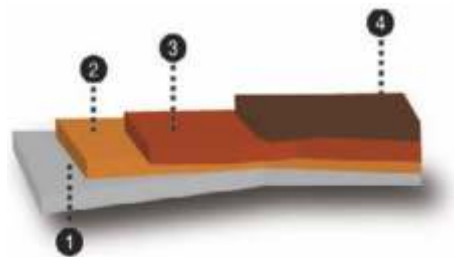

Description	Consumption
PU FLEX140 - Special, polyurethane, two-component adhesive.	1kg/m <sup>2</sup> for 1 layer
ISOPOL 854 - Shock-pad in rolls.	
ELASTOTURF 851S - Acrylic, elastic, smooth coating for sports floors systems.	2.2-2.5kg/m <sup>2</sup> for 3 layers
POLYSPORT 952 - Polyurethane, aliphatic, two-component top coating for indoor sport floorings.	0.35kg/m <sup>2</sup> for 2 layers

**SYSTEM POLYFLEX AEL – IN**  
**Total thickness of 8mm – 14mm**

---



Indoor highly flexible shock-absorbent, acrylic sports flooring system, ideal for multipurpose halls, gym floors, tennis, basketball, volleyball, handball, futsal courts (shoes without spikes), as well as any other indoor sports court. Combination of prefabricated shock-pads with coatings in average total thickness of 8-14mm.

**Steps :**

1. **PU FLEX 140 - Special, polyurethane, two component, adhesive.** Applied with V-notch trowel.
2. **ISOPOL 854 - Shock-pad in rolls.**
3. **ELASTOTURF 851S - Acrylic, elastic, smooth, coating for sports floors systems.**  
Applied by squeegee.
4. **POLYSPORT 952 - Polyurethane, aliphatic, two-component top coating for indoor sport floorings.** Applied, in two crossing layers by airless sprayer or short-haired mohair roller.

**Preparation – Application**

**Applied only on dry asphalt and waterproof concrete surfaces (over 40 days old from date of placement) without rising humidity issues and free of materials that might prevent bonding e.g. dust, loose particles, grease etc.** The success in the application depends on the right preparation of the underlay and use of the material.

- **Good, dry** cleaning of the surface from dust and residues with vacuum cleaner and squeegees.
- Application of polyurethane glue, **PU FLEX 140**, with V-notch trowel with 2mm teeth. Consumption: 1kg/m<sup>2</sup>.
- Place the **ISOPOL 854** rolls on the floor in their final positions without gluing them. Lift each side of each roll and apply the PU glue by a V-notch trowel with 2mm teeth and then glue the rolls immediately without waiting. In case there are small bulges (humps, swollen parts) on the roll after its application, you'll have to tear it around the edge of the hump without removing it completely, raise that small part, put some PU glue underneath and glue the hump part again, making sure this time it's flat. Weights such as sand bags have to be used on the edges, corners and seams

of the shock absorbent roll surface installation until the PU glue is cured. Then you let everything dry. Do not overlap the rolls but bring them as close together as possible to eliminate gaps. The usage of a light cylinder (10-15kg maximum) will help to compact the rolls on the floor. It is recommended that the joints (only) are covered flush with ELASTOTURF 851 or PU FLEX 140 with a flat trowel (or a brush) along their whole length, so that the surface is leveled out. Next day the joints are ground lightly with sandpaper or other grinding device to smooth out the joints with the rest of the surface and create the required roughness.

- Depending on ambient temperature **ELASTOTURF 851S** is diluted with 2% water, prior to application, in order to achieve better fluidity. It is applied in two or three coatings by squeegee, depending on the desired thickness. The next layer follows the other after the previous starts to dry. Consumption : 2,2 - 2,5 kg/m<sup>2</sup> (three layers)
- The next day, depending ambient temperature follows application of finishing paint **POLYSPORT 952** in 2 crossing layers by a short-haired mohair roller or even better by airless sprayer. Consumption: 0,35 kg per square meter in 2 layers.

### Important Remarks

- During temperatures over 40 degrees, ideal time for the application of **POLYFLEX AEL-IN SYSTEM** is between 22:00 and 09:00 and the minimum bearing temperature during application and drying should be over 10°C.
- In case the second layer of PU top coat is applied after more than 24 hours of the application of the first one then the whole surface must be sanded by a special sanding machine. After that the second layer can be applied.
- The freshly coated surface should be protected from high temperatures, wind, rain and frost for at least the first 24 hours.
- In case it gets damaged, it is simply repaired and recoated on the spot.

### Substrate

**Asphalt is the safer subfloor for sport floorings for sure and must be always preferred than concrete surfaces.**

#### **A. Asphalt Substrate**

**The asphalt must have a slope of 0.7-1% and must dry for at least 30 days so that all solvents from the asphalt can evaporate.**

The asphalt sub-floor should be applied on well compacted 150mm road base sub-floor and asphalt should be laid in one layer (and not 2) in 6 to 8cm with fine and coarse aggregates (up to 15mm granulometry) like the kind of asphalt used in road construction.

So, new road-grade asphalt will have to be laid (minimum 60mm) in one layer containing coarse aggregates and then mature for 30 days at least, before any application takes place on top of the asphalt to avoid bubbles on the final layer of the sport or rubber floorings.



## Asphalt Infrastructure

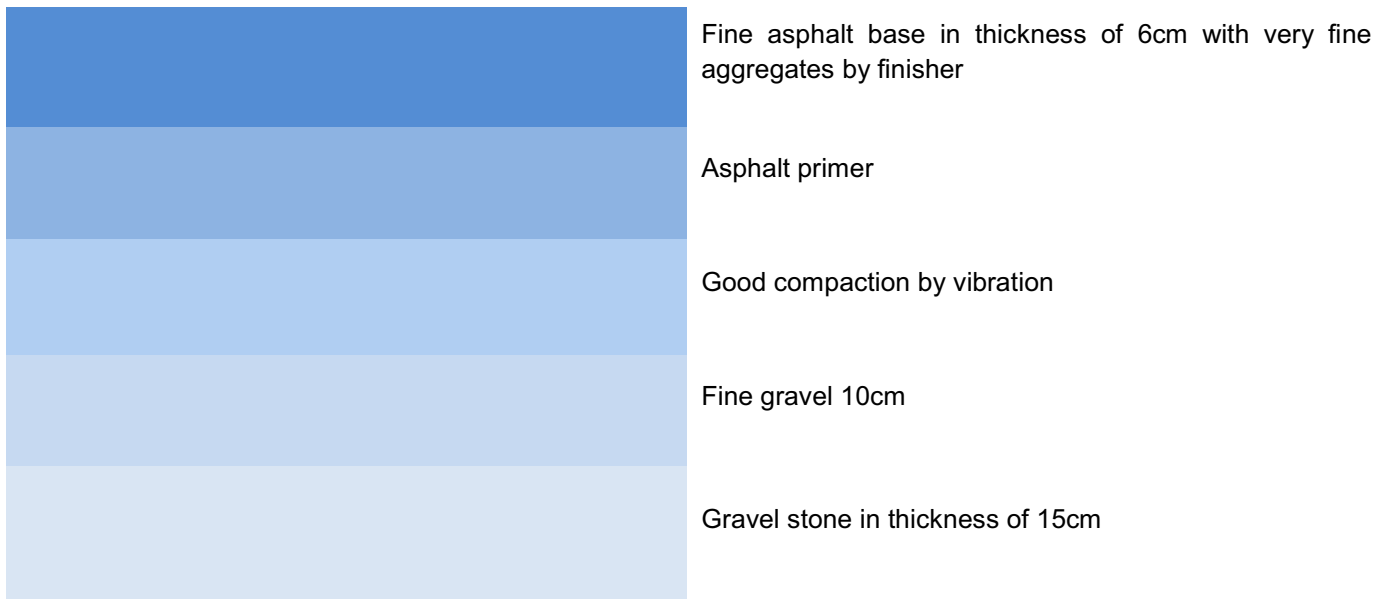

### B. Concrete Surface

**Concrete surface must be power-trowelled without cracks and must be smooth with a slope of 0.7-1% and humidity under 4% in 10cm depth of concrete.**

Concrete must also be **dry at least for 40 days** and then the application takes place if there is no rising humidity for the sub-floor. Before the application takes place, there must be proper grinding of the surface by a grinding machine to open the pores accordingly and also a measurement by special instrument to measure humidity on the surface and in 10cm under the surface.

Generally concrete is a risky sub-floor and there may be problems with rising humidity, especially in areas where the sea level is really high and when the sea is close or in areas near greenery.

**Always make expansion joints in large areas of concrete, in order to avoid uncontrollable cracks and failures.** Joints should be every 25 square meters creating a grid of 5x5 meters or close to that.

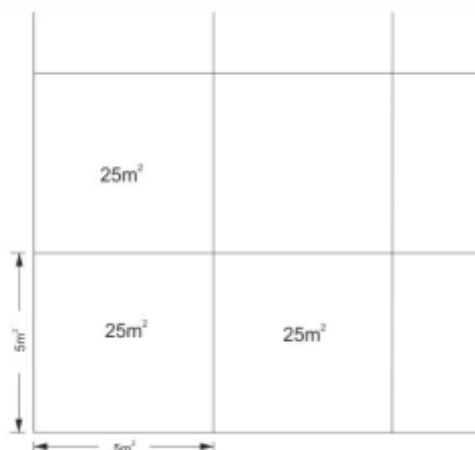

<b><u>SUBSTRATE REQUIREMENTS</u></b>	Concrete quality	at least C20/25
	Age:	at least 40 days
	Moisture content:	below 4%

**Tools:**



**Colors:** Following colorchart.



The colors may vary slightly from the original due to digital representation.



The colors may vary slightly from the original due to digital representation.

# PU FLEX 140

## SPECIAL PU GLUE FOR THE APPLICATION OF PREFABRICATED SHOCK ABSORBENT ROLLS

### GENERAL CHARACTERISTICS

**PU FLEX 140** is a two component, adhesive for the application of prefabricated shock-absorbent rolls made of recycled rubber or from EPDM granules and also for safety tiles.

- It is applied on dry, sealed surfaces of mosaic, concrete or asphalt.
- Suitable for interior and exterior use.
- Provides good filling properties.
- Non shrinking.

### TECHNICAL DATA

Mixing ratio:	93.33 : 6.67 (By weight)
Density (25°C):	1.80-1.90 kg/lit
Viscosity	15.000-26.000 mPas
Pot-life (25°C):	20-30 min.
Application temperature:	Min 10°C
Curing (25°C and %60 relative humidity):	6 - 9 hours
Color and odor:	Beige

### PREPARATION-APPLICATION

**Applied only on dry, level surfaces. Protected from arising humidity and free of materials that might prevent bonding e.g. dust, loose particles, grease etc.** The success in the application depends on the right preparation of the underlay and use of the material.

- **Good, dry** cleaning of the surface from dust and residues using brushes and air spray.
- Good mixing of components A (resin) & B (hardener) packed into separate containers in fixed weight proportions. Mixing should be performed using a 300-600 rpm mixer for 2-3 min until a uniform mass is obtained. Stirring of the mixture should be performed thoroughly near the sides and bottom of the container in order to achieve uniform dispersion of the hardener.
- The mixed adhesive **PU FLEX 140** is applied under each roll using a V notched trowel (2mm), as soon as possible in order to avoid any problems with the limited pot life. A roller should be used on the top of the shock absorbent rolls within an hour after the adhesive has been mixed.
- Light foot traffic is permitted after 6 hours. Full curing needs 2 days.

### CONSUMPTION

1 – 1.5 kg/m<sup>2</sup> depending on the sub-floor and type of floor covering.

### APPLICATION TOOLS

V - Notched trowels (2mm). Tools should be cleaned with **PU SOLVENT** immediately after use.

### PACKAGING

Supplied in set of 24 Kg.



---

## **STORAGE**

One year in unopened containers in dry places with minimum temperature 5°C and maximum temperature 30°C (avoid sunlight).

---

## **REMARKS**

- Working time of **PU FLEX 140** decreases when ambient temperature rises.
  - Avoid application of **PU FLEX 140** during rain, moist or foggy weather.
  - Prolonged storage of partially used containers containing **PU FLEX 140** must be avoided as contact with atmospheric moisture will result in skinning and clouding of the product.
  - When laying flooring over an underfloor heating system, caution must be taken so that the heating system is left in full operation for at least 8-10 days before the application. The screed must be dry prior application. Before laying, however, the heating system must be switched off or reduced, so that a surface temperature of 20-22 °C is not exceeded.
- 

## **CAUTION**

The application must take place in well-aired places using protective gloves. Skin or eye contact must be avoided, otherwise wash carefully with soap and water.

**For more information consult the safety data sheet.**

---

The information given here is true, represents our best knowledge and is based not only on laboratory work, but also on field experience. However, because of numerous factors affecting results we offer this information without any guarantee and no patent liability is assumed. For additional information or questions, contact the technical department of KDF LTD.

# ISOPOL 854

## SHOCK ABSORBENT UNDERFLOOR

### GENERAL CHARACTERISTICS

Elastic, prefabricated roll made of polymerically bound recycled rubber particles for shock-absorbency, in thickness of 3mm up to 14mm. It is covered with the acrylic coating **ELASTOTURF 851** or self-leveling PU coating, in thickness of 2mm, for the creation of athletic floorings for interior & exterior surfaces like basketball, volleyball, handball, football and tennis courts as well as for playgrounds. The point elastic sport surface possess good elasticity and force reduction characteristics as well as fulfilling a protective function for the athletes' joints and muscles. Its special cushion properties are indeed recommended for multipurpose.

**Suitable for external & internal courts with acrylic top coatings, internal halls with PU top coating, gyms, cross-fit areas and generally areas which need elastic flooring. Ideal also as sub-floor for athletic tracks.**

- Offers noise abatement
- Slip resistant
- Fire resistant
- Environmentally friendly
- Flexible
- Resistant against moisture, heat and mildew
- Easy application

---

### PREPARATION-APPLICATION

The sub-surface on which the material will be installed must be completely dry and clear of all foreign matter and free of dust, dirt, oil or any kind of spills.

The material surface will follow the contours of the sub-surface, which it covers. The smoother the sub-surface, the better the shock-absorbent material surfacing finishes.

Place the **ISOPOL 854** rolls on the floor in their final positions without gluing them. Lift each side of each roll and apply the PU glue by a V-notch trowel with 2mm teeth and then glue the rolls immediately without waiting.

In case there are small bulges (humps, swollen parts) on the roll after its application, you'll have to tear it around the edge of the hump without removing it completely, raise that small part, put some PU glue underneath and glue the hump part again, making sure this time it's flat. Weights such as sand bags have to be used on the edges, corners and seams of the shock absorbent roll surface installation until the PU glue is cured. Then you let everything dry.

Do not overlap the rolls but bring them as close together as possible to eliminate gaps. The usage of a light cylinder (10-15kg maximum) will help to compact the rolls on the floor.

It is recommended that the joints (only) are covered flush with ELASTOTURF 851 or PU FLEX 140 with a flat trowel (or a brush) along their whole length, so that the surface is leveled out. Next day the joints are ground lightly with sandpaper or other grinding device to smooth out the joints with the rest of the surface and create the required roughness.

---

### COLOR

Black.

---

---

**SURFACE**

Fine tuned granules structure.

---

**DIMENSIONS**

Rolls Width : 1050mm, 1250mm or 2100mm  $\pm$  1.5%

Rolls Length according to demand.

---

**THICKNESS**

4- 14mm  $\pm$  0.3mm

---

**DENSITY**

730 kg/m<sup>3</sup>  $\pm$  5%

---

**TECHNICAL DATA**

Tensile strength: approx.0,56 MPa at 7mm: approx. 0,65 MPa at 10mm (DIN EN ISO 1978)

Elongation at break: approx.57% at 7mm: approx. 60% at 10mm (DIN EN ISO 1978)

Force reduction\*: 8 mm Isopol 25 %

10 mm Isopol 30 %

(Value for mats only, not on complete floor)

Vertical deformation\*: 1,2 mm at 8 mm Isopol

\*Values measured on a sport hall system sample.

---

The information given here is true, represents our best knowledge and is based not only on laboratory work, but also on field experience. However, because of numerous factors affecting results we offer this information without any guarantee and no patent liability is assumed. For additional information or questions, contact the technical department of KDF LTD.

# ELASTOTURF 851S - SMOOTH

SPECIAL, ELASTIC, SMOOTH COATING FOR INTERNAL SPORT COURTS

## GENERAL CHARACTERISTICS

**ELASTOTURF 851S** is acrylic-based, elastic, smooth colored coating for internal sport courts.

Is combined with prefabricated shock- pad roll in thickness of 4mm to 14 mm or a wet-pour mixture of **SBR granunles** (0.5 – 2.0 mm granulometry) **plus PU BINDER** in order to seal the pores and plasticize the floor.

- Ideal for multipurpose courts, basketball, volleyball, handball, football and tennis internal courts. Suitable for sports centers, schools, fitness centers, hallways.
- Applied easily, having low cost.
- Provides a safe, high quality game.

## TECHNICAL DATA

Basis:	one-component acrylic resin
Appearance:	viscous liquid
Colors:	available in 24 colors form KDF colorchart
Temperature for the application and drying of the material:	10 – 40 °C
Viscosity:	22.000 – 32.000 mPa s at 25°C
Density	1.70 – 1.80 Kg/Lt
Walkability:	after 24 hours at 25°C
Total Hardening:	5 days at 25°C

## PREPARATION-APPLICATION

**Applied only on dry surfaces, without rising humidity issues and free of materials that might prevent bonding e.g. dust, loose particles, grease etc.** The success in the application depends on the right preparation of the underlay and use of the material.

- **Good, dry** cleaning of the surface from dust and residues with vacuum cleaner and squeegees.
- Application of the material (in three or more layers) on prefabricated shock-absorbent rolls in thickness of 4mm to 14mm or on wet-pour made from the mixture of **RECYCLED RUBBER 858 (0.5 -2.0 mm granulometry)** and **PU BINDER 1118** (in three or more layers), for sealing the pores of the underlay and plasticize the surface.
- Depending on the ambient temperature, **ELASTOTURF 851S** is diluted with 2-3% water, prior to application, in order to achieve better fluidity. The next layer is applied after the previous starts to dry.
- Before the application of the second layer and after the application of the final layer (before applying **TOP COAT POLYSPORT 952**), always use a sanding machine.
- The next day, depending on the ambient temperature follows the application of **TOP COAT POLYSPORT 952** in 2 crossing layers by a short-haired mohair roller or even better by airless sprayer.

---

## CONSUMPTION

- 2.2 – 2.5 kg/m<sup>2</sup> (three layers on shock-pad)
  - 3.5 – 3.8 kg/m<sup>2</sup> (three layers on wet-pour shock-pad)
- 

## APPLICATION TOOLS

Squeegee. Tools should be cleaned with **WATER** immediately after use.

---

## PACKAGING

Supplied in barrels of 200 Kg.

---

## STORAGE

12 months in unopened containers in dry places with minimum temperature 5°C and high temperature 30°C (avoid sunlight).

---

## REMARKS

- During temperatures over 38 C, ideal time for the application of **ELASTOTURF 851S** is between 22:00-9:00 a.m. and the minimum bearing temperature during application and drying should be 10 C.
  - The freshly coated surface should be protected from high temperatures and frost for at least the first 24 hours.
  - In case it gets damaged, it is simply repaired and recoated on the spot.
- 

## CAUTION

The application must take place in well-aired places using protective gloves. Skin or eye contact must be avoided, otherwise wash carefully with soap and water.

**For more information consult the safety data sheet.**

---

The information given here is true, represents our best knowledge and is based not only on laboratory work, but also on field experience. However, because of numerous factors affecting results we offer this information without any guarantee and no patent liability is assumed. For additional information or questions, contact the technical department of KDF LTD.



# POLYSPORT 952-SEMIMAT

POLYURETHANE-BASED, TWO-COMPONENT, SEMIMAT, FINISH ALIPHATIC COATING

## GENERAL CHARACTERISTICS

**POLYSPORT 952-SEMIMAT** is a polyurethane, two-component, solvent-based, semi-mat, finish aliphatic coating for indoor sports surfaces.

- It is applied on polyurethane, self-leveling coating **POLYSPORT PU 951** as a final, sealing layer of a multilayer polyurethane floor especially designed for sport halls such as tennis, basketball, handball, volleyball and multipurpose halls.
- Applies easily with short-haired mohair roller and airless sprayer.
- Provides a surface with anti-slip properties.

## TECHNICAL DATA

Basis:	two-component polyurethane paint
Appearance:	liquid
Colors:	KDF colorchart
Viscosity(25 <sup>0</sup> C):	1000-3500 mPas
Density(25 <sup>0</sup> C):	1.38-1.48 kg/lt
Mixing proportion (A:B):	85:15 by weight
Temperature for the application and drying of the material:	15 – 40°C

## PREPARATION-APPLICATION

**Applied on dry surfaces without rising humidity issues, free of materials that might prevent bonding e.g. dust, loose particles, grease etc (in case of asphalt or concrete).** The success in the application depends on the right preparation of the underlay and use of the material.

- **Good, dry** cleaning of the surface from dust and residues using vacuum cleaner and squeegees.
- Caution must be taken so that temperature of the support surface as well as ambient air remains above 15°C during application and curing of the materials while relative humidity does not exceed 75%.
- Application of prefabricated sub-floor **ISOPOL 854** using **PU FLEX 140** or wet-pour rubber cushion mix of SBR rubber and **PU BINDER 1118**.
- Sealing of surface porosity of **ISOPOL 854** or the wet-pour rubber cushion mix of SBR rubber and **PU BINDER 1118** using elastic pore sealer **POLYSPORT STUCCO 950** and application of self-leveling coating **POLYSPORT PU 951**.
- The next day, depending on the ambient temperature follows the application of **POLYSPORT 952-SEMIMAT** in two crossed layers. The second layer is applied after the first layer has dried (within 24h). Components A & B (hardener) packed into separate containers in fixed weight proportions are mixed together using a low revolution mixer (300-600 rpm) for 1-2 min. Stirring of the mixture should be performed thoroughly near the sides and bottom of the container in order to achieve uniform dispersion of the hardener.
- The application is done by airless sprayer or short-haired mohair roller in 2 crossing layers.

## CONSUMPTION

App.200-250 gr/m<sup>2</sup>, for two layers.

---

## **APPLICATION TOOLS**

Short-haired mohair paint roller or airless sprayer. Tools should be cleaned with **PU SOLVENT** immediately after use.

---

## **PACKAGING**

Supplied in set of 20 Kg (two drums).

---

## **STORAGE**

12 months in unopened containers in dry places with minimum temperature 5°C and maximum temperature 30°C (avoid sunlight).

---

## **REMARKS**

- In case the layer of PU top coat is applied after more than 24 hours of the application of the last layer of PU pore filler then the whole surface must be sanded by a special sanding machine. After that the PU top coat can be applied.
  - In case the second layer of PU top coat is applied after more than 24 hours of the application of the first one then the whole surface must be sanded by a special sanding machine. After that the second layer can be applied.
  - Working time of **POLYSPORT 952-SEMIMAT** decreases when ambient temperature rises.
  - Prolonged storage of partially used containers containing **POLYSPORT 952-SEMIMAT** must be avoided as contact with atmospheric moisture will result in skinning and clouding of the product.
  - All surfaces should be thoroughly cleaned from dust and residues prior each application.
  - After hardening **POLYSPORT 952-SEMIMAT** is completely safe for health.
- 

## **CAUTION**

The application must take place in well-aired places using protective gloves. Skin or eye contact must be avoided, otherwise wash carefully with soap and water.

**For more information consult the safety data sheet.**

---

The information given here is true, represents our best knowledge and is based not only on laboratory work, but also on field experience. However, because of numerous factors affecting results we offer this information without any guarantee and no patent liability is assumed. For additional information or questions, contact the technical department of KDF LTD.

# **CLEANING AND MAINTENANCE MANUAL FOR :**

## **-INDOOR SYSTEMS**

### **Introduction**

Indoor sports surfaces are made of extremely durable polymers, designed to withstand intense use. However for the best maintenance of the rubber and sport surface a regular check (once in 6 months) is required and maintenance of the surface is necessary to preserve the suitability of the surface.

The installer's guarantee will usually be conditional on the recommended maintenance requirements being carried out with due diligence.

### **Maintenance**

Maintenance procedures are necessary to preserve the lifetime of the surface and to ensure that:

- The Surface is kept clean.
- The Surface is safe for intense diverse use and all types of users.
- The facility looks attractive.

These objectives are achieved by:

- Sweeping/scraping/removing debris and foreign matter from the surface.
- Regularly washing the surface to remove contaminants such as any kind of food, small stones, drinks or any other particle that can create scratches or damage.

### **Maintenance Equipment**

Meticulous (mechanical) cleaning, occasional washing and dirt/foreign matter removing are the basic maintenance measures, apart from making sure that no damage occurs due to unforeseen reasons.

A mechanical vacuum cleaner is ideal for removing foreign matter and dirt. Restricted areas may have to be cleaned by hand.

The equipment should be well maintained and carefully operated to avoid contamination of, or physical damage to, the surface. Spillage of fuel or lubricating oil will damage the surface.

The pressure loading on the surface as well as the friction and shearing loads have to be kept to a minimum to prevent damage to the surface. Large pneumatic tires and soft brushes along with careful operating of the machinery, is recommended to avoid any damage on the surface.

Note that no aggressive chemical cleaning agents (chlorine or acid-based) should be used; normal neutral market detergents are adequate.

### **Prevention of damages**

To ensure maintaining the surfaces to a high standard, restrictions should be imposed on the use of the surface.

- No chemicals, oils, fuel or solvents or many kind of drink and food should be allowed on the surface.
- No fireworks or cigarettes or high heels or inadequate shoes should be allowed on the synthetic surface .

### **Damages and renovation**

The lifetime of an indoor sports surface depends on its quality, usage and level of maintenance. In general a normal indoor sports surface used intensively will last 8 to 10 years(depending on the system) before renovation is required. Renovation should be carried out periodically to prevent the total damage of the surface, which would necessitate complete renewal.

Renovation must be carried out by professional and skilled contractors with thorough knowledge of this type of work

There are different procedures for the renovation of a surface:

- Complete renewal by replacing the worn-out surface with a new sports flooring system.
- Re-topping or sealing with adequate polyurethane or acrylic materials. In general, one could refresh the indoor sports floor by applying couple of additional layers of PU top coat after 10-12 years.
- Partial re-topping in particular worn-out areas.

Information contained in this document is of general nature and is given in good faith. As the state of the surface and the use and application of the various cleaning products, is out of our control, our advice for individual cases, verbal, written or based on tests, does not exempt the applicator from the testing the suitability of the cleaning products and their applications.

The above maintenance guide refers to the below KDF systems:

**-SYSTEM POLYFLEX PU-IN**

**-SYSTEM POLYFLEX PU-IN WET-POUR**

**-SYSTEM POLYFLEX AEL-IN**

**-SYSTEM POLYFLEX AEL-IN WET-POUR**

# CERTIFICATES OF KDF Ltd



ISO KDF Ltd



POLTRACK SPRAYCOAT



POLTRACK SANDWICH



POLYFLEX AEL-EX



FLEXFLOOR-EX



SPORTFLOOR-EX



POLTRACK EQUINE



BADMINTON POLYFLEX PU



PU GRASS 149



# CERTIFICATES OF KDF Ltd



POLYFLEX PU



SPORTGROUND-EX



POLTRACK JOGGING TRACK



FIBA POLYFLEX PU



SAFEPOL



EPDM 856



PLAYPREM

SAFEPOL SANDPROOF

POLTRACK FULL-PU