

POLTRACK SPRAYCOAT SEALED

Running track system



Synthetic outdoor system for running tracks. It is applied on fine asphalt or smooth, waterproof concrete, without rising humidity issues. Consists of a first base layer, mixed at site, a mixture of **RECYCLED RUBBER 858** in granulometry of 1-4mm and the polyurethane binder **POLAPLAST P13**, then a second layer (sealing layer) the polyurethane, pore filler, **POLYSPORT STUCCO 1050**, and of a third layer, spray coat, which consists of **EPDM 856** and the colored polyurethane binder **POLAPLAST P12**. Priming with **POLAPLAST P10** precedes the application.

Steps

1. **POLAPLAST P10 - Polyurethane primer.**
2. **Mixture of POLAPLAST P13 and RECYCLED RUBBER 858**, applied by paving machine.
3. **POLYSPORT STUCCO - Polyurethane, two-component pore filler.**
4. **Mixture of POLAPLAST P12 and the EPDM 856**, applied by spraying machine.

Preparation – Application

Applied on dry asphalt surfaces (30 days old at least) or smooth concrete surfaces (30 days at least old) without arising humidity issues and free of materials that might prevent bonding e.g. dust, loose particles etc (in case of asphalt or concrete). The success in the application depends on the right preparation of the underlay and use of the material.

KDF - Kataskeves Dapedon LTD
e : exports@kdf.gr w : www.kdf.gr

Showroom Office
19th km National Road Thessaloniki-Moudania
57001, Neo Rysio, Thessaloniki, Greece
t / f : +30 2310 829598

Accounting Office
19 Mitropoleos Str
54624, Thessaloniki, Greece



- **Good, dry cleaning** of the surface from dust and residues.
- Priming of the surface **with POLAPLAST P10** applied by airless spray or brushes. The base coat of **POLTRACK SEALED SYSTEM** should be constructed while **POLAPLAST P10** is still sticky (wet on wet procedure), within 30-60 minutes of primer application.
- **Good mixing of the POLAPLAST P13 with RECYCLED RUBBER 858**, SBR granules (1-4mm) to create a flexible shock-absorbent layer.
- The mixture is poured on the surface and spread using a suitable paving machine or other appropriate machine or a hand straightedge. If the application will be done with hand straightedge then small irregularities in the surface may be removed by rolling on the fresh surface using a metallic cylinder.
- After the surface is fully cured (depending on the temperature and humidity, the curing of the shock-pad base coat of POLTRACK will take 48-72 hours), follows the application of the sealing layer **POLYSPORT STUCCO 1050** in two crossing layers with a metal trowel. Consumption: 2kg/m².
- After the pore filler is cured (12-24 hours depending on the temperature and humidity) the top spray coating of the **POLTRACK SEALED SYSTEM** is applied in two crossing layers. The epdm granules (granulometry 0,5-1,5mm) and the **POLAPLAST P12** are mixed and applied with a suitable spraying machine.
- The two components of **POLAPLAST P12** are thoroughly mixed at site. The EPDM granules and the **POLAPLAST P12** are mixed and applied with a suitable spraying machine. Then the **TOP SPRAY COATING OF THE POLTRACK SYSTEM** is applied in two "cross hatch" layers. The curing time of the **TOP SPRAY COATING OF THE POLTRACK SYSTEM** is 9-12 hours. After this time, the second layer can be applied.
- **The second layer has to be applied "cross hatch", i.e. perpendicular to the first layer to insure a good coverage.**
- After the second layer has cured (depending on conditions, this will usually take 9-12 hours at 20°C), it can be walked on. After 2 days, the top spray coating of **POLTRACK SEALED SYSTEM** is fully cured and can be put into service, after proper line marking is performed with the use of special two component polyurethane paint.

Important Remarks

- ✓ During temperatures over 40 degrees, ideal time for the application of **POLTRACK SPRAYCOAT SEALED SYSTEM** is between 22:00 and 09:00 and the minimum bearing temperature during application and drying should be over 10°C.
- ✓ The freshly coated surface should be protected from high temperatures, wind, rain and frost for at least the first 24 hours.

KDF - Kataskeves Dapedon LTD
e : exports@kdf.gr w : www.kdf.gr

Showroom Office
19th km National Road Thessaloniki-Moudania
57001, Neo Rysio, Thessaloniki, Greece
t / f : +30 2310 829598

Accounting Office
19 Mitropoleos Str
54624, Thessaloniki, Greece



Substrate

Asphalt is the safer subfloor for sport floorings for sure and must be always preferred than concrete surfaces.

A. Asphalt Substrate

The asphalt must have a slope of 0.7-1% and must dry for at least 30 days so that all solvents from the asphalt can evaporate.

The asphalt sub-floor should be applied on well compacted 150mm road base sub-floor and asphalt should be laid in one layer (and not 2) in 6 to 8cm with fine and coarse aggregates (up to 15mm granulometry) like the kind of asphalt used in road construction.

So, new road-grade asphalt will have to be laid (minimum 60mm) in one layer containing coarse aggregates and then mature for 30 days at least, before any application takes place on top of the asphalt to avoid bubbles on the final layer of the sport or rubber floorings.

Asphalt Infrastructure

	Fine asphalt base in thickness of 6cm with very fine aggregates by finisher
	Asphalt primer
	Good compaction by vibration
	Fine gravel 10cm
	Gravel stone in thickness of 15cm

B. Concrete Surface

Concrete surface must be power-trowelled without cracks and must be smooth with a slope of 0.7-1% and humidity under 4% in 10cm depth of concrete.

KDF - Kataskeves Dapedon LTD
e : exports@kdf.gr w : www.kdf.gr

Showroom Office
19th km National Road Thessaloniki-Moudania
57001, Neo Rysio, Thessaloniki, Greece
t / f : +30 2310 829598

Accounting Office
19 Mitropoleos Str
54624, Thessaloniki, Greece



Concrete must also be **dry at least for 40 days** and then the application takes place if there is no rising humidity for the sub-floor. Before the application takes place, there must be proper grinding of the surface by a grinding machine to open the pores accordingly and also a measurement by special instrument to measure humidity on the surface and in 10cm under the surface.

Generally concrete is a risky sub-floor and there may be problems with rising humidity, especially in areas where the sea level is really high and when the sea is close or in areas near greenery.

Always make expansion joints in large areas of concrete, in order to avoid uncontrollable cracks and failures. Joints should be every 25 square meters creating a grid of 5x5 meters or close to that.

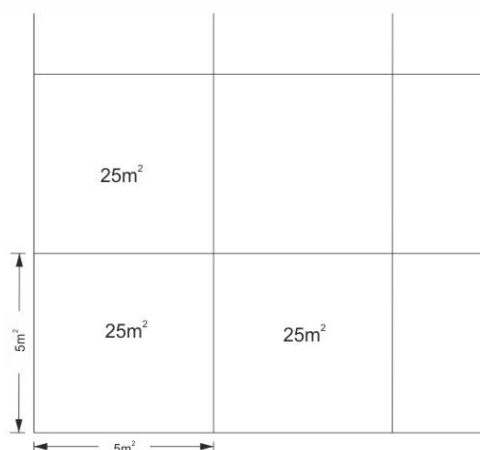

Substrate requirements

Concrete quality	at least C20/25
Age:	at least 40 days
Moisture content:	below 4%

KDF - Kataskeves Dapedon LTD
e : exports@kdf.gr w : www.kdf.gr

Showroom Office
19th km National Road Thessaloniki-Moudania
57001, Neo Rysio, Thessaloniki, Greece
t / f : +30 2310 829598

Accounting Office
19 Mitropoleos Str
54624, Thessaloniki, Greece



Tools



KDF - Kataskeves Dapedon LTD
 e : exports@kdf.gr w : www.kdf.gr

Showroom Office
 19th km National Road Thessaloniki-Moudania
 57001, Neo Rysio, Thessaloniki, Greece
 t / f : +30 2310 829598

Accounting Office
 19 Mitropoleos Str
 54624, Thessaloniki, Greece

