

# **KDF**

**Sports Flooring Systems & Building Materials**

## **POLTRACK SPRAYCOAT ACRYLIC RUNNING TRACK SYSTEM**



**KDF LTD** ([www.kdf.gr](http://www.kdf.gr)) is one of the most dynamic and export-oriented Greek companies (currently activated in more than 55 countries in 4 continents), based in Greece (EU) and U.A.E too, with production facilities and warehouses in both countries for acrylic and polyurethane materials.

**We are experts in sports, industrial and decorative flooring products and systems**, with huge experience in Europe, Africa, Asia, Middle East and India as well.

Our export horizon is expanding rapidly and our goal is to stand out as a model of flexibility and competitiveness. The company, being one of the pioneer companies in the sector of sports flooring systems and building materials and giving particular attention to providing a fully upgraded range of products and services, provides certified systems by **ITF, IAAF, EU norms, LNE, LABOSPORT, ISASPORT, to name but a few.**

**Our systems are approved in many ministries like:**

- Ministry of Education in U.A.E
- Ministry of Education in K.S.A
- Ministry of Education in Oman
- Ministry of Education in Kuwait and many other institutes like
- Oman Royal Police
- Aramco, K.S.A
- Musanada in U.A.E
- Municipality of Doha
- Municipality of Dubai, Abu Dhabi, Sharjah and many others institutions.

KDF goes far beyond trade, providing consultancy in marketing and also technical support all the way, from the costing till the finalization of the project. Operating under the requirements of ISO 9001/2015 for production, trade and also application, we make sure our products are first applied successfully at site by our own people before we launch them abroad.

Therefore, our systems have all stood the real life test in different climates, from Middle East till Russia, and this is one of our main assets, enabling us to provide full and vertical technical support from specifying to final application plus supervision when required or even full application and costing.

**We invite you to discover a world of sports flooring expertise and solutions.**

VIEW OUR NEW SPORTS CATALOGUE



**KDF - Kataskeves Dapedon LTD**  
e : [exports@kdf.gr](mailto:exports@kdf.gr)  
w : [www.kdf.gr](http://www.kdf.gr)

1 Papanikolaou Ave, Pefka  
57010, Thessaloniki, Greece  
t / f : 0030 2310 829598

# INDICATIVE REFERENCE LIST OF PROJECTS

-12 SCHOOLS IN U.A.E, MINISTRY OF EDUCATION(THROUGH VARIOUS CONTRACTORS) - 40000m<sup>2</sup> EPDM Rubber flooring

-UNIVERSITY OF DAMMAM - KSA - 13000m<sup>2</sup> - Acrylic cushion floorings

-KING ABDULLAH BASE AIR DEFENSE - TAIF, KSA - 12600 m<sup>2</sup> - Running track

-KING FAHD UNIVERSITY OF PETROLEUM AND MINERALS-DHARAN, KSA-12400m<sup>2</sup>-Rubber outdoor flooring

-RUNNING TRACK - K.S.A- 11000 m<sup>2</sup> - Running track, POLTRACK SANDWICH system

-GEMS SCHOOL - DUBAI, U.A.E - 10000 m<sup>2</sup> - Running track

-PASARGRAD WHOLESALE MARKET-IRAN - 10000 m<sup>2</sup> - Decorative flooring

-YAS ISLAND, ABU DHABI, U.A.E - 10000m<sup>2</sup> Bicycle track

-ABHA STADIUM - K.S.A - 9000m<sup>2</sup> - POLTRACK SANDWICH system

-ABU DHABI STADIUM - U.A.E - 9000m<sup>2</sup> - Artificial Grass, POLITURF LEADER 55140

-ALEXANDRIA STADIUM - ALEXANDRIA, EGYPT - 8500 m<sup>2</sup> - Running track

-MINISTRY OF EDUCATION IN KUWAIT - KUWAIT - 8000m<sup>2</sup> - Polyurethane flooring, Polyflex Pu-In system

-SALAM STREET & MINA ROAD, ABU DHABI, U.A.E - 8000m<sup>2</sup> Bicycle track, Sportground-Ex system

-KING FAHAD NAVAL BASE - JUBAIL, KSA - 8000m<sup>2</sup> - Running track

-MUNICIPALITY OF VELVENTO - KOZANI, GREECE - 8000m<sup>2</sup>, Running track

-ABBHA, KSA - 7600m<sup>2</sup> - Running track

-MUNICIPALITY OF ZENICA - ZENICA, BOSNIA& HERZEGOVINA - 7500m<sup>2</sup>, Poltrack Spraycoat, Running track

-ADNOC SCHOOLS - U.A.E - 7000m<sup>2</sup> - Safepol system

-ATLAS CENTER-BAM, IRAN - 7000 m<sup>2</sup> - Decorative flooring

-RUNNING TRACK - SUDAN - 7000 m<sup>2</sup> - Running track, POLTRACK SPRAYCOAT system

-CORNISH, JEDDAH, K.S.A - 6000m<sup>2</sup> Bicycle track Sportground-Ex system

-YOKOGAWA ELECTRIC CORPORATION-DHAHRAN TECHNO VALLEY-DAMMAM, KSA - 5500m<sup>2</sup>- Epoxy antistatic floorings

-AMITY INTERNATIONAL SCHOOL - ABHU DHABI, U.A.E - 5500m<sup>2</sup>, Poltrack Spraycoat, Running Track

-SHUQAIQ WATER AND ELECTRICITY COMPANY - JIZAN, KSA - 5400 m<sup>2</sup> - acrylic courts

-TALEEM UPTOWN SCHOOLS - DUBAI, UAE - 5400m<sup>2</sup>-Acrylic sports courts systems

-SAUDI AIR FORCE - KSA - 5250 m<sup>2</sup> - Acrylic coating elastoturf, running track

-RUNNING TRACK - K.S.A - 5000 m<sup>2</sup> - Running track, POLTRACK SANDWICH system

-AL HAMRA, RAS AL KHAIMAH, U.A.E - 5000m<sup>2</sup> Bicycle track, Sportground-Ex system

-AIRBASE IN TAIF - KSA - 5000 m<sup>2</sup> - Running track

-DEPARTMENT OF EDUCATION ASIR REGION - KHAMIS, KSA - 4500 m<sup>2</sup> - Running track

-SERVIA STADIUM - KOZANI, GREECE - 4500m<sup>2</sup>, Running track

-COMMUNITY COLLEGE - KHAMIS, KSA - 4200 m<sup>2</sup> - Running track

-MULTIPLE RUNNING TRACKS - ALGERIA - 40000 m<sup>2</sup> - Running track, POLTRACK SPRAYCOAT system

-SPORTS CLUB CENTER GLIFADA - ATHENS, GREECE - 4000m<sup>2</sup>- Poltrack Spraycoat, Running Track

-EMIRATES INTERNATIONAL SCHOOL - DUBAI, U.A.E - 4000m<sup>2</sup> - Safepol System, Playground flooring

-HH KHALID BIN BANDAR - RIYADH, KSA - 3800 m<sup>2</sup> - Volleyball/basketball rubber courts

-RUNNING TRACK- UKRAINE - 3600m<sup>2</sup> - RunningTrack, Poltrack Spraycoat system

-ANATOLIA GOLLEGE - THESSALONIKI, GREECE - 3600m<sup>2</sup>, Running track

-AIMARJAN ASLAND – PARTIAL - 3600m<sup>2</sup>- Poltrack Sandwich, Running Track

-RUNNING TRACK - ISRAEL - 3500 m<sup>2</sup> - Running track, POLTRACK SANDWICH system

**-MATRIX SPORTING CLUB - EGYPT - 3400 m<sup>2</sup> - Polyurethane outdoor flooring, Polyflex PU-EX System**  
**-SPORTS CLUB CENTER KISSAMOS - CRETE, GREECE - 3200m<sup>2</sup>- Poltrack Sandwich, Running Track**  
**-AL LUSAIL SPORTS CLUB - DOHA, QATAR - 3200m<sup>2</sup> - Jogging track**  
**-SPORTS CLUB CENTER - SERBIA, GREECE - 3200m<sup>2</sup> - Poltrack Sandwich, Running Track**  
**-STADIUM CENTER - UKRAINE - 3200m<sup>2</sup> - RunningTrack, Poltrack Spraycoat system**  
**-KING KHALID UNIVERSITY - ABHA, KSA - 3100 m<sup>2</sup> - Running track**  
**-AL FAIOUM UNIVERSITY - FAIOUM, EGYPT - 3000m<sup>2</sup>- Polyurethane indoor flooring, Polyflex PU-IN system**  
**-SPORTS CLUB CENTER "PAPAGO" - ATHENS, GREECE - 3000m<sup>2</sup>- Poltrack Sandwich, Running Track**  
**-PANORAMA SPORTS COMPLEX - THESSALONIKI, GREECE - 3000m<sup>2</sup>, Running track**  
**-INDIAN ARMY - SAGAR, INDIA - 2800m<sup>2</sup>- Acrylic sports courts**  
**-ALL SAINTS SCHOOL - MUMBAI, INDIA - 2700 m<sup>2</sup> - PU outdoor sports flooring and running track**  
**-INDIAN INSTITUTE OF SCIENCE EDUCATION AND RESEARCH-BHOPAL, INDIA-2700m<sup>2</sup> -Acrylic sports courts**  
**-OUR OWN GOLF SCHOOL - 2700m<sup>2</sup>- Poltrack Spraycoat, RunningTrack**  
**-AL RAYAN, QATAR - 2500 m<sup>2</sup> - Running track, POLTRACK SANDWICH system**  
**-OUTDOOR SPORTS VENUE - VARNA, BULGARIA - 2500 m<sup>2</sup> - Acrylic, ITF classified, 8 layers system**  
**-ALHOSN SPORTS COMPLEX - 2400 m<sup>2</sup> - Running track, POLTRACK SANDWICH system**  
**-TEACHERS COLLEGE - ABHA, KSA - 2050 m<sup>2</sup> - Running track**  
**-MUSAB BIN OMAIR BOYS SCHOOL - BIN OMRAN, QATAR - 2050 m<sup>2</sup> - PU outdoor sport flooring**  
**-BURAIRAT SCHOOL - RAK, UAE - 2000 m<sup>2</sup> - Running track**  
**-HADAYEK ALAHRAM CLUB - GIZA, EGYPT - 2000m<sup>2</sup>, PU outdoor sports flooring, POLYFLEX PU-EX WET-POUR system**  
**-AL SAILIYA BOYS SCHOOL - AL SAILIYA, QATAR - 2000 m<sup>2</sup> - Polyurethane, outdoor sport flooring**  
**-KING KHALID UNIVERSITY - ABHA, KSA - 2000 m<sup>2</sup> - Volleyball/basketball rubber courts**  
**-HH KHALID BIN BANDAR - RIYADH, KSA - 2000 m<sup>2</sup> - Volleyball/basketball rubber courts**  
**-RAWDA RASHEED PRIMARY SCHOOL FOR BOYS - 2000 m<sup>2</sup>**  
**-DAMIETTA GOVERNMENT - EGYPT - 2000m<sup>2</sup> - Running track, Poltrack Spraycoat Sealed System**  
**-AL WAKAIR BOYS SCHOOL - AL WAKRAH, QATAR - 1950 m<sup>2</sup> - Polyurethane, outdoor sport flooring**  
**-THE LAKE DISTRICT - PUNE, INDIA - 1950m<sup>2</sup>- Acrylic sports courts**  
**-PRESIDENTIAL GUARD COMMAND MAHAWI - ABU DHABI, UAE - 1900m<sup>2</sup> - Football court**  
**-UNITED (SABIC) SPORTS CLUB - 1900 m<sup>2</sup> - Rubber flooring**  
**-SHOOLS MINISTRY OF EDUCATION - KHAMIS, KSA - 1800 m<sup>2</sup> - Rubber floorin**  
**-AL MAJAD AMPHITHEATER - SHARJA, UAE - 1800m<sup>2</sup> - Certified Jogging track**  
**-QASSIM UNIVERSITY - KSA - 1800 m<sup>2</sup> - Polyurethane sports flooring**  
**-AL QADSIYA MODEL INDEPENDENT SCHOOL - ALWAAB, QATAR - 1770 m<sup>2</sup> - PU outdoor sport flooring**  
**-AL WAHDA SPORT ACADEMY CLUB - ABU DHABI, UAE - 1700 m<sup>2</sup> - Acrylic sports system**  
**-ALSARH SCHOOLS OF CIVIL - RIYADH, KSA - 1650m<sup>2</sup> - PU glue/Soccer field**  
**-GD GOENKA PUBLIC SCHOLL - PURNIA, INDIA - 1630m<sup>2</sup>- Acrylic sports courts**  
**-SPA RESORT DERENIVSKUPIA KI - UZHGOROD, UKRAINE - 1600 m<sup>2</sup> - Flexfloor-ex system, volleyball court**  
**-THE MILITARY HOSPITAL - RIYADH, KSA - 1560 m<sup>2</sup> - Volleyball/basketball rubber courts**  
**-THE MILITARY HOSPITAL - RIYADH, KSA - 1560 m<sup>2</sup> - Pu glue-PU sports flooring**  
**-AL FORSHAN SPORTS CENTRE - ABU DHABI, U.A.E - 1500m<sup>2</sup> - Smartfloor system, Acrylic flooring**  
**-INDUSTRIAL FLOORING - BULGARIA - 1500m<sup>2</sup> - Epoxy flooring, Polepox Coat 814 system**  
**-SCHOOL IN AL WAKRA CITY - DOHA, QATAR - 1500 m<sup>2</sup> - Playground flooring**

**-IRAQ ARMY CAMP - IRAQ - 1500m<sup>2</sup> - Acrylic flooring in 2,2mm**

**-SCHOOL IN AL WAKRA CITY - DOHA, QATAR - 1500 m<sup>2</sup> - Playground flooring**

**-PROJECT GREEN LAND - DUBAI, UAE - 1500 m<sup>2</sup> - Jogging track**

**-UP TOWN SCHOOL - 1500m<sup>2</sup>- Poltrack Spraycoat, RunningTrack**

**-INDIAN AIR FORCE - ALLAHABAD, INDIA - 1450m<sup>2</sup> - Acrylic sports courts**

**-DUBAI MODERN HIGH SCHOOL - DUBAI, UAE - 1375 m<sup>2</sup> - Acrylic sports courts**

**-PROJECT ECOGREEN - DUBAI, UAE - 1350 m<sup>2</sup> - Jogging track**

**-POLICE COMPLEX BARRACKS NIZWA - OMAN- 1300 m<sup>2</sup> - Colorflex, PU sport flooring**

**-POLICE COMPLEX BARRACKS AL AJAIZ - OMAN - 1300 m<sup>2</sup> - Colorflex, PU sport flooring**

**-POLICE COMPLEX BARRACKS KATMATMILAH SITE - OMAN- 1300 m<sup>2</sup> - Colorflex, PU sport flooring**

**-POLICE COMPLEX BARRACKS SUWAIQ - OMAN - 1300 m<sup>2</sup> - Colorflex, PU sport flooring**

**-POLICE COMPLEX BARRACKS AL KAMIL - OMAN - 1300 m<sup>2</sup> - Colorflex, PU sport flooring**

**-PLAYGROUND FLOORING - BAHRAIN - 1300m<sup>2</sup> - Safepol system**

**-POLICE COMPLEX BARRACKS SHINAS - OMAN - 1300 m<sup>2</sup> - Colorflex, PU sport flooring**

**-POLICE COMPLEX BARRACKS BHALA - OMAN - 1300 m<sup>2</sup> - Colorflex, PU sport flooring**

**-POLICE COMPLEX BARRACKS MUDHAIBI - OMAN - 1300 m<sup>2</sup> - Colorflex, PU sport flooring**

**-POLICE COMPLEX BARRACKS THUMRAIT - OMAN - 1300 m<sup>2</sup> - Colorflex, PU sport flooring**

**-POLICE COMPLEX BARRACKS AL KHOUDH - OMAN - 1300 m<sup>2</sup> - Colorflex, PU sport flooring**

**-POLICE COMPLEX BARRACKS MAHDAH - OMAN - 1300 m<sup>2</sup> - Colorflex, PU sport flooring**

**-POLICE COMPLEX BARRACKS BID BID - OMAN - 1300 m<sup>2</sup> - Colorflex, PU sport flooring**

**-POLICE COMPLEX BARRACKS AL KHABOORA - OMAN - 1300 m<sup>2</sup> - Colorflex, PU sport flooring**

**-POLICE COMPLEX BARRACKS DHANK - OMAN - 1300 m<sup>2</sup> - Colorflex, PU sport flooring**

**-POLICE COMPLEX BARRACKS HAFEET - OMAN - 1300 m<sup>2</sup> - Colorflex, PU sport flooring**

**-POLICE COMPLEX BARRACKS AUQAD - OMAN - 1300 m<sup>2</sup> - Colorflex, PU sport flooring**

**-POLICE COMPLEX BARRACKS SUMAIL - OMAN - 1300 m<sup>2</sup> - Colorflex, PU sport floor**

**-OUTDOOR SPORTS VENUE - KOSOVO - 1300 m<sup>2</sup> - POLTRACK SPRAYCOAT System**

**-ALHALAFI BREAK - RIYADH, KSA - 1276 m<sup>2</sup> - Rubber flooring**

**-GI-DHOFAR BEACH RESORT & SPA - OMAN - 1225 m<sup>2</sup> - Colorflex, PU sport flooring**

**-RLS BASIC EDUCATION SCHOOL SOHAR - OMAN - 1225 m<sup>2</sup> - Colorflex, PU sport flooring**

**-MIXED BASIC EDUCATION SCHOOL AL QABIL - OMAN - 1225 m<sup>2</sup> - Colorflex, PU sport flooring**

**-BOYS BASIC EDUCATION SCHOOL BARKHA - OMAN - 1225 m<sup>2</sup> - Colorflex, PU sport flooring**

**-GIRLS BASIC EDUCATION SCHOOL MUDHAIBI - OMAN - 1225 m<sup>2</sup> - Colorflex, PU sport flooring**

**-MIXED BASIC EDUCATION SCHOOL AL AMERAT - OMAN - 1225 m<sup>2</sup> - Colorflex, PU sport flooring**

**-UMSALAMA GIRLS SCHOOL - AL RAYYAN, QATAR - 1200 m<sup>2</sup> - Polyurethane, outdoor sport flooring**

**-SHERATON PARK - DOHA, QATAR - 1200 m<sup>2</sup> - Playground flooring**

**-RAWDA BIN JASSIM SCHOOL - AL AZIZIYAH, QATAR - 1200 m<sup>2</sup> - Polyurethane, outdoor sport flooring**

**-GEMS WESTMINISTER SCHOOL - DUBAI, U.A.E - 1200 m<sup>2</sup> - Acrylic sports courts**

**-SILVER SPORTS CLUB - INDIA - 1200m<sup>2</sup>- Acrylic sports courts**

**-OUR OWN SCHOOL - SHARJA, U.A.E - 1200m<sup>2</sup> - Acrylic sports courts**

**-SHARJAH FOOTBALL CLUB - SHARJAH, UAE - 1200 m<sup>2</sup> - Polyurethane basketball courtsing**

**-MATRIX SPORTING CLUB - EGYPT - 1300 m<sup>2</sup> - Acrylic flooring, Flexfloor System**

**-SHERATON PARK - DOHA, QATAR - 1200 m<sup>2</sup> - Playground flooring**

**-SYMBIOSIS COLLEGE - INDIA - 1180m<sup>2</sup> - Acrylic sports courts**

**-PROFESSOR ABDULAZIZ ANQARI - RIYADH, KSA -1150m<sup>2</sup> - PU glue/Socccer field**



**-AL SAQID ISLAMIC ENGLISH SHCOLL-DUBAI,UAE-1100m<sup>2</sup>- Acrylic flooring, WET-POUR POLYFLEX AEL-EX**  
**-FIRST POINT SCHOOLS - DUBAI, UAE - 1100m<sup>2</sup> - Acrylic sports courts**  
**-MAADI BRITISH SCHOOL- EGYPT - 1100m<sup>2</sup>, Multipurpose court, COLORFLEX system**  
**-DUBAI AMERICAN ACADEMY - DUBAI, UAE - 1080 m<sup>2</sup> - Acrylic sports court**  
**-PRELUDE PUBLIC SCHOOL - AGRA, INDIA - 1070m<sup>2</sup>- Acrylic sports courts**  
**-ALMGBAL BREAK - RIYADH, KSA - 1050 m<sup>2</sup> - Rubber playground**  
**-BANIYAS CLUB AND AL AIN ENGLISH SPEAKING SCHOOL - ABU DHABI, UAE - 1000m<sup>2</sup> - Acrylic flooring**  
**-WADY DEGLA LOTUS PROJECT - CAIRO, EGYPT- 1000 m<sup>2</sup> - Acrylic flooring, Wet-Pour Polyflex AEL-EX system.**  
**-MINISTRY OF EDUCATION - DAMMAM, KSA - 1000 m<sup>2</sup> - PU indoor multipurpose sports flooring**  
**-SHEIKH OBEID MAKTHOUM PALACE - 1000m<sup>2</sup> - Outdoor polyurethane flooring**  
**-INDIAN AIR FORCE - AGRA, INDIA - 1000m<sup>2</sup>- Acrylic sports courts**  
**-INDIAN AIR FORCE - LUCKNOW, INDIA - 1000m<sup>2</sup>- Acrylic sports courts**  
**-MULTIPURPOSE POLYURTEHANE INDOOR COURTS - F.Y.R.O.M - 1000m<sup>2</sup> - Polyflex PU-In system**  
**-SODIC PROJECT - EGYPT - 1000m<sup>2</sup>, Multipurpose court, COLORFLEX system**  
**-INDIAN AIR FORCE - VARANASI, INDIA - 1000m<sup>2</sup>- Acrylic sports courts**  
**-INTERNATIONAL SCHOOL OF CREATIVE SCHIENCE - SHARJAH, U.A.E - 1000m<sup>2</sup> - Safepol System**  
**-INDIAN AIR FORCE - BIHTA, INDIA - 1000m<sup>2</sup>- Acrylic sports courts**  
**-INDIAN AIR FORCE - DARBHANGA, INDIA - 1000m<sup>2</sup>- Acrylic sports courts**  
**-AL AIN INDIAN SCHOOL - AL AIN, UAE - 1000m<sup>2</sup> - Football court**  
**-DUBAI SCHOLRAS PRIVATE SCHOOL - DUBAI, U.A.E - 1000m<sup>2</sup> - Acrylic flooring in 2,2mm**  
**-COMMUNITY COLLEGE - KHAMIS, KSA - 940 m<sup>2</sup> - Polyurethane indoor multipurpose sports flooring**  
**-GEMS METROPOLE SCHOOL - DUBAI, U.A.E - 900 m<sup>2</sup> - Playground flooring**  
**-MINISTRY OF EDUCATION - ABHA, KSA - 900 m<sup>2</sup> - Polyurethane indoor multipurpose sports flooring**  
**-BAB AL SHAMS SPA HOTEL - DUBAI, UAE - 900m<sup>2</sup> - Football court**  
**-KING KHALID UNIVERSITY - ABHA, KSA - 820 m<sup>2</sup> - Polyurethane indoor multipurpose sports flooring**  
**-SCHOOL IN AL WAKRA CITY - DOHA, QATAR - 800m<sup>2</sup> - Polyurethane sports flooring**  
**-SULTAN MANOR - RIYADH, KSA - 800 m<sup>2</sup> - Polyurethane multipurpose sports flooring**  
**-MINISTRY OF EDUCATION - AL KHARIZ, KSA - 800 m<sup>2</sup> - PU indoor multipurpose sports flooring**  
**-INDOOR SPORTS COURT - MALAYSIA - 800 m<sup>2</sup> - PU indoor sports flooring**  
**-KID'S PLAY AREA IN MALL - MOROCCO - 800 m<sup>2</sup> - PU indoor sports flooring, POLYFLEX PU-IN system**  
**-DUBAI ENGLISH SPEAKING COLLEGE - DUBAI, UAE - 783m<sup>2</sup> - Acrylic flooring, SPORTFLOOR-EX, HARD COURT**  
**-SINGAPORE AIRLINES - SINGAPORE - 735m<sup>2</sup> - PU indoor sports flooring**  
**-AL DAJAN COMPANY - GASIM, KSA - 722 m<sup>2</sup> - Polyurethane sports flooring/Tennis court**  
**-SELECTIVE GOVERNMENT HIGH SCHOOL - EGYPT - 720m<sup>2</sup>, Outdoor sports flooring**  
**-INDIAN AIR FORCE - AHMEDABAD, INDIA - 720m<sup>2</sup>- Acrylic sports courts**  
**-FITNESS TIME - FAYSALIA, DAMMAM, KSA - 700 m<sup>2</sup>-PU indoor multipurpose sports flooring/running track**  
**-FITNESS TIME YASMEEN - RIYADH, KSA - 700 m<sup>2</sup> - PU indoor multipurpose sports flooring/running track**  
**-FERRARI WORLD - ABU DHABI, UAE - 700m<sup>2</sup> - Playground flooring**  
**-FITNESS TIME JUNIOR - RIYADH, KSA - 700 m<sup>2</sup> - PU indoor multipurpose sports flooring/running track**  
**-FITNESS TIME - OLAYA RIYADH, KSA - 700 m<sup>2</sup> - PU indoor multipurpose sports flooring/ running track**  
**-FITNESS TIME WAHA - RIYADH, KSA - 700 m<sup>2</sup> - PU indoor multipurpose sports flooring/running track**  
**-FITNESS TIME, NOOR BRANCH - DAMMAM, KSA -700 m<sup>2</sup> - PU indoor sports flooring and running track**  
**-FITNESS TIME, ALAMEEN BRANCH - DAMMAM, KSA - 700 m<sup>2</sup> - PU indoor sports flooring and running track**  
**-FITNESS TIME, PLUS RIYADH - RIYADH, KSA - 700 m<sup>2</sup> - PU indoor sports flooring and running track**

**-FITNESS TIME, SALAMA BRANCH BRO & FITNESS - JEDDAH, KSA - 700 m<sup>2</sup> - PU indoor sports flooring**  
**-FITNESS TIME, 40th BRANCH - JEDDAH, KSA - 700 m<sup>2</sup> - PU indoor sports flooring and running track**  
**-NASR CLUB- EGYPT - 700m<sup>2</sup>, Multipurpose court, POLYFLEX WET-POUR system**  
**-HUREL DOUBLE 3 - RAS AL KHAIMH, KSA - 700 m<sup>2</sup> - Shockpad plus acrylic coatings**  
**-THE SUSTAINABLE CITY - DUBAI, U.A.E - 700 m<sup>2</sup> - Acrylic flooring**  
**-EMAAR - EMIRATES HILLS 2 - DUBAI, U.A.E - 700m<sup>2</sup> - Basketball court, Acrylic flooring**  
**-AIRFORCE SURBOTO PARK - NEW DELHI, INDIA - 680 m<sup>2</sup> - Polyurethane outdoor sports flooring**  
**-INDIAN ARMY - DHRANGDHARA, INDIA - 670m<sup>2</sup>- Acrylic sports courts**  
**-MT.SAINT PATRICK ACADEMY - INDIA - 665m<sup>2</sup>- Acrylic sports courts**  
**-REGIONAL HQ AT BURAIMI - OMAN - 650 m<sup>2</sup> - Colorflex, PU sport flooring**  
**-ROYAL OMAN POLICE TASK FORCE RUSTAQ - OMAN - 650 m<sup>2</sup> - Colorflex, PU sport flooring**  
**-ROYAL OMAN POLICE TASK FORCE LIWA - OMAN - 650 m<sup>2</sup> - Colorflex, PU sport flooring**  
**-ROYAL OMAN POLICE TASK FORCE AL SALIL - OMAN - 650 m<sup>2</sup> - Colorflex, PU sport flooring**  
**-ROYAL OMAN POLICE TASK FORCE IBRI - OMAN - 650 m<sup>2</sup> - Colorflex, PU sport flooring**  
**-ROYAL OMAN POLICE TASK FORCE IBRA - OMAN - 650 m<sup>2</sup> - Colorflex, PU sport flooring**  
**-ROYAL OMAN POLICE TASK FORCE AL SUR - OMAN - 650 m<sup>2</sup> - Colorflex, PU sport flooring**  
**-ROYAL OMAN POLICE TASK FORCE AL DUKUM - OMAN - 650 m<sup>2</sup> - Colorflex, PU sport flooring**  
**-ROYAL OMAN POLICE TASK FORCE AL BURAIMI - OMAN - 650 m<sup>2</sup> - Colorflex, PU sport flooring**  
**-ROYAL OMAN POLICE TASK FORCE AL NIZWA - OMAN - 650 m<sup>2</sup> - Colorflex, PU sport flooring**  
**-ROYAL OMAN POLICE TASK FORCE AL SUWAIQ - OMAN - 650 m<sup>2</sup> - Colorflex, PU sport flooring**  
**-ABU DHABI MUNICIPALITY - ABU DHABI , UAE - 650 m<sup>2</sup> - Acrylic flooring**  
**-ROYAL OMAN POLICE TASK FORCE AL SALALAH - OMAN - 650 m<sup>2</sup> - Colorflex, PU sport flooring**  
**-ROYAL OMAN POLICE TASK FORCE AL BARKHA - OMAN - 650 m<sup>2</sup> - Colorflex, PU sport flooring**  
**-ROYAL OMAN POLICE TASK FORCE KHOUDH - OMAN - 650 m<sup>2</sup> - Colorflex, PU sport flooring**  
**-MULTIPURPOSE COURTS - TIRANA, ALBANIA - 650 m<sup>2</sup> - Acrylic sports flooring, FLEXFLOOR system**  
**-MOHAMMED JASSIM M AL THANI SCHOOL - UMSALALALI, QATAR - 620 m<sup>2</sup> - PU outdoor sport flooring**  
**-QATAR GEMS SCHOOL - DOHA, QATAR - 615 m<sup>2</sup> - Polyurethane sports flooring**  
**-VAISHNO DEVI - DELHI, INDIA - 608 m<sup>2</sup> - Polyurethane outdoor sports flooring**  
**-INDIAN ARMY - AGRA, INDIA - 600m<sup>2</sup>- Acrylic sports courts**  
**-THE INTERNATIONAL SCHOOL - AGRA, INDIA - 600m<sup>2</sup>- Acrylic sports courts**  
**-INDIAN ARMY - JHANSI, INDIA - 600m<sup>2</sup>- Acrylic sports courts**  
**-THE SUSTAINABLE CITY - DUBAI, U.A.E - 600 m<sup>2</sup> - Safepol system**  
**-AMITY SCHOOL, JUMEIRAH ISLAND - DUBAI, UAE - 600 m<sup>2</sup> - Safepol system**  
**-OUR OWN ENGLISH HIGH SCHOOL - SHARJAH, U.A.E - 600 m<sup>2</sup> - Flexfloor system**  
**-OUR OWN ENGLISH HIGH SCHOOL - SHARJAH, U.A.E - 600 m<sup>2</sup> - Polyflex Ael-EX system**  
**-SKATING FOR KIDS - GUJARAT, INDIA - 600 m<sup>2</sup> - Sportfloor system**  
**-NEW DUBAI BRADENTON SCHOOL- DUBAI, UAE - 570 m<sup>2</sup> - Acrylic sports courts**  
**-DUBAI SILICON OSIS-CENTRAL PARK, DSO - DUBAI, UAE - 560 m<sup>2</sup> - Jogging track**  
**-MPS WORLD SCHOOL - AGRA, INDIA - 560m<sup>2</sup>- Acrylic sports courts**  
**-AL WUKAIR GIRLS SCHOOL - AL WAKRAH, QATAR - 550 m<sup>2</sup> - Polyurethane, outdoor sport flooring**  
**-BBPS - DELHI, INDIA - 512 m<sup>2</sup> - Polyurethane outdoor sports flooring**  
**-IVY STATE - PUNE, INDIA - 511m<sup>2</sup>- Acrylic sports courts**  
**-KUNAL ICONIA - INDIA - 510m<sup>2</sup>- Acrylic sports courts**  
**-AMERICAN SCHOOL OF DUBAI - DUBAI, UAE - Acrylic sports courts**

**-ETIHAD MUSEUM - JUMEIRAH, DUBAI, UAE - Rubber flooring**  
**-CARPARKING - ABU DHABI, UAE - Acrylic flooring**  
**-DUBAI MILLENIUM SCHOOL - QUSAIS, UAE - Acrylic sports courts**  
**-AMERICAN UNIVERSITY - DUBAI, UAE – Acrylic outdoor sports flooring**  
**-RAK ACADEMY - RAK, UAE - Acrylic flooring**  
**-ISCS - SHARJA, UAE - Acrylic flooring**  
**-THE INTERNATIONAL SCHOOL OF CHOUEIFAT - AJMAN, U.A.E - Sportground-Ex system**  
**-THE KINDER GARDEN STARTERS - DUBAI, U.A.E - Safepol system**  
**-AL ZAHIA PROJECT - SHARJA, UAE - Safepol system**  
**-WADY DEGLA SHERATON CLUB - CAIRO, EGYPT - Acrylic sports flooring**  
**-GEMS WELLINGTON SCHOOL - DUBAI, U.A.E - Safepol system**  
**-JUMEIRAH RETAIL DEVELOPMENT - JUMEIRAH, DUBAI, UAE - Safety rubber flooring**  
**-MR.ABDULRHMIN - JUBAIL, KSA - Rubber playground**  
**-GEMS WESTMINISTER SCHOOL - DUBAI, U.A.E - Safepol system**  
**-POLYURETHANE INDOOR SPORTS COURT - TIRANA, ALBANIA - Polyflex PU-In system**  
**-MULTIPURPOSE COURTS - ODESSA, UKRAINE - Rubber flooring**  
**-MULTIPURPOSE COURTS - ZHOVKVA, UKRAINE - Rubber flooring**  
**-MUNICIPAL TENNIS CLUB - PATRA, GREECE - Flexfloor-EX system, Acrylic sports courts**  
**-INDIAN AIR FORCE - GORAKHPUR, INDIA - Acrylic sports courts**  
**-INDIAN AIR FORCE - BAREILLY, INDIA - Acrylic sports courts**  
**-INDIAN ARMY - BABINA, INDIA - Acrylic sports courts**  
**-ADAM AIRBASE PACKAGE 8, OMAN - Colorflex, PU sport flooring**  
**-GOLD GYM - KOLKATTA, INDIA - Polyurethane indoor sports flooring**  
**-MINISTRY OF FOREIGN AFFAIRS - ABU DHABI, UAE - Polyurethane flooring**  
**-SHRJAH SPORTS CLUB - SHARJAH, UAE - Polyurethane flooring**  
**-GEMS WINCHESTER SCHOOL - AL BARSHA SOUTH, UAE - Acrylic sports system**  
**-HOTEL DOUBLE 3 - RAS AL KHAIMAH, UAE - Prefabricated shock-pad 4mm plus acrylic coatings**  
**-ALNABBAGH STABLE - AL AIN, U.A.E - Polyurethane flooring, POLTRACK EQUESTRIAN FLOORING**  
**-AL WAHDA CLUB - ABU DHABI, UAE - Rubber flooring**  
**-ADJD MAIN BUILDING LANDSCAPE PROJECT - ABU DHABI, UAE - Rubber flooring**  
**-KADEEJ AL KURBA SCHOOL - ABU DHABI, UAE - Rubber flooring**  
**-INTERNATIONAL SCHOOL OF CREATIVE SCIENCE - SHARJA, U.A.E - Flexfloor system/Outdoor Multipurpose court**  
**-ENVIRO, VATIKA HOTELS PVT.LTD - GURGAON, INDIA - Acrylic sports flooring**  
**-ASHIANA - BHUBANESHWAR, INDIA - Acrylic sports flooring**  
**-TCS, ADIBATLA - HYDERABAD, INDIA - Acrylic sports flooring**  
**-IPS, ERODE - CHENNAI, INDIA - Acrylic sports flooring**  
**-LIONS GATE - MUMBAI, INDIA - Acrylic sports flooring**  
**-MORNING GLORY INFRA LIMITED - KANPUR, INDIA - Acrylic sports flooring**  
**-NAMBIAR - BANGALORE, INDIA - Acrylic sports flooring**  
**-PATHWAYS - GURGAON, INDIA - Acrylic sports flooring**  
**-WELHAMS GIRLS SCHOOL - DEHRADUN, INDIA - Acrylic sports flooring**  
**-WOODDUCK COMMERCIAL CENTER- IRAN - Industrial flooring**  
**-ARABIAN RANCHES by EMAR - DUBAI, U.A.E - Playground flooring**



**-OUR OWN ENGLISH HIGH SCHOOL - SHARJAH, U.A.E** - Playground flooring

**-POLO CLUB GHANTOOT - ABU DHABI, U.A.E** - Polyurethane flooring, POLTRACK EQUESTRIAN FLOORING

**-RAK MODERN SCHOOL - RAS AL KHAIMAH, U.A.E** - Playground flooring

**-GIIS/GLOBAL INDIAN INTERNATIONAL SCHOOL - RAS AL KHAIMAH, U.A.E** - Playground flooring

**-MINISTRY OF EDUCATION, NAD AL HAMAR BOYS SCHOOL - DUBAI, U.A.E** - Playground flooring

**-K.G. KIDS SCHOOL - AALI, BAHRAIN** - Playground flooring

**-SABIC BEACH CAMPS PROJECT - JUBAIL, K.S.A** - Outdoor sports flooring, artificial grass.

**-MINISTRY OF EDUCATION, MIZHER GIRLS SCHOOL - DUBAI, U.A.E** - Playground flooring

**-WARSAN STABLE** - Polyurethane flooring, POLTRACK EQUESTRIAN FLOORING

**-AL SHIMAL PARK - DOHA, QATAR** - Playground flooring

**-UM SELAL PARK - DOHA, QATAR** - Playground flooring

**-AL KABAN PARK - DOHA, QATAR** - Playground flooring

**-GEMS METROPOLE SCHOOL - DUBAI, U.A.E** - Hard court system/Outdoor Multipurpose court

**-ARABIAN RANCHES by EMAR - DUBAI, U.A.E** - Acrylic Outdoor Tennis and Basketball courts

**-RAK MODERN SCHOOL - RAS AL KHAIMAH, U.A.E** - Flexfloor system

**-GIIS/GLOBAL INDIAN INTERNATIONAL SCHOOL - RAS AL KHAIMAH, U.A.E** - Acrylic system

**-AVALON HEIGHTS - AJMAN, U.A.E** - Acrylic floorings

**-DELHI PRIVATE SCHOOL - DUBAI, U.A.E** - Acrylic flooring

**-ROYAL COMMISSION SCHOOL - JUBALI, KSA** - Acrylic sports flooring

**-FITNESS TIME PRO - AL AHSA BRANCH - KSA** - Flexfloor, Basketball court

**-FITNESS TIME PRO - MAKKAH SHARAIE - KSA** - Flexfloor, Basketball court

**-BIN HAM - AL AIN, UAE** - Polyurethane flooring

**-SHAMMA BINT MOHAMMED SHOOOL - AL AIN, UAE** - Polyurethane flooring

**-ABDULLAH BIN OTAIBA - ABU DHABI, UAE** - Polyurethane flooring

**-LIWA INTERNATIONAL SCHOOL - AL AIN, U.A.E** - Colorflex outdoor sport system.

**-ZOHOUR KG - MANAMA, BAHRAIN** - Polyurethane sports flooring

**-RAWDA RASHED - QATAR-** Polyurethane, outdoor sport flooring

**-SAAD BIN ABI WAQAS SCHOOL - AL RAYYAN, QATAR** - Polyurethane, outdoor sport flooring

**-FITNESS TIME PRO - MADINS RING ROAD BRANCH - KSA** - Flexfloor, Basketball court

**-AGRA CHAIN - AGRA, INDIA** - Acrylic sports flooring

**-SUNWORLD - NOIDA, INDIA** - Acrylic sports flooring

**-SSN INVESTMENTS PRIVATE LIMITED, FRIENDS COLONY - DELHI, INDIA** - Acrylic sports flooring

**-AJNARA - NOIDA, INDIA** - Acrylic sports flooring

**-BRIGHT RIDERS SCHOOL - ABU DHABI, UAE** - Running track, Acrylic sports court

**-OUR OWN ENGLISH HIGH SCHOOL - SHARJAH, U.A.E** - Poltrack Spaycoat system

**-NCC - JAIS, INDIA** - Acrylic sports flooring

**-ALPHA FOUNDATION FOR EDUCATION & RESEARCH - TRICHIRAPALLI, INDIA** - Acrylic sports flooring

**-PUSHPANJALI FARMS - NEW DELHI, INDIA** - Acrylic sports flooring

**-M3M - MERLIN GURGAON, INDIA** - Acrylic sports flooring

**-NORTH LONDON COLLEGIATE SCHOOL - DUBAI, U.A.E** - Playground flooring

**-FOOT COURT - EGYPT** - Running track, POLTRACK SPRAYCOAT system

**-FITNESS TIME ANDALUS BRANCH - JEDDAH, K.S.A** - Acrylic sports flooring, FLEXFLOOR SYSTEM

**-ST.JOSEPHS WOMENS COLLEGE - ALLEPPEY, KERALA, INDIA** - Polyurethane outdoor sports flooring

**-WADY DEGLA SHERATON CLUB - CAIRO, EGYPT** - Acrylic sports flooring

- RAILWAY SPORTS GROUND - GUNTAKAL, ANDRA PRADESH, INDIA - Acrylic sports flooring**
- TERVEL PROJECT - TERVEL, BULGARIA - Playground flooring, SAFEPOL system**
- INDOOR COURT - UKRAINE - Polyflex PU-In system**
- PRIVATE JOB - HYDERABAD, SOUTH INDIA - Acrylic outdoor sports flooring**
- RAILWAY SPORTS GROUND -GUNTAKAL, ANDRA PRADESH, INDIA-Acrylic outdoor sports flooring, 5 layers**
- MINISTRY OF EDUCATION U.A.E - Playground flooring**
- PLAYGROUND FLOORING - VARNA, BULGARIA - SAFEPOL System**

# PHOTOGRAPHS OF PROJECTS



**LABOSPORT**

**TEST REPORT**

**16-0492IT**

Issued on October 6<sup>th</sup> 2016

CLIENT

**KATASKEVES DAPEDON LTD**

PRODUCT NAME

**EPDM 856**

TYPE

**EPDM GRANULES**

Test according to:

**DIN 18036-7:2014 Sports Grounds Part 7; Synthetic Turf Areas  
Determination of Environmental Compatibility**

Reproduction of this test report is only authorized in its entirety

The results are safely considered valid for the specimen subjected to testing



Labosport Italia S.r.l.

Via Mend. 50 - 20179 CERVINATO LOMBARDO (MI) - IT  
Tel. +39 039 894 82 18 - Fax +39 039 868 31 89

[www.labosport.it](http://www.labosport.it)  
[labosport@labosport.it](mailto:labosport@labosport.it)

# PAH TEST REPORT EPDM GRANULES



Intertek Consumer Goods GmbH · Würzburger Straße 152 · 90766 Fürth · Germany

**KATASKEVES DAPEDON LTD - KDF**  
MRS. Maria Nikolaidoy  
Mitropoleos 19  
54024 Thessaloniki  
GREECE

Fürth, May 12/2020

## TEST REPORT No. FUTYP2020-01959-C

Date sample received: March 06/2020  
Period of testing: March 19/2020 – April 29/2020  
Technical Director: Kerstin Scharrer

**Sample description:** EPDM Granulates E1, E2, E7, E8, E11, E12, E13, E15, E16, E17, E18, E19, E20



*For the test results please refer to next pages*

Intertek Consumer Goods GmbH  
Würzburger Straße 152  
90766 Fürth, Germany

Tel.: +49 911 74075 0  
Fax: +49 911 74075 30  
cg.germany@intertek.com

Sitz Fürth  
Amtsgericht Fürth, HRB 5756  
USt-IdNr. DE169317871

Geschäftsführer  
Reinhold Gehling





## Test order

Test of products for polycyclic aromatic hydrocarbons

Summary	Results
Further requirements	<i>pass</i>

### Sample description:

No. 1:	Granulate E1 (red rose)
No. 2:	Granulate E2 (orange)
No. 7:	Granulate E7 (brown)
No. 8:	Granulate E8 (dark brown)
No. 11:	Granulate E11 (light blue)
No. 12:	Granulate E12 (dark blue)
No. 13:	Granulate E13 (purple)
No. 15:	Granulate E15 (light grey)
No. 16:	Granulate E16 (dark grey)
No. 17:	Granulate E17 (light green)
No. 18:	Granulate E18 (blue)
No. 19:	Granulate E19 (light brown)
No. 20:	Granulate E20 (EPDM red 0,5-1,5 mm)

## Test results

Abbreviations:

n.d. = not determinable (< LoQ)

LoQ = limit of quantification

### 1. Polycyclic Aromatic Hydrocarbons according to US-EPA+ 2 EFSA PAH and according to Regulation (EC) No. 1907/2006 (REACH) Annex XVII No. 50

Test method: AfPS GS 2019:01 PAK (2019-05)

Limit of quantification: 0.1 mg/kg

#### Test results in mg/kg

Parameter	CAS-No.	Sample No. 1	Sample No.2	Sample No. 7	Sample No. 8
1 Naphthalene	91-20-3	<b>0.26</b>	<b>0.14</b>	<b>0.14</b>	<b>0.18</b>
2 Acenaphthylene	208-96-8	n.d.	n.d.	n.d.	n.d.
3 Acenaphthene	83-32-9	n.d.	n.d.	n.d.	n.d.
4 Fluorene	86-73-7	<b>0.66</b>	<b>0.22</b>	<b>0.23</b>	<b>0.68</b>
5 Phenanthrene	85-01-8	<b>1.9</b>	<b>0.40</b>	<b>0.46</b>	<b>1.1</b>
6 Anthracene	120-12-7	<b>0.22</b>	n.d.	n.d.	n.d.
7 Fluoranthene	206-44-0	<b>0.39</b>	<b>0.14</b>	<b>0.18</b>	n.d.
8 Pyrene	129-00-0	n.d.	n.d.	<b>0.21</b>	n.d.
9 Benzo(a)anthracene	56-55-3	<b>0.23</b>	n.d.	n.d.	n.d.



Polycyclic Aromatic Hydrocarbons - continued

Test results in mg/kg

Parameter	CAS-No.	Sample No. 1	Sample No.2	Sample No. 7	Sample No. 8
10 Chrysene	218-01-9	<b>0.28</b>	n.d.	n.d.	n.d.
∑11+12 Benzo(b)fluoranthene + Benzo(j)fluoranthene	205-99-2 + 205-82-3	n.d.	n.d.	n.d.	n.d.
13 Benzo(k)fluoranthene	207-08-9	n.d.	n.d.	n.d.	n.d.
14 Benzo(e)pyrene	192-97-2	n.d.	n.d.	<b>0.21</b>	n.d.
15 Benzo(a)pyrene	50-32-8	n.d.	n.d.	n.d.	n.d.
16 Indeno(1,2,3-cd)pyrene	193-39-5	n.d.	n.d.	n.d.	n.d.
17 Dibenzo(a,h)anthracene	53-70-3	n.d.	n.d.	n.d.	n.d.
18 Benzo(ghi)perylene	191-24-2	n.d.	n.d.	n.d.	n.d.
<b>Sum 15 PAH</b>		<b>3.3<sup>b</sup></b>	<b>0.40<sup>b</sup></b>	<b>0.88<sup>b</sup></b>	<b>1.1<sup>b</sup></b>

<sup>a</sup> For summation according to AfPS GS 2019:01 PAK the following PAH are not included: Acenaphthylene, Acenaphthene, Fluorene

<sup>b</sup> Only contents from 0.2 mg/kg were used for summation.

Parameter	CAS-No.	Sample No. 11	Sample No. 12	Sample No. 13	Sample No. 15
1 Naphthalene	91-20-3	<b>0.34</b>	<b>0.30</b>	n.d.	n.d.
2 Acenaphthylene	208-96-8	n.d.	n.d.	n.d.	n.d.
3 Acenaphthene	83-32-9	n.d.	n.d.	n.d.	n.d.
4 Fluorene	86-73-7	<b>0.19</b>	n.d.	<b>0.32</b>	<b>0.21</b>
5 Phenanthrene	85-01-8	<b>0.87</b>	<b>0.61</b>	<b>0.65</b>	<b>0.53</b>
6 Anthracene	120-12-7	n.d.	n.d.	n.d.	n.d.
7 Fluoranthene	206-44-0	<b>0.25</b>	<b>0.16</b>	n.d.	<b>0.16</b>
8 Pyrene	129-00-0	n.d.	n.d.	n.d.	<b>0.15</b>
9 Benzo(a)anthracene	56-55-3	n.d.	n.d.	n.d.	n.d.
10 Chrysene	218-01-9	<b>0.15</b>	<b>0.12</b>	n.d.	n.d.
∑11+12 Benzo(b)fluoranthene + Benzo(j)fluoranthene	205-99-2 + 205-82-3	n.d.	n.d.	n.d.	n.d.
13 Benzo(k)fluoranthene	207-08-9	n.d.	n.d.	n.d.	n.d.
14 Benzo(e)pyrene	192-97-2	n.d.	n.d.	n.d.	n.d.
15 Benzo(a)pyrene	50-32-8	n.d.	n.d.	n.d.	n.d.
16 Indeno(1,2,3-cd)pyrene	193-39-5	n.d.	n.d.	n.d.	n.d.
17 Dibenzo(a,h)anthracene	53-70-3	n.d.	n.d.	n.d.	n.d.
18 Benzo(ghi)perylene	191-24-2	n.d.	n.d.	n.d.	n.d.
<b>Sum 15 PAH</b>		<b>1.5<sup>b</sup></b>	<b>0.91<sup>b</sup></b>	<b>0.65<sup>b</sup></b>	<b>0.53<sup>b</sup></b>

<sup>a</sup> For summation according to AfPS GS 2019:01 PAK the following PAH are not included: Acenaphthylene, Acenaphthene, Fluorene

<sup>b</sup> Only contents from 0.2 mg/kg were used for summation.

Polycyclic Aromatic Hydrocarbons - continued

Test results in mg/kg

Parameter	CAS-No.	Sample No. 16	Sample No. 17	Sample No. 18	Sample No. 19
1 Naphthalene	91-20-3	n.d.	n.d.	n.d.	n.d.
2 Acenaphthylene	208-96-8	n.d.	n.d.	n.d.	n.d.
3 Acenaphthene	83-32-9	n.d.	n.d.	n.d.	n.d.
4 Fluorene	86-73-7	n.d.	n.d.	0.45	n.d.
5 Phenanthrene	85-01-8	n.d.	0.12	0.81	0.12
6 Anthracene	120-12-7	n.d.	n.d.	n.d.	n.d.
7 Fluoranthene	206-44-0	n.d.	n.d.	n.d.	n.d.
8 Pyrene	129-00-0	n.d.	n.d.	n.d.	n.d.
9 Benzo(a)anthracene	56-55-3	n.d.	n.d.	n.d.	n.d.
10 Chrysene	218-01-9	n.d.	n.d.	n.d.	n.d.
Σ11+12 Benzo(b)fluoranthene + Benzo(j)fluoranthene	205-99-2 + 205-82-3	n.d.	n.d.	n.d.	n.d.
13 Benzo(k)fluoranthene	207-08-9	n.d.	n.d.	n.d.	n.d.
14 Benzo(e)pyrene	192-97-2	n.d.	n.d.	n.d.	n.d.
15 Benzo(a)pyrene	50-32-8	n.d.	n.d.	n.d.	n.d.
16 Indeno(1,2,3-cd)pyrene	193-39-5	n.d.	n.d.	n.d.	n.d.
17 Dibenzo(a,h)anthracene	53-70-3	n.d.	n.d.	n.d.	n.d.
18 Benzo(ghi)perylene	191-24-2	n.d.	n.d.	n.d.	n.d.
<b>Sum 15 PAH</b>		<b>n.d.<sup>b</sup></b>	<b>n.d.<sup>b</sup></b>	<b>0.81<sup>b</sup></b>	<b>n.d.<sup>b</sup></b>

<sup>a</sup> For summation according to AfPS GS 2019:01 PAK the following PAH are not included: Acenaphthylene, Acenaphthene, Fluorene

<sup>b</sup> Only contents from 0.2 mg/kg were used for summation.

Parameter	CAS-No.	Sample No. 20
1 Naphthalene	91-20-3	n.d.
2 Acenaphthylene	208-96-8	n.d.
3 Acenaphthene	83-32-9	n.d.
4 Fluorene	86-73-7	n.d.
5 Phenanthrene	85-01-8	n.d.
6 Anthracene	120-12-7	n.d.
7 Fluoranthene	206-44-0	n.d.
8 Pyrene	129-00-0	n.d.
9 Benzo(a)anthracene	56-55-3	n.d.
10 Chrysene	218-01-9	n.d.
Σ11+12 Benzo(b)fluoranthene + Benzo(j)fluoranthene	205-99-2 + 205-82-3	n.d.
13 Benzo(k)fluoranthene	207-08-9	n.d.
14 Benzo(e)pyrene	192-97-2	n.d.
15 Benzo(a)pyrene	50-32-8	n.d.
16 Indeno(1,2,3-cd)pyrene	193-39-5	n.d.
17 Dibenzo(a,h)anthracene	53-70-3	n.d.
18 Benzo(ghi)perylene	191-24-2	n.d.
<b>Sum 15 PAH</b>		<b>n.d.<sup>b</sup></b>

<sup>a</sup> For summation according to AfPS GS 2019:01 PAK the following PAH are not included: Acenaphthylene, Acenaphthene, Fluorene

<sup>b</sup> Only contents from 0.2 mg/kg were used for summation.



**Conclusion**

The tested sample of the presented products “**EPDM Granulates E1, E2, E7, E8, E11, E12, E13, E15, E16, E17, E18, E19, E20**” conform to the EC-Regulation 1907/2006, Annex XVII No. 50.



**Remark**

Requirements acc. to AfPS GS 2019:01 PAK (Utilization for GS-mark from July 1<sup>st</sup>, 2020) and Regulation (EC) No. 1907/2006, Annex XVII No. 50

Parameter	Category 1	Category 2		Category 3		Limit value acc. to EC regulation 1907/2006, Annex XVII No. 50	
		a. Use by children	b. other consumer products	a. Use by children	b. other consumer products	Toys, including activity toys, and childcare articles – Components rubber or plastic components that come into direct as well as prolonged or short-term repetitive contact with the human skin or the oral cavity, under normal or reasonably foreseeable conditions of use	Articles shall not be placed on the market for supply to the general public, if any of their rubber or plastic components that come into direct as well as prolonged or short-term repetitive contact with the human skin or the oral cavity, under normal or reasonably foreseeable conditions of use
Benzo[a]pyrene mg/kg	< 0.2	< 0.2	< 0.5	< 0.5	< 1		
Benzo[e]pyrene mg/kg	< 0.2	< 0.2	< 0.5	< 0.5	< 1	0.5	1
Benzo[a]anthracene mg/kg	< 0.2	< 0.2	< 0.5	< 0.5	< 1	0.5	1
Benzo[b]fluoranthene mg/kg	< 0.2	< 0.2	< 0.5	< 0.5	< 1	0.5	1
Benzo[j]fluoranthene mg/kg	< 0.2	< 0.2	< 0.5	< 0.5	< 1	0.5	1
Benzo[k]fluoranthene mg/kg	< 0.2	< 0.2	< 0.5	< 0.5	< 1	0.5	1
Chrysene mg/kg	< 0.2	< 0.2	< 0.5	< 0.5	< 1	0.5	1
Dibenzo[a,h]anthracene mg/kg	< 0.2	< 0.2	< 0.5	< 0.5	< 1	0.5	1
Benzo[ghi]perylene mg/kg	< 0.2	< 0.2	< 0.5	< 0.5	< 1	-	-
Indeno[1,2,3-cd]pyrene mg/kg	< 0.2	< 0.2	< 0.5	< 0.5	< 1	-	-
Phenanthrene, Pyrene, Anthracene, Fluoranthene, mg/kg	< 1 – Sum	< 5 – Sum	< 10 – Sum	< 20 – Sum	< 50 – Sum	-	-
Naphthalene mg/kg	< 1	< 2		< 10		-	-
Sum 15 PAH mg/kg	< 1	< 5	< 10	< 20	< 50	-	-
<b>Evaluation</b>	-	-	-	-	-	<b>pass</b>	-





---

**General note:**

This report has been prepared for the titled project or named part thereof and should not be relied upon or used for any other project without an independent check being carried out as to its suitability and prior written authority of Intertek being obtained. Intertek accepts no responsibility or liability for the consequences of this document being used for a purpose other than the purposes for which it was commissioned. Any person using or relying on the document for such other purposes agrees, and will by such use or reliance be taken to confirm his agreement to indemnify Intertek for all loss or damage resulting therefrom. Intertek accepts no responsibility or liability for this document to any party other than the person by whom it was commissioned.

We would like to point out, that Intertek can't provide legally binding assessments referring to isolated cases. The individual legal advice in Germany is reserved to the legal advisory professions and a binding interpretation is subject to the court of justice.

Copying excerpts or otherwise reproducing parts of the test report is permitted only with the consent of the laboratory accepting the order. This report pertains only to the test item(s).

All testing requests are subject to our Terms and Conditions available on [www.intertek.com](http://www.intertek.com).

END OF REPORT



# RUNNING TRACKS

## POLTRACK SPRAYCOAT ACRYLIC

Innovative, new, synthetic outdoor economical system with a shock-pad for running tracks or as outdoor system for refreshing old courts. It is applied on fine asphalt or smooth, or waterproof concrete without rising humidity issues, with first wet-pour base layer mixture, mixed at site, which consists of **RECYCLED RUBBER 858** in granulometry of 1-4mm and the polyurethane binder **POLAPLAST P13**, and the second layer (sealing layer) the acrylic pore filler **ELASTOTURF NEUTRO** on top of the cushion mixture or even directly on old, clean acrylic surfaces. The final layer (surface layer) is the mixture of highly pigmented 100% acrylic **ELASTOTURF TRACK** with colored **EPDM** rubber in fine granulometry.

It is designed for use on new asphalt or over existing colored surfaces. Ideal solution for making old track surfaces look good as new or make a new track altogether.

Priming with **POLAPLAST P10** precedes the application.



### Steps:

- POLAPLAST P10 - Polyurethane primer.**  
Applied by airless sprayer or brush.
- Mixture of POLAPLAST P13, RECYCLED RUBBER 858.**  
Applied by paving machine.
- ELASTOTURF NEUTRO- Acrylic pore filler.**  
Applied by squeegee.
- Mixture of ELASTOTURF TRACK and EPDM granules.**  
It is applied by paving machine or squeegee in two or three layers.

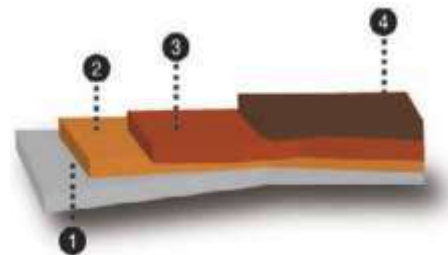

Description	Consumption
POLAPLAST P10 - Polyurethane primer.	0.15-0.2kg/m <sup>2</sup>
<b>BASE LAYER</b>	
POLAPLAST P13 - One-component, polyurethane binder.	1.1kg/m <sup>2</sup>
RECYCLED RUBBER 858 in granulometry of 1-4mm.	6kg/m <sup>2</sup>
<b>SEALING LAYER</b>	
ELASTOTURF NEUTRO - Acrylic pore filler.	1.3-2.5kg/m <sup>2</sup>
<b>TOP LAYER</b>	
ELASTOTURF TRACK - 100% modified acrylic.	1kg/m <sup>2</sup> in 2 layers for 2mm 1.5kg/m <sup>2</sup> in 3 layers for 3mm
EPDM 856 in granulometry of 0.5-1.5mm.	0.9kg/m <sup>2</sup>

## **POLTRACK SPRAYCOAT ACRYLIC** **Running track spray-coat system**

---



Innovative, new, synthetic outdoor economical system with a shock-absorbent layer for running tracks or as outdoor system for refreshing old courts.

It is applied on fine asphalt or smooth, or waterproof concrete without rising humidity issues. The first base layer is a wet-pour mixture, mixed at site, which consists of **RECYCLED RUBBER 858** in granulometry of 1-4mm and the polyurethane binder **POLAPLAST P13**. The second layer (sealing layer) is the acrylic pore filler **ELASTOTURF NEUTRO** on top of the cushion mixture or even directly on old, clean acrylic surfaces. The final layer (surface layer) is the mixture of highly pigmented 100% acrylic **ELASTOTURF TRACK** with colored EPDM rubber in fine granulometry.

It is designed for use on new asphalt or over existing colored surfaces. Ideal solution for making old track surfaces look good as new or make a new track altogether.

Priming with **POLAPLAST P10** precedes the application.

### **Steps :**

**1. POLAPLAST P10 - Polyurethane primer.**

Applied by airless sprayer or brush.

**2. Mixture of POLAPLAST P13 and RECYCLED RUBBER 858.**

Applied by paving machine.

**3. ELASTOTURF NEUTRO- Acrylic pore filler.**

Applied by squeegee.

**4. Mixture of ELASTOTURF TRACK and EPDM granules.**

It is applied by paving machine or squeegee in two or three layers.

### **Preparation – Application**

Applied on dry asphalt surfaces (30 days old at least) or smooth concrete surfaces (30 days at least old) without arising humidity issues and free of materials that might prevent bonding e.g. dust, loose particles etc (in case of asphalt or concrete). The success in the application depends on the right preparation of the underlay and use of the material.

- **Good, dry cleaning** of the surface from dust and residues.
- Priming of the surface **with POLAPLAST P10**.
- **Good mixing of POLAPLAST P13 with the SBR granules** to create a flexible shock-absorbent layer. Application is done by paving machine.
- Follows the application of **ELASTOTURF NEUTRO** by squeegee. Consumption: 1.3-2.5kg/m<sup>2</sup>.
- Application of the mixture of **ELASTOTURF TRACK** and **EPDM** granules, applied by paving machine or squeegee in two or three layers.

### **Important Remarks**

- During temperatures over 40 degrees, ideal time for the application of **POLTRACK SPRAYCOAT ACRYLIC SYSTEM** is between 22:00 and 09:00 and the minimum bearing temperature during application and drying should be over 10<sup>0</sup>C.
- The freshly coated surface should be protected from high temperatures, wind, rain and frost for at least the first 24 hours.

### **Substrate**

**Asphalt is the safer subfloor for sport floorings for sure and must be always preferred than concrete surfaces.**

#### **A. Asphalt Substrate**

**The asphalt must have a slope of 0.7-1% and must dry for at least 30 days so that all solvents from the asphalt can evaporate.**

The asphalt sub-floor should be applied on well compacted 150mm road base sub-floor and asphalt should be laid in one layer (and not 2) in 6 to 8cm with fine and coarse aggregates (up to 15mm granulometry) like the kind of asphalt used in road construction.

So, new road-grade asphalt will have to be laid (minimum 60mm) in one layer containing coarse aggregates and then mature for 30 days at least, before any application takes place on top of the asphalt to avoid bubbles on the final layer of the sport or rubber floorings.

## Asphalt Infrastructure

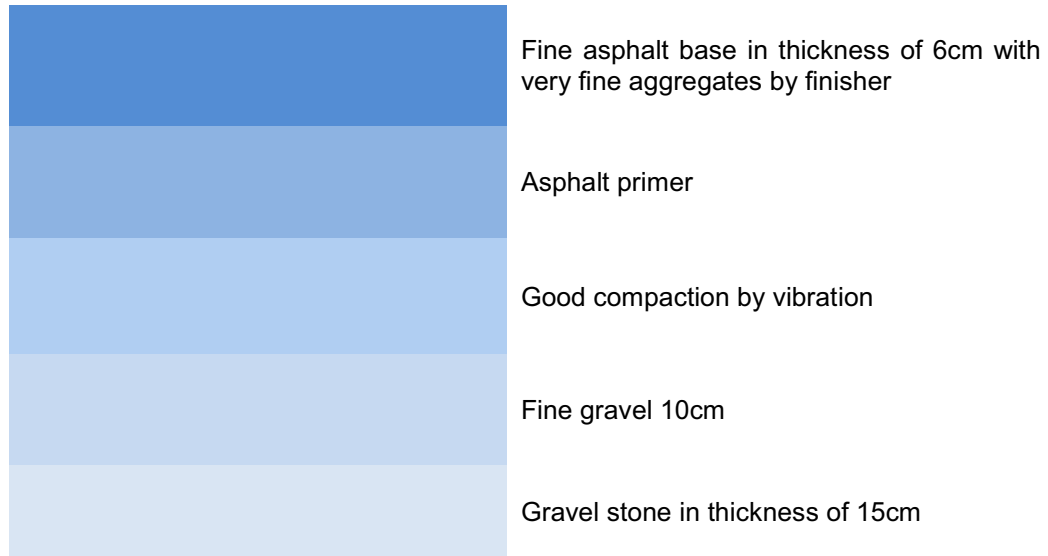

## B. Concrete Surface

**Concrete surface must be power-trowelled without cracks and must be smooth with a slope of 0.7-1% and humidity under 4% in 10cm depth of concrete.**

Concrete must also be **dry at least for 40 days** and then the application takes place if there is no rising humidity for the sub-floor. Before the application takes place, there must be proper grinding of the surface by a grinding machine to open the pores accordingly and also a measurement by special instrument to measure humidity on the surface and in 10cm under the surface.

Generally concrete is a risky sub-floor and there may be problems with rising humidity, especially in areas where the sea level is really high and when the sea is close or in areas near greenery.

**Always make expansion joints in large areas of concrete, in order to avoid uncontrollable cracks and failures.** Joints should be every 25 square meters creating a grid of 5x5 meters or close to that.

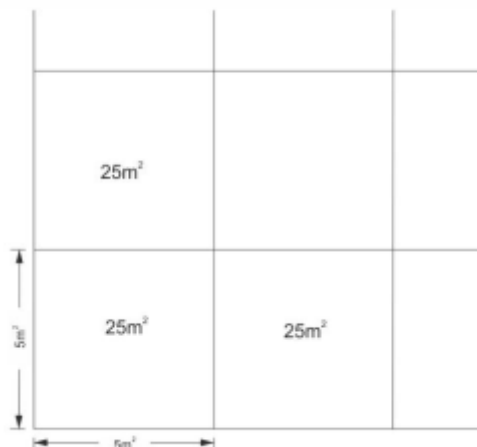



<b>SUBSTRATE REQUIREMENTS</b>	Concrete quality	at least C20/25
	Age:	at least 40 days
	Moisture content:	below 4%

**Tools:**



# POLAPLAST P10

## POLYURETHANE PRIMER ONE-COMPONENT

### GENERAL CHARACTERISTICS

**POLAPLAST P10** is a low viscosity, moisture curing, clear, polyurethane-based, one-component primer with good long term elasticity. **POLAPLAST P10** is used as an adhesive component between the sub-floor and the base layer (wet-pour mixture of SBR and POLAPLAST P13) of KDF's running track systems.

- Designed for improving adhesion of base layer (wet-pour mixture) of KDF's running track systems on asphalt and concrete surfaces without rising humidity issues.
- Penetrates in depth.
- Ideal for old and new surfaces.

### TECHNICAL DATA

Basis:	one-component polyurethane
Appearance:	liquid
Color:	transparent
Viscosity :	50 – 250 mPa s at 25°C
Density :	0.9 – 1.0 Kg/Lt at 25°C
Temperature for the application and drying of the material:	10 – 40°C

### PREPARATION-APPLICATION

**Applied on dry surfaces without rising humidity issues, free of materials that might prevent bonding e.g. dust, loose particles, grease etc (in case of asphalt or concrete).** The success in the application depends on the right preparation of the underlay and use of the material.

- **Good, dry** cleaning of the surface from dust and residues.
- Priming of the surface with **POLAPLAST P10** applied by airless sprayer equipment or brush, roller. The base layer (wet-pour mixture of SBR and **POLAPLAST P13**) of KDF's running track systems should be constructed while **POLAPLAST P10** is still a bit sticky. Curing takes place at ambient temperature by evaporation of the solvent and reaction with atmospheric moisture. High temperatures and moisture will shorten the cure time. **POLAPLAST P10** is applied in two or more layers as a thin film, and on the final layer, wet-pour mixture of SBR and **POLAPALST P13** can be applied on wet surface.
- The temperature should not fall below 10° C during curing.
- Opened drums should be used up quickly.
- Depending on the temperature and humidity, 3-5 hours is the minimum waiting time.
- The base layer (wet-pour mixture of SBR and **POLAPALST P13**) of the running track systems should be constructed while the final layer of **POLAPLAST P10** is still sticky.
- **NOTE: Rain will cause the primer to lose its function! If the primer was affected by rain, the base layer should not be constructed! Instead, the sub floor has to dry and the primer application has to be repeated.**

### CONSUMPTION

150-250 gr/m<sup>2</sup> depending on the type and the absorbency of the underlay.

---

**APPLICATION  
TOOLS**

Airless sprayer or brush or roller.

---

**PACKAGING**

Supplied in drums of 200 Kg.

---

**STORAGE**

12 months in unopened containers in dry places with minimum temperature 5°C and maximum temperature 30°C (out of sunlight).

---

**CAUTION**

The application must take place in well-aired places using protective gloves. Skin or eye contact must be avoided, otherwise wash carefully with soap and water.

**For more information consult the safety data sheet.**

---

The information given here is true, represents our best knowledge and is based not only on laboratory work, but also on field experience. However, because of numerous factors affecting results we offer this information without any guarantee and no patent liability is assumed. For additional information or questions, contact the technical department of KDF LTD.

# POLAPLAST P13

## ONE-COMPONENT POLYURETHANE BINDER

### GENERAL CHARACTERISTICS

**POLAPLAST P13** is a solvent free, clear, moisture curing one component polyurethane binder with good long term elasticity.

**POLAPLAST P13** exhibits excellent adhesion to most rubber granulates and gives a strong performance both in terms of tensile strength and durability. It is mixed with **RECYCLED RUBBER 858** for the creation of the base layer of KDF's running track systems as well as for the base coat of playgrounds, tennis courts etc.

### TECHNICAL DATA

Basis:	one-component polyurethane
Appearance:	liquid
Color:	transparent
Viscosity :	4.000 – 8.000 mPa s at 25°C
Density :	1.08 – 1.18 Kg / Lt at 25°C
Temperature for the application and drying of the material:	10 – 40 °C

### PREPARATION-APPLICATION

**Applied on dry surfaces, free of materials that might prevent bonding e.g. dust, loose particles etc (in case of asphalt or concrete).** The success in the application depends on the right preparation of the underlay and use of the material.

- **Good, dry** cleaning of the surface from dust and residues.
- Priming of the surface with **POLAPLAST P10** applied by airless sprayer and brush. The the base layer of KDF's running track systems, wet-pour shock-absorbent mixture, should be constructed while **POLAPLAST P10 is still sticky (wet in wet procedure)**. Curing takes place at ambient temperature by evaporation of the solvent and reaction with atmospheric moisture. High temperatures and moisture will shorten the cure time. Opened drums should be used up quickly.
- Good mixing of **POLAPLAST P13** and **RECYCLED RUBBER 858 (see mixing ratio below)**. Mixing should be performed using a low revolution mixer (300-600 rpm) for 1-2 min. Stirring of the mixture should be performed thoroughly near the sides and bottom of the container in order to achieve homogeneity.
- Following, the mixture is poured on the surface and spread on in thickness from 11 to 12mm using a suitable paving machine or a hand straightedge and a flat trowel. Any small irregularities in the surface may be removed by rolling the surface using a metallic cylinder.
- The temperature should not fall below 10°C during curing of **POLAPLAST P13**.
- Curing of **POLAPLAST P13** takes place at ambient temperature by reaction with atmospheric moisture. High temperatures and moisture will shorten the cure time of the **POLAPLAST P13**.
- The surface can be walked on after 12 – 18 hours at 25°C. After the surface is fully cured (depending on the temperature and humidity, the curing of the base layer mixture will take

### CONSUMPTION

1.1kg **POLAPLAST P13** mixed with 6kg **RECYCLED RUBBER 858** in granulometry of 1-4mm.

### RATIO

15.5% **POLAPLAST P13** to 84.5 % **RECYCLED RUBBER 858** in granulometry of 0.1-4mm.

---

**APPLICATION  
TOOLS**

A suitable paving machine or a hand straightedge and a flat trowel.

---

**PACKAGING**

Supplied in drums of 220 Kg. Other size on request.

---

**STORAGE**

12 months in unopened containers in dry places, out of sunlight, with minimum temperature 5°C and maximum temperature 30°C.

---

**CAUTION**

The application must take place in well-aired places using protective gloves. Skin or eye contact must be avoided, otherwise wash carefully with soap and water.

**For more information consult the material safety data sheet.**

---

The information given here is true, represents our best knowledge and is based not only on laboratory work, but also on field experience. However, because of numerous factors affecting results we offer this information without any guarantee and no patent liability is assumed. For additional information or questions, contact the technical department of KDF LTD.



# SBR RUBBER GRANULES 858

## GENERAL CHARACTERISTICS

It can be used in sports facilities as infill in synthetic grass with the parallel use of round sand and also as one of the components in case of cast applied wet-pour systems for playground floorings or as shock-pad for sport subfloors in athletic tracks and sports fields.

Rubber granule is derived from car and truck tires. During processing, the tires are mechanically granulated, removing all metal and synthetic fibers, as well as any other foreign part contained in there with specially designed sieves, so as to produce a 99.99% clear rubber with high quality.

## PROPERTIES

- 100% recyclable
- Long life
- Resistance to adverse weather conditions
- High shock absorbency and vibration damping
- High abrasion resistance

## PREPARATION-APPLICATION

In sports facilities and playgrounds to ensure flexibility of surface and vibration absorption.

## TECHNICAL CHARACTERISTICS

### Granulometry 1-3mm

DENSITY:	0.48kg/cm <sup>3</sup>
SPECIFIC GRAVITY	1.20+/- .05 (Water = 1.0)
HARDNESS	60
HUMIDITY(%)	<0.65
ELASTICITY	100% - No change
RESISTANCE	113N/cm - Excellent

## PACKAGING

Packaging is available in big-bags -1 ton in following sizes:

Grain size	0,5-1,5 mm
Grain size	0,5-2,5 mm
Grain size	0.5-4.0 mm
Grain size	2-8 mm
Grain size	8-20 mm
Grain size	80-50 mm
Grain size	80-120 mm

# ELASTOTURF NEUTRO

SPECIAL, ELASTIC, COATING FOR INTERNAL AND EXTERNAL SPORT FIELDS

## GENERAL CHARACTERISTICS

**ELASTOTURF NEUTRO** is acrylic-based, elastic, colored, non-slip coating for external and internal sport fields.

- It can be combined with prefabricated shock-absorbent rolls in thickness 4-14mm or wet-pour mixtures.
- Ideal for basketball, volleyball, handball, football and tennis external courts. Suitable for sports centers, schools, fitness centers, pavements, hallways.
- Applied easily, having low cost.
- Provides a safe, high quality game.

## TECHNICAL DATA

Basis:	one-component acrylic resin
Appearance:	viscous liquid
Colors:	neutral
Viscosity:	35.000 – 45.000 mPa s at 25°C
Density:	1.75 – 1.85 Kg/Lt
Temperature for the application and drying of the material:	10 – 40°C
Walkability:	after 24 hours

## PREPARATION-APPLICATION

**Applied only on dry surfaces, without rising humidity issues and free of materials that might prevent bonding e.g. dust, loose particles, grease etc.** The success in the application depends on the right preparation of the underlay and use of the material.

- **Good, dry** cleaning of the surface from dust and residues with vacuum cleaner and squeegees.
- Application of the material on prefabricated shock-absorbent rolls in thickness 4-12mm or a rubber mixture of **SBR plus PU BINDER**, for sealing the pores of the underlay and plasticize the surface.
- Depending on the ambient temperature, **ELASTOTURF NEUTRO** is diluted with 2-5% water, prior to application, in order to achieve better fluidity. The next layer follows the other after the previous dries.

## CONSUMPTION

1.3 - 2.5 kg/m<sup>2</sup>.

## APPLICATION TOOLS

Special squeegees. Tools should be cleaned with **WATER** immediately after use.

## PACKAGING

Supplied in barrels of 200 kg.

---

## **STORAGE**

12 months in unopened containers in dry places with minimum temperature 5°C and high temperature 30 °C (avoid sunlight).

---

## **REMARKS**

- **ELASTOTURF NEUTRO** should be applied in layers smaller than 0.6-0.7mm in order to avoid cracks on the material, due to the rapid evaporation of water. Lining thickness more than 1mm is achieved only by repeated layers.
  - During summer, ideal time for the application of **ELASTOTURF NEUTRO (850)** is between 6:00-9:00 a.m. and temperature less than 30 C, while in the winter, the minimum bearing temperature during application and drying should be 10 C.
  - The freshly coated surface should be protected from high temperatures, wind, rain and frost for at least the first 24 hours.
  - In case it gets damaged, it is simply repaired and recoated on the spot.
- 

## **CAUTION**

The application must take place in well-aired places using protective gloves. Skin or eye contact must be avoided, otherwise wash carefully with soap and water.

**For more information consult the material safety data sheet.**

---

The information given here is true, represents our best knowledge and is based not only on laboratory work, but also on field experience. However, because of numerous factors affecting results we offer this information without any guarantee and no patent liability is assumed. For additional information or questions, contact the technical department of KDF LTD.

# ELASTOTURF TRACK

## GENERAL CHARACTERISTICS

**ELASTOTURF TRACK** is a highly pigmented 100% acrylic polymer concentrate, filled with colored EPDM rubber in fine granulometry. It is designed for use for **POLTRACK SPRAYCOAT ACRYLIC** System.

Ideal for making an older track look new, or to be used on new construction, **ELASTOTURF TRACK** provides a low cost solution.

---

## TECHNICAL DATA

Basis:	one-component acrylic resin
Appearance:	viscous liquid
Colors:	neutral
Viscosity:	4.000 – 9.000 mPa s at 25°C
Density:	1.44 – 1.54 Kg/Lt
Temperature for the application and drying of the material:	10 – 40°C after 24 hours
Walkability:	

---

## PREPARATION-APPLICATION

- Application should be done with a spray coat machine.
  - Substrate must be completely cured prior applying **ELASTOTURF TRACK**.
  - After **ELASTOTURF NEUTRO** dries, follows the application of **ELASTOTURF TRACK** mixed with EPDM 0.5 -1.5 mm (mixing ratio 50:50 by weight).
  - The application should take place in 2-3 layers.
- 

## CONSUMPTION

1-1.5kg/m<sup>2</sup> in two or three layers.

---

## PACKAGING

150 Kg Barrels.

---

## CAUTION

The application must take place in well-aired places using protective gloves. Skin or eye contact must be avoided, otherwise wash carefully with soap and water.

**For more information consult the material safety data sheet.**

---

# EPDM 856

## RUBBER GRANULES

### GENERAL CHARACTERISTICS

Type of material: Rubber EPDM

Grain size: 0.8-2.5mm,1.0-3mm,1.0-4mm or others

### PERFORMANCE OF SAMPLE 25%

Test item	Performance
Tensile strength (Mpa)	>4.3
Elongation at break (%)	>735
Hardness (shore A)	60-65
Specific gravity (kg/cm <sup>3</sup> )	1.45 ± 0.05

### PREPARATION-APPLICATION

**EPDM 856** granules are basically used for wet pour colored playground floorings (granulometry 1-3mm), for flexible multipurpose outdoor courts in 10-20 mm, SYSTEM COLORFLEX, and in applications of running track system such as POLTRACK SANDWICH SYSTEM (granulometry 1-3mm) and POLTRACK SPRAYCOAT SYSTEM (granulometry 0.5-1.5 mm).

Can be used also as infill of artificial synthetic turf or in the production of epdm rubber tiles or even loose lay and around swimming pools as a flexible flooring.

### REMARKS

- It is highly suggested (especially in hot climates like in Middle East countries) the usage of the UV-resistance top coat **POLYSPORT XP 1069**, which gives a strong UV protection and doesn't allow the change of color to occur. **POLYSPORT XP 1069** is produced in all EPDM colour range and needs to be applied with 0,4 kg/m<sup>2</sup> in two crossing layers by airless sprayer or rollers.
- In case that there is no usage of UV-resistance polyurethane aliphatic coating strong shades like blue, rose, orange, grey etc will alter.
- All technical data are correct to the best of our knowledge and are intended to help our customers.
- They do not constitute a guarantee of qualities and provide on bases for legal liability.
- We advise our customers to choose the PU-binder according to the type and color of the EPDM rubber granules.

# **CLEANING AND MAINTENANCE MANUAL FOR :**

## **-OUTDOOR SPORTS FLOORING**

## **-PLAYGROUND FLOORINGS**

### **Introduction**

Outdoor sports floorings and playground surfaces are made of extremely durable polymers, designed to withstand extreme climate conditions and intense use. However for the best maintenance of the rubber and sport surface a regular check (once in 6 months) is required and the maintenance of the surface is necessary to preserve the suitability of the surface (sand pits, areas of vegetation) which could leave algae, moss and leaf deposits.

The installer's guarantee will usually be conditional on the recommended maintenance requirements being carried out with due diligence.

### **Maintenance**

Maintenance procedures are necessary to preserve the lifetime of the surface and to ensure that:

- The Surface is kept clean.
- The Surface is safe for intense diverse use and all types of users.
- The facility looks attractive.

These objectives are achieved by :

- Sweeping/scraping/removing leaves and other debris and foreign matter from the surface.
- Regularly washing the surface to remove contaminants such as grime, grease, algae, moss, sand, foreign matter etc.
- Applying suitable treatments of moss-killer and/or algaecide
- Periodically removing weed growth from the perimeter kerb lines.

### **Maintenance Equipment**

Leaves, pine needles and other detritus should not be allowed to remain on the surface for any length of time. If this does happen, they rapidly rot down, forming a contaminating "skin" on the surface and providing a growth media for algae and moss.



A mechanical leaf-sweeper or vacuum cleaner is ideal for removing vegetable matter and dirt. Restricted areas may have to be cleaned by hand.

The equipment should be well maintained and carefully operated to avoid contamination of, or physical damage to, the surface. Spillage of fuel or lubricating oil will damage the surface.

The pressure loading on the surface as well as the friction and shearing loads have to be kept to a minimum to prevent damage to the surface. Large pneumatic tires and soft brushes along with careful operating of the machinery, is recommended to avoid any damage on the surface.

A mechanical leaf-sweeper or vacuum cleaner is ideal for removing vegetable matter and dirt. Restricted areas may have to be cleaned by hand.

The equipment should be well maintained and carefully operated to avoid contamination of, or physical damage to, the surface. Spillage of fuel or lubricating oil will damage the surface.

The pressure loading on the surface as well as the friction and shearing loads have to be kept to a minimum to prevent damage to the surface. Large pneumatic tires and soft brushes along with careful operating of the machinery, is recommended to avoid any damage on the surface.

At least once a year it is advisable to wash the surface with low-pressure jetting apparatus.

Polymeric surfaces can withstand low pressures without suffering damage.

Note that no aggressive chemical cleaning agents (chlorine or acid-based) should be used; normal neutral market detergents are adequate.

### **Prevention of damages**

To ensure maintaining the surfaces to a high standard, restrictions should be imposed on the use of the surface.

- In general no vehicles should be permitted to drive on the outdoor sports/playground surface.
- No chemicals, oils, fuel or solvents should be allowed on the surface.
- No fireworks or cigarettes or inadequate shoes should be allowed on the synthetic surface.

### **Damages and renovation**

The lifetime of an outdoor sports/playground surface depends on its quality, usage and level of maintenance. In general a normal outdoor sports/playground surface used intensively will last 7 to 12 years (depending on the system) before renovation is required. Renovation should be carried out periodically to prevent the total damage of the surface, which would necessitate complete renewal.

Renovation must be carried out by professional and skilled contractors with thorough knowledge of this type of work

There are different procedures for the renovation of a surface:

- Complete renewal by replacing the worn-out surface with a new sports flooring system.
- Re-topping or sealing with adequate polyurethane or acrylic materials.
- Partial re-topping in particular worn-out areas.

Information contained in this document is of general nature and is given in good faith. As the state of the surface and the use and application of the various cleaning products, is out of our control, our advice for individual cases, verbal, written or based on tests, does not exempt the applicator from the testing the suitability of the cleaning products and their applications.

The above maintenance guide refers to **the below KDF systems:**

**-SYSTEM SPORTFLOOR**

**-SYSTEM FLEXFLOOR**

**-SYSTEM POLYFLEX AEL EX**

**-SYSTEM POLYFLEX WET POUR EX**

**-SYSTEM POLYFLEX PU EX**

**-SYSTEM POLYFLEX WET POUR AEL EX**

**-SYSTEM SMARTFLOOR**

**-SYSTEM SAFEPOL**

**-SYSTEM SAFEPOL COLORED**

**-SYSTEM SAFEPOL WITH TPV GRANULES**

**-SYSTEM SAFEPOL SANDPROOF**

**-SYSTEM QUICKLAWN PLAYGROUND SAFEPOL**

**-SYSTEM QUICKLAWN PLAYGROUND SAFEPOLSANDPROOF**

**-SYSTEM COLORFLEX**

**-SYSTEM SPORTGROUND-EX**

**-SYSTEM POLTRACK SPRAYCOAT**

**-SYSTEM POLTRACK SPRAYCOAT SEALED**

- SYSTEM POLTRACK SANDWICH**
- SYSTEM POLTRACK SANDWICH IN ROLLS**
- SYSTEM POLTRACK FULL PU**
- SYSTEM POLTRACK ACRYLIC**
- SYSTEM POLTRACK JOGGING TRACK**
- SYSTEM POLTRACK PU JOGGING TRACK**
- SYSTEM POLTRACK JOGGING TRACK SBR**
- SYSTEM POLTRACK JOGGING TRACK SHOCK-PAD - EPDM**
- SYSTEM POLTRACK JOGGING TRACK SHOCK-PAD - ISOPOL**
- SYSTEM POLTRACK EQUINE**

# CERTIFICATES OF KDF Ltd



ISO KDF Ltd



POLTRACK SPRAYCOAT



POLTRACK SANDWICH



POLYFLEX AEL-EX



FLEXFLOOR-EX



SPORTFLOOR-EX



SPORTFLOOR-EX FAST



POLTRACK EQUINE



BADMINTON POLYFLEX PU

# CERTIFICATES OF KDF Ltd



POLYFLEX PU



SPORTGROUND-EX



POLTRACK JOGGING TRACK



FIBA POLYFLEX PU



SAFEPOL



SAFEPOL



EPDM 856



SAFEPOL SANDPROOF



SAFEPOL SANDPROOF



# CERTIFICATES OF KDF Ltd



PLAYPREM



POLTRACK FULL-PU



PU GRASS 149



PAH TEST REPORT  
PU BINDER 1118



PAH TEST REPORT  
PU BINDER 1125 AL



PAH TEST REPORT  
EPDM 856



PAH TEST REPORT  
PU BINDER plus EPDM 856