

# KDF

Sports Flooring Systems & Building Materials  
45 YEARS OF EXPERIENCE

## SAFEPOL COLORED SYSTEM PLAYGROUND FLOORINGS



[www.kdf.gr](http://www.kdf.gr)

**KDF LTD** ([www.kdf.gr](http://www.kdf.gr)) is one of the most dynamic and export-oriented Greek companies (currently activated in more than 50 countries in 4 continents), based in Greece (EU) and U.A.E too, with production facilities and warehouses in both countries for acrylic and polyurethane materials.

**We are experts in sports, industrial and decorative flooring products and systems**, with huge experience in Europe, Africa, Asia, Middle East and India as well.

Our export horizon is expanding rapidly and our goal is to stand out as a model of flexibility and competitiveness. The company, being one of the pioneer companies in the sector of sports flooring systems and building materials and giving particular attention to providing a fully upgraded range of products and services, provides certified systems by **ITF, IAAF, EU norms, LNE, LABOSPORT, ISASPORT, to name but a few.**

**Our systems are approved in many ministries like:**

- Ministry of Education in U.A.E
- Ministry of Education in K.S.A
- Ministry of Education in Oman
- Ministry of Education in Kuwait and many other institutes like
- Oman Royal Police
- Aramco, K.S.A
- Musanada in U.A.E
- Municipality of Doha
- Municipality of Dubai, Abu Dhabi, Sharjah and many others institutions.

KDF goes far beyond trade, providing consultancy in marketing and also technical support all the way, from the costing till the finalization of the project. Operating under the requirements of ISO 9001/2015 for production, trade and also application, we make sure our products are first applied successfully at site by our own people before we launch them abroad.

Therefore, our systems have all stood the real life test in different climates, from Middle East till Russia, and this is one of our main assets, enabling us to provide full and vertical technical support from specifying to final application plus supervision when required or even full application and costing.

**We invite you to discover a world of sports flooring expertise and solutions.**

VIEW OUR NEW SPORTS CATALOGUE



**KDF - Kataskeves Dapedon LTD**  
e : [exports@kdf.gr](mailto:exports@kdf.gr)  
w : [www.kdf.gr](http://www.kdf.gr)

1 Papanikolaou Ave, Pefka  
57010, Thessaloniki, Greece  
t / f : 0030 2310 829598

# INDICATIVE REFERENCE LIST OF PROJECTS

- 12 SCHOOLS IN U.A.E, MINISTRY OF EDUCATION(THROUGH VARIOUS CONTRACTORS) - 40000m<sup>2</sup> EPDM Rubber flooring
- UNIVERSITY OF DAMMAM - KSA - 13000m<sup>2</sup> - Acrylic cushion floorings
- KING ABDULLAH BASE AIR DEFENSE - TAIF, KSA - 12600 m<sup>2</sup> - Running track
- KING FAHD UNIVERSITY OF PETROLEUM AND MINERALS-DHARAN, KSA-12400m<sup>2</sup>-Rubber outdoor flooring
- RUNNING TRACK - K.S.A- 11000 m<sup>2</sup> - Running track, POLTRACK SANDWICH system
- GEMS SCHOOL - DUBAI, U.A.E - 10000 m<sup>2</sup> - Running track
- PASARGRAD WHOLESALE MARKET-IRAN - 10000 m<sup>2</sup> - Decorative flooring
- YAS ISLAND, ABU DHABI, U.A.E - 10000m<sup>2</sup> Bicycle track
- ALEXANDRIA STADIUM - ALEXANDRIA, EGYPT - 8500 m<sup>2</sup> - Running track
- SALAM STREET & MINA ROAD, ABU DHABI, U.A.E - 8000m<sup>2</sup> Bicycle track, Sportground-Ex system
- KING FAHAD NAVAL BASE - JUBAIL, KSA - 8000m<sup>2</sup> - Running track
- MUNICIPALITY OF VELVENTO - KOZANI, GREECE - 8000m<sup>2</sup>, Running track
- ABBHA, KSA - 7600m<sup>2</sup> - Running track
- MUNICIPALITY OF ZENICA - ZENICA, BOSNIA& HERZEGOVINA - 7500m<sup>2</sup>, Poltrack Spraycoat, Running track
- ADNOC SCHOOLS - U.A.E - 7000m<sup>2</sup> - Safepol system
- ATLAS CENTER-BAM, IRAN - 7000 m<sup>2</sup> - Decorative flooring
- RUNNING TRACK - SUDAN - 7000 m<sup>2</sup> - Running track, POLTRACK SPRAYCOAT system
- CORNISH, JEDDAH, K.S.A - 6000m<sup>2</sup> Bicycle track Sportground-Ex system
- YOKOGAWA ELECTRIC CORPORATION-DHAHRAN TECHNO VALLEY-DAMMAM, KSA - 5500m<sup>2</sup>- Epoxy antistatic floorings
- AMITY INTERNATIONAL SCHOOL - ABHU DHABI, U.A.E - 5500m<sup>2</sup>, Poltrack Spraycoat, Running Track
- SHUQAIQ WATER AND ELECTRICITY COMPANY - JIZAN, KSA - 5400 m<sup>2</sup> - acrylic courts
- TALEEM UPTOWN SCHOOLS - DUBAI, UAE - 5400m<sup>2</sup>-Acrylic sports courts systems
- SAUDI AIR FORCE - KSA - 5250 m<sup>2</sup> - Acrylic coating elastoturf, running track
- RUNNING TRACK - K.S.A - 5000 m<sup>2</sup> - Running track, POLTRACK SANDWICH system
- AL HAMRA, RAS AL KHAIMAH, U.A.E - 5000m<sup>2</sup> Bicycle track, Sportground-Ex system
- AIRBASE IN TAIF - KSA - 5000 m<sup>2</sup> - Running track
- DEPARTMENT OF EDUCATION ASIR REGION - KHAMIS, KSA - 4500 m<sup>2</sup> - Running track
- SERVIA STADIUM - KOZANI, GREECE - 4500m<sup>2</sup>, Running track
- COMMUNITY COLLEGE - KHAMIS, KSA - 4200 m<sup>2</sup> - Running track
- MULTIPLE RUNNING TRACKS - ALGERIA - 40000 m<sup>2</sup> - Running track, POLTRACK SPRAYCOAT system
- EMIRATES INTERNATIONAL SCHOOL - DUBAI, U.A.E - 4000m<sup>2</sup> - Safepol System, Playground flooring
- SPORTS CLUB CENTER GLIFADA - ATHENS, GREECE - 4000m<sup>2</sup>- Poltrack Spraycoat, Running Track
- HH KHALID BIN BANDAR - RIYADH, KSA - 3800 m<sup>2</sup> - Volleyball/basketball rubber courts
- ANATOLIA GOLLEGE - THESSALONIKI, GREECE - 3600m<sup>2</sup>, Running track
- AIMARJAN ASLAND – PARTIAL - 3600m<sup>2</sup>- Poltrack Sandwich, Running Track
- RUNNING TRACK - ISRAEL - 3500 m<sup>2</sup> - Running track, POLTRACK SANDWICH system
- SPORTS CLUB CENTER KISSAMOS - CRETE, GREECE - 3200m<sup>2</sup>- Poltrack Sandwich, Running Track
- AL LUSAIL SPORTS CLUB - DOHA, QATAR - 3200m<sup>2</sup> - Jogging track
- SPORTS CLUB CENTER - SERVIA, GREECE - 3200m<sup>2</sup> - Poltrack Sandwich, Running Track

**-KING KHALID UNIVERSITY - ABHA, KSA - 3100 m<sup>2</sup> - Running track**

**-SPORTS CLUB CENTER "PAPAGOU" - ATHENS, GREECE - 3000m<sup>2</sup> - Poltrack Sandwich, Running Track**

**-PANORAMA SPORTS COMPLEX - THESSALONIKI, GREECE - 3000m<sup>2</sup>, Running track**

**-INDIAN ARMY - SAGAR, INDIA - 2800m<sup>2</sup>- Acrylic sports courts**

**-ALL SAINTS SCHOOL - MUMBAI, INDIA - 2700 m<sup>2</sup> - PU outdoor sports flooring and running track**

**-INDIAN INSTITUTE OF SCIENCE EDUCATION AND RESEARCH-BHOPAL,INDIA-2700m<sup>2</sup>-Acrylic sports courts**

**-OUR OWN GOLF SCHOOL - 2700m<sup>2</sup>- Poltrack Spraycoat, RunningTrack**

**-AL RAYAN, QATAR - 2500 m<sup>2</sup> - Running track, POLTRACK SANDWICH system**

**-ALHOSN SPORTS COMPLEX - 2400 m<sup>2</sup> - Running track, POLTRACK SANDWICH system**

**-TEACHERS COLLEGE - ABHA, KSA - 2050 m<sup>2</sup> - Running track**

**-MUSAB BIN OMAIR BOYS SCHOOL - BIN OMRAN, QATAR - 2050 m<sup>2</sup> - PU outdoor sport flooring**

**-BURAIRAT SCHOOL - RAK, UAE - 2000 m<sup>2</sup> - Running track**

**-HADAYEK ALAHRAM CLUB - GIZA, EGYPT - 2000m<sup>2</sup>, PU outdoor sports flooring, POLYFLEX PU-EX WET-POUR system**

**-AL SAILIYA BOYS SCHOOL - AL SAILIYA, QATAR - 2000 m<sup>2</sup> - Polyurethane, outdoor sport flooring**

**-KING KHALID UNIVERSITY - ABHA, KSA - 2000 m<sup>2</sup> - Volleyball/basketball rubber courts**

**-HH KHALID BIN BANDAR - RIYADH, KSA - 2000 m<sup>2</sup> - Volleyball/basketball rubber courts**

**-RAWDA RASHEED PRIMARY SCHOOL FOR BOYS - 2000 m<sup>2</sup>**

**-AL WAKAIR BOYS SCHOOL - AL WAKRAH, QATAR - 1950 m<sup>2</sup> - Polyurethane, outdoor sport flooring**

**-THE LAKE DISTRICT - PUNE, INDIA - 1950m<sup>2</sup>- Acrylic sports courts**

**-PRESIDENTIAL GUARD COMMAND MAHAWI - ABU DHABI, UAE - 1900m<sup>2</sup> - Football court**

**-UNITED (SABIC) SPORTS CLUB - 1900 m<sup>2</sup> - Rubber flooring**

**-SHOOLS MINISTRY OF EDUCATION - KHAMIS, KSA - 1800 m<sup>2</sup> - Rubber flooring**

**-AL MAJAD AMPHITHEATER - SHARJA, UAE - 1800m<sup>2</sup> - Certified Jogging track**

**-QASSIM UNIVERSITY - KSA - 1800 m<sup>2</sup> - Polyurethane sports flooring**

**-AL QADSIYA MODEL INDEPENDENT SCHOOL - ALWAAB, QATAR - 1770 m<sup>2</sup> - PU outdoor sport flooring**

**-AL WAHDA SPORT ACADEMY CLUB - ABU DHABI, UAE - 1700 m<sup>2</sup> - Acrylic sports system**

**-ALSARH SCHOOLS OF CIVIL - RIYADH, KSA - 1650m<sup>2</sup> - PU glue/Soccer field**

**-GD GOENKA PUBLIC SCHOLL - PURNIA, INDIA - 1630m<sup>2</sup>- Acrylic sports courts**

**-SPA RESORT DERENIVSKUPIA KI - UZHGOROD, UKRAINE - 1600 m<sup>2</sup> - Flexfloor-ex system, volleyball court**

**-THE MILITARY HOSPITAL - RIYADH, KSA - 1560 m<sup>2</sup> - Volleyball/basketball rubber courts**

**-THE MILITARY HOSPITAL - RIYADH, KSA - 1560 m<sup>2</sup> - Pu glue-PU sports flooring**

**-AL FORSHAN SPORTS CENTRE - ABU DHABI, U.A.E - 1500m<sup>2</sup> - Smartfloor system, Acrylic flooring**

**-SCHOOL IN AL WAKRA CITY - DOHA, QATAR - 1500 m<sup>2</sup> - Playground flooring**

**-IRAQ ARMY CAMP - IRAQ - 1500m<sup>2</sup> - Acrylic flooring in 2,2mm**

**-SCHOOL IN AL WAKRA CITY - DOHA, QATAR - 1500 m<sup>2</sup> - Playground flooring**

**-PROJECT GREEN LAND - DUBAI, UAE - 1500 m<sup>2</sup> - Jogging track**

**-UP TOWN SCHOOL - 1500m<sup>2</sup>- Poltrack Spraycoat, RunningTrack**

**-INDIAN AIR FORCE - ALLAHABAD, INDIA - 1450m<sup>2</sup>- Acrylic sports courts**

**-DUBAI MODERN HIGH SCHOOL - DUBAI, UAE - 1375 m<sup>2</sup> - Acrylic sports courts**

**-PROJECT ECOGREEN - DUBAI, UAE - 1350 m<sup>2</sup> - Jogging track**

**-POLICE COMPLEX BARRACKS NIZWA - OMAN- 1300 m<sup>2</sup> - Colorflex, PU sport flooring**

**-POLICE COMPLEX BARRACKS AL AJAIZ - OMAN - 1300 m<sup>2</sup> - Colorflex, PU sport flooring**

**-POLICE COMPLEX BARRACKS KATMATMILAH SITE - OMAN- 1300 m<sup>2</sup> - Colorflex, PU sport flooring**  
**-POLICE COMPLEX BARRACKS SUWAIQ - OMAN - 1300 m<sup>2</sup> - Colorflex, PU sport flooring**  
**-POLICE COMPLEX BARRACKS AL KAMIL - OMAN - 1300 m<sup>2</sup> - Colorflex, PU sport flooring**  
**-PLAYGROUND FLOORING - BAHRAIN - 1300m<sup>2</sup> - Safepol system**  
**-POLICE COMPLEX BARRACKS SHINAS - OMAN - 1300 m<sup>2</sup> - Colorflex, PU sport flooring**  
**-POLICE COMPLEX BARRACKS BHALA - OMAN - 1300 m<sup>2</sup> - Colorflex, PU sport flooring**  
**-POLICE COMPLEX BARRACKS MUDHAIBI - OMAN - 1300 m<sup>2</sup> - Colorflex, PU sport flooring**  
**-POLICE COMPLEX BARRACKS THUMRAIT - OMAN - 1300 m<sup>2</sup> - Colorflex, PU sport flooring**  
**-POLICE COMPLEX BARRACKS AL KHOUDH - OMAN - 1300 m<sup>2</sup> - Colorflex, PU sport flooring**  
**-POLICE COMPLEX BARRACKS MAHDAH - OMAN - 1300 m<sup>2</sup> - Colorflex, PU sport flooring**  
**-POLICE COMPLEX BARRACKS BID BID - OMAN - 1300 m<sup>2</sup> - Colorflex, PU sport flooring**  
**-POLICE COMPLEX BARRACKS AL KHABOORA - OMAN - 1300 m<sup>2</sup> - Colorflex, PU sport flooring**  
**-POLICE COMPLEX BARRACKS DHANK - OMAN - 1300 m<sup>2</sup> - Colorflex, PU sport flooring**  
**-POLICE COMPLEX BARRACKS HAFEET - OMAN - 1300 m<sup>2</sup> - Colorflex, PU sport flooring**  
**-POLICE COMPLEX BARRACKS AUQAD - OMAN - 1300 m<sup>2</sup> - Colorflex, PU sport flooring**  
**-POLICE COMPLEX BARRACKS SUMAIL - OMAN - 1300 m<sup>2</sup> - Colorflex, PU sport flooring**  
**-ALHALAFI BREAK - RIYADH, KSA - 1276 m<sup>2</sup> - Rubber flooring**  
**-GI-DHOFAR BEACH RESORT & SPA - OMAN - 1225 m<sup>2</sup> - Colorflex, PU sport flooring**  
**-RLS BASIC EDUCATION SCHOOL SOHAR - OMAN - 1225 m<sup>2</sup> - Colorflex, PU sport flooring**  
**-MIXED BASIC EDUCATION SCHOOL AL QABIL - OMAN - 1225 m<sup>2</sup> - Colorflex, PU sport flooring**  
**-BOYS BASIC EDUCATION SCHOOL BARKHA - OMAN - 1225 m<sup>2</sup> - Colorflex, PU sport flooring**  
**-GIRLS BASIC EDUCATION SCHOOL MUDHAIBI - OMAN - 1225 m<sup>2</sup> - Colorflex, PU sport flooring**  
**-MIXED BASIC EDUCATION SCHOOL AL AMERAT - OMAN - 1225 m<sup>2</sup> - Colorflex, PU sport flooring**  
**-UMSALAMA GIRLS SCHOOL - AL RAYYAN, QATAR - 1200 m<sup>2</sup> - Polyurethane, outdoor sport flooring**  
**-SHERATON PARK - DOHA, QATAR - 1200 m<sup>2</sup> - Playground flooring**  
**-RAWDA BIN JASSIM SCHOOL - AL AZIZIYAH, QATAR - 1200 m<sup>2</sup> - Polyurethane, outdoor sport flooring**  
**-GEMS WESTMINISTER SCHOOL - DUBAI, U.A.E - 1200 m<sup>2</sup> - Acrylic sports courts**  
**-SILVER SPORTS CLUB - INDIA - 1200m<sup>2</sup>- Acrylic sports courts**  
**-OUR OWN SCHOOL - SHARJA, U.A.E - 1200m<sup>2</sup> - Acrylic sports courts**  
**-SHARJAH FOOTBALL CLUB - SHARJAH, UAE - 1200 m<sup>2</sup> - Polyurethane basketball courts**  
**-SHERATON PARK - DOHA, QATAR - 1200 m<sup>2</sup> - Playground flooring**  
**-SYMBIOSIS COLLEGE - INDIA - 1180m<sup>2</sup>- Acrylic sports courts**  
**-PROFESSOR ABDULAZIZ ANQARI - RIYADH, KSA -1150m<sup>2</sup> - PU glue/Socccer field**  
**-AL SAQID ISLAMIC ENGLISH SHCOLL-DUBAI,UAE-1100m<sup>2</sup>- Acrylic flooring, WET-POUR POLYFLEX AEL-EX**  
**-FIRST POINT SCHOOLS - DUBAI, UAE - 1100m<sup>2</sup> - Acrylic sports courts**  
**-MAADI BRITISH SCHOOL- EGYPT - 1100m<sup>2</sup>, Multipurpose court, COLORFLEX system**  
**-DUBAI AMERICAN ACADEMY - DUBAI, UAE - 1080 m<sup>2</sup> - Acrylic sports court**  
**-PRELUDE PUBLIC SCHOOL - AGRA, INDIA - 1070m<sup>2</sup>- Acrylic sports courts**  
**-ALMGBAL BREAK - RIYADH, KSA - 1050 m<sup>2</sup> - Rubber playground**  
**-BANIYAS CLUB AND AL AIN ENGLISH SPEAKING SCHOOL - ABU DHABI, UAE - 1000m<sup>2</sup> - Acrylic flooring**  
**-MINISTRY OF EDUCATION - DAMMAM, KSA - 1000 m<sup>2</sup> - PU indoor multipurpose sports flooring**  
**-SHEIKH OBEID MAKTHOUM PALACE - 1000m<sup>2</sup> - Outdoor polyurethane flooring**  
**-INDIAN AIR FORCE - AGRA, INDIA - 1000m<sup>2</sup>- Acrylic sports courts**  
**-INDIAN AIR FORCE - LUCKNOW, INDIA - 1000m<sup>2</sup> - Acrylic sports courts**

**-MULTIPURPOSE POLYURTEHANE INDOOR COURTS - F.Y.R.O.M - 1000m<sup>2</sup> - Polyflex PU-In system**  
**-SODIC PROJECT - EGYPT - 1000m<sup>2</sup>, Multipurpose court, COLORFLEX system**  
**-INDIAN AIR FORCE - VARANASI, INDIA - 1000m<sup>2</sup> - Acrylic sports courts**  
**-INTERNATIONAL SCHOOL OF CREATIVE SCHIENCE - SHARJAH, U.A.E - 1000m<sup>2</sup> - Safepol System**  
**-INDIAN AIR FORCE - BIHTA, INDIA - 1000m<sup>2</sup> - Acrylic sports courts**  
**-INDIAN AIR FORCE - DARBHANGA, INDIA - 1000m<sup>2</sup> - Acrylic sports courts**  
**-AL AIN INDIAN SCHOOL - AL AIN, UAE - 1000m<sup>2</sup> - Football court**  
**-DUBAI SCHOLRAS PRIVATE SCHOOL - DUBAI, U.A.E - 1000m<sup>2</sup> - Acrylic flooring in 2,2mm**  
**-COMMUNITY COLLEGE - KHAMIS, KSA - 940 m<sup>2</sup> - Polyurethane indoor multipurpose sports flooring**  
**-GEMS METROPOLE SCHOOL - DUBAI, U.A.E - 900 m<sup>2</sup> - Playground flooring**  
**-MINISTRY OF EDUCATION - ABHA, KSA - 900 m<sup>2</sup> - Polyurethane indoor multipurpose sports flooring**  
**-BAB AL SHAMS SPA HOTEL - DUBAI, UAE - 900m<sup>2</sup> - Football court**  
**-KING KHALID UNIVERSITY - ABHA, KSA - 820 m<sup>2</sup> - Polyurethane indoor multipurpose sports flooring**  
**-SCHOOL IN AL WAKRA CITY - DOHA, QATAR - 800m<sup>2</sup> - Polyurethane sports flooring**  
**-SULTAN MANOR - RIYADH, KSA - 800 m<sup>2</sup> - Polyurethane multipurpose sports flooring**  
**-MINISTRY OF EDUCATION - AL KHARIZ, KSA - 800 m<sup>2</sup> - PU indoor multipurpose sports flooring**  
**-DUBAI ENGLISH SPEAKING COLLEGE - DUBAI, UAE - 783m<sup>2</sup> - Acrylic flooring, SPORTFLOOR-EX, HARD COURT**  
**-SINGAPORE AIRLINES - SINGAPORE - 735m<sup>2</sup> - PU indoor sports flooring**  
**-AL DAJAN COMPANY - GASIM, KSA - 722 m<sup>2</sup> - Polyurethane sports flooring/Tennis court**  
**-SELECTIVE GOVERNMENT HIGH SCHOOL - EGYPT - 720m<sup>2</sup>, Outdoor sports flooring**  
**-INDIAN AIR FORCE - AHMEDABAD, INDIA - 720m<sup>2</sup> - Acrylic sports courts**  
**-FITNESS TIME - FAYSALIA, DAMMAM, KSA - 700 m<sup>2</sup>-PU indoor multipurpose sports flooring/running track**  
**-FITNESS TIME YASMEEN - RIYADH, KSA - 700 m<sup>2</sup> - PU indoor multipurpose sports flooring/running track**  
**-FERRARI WORLD - ABU DHABI, UAE - 700m<sup>2</sup> - Playground flooring**  
**-FITNESS TIME JUNIOR - RIYADH, KSA - 700 m<sup>2</sup> - PU indoor multipurpose sports flooring/running track**  
**-FITNESS TIME - OLAYA RIYADH, KSA - 700 m<sup>2</sup> - PU indoor multipurpose sports flooring/ running track**  
**-FITNESS TIME WAHA - RIYADH, KSA - 700 m<sup>2</sup> - PU indoor multipurpose sports flooring/running track**  
**-FITNESS TIME, NOOR BRANCH - DAMMAM, KSA -700 m<sup>2</sup> - PU indoor sports flooring and running track**  
**-FITNESS TIME, ALAMEEN BRANCH - DAMMAM, KSA - 700 m<sup>2</sup> - PU indoor sports flooring and running track**  
**-FITNESS TIME, PLUS RIYADH - RIYADH, KSA - 700 m<sup>2</sup> - PU indoor sports flooring and running track**  
**-FITNESS TIME, SALAMA BRANCH BRO & FITNESS - JEDDAH, KSA - 700 m<sup>2</sup> - PU indoor sports flooring**  
**-FITNESS TIME, 40th BRANCH - JEDDAH, KSA - 700 m<sup>2</sup> - PU indoor sports flooring and running track**  
**-NASR CLUB- EGYPT - 700m<sup>2</sup>, Multipurpose court, POLYFLEX WET-POUR system**  
**-HUREL DOUBLE 3 - RAS AL KHAIMH, KSA - 700 m<sup>2</sup> - Shockpad plus acrylic coatings**  
**-THE SUSTAINABLE CITY - DUBAI, U.A.E - 700 m<sup>2</sup> - Acrylic flooring**  
**-EMAAR - EMIRATES HILLS 2 - DUBAI, U.A.E - 700m<sup>2</sup> - Basketball court, Acrylic flooring**  
**-AIRFORCE SURBOTO PARK - NEW DELHI, INDIA - 680 m<sup>2</sup> - Polyurethane outdoor sports flooring**  
**-INDIAN ARMY - DHRANGDHARA, INDIA - 670m<sup>2</sup> - Acrylic sports courts**  
**-MT.SAINT PATRICK ACADEMY - INDIA - 665m<sup>2</sup>- Acrylic sports courts**  
**-REGIONAL HQ AT BURAIMI - OMAN - 650 m<sup>2</sup> - Colorflex, PU sport flooring**  
**-ROYAL OMAN POLICE TASK FORCE RUSTAQ - OMAN - 650 m<sup>2</sup> - Colorflex, PU sport flooring**  
**-ROYAL OMAN POLICE TASK FORCE LIWA - OMAN - 650 m<sup>2</sup> - Colorflex, PU sport flooring**  
**-ROYAL OMAN POLICE TASK FORCE AL SALIL - OMAN - 650 m<sup>2</sup> - Colorflex, PU sport flooring**  
**-ROYAL OMAN POLICE TASK FORCE IBRI - OMAN - 650 m<sup>2</sup> - Colorflex, PU sport flooring**

-ROYAL OMAN POLICE TASK FORCE IBRA - OMAN - 650 m<sup>2</sup> - Colorflex, PU sport flooring  
-ROYAL OMAN POLICE TASK FORCE AL SUR - OMAN - 650 m<sup>2</sup> - Colorflex, PU sport flooring  
-ROYAL OMAN POLICE TASK FORCE AL DUKUM - OMAN - 650 m<sup>2</sup> - Colorflex, PU sport flooring  
-ROYAL OMAN POLICE TASK FORCE AL BURAIMI - OMAN - 650 m<sup>2</sup> - Colorflex, PU sport flooring  
-ROYAL OMAN POLICE TASK FORCE AL NIZWA - OMAN - 650 m<sup>2</sup> - Colorflex, PU sport flooring  
-ROYAL OMAN POLICE TASK FORCE AL SUWAIQ - OMAN - 650 m<sup>2</sup> - Colorflex, PU sport flooring  
-ABU DHABI MUNICIPALITY - ABU DHABI , UAE - 650 m<sup>2</sup> - Acrylic flooring  
-ROYAL OMAN POLICE TASK FORCE AL SALALAH - OMAN - 650 m<sup>2</sup> - Colorflex, PU sport flooring  
-ROYAL OMAN POLICE TASK FORCE AL BARKHA - OMAN - 650 m<sup>2</sup> - Colorflex, PU sport flooring  
-ROYAL OMAN POLICE TASK FORCE KHOUDH - OMAN - 650 m<sup>2</sup> - Colorflex, PU sport flooring  
-MOHAMMED JASSIM M AL THANI SCHOOL - UMSALALALI, QATAR - 620 m<sup>2</sup> - PU outdoor sport flooring  
-QATAR GEMS SCHOOL - DOHA, QATAR - 615 m<sup>2</sup> - Polyurethane sports flooring  
-VAISHNO DEVI - DELHI, INDIA - 608 m<sup>2</sup> - Polyurethane outdoor sports flooring  
-INDIAN ARMY - AGRA, INDIA - 600m<sup>2</sup>- Acrylic sports courts  
-THE INTERNATIONAL SCHOOL - AGRA, INDIA - 600m<sup>2</sup>- Acrylic sports courts  
-INDIAN ARMY - JHANSI, INDIA - 600m<sup>2</sup>- Acrylic sports courts  
-THE SUSTAINABLE CITY - DUBAI, U.A.E - 600 m<sup>2</sup> - Safepol system  
-AMITY SCHOOL, JUMEIRAH ISLAND - DUBAI, UAE - 600 m<sup>2</sup> - Safepol system  
-OUR OWN ENGLISH HIGH SCHOOL - SHARJAH, U.A.E - 600 m<sup>2</sup> - Flexfloor system  
-OUR OWN ENGLISH HIGH SCHOOL - SHARJAH, U.A.E - 600 m<sup>2</sup> - Polyflex Ael-EX system  
-NEW DUBAI BRADENTON SCHOOL- DUBAI, UAE - 570 m<sup>2</sup> - Acrylic sports courts  
-DUBAI SILICON OSIS-CENTRAL PARK, DSO - DUBAI, UAE - 560 m<sup>2</sup> - Jogging track  
-MPS WORLD SCHOOL - AGRA, INDIA - 560m<sup>2</sup>- Acrylic sports courts  
-AL WUKAIR GIRLS SCHOOL - AL WAKRAH, QATAR - 550 m<sup>2</sup> - Polyurethane, outdoor sport flooring  
-BBPS - DELHI, INDIA - 512 m<sup>2</sup> - Polyurethane outdoor sports flooring  
-IVY STATE - PUNE, INDIA - 511m<sup>2</sup>- Acrylic sports courts  
-KUNAL ICONIA - INDIA - 510m<sup>2</sup>- Acrylic sports courts  
-AMERICAN SCHOOL OF DUBAI - DUBAI, UAE - Acrylic sports courts  
-ETIHAD MUSEUM - JUMEIRAH, DUBAI, UAE - Rubber flooring  
-CARPARKING - ABU DHABI, UAE - Acrylic flooring  
-DUBAI MILLENIUM SCHOOL - QUSAIS, UAE - Acrylic sports courts  
-AMERICAN UNIVERSITY - DUBAI, UAE – Acrylic outdoor sports flooring  
-RAK ACADEMY - RAK, UAE - Acrylic flooring  
-ISCS - SHARJA, UAE - Acrylic flooring  
-THE INTERNATIONAL SCHOOL OF CHOUEIFAT - AJMAN, U.A.E - Sportground-Ex system  
-THE KINDER GARDEN STARTERS - DUBAI, U.A.E - Safepol system  
-AL ZAHIA PROJECT - SHARJA, UAE - Safepol system  
-WADY DEGLA SHERATON CLUB - CAIRO, EGYPT - Acrylic sports flooring  
-GEMS WELLINGTON SCHOOL - DUBAI, U.A.E - Safepol system  
-JUMEIRAH RETAIL DEVELOPMENT - JUMEIRAH, DUBAI, UAE - Safety rubber flooring  
-MR.ABDULRHMIN - JUBAIL, KSA - Rubber playground  
-GEMS WESTMINISTER SCHOOL - DUBAI, U.A.E - Safepol system  
-POLYURETHANE INDOOR SPORTS COURT - TIRANA, ALBANIA - Polyflex PU-In system  
-MULTIPURPOSE COURTS - ODESSA, UKRAINE - Rubber flooring

**-MULTIPURPOSE COURTS - ZHOVKVA, UKRAINE - Rubber flooring**

**-MUNICIPAL TENNIS CLUB - PATRA, GREECE - Flexfloor-EX system, Acrylic sports courts**

**-INDIAN AIR FORCE - GORAKHPUR, INDIA - Acrylic sports courts**

**-INDIAN AIR FORCE - BAREILLY, INDIA - Acrylic sports courts**

**-INDIAN ARMY - BABINA, INDIA - Acrylic sports courts**

**-ADAM AIRBASE PACKAGE 8, OMAN - Colorflex, PU sport flooring**

**-GOLD GYM - KOLKATTA, INDIA - Polyurethane indoor sports flooring**

**-MINISTRY OF FOREIGN AFFAIRS - ABU DHABI, UAE - Polyurethane flooring**

**-SHRJAH SPORTS CLUB - SHARJAH, UAE - Polyurethane flooring**

**-GEMS WINCHESTER SCHOOL - AL BARSHA SOUTH, UAE - Acrylic sports system**

**-HOTEL DOUBLE 3 - RAS AL KHAIMAH, UAE - Prefabricated shock-pad 4mm plus acrylic coatings**

**-AL WAHDA CLUB - ABU DHABI, UAE - Rubber flooring**

**-ADJD MAIN BUILDING LANDSCAPE PROJECT - ABU DHABI, UAE - Rubber flooring**

**-KADEEJ AL KURBA SCHOOL - ABU DHABI, UAE - Rubber flooring**

**-INTERNATIONAL SCHOOL OF CREATIVE SCIENCE - SHARJA, U.A.E - Flexfloor system/Outdoor Multipurpose court**

**-ENVIRO, VATIKA HOTELS PVT.LTD - GURGAON, INDIA - Acrylic sports flooring**

**-ASHIANA - BHUBANESHWAR, INDIA - Acrylic sports flooring**

**-TCS, ADIBATLA - HYDERABAD, INDIA - Acrylic sports flooring**

**-IPS, ERODE - CHENNAI, INDIA - Acrylic sports flooring**

**-LIONS GATE - MUMBAI, INDIA - Acrylic sports flooring**

**-MORNING GLORY INFRA LIMITED - KANPUR, INDIA - Acrylic sports flooring**

**-NAMBIAR - BANGALORE, INDIA - Acrylic sports flooring**

**-PATHWAYS - GURGAON, INDIA - Acrylic sports flooring**

**-WELHAMS GIRLS SCHOOL - DEHRADUN, INDIA - Acrylic sports flooring**

**-WOODDUCK COMMERCIAL CENTER- IRAN - Industrial flooring**

**-ARABIAN RANCHES by EMAR - DUBAI, U.A.E - Playground flooring**

**-OUR OWN ENGLISH HIGH SCHOOL - SHARJAH, U.A.E - Playground flooring**

**-NORTH LONDON COLLEGIATE SCHOOL - DUBAI, U.A.E - Playground flooring**

**-RAK MODERN SCHOOL - RAS AL KHAIMAH, U.A.E - Playground flooring**

**-GIIS/GLOBAL INDIAN INTERNATIONAL SCHOOL - RAS AL KHAIMAH, U.A.E - Playground flooring**

**-MINISTRY OF EDUCATION, NAD AL HAMAR BOYS SCHOOL - DUBAI, U.A.E - Playground flooring**

**-K.G. KIDS SCHOOL - AALI, BAHRAIN - Playground flooring**

**-SABIC BEACH CAMPS PROJECT - JUBAIL, K.S.A - Outdoor sports flooring, artificial grass.**

**-MINISTRY OF EDUCATION, MIZHER GIRLS SCHOOL - DUBAI, U.A.E - Playground flooring**

**-AL SHIMAL PARK - DOHA, QATAR - Playground flooring**

**-UM SELAL PARK - DOHA, QATAR - Playground flooring**

**-AL KABAN PARK - DOHA, QATAR - Playground flooring**

**-GEMS METROPOLE SCHOOL - DUBAI, U.A.E - Hard court system/Outdoor Multipurpose court**

**-ARABIAN RANCHES by EMAR - DUBAI, U.A.E - Acrylic Outdoor Tennis and Basketball courts**

**-RAK MODERN SCHOOL - RAS AL KHAIMAH, U.A.E - Flexfloor system**

**-GIIS/GLOBAL INDIAN INTERNATIONAL SCHOOL - RAS AL KHAIMAH, U.A.E - Acrylic system**

**-AVALON HEIGHTS - AJMAN, U.A.E - Acrylic floorings**

**-DELHI PRIVATE SCHOOL - DUBAI, U.A.E - Acrylic flooring**

**-ROYAL COMMISSION SCHOOL - JUBALI, KSA - Acrylic sports flooring**



**-FITNESS TIME PRO - AL AHSA BRANCH - KSA - Flexfloor, Basketball court**  
**-FITNESS TIME PRO - MAKKAH SHARAIE - KSA - Flexfloor, Basketball court**  
**-BIN HAM - AL AIN, UAE - Polyurethane flooring**  
**-SHAMMA BINT MOHAMMED SHOOL - AL AIN, UAE - Polyurethane flooring**  
**-ABDULLAH BIN OTAIBA - ABU DHABI, UAE - Polyurethane flooring**  
**-LIWA INTERNATIONAL SCHOOL - AL AIN, U.A.E - Colorflex outdoor sport system.**  
**-ZOHOUR KG - MANAMA, BAHRAIN - Polyurethane sports flooring**  
**-RAWDA RASHED - QATAR- Polyurethane, outdoor sport flooring**  
**-SAAD BIN ABI WAQAS SCHOOL - AL RAYYAN, QATAR - Polyurethane, outdoor sport flooring**  
**-FITNESS TIME PRO - MADINS RING ROAD BRANCH - KSA - Flexfloor, Basketball court**  
**-AGRA CHAIN - AGRA, INDIA - Acrylic sports flooring**  
**-SUNWORLD - NOIDA, INDIA - Acrylic sports flooring**  
**-SSN INVESTMENTS PRIVATE LIMITED, FRIENDS COLONY - DELHI, INDIA - Acrylic sports flooring**  
**-AJNARA - NOIDA, INDIA - Acrylic sports flooring**  
**-BRIGHT RIDERS SCHOOL - ABU DHABI, UAE - Running track, Acrylic sports court**  
**-OUR OWN ENGLISH HIGH SCHOOL - SHARJAH, U.A.E - Poltrack Spaycoat system**  
**-NCC - JAIS, INDIA - Acrylic sports flooring**  
**-ALPHA FOUNDATION FOR EDUCATION & RESEARCH - TRICHIRAPALLI, INDIA - Acrylic sports flooring**  
**-PUSHPANJALI FARMS - NEW DELHI, INDIA - Acrylic sports flooring**  
**-M3M - MERLIN GURGAON, INDIA - Acrylic sports flooring**  
**-FOOT COURT - EGYPT - Running track, POLTRACK SPRAYCOAT system**  
**-FITNESS TIME ANDALUS BRANCH - JEDDAH, K.S.A - Acrylic sports flooring, FLEXFLOOR SYSTEM**  
**-ST.JOSEPHS WOMENS COLLEGE - ALLEPPEY, KERALA, INDIA - Polyurethane outdoor sports flooring**  
**-WADY DEGLA LOTUS PROJECT - CAIRO, EGYPT - Acrylic sports flooring**  
**-RAILWAY SPORTS GROUND - GUNTAKAL, ANDRA PRADESH, INDIA - Acrylic sports flooring**

# PHOTOGRAPHS OF PROJECTS



# CERTIFICATES FOR SAFEPOL SYSTEM



## **TEST REPORT**

**14-0503IT**

Issued on November 07<sup>th</sup> 2014

CLIENT

**KATASKEVES DAPEDON LTD**

PRODUCT NAME

**SAFEPOL COLORED 55mm**

TYPE

**SHOCK ABSORBING SURFACE**

Test according to:

**UNI EN 1177:2008 Impact attenuating playground surfacing.  
Determination of critical fall height**

*Reproduction of this test report is only authorized in its entirety  
The results are solely considered valid for the specime subjected to testing*

**Labosport Italia S.r.l**

Via Monza, 80 – 23870 CERNUSCO LOMBARDONE (LC)  
Tel. +39 039 894.62.15 – Fax +39 039 968.51.68

**www.labosport.it**  
**labosport@labosport.it**

# **TEST REPORT**

**14-0446IT**

Issued on November 09<sup>th</sup> 2014

CLIENT

**KATASKEVES DAPEDON LTD**

PRODUCT NAME

**SAFEPOL COLORED 10mm**

TYPE

**SHOCK ABSORBING SURFACE**

Test according to:

**UNI EN ISO 5470-1:1999 Rubber or plastic coated fabrics. Determination of abrasion resistance. Taber abrader.**

**MI 096 Compressive strenght**

*This report may not be used for commercial purposes unless it is reproduced in its entirety.*

The results are valid only for the submitted samples as described in this report.



# PLAYGROUND FLOORING

## SAFEPOL COLORED

Elastic, safety wet-pour flooring ideal for children playgrounds in thickness from 4cm up to 15cm. Can be also used as first wet-pour layer of 6-15mm thickness for volleyball, handball, basketball, football courts and multipurpose courts, with the parallel use of paving machine.

Consists of a mixture of **RECYCLED RUBBER 858** (80% by weight) with colored **PU BINDER 1120** (20% by weight) applied by trowel with the parallel use of a cylinder (10kg). It can create many designs and patterns since the binder is produced in four colors, red, green, yellow and blue, with the parallel use of special UV-resistant paint **POLYSPORT XP 1069** in 2 crossing layers applied with airless sprayer.

The mixture of **RECYCLED RUBBER 858** with colored **PU BINDER 1120** is applied in thickness of 40mm till 150mm and can be colored in all the thickness or alternatively, in the last 10mm minimum top thickness of the system. In both cases, the top coat is the special UV-resistant, mat paint **POLYSPORT XP 1069**.

**Certified system by LABOSPORT Institute.**

### Steps:

- 1. PU PRIMER 870 - Special, polyurethane primer.**  
Applied by airless sprayer or brush.
- 2. Mixture of colored PU BINDER 1120 plus RECYCLED RUBBER 858.**  
PLAYGROUND APPLICATION: Applied by flat metal trowel after spreading and leveling with rake and straightedge. Rolling with cylinder follows for compacting.  
SPORTS FLOORING APPLICATION: Applied by paving machine in total thickness of 10mm.
- 3. POLYSPORT XP 1069 - UV-resistant, two-component, universal, mat, top coating for the protection of EPDM granules.**  
Applied in two crossing layers by airless sprayer or short haired mohair roller on the surface in the desired color, as dual protection from UV sunlight and color fading while giving the possibility to create different designs and patterns. Necessary protection for all EPDM colors except basic colors of KDF's colorchart, E3 & E10.

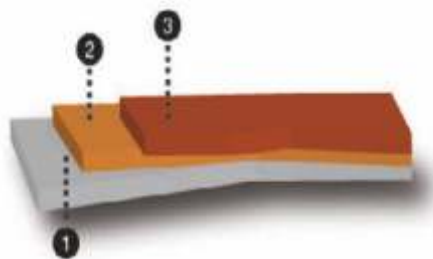

Description	Consumption
PU PRIMER 870 - Special, polyurethane, primer.	0.2-0.3kg/m <sup>2</sup> for 2 layers
PU BINDER 1120 - Colored, polyurethane binder.	1.2kg/m <sup>2</sup> for 10mm mixture
RECYCLED RUBBER 858 - SBR granules in granulometry of 1-3mm.	6kg/m <sup>2</sup> for 10mm mixture
POLYSPORT XP 1069 - UV-resistant, two-component, universal, mat, top coating for the protection of EPDM granules.	0.4kg/m <sup>2</sup> for 2 layers

**SAFEPOL COLORED SYSTEM**  
**Certified by LABOSPORT**

---



**Elastic safety wet-pour flooring ideal for children playground in thickness from 4cm up to 15cm.** Can be also used as first wet-pour layer of 6mm – 15mm for volleyball, handball, basketball, football courts and multipurpose courts, with the parallel use of paver machine.

Consists of mixture of **RECYCLED RUBBER 858** with **colored PU BINDER 1120** applied by trowel with the parallel use of a cylinder (10kg). It can create many designs and patterns since the binder is produced in various colors with the parallel use of special PU UV-resistant paint **POLYSPORT XP 1069** in a 2 cross layers by airless spray.

The mixture of **RECYCLED RUBBER 858** with **colored PU BINDER 1120** is applied in thickness of 40mm till 150mm and can be colored in all the thickness or alternatively, in the last 10mm minimum top thickness of the system.

In both cases, the top coat is the special PU UV – resistant paint **POLYSPORT XP 1069**.

**Steps :**

**a/ Playground Application**

1. **PU PRIMER 870** – Polyurethane Primer. Applied by brush in two layers. It is recommended that the second layer should be applied in sections each time, right before the application of the mixture of **PU BINDER 1120** and **RECYCLED RUBBER 858** in order to ensure proper adhesion, especially on the edges and endings of the playground flooring.
2. **Mixture of RECYCLED RUBBER 858, colored PU BINDER 1120.** Applied by flat metal trowel after spreading and leveling with rake and straightedge. Rolling with cylinder follows for compacting. Minimum 40mm thick or 10mm thick on 30mm mixture of SBR plus PU BINDER.
3. **POLYSPORT XP 1069 - UV-resistant, two-component, universal, mat, top coating for the protection of EPDM granules.**

Applied in two crossing layers by airless sprayer or short haired mohair roller on the surface in the desired color, as dual protection from UV sunlight and color fading while giving the possibility to create different designs and patterns. Necessary protection for all EPDM colors except basic colors of KDF's colorchart, E3 & E10.

#### **b/ Sport Flooring Application**

1. **PU PRIMER 870** – Polyurethane Primer. Applied by brush. It is recommended that the second layer should be applied in sections each time, right before the application of the mixture of **PU BINDER 1120** and **RECYCLED RUBBER 858** in order to ensure proper adhesion, especially on the edges and endings of the playground flooring.
2. **Mixture of RECYCLED RUBBER 858, colored PU BINDER 1120.** Applied by paver machine in total thickness of 10mm.
3. **POLYSPORT XP 1069 - UV-resistant, two-component, universal, mat, top coating for the protection of EPDM granules.**

Applied in two crossing layers by airless sprayer or short haired mohair roller on the surface in the desired color, as dual protection from UV sunlight and color fading while giving the possibility to create different designs and patterns. Necessary protection for all EPDM colors except basic colors of KDF's colorchart, E3 & E10.

#### **Important Remarks**

- During temperatures over 40 degrees, ideal time for the application of **SAFEPOL COLORED SYSTEM** is between 22:00 and 09:00 and the minimum bearing temperature during application and drying should be over 10°C.
- The freshly coated surface should be protected from high temperatures, wind, rain and frost for at least the first 24 hours.
- In case it gets damaged, it is simply repaired and recoated on the spot.

#### **Substrate**

**Asphalt is the safer subfloor for sport floorings for sure and must be always preferred than concrete surfaces.**

##### **A. Asphalt Substrate**

**The asphalt must have a slope of 0.7-1% and must dry for at least 30 days so that all solvents from the asphalt can evaporate.**

The asphalt sub-floor should be applied on well compacted 150mm road base sub-floor and asphalt should be laid in one layer (and not 2) in 6 to 8cm with fine and coarse aggregates (up to 15mm granulometry) like the kind of asphalt used in road construction.

So, new road-grade asphalt will have to be laid (minimum 60mm) in one layer containing coarse aggregates and then mature for 30 days at least, before any application takes place on top of the asphalt to avoid bubbles on the final layer of the sport or rubber floorings.

#### Asphalt Infrastructure

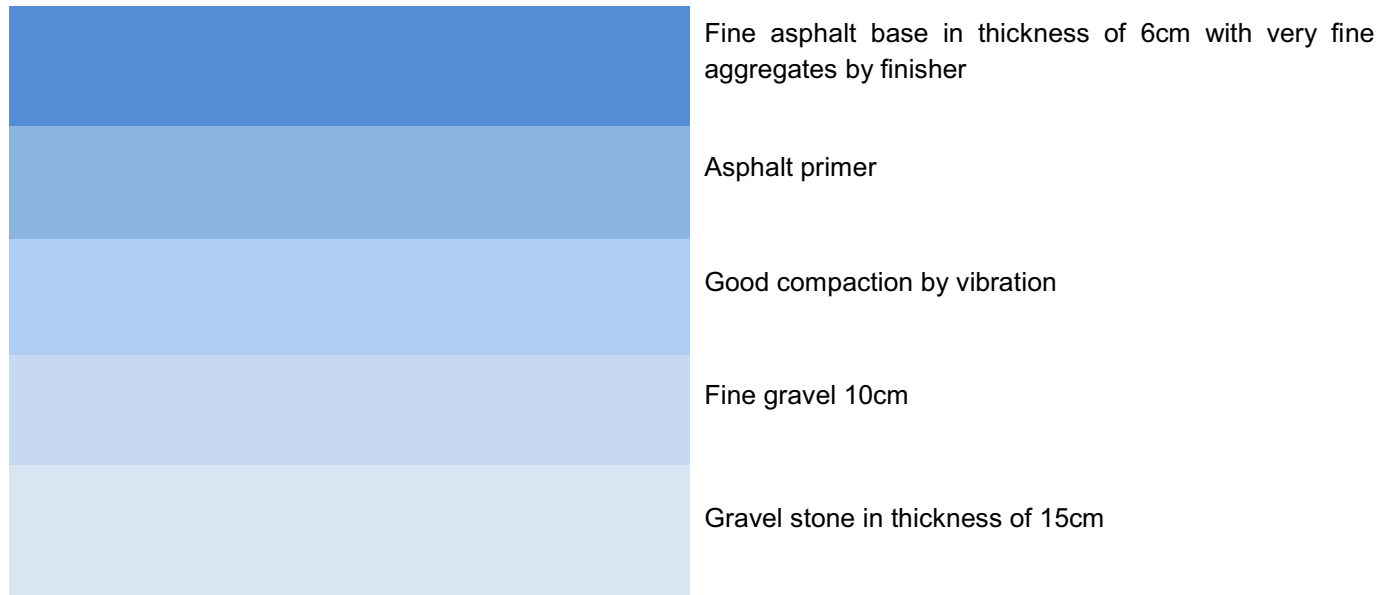

#### B. Concrete Surface

**Concrete surface must be power-trowelled without cracks and must be smooth with a slope of 0.7-1% and humidity under 4% in 10cm depth of concrete.**

Concrete must also be **dry at least for 40 days** and then the application takes place if there is no rising humidity for the sub-floor. Before the application takes place, there must be proper grinding of the surface by a grinding machine to open the pores accordingly and also a measurement by special instrument to measure humidity on the surface and in 10cm under the surface.

Generally concrete is a risky sub-floor and there may be problems with rising humidity, especially in areas where the sea level is really high and when the sea is close or in areas near greenery.

**Always make expansion joints in large areas of concrete, in order to avoid uncontrollable cracks and failures.** Joints should be every 25 square meters creating a grid of 5x5 meters or close to that.



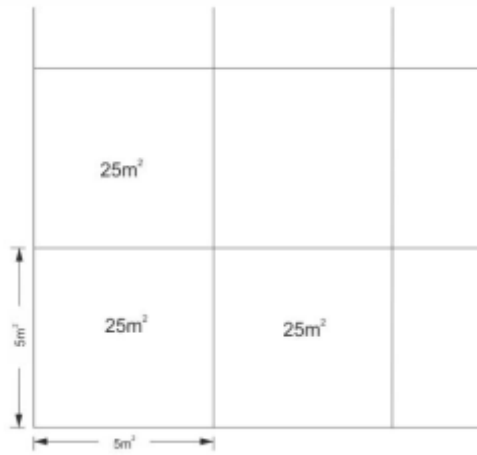

<b><u>SUBSTRATE REQUIREMENTS</u></b>	Concrete quality	at least C20/25
	Age:	at least 40 days
	Moisture content:	below 4%

**Tools:**



**Colors:** Following colorchart.





E1



E2



E9



E10



E3



E11



E4



E5



E12



E13



E6



E14



E7



E8



E15



E16



E17



E18



E19

The colors may vary slightly from the original due to digital representation.

# PU PRIMER 870

TRANSPARENT, ONE COMPONENT, POLYURETHANE-BASED PRIMER, USED AS AN ADHESIVE COMPONENT BETWEEN SUBFLOOR AND SPORTS SYSTEMS

## GENERAL CHARACTERISTICS

**POLYURETHANE PRIMER 870** is a clear, polyurethane-based, one-component primer, which is used as an adhesive component between the sub-floor and sport systems.

- Penetrates in depth.
- Ideal for old and new surfaces.

## TECHNICAL DATA

Basis:	one-component polyurethane
Appearance:	liquid
Color:	transparent
Viscosity:	50 – 250 mPa s at 25°C
Density:	0.9- 1.0 Kg/Lt
Temperature for the application and drying of the material:	10 – 40°C

## PREPARATION-APPLICATION

**Applied on dry surfaces without rising humidity issues, free of materials that might prevent bonding e.g. dust, loose particles, grease etc (in case of asphalt or concrete).** The success in the application depends on the right preparation of the underlay and use of the material.

- **Good, dry** cleaning of the surface from dust and residues.
- Priming of the surface with **PU PRIMER 870** applied by airless sprayer equipment or brush, roller. The base layer (wet-pour mixture of SBR and PU BINDER 1118) should be constructed while **PU PRIMER 870** is still a bit sticky. Curing takes place at ambient temperature by evaporation of the solvent and reaction with atmospheric moisture. High temperatures and moisture will shorten the cure time. **PU PRIMER 870** is applied in two or more layers as a thin film, and on the final layer, wet-pour mixture of SBR and PU BINDER 1118 can be applied on sticky surface.
- The temperature should not fall below 10° C during curing.
- Opened drums should be used up quickly.
- The layer (wet-pour mixture of SBR and PU BINDER 1118) should be constructed while the final layer of **PU PRIMER 870** is still sticky.
- **NOTE: Rain will cause the primer to lose its function! If the primer was affected by rain, the base layer should not be constructed! Instead, the sub floor has to dry and the primer application has to be repeated.**

## CONSUMPTION

200-300 gr/m<sup>2</sup> depending on the type and the absorbency of the underlay.

## APPLICATION TOOLS

Brush and airless sprayer. Tools should be cleaned with a PU solvent immediately after use.

## PACKAGING

Drums / Barrels.

---

## **STORAGE**

One year in unopened containers in cool and dry places, out of sunlight, with minimum temperature 5°C and maximum temperature 30°C.

---

## **REMARKS**

- Working time of **POLYURETHANE PRIMER 870** decreases when ambient temperature rises.
  - Prolonged storage of partially used containers containing **POLYURETHANE PRIMER 870** must be avoided as contact with atmospheric moisture will result in skinning and clouding of the product.
- 

## **CAUTION**

The application must take place in well-aired places using protective gloves. Skin or eye contact must be avoided, otherwise wash carefully with soap and water.

**For more information consult the safety data sheet.**

---

The information given here is true, represents our best knowledge and is based not only on laboratory work, but also on field experience. However, because of numerous factors affecting results we offer this information without any guarantee and no patent liability is assumed. For additional information or questions, contact the technical department of KDF LTD.

# PU BINDER 1120

## Pigmented MDI based Prepolymer

### GENERAL CHARACTERISTICS

**PU BINDER 1120** is an one component, aromatic polyisocyanate-prepolymer binder based on diphenylmethane diisocyanate.

Is used as a binder in manufacturing rubber granule mats, rubber molds and corks.

- Moisture curing
- low viscosity
- solvent free
- pigmented
- clean environment, free from pigment dust
- less labor cost, inventory cost
- permanent elasticity

**PU BINDER 1120** combines and bonds Recycled Rubber granules, polyurethane granules and sponge particles.

### TECHNICAL DATA

Viscosity(25°C):	8000±1000 mPas
Density (20°C):	1,30±0.1 gr/ cm <sup>3</sup>
Isocyanate NCO value %	7,80±1
Colour:	Red, green

### PREPARATION-APPLICATION

Children playground, indoor and outdoor sports grounds and offices.

#### **On-site applications:**

PU BINDER 1148 mixed with SBR granulometries and applied to entire sport/playground field with the help of special machines (paving machine) to have desired thickness. After this layer cured, the necessary controls need to be done.

#### **Molded in production:**

Rubber granules are highly dispersed with binder and taken into molds. Then pressure is applied. Prior experiences show that pressure with 160 bar and mold temperature of 130 °C gives reasonable results in 12 - 15 minutes and demolded easily. The curing time can be shortened by addition of a catalyst. In molding applications, binder consumption should not be below 7%-9% of SBR rubber granules.

### PACKAGING

220 kg in barrel

---

**STORAGE**

12 months in unopened containers in dry places with minimum temperature 5°C and high temperature 30°C (avoid sunlight).

---

**REMARKS**

The rubber granules must be dry, as moisture will accelerate the curing of the binder making installation more difficult or even impossible and may result in the binder foaming, leading to an uneven surface and a weak rubber tile. Surface must be sound, smooth, dry and free from oil, dirt, rust, chemicals and burr. Do not add different material to binder. Working time is influenced by the ambient, material and substrate temperature, as well as by humidity.

---

**CAUTION**

Avoid skin contact with the uncured product. If swallowed, consult a physician, he may decide to wash the stomach. Safety glasses and gloves are recommended. **PU BINDER 1120** is nonhazardous in its cured form.

**For more information consult the material safety data sheet.**

---

The information given here is true, represents our best knowledge and is based not only on laboratory work, but also on field experience. However, because of numerous factors affecting results we offer this information without any guarantee and no patent liability is assumed. For additional information or questions, contact the technical department of KDF LTD.

# SBR RUBBER GRANULES 858

## GENERAL CHARACTERISTICS

It can be used in sports facilities as infill in synthetic grass with the parallel use of round sand and also as one of the components in case of cast applied wet-pour systems for playground floorings or as shock-pad for sport subfloors in athletic tracks and sports fields.

Rubber granule is derived from car and truck tires. During processing, the tires are mechanically granulated, removing all metal and synthetic fibers, as well as any other foreign part contained in there with specially designed sieves, so as to produce a 99.99% clear rubber with high quality.

## PROPERTIES

- 100% recyclable
- Long life
- Resistance to adverse weather conditions
- High shock absorbency and vibration damping
- High abrasion resistance

## PREPARATION-APPLICATION

In sports facilities and playgrounds to ensure flexibility of surface and vibration absorption.

## TECHNICAL CHARACTERISTICS

### Granulometry 1-3mm

DENSITY:	0.48kg/cm <sup>3</sup>
SPECIFIC GRAVITY	1.20+/- .05 (Water = 1.0)
HARDNESS	60
HUMIDITY(%)	<0.65
ELASTICITY	100% - No change
RESISTANCE	113N/cm - Excellent

## PACKAGING

Packaging is available in big-bags -1 ton in following sizes:

Grain size	0,5-1,5 mm
Grain size	0,5-2,5 mm
Grain size	0.5-4.0 mm
Grain size	2-8 mm
Grain size	8-20 mm
Grain size	80-50 mm
Grain size	80-120 mm



# POLYSPORT XP 1069

UV resistant, two component coating for the protection of EPDM surface

## GENERAL CHARACTERISTICS

**POLYSPORT XP 1069** is a two-component, mat finish coating created for the UV protection of playground floorings, made from EPDM or TPV granules (wet pour floorings) or rubber tiles.

It is applied as a final, protective layer on top of playground floorings made from **EPDM granules** plus **PU binder** or also on recycled rubber tiles or EPDM tiles to maintain their colour.

- It doesn't change the EPDM structure or alter its appearance if applied properly by airless sprayer or properly even by simple rollers.
- It is UV-resistant and thus absolutely suitable for outdoor playground rubber surfaces.
- Ideal for renewing and refreshing old EPDM or rubber surfaces.

## TECHNICAL DATA

Mixing Ratio	90:10 by weight
Density (25°C)	1.38-1.48Kg/lt
Viscosity	4.000-7.500 mPa s at 25°C
Application Temperature	Min 10 - 40°C
Curing	3-4 hour at 25°C
Color	KDF's EPDM colorchart

## PREPARATION-APPLICATION

- Good, dry cleaning of the surface from dust and residues using vacuum cleaner and squeegees.
- Caution must be taken so that temperature of the support surface as well as ambient air remains above 10°C during application and curing of the materials while relative humidity does not exceed 75%.
- The A component should be thoroughly stirred to incorporate any slight separation, while continuing stirring of the B component should be added. Continue stirring until a homogeneous mix is obtained. Must be diluted with 15-20% water after mixing the A & B component prior application.
- Airless sprayer (ideal tool for the application) or shorthaired roller can apply **POLYSPORT XP 1069**.

## CONSUMPTION

0.3 -0.4 kg per square meter, depending on the EPDM structure, in 2 layers.

## PACKAGING

20Kg(set) - 18Kg A comp., 2Kg B comp.

## STORAGE

One year in unopened containers in dry places with minimum temperature 5°C and maximum temperature 30°C (avoid sunlight).

## REMARKS

- Working time of **POLYSPORT XP 1069** decreases when ambient temperature rises.
- Prolonged storage of partially used containers containing **POLYSPORT XP 1069** must be avoided as contact with atmospheric moisture will result in skinning and clouding of the

- product.
- After hardening **POLYSPORT XP 1069** is completely safe for health.
- 

**CAUTION**

The application must take place in well-aired places using protective gloves. Skin or eye contact must be avoided, otherwise wash carefully with soap and water.

**For more information consult the safety data sheet.**

---

The information given here is true, represents our best knowledge and is based not only on laboratory work, but also on field experience. However, because of numerous factors affecting results we offer this information without any guarantee and no patent liability is assumed. For additional information or questions, contact the technical department of KDF LTD.

# **CLEANING AND MAINTENANCE MANUAL FOR :**

## **-OUTDOOR SPORTS FLOORING**

## **-PLAYGROUND FLOORINGS**

### **Introduction**

Outdoor sports floorings and playground surfaces are made of extremely durable polymers, designed to withstand extreme climate conditions and intense use. However for the best maintenance of the rubber and sport surface a regular check (once in 6 months) is required and the maintenance of the surface is necessary to preserve the suitability of the surface (sand pits, areas of vegetation) which could leave algae, moss and leaf deposits.

The installer's guarantee will usually be conditional on the recommended maintenance requirements being carried out with due diligence.

### **Maintenance**

Maintenance procedures are necessary to preserve the lifetime of the surface and to ensure that:

- The Surface is kept clean.
- The Surface is safe for intense diverse use and all types of users.
- The facility looks attractive.

These objectives are achieved by :

- Sweeping/scraping/removing leaves and other debris and foreign matter from the surface.
- Regularly washing the surface to remove contaminants such as grime, grease, algae, moss, sand, foreign matter etc.
- Applying suitable treatments of moss-killer and/or algaecide
- Periodically removing weed growth from the perimeter kerb lines.

### **Maintenance Equipment**

Leaves, pine needles and other detritus should not be allowed to remain on the surface for any length of time. If this does happen, they rapidly rot down, forming a contaminating "skin" on the surface and providing a growth media for algae and moss.

A mechanical leaf-sweeper or vacuum cleaner is ideal for removing vegetable matter and dirt. Restricted areas may have to be cleaned by hand.

The equipment should be well maintained and carefully operated to avoid contamination of, or physical damage to, the surface. Spillage of fuel or lubricating oil will damage the surface.

The pressure loading on the surface as well as the friction and shearing loads have to be kept to a minimum to prevent damage to the surface. Large pneumatic tires and soft brushes along with careful operating of the machinery, is recommended to avoid any damage on the surface.

A mechanical leaf-sweeper or vacuum cleaner is ideal for removing vegetable matter and dirt. Restricted areas may have to be cleaned by hand.

The equipment should be well maintained and carefully operated to avoid contamination of, or physical damage to, the surface. Spillage of fuel or lubricating oil will damage the surface.

The pressure loading on the surface as well as the friction and shearing loads have to be kept to a minimum to prevent damage to the surface. Large pneumatic tires and soft brushes along with careful operating of the machinery, is recommended to avoid any damage on the surface.

At least once a year it is advisable to wash the surface with low-pressure jetting apparatus.

Polymeric surfaces can withstand low pressures without suffering damage.

Note that no aggressive chemical cleaning agents (chlorine or acid-based) should be used; normal neutral market detergents are adequate.

### **Prevention of damages**

To ensure maintaining the surfaces to a high standard, restrictions should be imposed on the use of the surface.

- In general no vehicles should be permitted to drive on the outdoor sports/playground surface.
- No chemicals, oils, fuel or solvents should be allowed on the surface.
- No fireworks or cigarettes or inadequate shoes should be allowed on the synthetic surface.

### **Damages and renovation**

The lifetime of an outdoor sports/playground surface depends on its quality, usage and level of maintenance. In general a normal outdoor sports/playground surface used intensively will last 7 to 12 years (depending on the system) before renovation is required. Renovation should be carried out periodically to prevent the total damage of the surface, which would necessitate complete renewal.

Renovation must be carried out by professional and skilled contractors with thorough knowledge of this type of work

There are different procedures for the renovation of a surface:

- Complete renewal by replacing the worn-out surface with a new sports flooring system.
- Re-topping or sealing with adequate polyurethane or acrylic materials.
- Partial re-topping in particular worn-out areas.

Information contained in this document is of general nature and is given in good faith. As the state of the surface and the use and application of the various cleaning products, is out of our control, our advice for individual cases, verbal, written or based on tests, does not exempt the applicator from the testing the suitability of the cleaning products and their applications.

The above maintenance guide refers to **the below KDF systems:**

**-SYSTEM SPORTFLOOR**

**-SYSTEM FLEXFLOOR**

**-SYSTEM POLYFLEX AEL EX**

**-SYSTEM POLYFLEX WET POUR EX**

**-SYSTEM POLYFLEX PU EX**

**-SYSTEM POLYFLEX WET POUR AEL EX**

**-SYSTEM SMARTFLOOR**

**-SYSTEM SAFEPOL**

**-SYSTEM SAFEPOL COLORED**

**-SYSTEM SAFEPOL WITH TPV GRANULES**

**-SYSTEM SAFEPOL SANDPROOF**

**-SYSTEM QUICKLAWN PLAYGROUND SAFEPOL**

**-SYSTEM QUICKLAWN PLAYGROUND SAFEPOLSANDPROOF**

**-SYSTEM COLORFLEX**

**-SYSTEM SPORTGROUND-EX**

**-SYSTEM POLTRACK SPRAYCOAT**

**-SYSTEM POLTRACK SPRAYCOAT SEALED**

- SYSTEM POLTRACK SANDWICH**
- SYSTEM POLTRACK SANDWICH IN ROLLS**
- SYSTEM POLTRACK FULL PU**
- SYSTEM POLTRACK ACRYLIC**
- SYSTEM POLTRACK JOGGING TRACK**
- SYSTEM POLTRACK PU JOGGING TRACK**
- SYSTEM POLTRACK JOGGING TRACK SBR**
- SYSTEM POLTRACK JOGGING TRACK SHOCK-PAD - EPDM**
- SYSTEM POLTRACK JOGGING TRACK SHOCK-PAD - ISOPOL**
- SYSTEM POLTRACK EQUINE**

# CERTIFICATES OF KDF Ltd



ISO KDF Ltd



POLTRACK SPRAYCOAT



POLTRACK SANDWICH



POLYFLEX AEL-EX



FLEXFLOOR-EX



SPORTFLOOR-EX



POLTRACK EQUINE



BADMINTON POLYFLEX PU



PU GRASS 149

# CERTIFICATES OF KDF Ltd



POLYFLEX PU



SPORTGROUND-EX



POLTRACK JOGGING TRACK



FIBA POLYFLEX PU



SAFEPOL



EPDM 856



PLAYPREM

Product name	Order number	Test number
SAFEPOL COLORED 15mm	14-0446IT	14-0446IT
Manufacturer	SAFEPOL	Page
Address	SAFEPOL	Number
Client	SAFEPOL	Number

**Photographs**

**Conditions**

Temperature	23°C
Humidity	50%

**Product information**

Material	SAFEPOL COLORED 15mm
Weight	2.00 kg
Thickness	15 mm
Supplier	SAFEPOL

**Test procedure**

Number 1: In the laboratory

Number 2: In the laboratory

Number 3: In the laboratory

Number 4: In the laboratory

Number 5: In the laboratory

Number 6: In the laboratory

Number 7: In the laboratory

Number 8: In the laboratory

Number 9: In the laboratory

Number 10: In the laboratory

SAFEPOL SANDPROOF

**IRTEC**

**ENHANCED SAFETY SURFACING SYSTEM**

**LABORATORY TEST REPORT**

Approximate surface falling height (EN 1177:2008) - 1000 mm

Approximate surface falling height (EN 1177:2008) - 1000 mm

Approximate surface falling height (EN 1177:2008) - 1000 mm

Test	Result
1. Impact resistance	1000 mm
2. Impact resistance	1000 mm
3. Impact resistance	1000 mm
4. Impact resistance	1000 mm
5. Impact resistance	1000 mm
6. Impact resistance	1000 mm
7. Impact resistance	1000 mm
8. Impact resistance	1000 mm
9. Impact resistance	1000 mm
10. Impact resistance	1000 mm

POLTRACK FULL-PU